



JBC WS High Temperature Wire Stripper Control Unit Instruction Manual

[Home](#) » [JBC](#) » JBC WS High Temperature Wire Stripper Control Unit Instruction Manual 

JBC WS High Temperature Wire Stripper Control Unit



This manual corresponds to the following references:

WS-9UA (100V)

WS-1UA (120V)

WS-2UA (230V)

Contents

- 1 Packing List**
- 2 Features**
- 3 Connection with WS140**
 - 3.1 Connection with WS440**
- 4 Control Process**
 - 4.1 Work Screen**
 - 4.2 Work Mode**
- 5 Operation**
 - 5.1 Troubleshooting**
Troubleshooting
- 6 Material Mode**
- 7 Accessories**
 - 7.1 Pedal P305**
 - 7.2 Flat Screw Driver***
 - 7.3 Cartridge Extractor Pliers***
 - 7.4 Metal Brush**
- 8 Maintenance**
- 9 Safety**
- 10 Specifications**
- 11 Documents / Resources**
 - 11.1 References**
- 12 Related Posts**

Packing List

The following items are included:



High-Temperature
Wire Stripper
Control Unit 1 unit



Power Cord 1 unit
Ref. 0024092 (100V)
0023715 (120V)
0023714 (230V)

JBC

www.jbctools.com

INSTRUCTION MANUAL



WS

High-Temperature Wire Stripper
Control Unit

Manual 1 unit
Ref. 0030210

Features

Control Unit

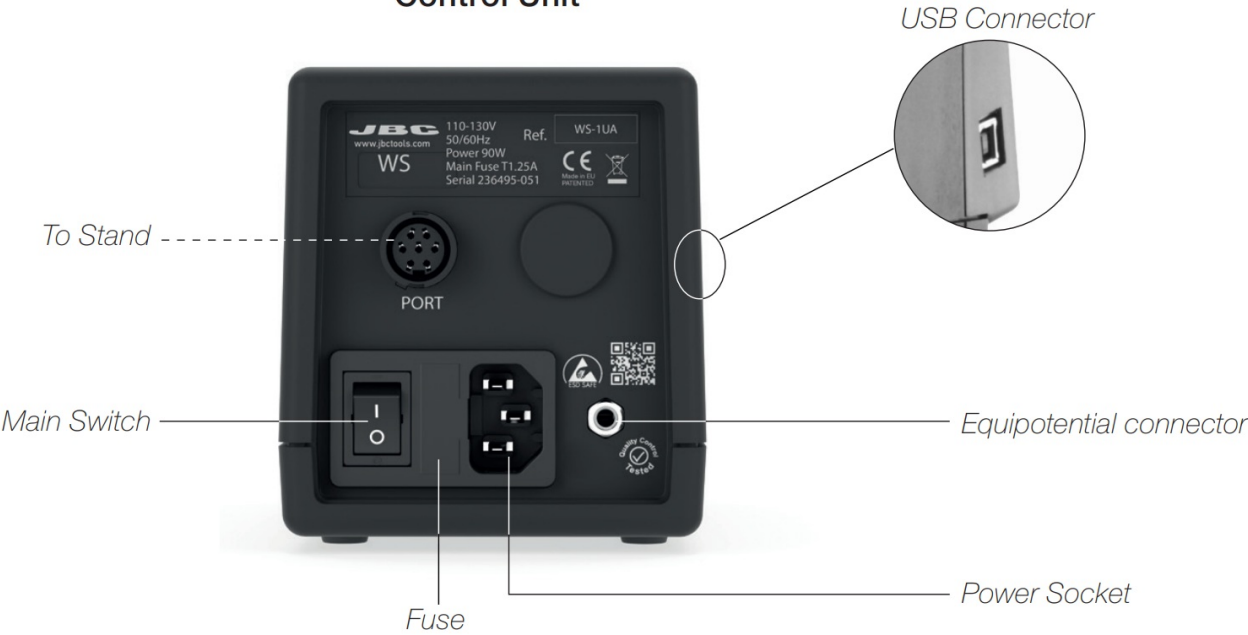

Connection with WS140

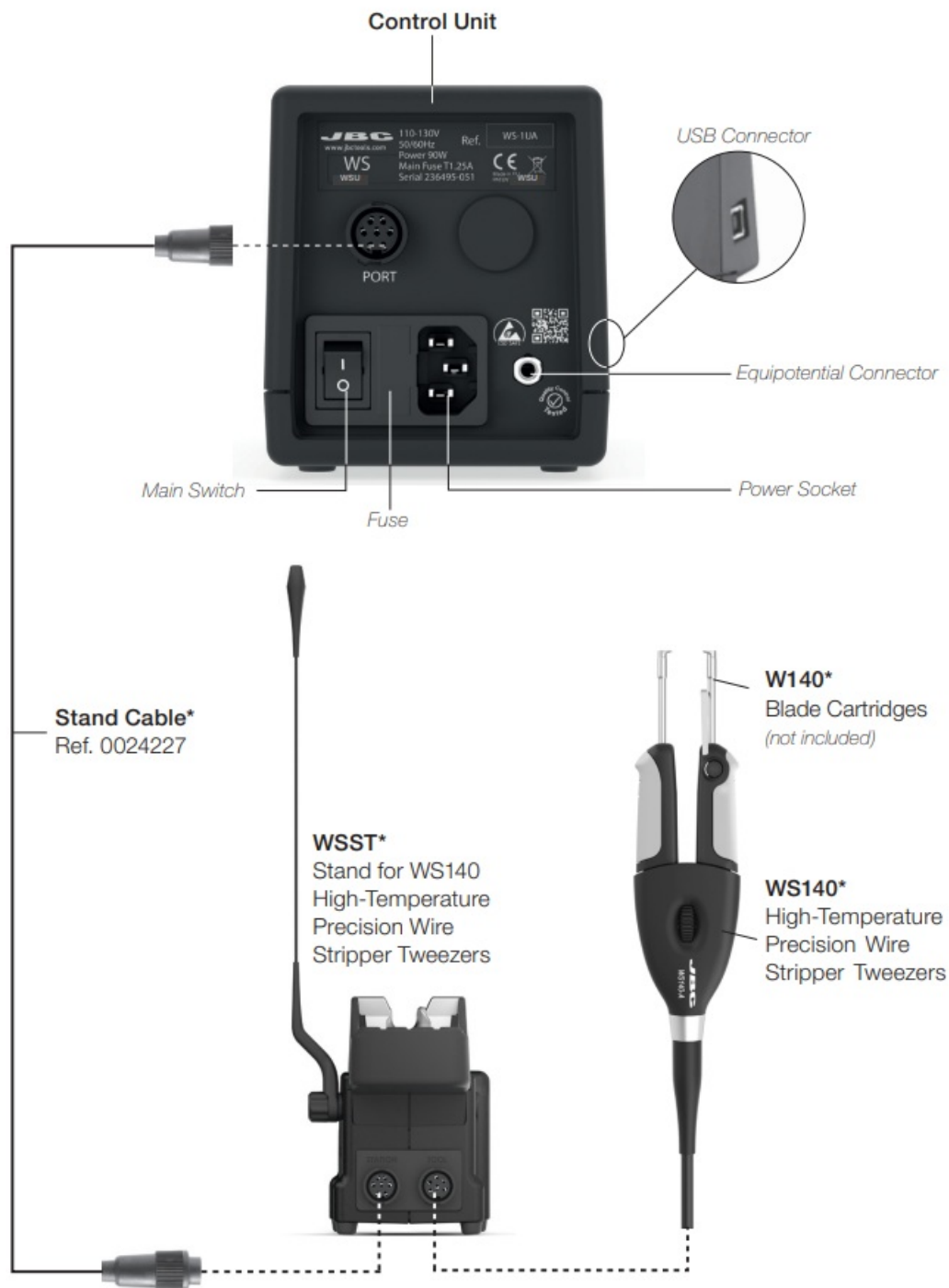

Connection with WS440

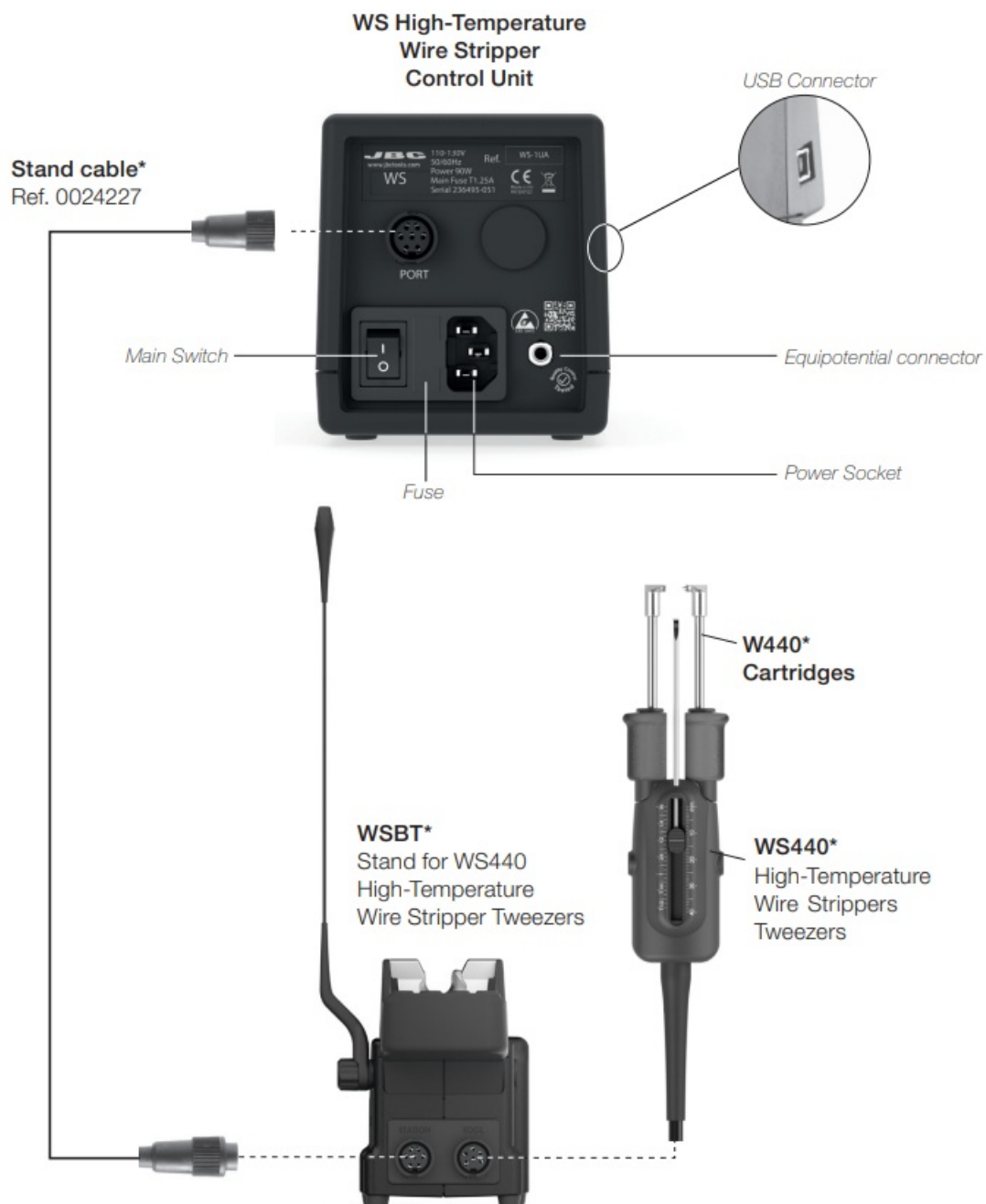

Control Process

Work Screen

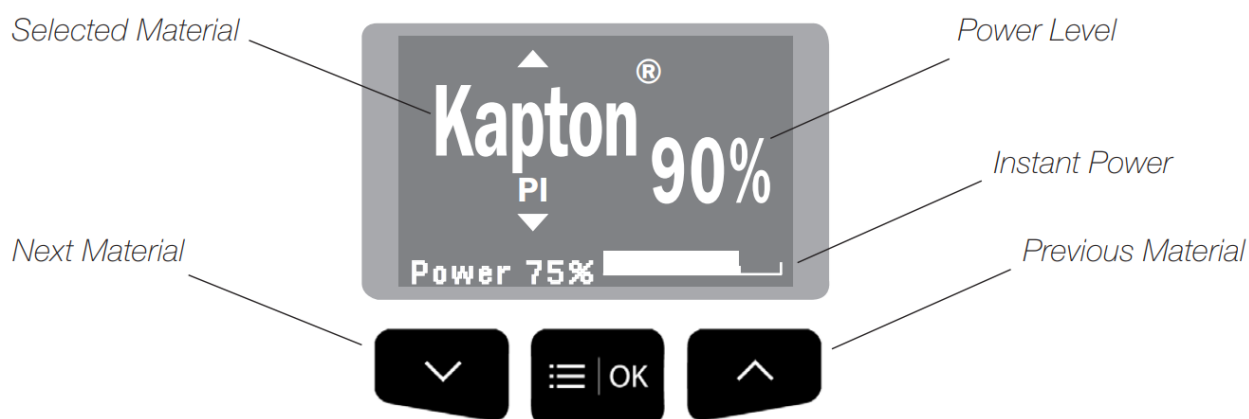



Work Mode

WS offers two different working modes. Switch the power on choose between Material Mode and Custom Mode by pressing the  button.

1. Material Mode



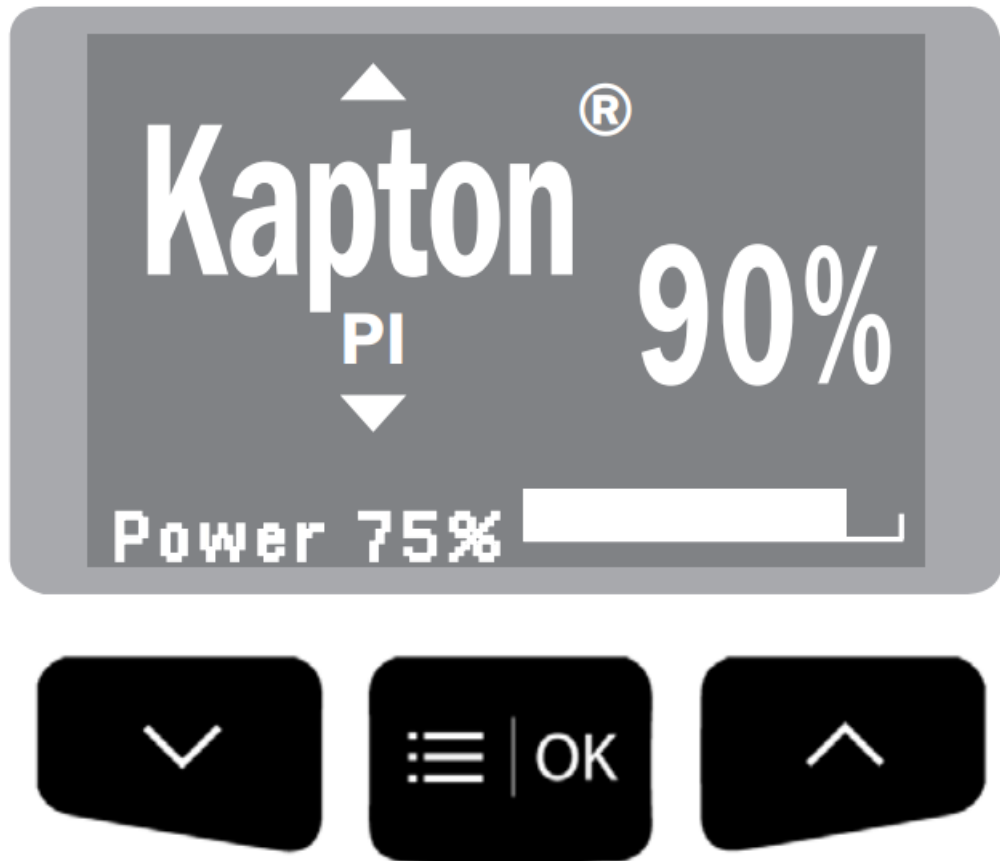

Choose between the different materials by pressing the buttons  and  to choose between all different material options.



2. Custom Mode

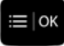

To work on a customized mode, press  and then the buttons  and  to select the power level.

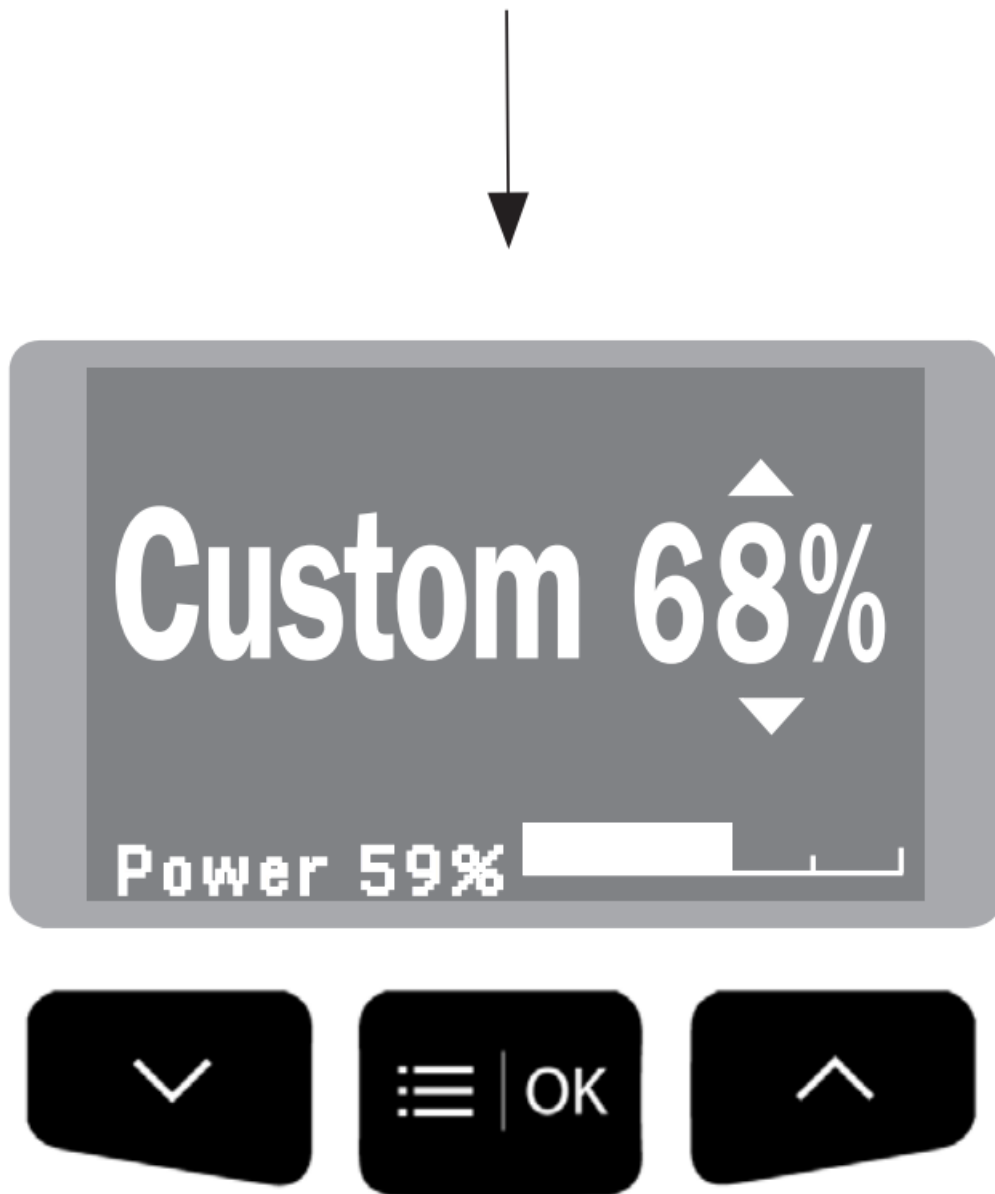

Operation

Depending on where the tool is located, the soldering station switches between three different states: Work, Sleep and Hibernation. Depending on where the tool is located, the soldering station switches between three different states: Work, Sleep and Hibernation.

These states are available for JBCs High-Temperature Wire Strippers Tweezers WS140 and WS440.

1. Work

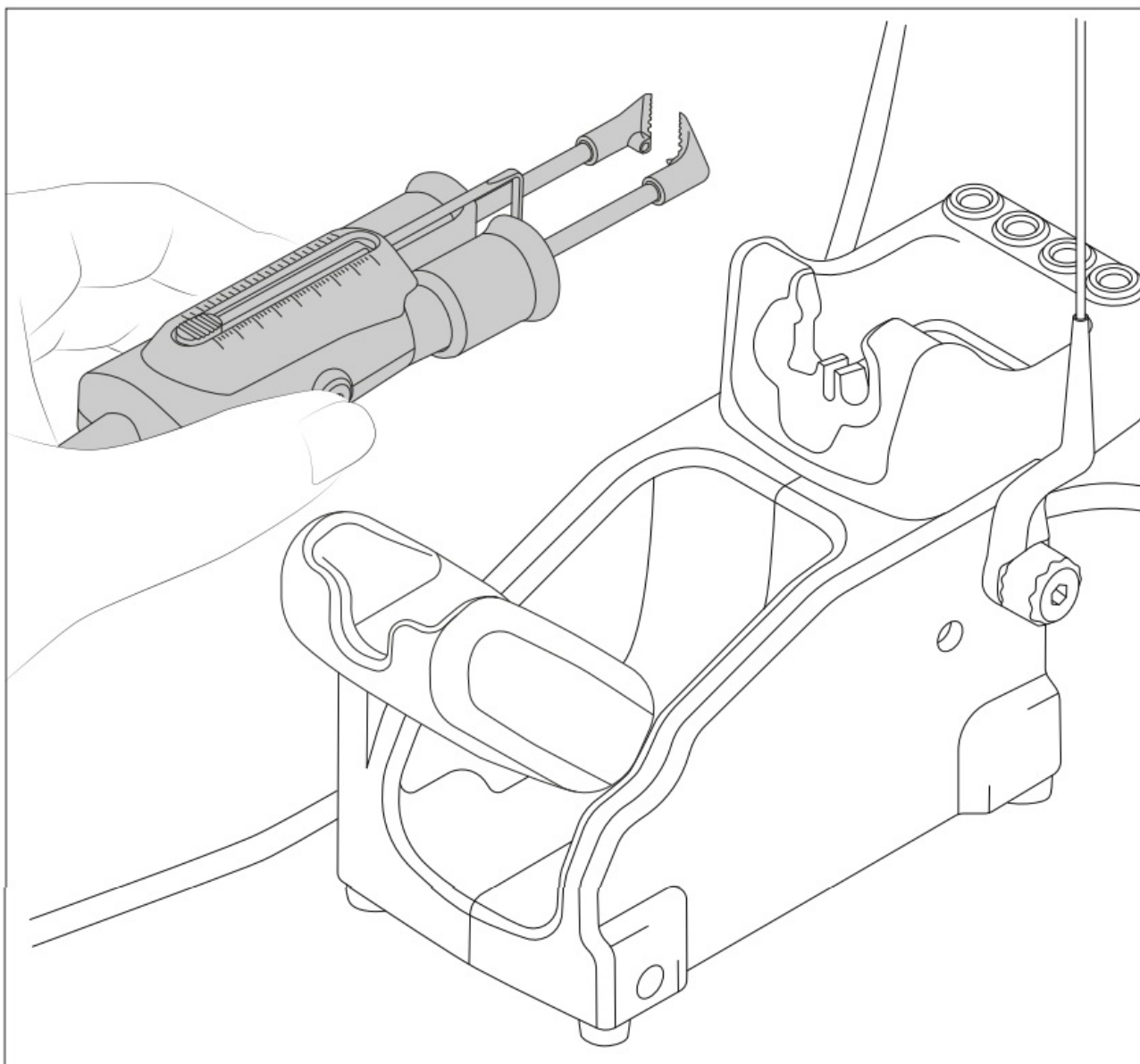

When the wire stripper is lifted from the stand, the cartridges will heat up according to the selected configuration.

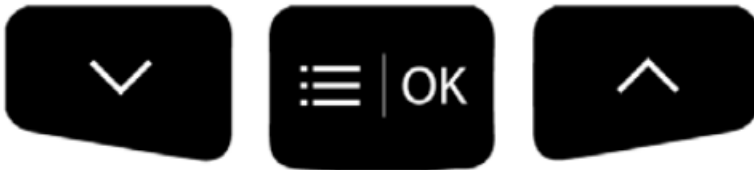
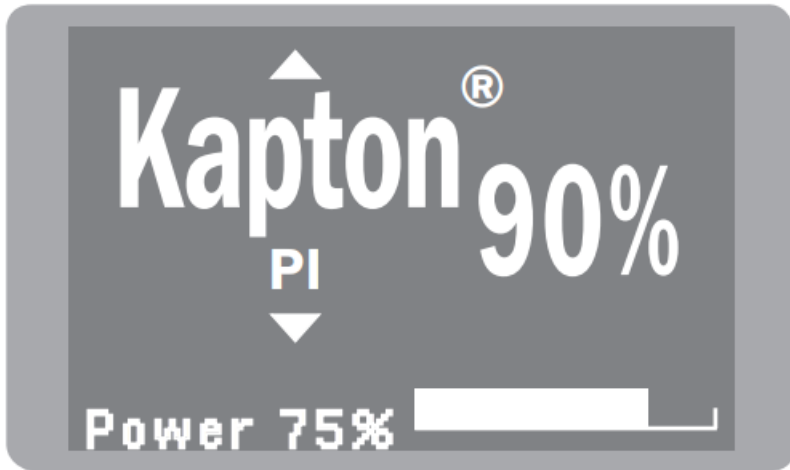

2. Sleep

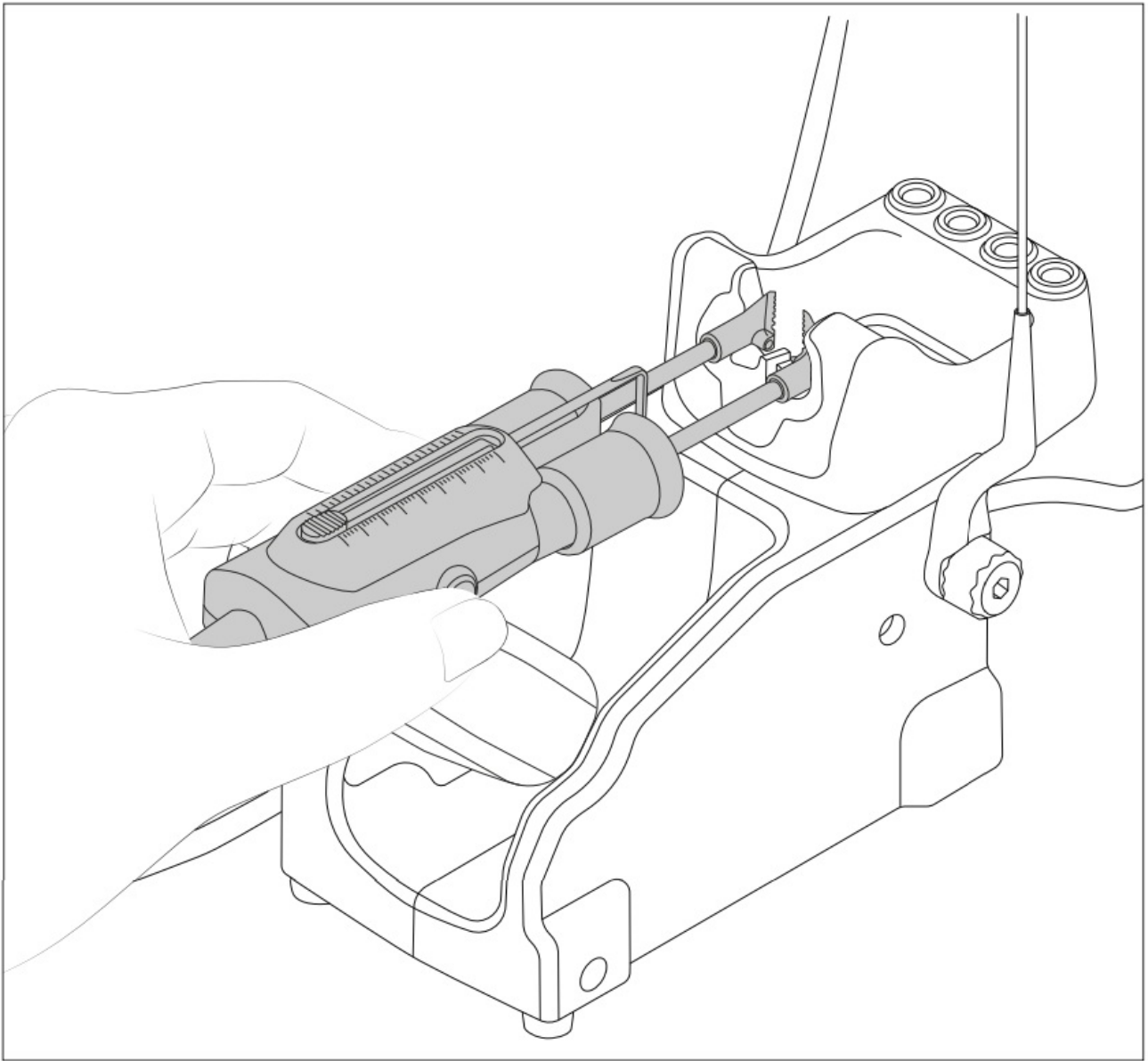

When the wire stripper is in the stand, the power falls after a specified time.

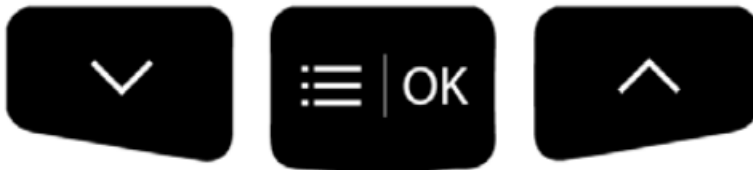
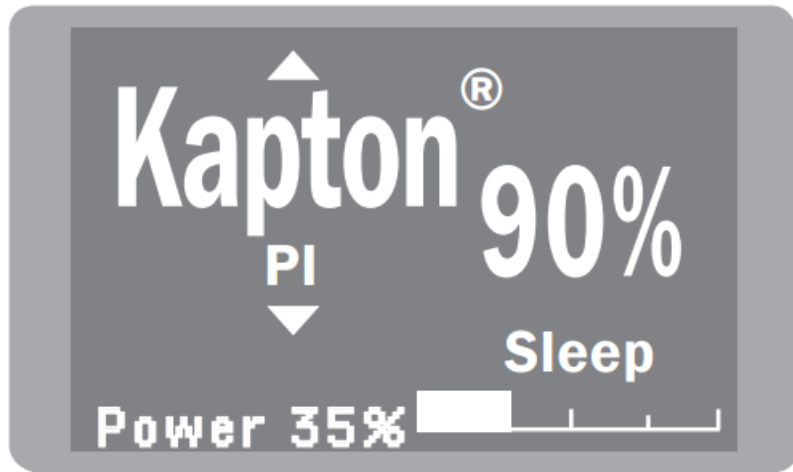

3. Hibernation

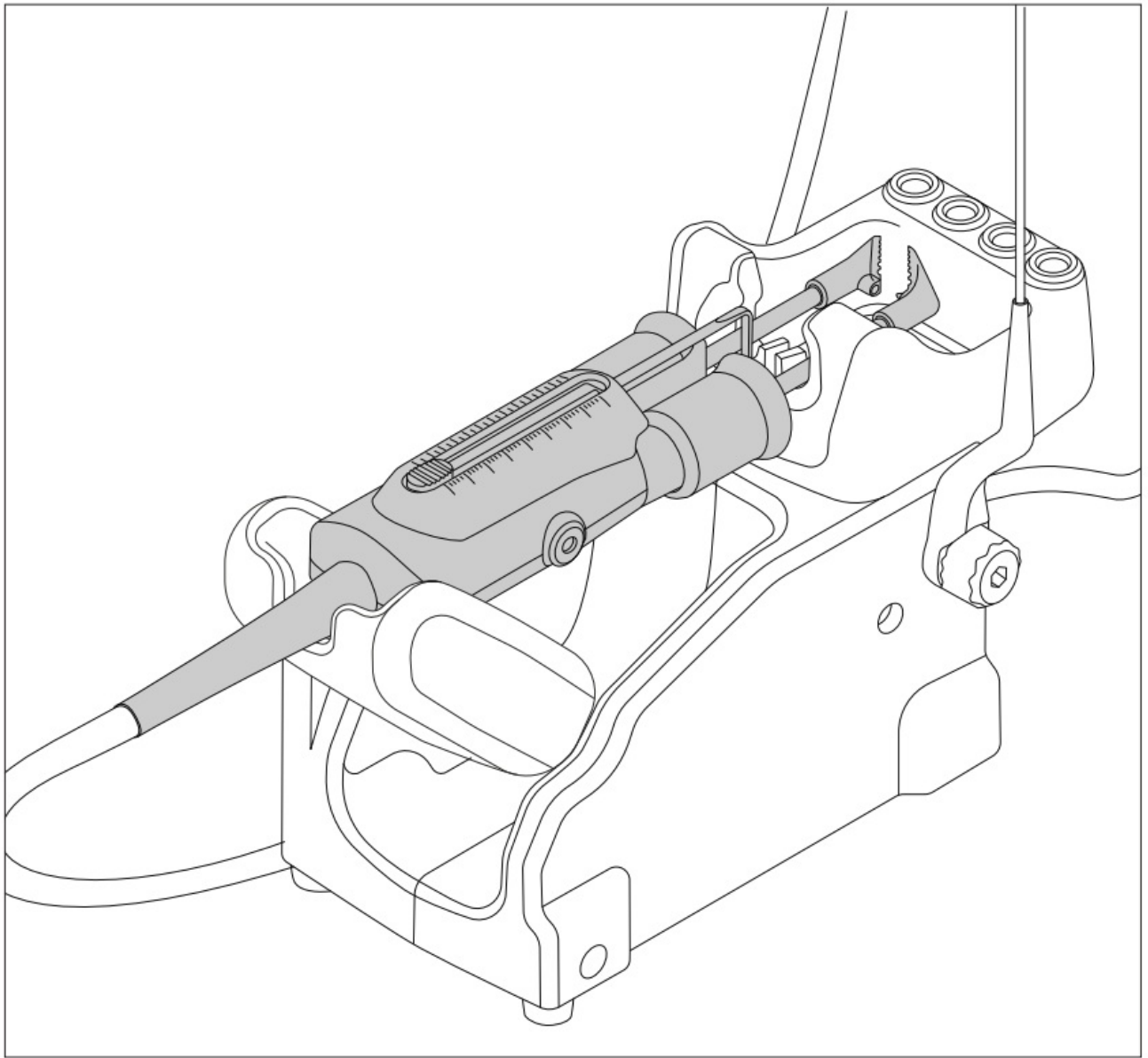

After longer periods of inactivity, the power is cut off and the cartridges cool down to room temperature.

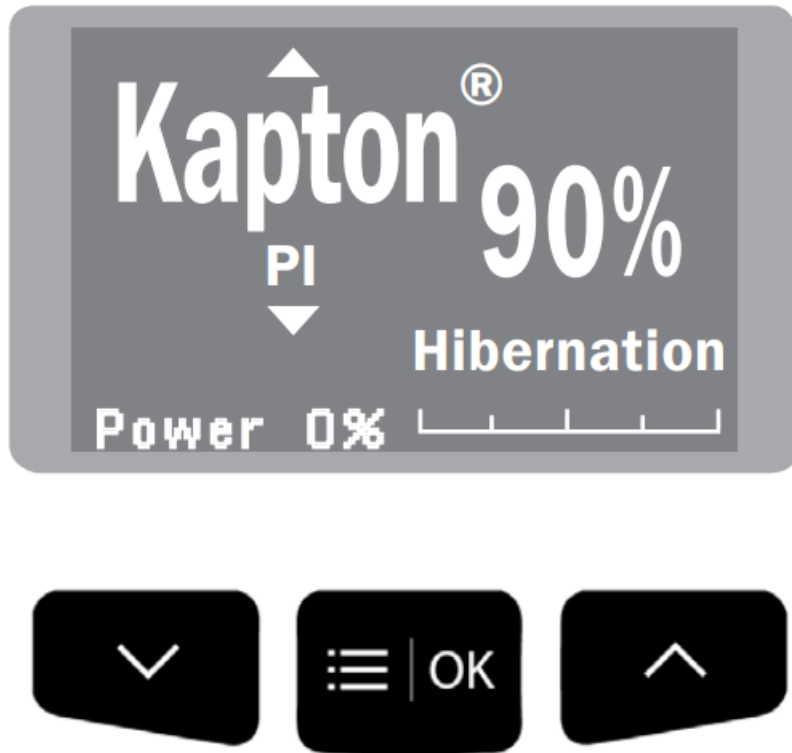

Troubleshooting Troubleshooting

Station troubleshooting available on the product page at www.jbctools.com

Material Mode

WS incorporates predetermined power levels and it also features a customized work mode. It allows you to work on wire insulations made of thermoplastics and thermostable materials such as Tefl on1 , Kapton2 , silicone, rubber, etc.

Options included:

	Insulation Material	Symbol	Power Level
Thermoplastics	Polyvinyl Chloride	PVC	6%
	Polyethylene	PE	7%
	Nylon ¹	PA	10%
	Kynar ²	PVDF	16%
	Tefzel ¹	ETFE	17%
Thermostable	Teflon ¹	FEP	16%
		PFA	21%
		PTFE	40%
	Ethylene Propylene Rubber	EPM/EPR	44%
	Silicone Rubber	SI	51%
	Kapton ¹	PI	90%

1. Registered Trade Marks of DuPont
2. Registered Trade Marks of Arkema

Accessories

Pedal P305

It can be used to activate/deactivate the Wire Stripper. Sleep and hibernation delay has to be set to 0 min. Lift the wire stripper from the stand, press and hold the pedal to activate them and strip the wire. Once the pedal is released the wire stripper enters in Hibernation. To reverse the pedal functionality flip the switch of the connection box.

Default PIN: 0105.

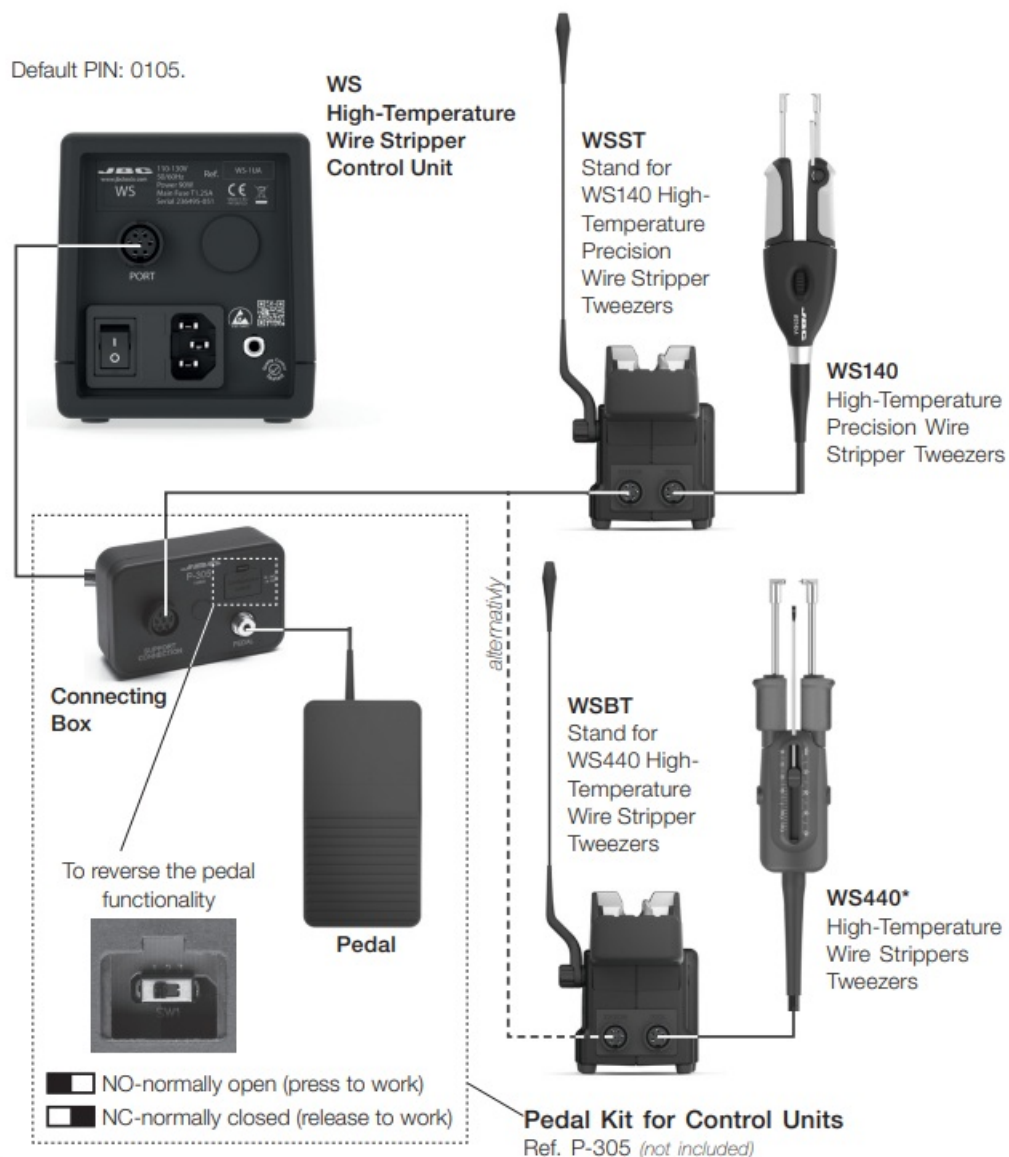

Flat Screw Driver*

To open or fix the wire stripper screws use JBC Flat Screw Driver Ref. 0023511.



Cartridge Extractor Pliers*

To manipulate the cartridges use JBC Cartridge Extractor Pliers Ref. PLR195. More Information at www.jbctools.com

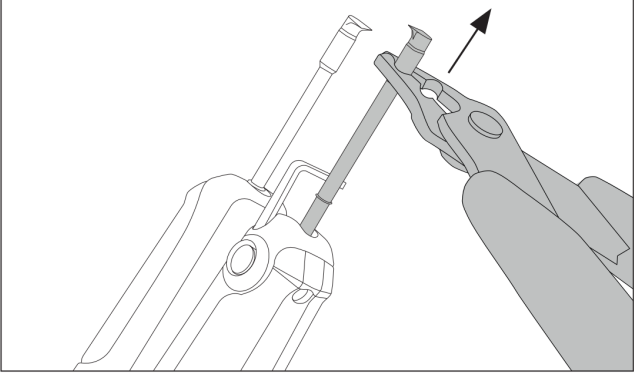
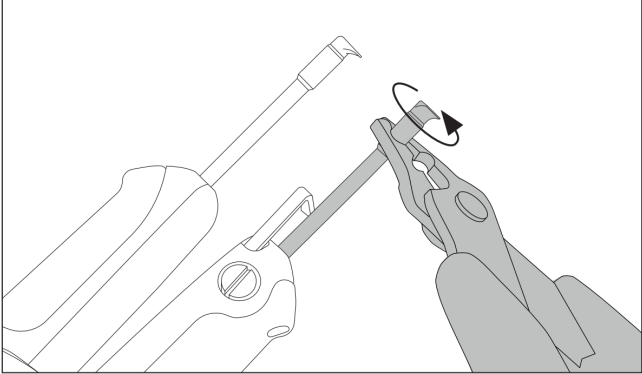

Removing	Inserting and Positioning
	
Remove cartridges with JBC pliers.	Align cartridges with JBC pliers.

Metal Brush

For cleaning the tips if unwanted material is stuck there. Metal Brush Ref. 0022793.



Maintenance

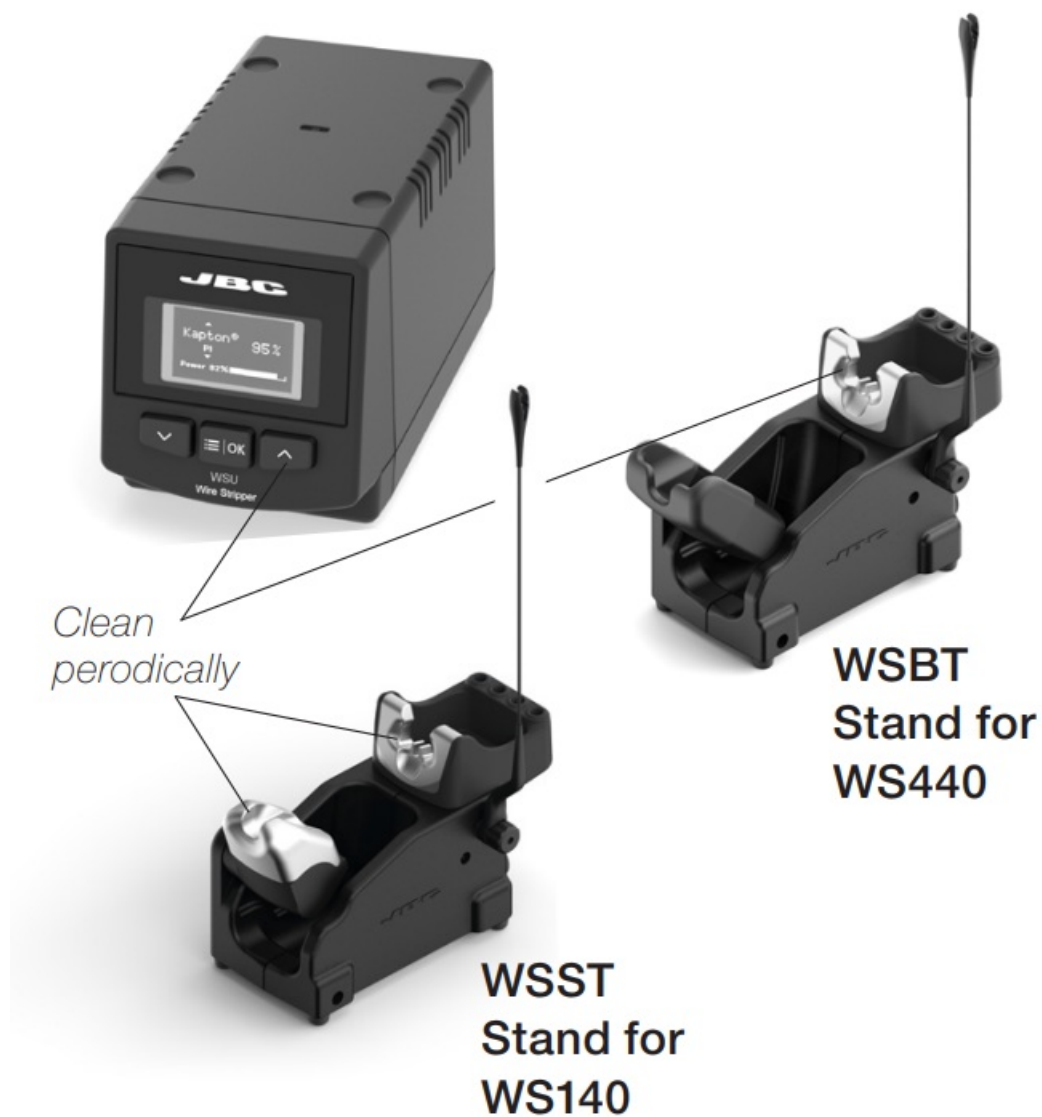

Before carrying out maintenance or storage, always allow the equipment to cool and unplug the stand from the station and the tool.

- Clean the station screen with a glass cleaner or a damp cloth.
- Use a damp cloth to clean the casing, the stand and the tool. Alcohol can only be used for cleaning the metal parts.
- Periodically check that the metal parts of the tool and stand are clean so that the station can detect the tool status.
- Maintain tip surface clean in order to ensure a correct stripped wire.
- Periodically check all cables.
- Replace a blown fuse as follows (see specification chart) :

1. take out the fuse holder and remove the fuse. If necessary use a tool to lever it out.

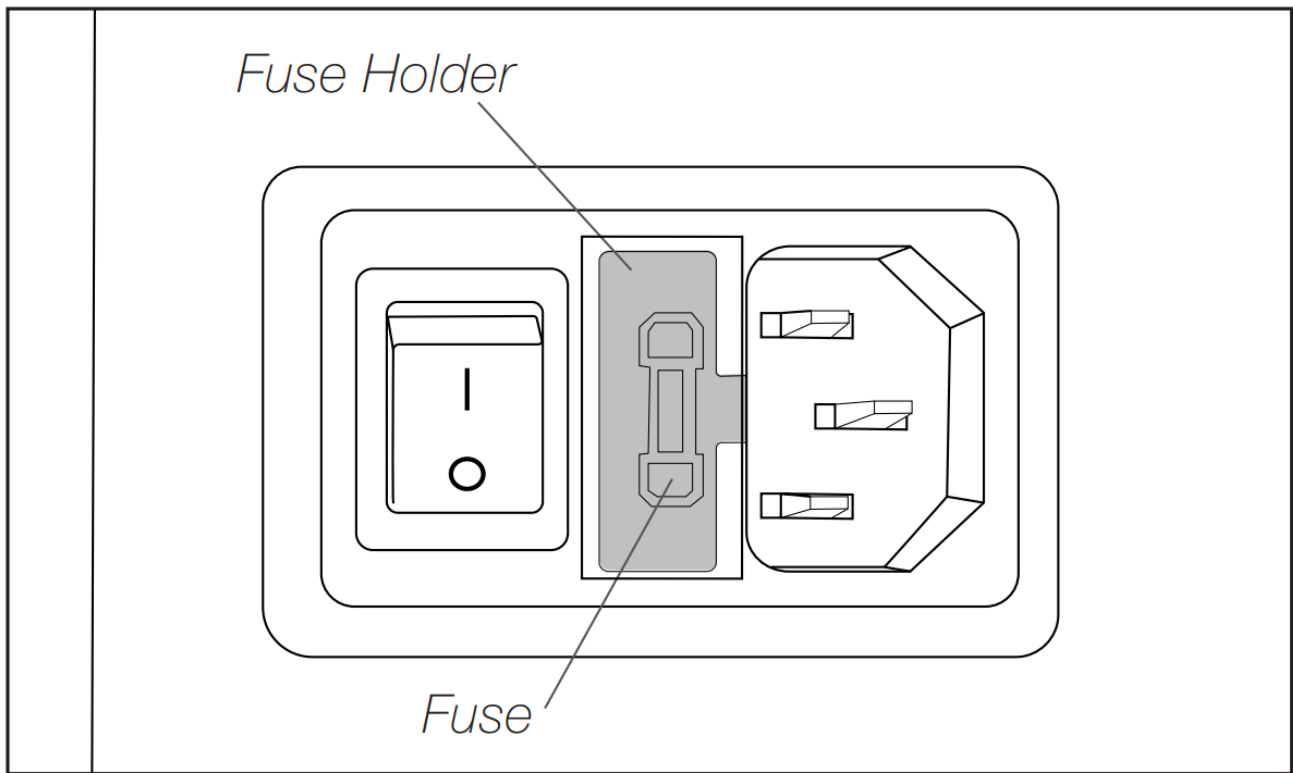

2. Press the new fuse into the fuse holder and reinsert it in the station.

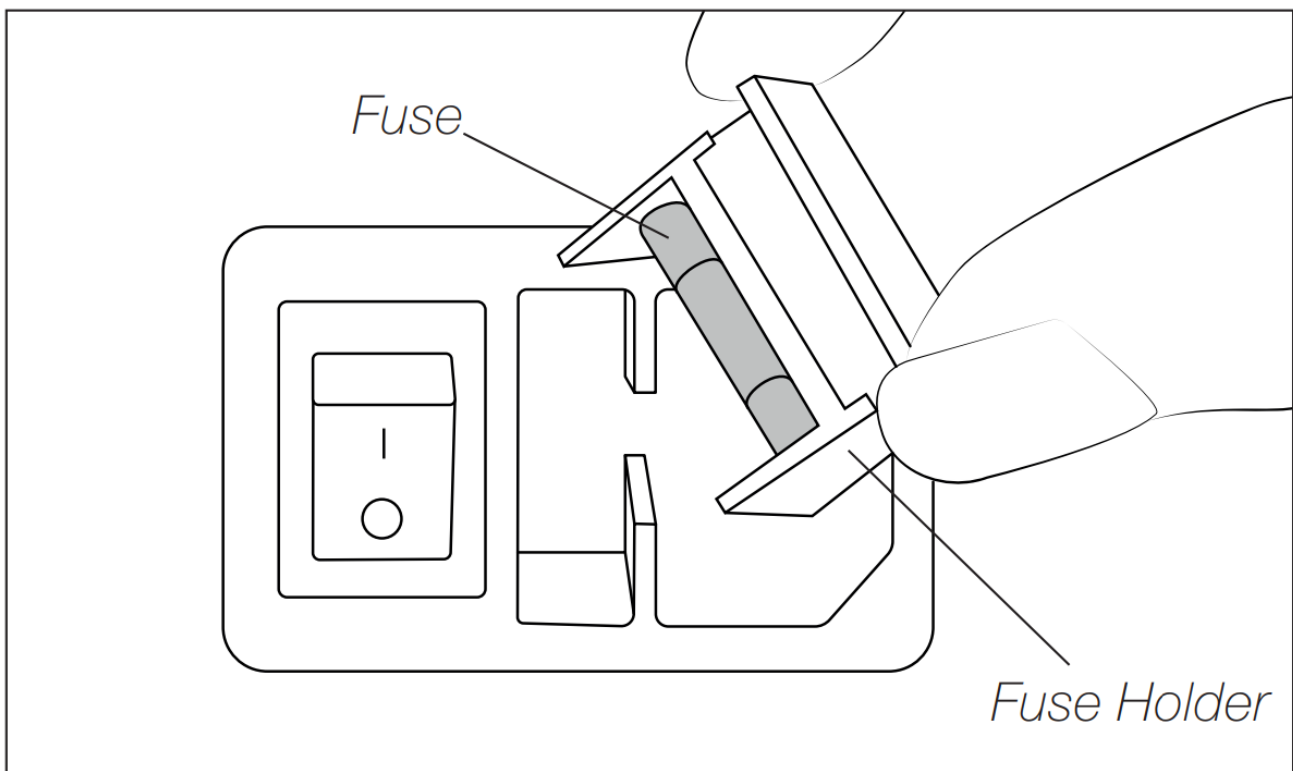

- Replace any defective or damaged pieces. Use original JBC spare parts only.
- Repairs should only be performed by a JBC authorized technical service

Safety



It is imperative to follow safety guidelines to prevent electric shock, injury, fire or explosion.

Warning

- Do not touch the blade or the metal parts around.
- Do not allow the blade be close to flammable materials.
- Keep your workplace clean and tidy. Wear appropriate protection glasses and gloves when working to avoid personal harm.
- This appliance can be used by children over the age of eight and also persons with reduced physical, sensory or mental capabilities or lack of experience provided that they have been given adequate supervision or instruction concerning use of the appliance and understand the hazards involved.
- Maintenance must not be carried out by children unless supervised.
- Place the tool on the stand when is not in use.
- Turn off the power when not in use, changing parts or storing.

Caution

- Do not use the Wire Stripper for other applications than wire stripping.
- Do not modify or customize the Wire Stripper.
- Do not hit the blade against workbench to eliminate stripped insulation debris. This behavior would damage the blade.
- Remove power from the tool by holding the plug, not the wires.
- Be careful with the fumes produced when stripping. We recomend to use our fume extractor.

Specifications

WS

High-Temperature Wire Stripper Control Unit

Ref.: **WSU-9A** 100V 50/60Hz. Input Fuse: T1.6A. 5x20mm Output: 15V

Ref.: **WSU-1A** 120V 50/60Hz. Input Fuse: T1.25A. 5x20mm Output: 15V.

Ref.: **WSU-2A** 230V 50/60Hz. Input Fuse: T0.63A. 5x20mm Output: 15V.

- Temperature Max : 800 °C /1472 °F
- Power: 75W
- Ambient operating temp: 10 to 50 °C /50 to 120 °F
- Connections: USB-B
- Control Unit Dimensions / Weight: 180 x 94 x 106 mm / 2.2 kg (L x W x H) 7.1 x 3.7 x 4.2 in / 4.85 lb
- Total Net Weight: 3.8 kg / 8.4 lb
- Total Package Dimensions / Weight: 368 x 368 x 195 mm / 4.6 kg (L x W x H) 14.5 x 14.5 x 7.7 in /10.15 lb

Complies with CE standards.

ESD safe

Warranty

JBC's 2 year warranty covers this equipment against all manufacturing defects, including the replacement of defective parts and labour.

Warranty does not cover product wear or misuse. In order for the warranty to be valid, equipment must be returned, postage paid, to the dealer where it was purchased.

Get 1 extra year JBC warranty by registering here: <https://www.jbctools.com/productregistration/> within 30 days of purchase.



This product should not be thrown in the garbage.



In accordance with the European directive 2012/19/EU, electronic equipment at the end of its life must be collected and returned to an authorized recycling facility



www.jbctools.com

JBC

Documents / Resources

 <small>INSTRUCTION MANUAL</small>  <small>WS High-Temperature Wire Stripper Control Unit</small>	<p>JBC WS High Temperature Wire Stripper Control Unit [pdf] Instruction Manual WS-9UA 100V, WS-1UA 120V, WS-2UA 230V, WS, WS High Temperature Wire Stripper Control Unit, High Temperature Wire Stripper Control Unit, Wire Stripper Control Unit, Stripper Control Unit, Control Unit</p>
--	--

References

- [JBC Soldering and Rework equipment for electronics](#)
- [JBC Warranty Extension](#)