



JBC T260-A Pick and Place Handle Instruction Manual

[Home](#) » [JBC](#) » JBC T260-A Pick and Place Handle Instruction Manual 

Contents

- [1 JBC T260-A Pick and Place Handle](#)
- [2 Product Information](#)
- [3 Product Packing List](#)
- [4 Product Specifications](#)
- [5 Product Warranty](#)
- [6 Disposal](#)
- [7 Product Usage Instructions](#)
- [8 Packing List](#)
- [9 Connections](#)
- [10 Working](#)
- [11 Specifications](#)
- [12 Warranty](#)
- [13 Documents / Resources](#)

JBC

JBC T260-A Pick and Place Handle



Product Information

The T260 Pick & Place Handle is a tool designed for efficient and precise component handling. It is accompanied by various accessories, including the CU260 Cups Set, NS260 Straight Needles Set, and NB260 Bent Needles Set. The product package also includes a manual for reference. The T260 Pick & Place Handle is compliant with CE standards and is ESD-safe, ensuring safe usage in electronic environments. It comes with a 2-year warranty that covers manufacturing defects, with the provision for the replacement of defective parts and labor.

Product Packing List

- Pick & Place Handle – 1 unit (Ref. T260-A)
- CU260 Cups Set – 1 unit (Ref. 0940163)
- Manual – 1 unit (Ref. 0028986)
- NS260 Straight Needles Set – 1 unit (Ref. 0901546)
- NB260 Bent Needles Set – 1 unit (Ref. 0861660)

Product Specifications

- Total Net Weight: 21 g / 0.046 lb
- Package Dimensions/Weight: 240 x 115 x 43 mm / 171 g
- Complies with CE standards
- ESD safe

Product Warranty

JBC's 2-year warranty covers this equipment against manufacturing defects, including the replacement of defective parts and labor. The warranty does not cover product wear or misuse. To avail the warranty, the equipment must be returned, postage paid, to the dealer from where it was purchased.

Disposal

This product should not be thrown in the garbage. In compliance with European directive 2012/19/EU, electronic

equipment at the end of its life must be collected and returned to an authorized recycling facility.

Product Usage Instructions

1. Choose the appropriate needle from the NS260 or NB260 set, based on the component being handled.
2. If required, select the appropriate suction cup from the CU260 Cups Set.
3. Connect the tool to the station suction plug.
4. For correct suction, insert the needle into the cup as shown in the picture. Ensure the needle does not protrude from the cup.
5. To activate suction, cover the pen hole with your finger and lift off the component.
6. To release the component, lift your finger from the pen hole.

This manual corresponds to the following references:

T260-A

Packing List

- The following items are included:



Pick & Place Handle 1 unit



Manual 1 unit
Ref. 0028986



CU260 Cups Set 1 unit
Ref. 0940163

Ø 4.3 mm - 0940112 (x2)
Ø 7 mm - 0940111 (x2)
Ø 10 mm - 0940110 (x2)



**NS260
Straight Needles Set**1 unit
Ref. 0901546

Ø 0.7 mm - 0901512 (x2) black
Ø 0.9 mm - 0901520 (x2) yellow
Ø 1.2 mm - 0901538 (x2) pink



**NB260
Bent Needles Set** 1 unit
Ref. 0861660

Ø 0.8 mm - 0861540 (x2) green
Ø 0.9 mm - 0861560 (x2) yellow
Ø 1.2 mm - 0861580 (x2) pink

Connections



- Choose the needle that best fits the component and the suction cup if needed.
- Connected the tool to the station suction plug.

Working

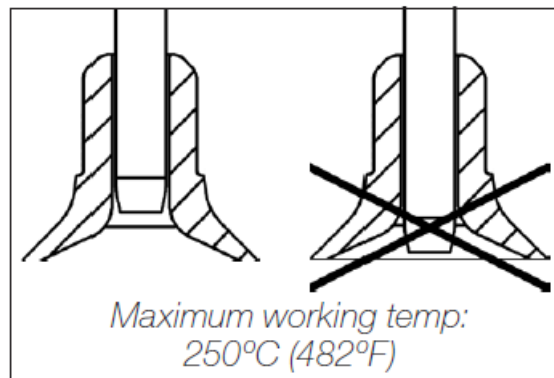

- For a correct suction process insert the needle in the cup as shown in the picture.
- Make sure the needle does not protrude from the cup.

Suction

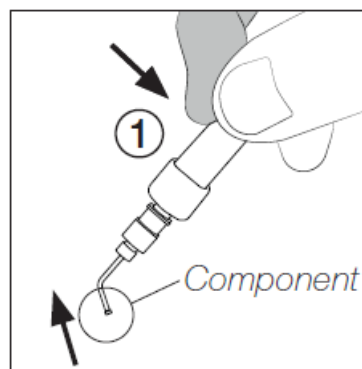

Release

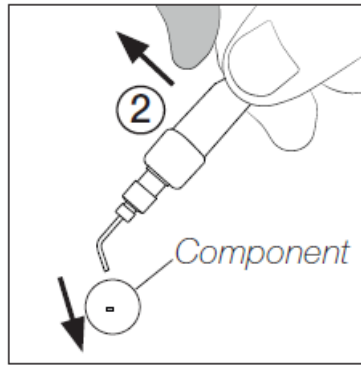

- Once the suction is activated, cover the pen hole with your finger (1) and lift off the component.
- Lift your finger (2) from the pen hole to release the component.

Specifications

T260 Pick & Place Handle

- **Ref:** T260-A
- **Total Net Weight:** 21 g / 0.046 lb
- **Package Dimensions/Weight:** 240 x 115 x 43 mm / 171 g (L x W x H) 9.45 x 4.53 x 1.69 in / 0.377 lb
- **Complies with CE standards:** ESD safe.

Warranty



- JBC's 2-year warranty covers this equipment against all manufacturing defects, including the replacement of defective parts and labor.
- The warranty does not cover product wear or misuse.
- In order for the warranty to be valid, equipment must be returned, postage paid, to the dealer where it was purchased.

Disposal



- This product should not be thrown in the garbage.
- In accordance with the European directive 2012/19/EU, electronic equipment at the end of its life must be collected and returned to an authorized recycling facility.



<div> <small>www.jbcheels.com</small> INSTRUCTION MANUAL</div> <div></div> <div>T260 Pick & Place Handle</div>	<p>JBC T260-A Pick and Place Handle [pdf] Instruction Manual</p> <p>T260-A Pick and Place Handle, T260-A, Pick and Place Handle, Place Handle, Handle</p>
---	--