



JBC CLR Tip Cleaner for Robot Instruction Manual

[Home](#) » [JBC](#) » JBC CLR Tip Cleaner for Robot Instruction Manual 

Contents

- [1 JBC CLR Tip Cleaner for Robot](#)
- [2 Packing List](#)
- [3 Features](#)
- [4 Connection](#)
- [5 Work Position Adjustment](#)
- [6 Accessories: Brush Ranges](#)
- [7 Dimensions](#)
- [8 Work Place Example](#)
- [9 Maintenance](#)
- [10 Safety](#)
- [11 Warranty](#)
- [12 Documents / Resources](#)
- [13 Related Posts](#)

JBC

JBC CLR Tip Cleaner for Robot



Packing List

The following items should be included:



- Tip Cleaner for Robot .. 1 unit
- Metal Brushes1 unit
- Ref. CLMU-A8 (2 brushes)
- Connector Cable (3m) 1 unit

Features

CLR is an automatic tip cleaner with two motorized brushes. It features a large-capacity collecting container with easy extraction and a wide opening for easy access to the soldering tip.

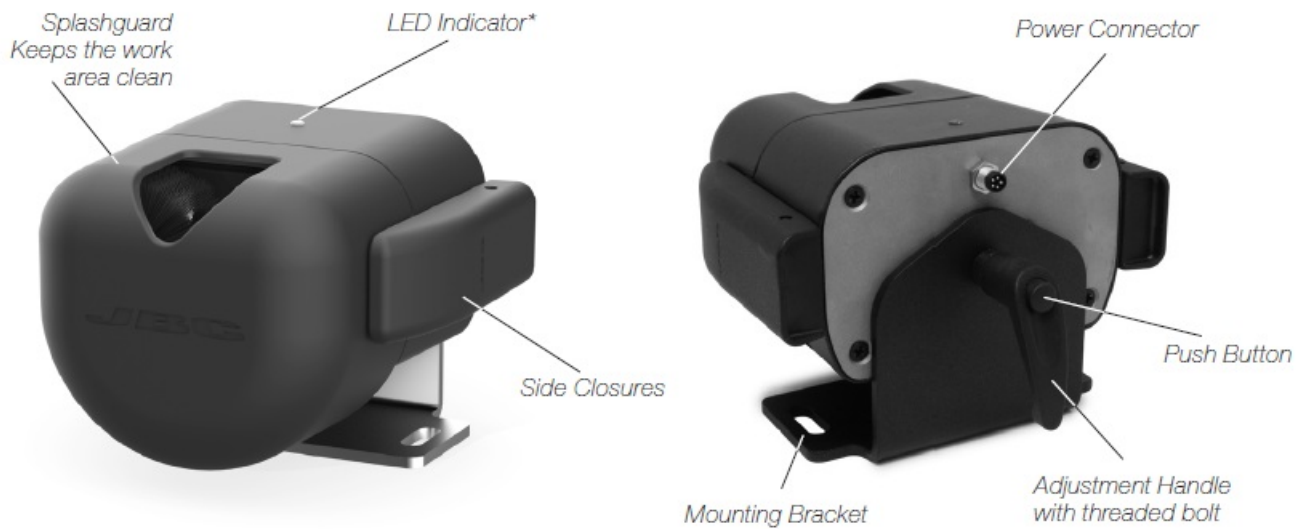

* Blue: Connected
Green: Working
Red (blinking): Blocked (Tip too large or depth limit is exceeded)

Connection



- CLR can be connected to a PLC by a five-pin connector cable.
- The connector provides a “switch” input and power supply.
- The input switch manages the cleaner’s activity. It can be connected to a PLC’s digital output and accepts PNP, NPN, or relay contacts.

For detailed information about pin distribution see the following table:

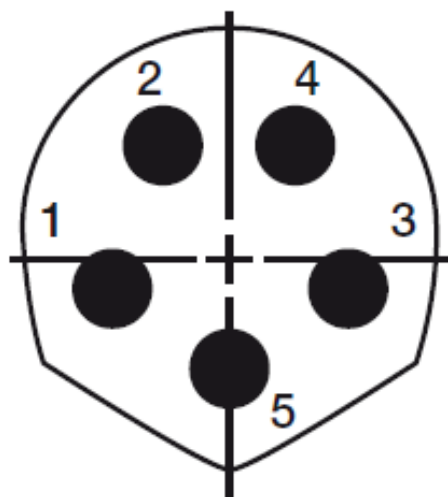

Front view

CLMR Power Connector

| Power Connector | | |
|-----------------|-------|--|
| Pin | Color | Description |
| 1 | Brown | Power supply input: 24Vdc ($\pm 5\%$). 2.5A current required. |
| 2 | White | Not used |
| 3 | Blue | Common reference: GND for power supply and switch. |
| 4 | Black | Switch input: 0V or 24V to start cleaning. Leave it open to stop. |
| 5 | Grey | Not used |

Work Position Adjustment

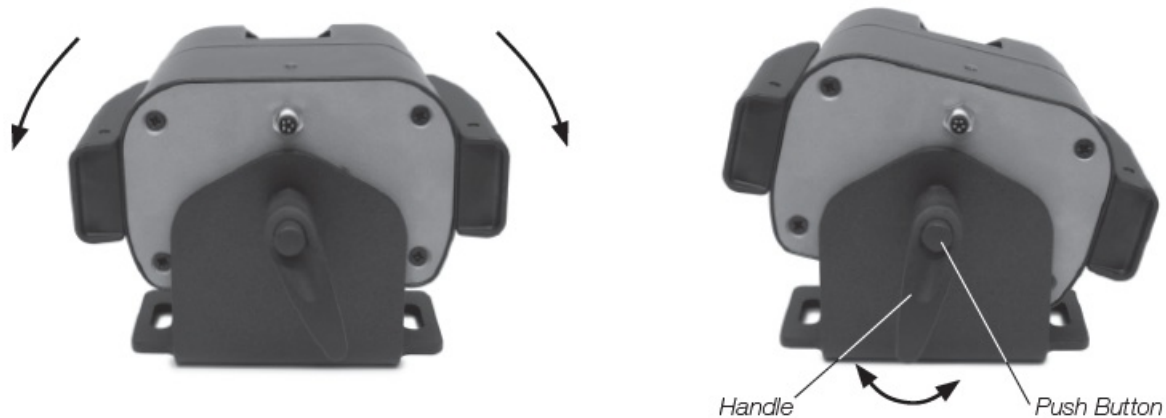





- CLR can be turned up to 35° in both directions to facilitate the cartridge tip's insertion.
- To pivot the CLR, loosen and tighten the handle to turn it. The Handle can be aligned vertically again by pressing the Push Button.

Accessories: Brush Ranges

All brushes are offered with black and blue core, to distinguish them when working with lead-free and leaded solder.

Note: As a reference, the cleaning process should last around 1 second.

| | CLU8 | CLU7 | CLUP1 / CLUP2 | CLUP7 / CLUP8 |
|-----------------------------|---|---|--|---|
| |  |  |  |  |
| Material | Metal | Metal | Non-Metal* / Non-Metal HMP* | Non-Metal* / Non-Metal HMP* |
| Cleaning | Intensive | Intensive | Gentle | Gentle |
| Max. time use | 10 s | 10 s | 5 s | 5 s |
| Recommended time use | 1-2 s | 1-2 s | 1-2 s | 1-2 s |
| Life cycle | Long | Long | Extended | Extended |
| Core | Black | Blue | Black | Blue |

Work Place Example

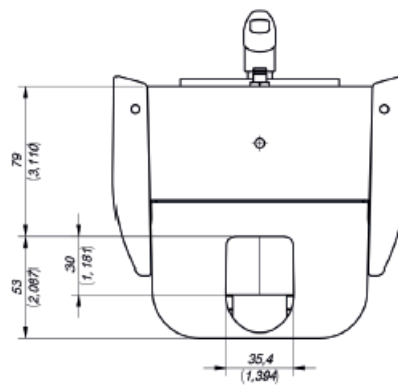
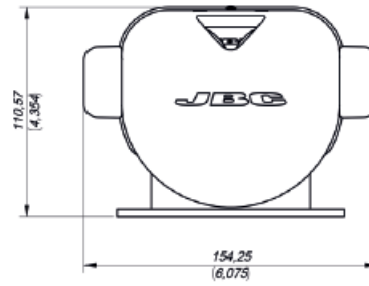
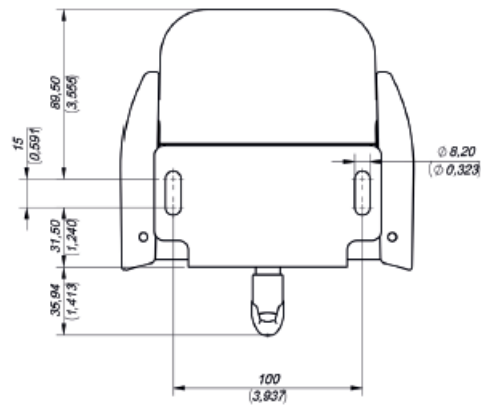

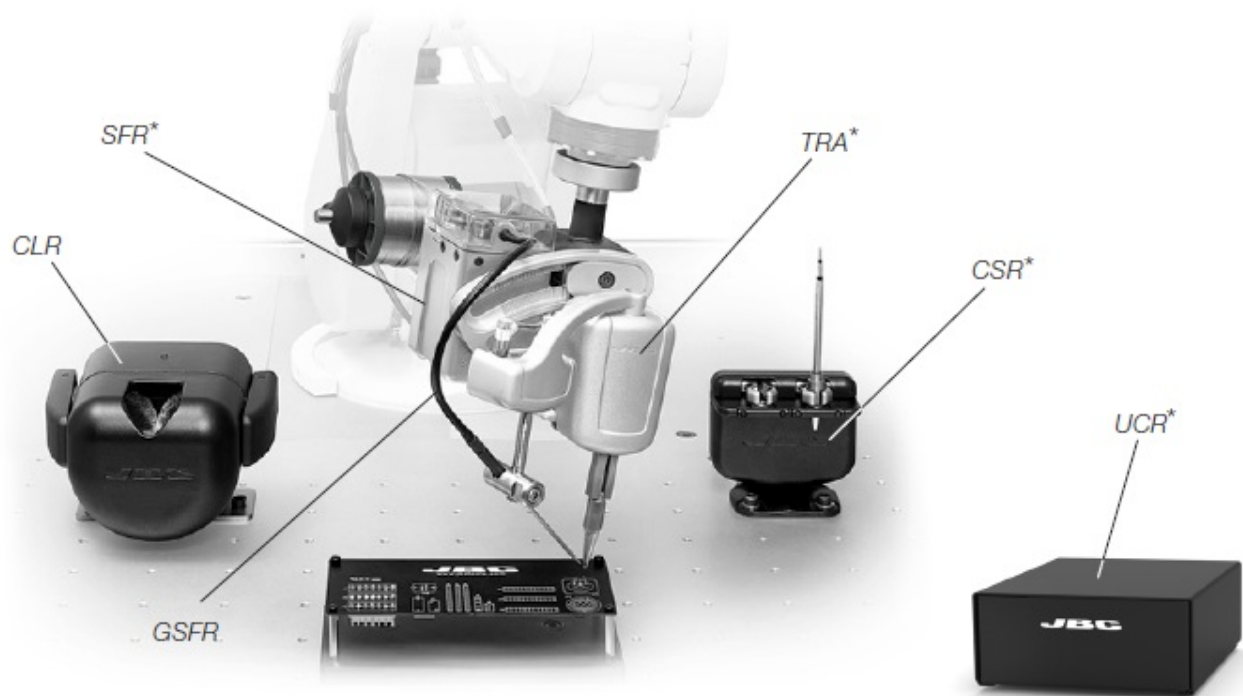

**Not included, sold separately*

Maintenance

Changing Brushes

Easily replace brushes and clean the solder collector tray as follows:

1. Unplug CLR from the mains and open the side closures.
2. Remove the Splashguard and press the brush's buttons (1) to remove them (2).

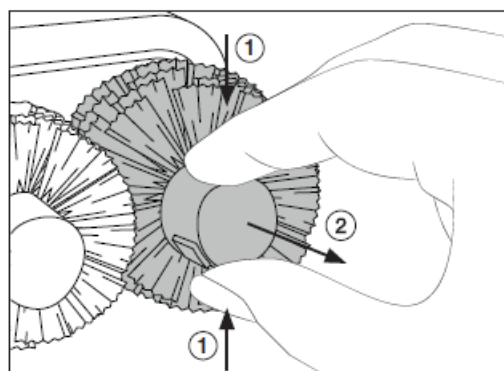
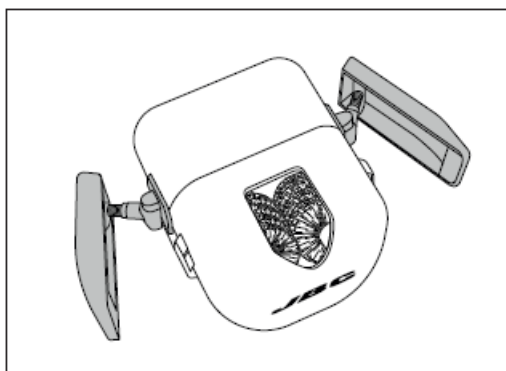

3. Align the brush axis with the motor axis and insert the brushes. Push them in until a click is heard. Check if the brushes are properly affixed.
4. The Splashguard also works as a tin collector. Clean it and place it back in its position.

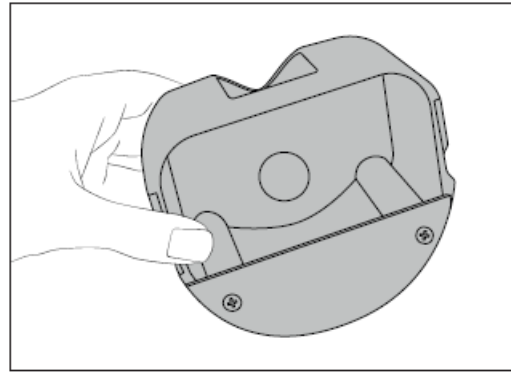
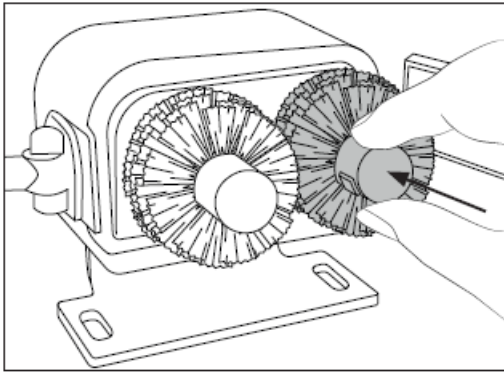

- Before carrying out maintenance or storage, unplug the equipment from the main supply.
- Use a damp cloth to clean the splashguard outside and inside.
- Keep the brushes clean and replace them when necessary.
- Periodically check all cables and tube connections.
- Replace any defective or damaged parts. Use original JBC spare parts only.
- Repairs should be performed only by a JBC-authorized technical service.



Safety

It is imperative to follow safety guidelines to prevent electric shock, injury, fire, or explosion.



- Do not use the equipment for any purpose other than tip cleaning. It is not a tool stand.
- Do not leave the equipment unattended when it is on.
- You must turn the device off before changing the brushes.
- The temperature of accessible surfaces may remain high after the equipment is turned off. Handle with care.
- Heat can cause inflammable products to ignite even when not visible.
- Avoid contact when brushes are rotating.
- Be careful with the fumes produced when soldering.
- Keep your workplace clean and tidy. Wear appropriate protection glasses and gloves when working to avoid personal injury.
- Utmost care must be taken with liquid tin waste which can cause burns.

Warranty

JBC's 2-year warranty covers this equipment against all manufacturing defects, including the replacement,of defective parts and labor. The warranty does not cover product wear or misuse. In order for the warranty to be valid, equipment must be returned, postage paid, to the dealer where it was purchased.

This product should not be thrown in the garbage. In accordance with the European directive 2012/19/EU, electronic equipment at the end of its life must be collected and returned to an authorized recycling facility.

Documents / Resources

| | |
|---|---|
| <div><div> www.jbctools.com INSTRUCTION MANUAL</div><div></div><div>CLR Tip Cleaner for Robot</div></div> | <div>JBC CLR Tip Cleaner for Robot [pdf] Instruction Manual CLR Tip Cleaner for Robot, CLR, Tip Cleaner for Robot</div> |
|---|---|