



JASSWAY APUS Professional POS System User Manual

September 15,
2025

Contents [[hide](#)]

1 JASSWAY APUS Professional POS System

2 PRECAUTION

2.1 An important letter to customers

2.2 About the manual

2.3 Declaration of security

2.4 Warranty declaration

3 1. Product Overview

3.1 1.1 Product Features

3.2 1.2 Specification

3.3 1.3 External Dimension

3.4 1.4 Product Views

3.5 1.5 Introduction of I/O port

3.6 1.6 Installation Style

4 2. Powering ON/OFF the APUS

4.1 2.1 Power on

4.2 2.2 Power off

5 Specifications

6 Warranty notice

7 Contact Information

8 FAQ

8.1 Q: Can I upgrade the RAM on this device?

8.2 Q: What operating systems are compatible with this product?

9 Documents / Resources

9.1 References

10 Related Posts

JASSWAY APUS Professional POS System



USER MANUAL

VOC-V-SDTS-A4G-I511TH16G128

PRECAUTION

An important letter to customers

1. Personal safety is very important when the equipment is operated and maintained.

The manual includes necessary warning and considerations for safe operation. Before operating and maintaining the equipment, ensure to read these completely and understand all safety warning and relevant items.

2. Don't repair or adjust the equipment by yourself. If the failure that cannot be solved by following flow described in the instructions, switch off the power supply and remove the power plug. Contact us or qualified repairmen for help.

About the manual

3. The manual serves as instruction for use of the series products. There is no further

notice for update of manual content and version, etc.

Declaration of security

4. The contained guide and description is only applicable to the product when the manual is issued. No further notice will be given for change of product content and manual content, specification and instructions. No responsibility will be undertaken for damage caused by direct or indirect mistake, omission or difference. The product implements GB4943.1 and GB 9254-2008 standard.

Warranty declaration

5. When repair for failure is made for the product, please return it to the original factory for repair. Don't remove, change, install inner components or repair the product. If damage and failure are caused due to dismantling or installing the product, inner components and improper use, the warranty becomes invalid immediately.

1. Product Overview

1.1 Product Features

- 15.6-inch full HD display with virtually borderless widescreen.
- Windows and Android OS support.
- Ultra-slim bezel design (8mm), with elegant and stylish appearance.
- Aluminum alloy body delivers beauty and utility with effective heat dissipation.
- Slim thickness, can create a more sophisticated space.
- 10.1" customer display.
- Plenty of I/O ports support Easy system expansion.

1.2 Specification

| | |
|-----------|-----------------------------|
| Model No. | VOC-V-SDTS-A4G-I511TH16G128 |
| SYSTEM | |

| | | |
|----------------|--|---|
| Processor | Intel Celeron J6412 Quad-Core, Up to 2.60 GHz Intel Alder Lake-N97 Quad-Core, Up to 3.60GHz Intel Core i3/i5 10th High Performance CPU | Intel Tiger Lake i3-1115G4 Fanless CPU Intel Tiger Lake i5-1135G7 Fanless CPU |
| RAM | DDR41 x SO-DIMM DDR4 slot, 4GB RAM Standard, Up to 16 GB | |
| ROM | 128GB SSD Standard, 256GB, 512GB Option | |
| OS | Windows 10/11 | |
| DISPLAY | | |
| Main Display | 15.6 Inch LED Backlight Display | |
| Resolution | 1920*1080 | |
| Brightness | 250 nits, 300 nits Option | |
| Aspect Ratio | 16:9 | |
| Second Display | 10.1 inch (Touch on 2nd Display Option) | |
| Touchscreen | Projective Capacitive Touch Screen | |
| INTERFACE | | |
| USB | 4*USB 2.0, 2*USB 3.0 | 4*USB 2.0, 2*USB 3.0 |
| LAN | 1*RJ45 10/1000m Ethernet | 1*RJ45 10/1000m Ethernet |
| Cash Drawer | — | 1*RJ11 |
| Serial | 1*DB9 RS232 COM | 2*RJ50 RS232 COM |
| Display | 1*HDMI | 1*HDMI |
| Audio | 1*3.5mm Audio Jack | — |

| | | |
|--------------------------|---|--------------------------------|
| Power Supply | Adapter 12V, 5A/7A(DC Plug) | Adapter 24V, 3.75A(3-Pin Plug) |
| PHYSICAL & ENVIRONMENTAL | | |
| Operating Temperature | Operating 0°C~45°C at 5% to 90% humidity | |
| Storage Temperature | Storage -12°C~60°C at 10% to 90% humidity | |
| Dimensions | (W×D×H) 210x363x375 mm | |

| | |
|-----------------------|------------------------------|
| Packing Dimensions | (W×D×H) 460x290x460 mm |
| Net Weight | 3.60 kg |
| Packing Weight | 7.20 kg |
| Material | Anodised aluminum, plastic |
| Color | Space black |
| OPTIONS & PERIPHERALS | |
| Wifi | 2.4 g dual-band Wi-Fi Option |
| Bluetooth | Bluetooth 4.2/5.0 Option |
| Speaker | 1*2w Speaker Option |

1.3 External Dimension

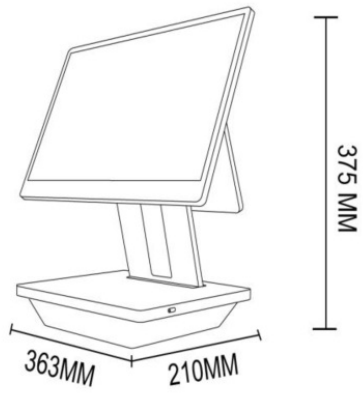

Front view



Back view



side view

1.4 Product Views



1.5 Introduction of I/O port

1.5.1 I/O port of i3-1115A

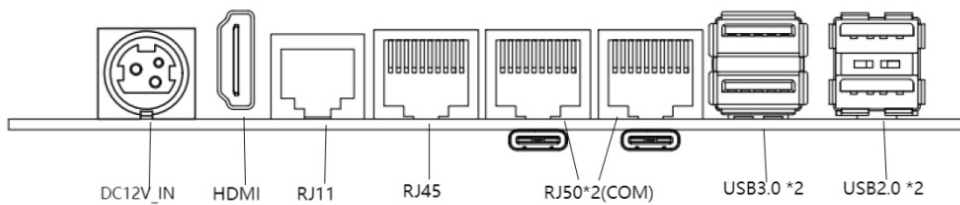

1.5.2 physical interface of i3-1115A



USB2.0*2 USB3.0*2 RJ45*2 RJ45 RJ11 HDMI DC12V

1.6 Installation Style



Desktop

2. Powering ON/OFF the APUS

2.1 Power on

Connect the power supply and press the power button

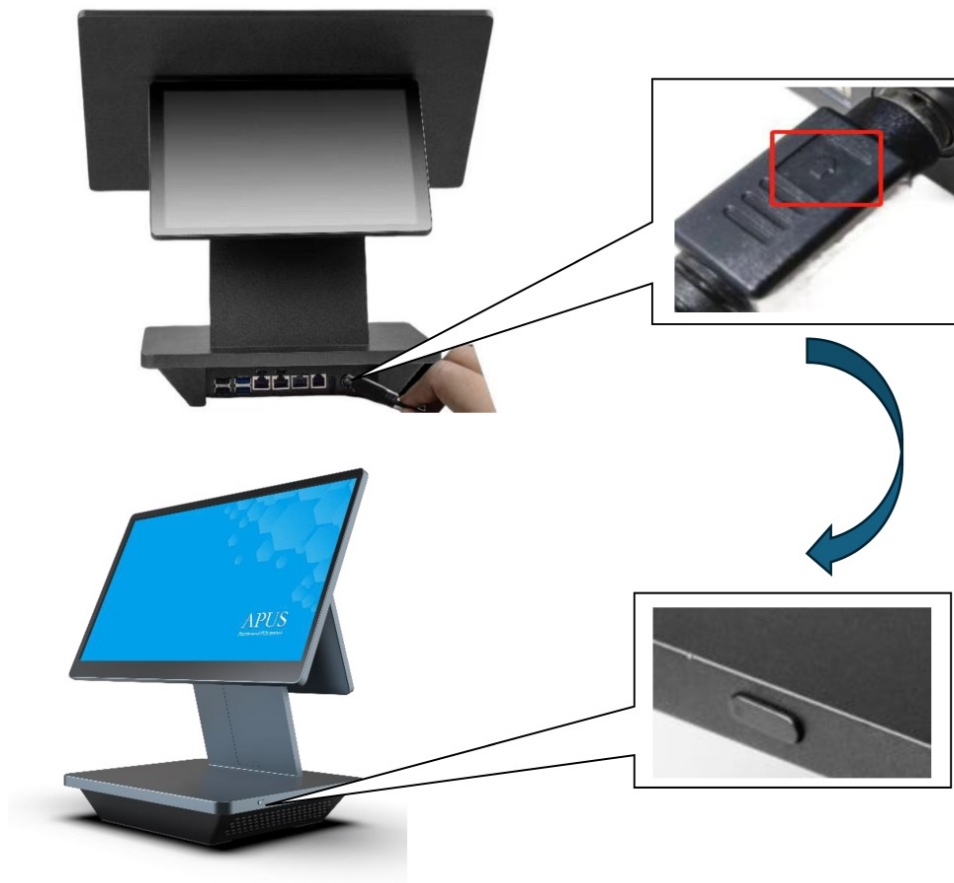

2.2 Power off

Press the shutdown button for two seconds, and then click the screen shutdown button.



Specifications

- **Model No.:** SYSTEM VOC-V-SDTS-A4G-I511TH16G128
- **Processor:**
 - Intel Celeron J6412 Quad-Core, Up to 2.60 GHz
 - Intel Tiger Lake i3-1115G4 Fanless CPU
 - Intel Alder Lake-N97 Quad-Core, Up to 3.60GHz
 - Intel Tiger Lake i5-1135G7 Fanless CPU
 - Intel Core i3/i5 10th High Performance CPU
- **RAM:** DDR4 1 x SO-DIMM DDR4 slot, 4GB RAM
Standard, Up to 16 GB
- **ROM:** 128GB SSD Standard, 256GB, 512GB Option
- **OS:** Windows 10/11
- **DISPLAY:**
 - Main Display: 15.6 Inch LED Backlight Display
 - Resolution: 1920*1080
 - Brightness: 250 nits, 300 nits Option
 - Aspect Ratio: 16:9
 - Second Display: 10.1 inch (Touch on 2nd Display Option)

Warranty notice

Respected users:

Thank you for purchasing our company's products! The warranty regulation is formulated hereby in order to protect your legal rights and interest and remove your future worries and improve after-sale service for customers. You are asked to read carefully and propose valuable opinion and suggestion.

I. Our company's products enjoy free warranty of 18 months since the Shipment date. If it exceeds the warranty period, reasonable service expense and material cost will be charged.

II. The product for repair should be packed and transported properly. If there is any damage or loss during the process of transportation, our company will not take responsibility.

III. Our company has the right to refuse to provide service or charge material and service cost where appropriate with occurrence of the following items within the free warranty

period.

- Product failure or damage caused by improper use of users;
- The accident of burning caused of electric shock or improper installation;
- Damage caused by dismantling of non repairmen.
- The label indicating fragile product is damaged.

IV. Please read the user manual carefully before the company's product is installed and used.

V. The warranty card must be stamped with seal and indicate the date by the selling unit to ensure your rights and interest.

Contact Information

Shenzhen Jassway Infotech Co., Ltd

Nanfeng Building, Yungu Innovation Industrial Park, Liuxian Avenue, Nanshan District, Shenzhen, Guangdong, China Phone: +86-755-8606 5500

Info@jassway.com <http://www.jassway.com/>

FAQ

Q: Can I upgrade the RAM on this device?

A: Yes, the device supports RAM upgrades up to 16GB through the available SO-DIMM DDR4 slot.

Q: What operating systems are compatible with this product?

A: The product is compatible with Windows 10 and Windows 11 operating systems.

Documents / Resources

| | |
|--|---|
| <div>User Manual</div> <div></div> <div>For Windows</div> | JASSWAY APUS Professional POS System [pdf] User Manual APUS Professional POS System, Professional POS System, POS System |
|--|---|

References

- [User Manual](#)

Related Posts



[Professional Digital Multimeter User Manual](#)

Professional Digital Multimeter User Manual - Download
[optimized] Professional Digital Multimeter User Manual - Download



[HP P1100 LASERJET PROFESSIONAL User Manual](#)

HP P1100 LASERJET PROFESSIONAL User Manual



[Optoma X400LVe Professional Projector User Manual](#)

Optoma X400LVe Professional Projector



[NEC P603X Professional Projector User Manual](#)

NEC P603X Professional Projector

Leave a comment

Your email address will not be published. Required fields are marked *

Comment *

Name

Email

Website

☐ Save my name, email, and website in this browser for the next time I comment.

Post Comment

Search:

e.g. whirlpool wrf535swhz

Search

[Manuals+](#) | [Upload](#) | [Deep Search](#) | [Privacy Policy](#) | [@manuals.plus](#) | [YouTube](#)

This website is an independent publication and is neither affiliated with nor endorsed by any of the trademark owners. The "Bluetooth®" word mark and logos are registered trademarks owned by Bluetooth SIG, Inc. The "Wi-Fi®" word mark and logos are registered trademarks owned by the Wi-Fi Alliance. Any use of these marks on this website does not imply any affiliation with or endorsement.