



## JASCO ZW3105 Z-Wave Light Dimmer Module Instruction Manual

[Home](#) » [JASCO](#) » JASCO ZW3105 Z-Wave Light Dimmer Module Instruction Manual 

### Contents

- [1 JASCO ZW3105 Z-Wave Light Dimmer Module](#)
- [2 INSTALLATION](#)
- [3 Documents / Resources](#)
- [4 Related Posts](#)



**JASCO ZW3105 Z-Wave Light Dimmer Module**



This device complies with Part 15 of the FCC and Industry Canada license-exempt RSS standards. Operation is subject to the following two conditions:

1. this device may not cause harmful interference, and
2. this device must accept any interference received, including interference that may cause undesired operation.

**FCC NOTE:** The manufacturer is not responsible for any radio or TV interference caused by unauthorized modifications to this equipment. Such modifications could void the user's authority to operate the equipment.

**NOTE:** This equipment has been tested and found to comply with the limits for a Class B digital device, pursuant to Part 15 of the FCC Rules. These limits are designed to provide reasonable protection against harmful interference in a residential installation. This equipment generates, uses and can radiate radio frequency energy, and if not installed and used in accordance with the instructions, may cause harmful interference to radio communications. However, there is no guarantee interference will not occur in a particular installation. If this equipment does cause harmful interference to radio or television reception, which can be determined by turning the equipment off and on, the user is encouraged to try to correct the interference by one or more of the following measures:

- Reorient or relocate the receiving antenna.
- Increase the separation between the equipment and receiver.
- Connect the equipment into an outlet on a circuit different from which the receiver is connected.
- Consult the dealer or an experienced radio/TV technician for help.

**Important note:** To comply with the FCC RF exposure compliance requirements, no change to the antenna or the device is permitted. Any change to the antenna or the device could result in the device exceeding the RF exposure requirements and void user's authority to operate the device.

## MANUAL



## DO NOT RETURN THIS PRODUCT TO THE STORE

If you have any problems or questions, contact our U.S.-based Consumer Care at **1-800-654-8483**, option 1, Monday–Friday, 7AM–8PM Central Time. For the most up-to-date product support, accessories, electronic (PDF) format manuals and more, visit [www.byjasco.com/support](http://www.byjasco.com/support). No user-serviceable parts in this unit.

## WARNING:

TO REDUCE THE RISK OF ELECTRIC SHOCK, THIS PRODUCT HAS A GROUNDING TYPE PLUG THAT HAS A THIRD (GROUNDING) PIN. THIS PLUG WILL ONLY FIT INTO A GROUNDING TYPE POWER OUTLET. IF THE PLUG DOES NOT FIT INTO THE OUTLET, CONTACT A QUALIFIED ELECTRICIAN TO INSTALL THE PROPER OUTLET. DO NOT CHANGE THE PLUG IN ANY WAY.

## CONTROLLING APPLIANCES

**CAUTION:** TO REDUCE THE RISK OF OVERHEATING AND POSSIBLE DAMAGE TO OTHER EQUIPMENT, DO NOT INSTALL TO CONTROL A MOTOR-OPERATED APPLIANCE, FLUORESCENT LIGHTING FIXTURE OR TRANSFORMER-SUPPLIED APPLIANCE.

- ONLY USE TO CONTROL INCANDESCENT OR DIMMABLE CFL/LED BULBS
- DO NOT EXCEED RATINGS
- DO NOT USE TO CONTROL ANY DEVICE WHERE UNINTENDED OPERATION COULD CAUSE UNSAFE

CONDITIONS (HEAT LAMP, SUN LAMP, ETC.)

## Before Installation

### Getting to know your new Z-Wave device

Maximum load for the Z-Wave controlled outlet: 300W (2.5A) incandescent or 100W dimmable CFL/LED

- One Z-Wave controlled AC outlet for standard incandescent lighting or dimmable CFL/LEDs
- Remote ON/OFF and brightness control via the Z-Wave controller
- Manual ON/OFF and brightness control with the top-mounted push button
- One always-on pass-through AC outlet
- Space-efficient design
- Does not block the lower outlet when plugged into the upper outlet of a duplex wall receptacle (assumes the duplex receptacle is mounted with the ground pin down)
- Plugs and cords for connected devices route to the side allowing close placement of furniture
- Grounded 3-wire power connection for safety
- This Z-Wave device has advanced features that allow you to customize your experience. These features can only be adjusted by a Z-Wave enabled controller that supports the Z-Wave configuration command class. For a complete list of adjustable configurations, visit [www.ezzwave.com/config](http://www.ezzwave.com/config)

## INSTALLATION

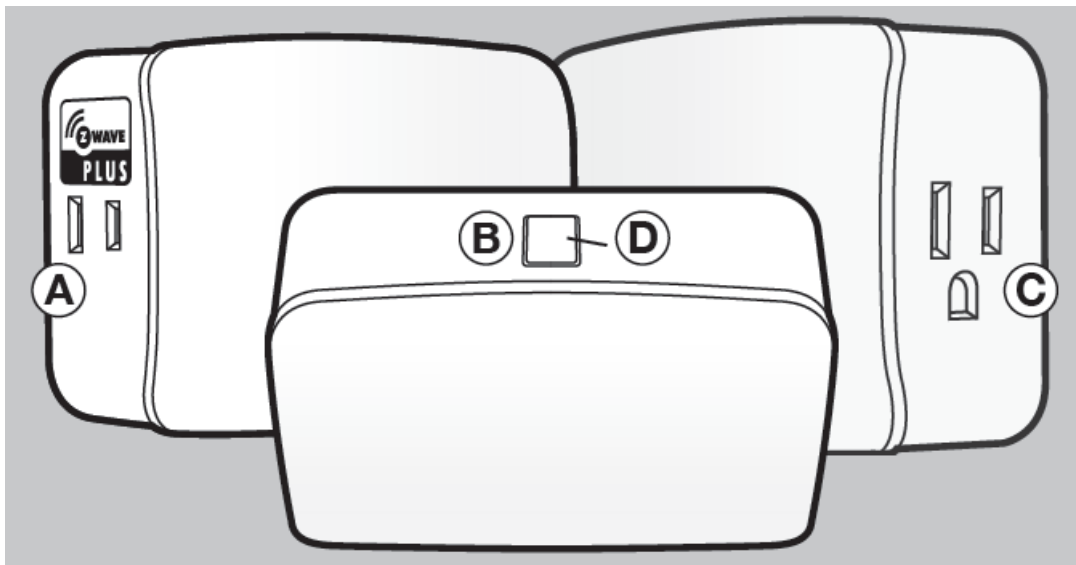

### A. Z-Wave controlled outlet

This outlet can remotely turn ON/OFF and dim the connected lamp

### B. Manual/program button

Single press — turn the lamp ON/OFF

Press and hold — dim/brighten the lamp

Single press — add or remove in Z-Wave network

### C. Pass-through AC outlet

This space-saving outlet is always on and not controlled by Z-Wave

### D. Cycle LED light

The LED acts as a guide light or status indicator. How to cycle through options: Press program button 10 times quickly.

1. LED is ON when the load is ON (indicates the dimmer is ON) (default)
2. LED is ON when the load is OFF (guide light in the dark)
3. LED is always OFF
4. LED is always ON

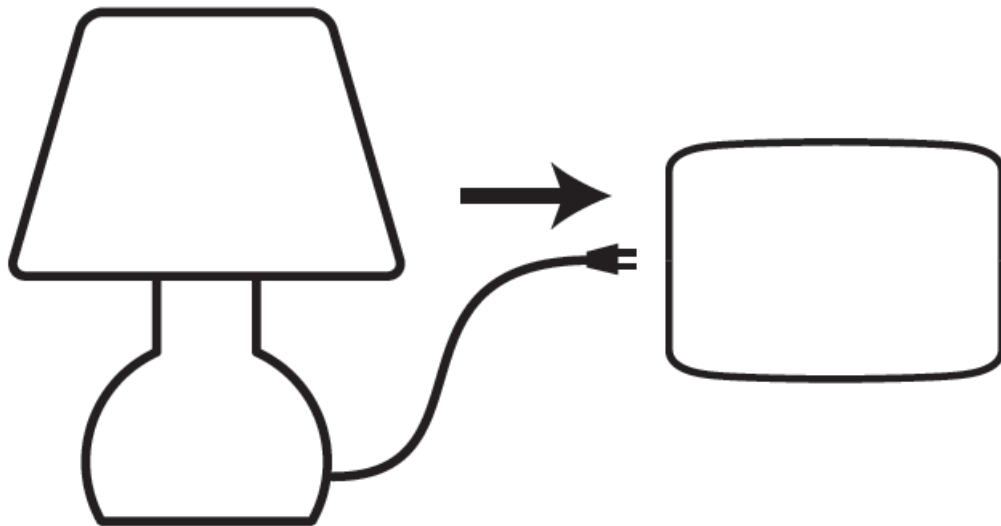

1. Plug the light you want to control into the Z-Wave controlled outlet on the smart dimmer as indicated by the Z-Wave logo.

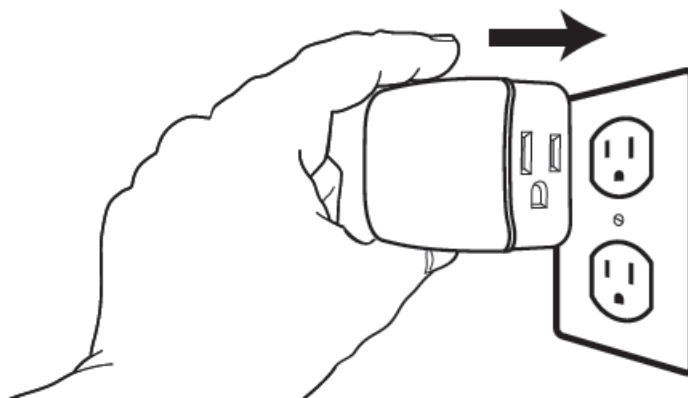

2. Plug the smart dimmer directly into an available grounded outlet (top outlet recommended).

**NOTE:** Plug directly into outlet. Do not use with extension cords.

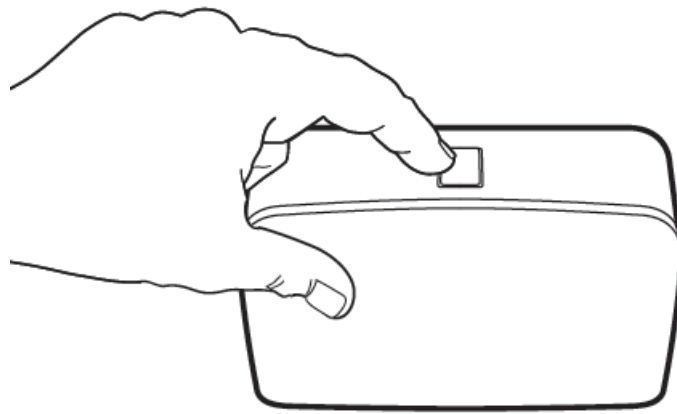

**The manual/program button on the smart dimmer allows the user to:**

1. Manually turn the connected lamp ON or OFF (press and release).
2. Adjust the brightness level of the connected lighting by pressing and holding the button. Release the button when the desired level is attained.
3. Add/remove the smart dimmer from the network.

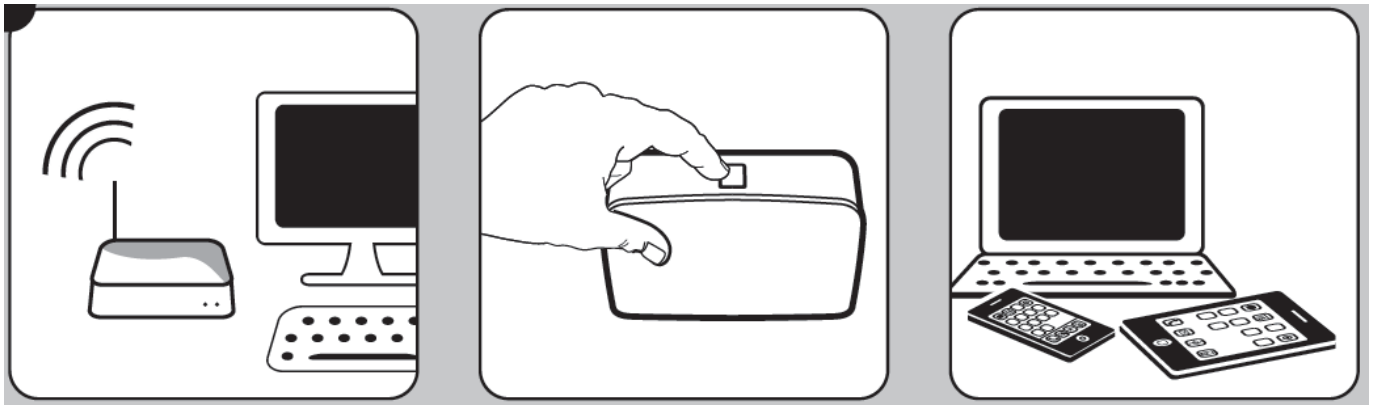

**Adding your device to a Z-Wave network:**

1. Follow the instructions for your Z-Wave certified controller to add a device to the Z-Wave network.
2. Once the controller is ready to add your device, press the program button of the smart dimmer. You have complete control to turn your fixture ON/OFF and adjust brightness according to groups, scenes, schedules and interactive automations programmed by your controller. If your Z-Wave certified controller features remote access, you can control your fixture from your mobile devices. If prompted by the controller to enter the S2 security code, refer to the QR code/security number on the side of the box or the QR code label on the product (see Figure 1). Enter the 5-digit pin code. Figure 1.

**To remove and reset the device:**

1. Follow the instructions for your Z-Wave certified controller to remove a device from the Z-Wave network.
2. Once the controller is ready to remove your device, press and release the manual/program button on the smart dimmer.

**To return your dimmer to factory defaults:**

1. If plugged in, unplug the dimmer from the receptacle.
2. Press and hold the top button for at least three seconds while you plug the dimmer into a receptacle.

**NOTE:** This should only be used in the event your network's primary controller is missing or otherwise inoperable.

**NOTE:** SmartStart enabled products can be added into a Z-Wave network by scanning the QR code on the product with a controller providing SmartStart inclusion. No further action is required and the SmartStart product will be added automatically within 10 minutes of being switched on in the network vicinity.

**NOTE:** Actual performance of any CFL or LED will vary from bulb type to bulb type and among manufacturers. It is important to note only bulbs designed as dimmable should be used on a dimmer. To find out if your bulb is dimmable, please check the package, the bulb itself or call the bulb manufacturer directly. For a complete list of recommended CFL/LED bulbs for this and other Z-Wave products from Jasco, please visit [www.ezzwave.com](http://www.ezzwave.com)

### **This device supports Association Command Class (3 Groups)**

- Association Group 1 supports Lifeline, Multi Level Report
- Association Group 2 supports Basic Set and is controlled with the local load
- Association Group 3 supports Basic Set and is controlled by double pressing the button
- Each Association Group supports 5.

### **Z-WAVE INTEROPERABILITY**

This product can be included and operated in any Z-Wave network with other Z-Wave certified devices from other manufacturers and/or other applications. All non-battery operated nodes within the network will act as repeaters regardless of vendor to increase reliability of the network.

### **Documents / Resources**

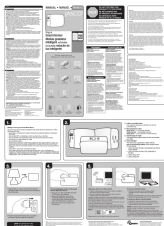
	<p><a href="#">JASCO ZW3105 Z-Wave Light Dimmer Module</a> [pdf] Instruction Manual ZW3105, Z-Wave Light Dimmer Module</p>
---	--