



Jandy WLC4C Water Colors LED Light Controller Installation Guide

[Home](#) » [Jandy](#) » Jandy WLC4C Water Colors LED Light Controller Installation Guide 



Installation Guide
WaterColors
LED Light Controller

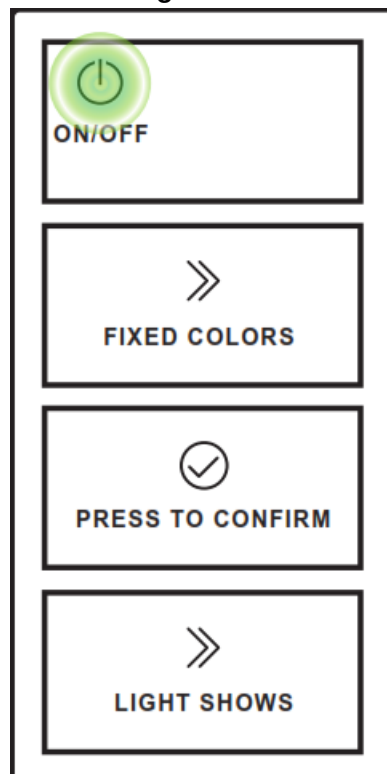

Model: WLC4C

Compatible with Jandy® WaterColors, Pentair® IntelliBrite®, and Hayward® UCL LED Lights*

Contents

- [1 WARNING](#)
- [2 Specifications](#)
- [3 Contents](#)
- [4 Installation](#)
- [5 Button Functions](#)
- [6 Operation](#)
- [7 Documents / Resources](#)
 - [7.1 References](#)
- [8 Related Posts](#)

WARNING

FOR YOUR SAFETY – Before installing this product, read and follow all warning notices and instructions that accompany this product. Failure to follow warning notices and instructions may result in property damage, personal injury, or death. Improper installation and/or operation can create unwanted electrical hazard which can cause serious injury, property damage, or death.

Installation must be done in accordance with the National Electrical Code ® (NEC ® or NFPA-70 ®) in the US, the Canadian Electrical code (CEC or C22.1) in Canada, and applicable local codes.

- Prior to installation or performing any service, turn off all switches and the main breaker in the pool/spa pump electrical circuit. Failure to comply may cause a shock or hazard resulting in severe personal injury or death. While disconnecting and or connecting any electrical wiring, be careful not to damage or abrade any of the wiring. For indoor use only.
- Unit is not intended for outdoor use unless mounted in a suitable UL rated weatherproof outlet box and cover.
- To reduce the risk of injury, do not permit children to use this product.
- Connect only to a branch circuit protected by a ground fault circuit-interrupter (GFCI).
- Contact a qualified electrician if you cannot verify that the circuit is protected by a GFCI. Make sure such a GFCI should be provided by the installer and should be tested on a routine basis. To test the GFCI, push the test button.

Power should be restored.

- If the GFCI interrupts power to the device without the test button being pushed, a ground current is flowing, indicating the possibility of electrical shock. Do not use the device. Disconnect the device and have the problem corrected by a qualified service representative before using.

SAVE THESE INSTRUCTIONS

Specifications

CSA enclosure type:	Type 2, ENCL 2, or equivalent
Indoor electrical box:	Requires UL recognized single or multi gang with minimum box size 14 cu in.
Outdoor electrical box:	Requires UL recognized single or multi gang with minimum box size 18 cu in. Suitable for outdoor use

Contents

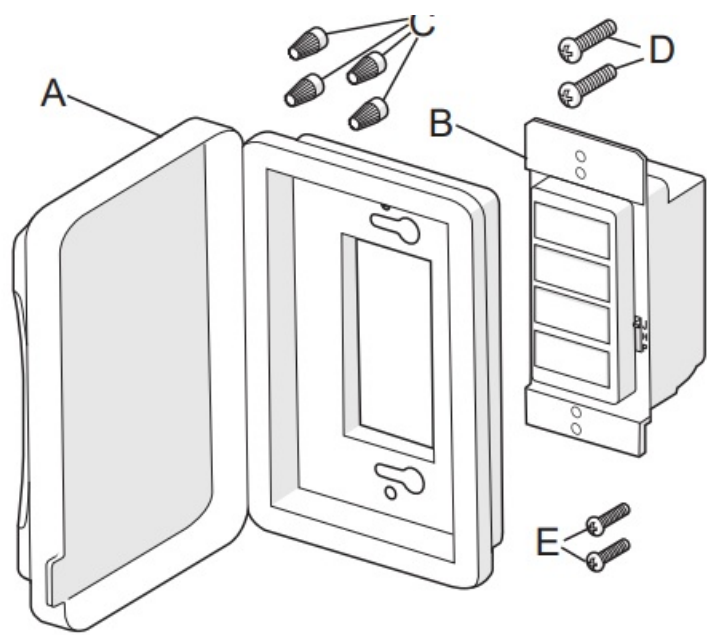

A	Waterproof Enclosure	1
B	WaterColors LED Light Controller	1
C	Wire Nuts	4
D	Long Screws	2
E	Short Screws	2
F	Color Mode Labels	3

Wiring

WATERCOLORS LED LIGHT CONTROLLER LOW VOLTAGE WIRING DIAGRAM

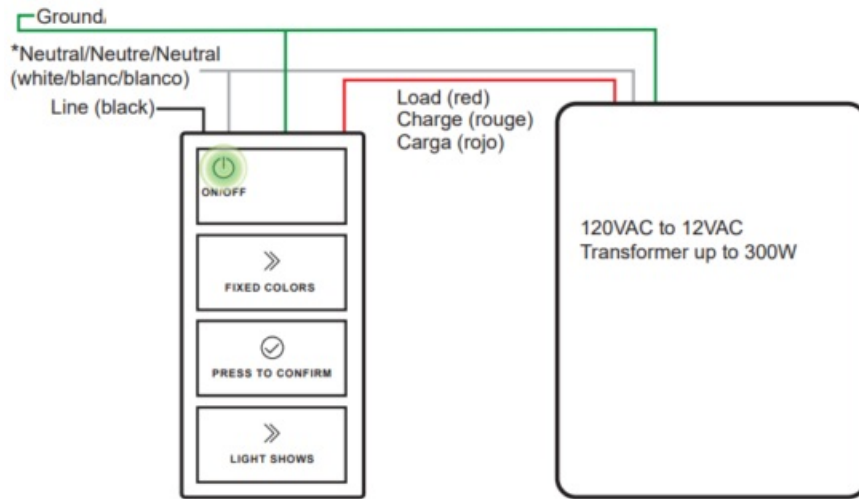

WATERCOLORS LED LIGHT CONTROLLER HIGH VOLTAGE WIRING DIAGRAM

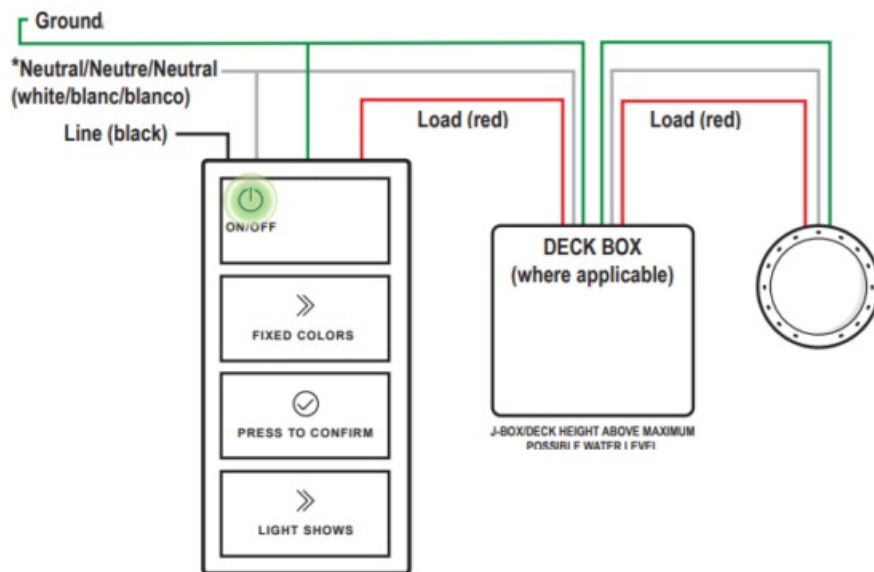

WARNING

Neutral wire must be connected to the neutral conductor of the branch circuit supply. DO NOT connect neutral wire to the earth ground conductor.

Installation

WARNING

Always turn off power at breaker panel before installation.

IMPORTANT

Calculate the total load wattage. Recommended maximum load is 240W. Do not exceed 300W. Do not use more than 80% of transformer wattage.

Note

Use waterproof enclosure for outdoor installations only.

1. Attach the WaterColors LED light controller to the enclosure using the two short screws (A). Skip this step on indoor installations.

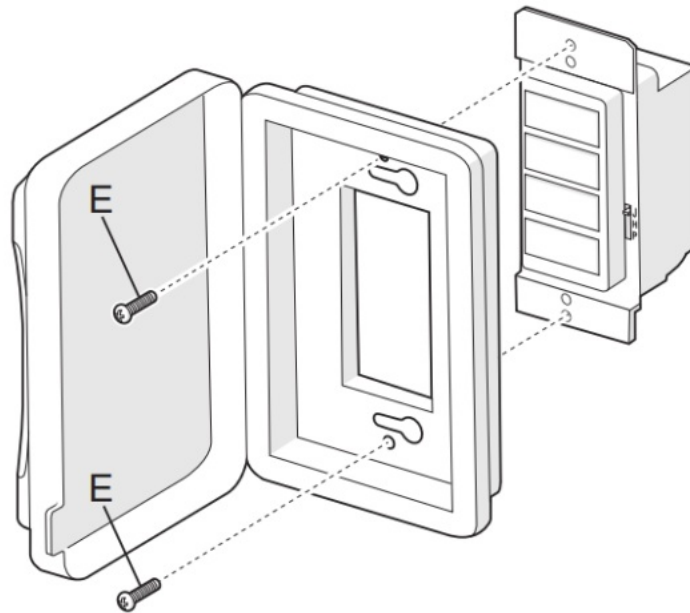

2. Remove existing fixture, if applicable, to expose the wires.

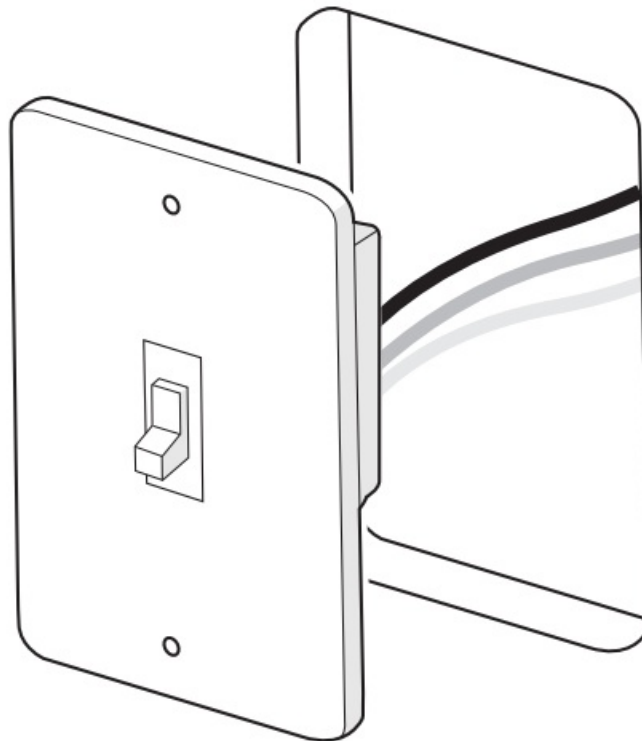

3. Strip wires to correct length, use wire nuts to connect wires. A neutral wire is required for proper operation. Refer to the wiring diagram for proper connections.

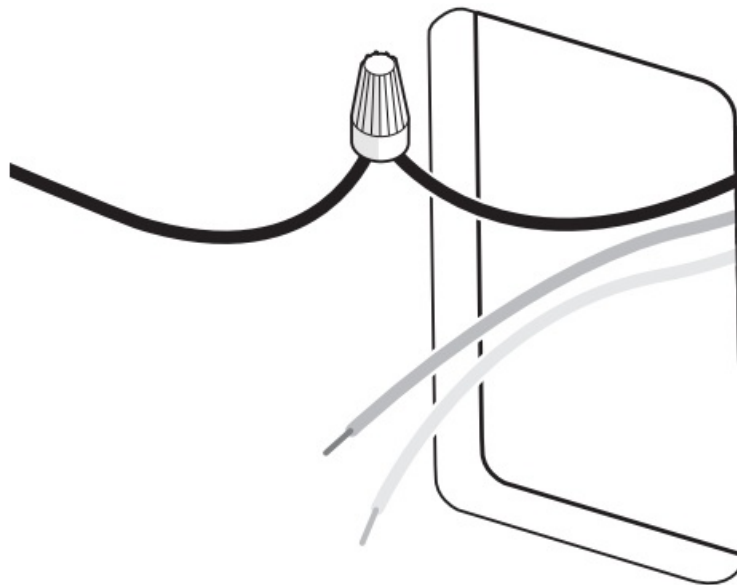

4. Set the JHP switch according to which brand of lights are currently installed: Jandy (J-Series), Hayward® (H-Series), or Pentair® (P-Series). Refer to the wiring diagram for proper connections.

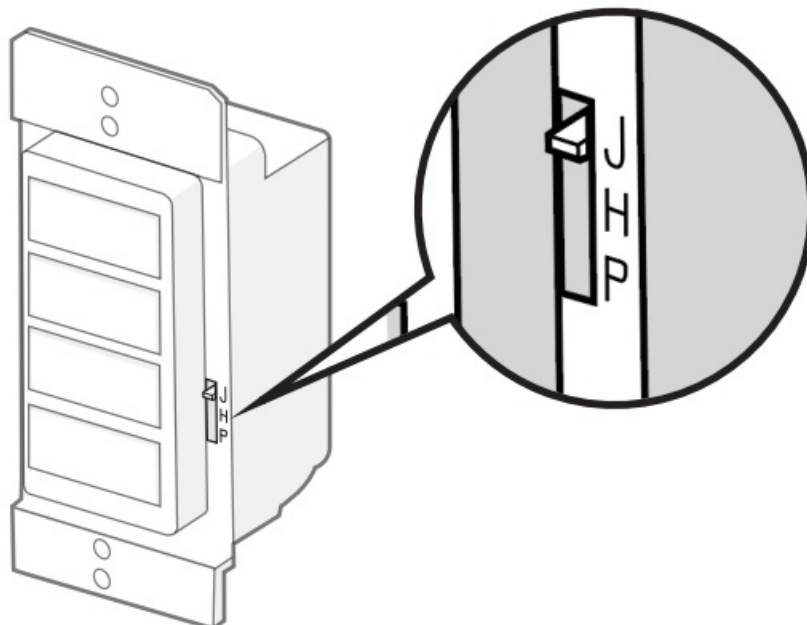

5. Attach the corresponding color mode label (Jandy “J-Series, Hayward® “H-Series”, or Pentair® “P-Series”) to the inside of the enclosure door. Skip this step for indoor installations.

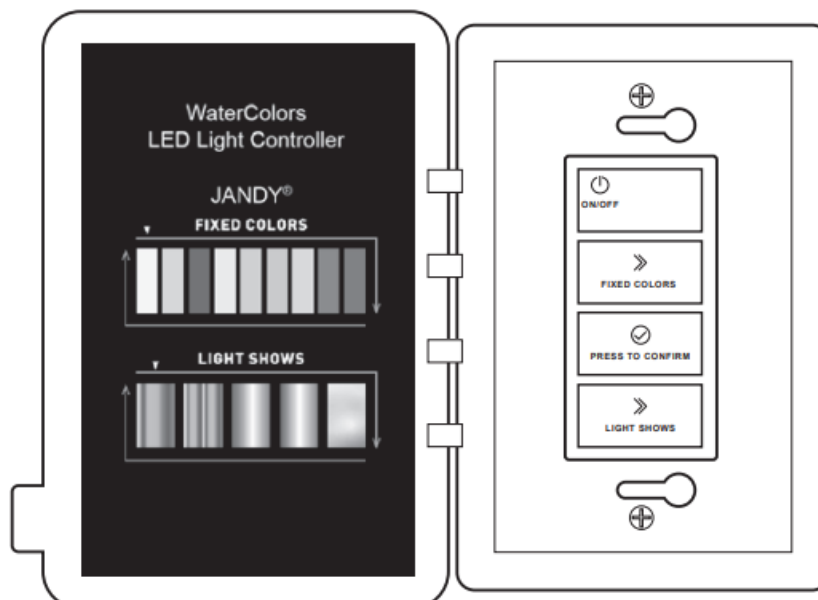

6. Push the wires into the opening. Secure the WaterColors LED Light Controller and enclosure with the two long

screws (A).

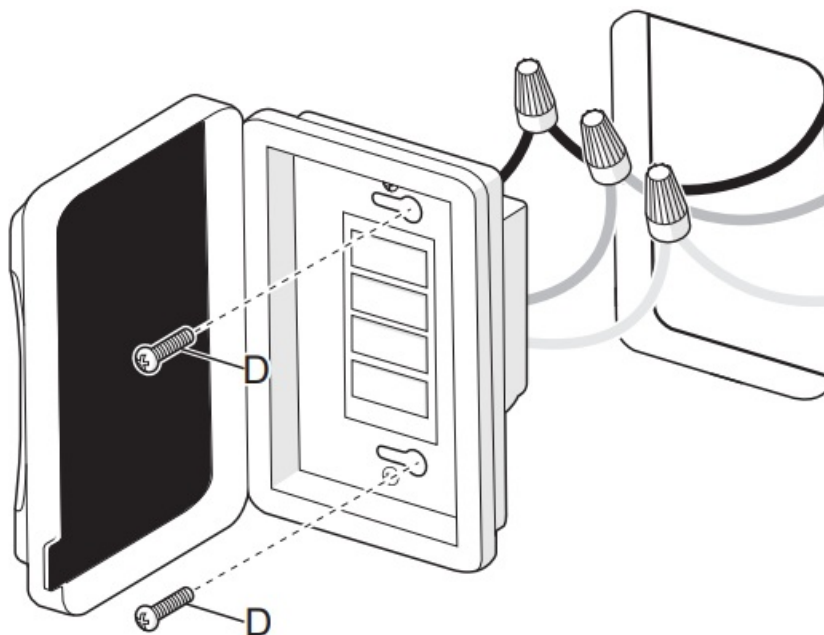

7. Install a standard faceplate over the WaterColors LED Light Controller on indoor installations only.

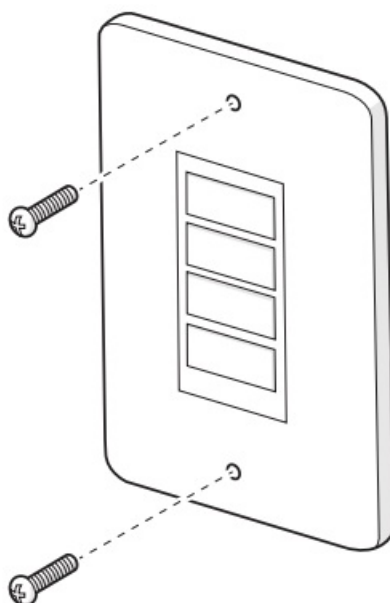

8. Test the light function (see Operation).

Button Functions

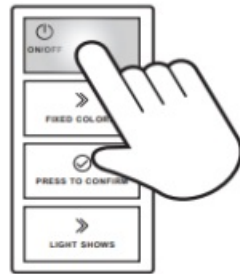

Power ON/OFF

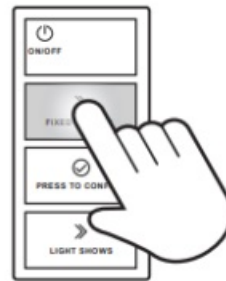

Select fixed colors



Select light shows

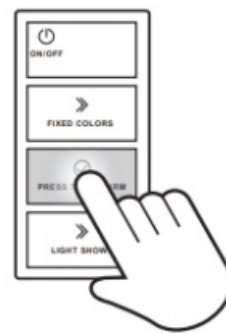

Confirm selection

Operation

Light shows display alternating colors, while fixed colors will only display the color selected.



Compatible with Jandy WaterColors Color Modes

Sequence Order	Fixed Colors
1	Alpine White
2	Sky Blue
3	Cobalt Blue
4	Caribbean Blue
5	Spring Green
6	Emerald Green
7	Emerald Rose
8	Magenta
9	Violet
Sequence Order	Light Shows <i>Spectacles</i>
1	Slow Color Splash
2	Fast Color Splash
3	America the Beautiful
4	Fat Tuesday
5	Disco Tech



Compatible with Hayward® UCL Color Modes	
Sequence Order	Fixed Colors
1	Deep Blue Sea
2	Royal Blue
3	Afternoon Skies
4	Aqua Green
5	Emerald
6	Cloud White
7	Warm Red
8	Flamingo Pink
9	Vivid Violet
10	Sangria Dark Purple/Red
Sequence Order	Light Shows <i>Spectacles</i>
1	Voodoo Lounge
2	Twilight
3	Tranquility
4	Gemstone
5	USA
6	Mardi Gras
7	Cool Cabaret



Compatible with Pentair® IntelliBrite®	
Sequence Order	Fixed Colors <i>Couleurs</i>
1	Blue
2	Green
3	Red
4	White
5	Magenta
Sequence Order	Light Shows <i>Spectacles</i>
1	SAm® Mode
2	Party Mode
3	Romance Mode
4	Caribbean Mode
5	American Mode
6	California Sunset
7	Royal Mode

Hint/Tips

- Power] button lights up and stays on when pressed.
- Confirm] button lights up when pressed and will automatically turn off after 30 seconds.

- Lights always sync to white before changing colors.

Zodiac Pool Systems LLC

2882 Whiptail Loop # 100

Carlsbad, CA 92010

1.800.822.7933 | www.Jandy.com

Zodiac Pool Systems Canada, Inc.

2-3365 Mainway

Burlington, ON

Canada L7M 1A6

1.888.647.4004 | www.Jandy.ca

**ETL LISTED:**

Conforms to ANSI/UL STD 1563

Certified to CAN/CSA C22.2 NO. 218.1

©2021 Zodiac Pool Systems LLC. All rights reserved. ZODIAC ® is a registered trademark of Zodiac International, S.A.S.U., used under license. All other trademarks (including third party) are the property of their respective owners.

H0698200_REVD

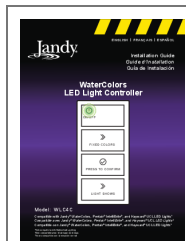
Documents / Resources

[Jandy WLC4C Water Colors LED Light Controller](#) [pdf] Installation Guide

WLC4C Water Colors LED Light Controller, WLC4C, Water Colors LED Light Controller, Colors L
ED Light Controller, LED Light Controller, Light Controller, Controller

References

- [User Manual](#)

[Manuals+](#), [Privacy Policy](#)

This website is an independent publication and is neither affiliated with nor endorsed by any of the trademark owners. The "Bluetooth®" word mark and logos are registered trademarks owned by Bluetooth SIG, Inc. The "Wi-Fi®" word mark and logos are registered trademarks owned by the Wi-Fi Alliance. Any use of these marks on this website does not imply any affiliation with or endorsement.