

[Skip to content](#)

Manuals+

User Manuals Simplified.



Jandy TC3 Flush Mount Pool/Spa Return Jet Installation Guide

[Home](#) » [Jandy](#) » Jandy TC3 Flush Mount Pool/Spa Return Jet Installation Guide

Jandy TC3 Flush Mount Pool/Spa Return Jet
Installation Guide



855.280.6465
Jandy.com

Installation Instructions

[Jandy.com](#)

TC3 Flush Mount Pool/Spa Return Jet

CAUTION

This product must be installed by a contractor who is licensed and qualified in pool equipment by the jurisdiction in which the product will be installed where such state or local requirements exists.

1. After the 1½" return line is plumbed through shell and pressure tested, cut pipe flush with the pool wall.

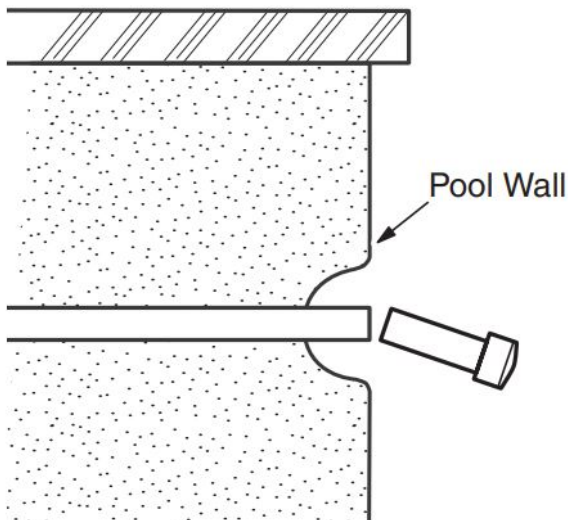

2. . Use Inside Pipe Cutter (part #5-17-4) to cut pipe back 5/8" behind shell surface.

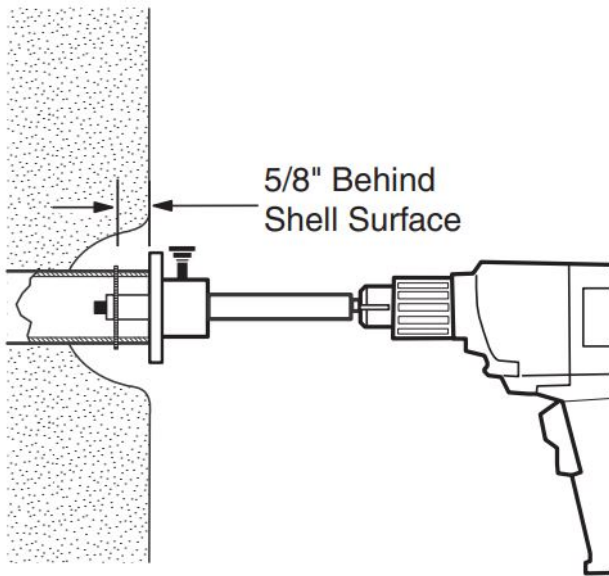

3. Prime pipe and fitting. With protective cap attached, glue fitting into pipe, positioning for thickness of finish material.
4. After troweling the final finish, use needle-nose pliers (or ThreadCare Tool, part #4-17-4) to remove the protective cap turning clockwise until cap separates or breaks off.

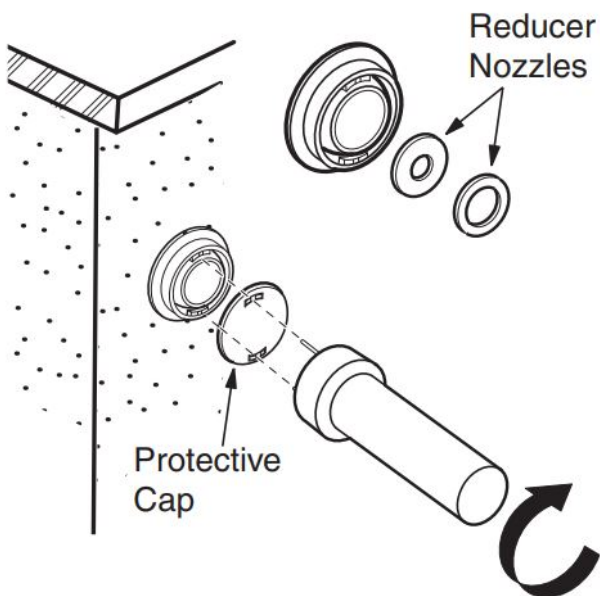

5. At startup, select and insert the applicable restrictor nozzle if required for the installation.

©2021 Zodiac Pool Systems LLC. All rights reserved. Zodiac® is a registered trademark of Zodiac International, S.A.S.U. used under license. All other trademarks referenced herein are the property of their respective owners. TL-1317 D

Contents [hide](#)

[1 Documents / Resources](#)

[2 Related Posts](#)

Documents / Resources

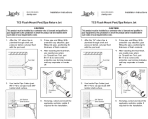

[Jandy TC3 Flush Mount Pool/Spa Return Jet](#) [pdf] Installation Guide
TC3, Flush Mount Pool Return Jet, Flush Mount Spa Return Jet

[Manuals+](#),

- [home](#)
- [privacy](#)