



Jandy SMARTSYNC60W Smart Sync LED Adapter Instruction Manual

[Home](#) » [Jandy](#) » Jandy SMARTSYNC60W Smart Sync LED Adapter Instruction Manual 

Contents

- [1 Jandy SMARTSYNC60W Smart Sync LED Adapter](#)
- [2 Product Information](#)
- [3 Product Usage Instructions](#)
- [4 Installation](#)
- [5 Specifications](#)
- [6 Attach Wiring](#)
- [7 Documents / Resources](#)



Jandy SMARTSYNC60W Smart Sync LED Adapter



Product Information

- **Product Name:** SMARTSYNC60W
- **Model:** SMARTSYNC60W
- **Compliance:** This device complies with Part 15 of the FCC Rules.
- **Safety Instructions:** Please read and follow all instructions provided in the user manual.
- **Compatibility:** The Jandy Smart Sync LED Adapter is compatible with Smart Sync compatible devices and requires connection to an automation system or control switch.
- **Mounting:** The Smart Sync LED Adapter should be mounted in a NEMA approved weatherproof enclosure. The minimum enclosure size is 9 x 3 x 4 (228 mm x 100 mm x 75 mm).
- **Power Requirement:** The Smart Sync LED Adapter must be powered by a listed low voltage Class 2 12VAC output transformer.

Product Usage Instructions

Installation

1. Selecting Series
 - Determine which series to use based on the type of lighting the Smart Sync LED Adapter will be controlling.
 - Using a flathead screwdriver, rotate the dial on the side of the Smart Sync LED Adapter to the corresponding number for the series you want to select (see sticker on LED adapter).
2. Mounting the Smart Sync LED Adapter
 - Mount the Smart Sync LED Adapter in a NEMA approved weatherproof enclosure using the included mounting screws.
3. Attaching Wiring
 - The Smart Sync LED Adapter must be powered by a listed low voltage Class 2 12VAC output transformer.
 - Attach each of the four or five wires to the Smart Sync LED Adapter by pushing back an orange spring clamp and inserting the correct wire below.
 - If needed, push back the orange spring clamps to release wires.
 - Refer to Figure 4 for wire stripping and insertion, Figure 5 for RGB wiring, and Figure 6 for RGBW wiring.

Please refer to the user manual for more detailed instructions and safety precautions.

Model: SMARTSYNC60W

Compatible with Jandy® WaterColors LED Light Controller and AquaLink® Automation Systems (RS, PDA, TCX);
Compatible with Jandy® WaterColors, Pentair® IntelliBrite®, and Hayward® UCL color modes

WARNING

FOR YOUR SAFETY

This product must be installed and serviced by a contractor who is licensed and qualified in pool equipment by the jurisdiction in which the product will be installed where such state or local requirements exist. The maintainer must be a professional with sufficient experience in pool equipment installation and maintenance so that all of the instructions in this manual can be followed exactly. Before installing this product, read and follow all warning notices and instructions that accompany this product. Failure to follow warning notices and instructions may result

in property damage, personal injury, or death. Improper installation and/or operation may void the warranty. Improper installation and/or operation can create unwanted electrical hazard which may cause serious injury, property damage, or death.

FCC Statement

This device complies with Part 15 of the FCC Rules. Operation is subject to the following two conditions: (1) this device may not cause harmful interference, and (2) this device must accept any interference received, including interference that may cause undesired operation.

NOTE: This equipment has been tested and found to comply with the limits for a Class B digital device, pursuant to part 15 of the FCC Rules. These limits are designed to provide reasonable protection against harmful interference in a residential installation. This equipment generates, uses and can radiate radio frequency energy and, if not installed and used in accordance with the instruction, may cause harmful interference to radio communications. However, there is no guarantee that interference will not occur in a particular installation. If this equipment does cause harmful interference to radio or television reception which can be determined by turning the equipment off and on, the user is encouraged to try to correct interference by one or more of the following measures:

- Reorient or relocate the receiving antenna.
- Increase the separation between the equipment and receiver.
- Connect the equipment into an outlet on circuit different from that to which the receiver is connected.
- Consult the dealer or an experienced radio/TV technician for help.

CAUTION: Any changes or modifications not expressly approved by the party responsible for compliance could void the user's authority to operate the equipment.

Section 1. Important Safety Instructions

READ AND FOLLOW ALL INSTRUCTIONS

Specifications

- Smart Sync 60 Watt
 - Rated Max Input 5.0A @ 12VAC
 - Rated Max Output 4.5A @12VDC
 - Controls up to 12 feet of LED waterfalls
- Only use 12VAC input power from a listed low voltage Class 2 landscape or pool/spa lighting transformer.
- Always connect the Class 2 isolated transformer in between pool controls and Smart Sync.
- Each waterfall requires 5 watts per foot.

ATTENTION: The Jandy Smart Sync LED Adapter should only be used with Smart Sync compatible devices. Never use in conjunction with the LED Waterfall Colorwheel Controls. Use of the Jandy Smart Sync LED Adapter requires connection to an automation system or control switch.

SAVE THESE INSTRUCTIONS

Section 2. Installation

WARNING: Risk of electric shock which can result in serious injury or death:

Before attempting to install or service, ensure that all power to the circuit supplying power to the system is disconnected or turned off at the circuit breaker. All wiring must be done in accordance with the National Electrical Code® (NEC®), NFPA70®. In Canada, the Canadian Electrical Code (CEC), CSA C22.1, must be followed. All applicable local installation codes and regulations must be followed.

Select Series

Each of the three series has a distinct color/show sequence and matches with a different type of lighting.

1. Determine which series to use based on the type of lighting the Smart Sync LED Adapter will be controlling:
 - Jandy®: J-Series (1)
 - Hayward® Industries: H-Series (2)
 - Pentair® Water Pool and Spa, Inc.: P-Series (3)
2. Using a flathead screwdriver, rotate the dial on the side of the Smart Sync LED Adapter to the corresponding number for the series you want to select (see sticker on LED adapter). See Figure 1.

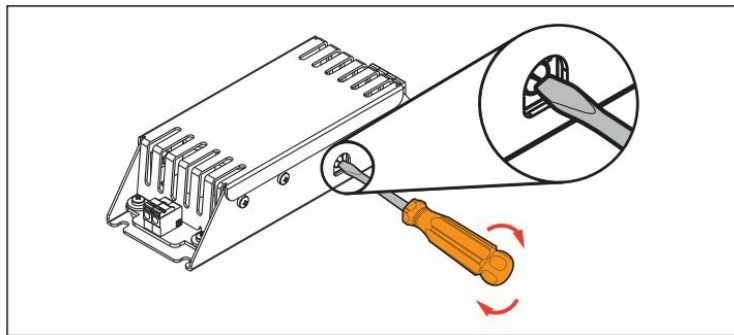

Figure 1. Turning dial with screwdriver

Mount the Smart Sync LED Adapter

Mount the Smart Sync LED Adapter in a NEMA approved weatherproof enclosure using the included mounting screws, as shown in Figure 3. Enclosure is not included. Minimum Enclosure Size (Internal): 9" x 3" x 4" (228 mm x 100 mm x 75 mm)

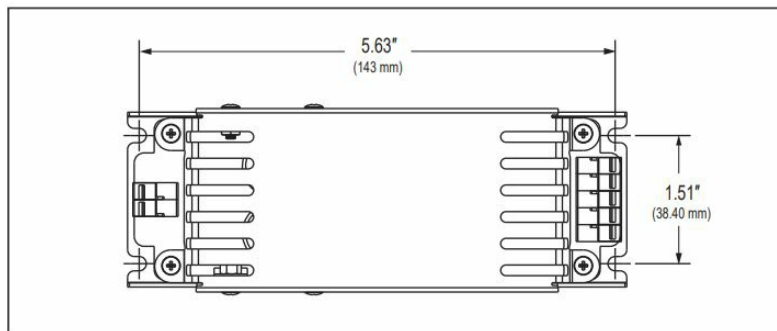

Figure 2. Smart Sync LED Adapter dimensions

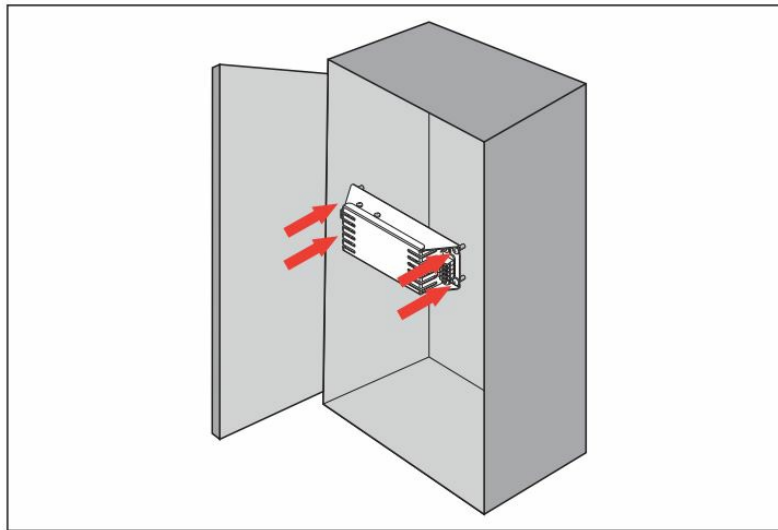

Figure 3. NEMA approved weatherproof enclosure

Attach Wiring

Wiring Steps

CAUTION: The Smart Sync LED Adapter must be powered by a listed low voltage Class 2 12VAC output transformer. Connect the low voltage transformer between pool control system and Smart Sync LED Adapter.

1. Wire to the Smart Sync compatible device. Strip the four RGB or five RGBW wires by at least $\frac{1}{4}$ ". (Compatible with both solid and stranded wire 24–14 AWG.)
2. Attach each of the four or five wires to the Smart Sync LED Adapter by pushing back an orange spring clamp and inserting the correct wire below. If needed, push back the orange spring clamps to release wires. See Figure 4 for wire stripping and insertion, Figure 5 for RGB wiring, and Figure 6 for RGBW wiring.
3. Repeat steps 1 and 2 to connect wiring from the listed Class 2 12VAC transformer.

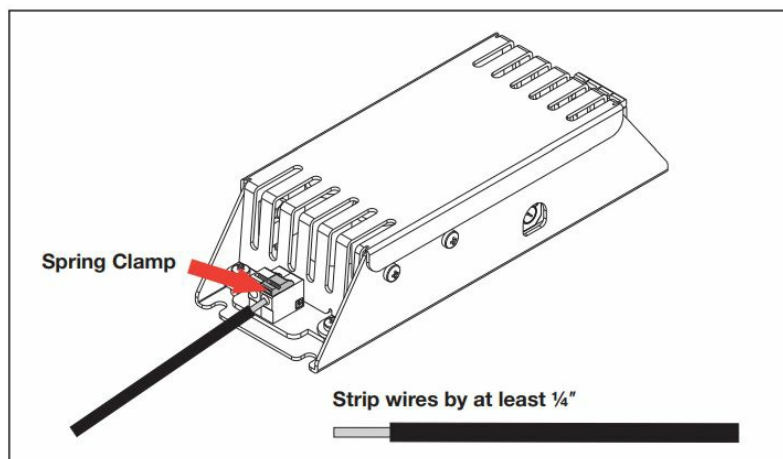

Figure 4. Wire stripping and insertion

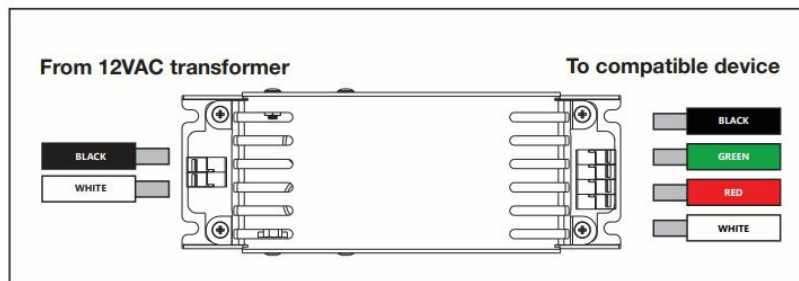

Figure 5. RGB wiring

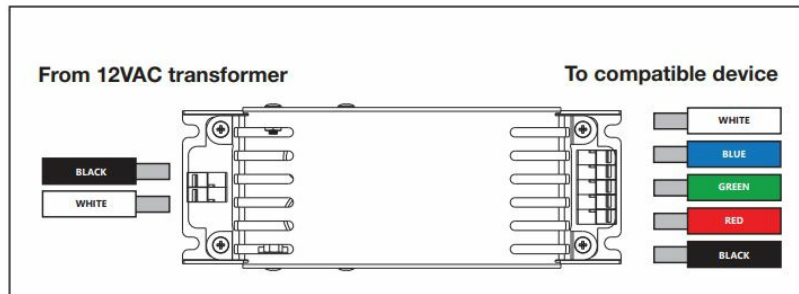
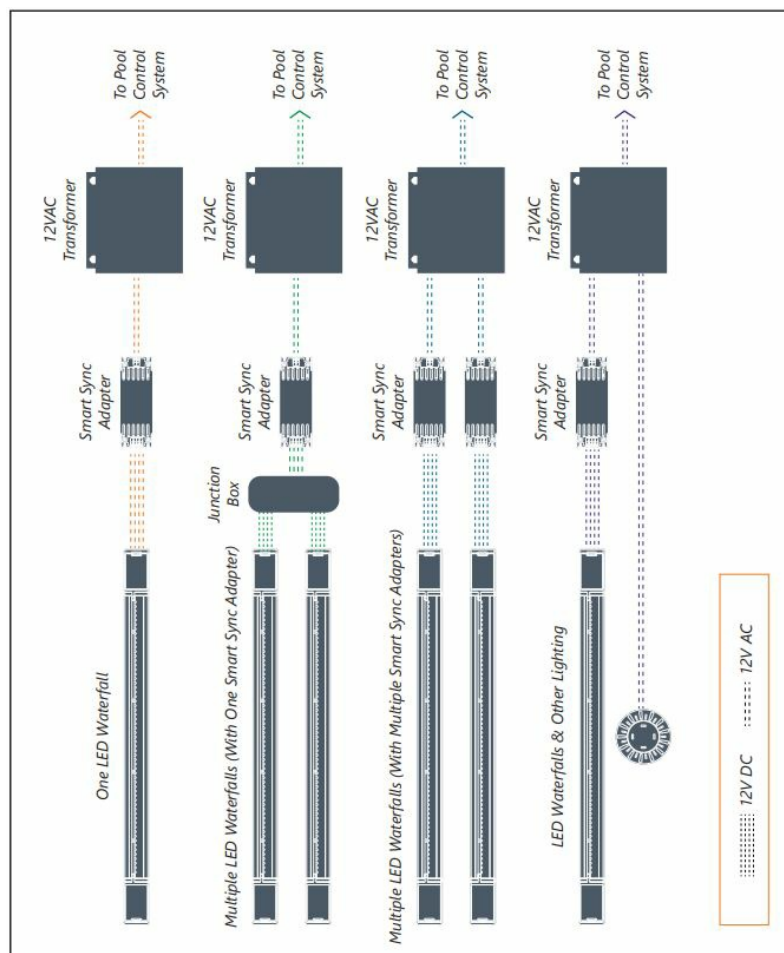

Figure 6. RGBW wiring

System Wiring Examples



Brightness

WARNING: Turn off all power to the Smart Sync LED Adapter before opening enclosure and adjusting brightness.

1. Turn off all power to the Smart Sync LED Adapter before opening enclosure.
2. Open the enclosure door.

3. Adjust brightness by rotating the dimmer dial. There are eight brightness settings from 0–7, with 0 being the brightest setting.

NOTE: Follow the same steps when adjusting brightness after initial installation.

Section 3. Operation

ATTENTION: Incorrect wire connections will affect color sequencing. For problems with color sequence and/or synchronization, check wire connection(s) and wire color coding. 3.1 J-Series (Factory Default)

1. Turn the light ON.
2. Turn the light OFF and ON within three seconds repeatedly until you reach the desired color or show. See Table 1 for the color sequence.

NOTE: When the light is OFF for more than seven seconds, it will remain on the last active color or show.

Reset J-Series Lights

To reset the light to the beginning of the color sequence (Alpine White):

3. Turn the light OFF.
4. Wait four to six seconds.
5. Turn the light ON.

Table 1. J-Series Colors and Shows Sequence

Sequence Order	Color/Show
1	Alpine White
2	Sky Blue (primary blue)
3	Cobalt Blue (dark blue)
4	Caribbean Blue (light blue)
5	Spring Green (light green)
6	Emerald Green (primary green)
7	Emerald Rose (warm yellow)
8	Magenta
9	Violet
10	Slow Color Splash (slow fading color show)
11	Fast Color Splash (fast fading color show)
12	America the Beautiful (red/white/blue show)
13	Fat Tuesday (blue/pink/light green show)
14	Disco Tech (rapid exciting color show)

H-Series

1. Turn the light ON.
2. Turn the light OFF and ON within ten seconds repeatedly until you reach the desired color or show. See Table 2 for the color sequence.

NOTE: When the light is OFF for more than 60 seconds, it will remain in the last active color or show. When the light is turned back on, it will display white for 15 seconds before returning to that last active color or show.

Sync H-Series Lights

If some lights are displaying different colors or out-of-sync shows, follow these steps to sync them again:

1. Turn the light OFF.
2. Wait between 11–14 seconds.
3. Turn the light ON.

Table 2. H-Series Colors and Shows Sequence

Sequence Order	Color/Show
1	Voodoo Lounge (fast fading color show)
2	Deep Blue Sea (dark purple/blue)
3	Royal Blue
4	Afternoon Skies
5	Aqua Green
6	Emerald (green)
7	Cloud White
8	Warm Red
9	Flamingo (pink)
10	Vivid Violet
11	Sangria (purple)
12	Twilight (slow fading color show)
13	Tranquility (blue tones show)
14	Gemstone (green/blue/red show)
15	USA (red/white/blue show)
16	Mardi Gras (purple/orange/green show)
17	Cool Cabaret (medium fading color show)

P-Series

1. Turn the light ON.
2. Turn the light OFF and ON the required number of times to display the desired color or show. See Table 3 for required numbers.

NOTE: P-Series lights always start over at 1 when changing the color/show. For example, to change the light from Party Mode (2) to California Sunset Mode (6), you need to turn the light OFF and ON 6 times, as listed in Table 3.

Hold and Recall Features

Save unique colors (e.g. when one color is fading into another in the middle of a show) by using the Hold and Recall features.

- To save a unique color, turn the light OFF and ON 13 times starting when the light is displaying the desired color effect.
- To display the saved color, turn the light OFF and ON 14 times.

Table 3. P-Series Colors and Shows

Number	Color/Show
1	SAm® Mode (blue/magenta/white/green show)
2	Party Mode (fast fading color show)
3	Romance Mode (medium fading color show)
4	Caribbean Mode (green/white/blue show)
5	American Mode (red/white/blue show)
6	California Sunset Mode (warm tone color show)
7	Royal Mode (purple/orange/green show)
8	Blue
9	Green
10	Red
11	White
12	Magenta
13	Hold Feature
14	Recall Feature

Zodiac Pool Systems LLC 2882 Whiptail Loop # 100 Carlsbad, CA 92010, USA Jandy.com 1.800.822.7933
Zodiac Pool Systems Canada, Inc. 2-3365 Mainway Burlington, ON L7M 1A6, Canada Jandy.ca 1.800.822.7933

A Fluidra Brand

©2023 Zodiac Pool Systems LLC. All rights reserved. ZODIAC® is a registered trademark of Zodiac International, S.A.S.U., used under license. All other trademarks are the property of their respective owners.

H0785800_REVB

CONFORMS TO UL STD 8750
Certified to CSA STD C22.2 250.13

Documents / Resources

	<p>Jandy SMARTSYNC60W Smart Sync LED Adapter [pdf] Instruction Manual</p> <p>SMARTSYNC60W Smart Sync LED Adapter, SMARTSYNC60W, Smart Sync LED Adapter, Sync LED Adapter, LED Adapter, Adapter</p>
---	--

[Manuals+.](#)