

JAMO MPA-101 Multi Purpose Amplifier



JAMO MPA-101 Multi Purpose Amplifier Instruction Manual

[Home](#) » [jamo](#) » JAMO MPA-101 Multi Purpose Amplifier Instruction Manual 

Contents

- [1 JAMO MPA-101 Multi Purpose Amplifier](#)
- [2 Product Information](#)
- [3 Product Usage Instructions](#)
- [4 Safety Precautions](#)
- [5 Introduction](#)
- [6 Features](#)
- [7 Jamo MPA-101 front panel](#)
- [8 Jamo MPA-101 rear panel](#)
- [9 Connection](#)
- [10 Connecting examples](#)
- [11 Specifications](#)
- [12 Documents / Resources](#)
 - [12.1 References](#)

Jamo®

JAMO MPA-101 Multi Purpose Amplifier



Product Information

Specifications

- **Model:** MPA-101
- **Power Output:** 2 x 100W (stereo), 200W (bridged)
- **Connection:** Passive subwoofer, full-range stereo
- **Warranty:** See page 13 for details

Features

The Jamo MPA-101 amplifier offers the following features:

- Jamo MPA-101 front panel
- Jamo MPA-101 rear panel
- Connecting examples
- Daisy chain support

Safety Precautions

1. Heed warnings: All warnings on the product and in the User's Guide must be adhered to.
2. Read all instructions before using this product, and keep the instructions safe for later reference.
3. Do not expose the product to rain or moisture. Avoid using it immediately after moving it from a cold environment to prevent condensation.
4. Ensure sufficient ventilation for the product at all times.
5. Avoid placing the product near heat sources or in direct sunlight.
6. Use only a mains supply that corresponds to the marking on the product. Do not modify the plug to defeat its safety features.
7. Disconnect the mains lead from the wall outlet if the product is not used for a longer period of time or during a lightning storm.
8. When disconnecting the plug from the wall outlet, pull on the mains plug itself, not the mains lead. Take care to prevent stretching or trapping of the mains lead.
9. Follow the user instructions when making connections to other appliances.
10. Avoid dropping objects or spilling liquid through the openings in the product.
11. Route power supply cords in a way that they are not likely to be walked on or pinched by items placed upon or against them.

Product Usage Instructions

Installation

Follow these steps to properly install the Jamo MPA-101 amplifier:

1. Read all instructions and safety precautions before proceeding with the installation.
2. Choose a suitable location for the amplifier that provides sufficient ventilation and is away from heat sources.

3. Ensure the mains supply corresponds to the marking on the product and use a grounded outlet if available.
4. Connect the amplifier to the desired audio source using the appropriate cables as per the connecting examples provided.
5. If using a passive subwoofer, connect it to the dedicated subwoofer output on the rear panel of the amplifier.
6. If using full-range stereo speakers, connect them to the corresponding left and right speaker outputs on the rear panel of the amplifier.
7. If bridging the amplifier for increased power output, follow the bridging instructions provided in the connecting examples section.
8. Ensure all connections are secure and properly tightened.

Operation

Once the Jamo MPA-101 amplifier is properly installed, follow these instructions for its operation:

1. Connect the mains to a suitable power outlet.
2. Turn on the amplifier using the power switch located on the front or rear panel.
3. Adjust the volume and other settings as desired.
4. Refer to the User's Guide for detailed instructions on adjusting specific features and settings of the amplifier.

Maintenance

To ensure proper maintenance of the Jamo MPA-101 amplifier, follow these guidelines:

1. Keep the amplifier clean by wiping it with a soft, dry cloth.
2. Avoid using abrasive cleaners or solvents that may damage the surface of the amplifier.
3. Regularly check and clean the ventilation openings to prevent dust buildup.

FAQ

- **Q:** Are there any troubleshooting steps for common issues?
- **A:** Yes, please refer to the Troubleshooting section on page 12 of the User's Guide for common issues and their solutions.
- **Q:** Can I use the amplifier with a wireless audio source?
- **A:** The Jamo MPA-101 amplifier does not have built-in wireless capabilities. However, you can use wireless audio adapters or transmitters to connect a wireless audio source to the amplifier.
- **Q:** Is it possible to connect multiple amplifiers?
- **A:** Yes, you can daisy chain multiple Jamo MPA-101 amplifiers together using appropriate cables and connections. Please refer to the connecting examples section for more information.
- **Q:** Can I connect both a passive subwoofer and full-range stereo speakers to the amplifier simultaneously?
- **A:** No, the amplifier supports either a passive subwoofer or full-range stereo speakers. Connecting both simultaneously may result in improper audio output and could potentially damage the speakers or the amplifier.
- **Q:** Does the amplifier come with a remote control?
- **A:** The Jamo MPA-101 amplifier does not include a remote control. All operations and adjustments can be made directly on the amplifier itself.

CAUTION



- The lightning flash with arrowhead, within an equilateral triangle, is intended to alert the user to the presence of uninsulated “dangerous voltage” within the product’s enclosure that may be of sufficient magnitude to constitute a risk of electric shock to persons.



- The exclamation point within an equilateral triangle is intended to alert the user to the presence of important operating and maintenance (servicing) instructions in the literature accompanying the appliance

Warning

To prevent electric shock, never open this product. No user-serviceable parts inside. Leave all service to qualified service personnel.

Safety Precautions

1. Heed warnings: All warnings on the product and in the User’s Guide must be adhered to.
2. Read all instructions before using this product, and keep the instructions safe for later reference.
3. **WARNING:** To reduce the risk of fire or electric shock, do not expose this product to rain or moisture – Never use the product immediately after moving it from a cold environment, which may cause condensation.
4. The product must be positioned in such a way that there is sufficient ventilation at all times.
5. Do not place the product near heat sources, such as radiators, heaters or any other heat-emitting appliances.
6. Avoid placing in direct sunlight.
7. The product may only be attached to a mains supply that corresponds to the marking on the product. Do not defeat the safety purpose of a polarized or grounding-type plug. A polarized plug has two blades with one wider than the other. A grounding-type plug has two blades and a third grounding prong. The wide blade or the third prong is provided for safety reasons. If the provided mains plug does not fit into your outlet, consult an electrician for replacement of the obsolete outlet.
8. If the product is not used for a longer time, or for added protection during a lightning storm, disconnect the mains lead from the wall outlet.
9. Pull on the mains plug – never the mains lead itself – when disconnecting the plug from the wall outlet. Ensure that the mains lead does not become stretched or trapped/clamped, especially around the mains plug and the point at which the lead is connected to the product.
10. Always follow the user instructions when making connections to other appliances.
11. Take care not to drop objects or spill liquid through the openings in the product.
12. The product should be serviced by qualified personnel if:
 1. The main lead or plug is damaged.
 2. Objects are dropped or liquid is spilled into the product.

3. The product has been exposed to rain.
 4. The product is not operating normally.
 5. The product has been dropped and/or the cabinet is damaged.
13. Please note that this product – either alone or combined with an amplifier, loudspeakers or headphones – can cause damage to hearing. Never play at high volume for longer periods and never play so loud that it feels uncomfortable. Warning! It can be particularly difficult to estimate sound pressure in the deep bass area, which is why extra attention must be paid in order to avoid harmful sound pressures. Always contact your doctor if you experience loss of hearing and/or ringing in the ears.
14. Warning: Power-supply cords should be routed so that they are not likely to be walked on or pinched by items placed upon or against them, paying particular attention to cords at plugs, and the point at which they exit from the product.

Introduction

Congratulations on your purchase of your new Jamo Multi-Purpose Amplifier (MPA-101). It is backed by state-of-the-art engineering and manufacturing techniques to bring you the best quality craftsmanship and reliable performance.

The MPA-101 is specifically designed for home theatre applications. Because of its ample power and two-channel capacity (stereo), it can fit into virtually any surround application. Narrow width chassis is designed for convenient shelf or system rack mounting in the space of the one stereo component. It allows you to use one amplifier for left and right stereo front speakers, a second amplifier use as left and right rear (surround) speakers and a third amplifier for the centre channel. Bridge mode capability allows the use of the two channels connected together to form one high-power amplifier channel, providing 100 watts into 8 Ohm. The MPA-101 is also a subwoofer amplifier with an adjustable electronic crossover. With the switch in the OFF position, it becomes full range amplifier. The power ratings for the Jamo MPA-101 power amplifier are obtained using fixed-value test load impedances and high-intensity sine wave test tones. However, the actual impedance of the loudspeaker will vary with frequency, deviating somewhat from the loudspeaker manufacturer's nominal impedance rating. This Jamo amplifier has been specially designed to drive any modern loudspeaker system with a rated impedance of 4 Ohms or higher.

Features

1. Power output, rated at 2×50 Watts (stereo) into 4 Ohm
2. High power output (bridged mode), rated at 100 Watts into 8 Ohm
3. Subwoofer amplifier, adjustable crossover frequency 50 Hz – 150 Hz
4. Full range amplifier
5. Extensive heat sinks for reliable operation and long life of the amplifier
6. High current discrete power transistors in the output stage for the best possible performance
7. Automatic power turn "ON"
8. Level control
9. Gold-plated RCA input and output jacks
10. Heavy-duty push-button binding posts
11. Overload protection

Jamo MPA-101 front panel

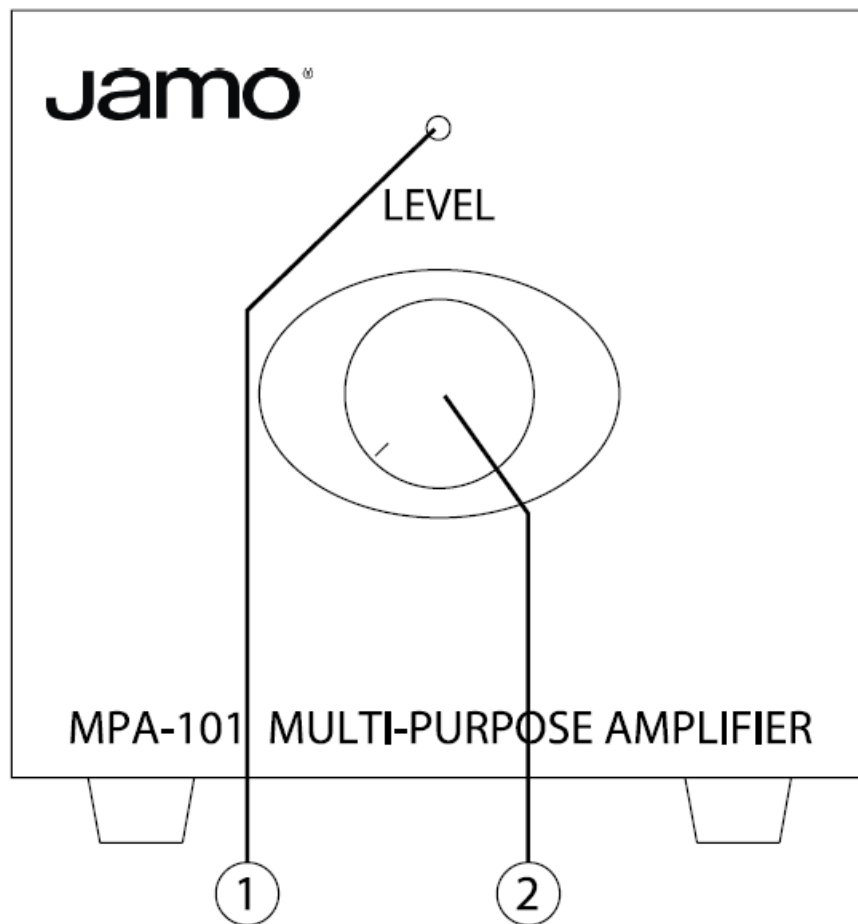

1. Power LED

1. Flashing blue – Standby mode
2. Blue – Amplifier On
3. Flashing red – Thermal protection
4. Red – Overload protection

2. Level adjustment

Jamo MPA-101 rear panel

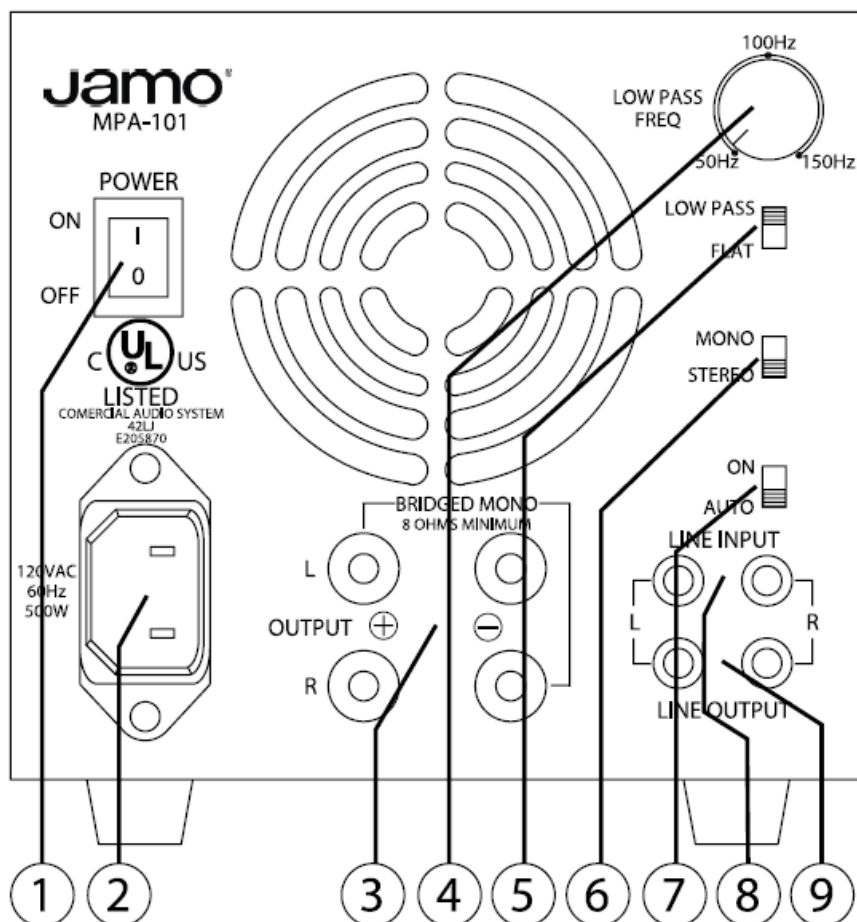

1. **Power switch**
2. **Socket for mains cable**
3. **Speaker output:** Speakers' terminals
4. **Low pass adjustment:** Output frequency is adjustable between 50 – 150 Hz. Only adjustable when „low pass” is selected ©
5. **Low pass:** 4
 1. **Flat:** Fullrange
6. **Stereo/mono:** Stereo mode – 2 x 50 watt
 1. stereo output (4Ω)
 2. Mono mode – 100 watt
 3. mono output (8 Ω)
7. **On** – Amplifier ON
 1. **AUTO** – auto turn-on mode
8. **Line in:** Line-level input from the source
9. **Line out:** Line level output

Connection

The Jamo MPA-101 is equipped with gold-plated push button binding posts which will accept very heavy stripped wire. Ask your local Jamo dealer for advice on the choice of cable. Connect the loudspeakers to your Jamo MPA-101 as follows:

1. Turn of the MPA-101

2. Carefully remove approx. 3/8" (10 mm) of the insulating material – beware not to damage the conductors!
3. Twist the conductor's ends
4. Push the binding posts so the conductors can easily fit into the holes

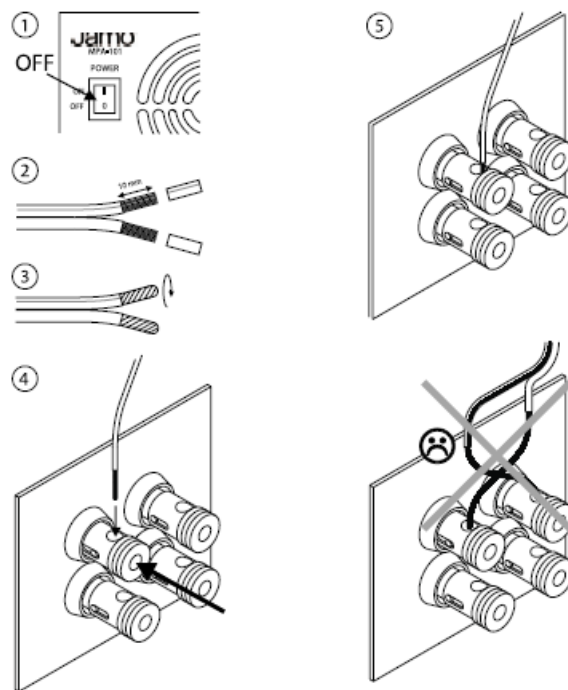

Note: Make sure that the stripped + and – wires do not touch each other, as a short circuit could damage the Jamo MPA-101's output section.

Always make sure that

Your loudspeakers are in the correct phase;

- The loudspeaker's + terminal is connected to the Jamo MPA-101's + terminal.
- The loudspeaker's – terminal is connected to the Jamo MPA-101's – terminal.
- Usually, the loudspeaker cable is marked on one wire which is normally used to connect the + terminals to ensure the correct phase.

Connecting examples

Passive subwoofer

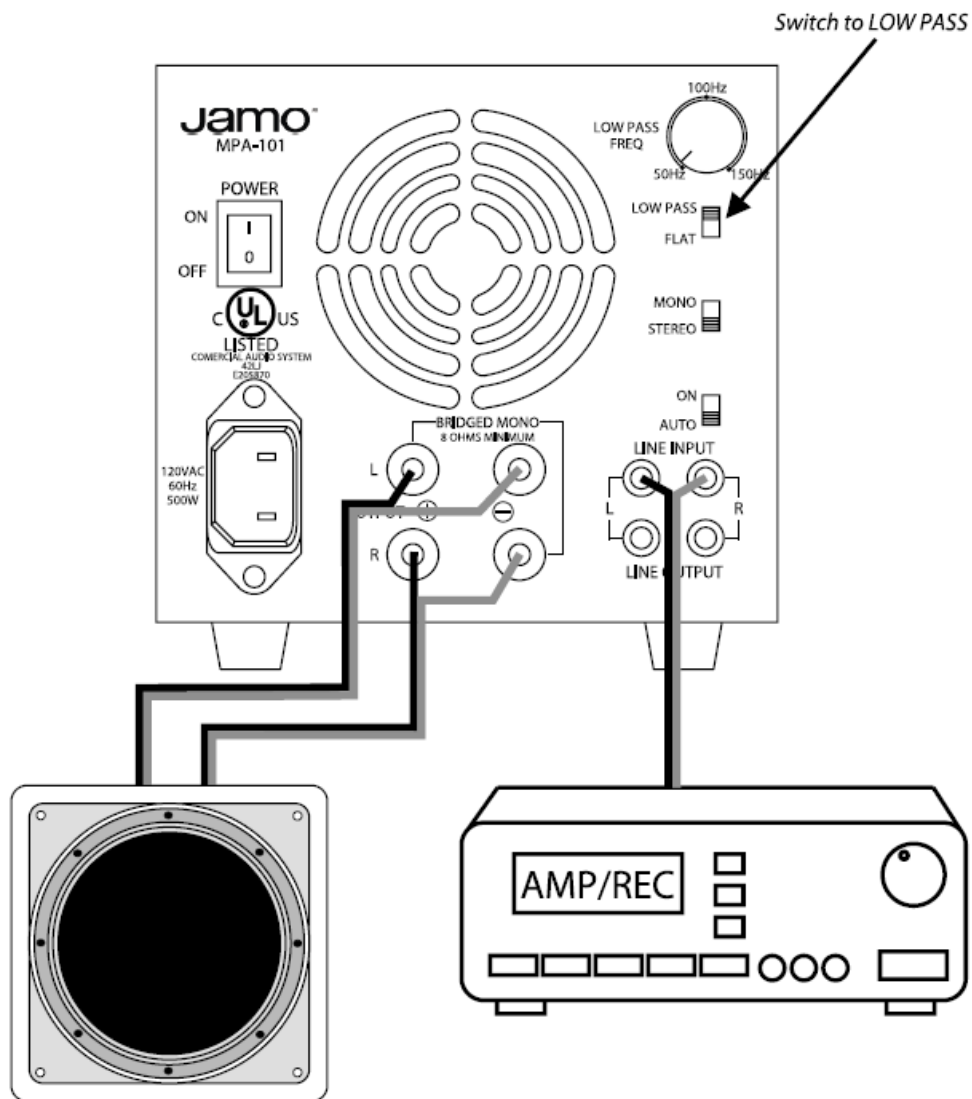

When „Low pass“ is selected, you can adjust the low pass frequency between 50 – 150 Hz. This makes it possible to make the subwoofer match your front speakers.

Full-range stereo

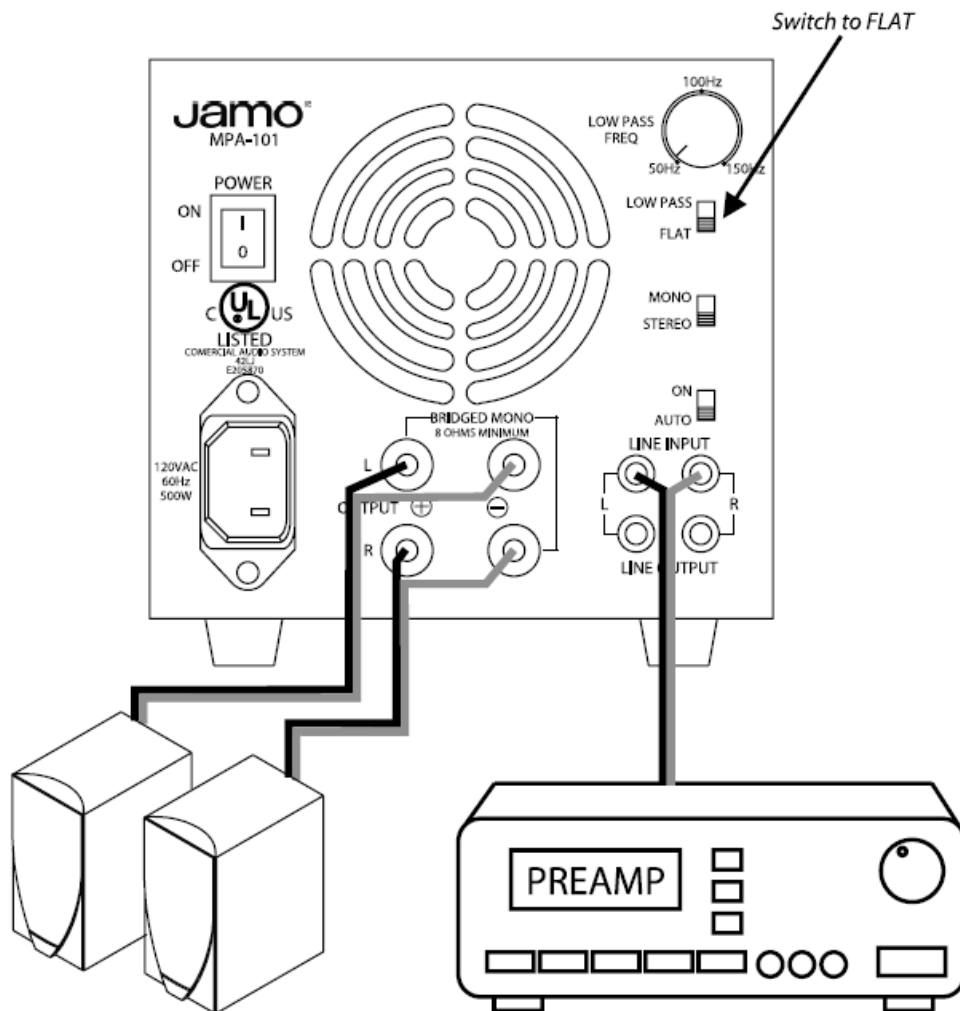

2 x 100W bridged

2 x 100W bridged

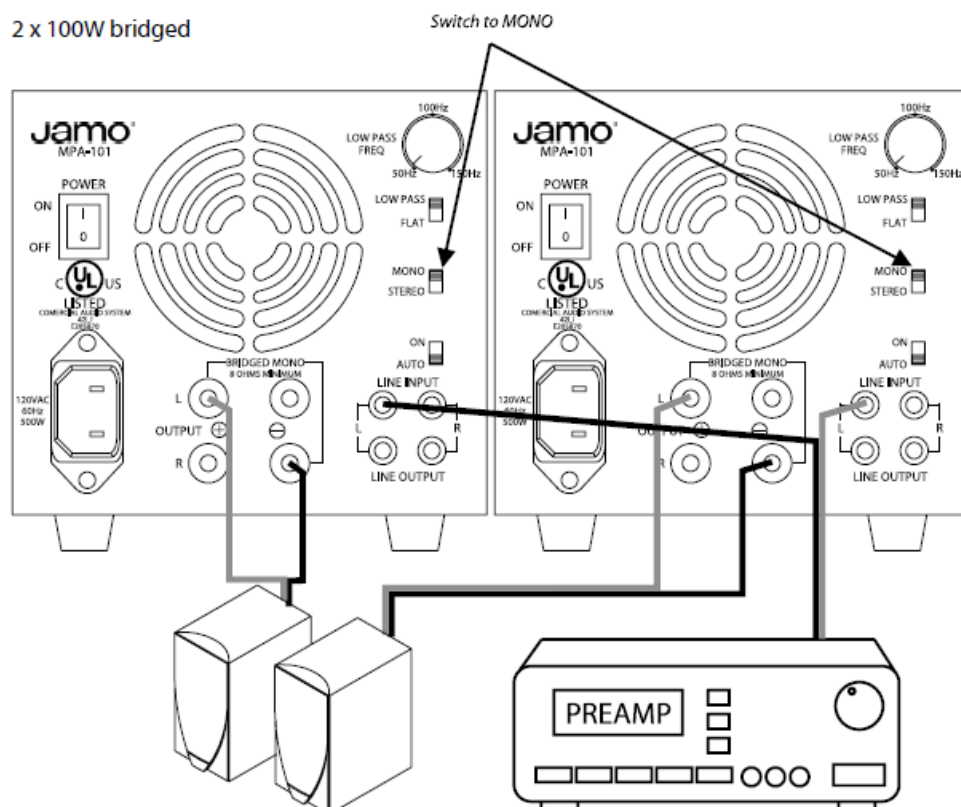

Daisy chain

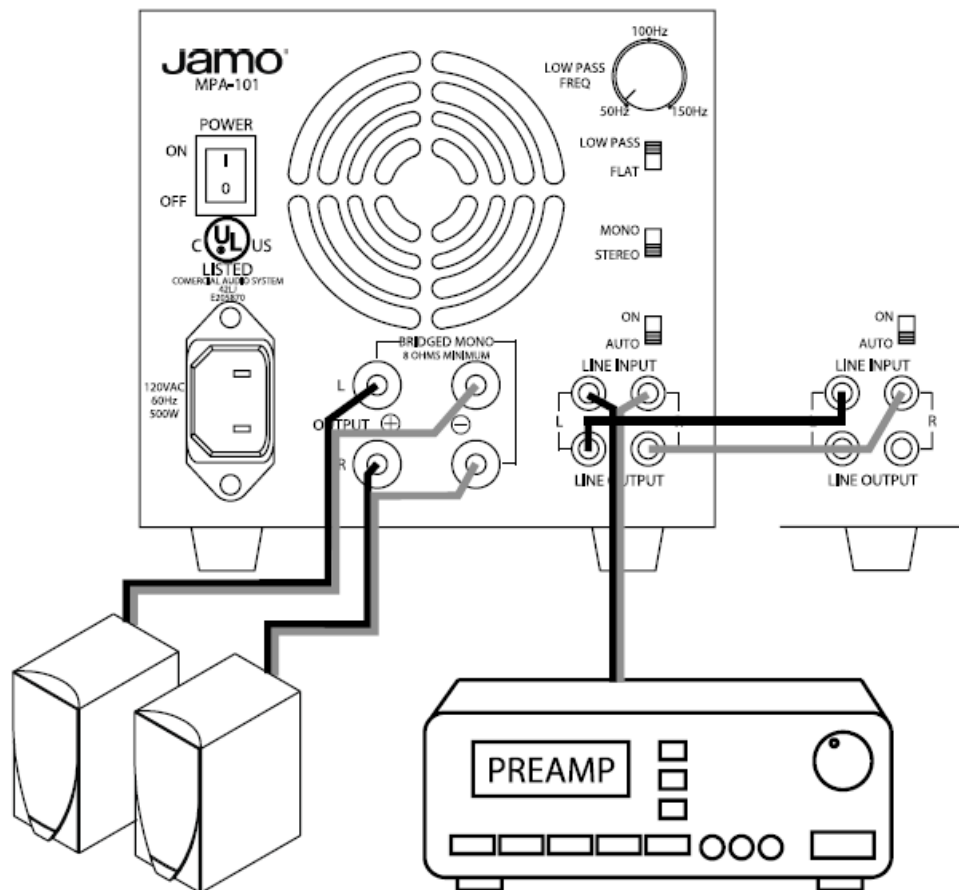

When using this feature you can connect all the MPA-101 in parallel you need.

Specifications

Rated Power Output	50 Watts (Stereo) into 4Ω Load
Total Harmonic Distortion (THD)	100 Watts (BTL) into 8Ω Load
Signal-to-Noise Ratio	<0.1%
Crossover Freq. Response (-3dB):	@ Min position 28-45Hz 40Hz/0dB ref @ Max position 32-60Hz 40Hz/0dB ref
Auto Turn On Sensitivity	11.0V +/-3 Full Range 1KHz 7.0V +/-2 Sub Input 50 Hz
Delay „OFF“ Time	15 - 20 minutes
Input Sensitivity Line In	Output 1 W/4Ω with: Full Range 44mV +/-10 1KHz Sub In 7mV +/-2 50Hz
Line Out Freq. Response (-3dB)	20Hz +/-5K - 20 KHz +/-5K 1KHz/0dB ref
Input Impedance Line In	47KΩ +/-5
Max. noise+hum Vol Max	<3.0mV, Input Shorted
Clearance for ventilation - Back	Minimum 2" (50mm)
Power Requirement	115V 60Hz
Weight	7.8lbs (3.6 kgs)
Shipping Weight	8.6lbs (3.9kgs)
Dimentions:	
Width	6.000" (152.00mm)
Height	3.125" (79.00mm)
Depth	11.4375" (290.00mm)
Clearance for ventilation	
Top	Minimum 3/8" (10 mm)
Back	Minimum 2" (50 mm)

The scope of the warranty

The warranty period will come into force as from the purchase date stated on the invoice. The warranty will apply for the following period:

- 2 years for electronics (power supply, amplifier, etc.)
- 7 years for other parts (cabinet, speaker units, etc.)

In case of warranty inquiries, please contact your dealer. In case of a request for service under warranty, please enclose your original receipt. Defects covered by the warranty: Except for the defects stated below, the warranty covers any production and material defects of the product. Defects not covered by the warranty:

- Defects arising from accidents, misuse, normal wear and tear, mis-maintenance, voltage variations, overloading, stroke of lightning, and other force majeure events
- Defects arising from incorrect installation or operation
- Defects arising from modification/repair/attempt of repair by a non-authorised service centre
- Defects arising from the use of non-original spare parts
- Defects on products with altered or lacking series number
- Other defects due to conditions or circumstances beyond the supplier's control

Transportation costs for servicing are not covered by the warranty. The supplier is liable only to repair or replace

defective parts or products. A replacement cannot exceed the value of the product under warranty.

Documents / Resources

	<p>JAMO MPA-101 Multi Purpose Amplifier [pdf] Instruction Manual MPA-101 Multi Purpose Amplifier, MPA-101, Multi Purpose Amplifier, Purpose Amplifier, Amplifier</p>
-----------------------------------------------------------------------------------	-------------------------------------------------------------------------------------------------------------------------------------------------------------------------------------------------

References

-  [Manual-Hub.com - Free PDF manuals!](#)
- [User Manual](#)

Manuals+. [Privacy Policy](#)

This website is an independent publication and is neither affiliated with nor endorsed by any of the trademark owners. The "Bluetooth®" word mark and logos are registered trademarks owned by Bluetooth SIG, Inc. The "Wi-Fi®" word mark and logos are registered trademarks owned by the Wi-Fi Alliance. Any use of these marks on this website does not imply any affiliation with or endorsement.