



JamesHardie HardiePlank Lap Siding Instruction Manual

[Home](#) » [JamesHardie](#) » JamesHardie HardiePlank Lap Siding Instruction Manual 



HardiePlank® Lap Siding
EFFECTIVE DECEMBER 2019

IMPORTANT: FAILURE TO FOLLOW JAMES HARDIE WRITTEN INSTALLATION INSTRUCTIONS AND COMPLY WITH APPLICABLE BUILDING CODES MAY VIOLATE LOCAL LAWS, AFFECT BUILDING ENVELOPE PERFORMANCE, AND MAY AFFECT WARRANTY COVERAGE. FAILURE TO COMPLY WITH ALL HEALTH AND SAFETY REGULATIONS WHEN CUTTING AND INSTALLING THIS PRODUCT MAY RESULT IN PERSONAL INJURY. BEFORE INSTALLATION, CONFIRM YOU ARE USING THE CORRECT HARDIEZONE® PRODUCT INSTRUCTIONS BY VISITING HARDIEZONE.COM OR CALL 1-866-942-7343 (866-9-HARDIE)

STORAGE & HANDLING:

Store flat and keep dry and covered prior to installation. Installing siding wet or saturated may result in shrinkage at butt joints. Carry planks on edge. Protect edges and corners from breakage. James Hardie is not responsible for damage caused by improper storage and handling of the product.

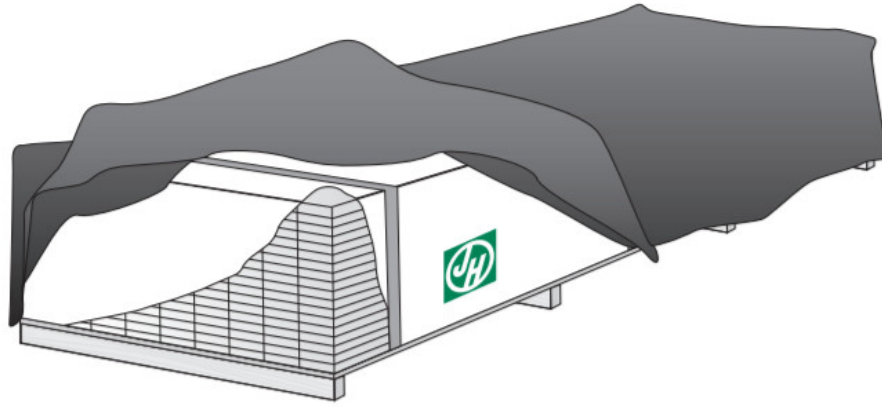

CUTTING INSTRUCTIONS

OUTDOORS

1. Position cutting station so that airflow blows dust away from the user and others near the cutting area.
2. Cut using one of the following methods:
 - a. Best: Circular saw equipped with a HardieBlade® saw blade and attached vacuum dust collection system. Shears (manual, pneumatic or electric) may also be used, not recommended for products thicker than 7/16 in.
 - b. Better: Circular saw equipped with a dust collection feature (e.g. Roan® saw) and a HardieBlade saw blade.
 - c. Good: Circular saw equipped with a HardieBlade saw blade.

INDOORS

DO NOT grind or cut with a power saw indoors. Cut using shears (manual, pneumatic or electric) or the score and snap method, not recommended for products thicker than 7/16 in.

- DO NOT dry sweep dust; use wet dust suppression or vacuum to collect dust.
- For maximum dust reduction, James Hardie recommends using the “Best” cutting practices. Always follow the equipment manufacturer’s instructions for proper operation.
- For best performance when cutting with a circular saw, James Hardie recommends using HardieBlade® saw blades.
- Go to jameshardiepros.com for additional cutting and dust control recommendations.

IMPORTANT: The Occupational Safety and Health Administration (OSHA) regulates workplace exposure to silica dust. For construction sites, OSHA has deemed that cutting fiber cement with a circular saw having a blade diameter less than 8 inches and connected to a commercially available dust collection system per manufacturer’s instructions results in exposures below the OSHA Permissible Exposure Limit (PEL) for respirable crystalline silica, without the need for additional respiratory protection.

If you are unsure about how to comply with OSHA silica dust regulations, consult a qualified industrial hygienist or safety professional, or contact your James Hardie technical sales representative for assistance. James Hardie makes no representation or warranty that adopting a particular cutting practice will assure your compliance with OSHA rules or other applicable laws and safety requirements.

Contents

1 GENERAL REQUIREMENTS:

2 INSTALLATION: JOINT TREATMENT

3 Documents / Resources

3.1 References

4 Related Posts

GENERAL REQUIREMENTS:

- HardiePlank® lap siding can be installed over braced wood or steel studs, 20 gauge (33 mils) minimum to 16 gauge (54 mils) maximum, spaced a maximum of 24 in o.c. or directly to minimum 7/16 in thick OSB sheathing. See General Fastening Requirements. Irregularities in framing and sheathing can mirror through the finished application. Correct irregularities before installing siding.
- Information on installing James Hardie products over non-nailable substrates (ex: gypsum, foam, etc.) can be located in JH Tech Bulletin 19 at www.jamehardie.com
- A water-resistive barrier is required in accordance with local building code requirements. The water-resistive barrier must be appropriately installed with penetration and junction flashing in accordance with local building code requirements. James Hardie will assume no responsibility for water infiltration. James Hardie does manufacture HardieWrap® Weather Barrier, a non-woven non-perforated housewrap¹, which complies with building code requirements.
- When installing James Hardie products all clearance details are in figs. 3-14 must be followed.
- Adjacent finished grade must slope away from the building in accordance with local building codes – typically a minimum of 6 in. in the first 10 ft..
- Do not use HardiePlank lap siding in Fascia or Trim applications.
- Do not install James Hardie products, such that they may remain in contact with standing water.
- HardiePlank lap siding may be installed on flat vertical wall applications only.
- For larger projects, including commercial and multi-family projects, where the span of the wall is significant in length, the designer and/or architect should take into consideration the coefficient of thermal expansion and moisture movement of the product in their design. These values can be found in the Technical Bulletin “Expansion Characteristics of James Hardie® Siding Products” at www.jameshardie.com.
- James Hardie Building Products provides installation/wind load information for buildings with a maximum mean roof height of 85 feet. For information on installations above 60 feet, please contact JH technical support.

INSTALLATION: JOINT TREATMENT

One or more of the following joint treatment options are required by code (as referenced 2009 IRC R703.10.2)

A. Joint Flashing (James Hardie recommended)

B. Caulking* (Caulking is not recommended for ColorPlus for aesthetic reasons as the Caulking and ColorPlus will weather differently. For the same reason, do not caulk nail heads on ColorPlus products.)

C. “H” jointer cover

Note: Field painting over caulking may produce a sheen difference when compared to the field painted PrimePlus.

*Refer to the Caulking section in these instructions.

¹For additional information on HardieWrap® Weather Barrier, consult James Hardie at 1-866-4Hardie or www.hardiewrap.com

JOINT TREATMENT

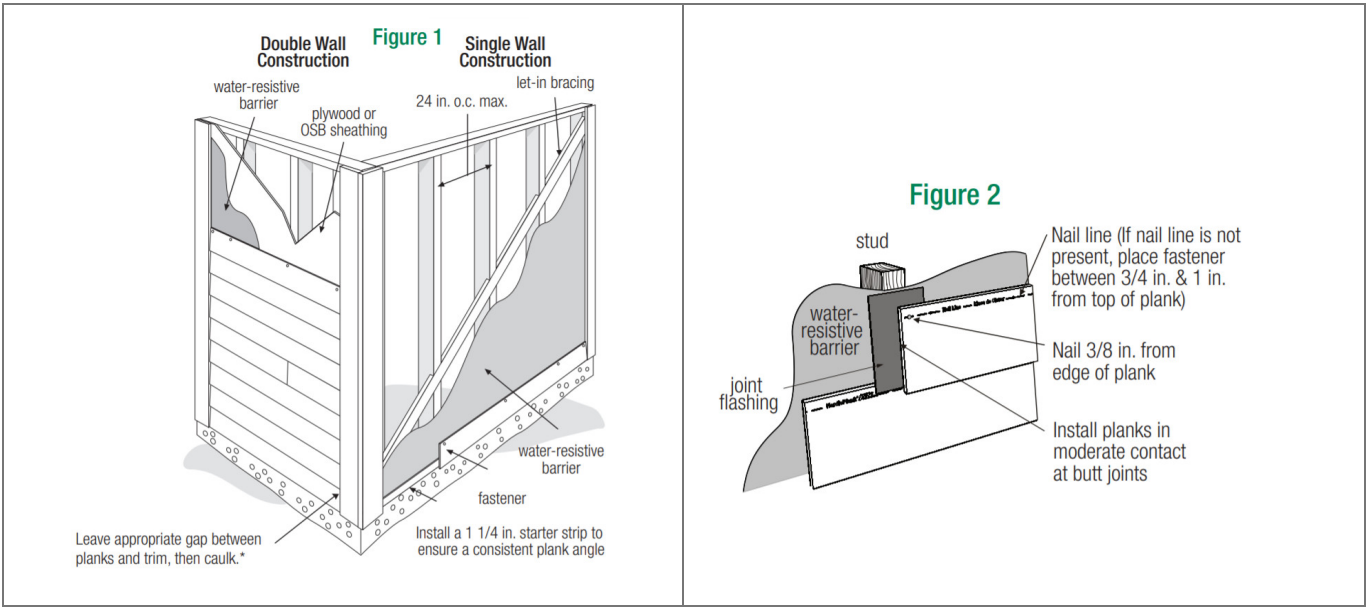

CLEARANCE AND FLASHING REQUIREMENTS

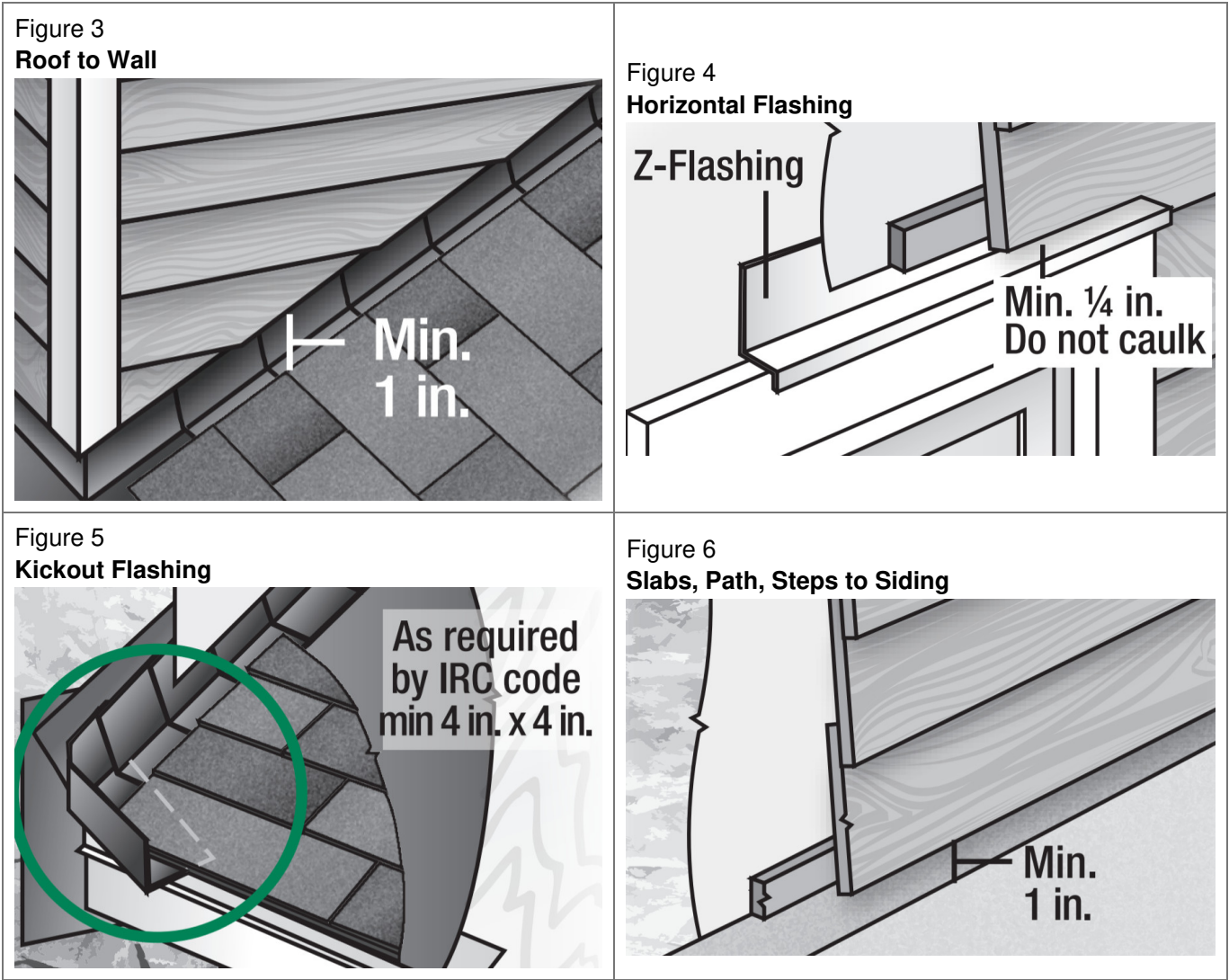

Figure 7
Deck to Wall

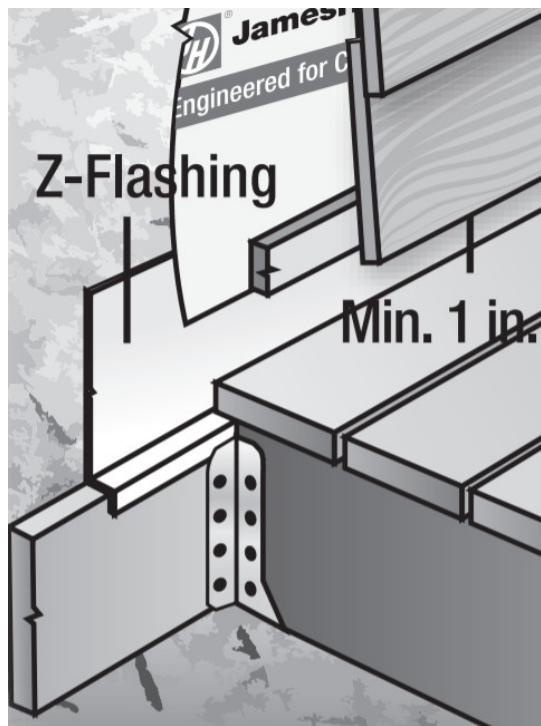

Figure 8
Ground to Siding

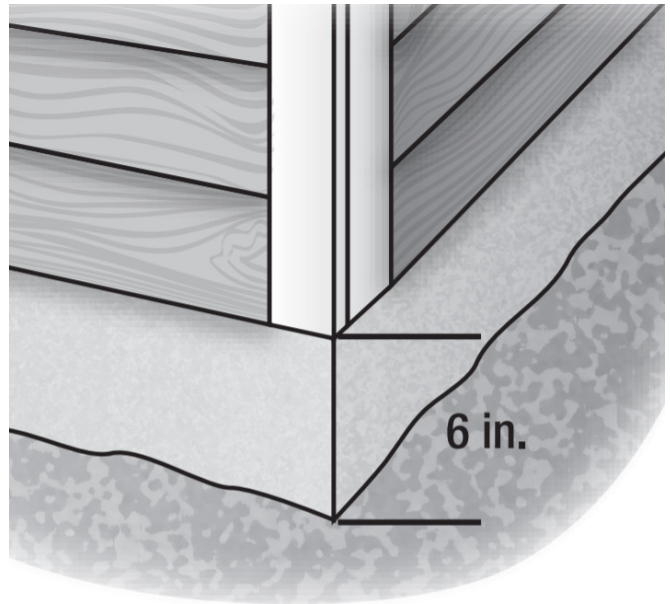

Figure 9
Gutter to Siding



Figure 10
Sheltered Areas

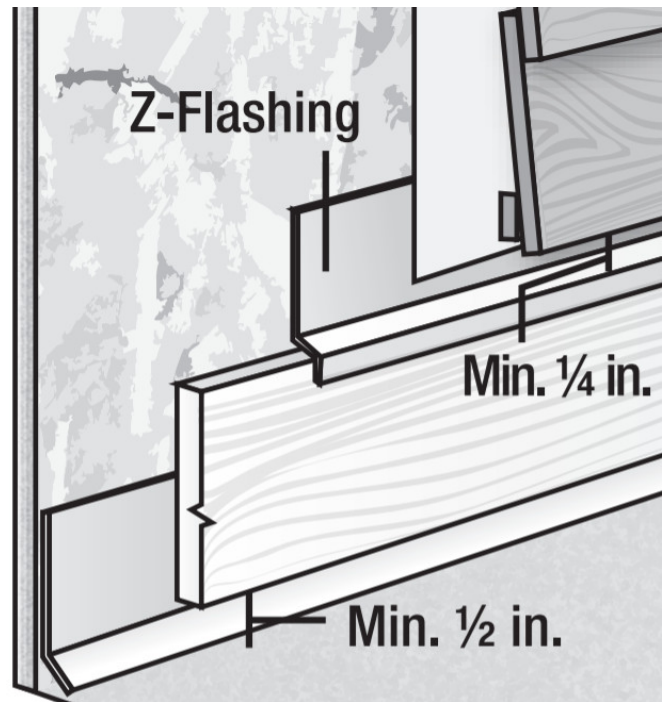

Figure 11
Mortar/Masonry

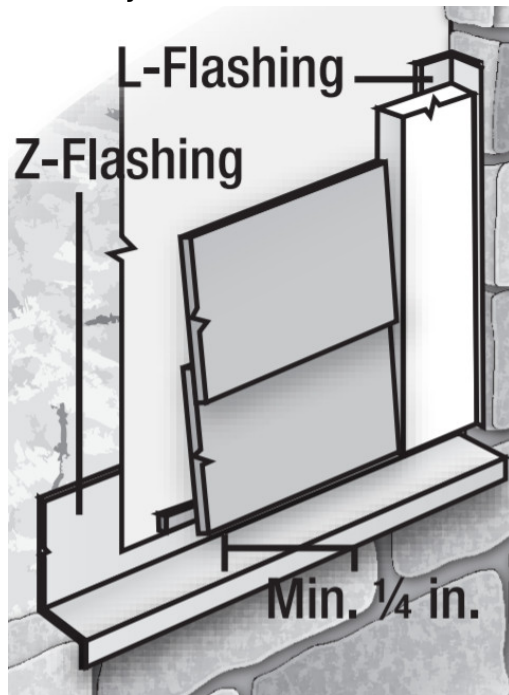

Figure 12
Drip Edge

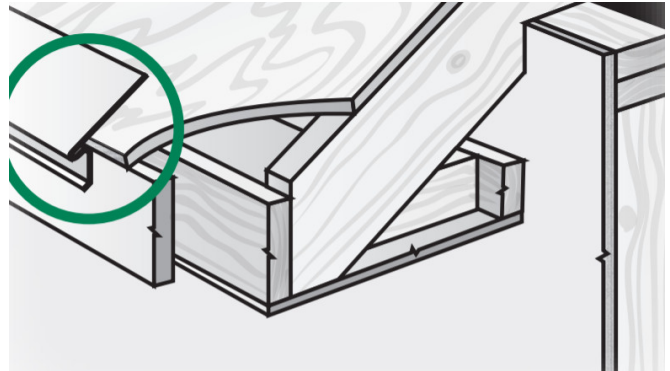

Figure 13
Block Penetration

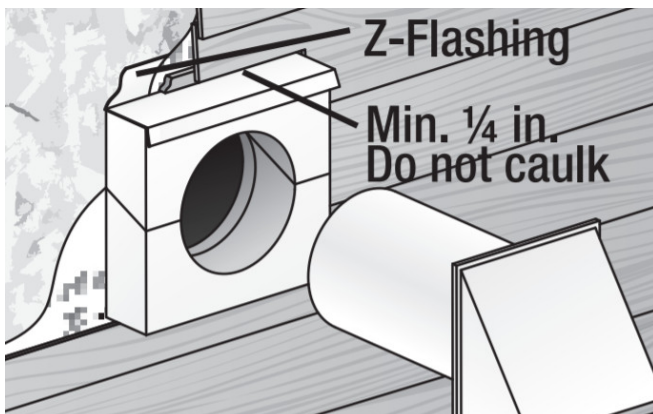
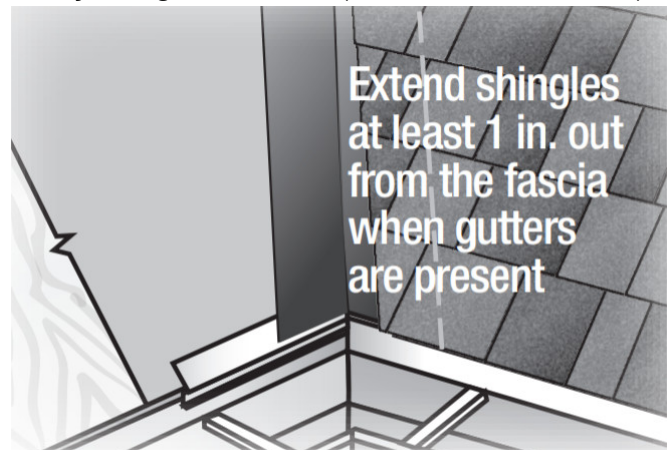

Figure 14
Valley/Shingle Extension (Recommended in HZ10)



FASTENER REQUIREMENTS*

Refer to the applicable ESR report online to determine which fastener meets your wind load design criteria. Blind Nailing is the preferred method of installation for HardiePlank® lap siding products. Face nailing should only be used where required by code for high wind areas and must not be used in conjunction with Blind nailing (Please see JH Tech bulletin 17 for exemption when doing a repair).

BLIND NAILING	FACE NAILING
Nails – Wood Framing <ul style="list-style-type: none"> Siding nail (0.09 in. shank x 0.221 in. HD x 2 in. long) 11ga. roofing nail (0.121 in. shank x 0.371 in. HD x 1.25 in. long) 	Nails – Wood Framing <ul style="list-style-type: none"> 6d (0.113 in. shank x 0.267 in. HD x 2 in. long) Siding nail (0.09" shank x 0.221" HD x 2" long)
Screws – Steel Framing <ul style="list-style-type: none"> Ribbed Wafer-head or equivalent (No. 8 x 1 1/4 in. long x 0.375 in. HD) Screws must penetrate 3 threads into metal framing. 	Screws – Steel Framing <ul style="list-style-type: none"> Ribbed Bugle-head or equivalent (No. 8-18 x 1-5/8 in. long x 0.323 in. HD) Screws must penetrate 3 threads into metal framing.
Nails – Steel Framing <ul style="list-style-type: none"> ET & F Panelfast® nails or equivalent (0.10 in. shank x 0.313 in. HD x 1-1/2 in. long) Nails must penetrate a minimum of 1/4 in. into metal framing. 	Nails – Steel Framing <ul style="list-style-type: none"> ET & F pin or equivalent (0.10 in. shank x 0.25 in. HD x 1-1/2 in. long) Nails must penetrate a minimum of 1/4 in. into metal framing.
OSB minimum 7/16 in. <ul style="list-style-type: none"> Siding nail (0.09 in. shank x 0.215 in. HD x 1-1/2 in. long) Ribbed Wafer-head or equivalent (No. 8 x 1 5/8 in. long x 0.375 in. HD). 	OSB minimum 7/16 in. <ul style="list-style-type: none"> Siding nail (0.09 in. shank x 0.221 in. HD x 1-1/2 in. long)

*Also see General Fastening Requirements; and when considering alternative fastening options refer to James Hardie's Technical Bulletin USTB 5 – Fastening Tips for HardiePlank Lap Siding.

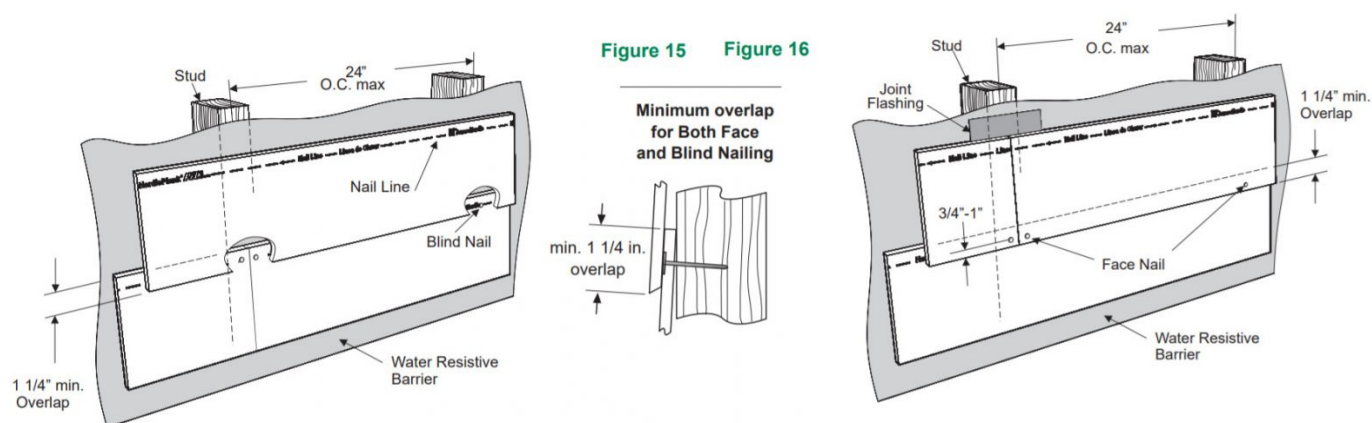

Laminate sheet to be removed immediately after installation of each course for ColorPlus® products.

Pin-backed corners may be done for aesthetic purposes only. Finish nails are recommended for pin-backs. Headed siding nails are allowed. Place pin-backs no closer than 1 in. from plank ends and 3/4 in. from plank edge into min. 3/8 in. wood structural panel. Pin-backs are not a substitute for blind or face nailing.

GENERAL FASTENING REQUIREMENTS

Fasteners must be corrosion-resistant, galvanized, or stainless steel. Electro-galvanized is acceptable but may exhibit premature corrosion. James Hardie recommends the use of quality, hot-dipped galvanized nails. James Hardie is not responsible for the corrosion resistance of fasteners. Stainless steel fasteners are recommended when installing James Hardie® products near the ocean, large bodies of water, or in very humid climates.

Manufacturers of ACQ and CA preservative-treated wood recommend spacer materials or other physical barriers to prevent direct contact with ACQ or CA preservative-treated wood and aluminum products. Fasteners used to attach HardieTrim Tabs to preservative-treated wood shall be of hot-dipped zinc-coated galvanized steel or stainless steel and in accordance with 2009 IRC R317.3 or 2009 IBC 2304.9.5

- Consult applicable product evaluation or listing for correct fasteners type and placement to achieve specified design wind loads.
- **NOTE:** Published wind loads may not be applicable to all areas where Local Building Codes have specific jurisdiction. Consult James Hardie Technical Services if you are unsure of applicable compliance documentation.
- Drive fasteners perpendicular to siding and framing.
- Fastener heads should fit snug against siding (no air space).
- **NOTE:** Whenever a structural member is present, HardiePlank should be fastened with even spacing to the structural member. The tables allowing direct to OSB or plywood should only be used when traditional framing is not available.

CUT EDGE TREATMENT

Caulk, paint, or prime all field cut edges. James Hardie touch-up kits are required to touch up ColorPlus products.

CAULKING

For best results use an Elastomeric Joint Sealant complying with ASTM C920 Grade NS, Class 25 or higher, or a Latex Joint Sealant complying with ASTM C834. Caulking/Sealant must be applied in accordance with the caulking/sealant manufacturer's written instructions.

Note: some caulking manufacturers do not allow "tooling".

PNEUMATIC FASTENING

James Hardie products can be hand nailed or fastened with a pneumatic tool. Pneumatic fastening is highly recommended. Set air pressure so that the fastener is driven snug with the surface of the siding. A flush mount attachment on the pneumatic tool is recommended. This will help control the depth the nail is driven. If setting the nail depth

proves difficult, choose a setting that under drives the nail. (Drive under driven nails snug with a smooth-faced hammer – Does not apply for installation to steel framing).

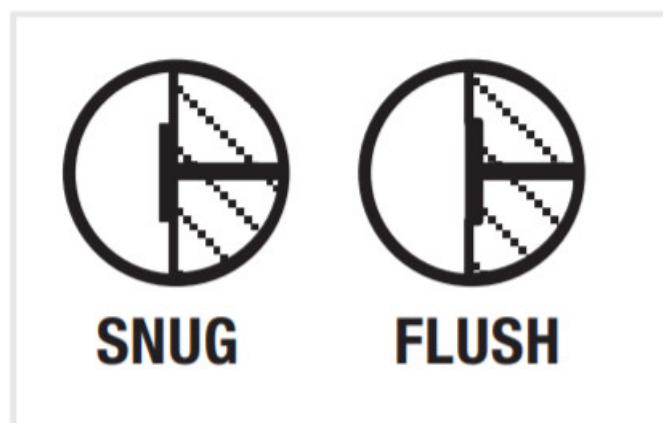

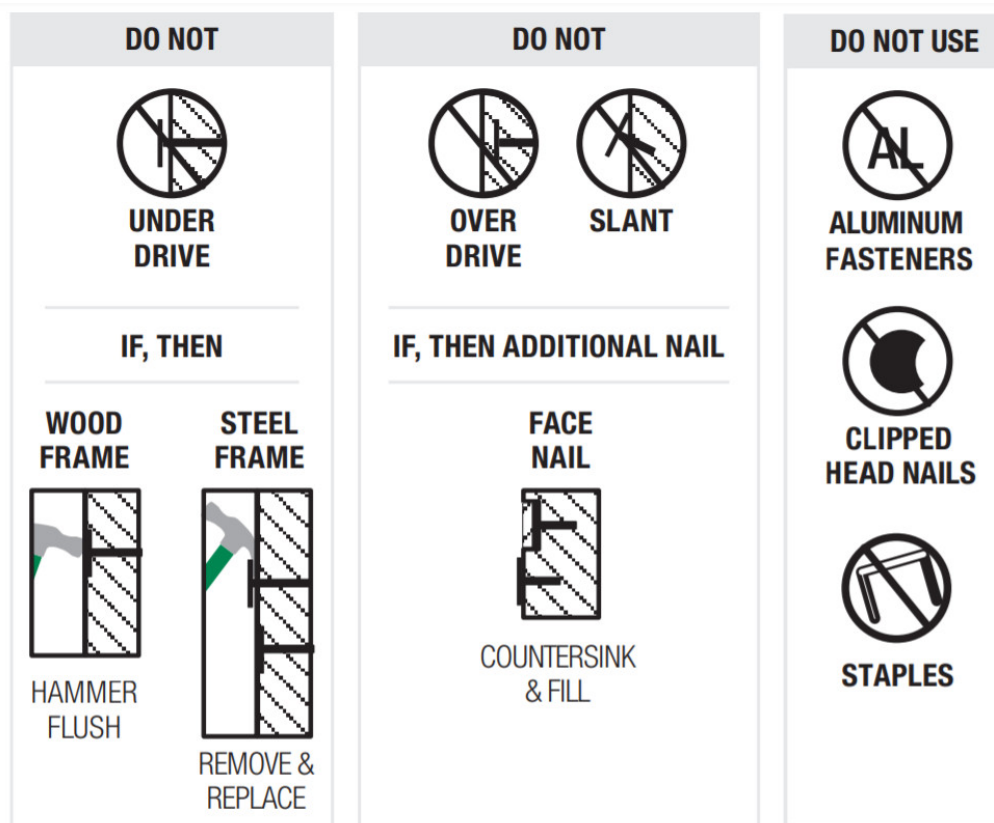

PAINTING

DO NOT use stain, oil/alkyd-based paint, or powder coating on James Hardie® Products. Factory-primed James Hardie products must be painted within 180 days of installation.

100% acrylic topcoats are recommended. Do not paint when wet. For application, rates refer to paint manufacturers' specifications. Back-rolling is recommended if the siding is sprayed.

COLORPLUS® TECHNOLOGY CAULKING, TOUCH-UP & LAMINATE

- Care should be taken when handling and cutting James Hardie® ColorPlus® products. During installation use a wet soft cloth or soft brush to gently wipe off any residue or construction dust left on the product, then rinse with a garden hose.
- Touch up nicks, scrapes, and nail heads using the ColorPlus® Technology touch-up applicator. Touch-up should be used sparingly. If large areas require touch-up, replace the damaged area with new HardiePlank® lap siding with ColorPlus® Technology.
- The laminate sheet must be removed immediately after the installation of each course.
- Terminate non-factory cut edges into trim where possible, and caulk. Color-matched caulks are available from your ColorPlus® product dealer.
- Treat all other non-factory cut edges using the ColorPlus Technology edge coat, available from your ColorPlus product dealer.

Note: James Hardie does not warrant the usage of third-party touch-up or paints used as a touch-up on James Hardie ColorPlus products.

Problems with appearance or performance arising from the use of third party touch-up paints or paints used as touch-ups that is not James Hardie touch-up will not be covered under the James Hardie ColorPlus Limited Finish Warranty.

PAINTING JAMES HARDIE® SIDING AND TRIM PRODUCTS WITH COLOR PLUS® TECHNOLOGY

When repainting ColorPlus products, James Hardie recommends the following regarding surface preparation and topcoat application:

- Ensure the surface is clean, dry, and free of any dust, dirt, or mildew
- Repriming is normally not necessary
- 100% acrylic topcoats are recommended
- DO NOT use stain, oil/alkyd-based paint, or powder coating on James Hardie® Products.
- Apply finish coat in accordance with paint manufacturers written instructions regarding coverage, application methods, and application temperature
- DO NOT caulk nail heads when using ColorPlus products, refer to the ColorPlus touch-up section

COVERAGE CHART/ESTIMATING GUIDE

The number of 12 ft. planks, does not include waste

COVERAGE AREA FEW ER OPENIN GS	HARDIEPLANK® LAP SIDING WIDTH								
	5 1/4 4	6 1/4 5	7 1/4 6	7 1/2 6 1/4	8 6 3/4	8 1/4 7	9 1/4 8	9 1/2 8 1/4	12 10 3/4
1	25	20	17	16	15	14	13	13	9
2	50	40	33	32	30	29	25	25	19
3	75	60	50	48	44	43	38	38	28
4	100	80	67	64	59	57	50	50	37
5	125	100	83	80	74	71	63	63	47
6	150	120	100	96	89	86	75	75	56
7	175	140	117	112	104	100	88	88	65
8	200	160	133	128	119	114	100	100	74
9	225	180	150	144	133	129	113	113	84
10	250	200	167	160	148	143	125	125	93
11	275	220	183	176	163	157	138	138	102
12	300	240	200	192	178	171	150	150	112
13	325	260	217	208	193	186	163	163	121
14	350	280	233	224	207	200	175	175	130
15	375	300	250	240	222	214	188	188	140
16	400	320	267	256	237	229	200	200	149
17	425	340	283	272	252	243	213	213	158
18	450	360	300	288	267	257	225	225	167
19	475	380	317	304	281	271	238	238	177
20	500	400	333	320	296	286	250	250	186

This coverage chart is meant as a guide. Actual usage is subject to variables such as building design. James Hardie does not assume responsibility for over or under-ordering products.

SILICA WARNING

DANGER: May cause cancer if dust from the product is inhaled. Causes damage to the lungs and respiratory system through prolonged or repeated inhalation of dust from the product. Refer to the current product Safety Data Sheet before use.

The hazard associated with fiber cement arises from crystalline silica present in the dust generated by activities such as cutting, machining, drilling, routing, sawing, crushing, or otherwise abrading fiber cement, and when cleaning up, disposing of or moving the dust. When doing any of these activities in a manner that generates dust you must (1) comply with the OSHA standard for silica dust and/or other applicable law, (2) follow James Hardie cutting instructions to reduce or limit the release of dust; (3) warn others in the area to avoid breathing the dust; (4) when using a mechanical saw or high-speed cutting tools, work outdoors and use dust collection equipment; and (5) if no other dust controls are available, wear a dust mask or respirator that meets NIOSH requirements (e.g. N-95 dust mask). During clean-up, use a well-maintained vacuum and filter appropriate for capturing fine (respirable) dust or use wet clean-up methods – never dry sweep.}



WARNING: This product can expose you to chemicals including respirable crystalline silica, which is known to the State of California to cause cancer. For more information go to [P65Warnings.ca.gov](https://www.p65warnings.ca.gov).

RECOGNITION: In accordance with ICC-ES Evaluation Report ESR-2290, HardiePlank® lap siding is recognized as a suitable alternate to that specified in the 2006, 2009, 2012 & 2015 International Residential Code for One and Two-Family

Dwellings, and the 2006, 2009, 2012 & 2015 International Building Code. HardiePlank lap siding is also recognized for application in the following: City of Los Angeles Research Report No. 24862, State of Florida Product Approval FL#13192,

Miami-Dade County Florida NOA No. 17-0406.06, U.S. Dept. of HUD Materials Release 1263f, Texas Department of Insurance Product Evaluation EC-23, City of New York MEA 223-93-M, and California DSA PA-019. These documents should also be consulted for additional information concerning the suitability of this product for specific applications.



SELECT CEDARMILL®|SMOOTH|BEADED CEDARMILL®|BEADED SMOOTH|CUSTOM COLONIAL
SMOOTH®|CUSTOM COLONIAL™ ROUGHSAWN

Visit [jameshardiepros.com](https://www.jameshardiepros.com) for the most recent version.

HS11119 P1/4 12/19

© 2018 James Hardie Building Products, Inc. All rights reserved TM, SM and ®
denote trademarks or registered trademarks of James Hardie Technology Limited.

Product warranties, safety information, and additional installation
information are available at [jameshardiepros.com](https://www.jameshardiepros.com)



JamesHardie™

Documents / Resources



[JamesHardie HardiePlank Lap Siding](#) [pdf] Instruction Manual HardiePlank Lap Siding

References

- [🌐 The HardieZone System | James Hardie Pros](#)
- [🌐 Fiber Cement Products | James Hardie Pros](#)
- [🌐 P65Warnings.ca.gov](#)
- [🌐 House Wrap | HardieWrap Weather Barrier | James Hardie](#)
- [🌐 jameshardie.com](#)
- [🌐 House Siding & Backer Board | James Hardie](#)