



JAMARA 405225 First RC Kit Radlader Instruction Manual

[Home](#) » [JAMARA](#) » JAMARA 405225 First RC Kit Radlader Instruction Manual 

JAMARA 405225 First RC Kit Radlader Instruction Manual



Contents

- [1 Instruction](#)
- [2 Construction](#)
- [3 Documents / Resources](#)
 - [3.1 References](#)
- [4 Related Posts](#)

Instruction

General information

JAMARA e.K. is not liable for any damage caused to the product itself or through this, provided this is due to improper operation or handling errors. The Customer alone bears the full responsibility for the proper use and handling, including without limitation, the assembly, the charging process, the use and choice of the operation area. Please refer to the operating and user instructions, it contains important information and warnings.

Suitable for children over 3 years.



Warning: – Not suitable for children under 36 months.
RISK OF SUFFOCATION!

- Contains small parts which can be swallowed.
Keep away necessarily from children.
- This device is not intended for use by individuals (Including children) with reduced physical sensory, mental abilities
- lack of experience and / or knowledge, unless they are supervised in how the device is to be used.

Read the complete instructions and security instructions carefully before using the model.



Caution! Please fully and carefully read warnings/ safety instructions.
These are for our own security and can avoid accidents/injuries.



Certificate of Conformity

Hereby JAMARA e.K. declares that the products „First RC Kit Radlader, No. 405225“ comply with Directives 2014/53/EU, 2011/65/EU and 2009/48/EC.

The full text of the EU Declaration of Conformity is available at the following Internet address:

www.jamara-shop.com/Conformity

Battery warning

Non-rechargeable batteries are not to be recharged!

Do not open! Do not dispose of in fire! Do not mix old and new batteries!

Do not mix alkaline batteries, standard (carbon-zinc) or rechargeable batteries!

Rechargeable batteries are to be removed from the toy before being charged!

Rechargeable batteries are only to be charged under adult supervision!

The supply terminals are not to be short-circuited!

Components Transmitter:

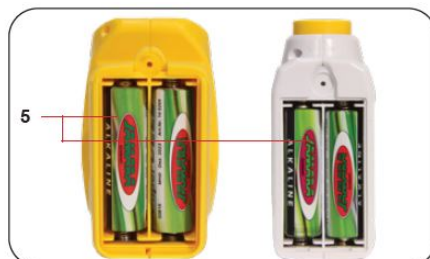

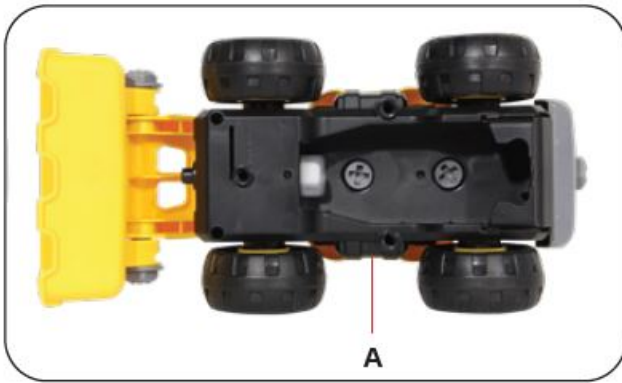

1. Forward
2. Reverse
3. Continuous operation Forward/Reverse | RC switch
4. ON/OFF switch | 2,4GHz
5. Battery compartment

Car:

A Compartment for RC module:

Here the module is used so that the model can be controlled remotely. To do this, the switch on the module (3) must be set to RC and the remote control to (4).



Binding

process

First insert 2x AA batteries into the transmitter and the RC module. Make sure that the polarity is correct. The LED starts flashing. Insert the RC module into the vehicle. Now switch the remote control to 2,4GHz. If the binding is successful, the LED on the module stops flashing. When operating several models, make sure you bind them correctly. Always bind one model after the other.



1. Forward / Reverse

Push the throttle stick forward or backward, the model will drive forward or backward

2. RC module

If you set the switch of the RC module to the far right, it turns permanently to the left. If you set the switch to the second position, it turns permanently to the right.

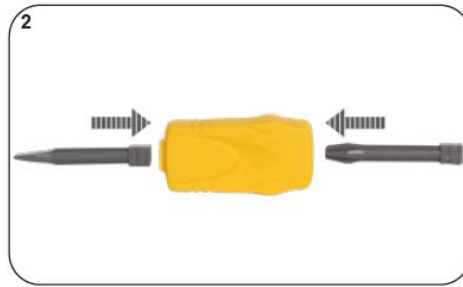

1. **Cordless screwdriver**

To use the cordless screwdriver you must insert the RC module into the remote control and insert a screw attachment.

To use the buttons of the remote control the module and the remote control must be set to 2.4 GHz.

2. **Screwdriver**

To use the screwdriver, insert a screwdriver attachment on the handle. In the handle there is an additional attachment that can be pulled out.

Construction

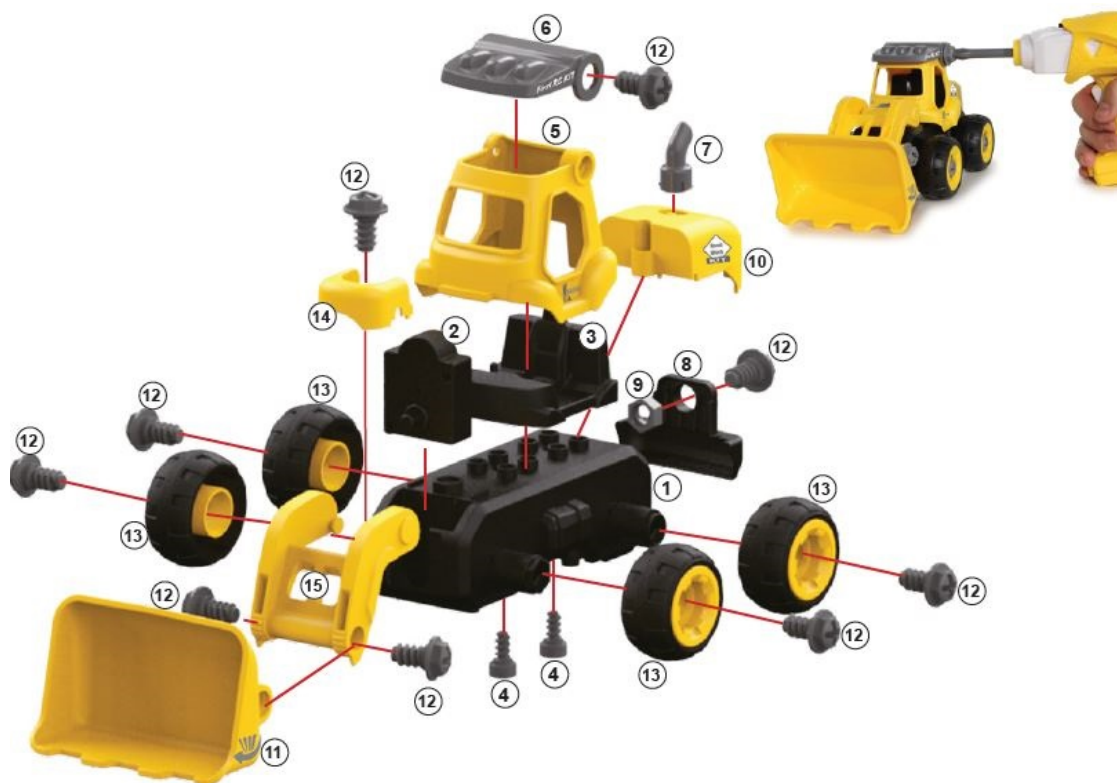

No.		St.	No.		St.	No.		St.
1		1	6		1	11		1
2		1	7		1	12		9
3		1	8		1	13		4
4		2	9		1	14		1
5		1	10		1	15		1

Disposal restrictions



Batteries and accumulators must not be disposed of in domestic waste. You are obliged to dispose of batteries (separate collection) appropriately. After use you can return batteries free of charge to the retail store. As batteries contain substances that can be irritant, can cause allergy and are highly reactive, separate collections and proper recycling is important to the environment and to your health. If the batteries are marked with a chemical symbol Hg, Cd or Pb below the crossed-out waste bin on wheels it refers to that more than 0.0005% of mercury (Hg), more than 0.002% of cadmium (Cd) or more than 0.004% Lead (Pb) is included.

Disposal restrictions



Electrical appliances must not be disposed of in domestic waste and must be disposed of separately. You are obliged to take out the batteries, if possible, and to dispose of the electrical equipment at the communal collection points. Should personal data be stored on the electrical appliance you must remove them by yourself.

Service centre
Reitter Modellbau Versand
Patricia Reitter
Degerfeldstrasse 11
DE-72461 Albstadt
Tel +49 (0) 7432 9802700
Fax +49 (0) 7432 2009594
Mail info@modellbauversand.de
Web www.modellbauversand.de

Mooser T-Trade
Thomas Mooser
Bürgermeister-Koch-Str. 32a
DE-82178 Puchheim
Tel +49 (0) 89 1792 9867
Fax +49 (0) 89 1792 9869
Mail info@mooser-t-trade.de
Web www.mooser-t-trade.de
info@jamara.com
www.jamara.com

Service – Tel. +49 (0) 75 65/94 12-777
service@jamara.com



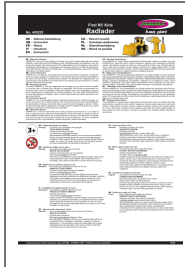

JAMARA LOGO

Documents / Resources



[JAMARA 405225 First RC Kit Radlader](#) [pdf] Instruction Manual
405225 First RC Kit Radlader, 405225, First RC Kit Radlader, RC Kit Radlader, Kit Radlader, Radlader

References

-  Naslovnica - Net.hr
-  t-trade.de is available for purchase - Sedo.com
-  jamara.com
-  [Modellbau Zentral - Peter Hofer - Altdorf UR](#)
-  [Reitter Modellbau & Robotics - Zubehör, Ersatzteile, Bausätze](#)
- [User Manual](#)

[Manuals+.](#) [Privacy Policy](#)

This website is an independent publication and is neither affiliated with nor endorsed by any of the trademark owners. The "Bluetooth®" word mark and logos are registered trademarks owned by Bluetooth SIG, Inc. The "Wi-Fi®" word mark and logos are registered trademarks owned by the Wi-Fi Alliance. Any use of these marks on this website does not imply any affiliation with or endorsement.