



Jada JT24TX99042 Transformers WOW Optimus Transforming RC Instruction Manual

[Home](#) » [Jada](#) » Jada JT24TX99042 Transformers WOW Optimus Transforming RC Instruction Manual 



8 +
Important!
Problems?



For customer support

Please contact us at: cs@jadatoy.com or 1-800-679-5232
Between the hours of 9:00 am to 6:00 pm: Pacific Time: Monday – Friday
WWW.JADATOYS.COM

U.S.A & Canada
30-Day Limited Warranty
Jada Toys Products

Jada Toys, Inc. warrants to the original consumer purchaser that this product will be free of defects in material and workmanship for thirty (30) days from the date of purchase. Jada Toys will repair or replace the product, at our sole discretion, in the event of such a defect within the warranty period.

In the event of a defect covered under this warranty, first, call the phone numbers listed below. Many problems can be solved in this manner. If necessary, you may be asked to return the product for a replacement or refund at the place of purchase (please refer to the retailer's return policy) or you may be instructed to return the product (postage paid and insured by the consumer) to the address below. Include your name, address, telephone number, copy of dated sales receipt, and a brief explanation of the defect. Repair/replacement and return shipping will be free of charge. Please return the defective part or unit, packed securely. This warranty does not cover damage resulting from unauthorized modification, accident, misuse, or abuse. If the product is returned without a dated sales receipt, the product may be excluded from coverage under this warranty.

Jada Toy's liability for defects in material and workmanship under this warranty shall be limited to repair or replacement, at our sole discretion, and in no event shall we be responsible for incidental, consequential, or contingent damages (except in those states that do not allow this exclusion or limitation). This warranty is exclusive and is made in lieu of any express or implied warranty. **Valid only in U.S.A. and Canada.** This warranty gives you specific legal rights and you may have other rights, which may vary from state to state. Some states do not allow the exclusion of incidental or consequential damages, so the above exclusions or limitations may not apply to you.

TOLL-FREE NUMBER: 1-800-679-JADA (5232)

(valid only in the U.S.A. and Canada)

Hours: 9:00 A.M. – 6:00 P.M. Pacific Time; Monday – Friday.

Expect some delay in January following the holiday season.

Please be patient and keep trying the toll-free number.

Address for Returns:

Consumer Relations, Jada Toys, Inc.

938 Hatcher Ave.

City of Industry, CA 91748, USA

Industry Canada Warning:

This device contains license-exempt transmitter(s)/receiver(s) that comply with Innovation, Science and Economic Development Canada's license-exempt RSS(s).

Operation is subject to the following two conditions: 1. This device may not cause interference. 2. This device must accept any interference, including interference that may cause undesired operation of the device.

Under Industry Canada regulations, this radio transmitter may only operate using an antenna of a type and maximum (or lesser) gain approved for the transmitter by Industry Canada. To reduce potential radio interference to other users, the antenna type and its gain should be so chosen that the equivalent isotropically radiated power (e.i.r.p.) is not more than that necessary for successful communication.

FCC WARNING:

This device complies with part 15 of the FCC Rules. Operation is subject to the following two conditions:

- (1) This device may not cause harmful interference, and
- (2) this device must accept any interference received, including interference that may cause undesired operation.

Warning: Any changes or modifications not expressly approved by the party responsible for compliance could void the user's authority to operate this equipment.

NOTE: This equipment has been tested and found to comply with the limits for a Class B digital device, pursuant to Part 15 of the FCC Rules. These limits are designed to provide reasonable protection against harmful interference in a residential installation. This equipment generates, uses, and can radiate radio frequency energy and, if not installed and used in accordance with the instructions, may cause harmful interference to radio communications. However, there is no guarantee that interference will not occur in a particular installation. If this equipment does cause harmful interference to radio or television reception, which can be determined by turning the equipment off and on, the user is encouraged to try to correct the interference by one or more of the following measures:

- Reorient or relocate the receiving antenna.
- Increase the separation between the equipment and receiver.
- Connect the equipment into an outlet on a circuit different from that to which the receiver is connected.
- Consult an experienced radio/TV technician for help.

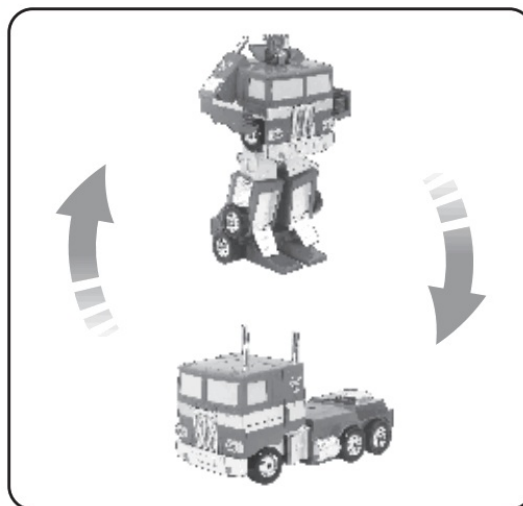
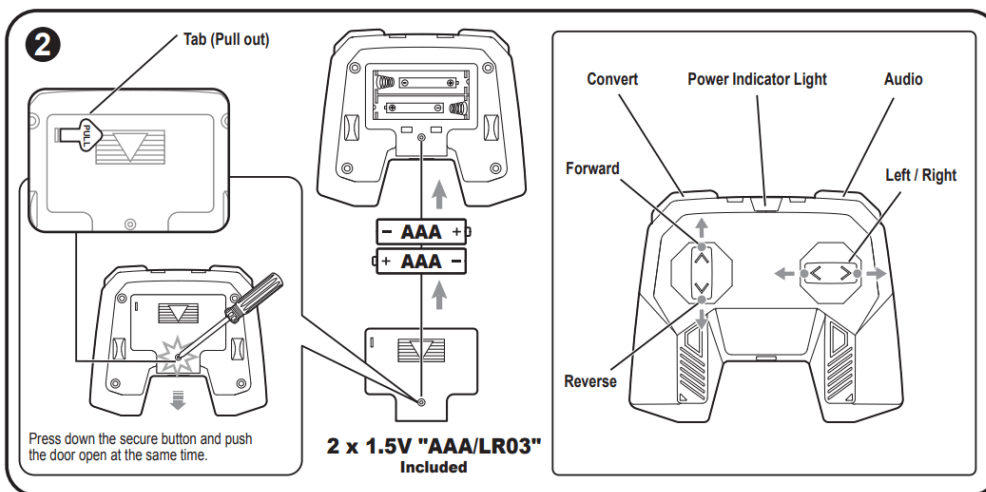
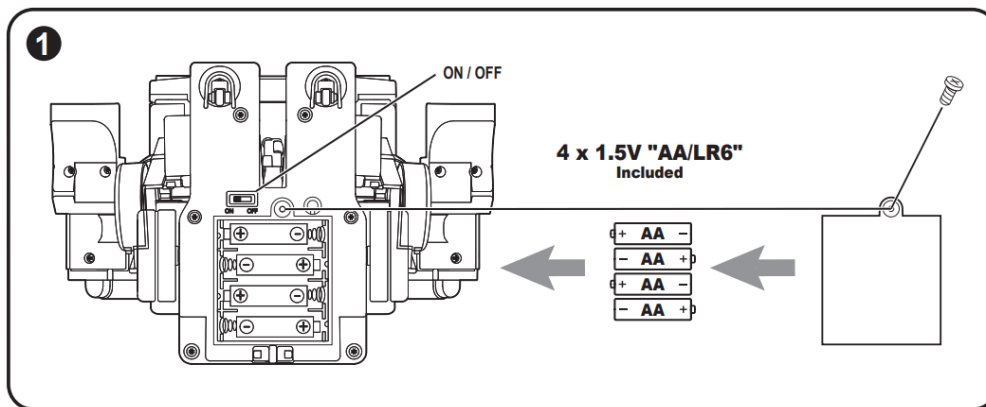

Contents

- 1 HOW TO PLAY:
- 2 CONTENTS:
- 3 SAFETY TIPS:
- 4 INSTALLING BATTERIES IN THE VEHICLE (See Diagram 1)
- 5 INSTALLING BATTERIES INTO CONTROLLER (See Diagram 2)
- 6 BATTERY SAFETY INFORMATION
- 7 QUICK TIPS
- 8 CLEANING INSTRUCTION
- 9 TROUBLESHOOTING
- 10 Documents / Resources
- 11 Related Posts

HOW TO PLAY:

1. Turn the vehicle ON, then press any button on the transmitter controller within 15 seconds for pairing.
2. The LED will blink for pairing.
3. Once the pairing is successful, the LED on the controller will stop blinking and stay on.
4. If pairing is unsuccessful, turn the vehicle OFF and reinstall the battery in the controller to try again.
 - * If your controller LED is blinking or losing brightness, please replace the battery.
 - * When playing with multiple vehicles, only pair one controller to one vehicle at a time in order to avoid interference.

THE INSTRUCTIONS SHEET MUST BE RETAINED SINCE IT CONTAINS IMPORTANT INFORMATION.

These operating, installation and safety instructions are integral parts of the product.

IMPORTANT:

Please read all “CONSUMER INFORMATION” before operating this toy vehicle.

ADULT SUPERVISION IS REQUIRED.

Note to Adults: to ensure that the child's play is both safe and fun, please review all operating instructions and safety tips in the CONSUMER INFORMATION section with your child.

— CONSUMER INFORMATION —

CONTENTS:

- 1 x Vehicle
- 1 x Transmitter Controller

SAFETY TIPS:

- Toy surfaces may become hot and cause burns if the electronics get wet. DO NOT OPERATE this vehicle near/in/through water, snow, sand, grass or any wet or muddy surfaces.
- Never play this vehicle on the streets! The streets are for real cars!
- Do not pick up the vehicle while in motion.
- Always place the car gently on the floor by hand. Never throw the car onto the floor.

- Avoid collisions with walls, any hard objects, or human/animal bodies.
- Keep fingers, hair, and loose clothing away from tires and wheel hubs.
- To avoid accidental operation, remove all batteries from the controller when not in use.
- Do not connect this toy with other power supplies.
- Do not insert any wire into electrical outlets.
- Be sure to rest your vehicle for at least 5 minutes after every 15 minutes of operations.
- Stay clear of obstructions and hazards to avoid injury and damage.

THIS VEHICLE IS DESIGNED TO WORK WITH 4 (FOUR) STANDARD “AA” ALKALINE BATTERIES. THE CONTROLLER IS DESIGNED TO WORK WITH 2 (TWO) STANDARD “AAA” BATTERIES.

INSTALLING BATTERIES IN THE VEHICLE (See Diagram 1)

Requires 4 (four) “AA” alkaline batteries.

1. Push the ON/OFF switch to the “OFF” position underneath the vehicle.
2. Using a screwdriver (Not included), remove the battery compartment door.
3. Remove and properly dispose of the used batteries (if any).
4. Insert the 4 “AA” batteries, with polarity (+/-) as shown inside the battery compartment.
5. Replace the battery compartment door and use a screwdriver to lock the compartment door.

INSTALLING BATTERIES INTO CONTROLLER (See Diagram 2)

Requires 2 (two) “AAA” batteries.

1. Press the lock button-down with a screwdriver and slide the door open.
2. Remove and properly dispose of the used batteries (if any).
3. Insert the 2 “AAA” batteries, with polarity (+/-) as shown inside the battery compartment.
4. Replace the battery compartment door.

BATTERY SAFETY INFORMATION

- It is recommended to use only Alkaline type batteries.
- Do not mix alkaline, standard (carbon-zinc), or rechargeable batteries.
- Remove batteries if the vehicle will not be used for a long period of time to prevent possible battery leakage.
- Dispose of batteries safely. Do not dispose of batteries (or products containing non-replaceable batteries) in fire, as batteries may explode or leak.
- Rechargeable batteries are to be removed from the toy before being charged.
- Rechargeable batteries are to be charged by adults only.
- Non-rechargeable batteries are not to be recharged.
- Different types of batteries or new and used batteries are not to be mixed.
- Batteries are to be inserted with the correct polarity.
- Exhausted batteries are to be removed from the toy.
- The supply terminals are not to be short-circuited.

QUICK TIPS

- When your vehicle starts to lose power, it may lose function or performance. It's time for fresh batteries. Your vehicle's running time may change depending on your driving style.
- Radio interference can make your vehicle run abnormally. Interference can be caused by other R/C vehicles running on the same frequency; electrical wires, large buildings; or CB radios. Try to stay away from these!
- Don't store your vehicle near heat or in direct sunlight. Always turn switches OFF and remove all batteries for storage.
- If the vehicle resets automatically, that means the batteries are weak and need to be changed.
- Performs best on a flat, smooth floor or surface.

CLEANING INSTRUCTION

To clean, wipe excess dirt from the toy. Remove batteries first. Wipe toy clean with a damp cloth. Wipe dry. **DO NOT IMMERSE IN WATER and DO NOT CLEAN VEHICLE WITH ANY CHEMICALS.** Let the toy completely dry before putting batteries back into a clean, dry battery compartment.

INSTRUCTION FOR DISPOSAL OF WASTE

- Your batteries and electronic toys should be recycled or disposed of per your local waste management guidelines.
- Contact your local waste management officials for information regarding the environmentally sound recycling and disposal of batteries and electronic toys.

WARNING: This toy produces flashes that may trigger epilepsy in sensitized individuals.

TROUBLESHOOTING

PROBLEM	SOLUTION
The vehicle will not START	<ol style="list-style-type: none"> 1. Power switch is off. Make sure to turn it on. 2. Batteries are installed with incorrect polarities. Check the + and – markings to make sure the batteries are properly aligned. 3. Batteries are drained. Charge batteries and/or install new batteries.
The vehicle does not respond to controls.	<ol style="list-style-type: none"> 1. Transmitter controller battery is drained. Replace the controller battery. 2. Vehicle is out of range. Bring the controller closer to the vehicle. 3. Interference from surrounding electrical machinery. Bring to a wide-open space.
The vehicle does not move	<ol style="list-style-type: none"> 1. Stop operation, switch off the power, and rest your vehicle for a few minutes. 2. Check the position of the batteries in the vehicle, they may have been knocked loose during play.
The vehicle does not respond properly	The major reason is out of range. Bring the controller closer to the vehicle. If the problem still happens, remove the controller batteries and replace them with new batteries and restart (ON/OFF) the vehicle.
The transmitter controller does not work	The controller light is off, its battery is drained. Replace the controller battery.



We reserve the right to improve or amend product specifications. Colors may vary.
Jada oval mark is a registered trademark of Jada Toys, Inc.

Licensed By:

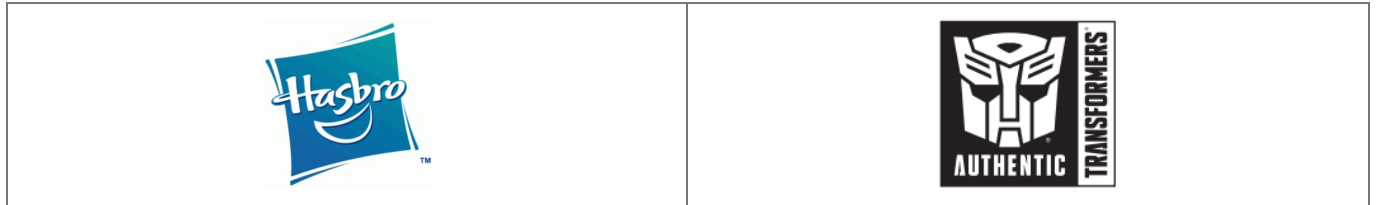

HASBRO and its logo, TRANSFORMERS, and all related characters are trademarks of Hasbro and are used with permission.

© 2022 Hasbro. All Rights Reserved.

© 2022 Paramount Pictures Corporation. All Rights Reserved.

©2022 JADA TOYS, INC. CITY OF INDUSTRY, CA 91748, USA

The product uses 2.4GHz remote control technology.

MADE IN CHINA

F33521-0000-ISH-EN01A P2/2

Documents / Resources

