



## j5create JVAW62 Wireless Display Transmitter User Guide

[Home](#) » [j5Create](#) » j5create JVAW62 Wireless Display Transmitter User Guide 

### Contents

- [1 j5create JVAW62 Wireless Display Transmitter](#)
- [2 How to mirror](#)
- [3 How to pair JVAW62 TX with receiver](#)
- [4 FCC](#)
- [5 Documents / Resources](#)
- [6 Related Posts](#)



### j5create JVAW62 Wireless Display Transmitter



### How to mirror

## Simply plug into laptop or mobile

Plug JVAW62 TX to Type C port on laptop or mobile. Wait a few seconds until the flashing light on JVAW62 TX stops, and it will start mirroring automatically. Please make sure to install and pair to JVAW62 wireless display receiver if flashing over 20 seconds.

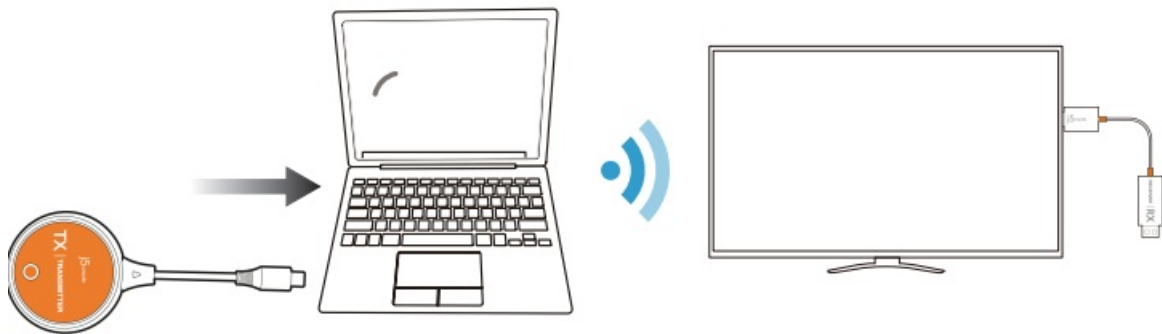

## Stop and restart mirroring

Press the JVAW62 TX button to stop mirroring or restart mirroring.



**Note:** JVAW62 TX support mirroring for all laptops including Windows and MacOS, and Android mobiles supporting DP output.

## How to pair JVAW62 TX with receiver

### Turn on pairing mode for receiver

Press the reset button (or insert the pin to press) for 2 seconds on JVAW62 wireless display receiver. Release the button when the screen shows “Release the button to pair with ScreenCast”. Please make sure your receiver has been upgraded to the latest version.

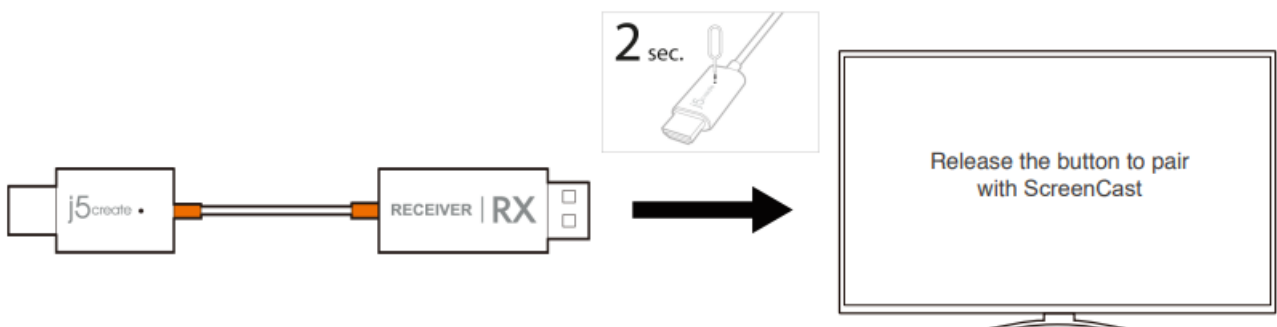

## Press the JVAW62 TX button

Plug JVAW62 TX on a laptop or mobile to provide power. Press the JVAW62 TX button to complete pairing while the screen shows "Ready to pair".



**Note:** There are 3 mode for reset button on receiver, depending on pressing duration.

1. Simple click: Switch the receiver to 2.4G/ 5G Hz Wi-Fi mode.
2. Press for 2 seconds: Turn on pairing mode for JVAW62 TX.
3. Press for 10 seconds: Reset the receiver to default.

## FCC

This device complies with part 15 of the FCC Rules. Operation is subject to the following two conditions: (1) This device may not cause harmful interference, and (2) this device must accept any interference received, including interference that may cause undesired operation.

Note: This equipment has been tested and found to comply with the limits for a Class B digital device, pursuant to part 15 of the FCC Rules. These limits are designed to provide reasonable protection against harmful interference in a residential installation. This equipment generates, uses and can radiate radio frequency energy and, if not installed and used in accordance with the instructions, may cause harmful interference to radio communications. However, there is no guarantee that interference will not occur in a particular installation. If this equipment does cause harmful interference to radio or television reception, which can be determined by turning the equipment off and on, the user is encouraged to try to correct the interference by one or more of the following measures:

- Reorient or relocate the receiving antenna.
- Increase the separation between the equipment and receiver.
- Connect the equipment into an outlet on a circuit different from that to which the receiver is connected.
- Consult the dealer or an experienced radio/TV technician for help.

Caution: Any Changes or modifications not expressly approved by the party responsible for compliance could void the user's authority to operate the equipment.

This equipment complies with FCC radiation exposure limits set forth for an uncontrolled environment. This equipment should be installed and operated with minimum distance 20cm between the radiator & your body.

## FCC

This device complies with Part 15 of the FCC rules. Operation is subject to the following two conditions

## Documents / Resources

JVAW62 Wireless Display  
Transmitter Quick Start  
Guide  
Rev. 1.0



[j5create JVAW62 Wireless Display Transmitter](#) [pdf] User Guide  
JVAW62, 2AD37JVAW62, JVAW62, Wireless Display Transmitter