



J-TECH DIGITAL JTD-677 4K HDMI 100M KVM Extender User Manual

[Home](#) » [J-TECH DIGITAL](#) » J-TECH DIGITAL JTD-677 4K HDMI 100M KVM Extender User Manual 

Contents

- [1 J-TECH DIGITAL JTD-677 4K HDMI 100M KVM Extender](#)
- [2 Introduction](#)
- [3 Features](#)
- [4 Specifications](#)
- [5 Operation controls and Functions](#)
- [6 Connecting and Operating](#)
- [7 Packing list](#)
- [8 Connection diagram](#)
- [9 Documents / Resources](#)
- [10 Related Posts](#)



J-TECH DIGITAL JTD-677 4K HDMI 100M KVM Extender



Thank you for purchasing this product. For optimum performance and safety, please read these instructions carefully before connecting, operating or adjusting this product. Please keep this manual for future reference.

Introduction

The 4K HDMI KVM Extender—Extend USB Keyboard, Mouse, and HDMI video signals up to 328ft (100m) over CAT6/6a/7 cable, and you can display on 3 compatible monitors meanwhile. And you can use 2 USB ports on the Receiver (RX) to control your PC at a remote location.

Features

1. Support HDMI1.4 and HDCP1.4.
2. Supports uncompressed data transmission at 4K @30Hz with near zero latency.
3. Supports PCM, LPCM, Dolby, DTS audio formats
4. Supports 3.5MM audio output on TX & RX.
5. Equipped with an HDMI Loop-out on the TX for a local display, and 2 HDMI output on the RX.
6. Equipped with 2 USB ports on the Receiver (RX) to control your PC at a remote location with a USB keyboard and mouse.
7. Supports IR control

Specifications

Bandwidth	10.2 Gbps
Input	TX:1* HDMI,1* PC, RX:1* HDMI,1* RJ45,1*IR
Output	TX:1* RJ45,1*3.5mm(audio out),1*HDMI(Loop out),1*IR RX:2* HDMI,1*USB Type A,1*USB Type B,1*3.5mm(audio out)
Max resolution	4k@30Hz
Transmission range	328ft (100m) over CAT6
Audio support	PCM, LPCM, Dolby, DTS
Power Supply	DC 5 V 2 A
ESD Protection Human Body Model:	± 8kV (air-gap discharge) ± 4kV (contact discharge)
Operating Temperature	0°C ~ 40°C / 32°F ~ 104°F
Storage Temperature	-20°C ~ 60°C / -4°F ~ 140°F
Relative Humidity	20 ~ 90% RH (Non-condensing)
Power Consumption (Max)	20W
Housing	Aluminum alloy
Dimension (L x W x H)	130x100x22(mm)
Weight	TX:260(g) RX:250(g)

Operation controls and Functions

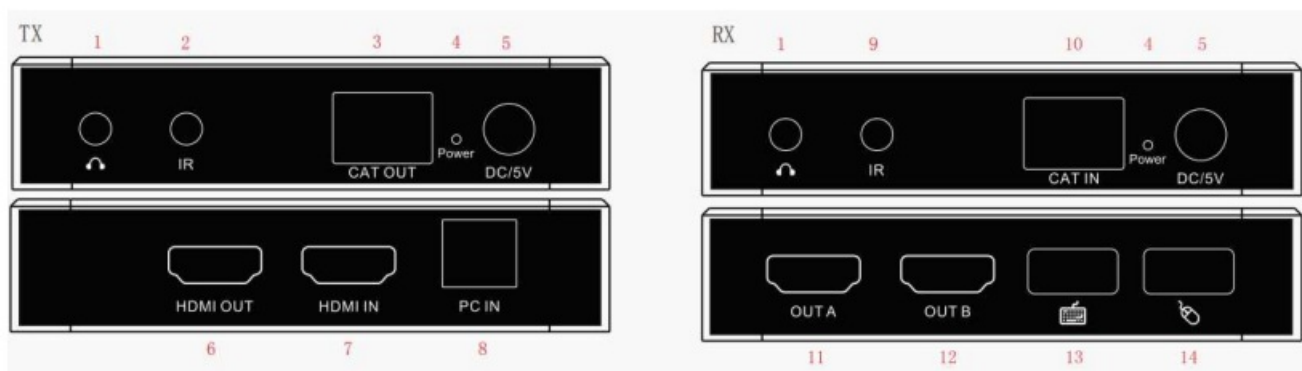

1. 3.5 Audio output
2. IR output
3. RJ 45 output for cat6
4. power indicator
5. 5V2A power input
6. Local HDMI output
7. HDMI input
8. USB input from PC
9. IR input
10. RJ 45 input for cat6
11. HDMI Output A
12. HDMI Output B
13. USB for keyboard input
14. USB for mouse input

Connecting and Operating

1. Connect one HDMI cable between source device and TX Extender, and another one HDMI cable between display device and RX Extender.
2. Connect single cat-6 cables between TX and RX Extender, the max cable distance is 100 meters.
3. Connect 5V/2A power supply to the TX and RX.
4. Plug the mouse and keyboard into the port of the receiver, and connect the port of the transmitter with the computer if you need the KVM control function.
5. Plug the 3.5mm audio ports when you want to use earphones.
6. LED indicator light: Turn it on, the power light is red; when there is a signal input, the yellow light in the RJ45 flashing.

Packing list

- HDMI KVM CAT6 Extender (TX & RX units)
- IR cables(Transmitter & Receiver)
- 2x Power adapter(5V/2A)
- 1x Operation Manual
- 1x USB cable

Connection diagram



Documents / Resources

 <p>J-TECH DIGITAL JTD-677 4K HDMI 100M KVM Extender User Manual</p> <p>1. Introduction 2. Features 3. Installation 4. Operation 5. Troubleshooting 6. Appendix 7. Index</p>	<p>J-TECH DIGITAL JTD-677 4K HDMI 100M KVM Extender [pdf] User Manual JTD-677, 4K HDMI 100M KVM Extender, JTD-677 4K HDMI 100M KVM Extender, KVM Extender, Extender</p>
--	--