



J-TECH DIGITAL JTD-2867 Wireless HDMI Dongle Extender User Manual

[Home](#) » [J-TECH DIGITAL](#) » J-TECH DIGITAL JTD-2867 Wireless HDMI Dongle Extender User Manual 

Contents

- [1 J-TECH DIGITAL JTD-2867 Wireless HDMI Dongle Extender](#)
- [2 Connection Diagram](#)
- [3 Hardware Casting](#)
- [4 Pairing Instructions](#)
- [5 Function Settings](#)
- [6 Software Casting](#)
- [7 Troubleshooting](#)
- [8 Warranty](#)
- [9 Documents / Resources](#)
- [10 Related Posts](#)



J-TECH DIGITAL JTD-2867 Wireless HDMI Dongle Extender



Preface

Thank you for purchasing the J-Tech Digital JTECH-WDEX-50M2 wireless HDMI extender set. For optimum operation, please read this manual carefully before use.

Connection Diagram

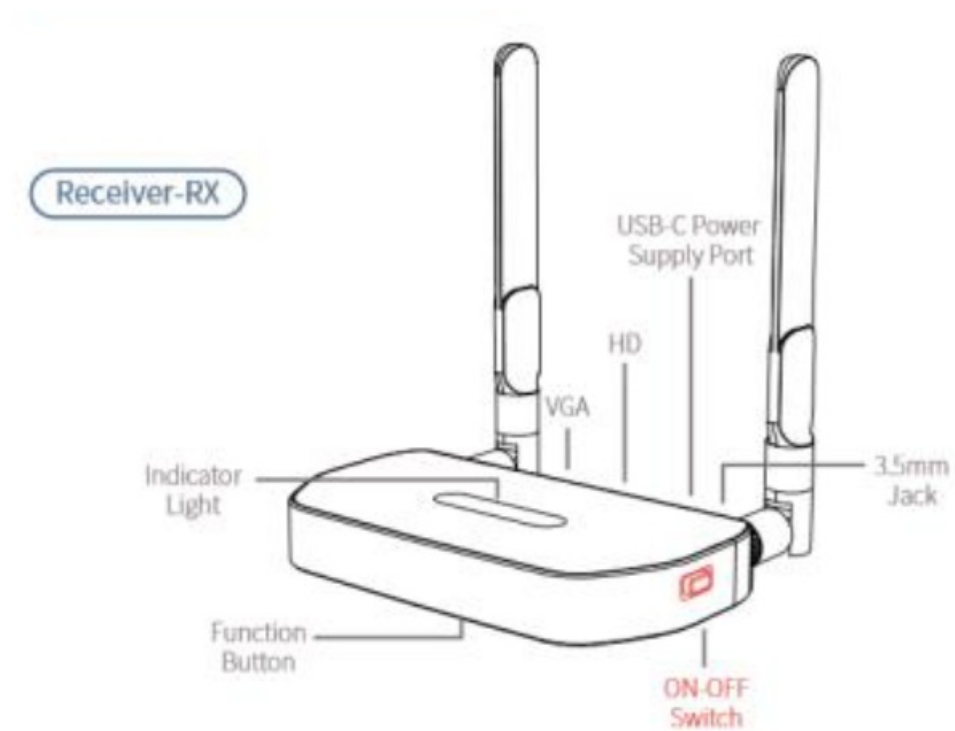



Hardware Casting

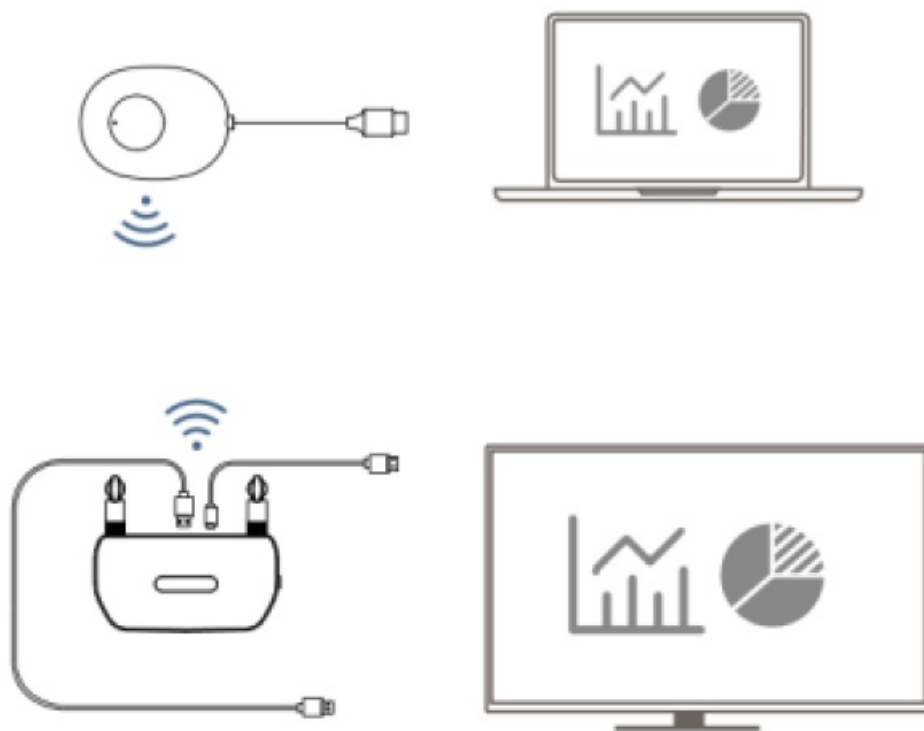

1. Connect the HDMI port or VGA port of the receiver to the video input port of the display device (monitor or TV).
2. Connect the USB-C power supply port of the receiver to the charging cable and plug it into the power adapter (5V 2A). Turn on the receiver power switch.
3. Adjust the HD signal source of the monitor or TV to the corresponding HD port until the boot screen of the receiver is displayed.
4. Connect the transmitter to your HDMI source device. After the indicator light begins flashing quickly, wait 10 seconds to complete casting.

Note Please ensure that power from your HDMI source device is sufficient. If the power from your HDMI source device is unable to supply power, please connect the transmitter to a USB-C power adapter

Pairing Instructions

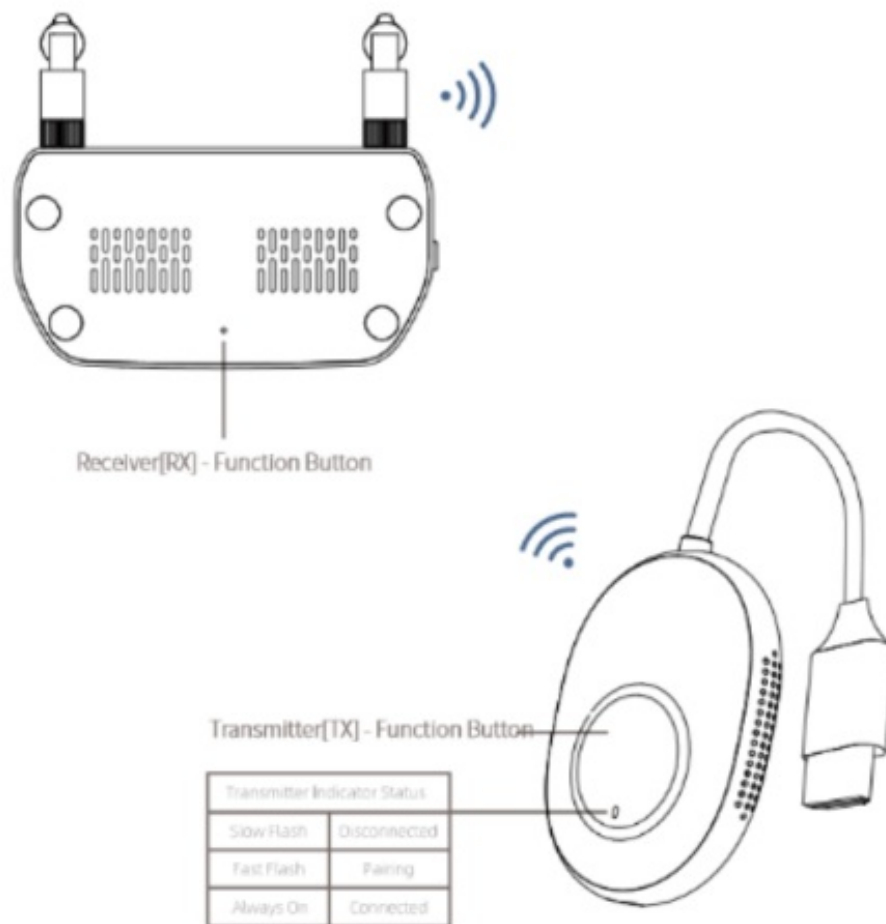

The product has been paired out of the factory. In case of pairing failure due to improper operation or other circumstances during use, it is necessary to restore and repair the device as follows:

1. Please press and hold the receiver function button for 3 seconds and the prompt will show up on the on-screen display. Release the button to pair with the transmitter. Wait for the transmitter to enter pairing mode.
2. Press and hold the transmitter function button for 3 seconds. The indicator will flash to signify pairing has begun. When the indicator light is solid, pairing is successful.

Note One receiver can pair with up to 8 transmitters

Function Settings

1. Search for a receiver in Wireless Network Settings (SSID is JTECH-XXXX | Default password is 12345678)
2. Open the mobile device web browser and enter 192.168.203.1 in the address bar
3. After entering the web gui, you can operate the distribution network, resolution, firmware upgrade and device restart functions

Software Casting

When the receiver is used without a transmitter, it must work with the source device's operating system.

Connect to the receiver's network via step 1 in Function Settings

Apple iOS System- Operation Steps

Slide the screen to enter the Apple Device Control Center

Click Airplay and select the "JTECH-XxXX*" device

Android System- Operation Steps

1. Turn on the screencasting function of the mobile device
2. Search and connect to the "JTECH-XXXX" device Different brands screen casting function path reference:

Different brands screen casting function path reference:

- SAMSUNG: Phone from top to bottom> Smart View
- Lenovo: Setting Display> Wireless Display
- OPPO: Settings > Other Connection Methods > Smart Screen
- VIVO: Settings > Other Connection Methods > Smart Screen
- Xiaomi: Settings> Connect and Share > Cast Screen
- HUAWEI: Settings> Smart Assist > Multi-screen Interactive

Troubleshooting

• Q: How do you restore factory default settings?

A: If the product fails, press and hold the receiver function button for 10 seconds. After the display goes dark and the receiver restarts, factory settings will be restored.

• Q: Can devices with HD interfaces be used?

A: Yes, please use the source device with an HD interface converter.

• Q: How do you enter privacy mode?

A: Tap the transmitter function button to disconnect or reconnect.

Warranty

If your product does not work properly because of a defect in materials or workmanship, J-Tech Digital (referred to as "the warrantor") will, for the length of the period indicated as below (Parts (1) Year) which starts with the date of original purchase ("Limited Warranty Period"), at its option either (a) repair your product with new or refurbished parts, or (b) replace it with a new or refurbished product. The decision to repair or replace will be made by the warrantor. During the "Parts" warranty period, there will be no charge for parts. You must mail in your product during the warranty period. This Limited Warranty is extended only to the original purchaser and only covers products purchased as new. A purchase receipt or other proof of original purchase date is required for Limited Warranty service.

Extended Warranty

With the registration of supported J-Tech Digital products, you extend the current warranty by six months. This extension is added to the warranty that starts at the purchase date of the device supported. Total product warranty with the extended period will equate to a total of 18 months of warranty from the date of purchase.

For extended warranties to be accepted, all warranty extensions must be claimed within 30 days of purchasing the eligible J-Tech Digital product. Extensions attempted to be claimed outside of the 30-day window will not be accepted.

Visit www.jtechdigital.com to register your extended warranty.

Documents / Resources

	<p>J-TECH DIGITAL JTD-2867 Wireless HDMI Dongle Extender [pdf] User Manual JTD-2867, JTECH-WDEX-50M2, Wireless HDMI Dongle Extender</p>
---	--