



J BURROWS Elite MS400 Verticle Wireless Mouse Instruction Manual

[Home](#) » [J.burrows](#) » J BURROWS Elite MS400 Verticle Wireless Mouse Instruction Manual 

J BURROWS Elite MS400 Verticle Wireless Mouse Instruction Manual



Contents

- [1 Contents](#)
- [2 Functions](#)
- [3 Installation Guide](#)
- [4 BT Bluetooth Operation](#)
- [5 Bluetooth Pairing](#)
- [6 Specifications](#)
- [7 Product Warranty-valid for Australian customers only](#)
- [8 Documents / Resources](#)
- [9 Related Posts](#)

Contents

1. Mouse



2. USB-A receiver

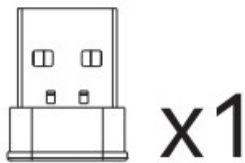

3. Charging cable

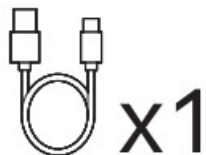

4. Instruction manual



5. Quick start guide



Functions

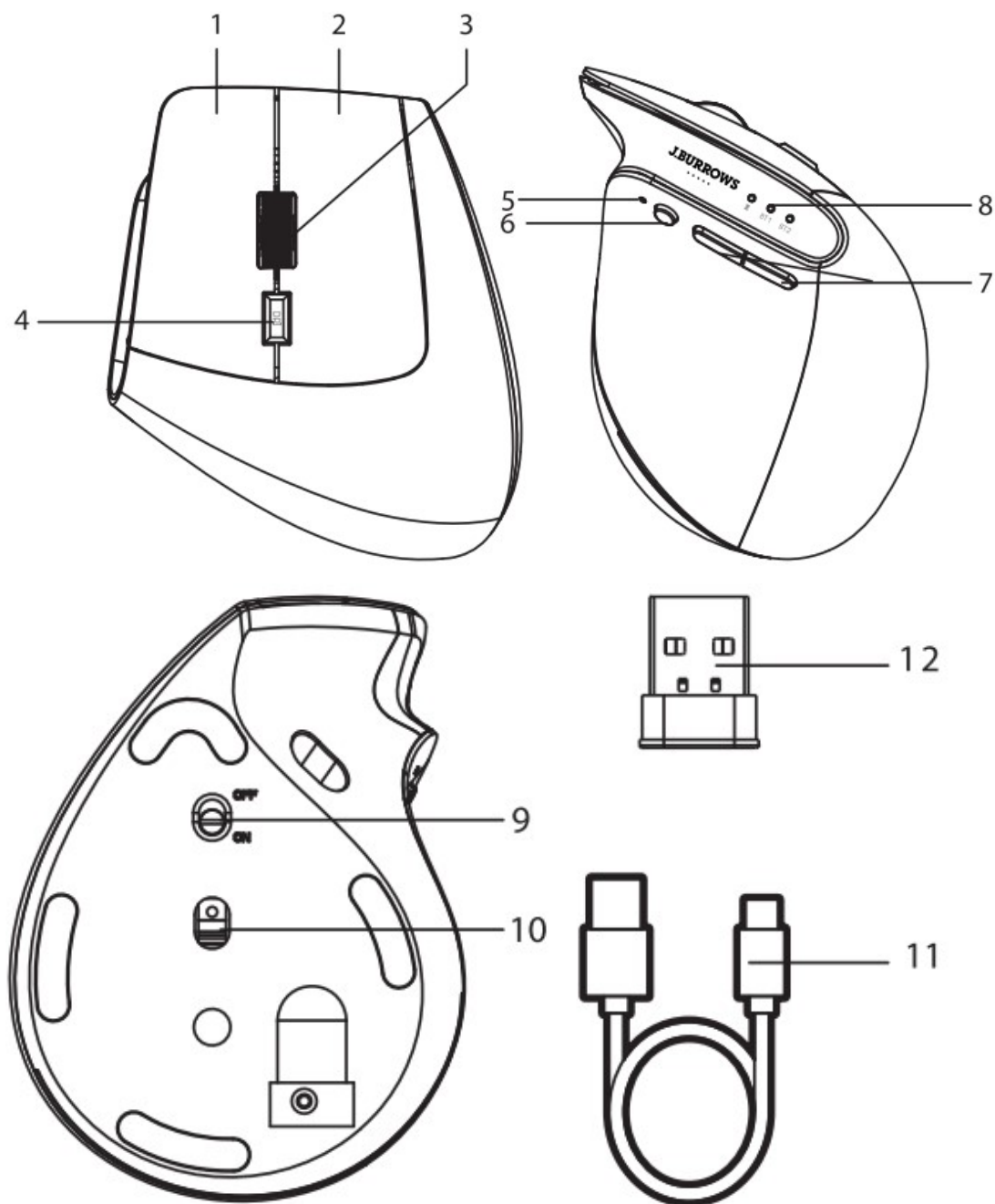

1. Left button
2. Right button
3. Scroll wheel
4. DPI button
5. DPI/Low power indicator light
6. Mode button
7. Forward / Backward
8. Mode indicator light
9. On / Off switch
10. Optical sensor
11. Charging cable
12. USB-A receiver

Installation Guide



Retrieve USB receiver from magnetic position.

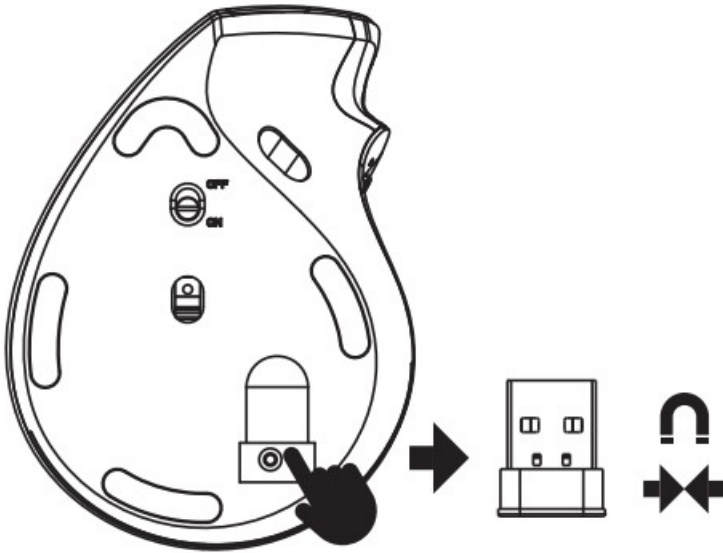

Turn on the power switch.

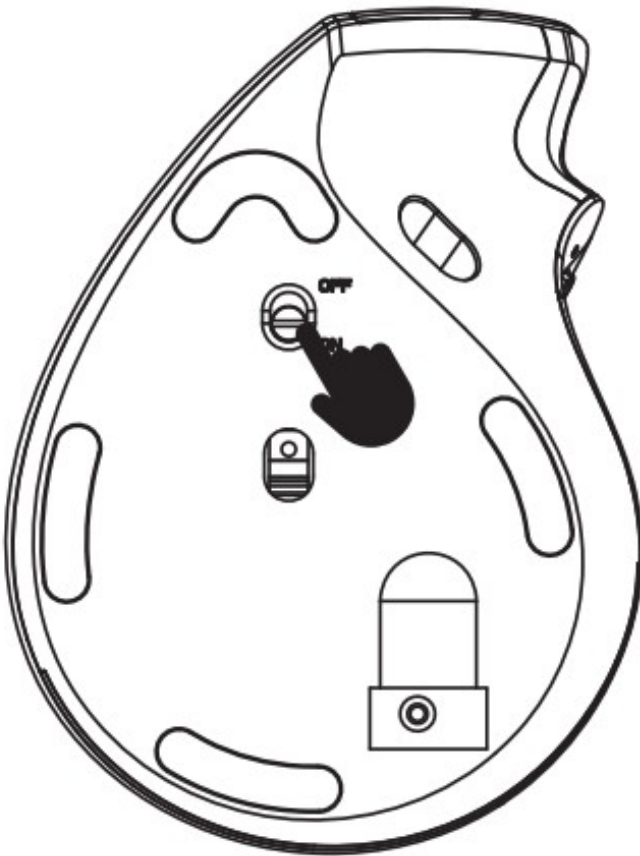

Plug the USB receiver into the computer USB port.

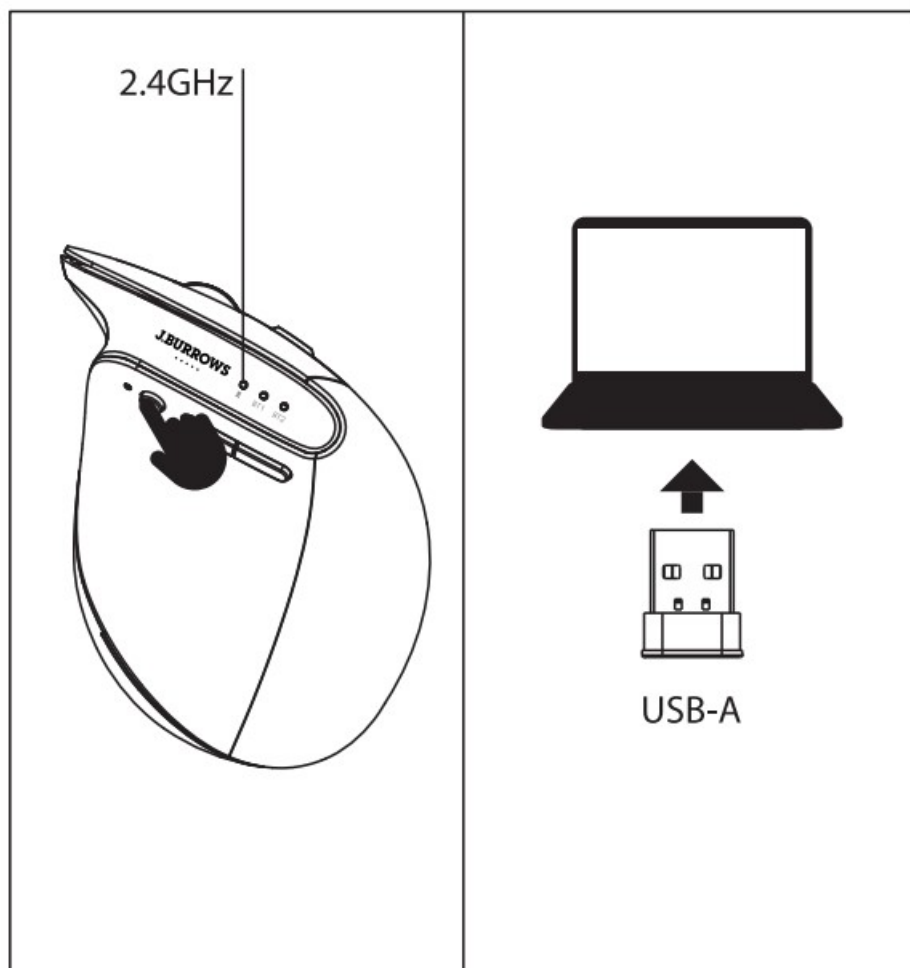

DPI Press DPI button to modify the DPI/ mouse sensitivity.

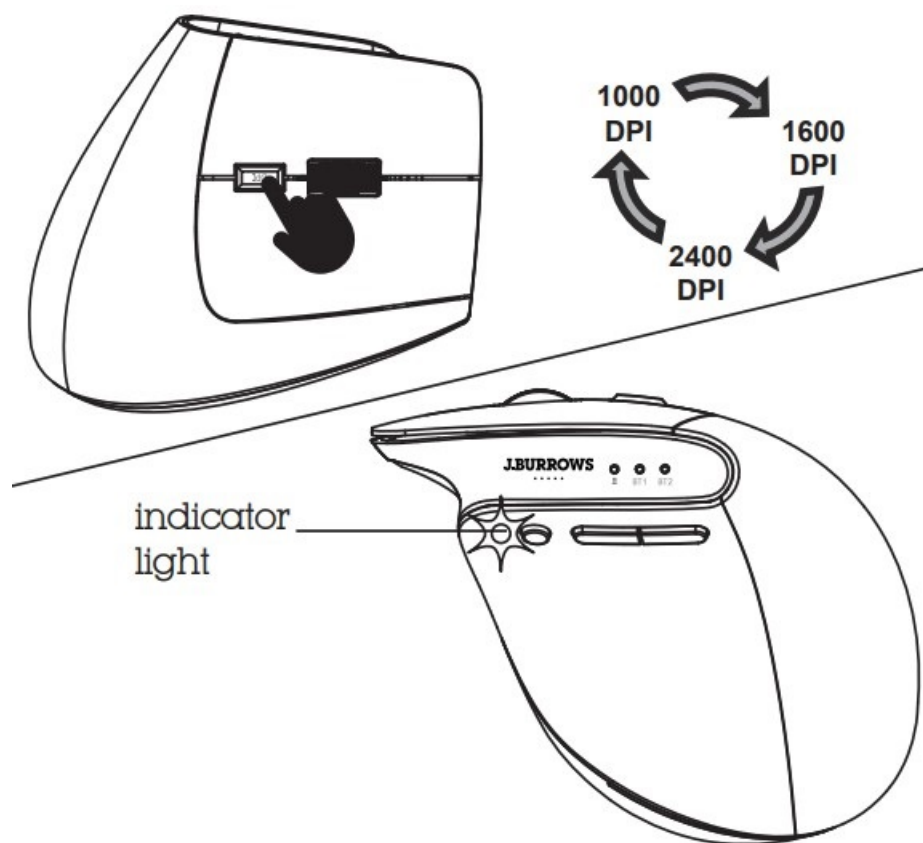

The red LED indicator light will flash once for 1000 DPI, twice for 1600 DPI and 3 times for 2400 DPI.

BT Bluetooth

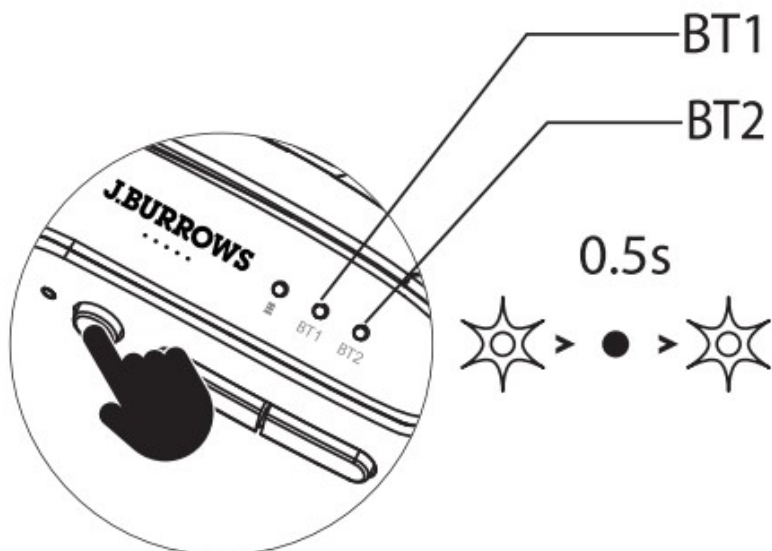

Operation

1. Connect a 2.4 GHz device. Drivers will automatically install. Once completed the mouse is ready to use. Ensure the left white selection light on the top of the mouse is flashing.

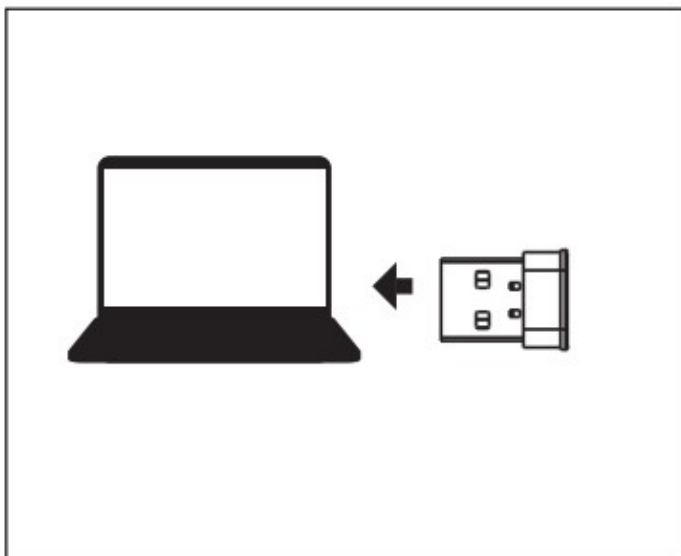

2. Connect the first Bluetooth device Press the mode button and select BT1 (white light in the middle on the top of the mouse). The white light will flash once. Then hold the round button for more than three seconds until the white light flashes quickly. It is now in Bluetooth pairing mode.

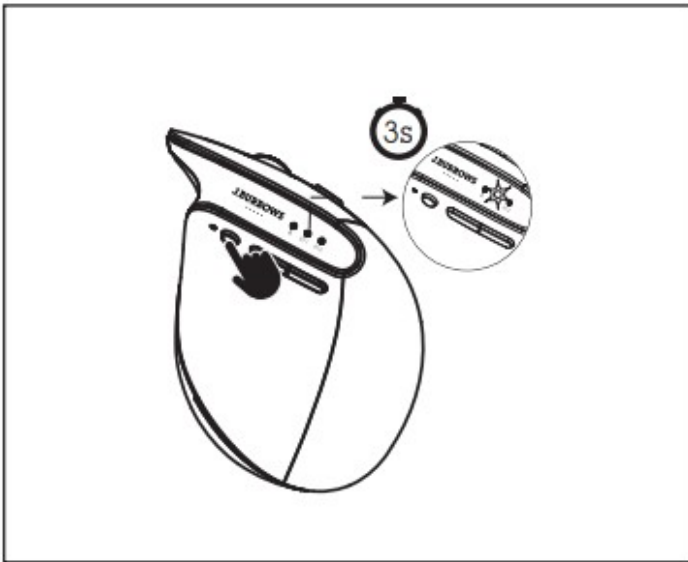

3. Connect the second Bluetooth device Press the mode button and select BT2 (white light in the right on the top of the mouse). The white light will flash once. Then hold the mode button for more than three seconds until the white light flashes quickly. It is now in Bluetooth pairing mode.

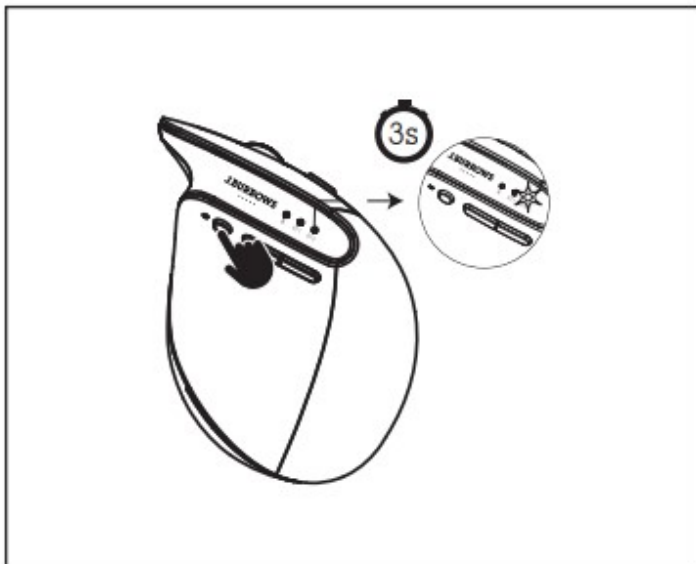

Bluetooth Pairing

Press round button and select BT1 or BT2. When selected the white indicator light will be on. Hold mode button for 3 seconds until the white indicator light flashes. Find and pair **Elite MS400** on Bluetooth device list on your computer.



Indicator Light

Red LED light will flash when power is low. Blue LED light will be on when charging. LED light will be off when fully charged. Full charging time is approximately 4 hours.

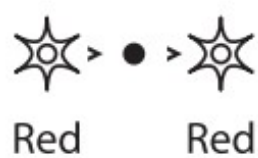
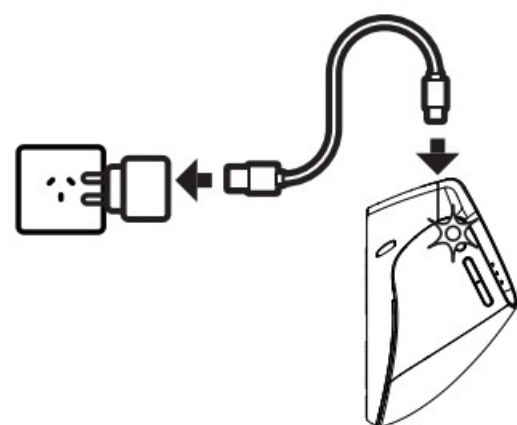
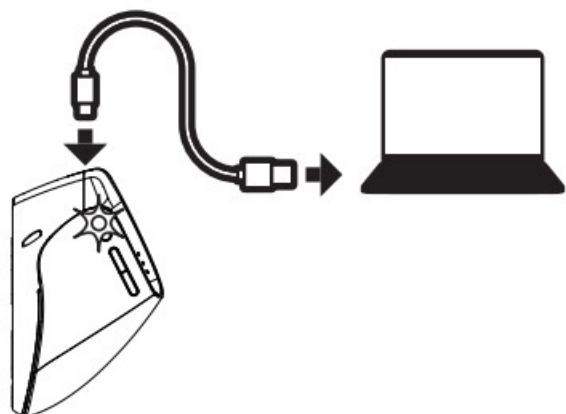

Red

Red



Blue



OFF

Note

Fully charge your Elite MS400 before first use. Before charging, make sure the wireless mouse is turned off.

Specifications

- Product Model: Elite MS400
- Officeworks Product Code: JBERGOV10M
- Bluetooth Version: 4.2
- Operating Voltage: DC 3.7V
- Operating Current: 10mA
- Working Frequency: 2.4GHz
- Rechargeable battery: Lithium 300mAh
- DPI: 1000 / 1600 / 2400
- Dimensions: 113.85 x 83.40 x 69.07 mm
- Charging cable length: 1 M
- System Requirements: Windows® 10 or later, Mac OS 10.10 or later Android™ 10 or later, or iOS system.

Windows is a trademark of the Microsoft Corporation in the United States and other countries. Mac and MacOS are trademarks of Apple Inc., registered in the U.S. and other countries.

The Bluetooth® word mark and logos are registered trademarks owned by Bluetooth SIG, Inc. and any use of such marks by Officeworks Ltd is under license.

Android is a trademark of Google LLC.

IOS is a trademark or registered trademark of Cisco in the U.S. and other countries and is used under license.



Do not connect this cable to products other than Elite MS400 wireless mouse. Connecting this cable to other devices might cause damage to both cable and the device

Product Warranty-valid for Australian customers only

Officeworks Ltd warrants that this product will be free from defects and work as intended for 8 years from the date of purchase by the original customer.

If the product has any defects or does not work as specified during the Warranty Period, Officeworks will, at its election and at its expense, repair or replace the product. This warranty does not apply

- to cosmetic damage;
- to damage caused by consumables used in connection with the product (such as batteries);
- where the product has not been used in accordance with all provided instructions;
- to damage arising from fair wear and tear;
- where the product has not been subject to reasonable use;
- where the product has not been intentionally or negligently damaged and/or;

- if the customer has attempted to repair the product

To make a claim under this warranty, please return your product with your receipt or proof of purchase to your nearest Officeworks store or contact 1300 633 423. the Australian Consumer Law. You are entitled to a replacement or refund for a major failure and compensation for any other reasonably foreseeable loss or damage. You are also entitled to have the goods repaired or replaced if the goods fail to be of acceptable quality and the failure does not amount to a major failure.

This warranty is provided in addition to any rights you may be entitled to under the Competition & Consumer Act 2010. Our goods come with guarantees that cannot be excluded under the Australian Consumer Law. You are entitled to a replacement or refund for a major failure and compensation for any other reasonably foreseeable loss or damage. You are also entitled to have the goods repaired or replaced if the goods fail to be of acceptable quality and the failure does not amount to a major failure.

J.BURROWS

Documents / Resources

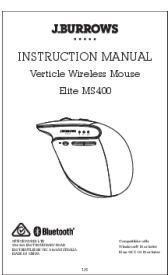
	<p>J BURROWS Elite MS400 Verticle Wireless Mouse [pdf] Instruction Manual Elite MS400 Verticle Wireless Mouse, Elite MS400, Verticle Wireless Mouse, Wireless Mouse, Mouse</p>
--	--