



# ITC EWS-XYZ-A Ethernet Webpage Server Instruction Manual

[Home](#) » [ITC](#) » ITC EWS-XYZ-A Ethernet Webpage Server Instruction Manual 

## ITC EWS-XYZ-A Ethernet Webpage Server Instruction Manual



### Contents

- [1 PARTS/TOOLS NEEDED](#)
- [2 INSTALLATION](#)
- [CONSIDERATIONS](#)
- [3 OEM SET UP INFORMATION](#)
- [4 TROUBLESHOOTING](#)
- [5 Documents / Resources](#)
  - [5.1 References](#)
- [6 Related Posts](#)

### PARTS/TOOLS NEEDED

- Ethernet Server & CAN Connector Cable



- RGB(W) or ARGB(W) Controller  
(purchased separately)



- Digital Dash  
(purchased separately)



## INSTALLATION CONSIDERATIONS

- The Ethernet Webpage Server is part of the ITC VersiColor line of RGB products. Lighting and additional controller products need to be purchased separately. Refer to the installation instructions for these products for additional considerations.
- The Ethernet Webpage Server is a bridge between Ethernet and CAN J1939 protocol.
- An ITC VersiControl RGB(W) controller must be used to connect to the Webpage Server. Please contact your ITC sales representative for available options.
- Disconnect power before installing, adding or changing any component.
- To avoid a hazard to children, account for all parts and destroy all packing materials.

- This device complies with FCC part 15B regulations.

## OEM SET UP INFORMATION

- To adjust configuration settings, first press the help button, then system info button.
- Select zone info, this will display the current settings of a zone. Select a zone on the left to show it's settings.
- To change them, press either zone setup or controller setup.
- **Note:** You must enter a password in order to make changes to the settings.
- To find the version number, push the help button on the main screed.

### 1. System Connections

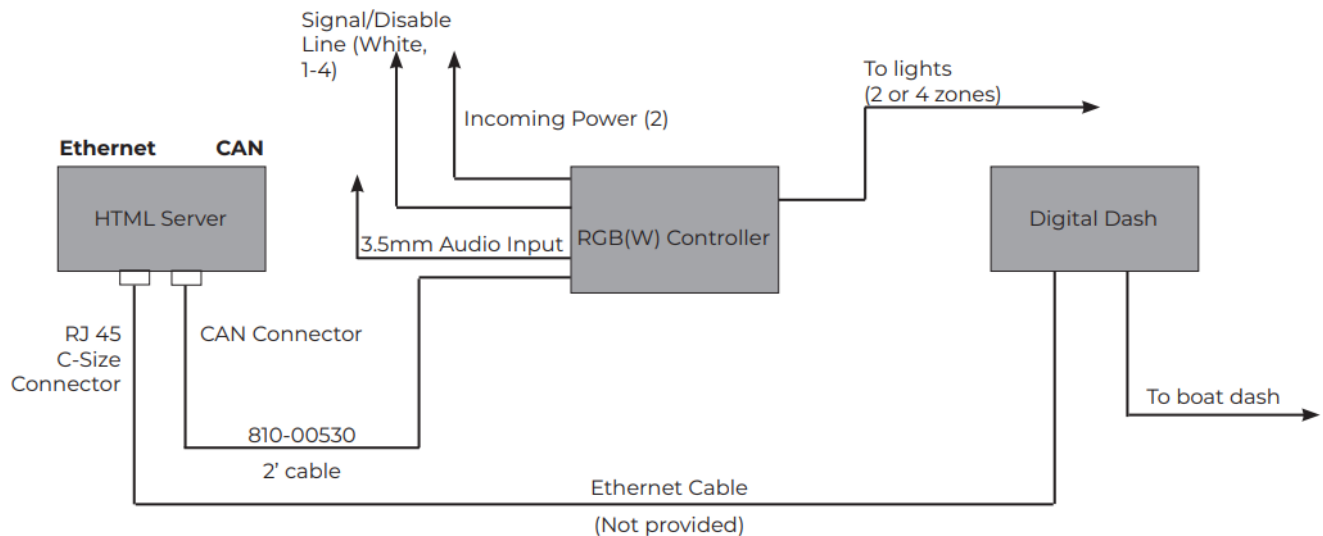

### 2. Open ITC lighting control screen

- Turn on power to system. The MFD will display a button called "ITC Marine VersiControl". Press and the main lighting screen will open.
- **Note:** When using the keyboard to rename zones or scenes, you must touch an area outside of the keyboard to close it.
- In the help screen, there is system info screen that will provide revision information.



### 3. Color control screen

On the main screen, select your zones then press the set color button.

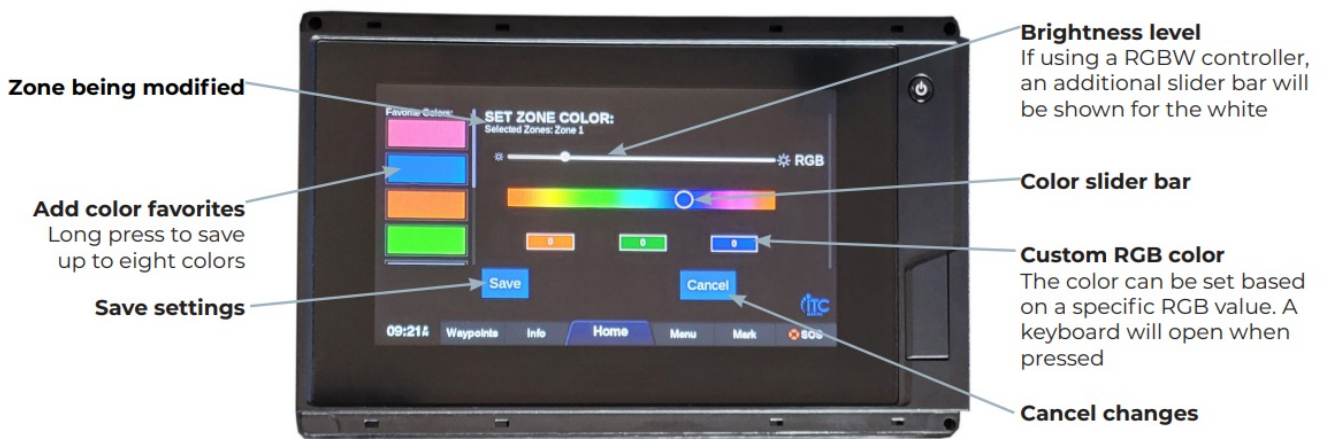

#### 4. Scene setup screen

- Hold add scene button and the scene setup screen will appear.
- **Note**, the ethernet web server will not come with any preset scenes. These must be set by the OEM or end consumer.
- When entering a mode you must select the zones first



#### 5. Standard fades screen

Select the color fade button on the scene set up menu

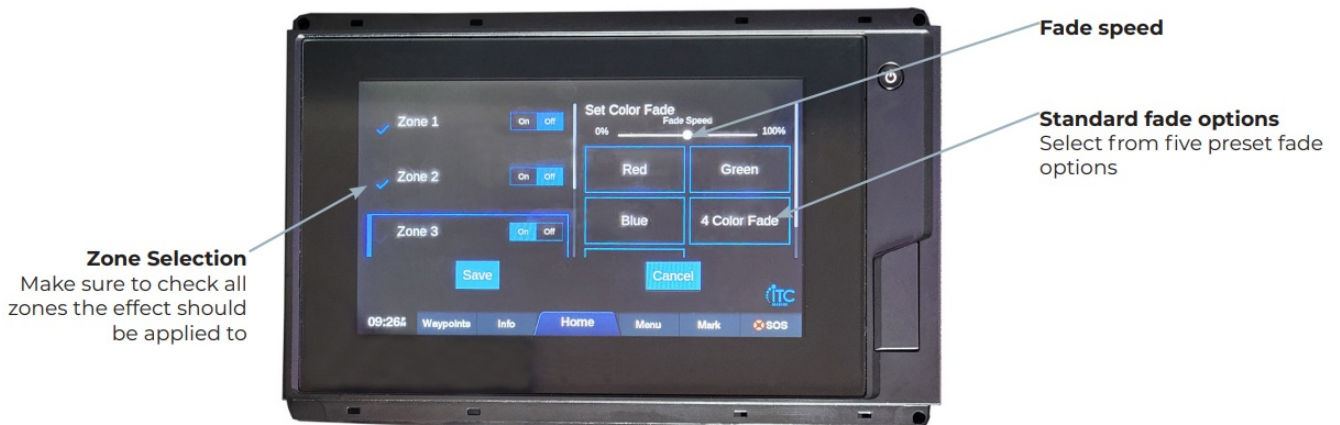

#### 6. Chasing mode screen

Applies only if an ARGB(W) controller is connected.



## 7. Music mode screen

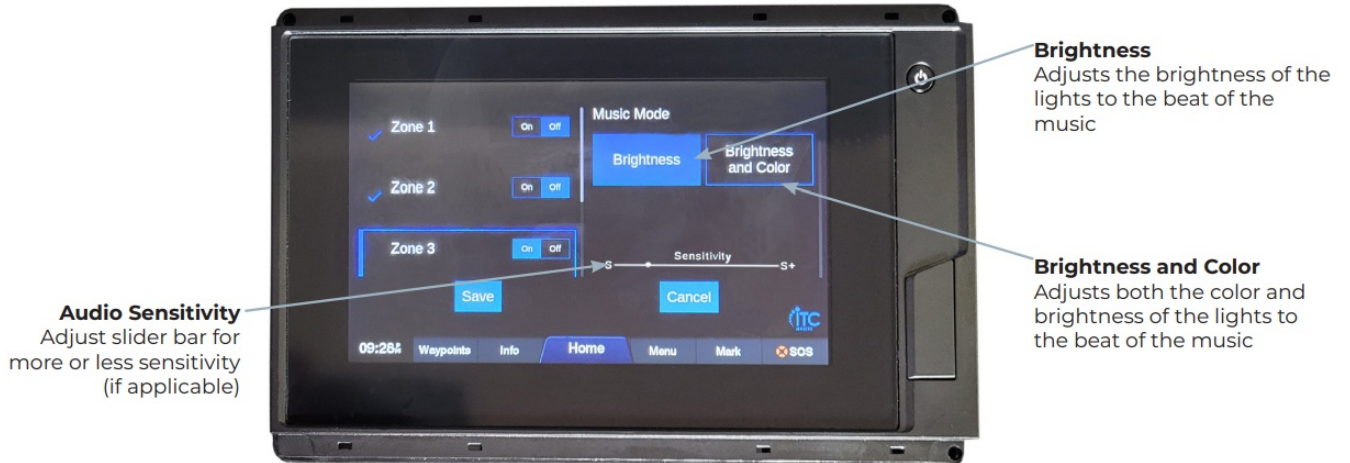

## TROUBLESHOOTING



Problem	Solution
No zones are visible	Check to make sure the controller is connected and make sure to reset both the server and the controller
Page is stuck on loading	Check to make sure the controller is connected properly
Reset or sync the fade on multiple screens	Return to the main screen and turn the <i>instant white</i> button on and off
Screen is flickering	If you are using two controllers, they may be set to the same address, change the address of one
Access is needed for the set up screens	You will need to use a password – set up screens should <b>only</b> be accessed by OEM suppliers
The server firmware needs to be updated	Contact ITC sales representative for instructions
Scenes not functioning properly	Remove scene and start over by going to scene edit and pressing the <i>delete</i> button, restart scene set up
Additional help needed	Press the help button and scan the QR code to pull up FAQ and more information on the ITC website

## Documents / Resources

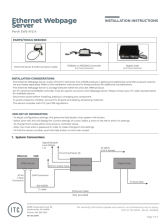
	<p><a href="#">ITC EWS-XYZ-A Ethernet Webpage Server</a> [pdf] Instruction Manual  EWS-XYZ-A Ethernet Webpage Server, EWS-XYZ-A, Ethernet Webpage Server, Webpage Server, Server</p>
---	--

## References

-  [ITC Warranty & Return Policy](#)

Manuals+.