



iTalkBB AH6W Aljia Camera User Guide

[Home](#) » [iTalkBB](#) » iTalkBB AH6W Aljia Camera User Guide 



Contents

- [1 iTalkBB AH6W Aljia Camera](#)
 - [1.1 In The Box](#)
 - [1.2 Basics of camera](#)
 - [1.3 Setup your camera](#)
 - [1.4 Setup your camera](#)
- [2 Documents / Resources](#)
 - [2.1 References](#)
- [3 Related Posts](#)

iTalkBB AH6W Aljia Camera



We are available 24/7.

For United States and Canada, 1-877-482-5503 For Korean Customer Service, 1-800-875-8318 Korean Customer Service 06:00-22:30 PST

We are also available on WeChat

Our customer service is also available on WeChat! Search iTalkBB on WeChat, and chat with us! For more information, please visit www.iTalkBB.com.

In The Box

- Camera
- Wall Mount
- Pre-install Battery
- Camera Power Adaptor
- Camera Charging Cable
- Screw Kit
- Quick Start Guide
- Warning Sign

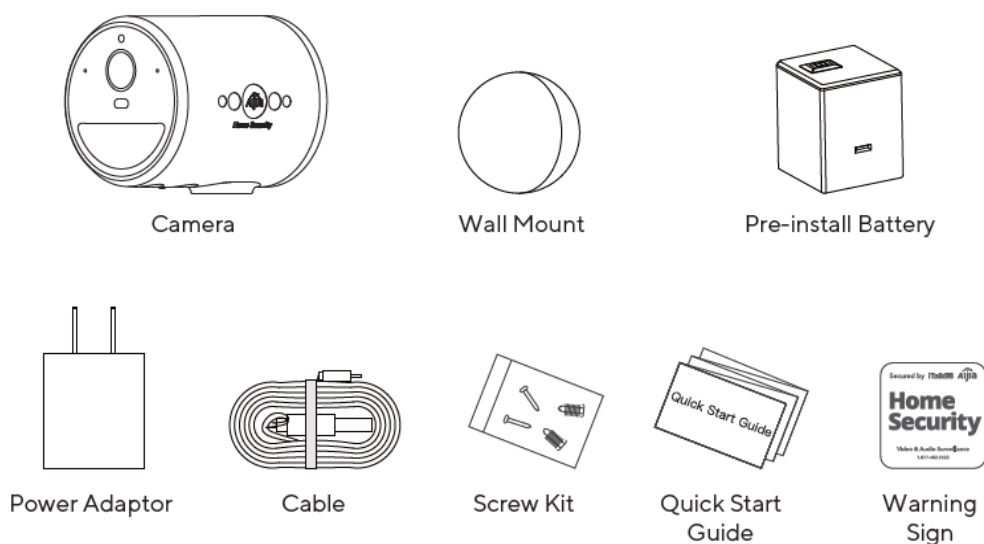

Basics of camera

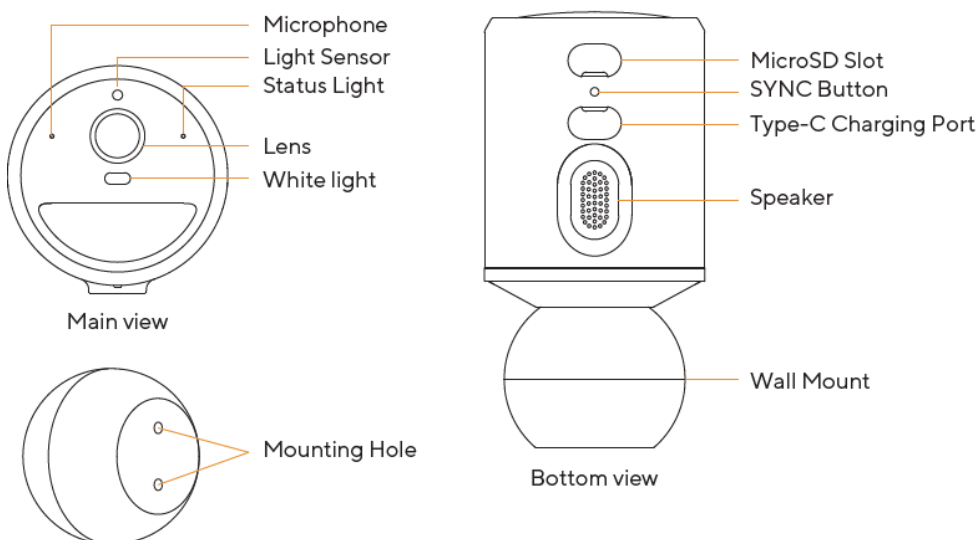

- The best area for motion detection is 5 feet to 25 feet (1.5 to 7.5 meters) from the camera.

2.5m

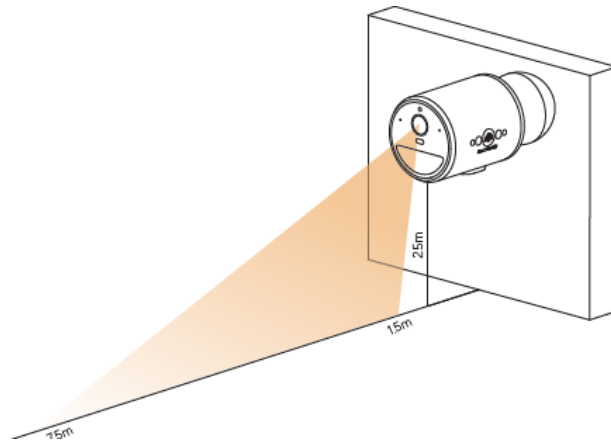

- Secure the magnetic mount with screws

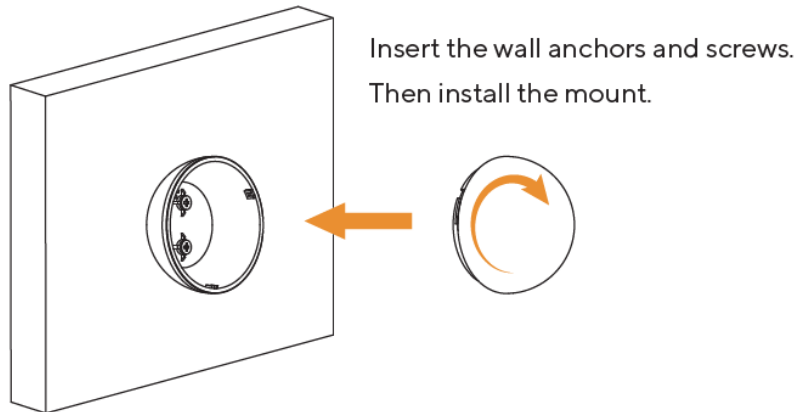

- Attach the camera to the magnetic mount.

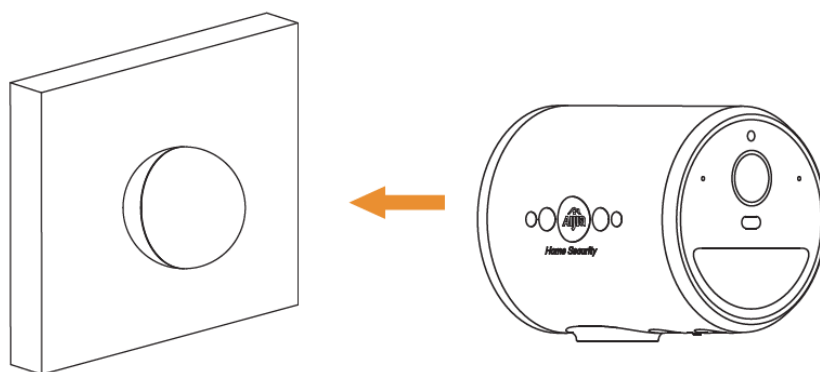

Note: Prolonged direct sunlight can heat the inside of your camera past its maximum operating temperature of 122°F (50°C). Avoid directly sunlight where possible and only use your camera in environments within its operating temperature range: -4°F to 122°F (-20°C to 50°C).

Setup your camera

- Download the Aljia app and create an account.

Note: If you already use the iTalkBB Aijia app, please make sure that you are using the latest

version. To find out if an update is available, go to the app store and search for iTalkBB Aljia.

- Follow the Aljia app to set up the base station.

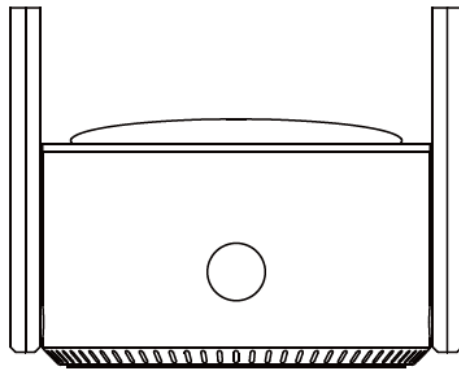

- Follow the Aljia app to set up the camera.

Note: Please fully charge the battery before using it.

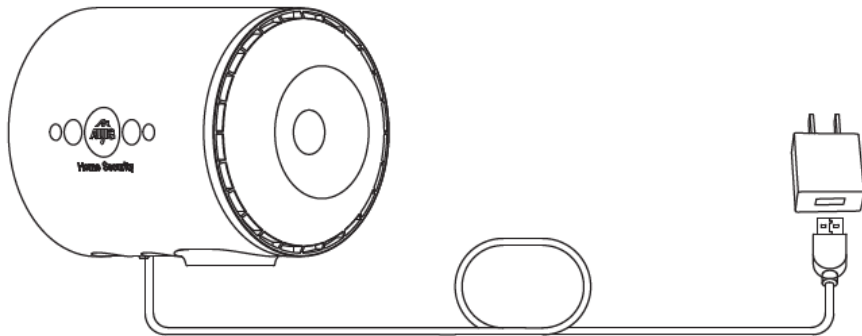

Setup your camera

- Place your camera in a location with a clear, unblocked field of view.

Your camera provides a 120° viewing angle, so place the camera to cover a desired area.

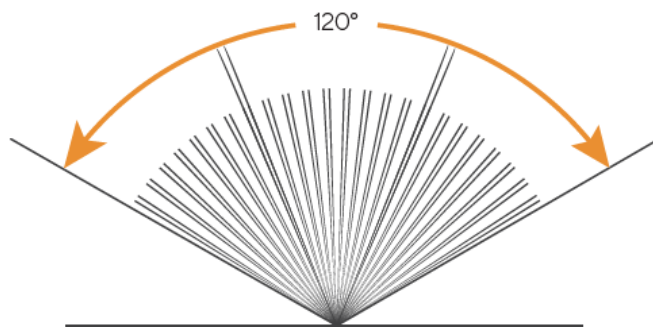

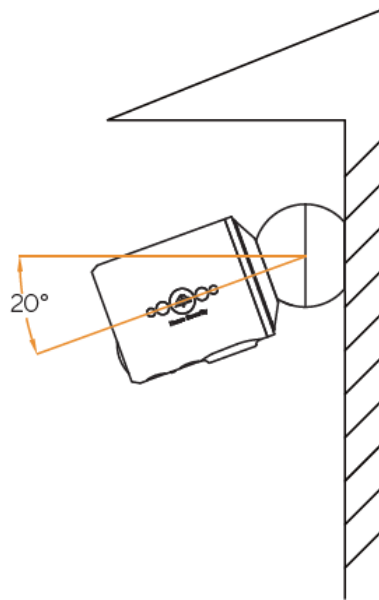

It is recommended to install at a height of 2.5m from the ground, with the fuselage tilted down by 20°.

Battery

When using the camera for the first time, be sure to fully charge the battery.

• Charge the battery

1. Make sure the battery is inserted into the camera

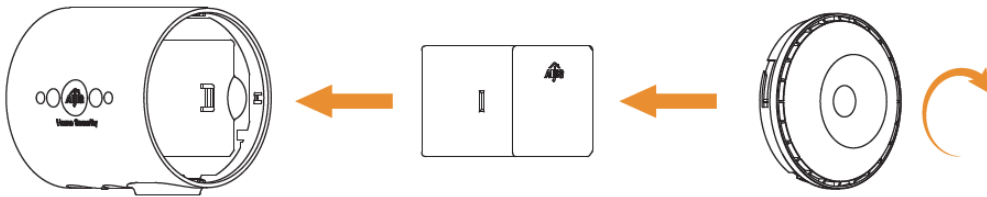

2. . Connect the camera to a power outlet using the power adapter (5V,2A).

A camera will be blinking red when being charged.

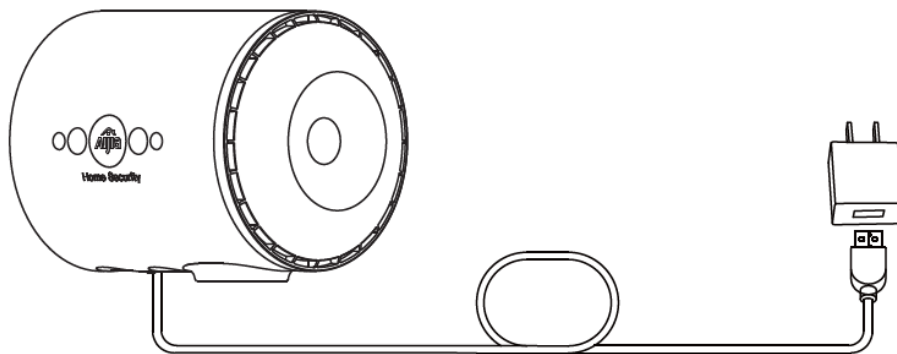

3. It usually takes about 5-6 hours to fully charge the battery. Once a camera is fully charged, indicator light will be solid red.

Note: The app will notify you when it detects a low battery level

Light Indications

• Solid yellow light

The device is powered on and initializing

- **Flashing yellow & blue lights**

The device is pairing with the base station

- **Solid blue light**

The device is working properly

- **Flashing blue light**

The device is connecting to the network

- **Solid red light**

The device is fully charged

- **Flashing purple light**

The device is upgrading

- **Solid purple light**

Something went wrong with the firmware

- **No indicator light**

The device is powered or sleeping

This device complies with Part 15 of the FCC Rules. Operation is subject to the following two conditions:

1. This device may not cause harmful interference , and
2. This device must accept any interference received, including interference that may cause undesired operation

Note: This product has been tested and found to comply with the limits for a Class B digital device, pursuant to Part 15 of the FCC Rules . These limits are designed to provide reasonable protection against harmful interference in a residential installation. This product generates, uses, and can radiate radio frequency energy and, if not installed and used in accordance with the instructions, may cause harmful interference to radio communications. However, there is no guarantee that interference will not occur in a particular installation. If this product does cause harmful interference to radio or television reception, which can be determined by turning the equipment and on, the user is encouraged to try to correct the interference by one or more of the following measures

- Reorient or relocate the receiving antenna.
- Increase the separation between the equipment and receiver.
- Connect the equipment into an outlet on a circuit different from that to which the receiver is connected.
- Consult the dealer or an experienced radio/TV technician for help.

Please take attention that changes or modification not expressly approved by the party responsible for compliance could void the user's authority to operate the equipment. This equipment complies with FCC radiation exposure limits set forth for an uncontrolled environment. This equipment should be installed and operated with minimum distance 20cm between the radiator & your body.

Documents / Resources

	<p>iTalkBB AH6W Aljia Camera [pdf] User Guide AH6W, 2ASRO-AH6W, 2ASROAH6W, AH6W Aljia Camera, AH6W, Aljia Camera</p>
---	--

References

-  [iTalkBB](#)

[Manuals+](#), [home](#) [privacy](#)