

irocks®
K85R Rechargeable
Wireless Mechanical
Keyboard



irocks K85R Rechargeable Wireless Mechanical Keyboard Installation Guide

[Home](#) » [irocks](#) » irocks K85R Rechargeable Wireless Mechanical Keyboard Installation Guide 

Contents

- 1 irocks K85R Rechargeable Wireless Mechanical Keyboard
- 2 PACKAGE CONTENTS
- 3 SYSTEM REQUIREMENTS
- 4 FEATURES
- 5 KEYBOARD SPECIFICATIONS
- 6 HARDWARE INSTALLATION
- 7 HOT-SWAPPABLE SWITCH REPLACEMENT
- 8 PRODUCT INFORMATION
- 9 TROUBLESHOOTING
- 10 WIRELESS ID PAIRING
- 11 FCC WARNING STATEMENT
- 12 Documents / Resources
 - 12.1 References



irocks K85R Rechargeable Wireless Mechanical Keyboard



PACKAGE CONTENTS

- Keyboard x 1
- USB Dongle
- USB-C Cable x 1
- Puller for Switch & Keycap x 1
- Extra Switches x 4
- Quick Installation Guide x 1

SYSTEM REQUIREMENTS

- Microsoft Windows system: Windows® 8.1. Windows® 10. Windows® 11. and above
- Mac OS 10.14 or higher
- Available USB Port

FEATURES

- Equipped with a 1.14-inch LCD screen for displaying various functions and settings
- The gasket structure and a four-layer sound-dampening structure provide a soft and unified typing experience
- stocks pre-lubed switches and Gateron hot-swappable switch sockets
- Compatible with Windows and macOS operating systems
- Wheel with switchable modes, customizable in Windows 10 and 11 for volume control, and scrolling, zooming, and more
- High-performance 2.46Hz wireless and USB-C wired connectivity
- Vibrant RGB backlighting with static or dynamic effects

KEYBOARD SPECIFICATIONS

- **Model name:** Wireless Mechanical Keyboard
- **Model No. :** IRK85R
- **Dual mode interface:** Wired (USB Full Speed) / Wireless (2.46Hz)
- 98 Keys
- **Switch type:** Mechanical switch with hot-swappable switch sockets
- N-Key rollover (NKRO)

- **Multimedia hotkeys:** 12 keys
- **Backlight effect hotkeys:** 4 keys
- **Voltage:** DC 5V
- **Charging interface:** USB-C
- **Rechargeable Li-ion battery:** 3750 mAh
- **Cable length:** approx. 180 cm
- **Weight:** approx. 1030 g
- **Dimension:** 407 (.) X 143(1) X 44(H) mm

RECEIVER SPECIFICATIONS

- **Interface:** US8
- **Dimension :** 18.6(L) X 14.5(W) X 6.1 (H) mm

HARDWARE INSTALLATION

First-time Use and Charging Instructions

For the initial use or if the keyboard has been unused for an extended period, it is important to charge the battery to ensure proper keyboard and battery functionality. Prolonged periods of non-use can gradually reduce battery voltage. Therefore, it is recommended to fully charge the battery every few months (approximately 4-5 months) before use to extend the battery lifespan.

Charging Method:

1. Connect the US8 cable to your computer or a USB DC5V charger.
2. Plug the other end into the keyboard for charging.
3. Charging is completed when the screen on your keyboard indicates 99% ~ 100% battery level.

Note: It is advisable to turn off the backlight function during charging to shorten charging time.

Screen Menu Functions

The screen on the keyboard provides options for configuring the wheel and basic functions. You can customize and operate various functions by using the corresponding keys and the scroll wheel. Please refer to the introduction to wheel functions below :

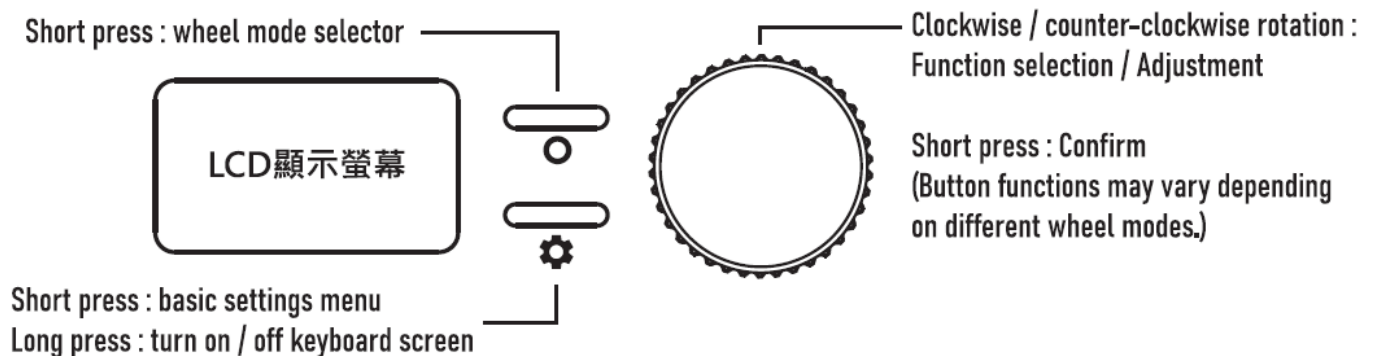

- Wheel Mode Selector includes volume adjustment, task switcher, and Smart Wheel mode.
- The basic Settings Menu includes connectivity. Windows/mac system switching, lighting effects,
 - lighting color, lighting brightness, lighting speed,

- language selection, home settings

Keyboard linking

This keyboard has two connection modes: wired and wireless. Follow the steps below to set up your keyboard.

Wired Installation

1. Turn on your computer.
2. Plug the USB cable into an available USB port on your computer and keyboard.
3. Setting the wired interface mode (Basic Settings Menu > Connect » Wired)
4. Your computer will automatically detect the keyboard
5. You may use the keyboard after detection

Press FN+Ctrl+S to enable or disable Energy Saving Mode. When the mode is enabled, the backlight of your keyboard will automatically be turned off after 5 minutes of keyboard inactivity and turned back on after pressing any key. Energy Saving Mode in wired mode is disabled by default.

Wireless Installation

1. Power on the computer and plug the USB receiver into a USB port on your computer.
2. Flip the power switch to "ON", then set it to '2.4GHz wireless mode' (Basic Settings Menu > Connect > 2.4GHz wireless)|
3. Your computer will automatically detect the receiver and connect to the keyboard.

Under wireless mode: The backlight of your keyboard will be automatically turned off after 1.5 minutes of keyboard inactivity. To turn the backlight back on, press any key.

To set an idle timeout for the keyboard's Energy Saving Mode under wireless mode

- FN + CTRL + 0** : Fully disable Energy Saving Mode
- FN + CTRL + 1** : 1.5 minutes (default, key 1 will blink 3 times when enabled)
- FN + CTRL + 2** : 5 minutes (key 2 will blink 3 times when enabled)
- FN + CTRL + 3** : 10 minutes (key 3 will blink 3 times when enabled)

HOT-SWAPPABLE SWITCH REPLACEMENT

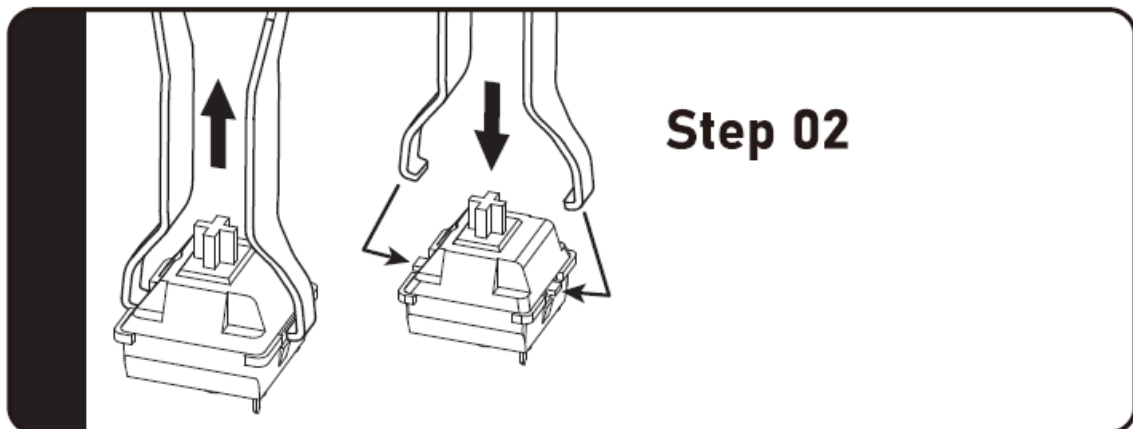
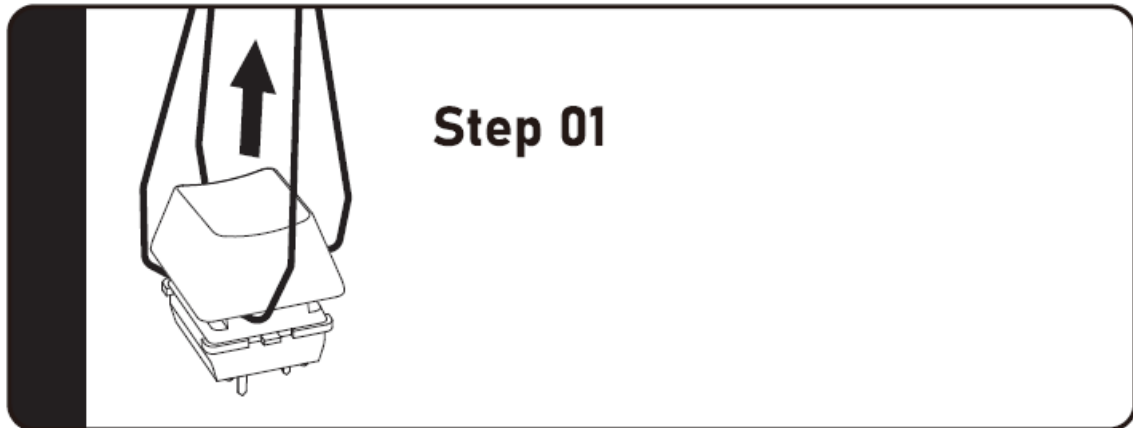
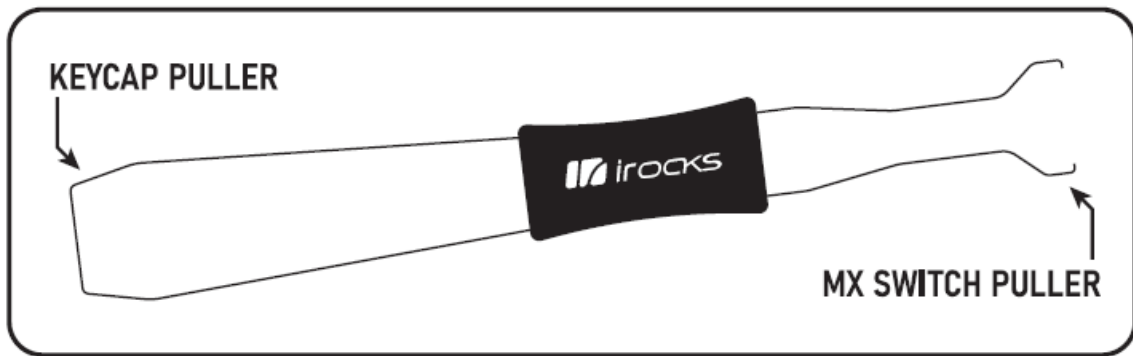

1. Step 01

Remove the keycap with the key puller side of the 2-in-1 tool coming with your keyboard.

2. Step 02

Remove the switch with the switch puller side of the tool.

3. Step 03

Gently push in the replacement switch

- and make sure the pins of the switch are aligned with the pin holes before pushing it in. Push from the top of the switch
- to avoid pin damage, do not push on the side of the switch.

4. Step 04

Push back the keycap.

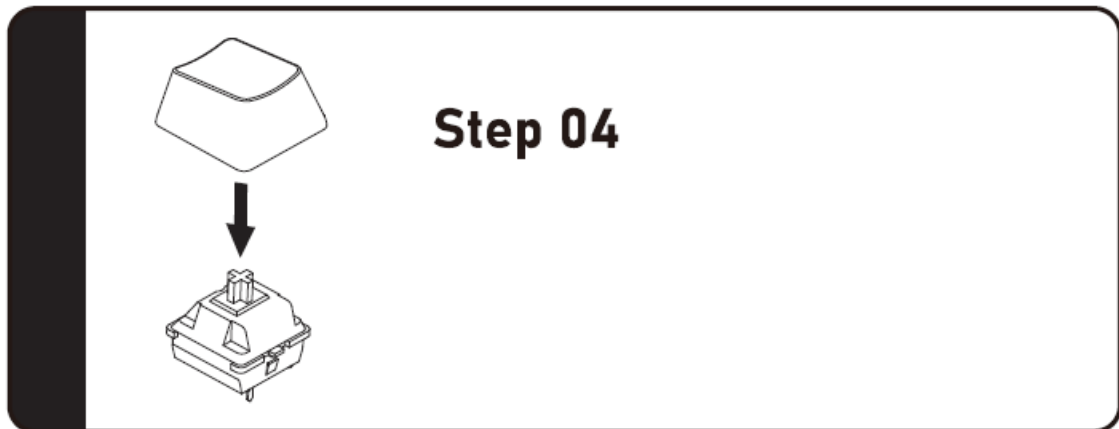
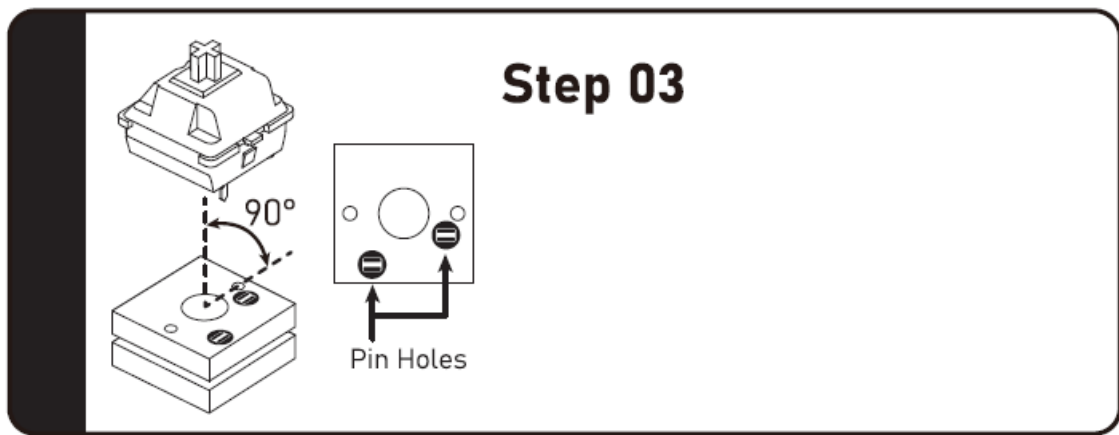

PRODUCT INFORMATION

1. LED Indicator

1 : Numeric Lock Indicator

↓ : Scroll Lock Indicator

A : Caps Lock Indicator

W : Windows lock

2. Function Keys

Press and hold the 'Fn' key, then press a desired function key to use hotkeys.

1. Setting Hotkeys

FN + **CTRL** + **G** : N-Key Rollover anti-ghosting function (default)

FN + **CTRL** + **N** : 6-Key Rollover anti-ghosting & standard USB settings

FN + **CTRL** + **P** : Factory reset (Press and hold for 5 seconds)

2. Multimedia & Function Hotkeys

- FN** + **CTRL** + **Q** : Switch to macOS mode
- FN** + **CTRL** + **W** : Switch to Windows mode
- FN** + **CTRL** + **E** : Switch to wired connection
- FN** + **CTRL** + **R** : Switch to wireless connection
- FN** + **Esc** : Lock entire keyboard

(Only the ESC key is red backlit when keyboard is locked.)

mac OS	KEY	PRESS	FN + PRESS
	F1	Decrease Screen Brightness	F1
	F2	Increase Screen Brightness	F2
	F3	Mission Control	F3
	F4	Spotlight	F4
	F5	Search	F5
	F6	No function	F6
	F7	Previous Track	F7
	F8	Play / Pause	F8
	F9	Next Track	F9
	F10	Mute	F10
	F11	Volume Down	F11
	F12	Volume Up	F12

3. Keyboard Backlight

- FN** + **▲** or **▼** : Adjust brightness / turn off backlight (5 levels)
- FN** + **◀** or **▶** : Adjust backlight speed (depending on backlight effects)
- FN** + **⌂** or **=+** : Adjust brightness effects (depending on backlight effects)

4. Smart wheel function

Smart Wheel mode is powered by Windows 10/11 protocol without additional software if you're using the latest version of Windows 10/11. Your wheel under Smart Wheel mode is customizable and will automatically switch to your preferred tool depending on the software you're using. Switch between scrolling, zoom, rotation, brush tuning, and video editing. Multimedia control and more. Smart Wheel support ranges from Windows built-in apps to pro software

Press the below button to switch between wheel modes:



• Wheel – Volume Control Mode

- Wheel clockwise: Increase volume
- Wheel counterclockwise: Decrease volume
- Wheel button: Mute / Unmute



• Wheel – Task Switcher Mode (Only works on PC with Windows®)

- Wheel clockwise: Next Window
- Wheel counterclockwise: Previous Window
- Wheel button: Select



• Wheel – Smart Wheel Mode

- Only works on PC with Windows® 10/11
- Go to Windows® 10/11 Settings – Devices – Wheel for customization.

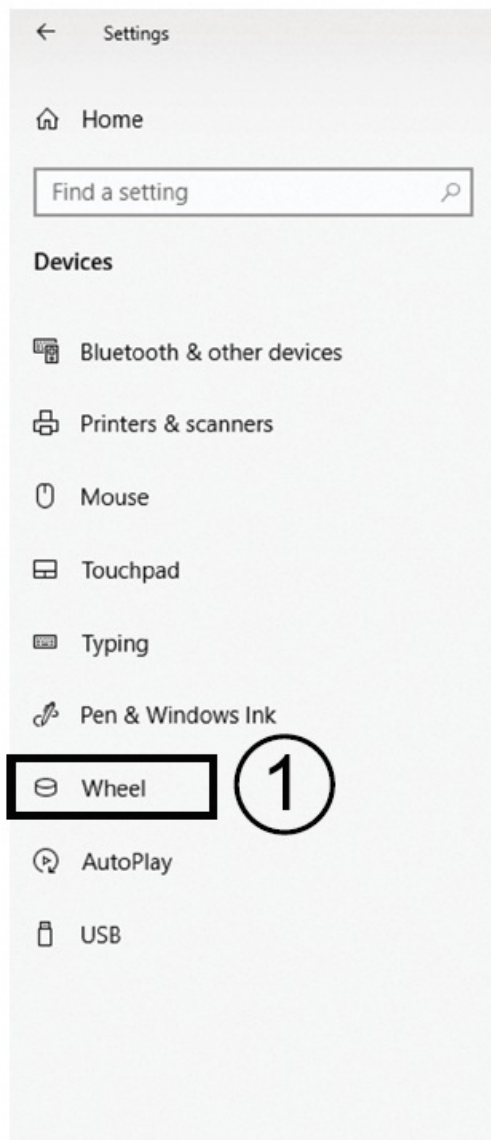

Wheel

Wheel settings

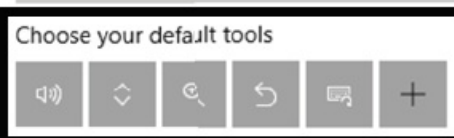
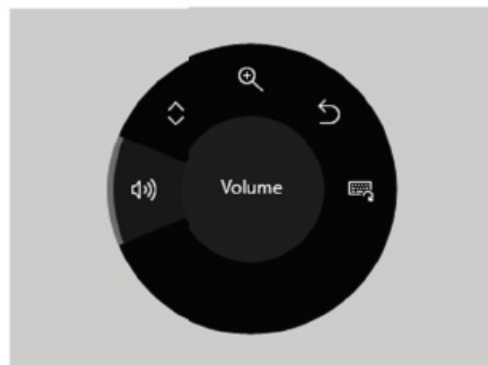

Vibrate

☒ On

Custom tool

Choose keyboard shortcuts to use as your custom tool.

Rotate right shortcut

Ctrl + Right

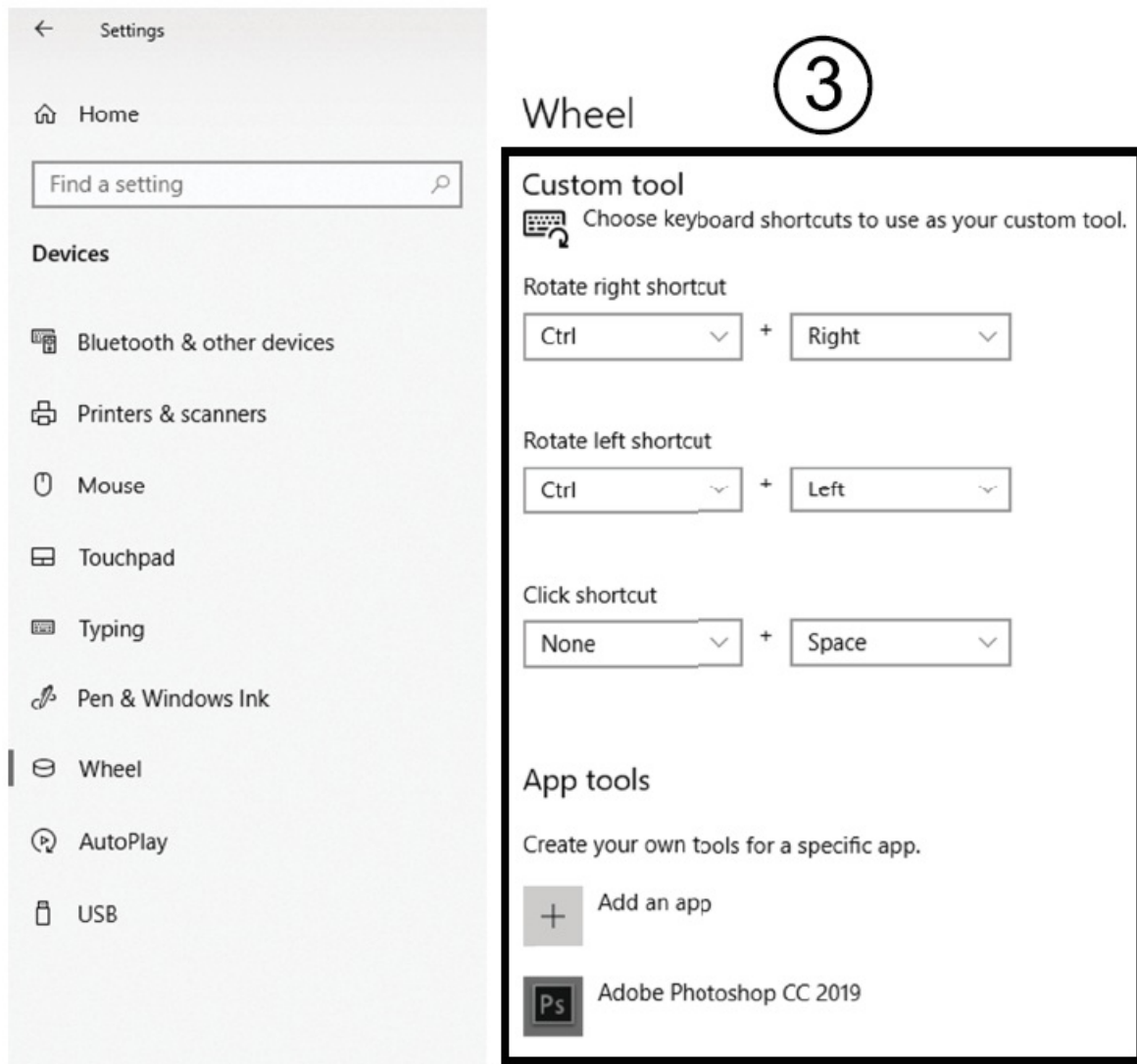

Software

The keyboard software requires the keyboard to be in wired mode, as it directly saves most of the settings to the keyboard's onboard memory. Saved keyboard settings will be applied under both wired and wireless modes. Please visit iRock's official website to download and install the latest software for backlight, macro, multimedia keys configuration, and more.

1. Double-click the installation software downloaded from iRocks, and follow the instructions.
2. Plug in the keyboard after installation, the software will start to identify your keyboard.
3. Launch the software, It will take some time to synchronize the memory parameter and setting of the keyboard.

Attention: The keyboard has to be switched to wired mode for software configuration.

Onscreen Time Calibration

You can synchronize time on your keyboard screen with your computer using the installed software with the following steps:

1. Ensure the keyboard is connected to the software and launch the software.
2. Click on GIF (LCD Video Editor).
3. Click on Time Calibration.'



TROUBLESHOOTING

CAUTIONS

If your wireless keyboard does not work normally :

- Ensure the keyboard is switched to the correct mode – wired or 2.4GHz wireless mode.
- Check the USB receiver is connected to your computer's USB port correctly – unplug and plug it back.
- Check if the keyboard has sufficient battery power.
- Metal objects close to or in between the keyboard may reduce wireless performance. Try moving metal objects away from the keyboard.
- This keyboard has a 2.4GHz wireless connection, using USB 3x and 2.4GHz wireless devices at the same time may cause radio frequency interference and affect normal. Functionality of the wireless device. Try to reduce radio interference of the USB 3x device to your wireless keyboard, Plug the receiver into the Usa 20 port or other locations as far away as possible from the Use 3. port or use Uthe SB Huo / U58 extension cable to re-position your wireless receiver to a location away from the USB 3. x port.
- For saving power, the keyboard goes into sleep mode when it's not in use for a while. Press any key and wait for 1 to 3 seconds to bring the keyboard out of sleep mode.
- When not using the keyboard for an extended period, please switch off the keyboard and charge it periodically. Avoid letting the battery remain at low voltage for too long to ensure the battery's proper operation and extend its lifespan.
- Avoid putting your keyboard under high moisture conditions or direct sun.
- Do not expose your keyboard to extreme temperatures, heat, fire, or liquid.

WIRELESS ID PAIRING

The wireless keyboard is pre-paired with an included receiver before shipment. It saves the need to pair and is ready to use out of the box. When you need to repair your keyboard and receiver manually to prevent signal interference or other issues, please follow the steps below.

1. Make sure the keyboard is in wireless mode.
2. Press and hold Fn • P for 3 seconds to enter pairing mode (The p key will flash).|

3. Unplug and plug the US: receiver back into your computer's USB port.
4. Move the keyboard to close the USB receiver within 15cm, the ID setting process will start automatically. (It will take about 4-8 seconds)
5. Your keyboard should be ready to use
6. The above steps need to be completed within 1 minute. If the keyboard doesn't work properly, please remove the U58 receiver from the computer's USB port, then proceed to steps 1-4 again.

FCC WARNING STATEMENT

Changes or modifications not expressly approved by the party responsible for compliance could void the user's authority to operate the equipment. This equipment has been tested and found to comply with the limits for a Class B digital device, under Part 15 of the FCC Rules. These limits are designed to provide reasonable protection against harmful interference in a residential installation. This equipment generates uses and can radiate radio frequency energy and, if not installed and used by the instructions, may cause harmful interference to radio communications. However, there is no guarantee that interference will not occur in a particular installation. Suppose this equipment does cause harmful interference to radio or television reception, which can be determined by turning the equipment off and on. In that case, the user is encouraged to try to correct the interference by one or more of the following measures:

- Reorient or relocate the receiving antenna.
- Increase the separation between the equipment and the receiver.
- Connect the equipment to an outlet on a circuit different from that to which the receiver is connected.
- Consult the dealer or an experienced radio/TV technician for help.

This device complies with part 15 of the FCC Rules. Operation is subject to the following two conditions:

1. This device may not cause harmful interference, and
2. this device must accept any interference received, including interference that may cause undesired operation.

The device has been evaluated to meet general RF exposure requirements. The device can be used in portable exposure conditions without restriction. **I-Rocks Technology Co., Ltd.**

- Headquarter Office: 7F., No. 786, Zhongzheng Rd., Zhonghe Dist.,
- New Taipei City 23586, Taiwan
- **Tel:** +886-2-2225-5080
- **Fax:** +886-2-2228-1712
- www.i-rocks.com
- i-Rocks Korea
- www.i-rocks.co.kr

Documents / Resources

	<p>i-rocks K85R Rechargeable Wireless Mechanical Keyboard [pdf] Installation Guide K85R Rechargeable Wireless Mechanical Keyboard, K85R, Rechargeable Wireless Mechanical Keyboard, Wireless Mechanical Keyboard, Mechanical Keyboard, Keyboard</p>
---	---

References

- [User Manual](#)

[Manuals+](#), [Privacy Policy](#)

This website is an independent publication and is neither affiliated with nor endorsed by any of the trademark owners. The "Bluetooth®" word mark and logos are registered trademarks owned by Bluetooth SIG, Inc. The "Wi-Fi®" word mark and logos are registered trademarks owned by the Wi-Fi Alliance. Any use of these marks on this website does not imply any affiliation with or endorsement.