

iRobot j5 Roomba Combo Robot Vacuum



iRobot j5 Roomba Combo Robot Vacuum User Manual

[Home](#) » [iRobot](#) » iRobot j5 Roomba Combo Robot Vacuum User Manual 

Contents

- [1 iRobot j5 Roomba Combo Robot Vacuum User Manual](#)
- [2 About Your Roomba Robot Vacuum](#)
- [3 INSTALL THE MOPPING PAD](#)
- [4 Troubleshooting](#)
- [5 Care and Maintenance](#)
- [6 Cleaning the Multi-Surface Brushes](#)
- [7 Cleaning the Mopping Pad](#)
- [8 References](#)
- [9 Related Posts](#)



iRobot j5 Roomba Combo Robot Vacuum User Manual



About Your Roomba Robot Vacuum

Top View

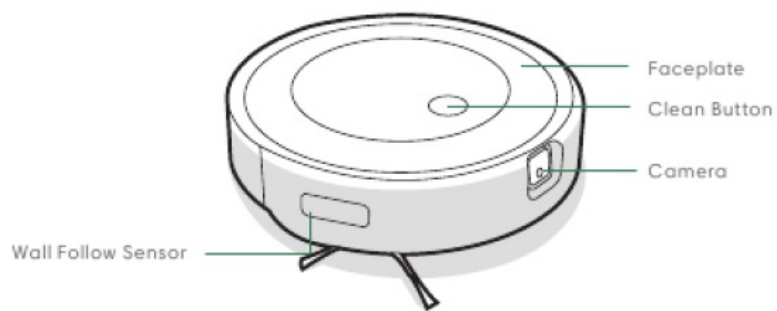

Bottom View

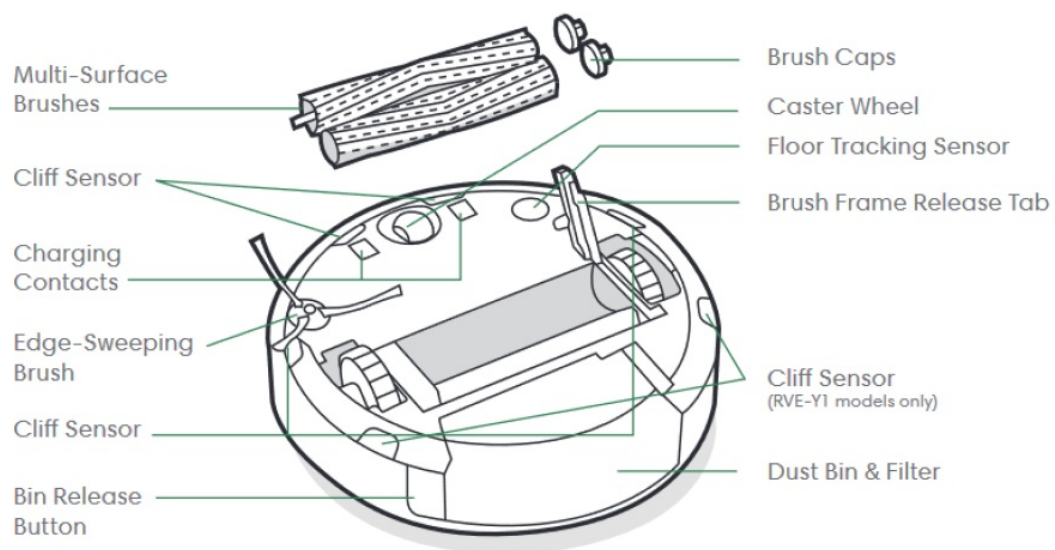

Home Base Charging Station

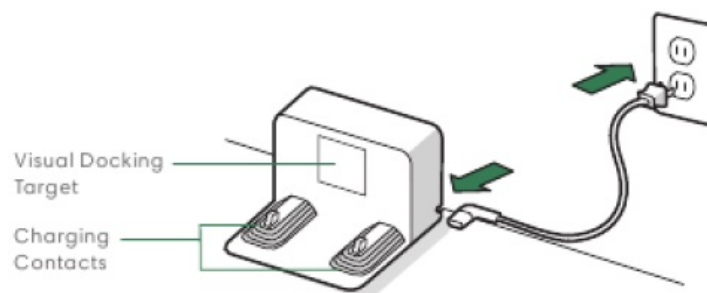

About Your Roomba Combo Bin

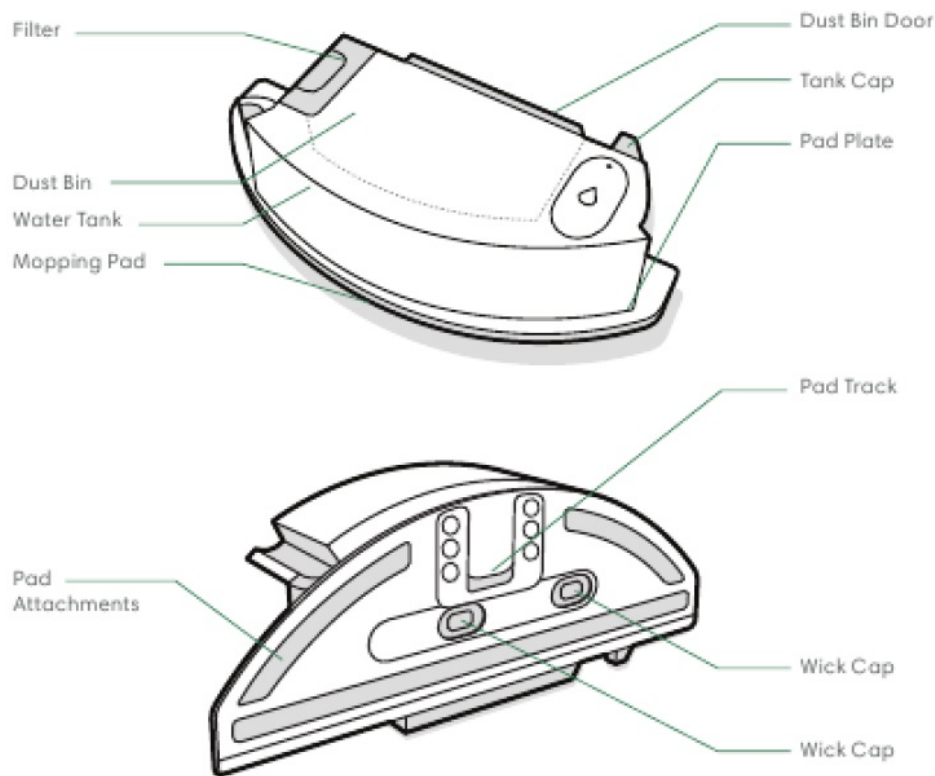

IMPORTANT INFORMATION

You must register your product in the iRobot Home App and complete a mapping run before using your Combo Bin. See the Activate your Combo Bin card for instructions.

INSTALL THE MOPPING PAD

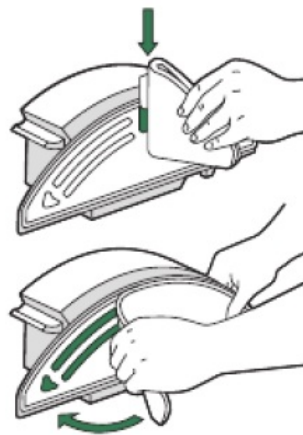

1. Slide the pad down over the track. Press the pad to the plate to attach.

FILL THE BIN

Fill the Combo Bin with water. You may also use a compatible cleaning solution. Compatible solutions are listed at this answers.irobot.com/s/roombacombo-cleanser

Note: The product starts wicking as soon as water is put into the tank.

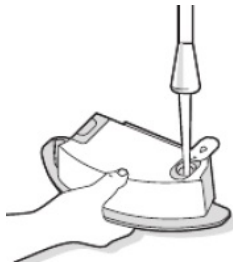

SWAP THE BINS

Remove the Dust Bin from the robot, and install the Combo Bin.

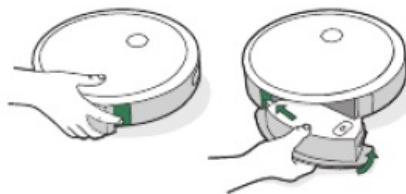

IMPORTANT INFORMATION

Do not flip the robot over with the Combo Bin installed

Using Your Roomba Robot Vacuum

Positioning the Home Base™ Charging Station

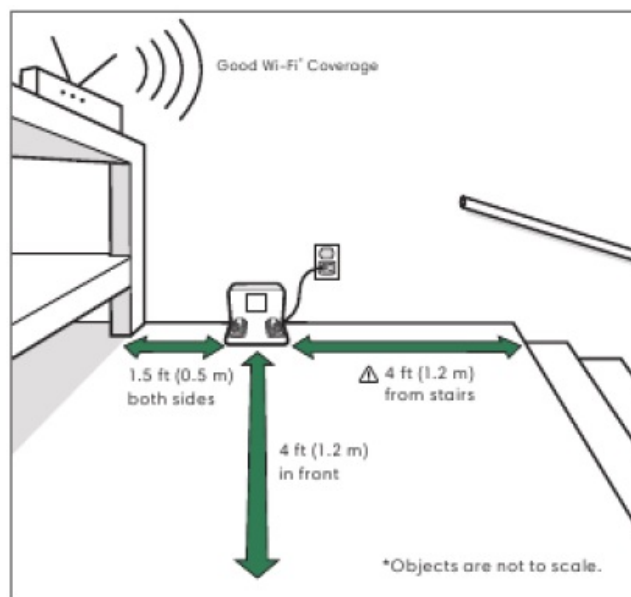

Note

Do not place your Home Base™ in direct sunlight. Ensure the area around the dock is free of clutter to improve docking performance. To prevent the risk of your robot falling downstairs, ensure that the charging station is placed at least 4 feet (1.2 meters) away from stairs.

Download the iRobot Home App and Connect to Wifi

Follow the step-by-step instructions to set up your Roomba. Set up Precision Vision Navigation to avoid obstacles in real time. Set an automatic cleaning schedule and customize cleaning preferences. Create smart maps to tell your robot where and when to clean.



Charging



- Light Ring Spiral While Charging
- White Spiral: charging
- Red Spiral: charging, low battery
- A solid white light will indicate the battery charge percentage of your robot

Place the robot on the charging station to activate the battery.

Note: Your robot comes with a partial charge, but we recommend that you charge the robot for 3 hours prior to starting the first cleaning job. When your robot is fully charged, the light ring indicator will intermittently pulse white at the rear.



The robot uses a small amount of power whenever it is on the charging station. You can put the robot in a further-reduced power state when not in use. To put your robot into reduced power standby mode, remove the dust bin and tap the clean button 5 times. To exit reduced power standby mode, place your robot on the charging station and tap the clean button. For more details on this Reduced Power Standby Mode, refer to the FAQ page on our website. For long-term storage, turn off the robot by removing it from the charging station and holding down the clean button for 3 seconds with one wheel off the ground. Store the robot in a cool, dry place.

Cleaning

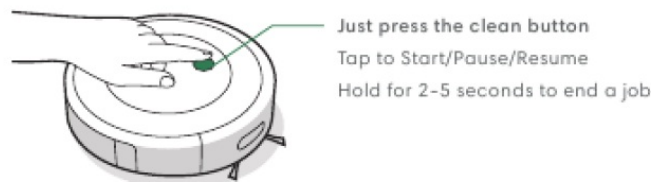

- To end a job and send the robot back to its charging station, hold the clean button down for 2-5 seconds. A blue light ring pattern will indicate that the robot is seeking the charging station.
- When your robot detects an especially dirty area, it will engage Dirt Detect™ mode, moving in a forward/backward motion to clean the area more thoroughly. The light ring indicator will flash blue.



- When the robot senses its bin needs to be emptied, the light ring indicator will illuminate in a red sweeping motion toward the rear.



Troubleshooting

- Your robot will tell you something is wrong by playing an audio alert and turning the light ring indicator red. Press the clean button or tap the bumper for details.
- Check the iRobot Home App for further support
- After 90 minutes of inactivity off the charging station, the robot will automatically end its cleaning job.

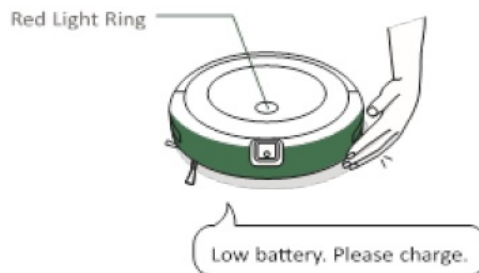

- To factory reset your robot, remove the dust bin and hold the clean button down for seven (7) seconds.
- A sound will let you know when the factory reset has been completed. Press the clean button down once more to confirm.

Battery Safety & Shipping

For best results, only use the iRobot Lithium Ion Battery that comes with your robot. Lithium ion batteries and products that contain lithium ion batteries are subject to stringent transportation regulations. If you need to ship this product for service, travel or any other reason, you **MUST** follow the below shipping instructions.

Battery **MUST** be turned off before shipping

Turn off the battery by removing the robot from the charging station and holding down the clean button for 3 seconds with one wheel off the ground. All indicators will turn off. Package the robot securely for shipping. If you need further assistance, contact our Customer Care team or visit global.irobot.com.

Care and Maintenance

Care and Maintenance Instructions

To keep your robot running at peak performance, perform the procedures on the following pages. There are additional instructional videos in the iRobot Home App. If you notice the robot picking up less debris from your floor, empty the bin, clean the filter, and clean the brushes.

Part	Care Frequency	Replacement Frequency*
Bin	Wash bin as needed	–
Filter	Clean once a week (twice a week if you have a pet). Do not wash.	Every 2 months
Full Bin Sensor	Clean every 2 weeks	–
Front Caster Wheel	Clean every 2 weeks	Every 12 months
Edge-Sweeping Brush and Multi-Surface Brushes	Clean once a month (twice a month if you have a pet)	Every 12 months
Sensors and Charging Contacts	Clean once a month	–
Camera Window	Clean and inspect once a month	After 30 washes
Mopping pad	Clean after a mopping job	After 30 washes
Wick cap	Replace if dirty or shows wear	–

Note: iRobot manufactures various replacement parts and assemblies. If you think you need a replacement part, please contact iRobot Customer Care for more information. Replacement frequency may vary. Parts should be replaced if visible wear appears.

Emptying the Bin

1. Press bin release button to remove bin.



2. Open bin door to empty bin.



3. Place bin back in the robot.

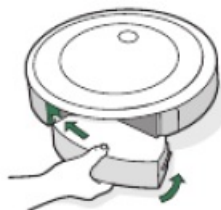

Cleaning the Filter

1. Remove the bin. Remove the filter by grasping both ends and pulling out.

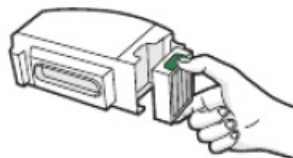

2. Remove debris by tapping the filter against your trash container.



3. Reinsert filter with ridged grips facing out. Place bin back in the robot.
4. The robot will not run if the filter is not installed correctly. Replace the filter every two months.

Cleaning the Full Bin Sensors

1. Remove and empty the bin.

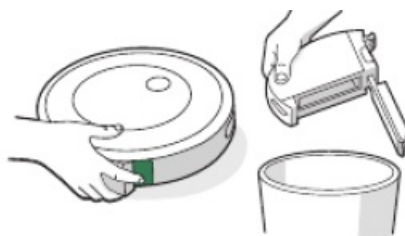

2. Wipe the inner sensors with a clean, dry cloth.

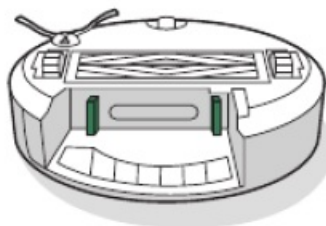

3. Wipe the bin door with a clean, dry cloth.

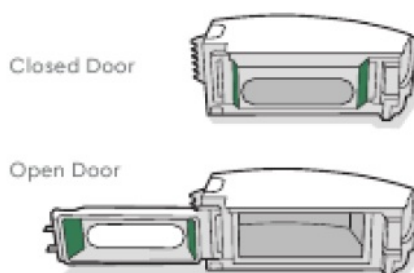

4. Washing the Bin

IMPORTANT INFORMATION

1. Do not wash the filter. Remove the filter before washing the bin.
2. Release the bin, remove the filter, and open the bin door.
3. Rinse the bin using warm water.

Note: Bin is not dishwasher safe.

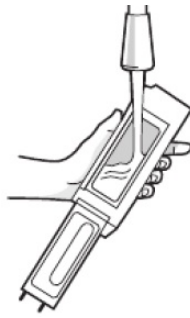

4. Make sure bin is completely dry. Reinsert filter and place bin back in the robot.

Cleaning the Edge-Sweeping Brush

1. Use a coin or small screwdriver to remove the screw holding the Edge-Sweeping Brush in place.
2. Pull to remove the Edge-Sweeping Brush. Remove any hair or debris, then reinstall the brush.

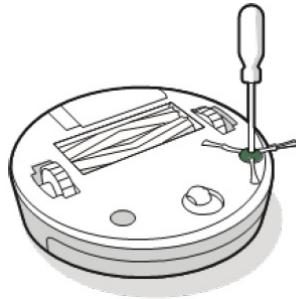

Cleaning the Front Caster Wheel

1. Pull firmly on the front wheel module to remove it from the robot.
2. Pull firmly on the wheel to remove it from its housing (see illustration below).
3. Remove any debris from inside the wheel cavity.
4. Reinstall all parts when finished. Make sure the wheel clicks back into place.

IMPORTANT INFORMATION

A front wheel clogged with hair and debris could result in damage to your floor. If the wheel is not spinning freely after you have cleaned it, please contact Customer Care.

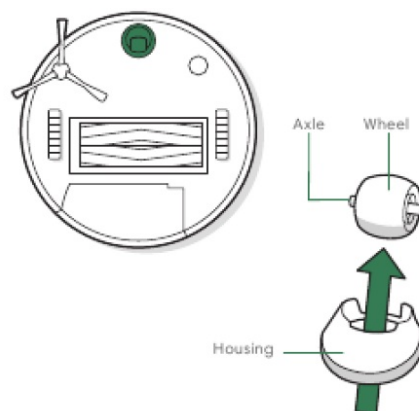

Cleaning the Multi-Surface Brushes

1. Pinch the brush frame release tab, lift the tab, and remove any obstructions.

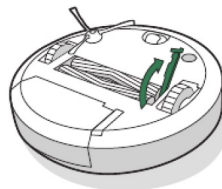

2. Remove the brushes from the robot. Remove the brush caps from the ends of the brushes. Remove any hair or debris that has collected beneath the caps. Reinstall the brush caps.

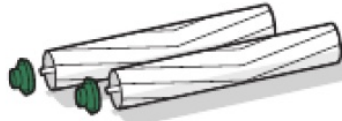

3. Remove any hair or debris from the square and hexagonal pegs on the opposite side of the brushes.



4. Remove the bin from the robot and clear any debris from the vacuum path.

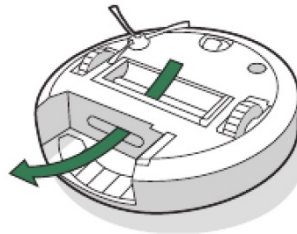

5. Reinstall the brushes in the robot. Match the shape of the brush pegs with the shape of the brush icons in the cleaning head module.

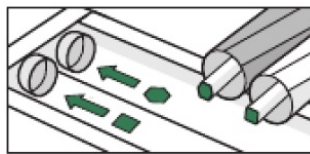

6. Cleaning the Sensors, Camera Window and Charging Contacts
7. Wipe sensors, camera window, and charging contacts with a clean, dry cloth
8. Do not spray cleaning solution or water onto the sensors or sensor openings.

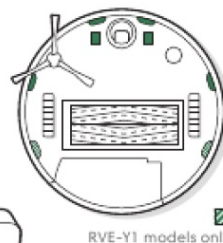

RVE-Y1 models only

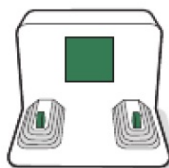

Cleaning the Mopping Pad

HAND WASHING

Thoroughly wash the pad with warm water.

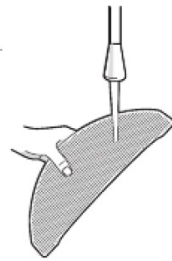

MACHINE WASHING

Wash using the warm cycle, then air dry. Do not tumble dry. Do not wash with delicates.

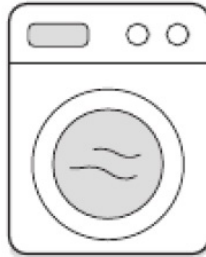

Replacing the Wick Cap

1. Remove pad plate

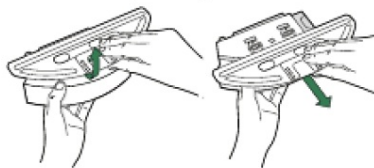

2. Remove the wick cap by pulling on the side rubber tab. Replace with a new wick cap, pressing firmly into place to create a tight seal to prevent leaking.
3. Reinsert all pad plate.



Download PDF: [iRobot j5 Roomba Combo Robot Vacuum User Manual](#)

References

- [User Manual](#)

[Manuals+](#), [Privacy Policy](#)

This website is an independent publication and is neither affiliated with nor endorsed by any of the trademark owners. The "Bluetooth®" word mark and logos are registered trademarks owned by Bluetooth SIG, Inc. The "Wi-Fi®" word mark and logos are registered trademarks owned by the Wi-Fi Alliance. Any use of these marks on this website does not imply any affiliation with or endorsement.