



IRIS BLND G1 Professional 3 Speed Blender User Manual

[Home](#) » [IRIS](#) » IRIS BLND G1 Professional 3 Speed Blender User Manual 



Contents

- [1 BLND G1 Professional 3 Speed Blender](#)
- [2 IMPORTANT SAFEGUARDS](#)
- [3 PARTS AND FEATURES](#)
- [4 BEFORE FIRST USE](#)
- [5 HOW TO USE](#)
- [6 CLEANING AND MAINTENANCE](#)
- [7 TROUBLESHOOTING](#)
- [8 SPECIFICATIONS](#)
- [9 MANUFACTURER _YEAR WARRANTY](#)
- [10 Documents / Resources](#)
 - [10.1 References](#)
- [11 Related Posts](#)

BLND G1 Professional 3 Speed Blender

Thank you for your purchase. Read this instruction manual carefully to ensure proper use. Read all safety precautions prior to use. Save this instruction manual for future reference.

READ AND SAVE THESE INSTRUCTIONS

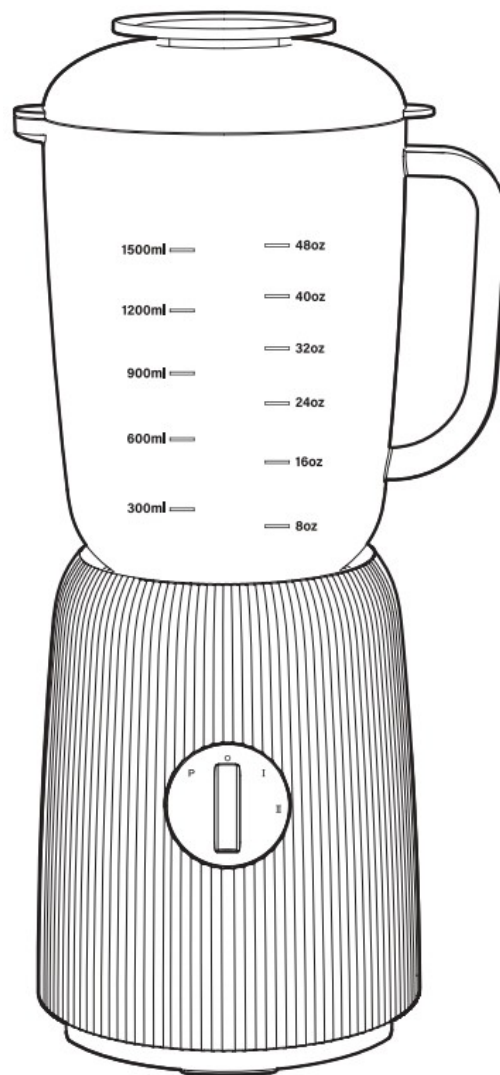

IMPORTANT SAFEGUARDS

Read all instructions and precautions before using.

When using Blender, the following safety instructions and precautions should always be followed.

Graphic symbol Indications: Indicates content that could lead to death or injury if handled incorrectly.

 CAUTION	 PROHIBITED	 INSTRUCTION LOWED
--	---	--

Disassembly prohibited.

- Do not disassemble the Motor Unit. It must be serviced or repaired only by authorized personnel.

Product use.

- When blending hot liquids, remove center piece of two-piece cover.
- Be sure that the Jar Cover is in place before blending.
- Do not touch the Blade when emptying and cleaning the Jar.
- To avoid the risk of electrical shock, do not immerse the Motor Unit in water or any liquid.

- Do not use Blender by or near children.
- This appliance is not intended for use by persons (including children) with reduced physical, sensory, or mental capabilities, or lack of experience and knowledge unless they are closely supervised and instructed concerning the use of the appliance by a person responsible for their safety. Close supervision is necessary when any appliance is used by or near children. Children should be supervised to ensure that they do not play with the appliance.
- Avoid contact with any moving parts. (Do not attempt to override any safety mechanisms.)
- Do not use any attachments (including canning jars) that are not recommended or sold by manufacturer. Fire, electric shock, or injury may occur.
- Do not use Blender outdoors.
- Keep hands and utensils out of the Jar while blending, to reduce the risk of severe injury to persons or damage to the Blender. A scraper may be used but must be used only when the blender is not running. Blade is sharp. Do not touch.
- To reduce the risk of injury, do not place the Blade Base on the Motor Unit without the Blender Jar Unit properly attached.
- Always operate Blender with Jar Cover in place.
- Do not leave Blender unattended when the Blade is running.
- Do not separate the Blender Jar Unit from the Motor Unit while the Blade is running.
- Wash the Cover Cap, Jar Cover, Silicone Gasket, Jar, Blade, Seal Ring, and Blade Base before first use.



Unplug.

- Unplug from outlet when not in use, and before assembling or disassembling Blender. Do not touch inside of the Jar, Blade, and Blade Base when Blender is plugged in. Turn Blender off and unplug before changing or replacing parts.
- To unplug, grasp the plug and pull from the outlet. Never pull from the power cord.



Use power plug and cord correctly.

- Do not operate any appliance with a damaged cord or plug or after the appliance malfunctions or is dropped or damaged in any manner. Contact the manufacturer at their customer service telephone number for information on examination, repair, or adjustment.
- Do not leave the cord over edge of counter or table, on hot surface.
- This appliance has a polarized plug (one prong is wider than the other). To reduce the risk of electric shock, this plug is designed to only fit in a polarized outlet one way. If the plug does not fit into the outlet or offers resistance when inserting into the outlet, please confirm the plug is oriented correctly. If it still does not fit, contact a qualified electrician. Do not modify the plug in any way.

SAVE THESE INSTRUCTIONS

PARTS AND FEATURES

Product Diagram

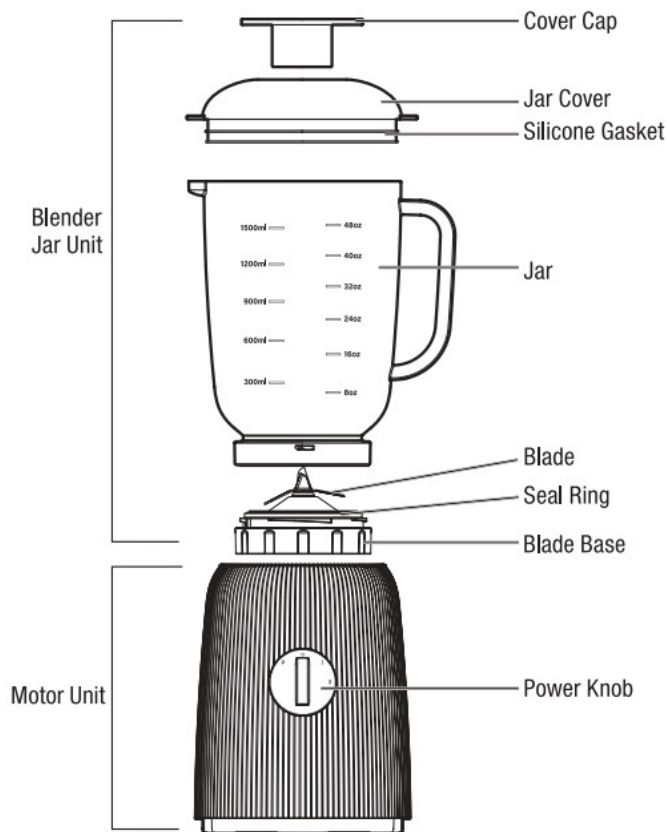

Power Knob

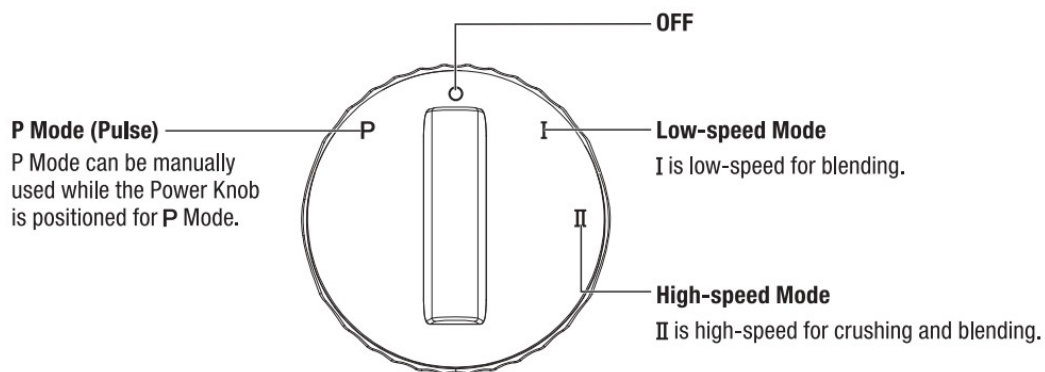

BEFORE FIRST USE

1. Before assembling the unit, make sure all parts are included.
2. Blender Unit may already be assembled with the Cover Cap, Jar Cover, Silicone Gasket, Jar, Cover Cap, Jar Cover, Silicone Gasket, Jar, Blade, Seal Ring, and Blade Base, do not wash the Motor Unit.
3. Wash the Cover Cap, Jar Cover, Silicone Gasket, Jar, Cover Cap, Jar Cover, Silicone Gasket, Jar, Blade, Seal Ring, and Blade Base before first use. Do not reassemble the unit while the parts are not completely dry.
 - (1) Turn the Jar upside-down and place on a level surface as (Fig.1) shows. Put the Seal Ring back onto the Blade Base. While holding the Jar Handle, place the Blade Base onto the bottom of the Jar, and tighten it counter-clockwise securely. (See Fig.1)

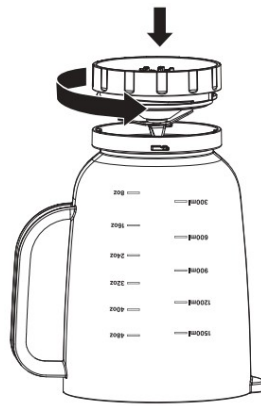

(Fig.1)

(2) Turn the Jar upright s (Fig.2) shows. Put the Silicone Gasket back onto the Jar Cover. Place the Jar Cover onto the top of the Jar. Attach the Cover Cap to the Jar Cover.

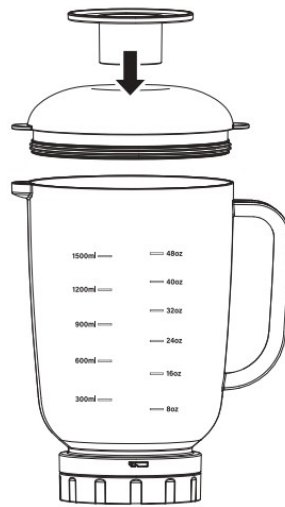

(Fig.2)

(3) Place Blender Jar Unit onto the Motor Unit. Make sure to locate the tabs on the both sides of the Blade Base corresponding the strips on the Motor Unit. Tighten the Blender Jar Unit securely until it makes the click sound.

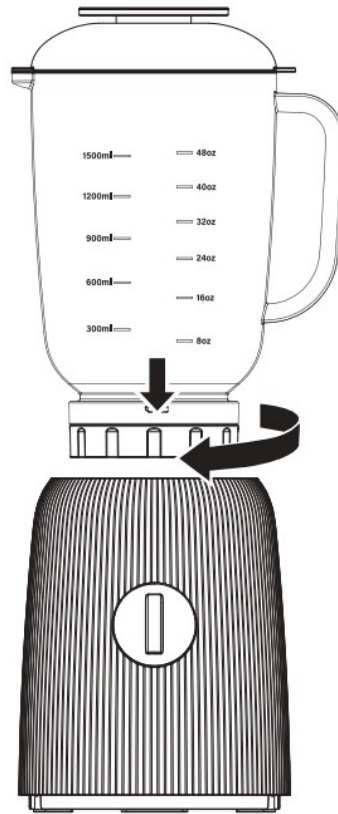

(Fig.3)

HOW TO USE

1. Prepare fruits or vegetables (Peeling, cutting etc.)
2. Put the ingredient (s) into the Jar. Adding certain amount of water is recommended for blending smoothly. The ideal ratio of the ingredient (s) and water is 2:3. The mixture amount should not exceed the 50.7 oz (1500 ml) level as indicated on the Jar.
3. Place the Jar Cover onto the Jar. Be sure that the Cover Cap is attached to the Jar Cover.
4. Plug the cord and turn the Power Knob to the appropriate mode for the ingredient (s).
5. For optimal blending task, turn the Power knob to P Mode and hold for a few seconds. Upon releasing the Power Knob, it returns to o position (OFF) automatically and the Blade stops blending. Repeat this process several times until the ingredient (s) in the Jar becomes the desired profile.
6. When adding more ingredient (s) while blending, take the Cover Cap off the Jar Cover and add the more ingredient (s) through the hole. (See Fig.4)

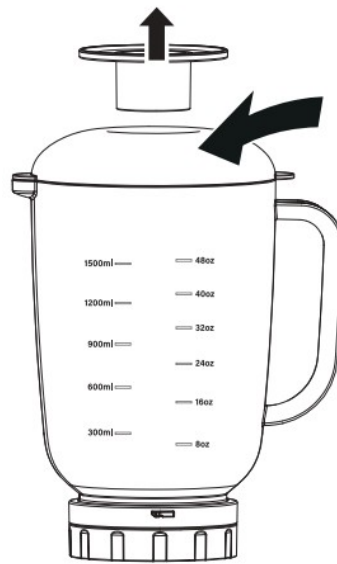

(Fig.4)

7. When crushing ice or blending hard ingredient (s), keep one hand securely on the Jar Cover.
8. When the desired mixture is made, turn the Power Knob to © position (OFF).

Example

INGREDIENT	PROFILE	AMOUNT	MODE
Carrot	Cut into 0.6 in*0.6in*0.6 in	Carrot 20.3 Oz/ 600 ml Water 30.4 Oz/900 ml	II
Crushed ice	0.6in*0.6in*0.6in	3.50z/100 ml	P

CAUTION

- When blending for more than 3 minutes, an interval of at least 10 minutes must be applied for continuous operation. The Motor Unit must be at the ambient temperature before the next operation.
- Turn the Power Knob to o position (OFF) anytime when Blender needs to stop operating.
- Do not use Blender with any boiling liquids and run Blender with no ingredient(s).

Additional Tips

- For blending smoothly ingredient (s) and liquid, add liquid into the Jar first, and then add ingredient (5).
- The following tasks may not be performed properly with Blender: Beating egg whites, whipping cream, mashing potatoes, grinding meat, mixing dough, extracting juice from fruits and vegetables.
- The following ingredients should not be added into Blender. May result in severe damage to Blender: Bones, large pieces of solid or frozen food, hard ingredients (such as turnips).
- To make crushed ice, add up to 6 ice cubes first. Add more ice cubes through the hole when necessary. (See Fig.5)

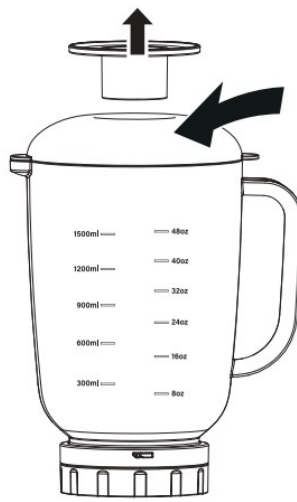

(Fig.5)

CLEANING AND MAINTENANCE

This product contains parts that should not be repaired by the user. Ask a qualified service personnel for maintenance service.

1. Before cleaning, unplug Blender
2. Always rinse immediately after use. Do not leave residual mixture in the Jar.
3. When washing the inside of the Jar, pour a small amount of warm water and dishwashing soap. After putting the Jar Cover on, turn the Power Knob to P Mode for a few seconds.
4. Separate the Blender Jar unit from the Motor Unit. Turn the Blade Base clockwise to take off the Jar. (See Fig.6, Fig.7, Fig.8)



(Fig.6)

5. The Cover Cap, Jar Cover, Silicone Gasket, Jar, Seal Ring, and Blade Base are dishwasher safe. When washing them in household dishwasher, the temperature setting must be below 149 °F/65 °C. Otherwise, rinse them by hand.

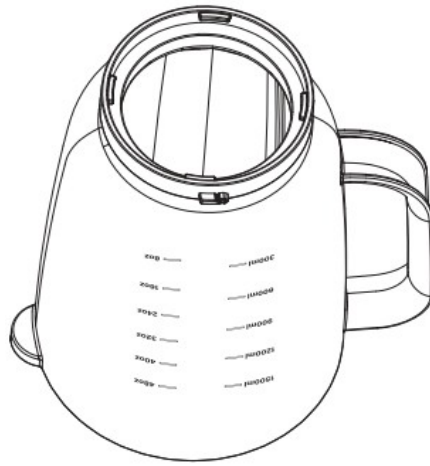

(Fig.7)

6. Use warm water and dishwashing soap when brushing the Blade. Rinse it thoroughly under the tap. Do not touch the blade by hand. Do not soak the Blade in water. When drying the Blade, Keep it away from children.



(Fig.8)

7. Wipe the Motor Unit with a damp cloth and dry completely. Apply non-abrasive cleaner for the tough stain spots. When liquid has spilled into the Motor Unit, unplug Blender, wipe with a damp cloth, and dry completely.



CAUTION

Do not immerse the motor unit in liquid to prevent the risk of electric shock.
Do not use rough scouring pads or cleaners on parts.

TROUBLESHOOTING

Read the following steps carefully to fix common problems.

PROBLEM	POSSIBLE CAUSES	SOLUTION
The unit does not work	Check if the electric cord is plugged into the outlet	Plug the electric cord into the outlet
	Check if power supply is running properly	Check the circuit breaker (fusebox).
	Check if the unit is overheated	Turn off the unit and allow it to cool down before restarting
	Check if the Jar is filled with too many ingredients	Turn off and unplug the unit, and remove some ingredients. Stir evenly before restarting.
The Blade rotation is very slow	Check if the Jar is filled with too many ingredients	Turn off and unplug the unit. Remove some ingredients. Stir evenly before restarting.

ow	Check if less liquid is in the Jar	Turn off the unit and add some liquid before restarting.
The ingredients are not mixed well enough	Profile of the ingredients is too big or coarse	Turn off and unplug the unit, and remove some ingredients. Cut them into 's small pieces.
	Check if the Jar is filled with too many ingredients	Turn off and unplug the unit. Remove some ingredients. Stir evenly before restarting.
	Check if tendons are in the Jar	Tendons and hard ingredients can break the Blade. Do not continue to mix them in the Jar.
	Check if hard ingredients are in the Jar	
Burnt smell during the operation	The unit has been used for the first time	The smell could be noticeable during the first use. Afterwards, it will dissipate.
	The unit has been running continuously for more than 3 minutes	The blending time should not exceed 3 minutes. Allow the unit to cool down before restarting.
	Check if the Jar is filled with too many ingredients	Turn off and unplug the unit. Remove some ingredients and allow the unit to cool down for 30 minutes before restarting. Stir evenly before restarting.
'Smoke comes out of the unit during operation	Check if the Jar is filled with too many ingredients	'The Motor Unit shuts down due to excessive amount of ingredients in the Jar. This is to protect the Motor Unit, not product failure.
	The unit has been running continuously for more than 3 minutes	Turn off and unplug the unit. Remove some ingredients and allow the unit to cool down for 30 minutes before restarting.
	Ingredient amount exceeds the limit of the Jar's capacity	The Motor Unit may stop running due to excessive amount of ingredients in the Jar.
The unit stops suddenly during operation	Check if the Jar is filled with too many ingredients	The Motor Unit shuts down due to excessive amount of ingredients in the Jar. This is to protect the Motor Unit, not product failure.
	The unit has been running continuously for more than 3 minutes	Turn off and unplug the unit. Remove some ingredients and allow the unit to cool down for 30 minutes before restarting.
	Ingredient amount exceeds the limit of the Jar's capacity	The Motor Unit may stop running due to excessive amount of ingredients in the Jar.

If a problem cannot be resolved by the steps listed above, contact IRIS USA, Inc. Customer Service.

SPECIFICATIONS

RATED VOLTAGE	120V~
RATED FREQUENCY	60 Hz
RATED CURRENT	3A
PRODUCT SIZE (APPROXIMATELY) (NOT INCLUDING THE POWER CORD)	7.5x 6.1 x15.7 in/190 x 155 x 400 mm
PRODUCT WEIGHT (APPROXIMATELY)	3.751bs/1.7 kg
CAPACITY	50.7 Oz/1500 ml
POWER CORD LENGTH (APPROXIMATELY)	43.3in/1.1m

*Specifications are subject change without notice.

MANUFACTURER _YEAR WARRANTY

THE MANUFACTURER WARRANTIES

IRIS USA, Inc. products are to be free from defects in material and workmanship under normal non-commercial, household use, when operated and cared for in accordance with the Manufacturer's written instructions provided.

THE 1-YEAR WARRANTY ("WARRANTY") DOES NOT COVER

Any damage caused by accident, misuse, or abuse, including without imitation, damage caused by use in a humid area, improper cleaning, neglect, alteration, fire, theft, non-recommended temperature use and does not apply to minor imperfections, scratches, stains, discoloration, surface markings as a result of shipping or other damage to external or internal surfaces which does not impair the utility and/or functionality of the product.

TO OBTAIN SERVICE

If service should be necessary, you should contact IRIS USA, Inc. Customer Service (*Customer Service") at 1-800-320-4747. You may then return the properly packaged product(s), (using adequate packing and shipping material to prevent damage in transit), with postage prepaid along with name, address, telephone number, model number, and proof of date of purchase (a copy of the receipt) and a detailed description of the claimed defect. This warranty shall not cover any damage incurred to the products during transit to Customer Service. You shall have the obligation and responsibility to: pay for all services and parts not covered by the warranty.

MANUFACTURER'S OBLIGATION

The Warranty may not be altered, expanded, extended, revised or varied except by written instrument executed by the Manufacturer.

THE MANUFACTURER'S LIABILITY UNDER THIS WARRANTY IS LIMITED TO THE REPAIR OR REPLACEMENT OF THE DEFECTIVE PRODUCT(S) AT THE MANUFACTURER'S SOLE AND EXCLUSIVE OPTION. THE MANUFACTURER WILL REPLACE ANY ITEM FOUND TO BE DEFECTIVE IN MATERIAL OR WORKMANSHIP WITH THE MOST COMPARABLE CURRENT ITEM. IRIS USA, INC. DOES NOT ACCEPT SPECIAL REQUESTS, NOR DO WE HAVE THE ABILITY TO UPGRADE IN EXCHANGE FOR MONEY. THE MANUFACTURER SHALL NOT BE LIABLE FOR ANY SPECIAL, INCIDENTAL OR CONSEQUENTIAL DAMAGES, WHETHER DIRECT OR INDIRECT. THE WARRANTIES SET FORTH HEREIN ARE EXCLUSIVE AND NO OTHER WARRANTIES, EXPRESS OR IMPLIED, INCLUDING BUT NOT LIMITED TO ANY WARRANTY OF MERCHANTABILITY OR FITNESS FOR A PARTICULAR PURPOSE OR USE ARE MADE WITH RESPECT TO THE PRODUCTS.

Some states do not allow the exclusion of limitation of incidental or consequential damages, so the above limitation exclusions may not apply. This Warranty gives specific legal rights, and there may also be other rights which vary from state to state.

DISCONTINUED ITEM RETURNED

If the item returned is discontinued and is no longer available, IRIS USA, Inc. will automatically replace your item with the most comparable item currently manufactured.



Attn: Customer Service (Returns Department)
IRIS USA, Inc.
13423 West Cactus Road
Surprise, AZ 85379
©2021 IRIS USA, Inc. All rights reserved.
310521-GCO-DIM-02

Documents / Resources

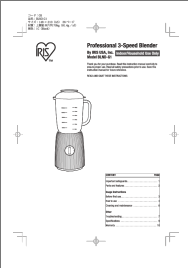
	<p>IRIS BLND G1 Professional 3 Speed Blender [pdf] User Manual BLND G1 Professional 3 Speed Blender, BLND G1, Professional 3 Speed Blender, 3 Speed Blender, Speed Blender, Blender</p>
--	--

References

- [User Manual](#)