



ipega PG-4019 Bumblebee Wireless Game Controller User Manual

[Home](#) » [ipega](#) » ipega PG-4019 Bumblebee Wireless Game Controller User Manual 



**Bumblebee wireless game controller
Product manual(PG-4019)English version**

Contents

- [1 Function keys:](#)
- [2 Specifications](#)
- [3 P4 Mode](#)
- [4 P3 / PC Mode](#)
- [5 IOS MFI Mode](#)
- [6 Controller charging function](#)
- [7 Accessories List:](#)
- [8 Documents / Resources](#)
- [9 Related Posts](#)

Function keys:

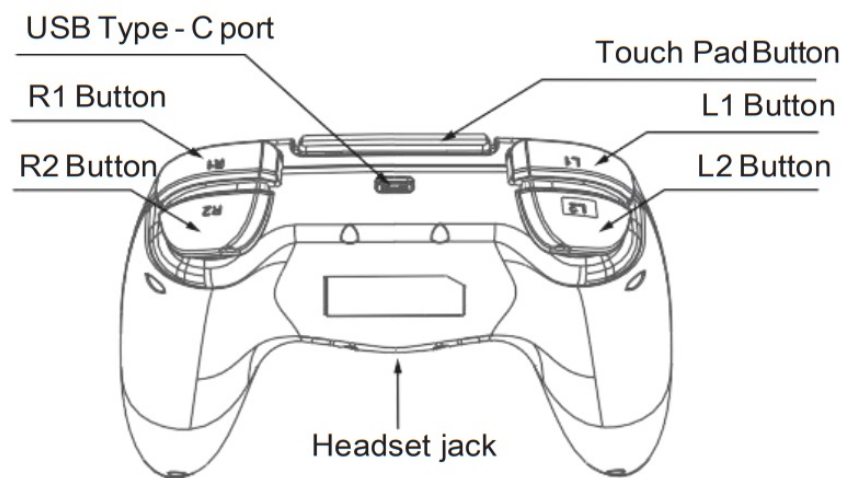
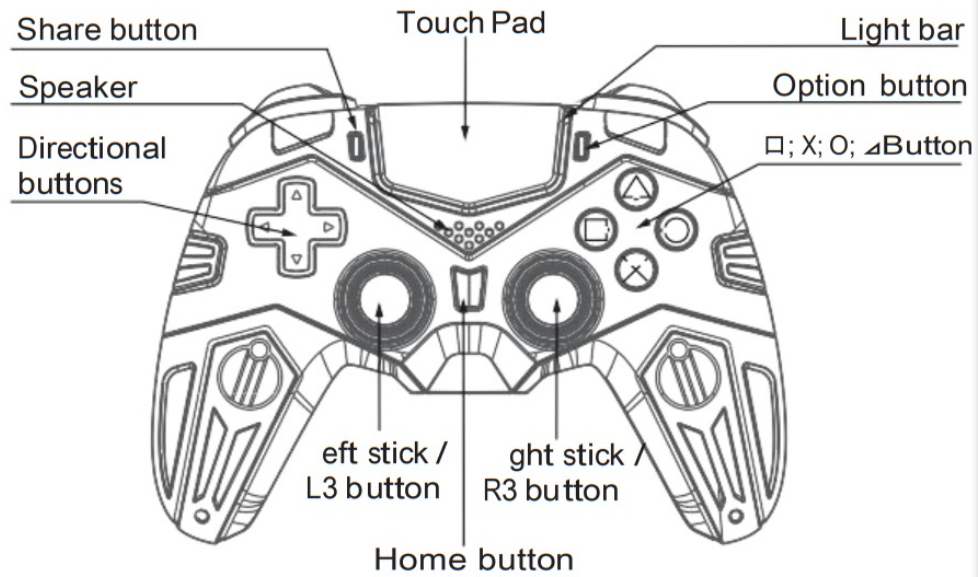

Specifications

Battery type.	Built-in battery
Voltage	DC4.2V
Input voltage	5V
Input current	500mA
Static current	<15uA
Battery capacity	600mAh
Wireless	Support
Supporting platform	P4 / P3 / PC / IOS
Working current	<70mA
Vibration	Yes
Speaker	Built-in speaker
Transmission distance	≤8M
Charging hours	3 hours

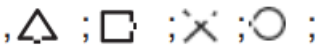
1. This product is able to support PS4, PS3, IOS 13.0 or above, and PC.
2. Using the wireless to connect between the device and the gamepad. Ensure to provide a reliable signal (within 8 meters).
3. Built-in LED light  button to be provided with backlight function.
4. Built-in left and right asymmetric motors, supporting dual motors and dual vibration functions.
5. Built-in 3D acceleration sensor and gyroscope sensor, with six-axis sensing function.
6. Equipped with speakers and a 3.5mm headset jack, which is able to output game audio signals through the handle's speakers and headphones.
7. The structure accords with ergonomics and feels comfortable.
8. The gamepad without any motion will go to the sleeping mode in 15 mins, the gamepad signal light will turn off.
9. Support dual-point capacitive sensing touchpad.
10. PC USB online upgrade product program, to support the latest upgrade system of PS4 host. It can avoid the console upgrade system issue.

**Due to the official game platform software upgrade or source code changes and other not resist factors caused of some games can not be played or connected with our gamepad. Our company has no responsibility, we reserve the right of final interpretation for this.

P4 Mode

1. Turn on the P4 console, using the Type-C USB cable to connect between the P4 console and gamepad.
2. Press the "Home" button to connect. Once they are connected, the light bar will be always on. Then unplug the USB cable.
3. The light bar will identify each user, and the console will automatically pair each gamepad. 1P: Blue | 2P: Red | 3P: Green | 4P: Pink

4. Six-Axis correction Turn off the gamepad, and press the “Option” button and “Home” button at the same time. When the light bar turns green, then press the “Option” button. Once the light bar is from green to red and blue, the correction has been done (place the gamepad on the table during the correction).
5. □ + △ + X + O button backlight on/off, press the “Share” button + □ button to switch (work in wireless mode).
6. Press the “Home” button for 10 sec to turn off the gamepad.

P3 / PC Mode

1. PC wired mode: Using the Type-C USB cable to connect between the gamepad and console usb port. Once the light bar turns green, the gamepad will default to Xbox360 ver. Press the “Home” button to switch P3 and Xbox360 ver. (Image 1)

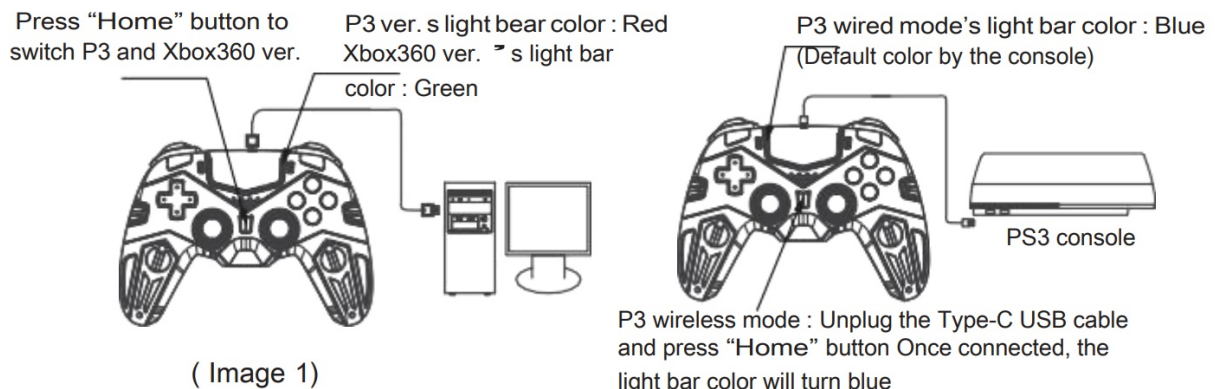

2. P3 wired mode: Turn on the P3 console, using the Type-C USB cable to connect between the P3 console and gamepad. Once they are connected, the light bar will turn blue. Switch to P3 wireless mode: Unplug the Type-C USB cable and press “Home” to turn on the gamepad.
- 3) PS3 / PC are not supported the Six-Axis function. While connecting to the PC, do not install any drivers and play it directly.
3. Update the gamepad firmware to avoid the disconnection between the gamepad and console.

IOS MFI Mode

1. Pairing step: Turn off the gamepad, press the” Share” + “Home” button to turn on the gamepad to pairing mode. Thelightbarwillflashblueandthespeakeremitasound same as motor vibrates.
2. In the IOS wireless list, find and click “DUALSHOCK 4 Wireless Controller” to pair. Once the pairing is successful, the blue light is always on.
3. When pairing successfully, you can play MFI-certified games.
4. □ + △ + X + O button backlight on/off: press “Share” + □ button to switch.
5. When the gamepad is off or in sleeping mode, press the “Home” button to connect it back, and the light bar will guide display blue, red, and green in the cycle. Once the speaker emits a sound same as the motor vibrates. □ + △ + X + O button backlight will turn on and the light bar will always be on.
6. Update the gamepad firmware to avoid the disconnection between the gamepad and console

Note: iOS devices only support the system version above iOS 13 to use

Controller charging function

1. Low battery: When the battery voltage gets down to 3.45V – 3.3V, the light bar will keep flashing. Below 3.3V, the gamepad will directly go to sleeping mode.
2. Charging instruction: When the gamepad is off, plug in the Type-C USB cable to charge the gamepad. During the charging mode, the light bar will turn yellow. Once it is finished, the light bar will turn off.
* When the charging is nearly finished, the light bar will flash to info the user almost ready.

Note

- A. Please do not store this product in wet or high-temperature areas.
- B. Don't knap, beat, drub, pierce, or try to decompose this product, to avoid unnecessary damage to the product.
- C. Nonprofessional personnel should not disassemble the product, otherwise it will not be covered in the after-sales warranty service.
- D. Due to the official game platform software upgrade or source code changes and other not resist factors caused some games can not be played or connected with our gamepad. Our company has no responsibility, we reserve the right of final interpretation for this.

Accessories List:



Wireless gamepad x 1

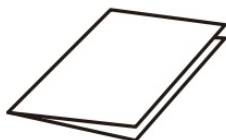

User Manual x 1



Type-C cable x 1

ipega trademarks belong to PEGA LIMITED.

This device complies with Part 15 of the FCC Rules. Operation is subject to the following two conditions: (1) this device may not cause harmful interference, and (2) this device must accept any interference received, including interference that may cause undesired operation

NOTE: This equipment has been tested and found to comply with the limits for a Class B digital device, pursuant to Part 15 of the FCC Rules. These limits are designed to provide reasonable protection against harmful interference in a residential installation. This equipment generates, uses, and can radiate radio frequency energy and, if not installed and used in accordance with the instructions, may cause harmful interference to radio communications. However, there is no guarantee that interference will not occur in a particular installation. If this equipment does cause harmful interference to radio or television reception, which can be determined by turning the equipment off and on, the user is encouraged to try to correct the interference by one or more of the following measures:

- Reorient or relocate the receiving antenna.
- Increase the separation between the equipment and receiver.
- Connect the equipment into an outlet on a circuit different from that to which the receiver is connected.
- Consult the dealer or an experienced radio/TV technician for help.

Warning: Changes or modifications not expressly approved by the party responsible for compliance could void the user's authority to operate the equipment

Documents / Resources



[ipega PG-4019 Bumblebee Wireless Game Controller](#) [pdf] User Manual
P4019, 2A5T5-P4019, 2A5T5P4019, PG-4019 Bumblebee Wireless Game Controller, PG-4019
, Bumblebee Wireless Game Controller