



ION PA Glow Max User Guide

[Home](#) » [ION](#) » ION PA Glow Max User Guide 



TOTAL PA™ GLOW MAX

Quickstart Guide

Contents

- [1 Introduction](#)
- [2 Box Contents](#)
- [3 Support](#)
- [4 Speaker Stand Installation](#)
- [5 Setup](#)
- [6 Connection Diagram](#)
- [7 Features](#)
- [8 Rear Panel](#)
- [9 Media Panel](#)
- [10 Remote Control](#)
- [11 Operation](#)
- [12 Pairing with a Bluetooth Device](#)
- [13 SD/USB Mode](#)
- [14 App Control](#)
- [15 Troubleshooting](#)
- [16 Appendix](#)
- [17 Technical Specifications](#)
- [18 Trademarks & Licenses](#)
- [19 Documents / Resources](#)
 - [19.1 References](#)
- [20 Related Posts](#)

Introduction

Thank you for purchasing the Total PATM Glow Max. At ION, your entertainment is as important to us as it is to you. That's why we design our products with one thing in mind— to make your life more fun and more convenient.

Box Contents

Total PA™ Glow Max
Power Cable (5 ft. / 150 cm)
Microphone with cable (15 ft. / 450 cm)
Remote Control
Speaker Stand
Quickstart Guide

Support

For the latest information about this product (documentation, technical specifications, system requirements, compatibility information, etc.) and product registration, visit ionaudio.com.
For additional product support, visit ionaudio.com/support.

Speaker Stand Installation

1. Extend the speaker stand tripod legs on a flat, stable surface. Fully extend the legs until the plastic bracket is stopped by the bumps on the center pole. Insert the lower pin directly above the lower adjustment knob and tighten the lower adjustment knob.
2. Raise the mounting pole up to the appropriate height needed and tighten the side adjustment knob. When raising the mounting pole, make sure the end with the upward pointing arrow is on the top.
3. Insert the upper pin into the upper pin-hole so the mounting pole stays at your set height, and tighten the side adjustment knob.
4. On Total PATM Glow Max, adjust the bottom knob counter-clockwise so the screw is not blocking the opening.
5. Line up the Total PA™ Glow Max mounting hole with the speaker stand pole and place on the pole.
6. Tighten the mounting knob clockwise on Total PA™ Glow Max.

Note: Remove Total PATM Glow Max prior to moving the stand for maximum safety.

Setup

1. Make sure all items listed in the Box Contents are included in the box. Look in the box under the foam sheet for the power cable and microphone.
2. Read the Safety & Warranty Manual before using the product.
3. Study the Connection Diagram.
4. Make sure all input devices (such as microphones, CD players, or digital media players) are turned off with their volume settings set to "zero."
5. Connect all devices as shown in the Connection Diagram.
6. Switch everything on in the following order:
 - a. Audio input devices (e.g. microphones, instruments, CD players)
 - b. Total PA™ Glow Max
7. When you are finished using Total PA™ Glow Max, switch everything off in the following order:
 - a. Total PA™ Glow Max
 - b. Audio input devices

Connection Diagram

Items not listed under the Box Contents are sold separately.

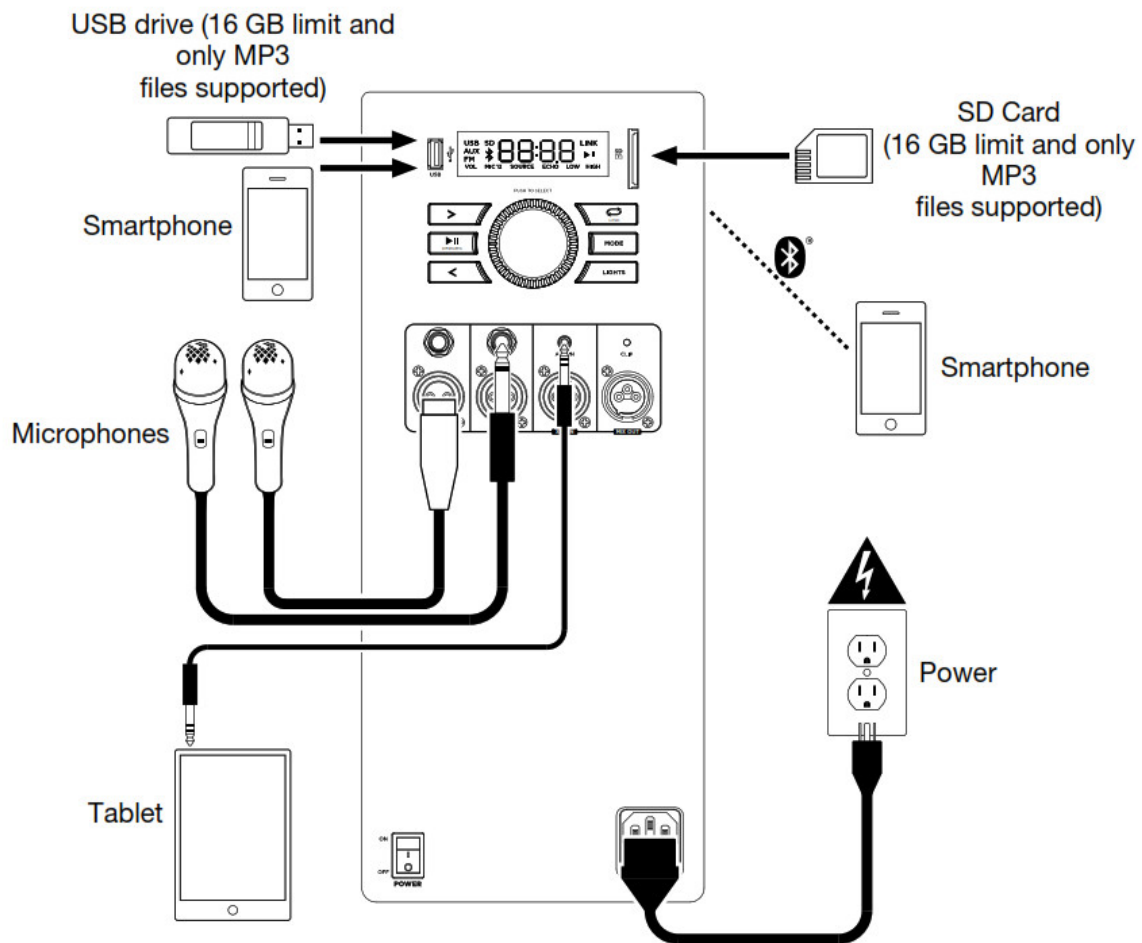

Features

Rear Panel

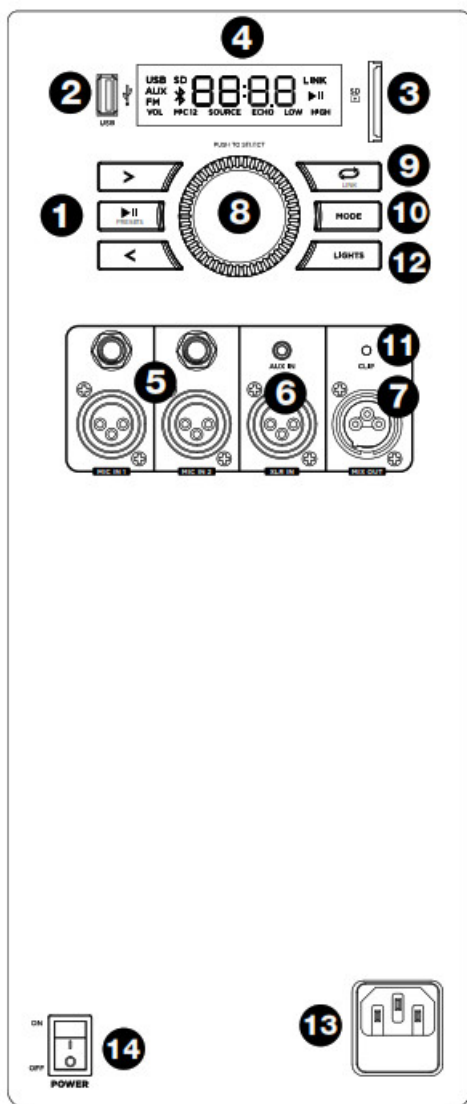

1. **Media Panel Buttons:** Controls for the USB/SD, FM radio, and Bluetooth® audio sources. These controls include mode selection and music playback options. See Media Panel for more information.
2. **USB Port:** Connect your USB flash drive here to play music. You can also use this port for charging the USB device, such as a tablet or smartphone. To charge a device that is streaming music via Bluetooth, pause the music first and then wait for it to reconnect after the USB cable is inserted.
3. **SD Card Slot:** Insert your SD card here to play music.
4. **Display:** This screen shows information relevant to Total PATM Glow Max's current operation.
Note: The Display comes with a plastic protector on it. Remove this for optimal viewing.
5. **Mic Inputs (1/4"/6.35 mm & XLR):** Connect a microphone or mic-level source to these inputs.
6. **Aux Inputs (1/8" & XLR):** These inputs can be used to connect a CD player, MP3 player, or other audio source.
7. **Mix Out (XLR):** Connect this output to a speaker, mixer, or recorder.
8. **Control Knob:** Turn this knob to adjust the main volume (overall output) of the loudspeaker. Push this knob to select and make adjustments to the mic 1 volume, the mic 2 volume, source volume (radio, USB, SD, Bluetooth signal, and aux input), echo effect, high EQ, and low EQ. The volume of Total PATM Glow Max does not affect your Bluetooth device volume. For the best sound quality, set your

input source volume to 100% and use the Source and Main Volume control of the speaker to adjust the volume.

9. **Repeat/Link:** In USB or SD mode, press this button to repeat a single track, folder, or all tracks. Press and hold this button to start stereo linking to another compatible ION speaker (see ionaudio.com for a list of compatible speakers).
10. **Mode:** Press this button to select the audio source to use: USB, SD, FM radio, Aux (available to select when the USB port and SD card slot are empty), or Bluetooth.
11. **Clip LED:** The Clip LED will flash red if the signal from the input jacks or Media Panel audio source is clipping (distortion from an overly loud signal). If this happens, decrease the setting of the Main Volume knob or the volume for the Aux/Mic Input (if a loud device is plugged into either).
12. **Light Mode Button:** Press this button to toggle between one of these five modes for the lights on the front panel.
 - **Color Cycle:** The lights slowly glow and cycle through colors. This is the default mode when Total PATM Glow Max is first powered on. Press and hold the light mode button to freeze the lights on one color. Press and release the button to unfreeze.
 - **Beat Sync:** The lights flash and change colors according to the tempo of the music playing on the speaker. For the best lighting effect, you may need to adjust the volume of your device, the source volume, and/or the main volume.
 - **Color Wheel:** The lights rotate in a wheel of all colors.

- **Color Beat Sync:** The lights rotate in a wheel of all colors and change direction and speed according to the tempo of the music playing on the speaker. For the best lighting effect, you may need to adjust the volume of your device, the source volume, and/or the main volume.

- **Off:** The lights turn off.

13. **Power Cable Input (IEC):** Insert the included power cable here to charge the unit.

14. **Power Switch:** Flip this switch to toggle the speaker's power on or off.

Note: Total PATM Glow Max will power off after 15 minutes with no audio playing.

Media Panel

Use the following buttons on the Media Panel to control the USB/SD, FM Radio, and Bluetooth audio sources.

Mode: Press this button to switch the audio source between USB/SD, FM radio, Aux (available to select when the USB port and SD card slot are empty) and Bluetooth. The default mode when powering on Total PA™ Glow Max is Bluetooth. The USB/SD mode is only selectable if a USB drive or SD card is plugged into Total PA™ Glow Max; otherwise, the Mode button will toggle between Bluetooth, Aux, and FM radio only.

Note: Your USB drive or SD card cannot be more than 16 GB and it must contain playable files in order for its data to appear properly in the Display. It can have MP3 files. When you connect a USB drive or SD card with playable files, Total PATM Glow Max will order the files alphabetically by folder on the root directory and then by track name in the folder.

Play/Pause: When USB/SD is selected as the audio source, press this button to play/pause the currently selected track. Double press this button to stop playback and return to the beginning of the track list. When Bluetooth is selected as the audio source, press this button to play/pause the currently selected track or press and hold this button to turn voice prompts on/off.

Repeat: Press this button to cycle through the five repeat/shuffle options:

- Play the USB/SD folder's tracks in order with repeat/shuffle off (OFF).
- Play the tracks in random order (Rd0).
- Play the current USB/SD track on repeat (ONE).
- Play all the tracks on the USB drive or SD card on repeat (ALL).
- Play the current folder's tracklist on repeat (F0d). The folder used is based on what song is playing when it is activated. For instance, if a song playing is on the root level, selecting F0d will repeat only songs at the root level. If a song is in folder "A", then only songs in folder "A" will be repeated.

Previous: When USB/SD or Bluetooth is selected as the audio source, press this button to go to the previous track in the playlist.

Next: When USB/SD or Bluetooth is selected as the audio source, press this button to go to the next track in the playlist.

Note: In some apps on Bluetooth devices, pressing the < (Previous) or > (Next) buttons may change the playlist or music genre rather than the track.

Remote Control

Stop: Stops the media panel source from playing.

Mode: Selects the media panel source: Aux, USB, SD, FM radio, or Bluetooth.

Mute: Silences the music playback on media panel sources. Press Mute again to un-mute the music playback.

Prev: Goes to the previous USB or SD card track. When listening to Bluetooth sources, pressing Prev in some apps may go to another playlist or music genre. When listening to the FM radio, press the Prev button to tune the

radio station down.

Next: Advances to the next USB or SD card track. When listening to Bluetooth sources, pressing Next in some apps may go to another playlist or music genre. When listening to the FM radio, press the Next button to tune the radio station up.

Play/Pause: Plays or pauses the USB, SD, or Bluetooth media panel source. Files are played from the USB or SD source first by alphabetical order of what is on the root level, then alphabetical by folder, and then alphabetical by the track name. In Radio Mode, double press the Play/Pause button to toggle through radio presets.

Vol -: Decreases the Main Volume.

Vol +: Increases the Main Volume.

EQ: Press this button to toggle through EQ presets (the preset name will be shown on the display).

100+: Jumps ahead by 100 tracks.

200+: Jumps ahead by 200 tracks.

Number Keys: Provides track selection for USB and SD card sources.

Operation

Using the Control Knob

The Control Knob defaults to controlling the Main Volume for all channels. Press the Control Knob to toggle through different functions: Mic Channel, Source, Echo effect level, and EQ.

- Press the Control Knob to select the Mic channel 1 or 2. Rotate the Control Knob to raise or lower the volume of the Mic input independently of the other channels.
- Press the Control Knob again to select Source. Rotate the Control Knob to raise or lower the volume of the Aux/BT/USB/Radio signal independently of the Mic channels.
- Press the Control Knob again to control the Echo effect level for the Mic channel.
- Press the Control Knob again to select Low EQ adjustment. Rotate the Control Knob to raise or lower the low frequencies on all channels.
- Press the Control Knob again to select High EQ adjustment. Rotate the Control Knob to raise or lower the high frequencies on all channels.
- Press the Control Knob again to return to Main Volume adjustment. If there is no activity on the Control Knob for 5 seconds, the function will go back to Main Volume.

Pairing with a Bluetooth Device

1. Power on the Total PATM Glow Max by flipping the on/off switch. Total PATM Glow Max will automatically enter Bluetooth pairing mode.
2. Navigate to your device's Bluetooth setup screen, find Total PA Glow Max, and connect. Do not connect to Total PA Glow Max_BLE; this is reserved exclusively for connecting to the ION Sound XPTM app. When connected, the Bluetooth icon on the display will flash and you will hear "Connected". Note: If you experience trouble in connecting, select "Forget this Device" on your Bluetooth device and try to connect again.
3. To disconnect, turn off Bluetooth from your device's Bluetooth settings.

Linking Two Compatible Speakers (Stereo-Link 2.0™):

1. Power on both Total PATM Glow Max speakers by flipping their on/off switches. Make sure they are in Bluetooth pairing mode and not connected to a device.
2. Press and hold the Repeat/Link button on one speaker (the primary speaker which will control both) to enter

Stereo Link mode. Once a link has been established, the word LINK will appear on both speaker displays.

3. Connect to the primary speaker via Bluetooth. To disconnect, double press the Repeat/Link button.

Note: The speakers should be within 100' (33.3 m) of each other to properly link. Note: Total PATM Glow Max is not compatible with previous ION PA models. To link to a previous model, use an XLR cable (not included) and link from the newer PA to the previous one via the XLR Out on Total PATM Glow Max and the XLR Aux In on the previous model.

SD/USB Mode

Press the Mode button to toggle through to select SD or USB mode. Total PATM Glow Max will automatically play the first compatible file. Files are played in alphabetical order of what is on the root level, then alphabetical by folder, and then alphabetical by track name. Media playback will stop when all media has been played on the SD card or USB drive. Press and hold the Next and Previous buttons to fast forward or rewind within the song.

Note: The SD card or USB drive must have playable files for it to appear on the media panel's display. If there is no USB drive or SD card inserted into the media panel, press and release the Mode button will toggle through Bluetooth and radio.

Repeat settings (abbreviations will show on the display):

- ALL: Repeat all of the tracks in the folder.
- FOLd: Repeat all of the tracks in the folder.
- OnE: Repeat the current playing USB track.
- rAn: Shuffle the track order.

App Control

IMPORTANT: To ensure the best possible experience with the app, use the most current Android OS or iOS on your device. Follow these steps to download the free app on your device:

1. Open the Apple App Store or Google Play on your device. Then, search for the ION Sound XP app.
2. Follow the on-screen instructions to download and install the app. Once downloaded, the ION Sound XP app will appear on your device's home screen.
3. Connect your device to Total PATM Glow Max via Bluetooth. See the Pairing with a Bluetooth Device to learn how to do this.
4. Open the ION Sound XPTM app. If prompted, allow the app to access your device's Bluetooth and Location Services.
5. Tap to select Add A Product on the screen. The app will scan and find Total PATM Glow Max. If you are having issues connecting, tap Help with setting up? for additional tips.
6. Select the Total PATM Glow Max icon to go to the next screen, where you can use the app to control various functions of the speaker such as:
 - **Radio:** Play the radio, change stations, and edit presets.
 - **EQ:** Adjust the speaker's equalization, and enable or disable Bass Boost.
 - **Volume:** Adjust the speaker volume and microphone volume.
 - **Voice Prompts:** Enable or disable the voice prompts.
 - **Support:** Visit ionaudio.com, contact Technical Support, and view Warranty information and Frequently Asked Questions.

Troubleshooting

If the sound is distorted: Try lowering the volume control of your sound source, musical instrument, or microphone. Also, try to reduce the overall volume of Total PA™ Glow Max using the Main Volume knob.

If there is too much bass: Try adjusting the tone or EQ control on your sound source to lower the bass level. This will allow you to play the music louder before clipping (distortion) occurs.

If there is a high-pitched whistling noise when using microphones: This is probably feedback. Point the microphone away from the speaker.

If you can't hear the microphone over the music volume: Turn down the music volume from your source.

The Display shows "NONE": If a USB drive or SD card is already properly inserted, make sure it contains playable files (MP3 files).

If you cannot connect your audio device to Total PA™ Glow Max via Bluetooth:

- Have your audio device (e.g., smartphone or tablet) and Total PATM Glow Max as close together as possible while trying to connect. Make sure both the audio device and Total PA™ Glow Max are unobstructed by walls, furniture, etc.
- Reset the Bluetooth connection on Total PATM Glow Max to disconnect Total PA™ Glow Max from any other audio device and restart the search process. If this does not work right away, power off Total PATM Glow Max and then power it back on. See Pairing with a Bluetooth Device for more information.
- Reset the Bluetooth connection on your audio device by turning Bluetooth off and back on. You can find this under the Bluetooth menu in the Settings for your phone or other audio device. If this does not work, and you have connected to Total PA™ Glow Max before, find Total PA™ Glow Max in the list of available or previously connected devices in your audio device's Bluetooth menu, tap the "gear" or "i" icon located next to it and then select Unpair or Forget. Turn Total PA™ Glow Max off and back on and try pairing again once it reappears in your available devices list.

Note: If Total PATM Glow Max has been paired to another audio device recently that is still within range, you may need to repeat this process with that audio device to fully disconnect.

If you experience audio dropouts while playing music from a Bluetooth device, this may be happening because your unit is trying to link to another speaker. This can occur if you power off a speaker that was linked to your unit or if you have just turned on your unit and it is in StereoLink mode. To stop the audio dropouts, exit Stereo-Link mode by double-pressing the Repeat/Link button. Alternatively, you can wait for your unit to link to another speaker if there is one within range.

If you would like to stop your speaker from automatically linking when you power it on, make sure you double-press the Repeat/Link button to exit Stereo-Link mode before you power it off.

Appendix

Technical Specifications

Output Power	500 W (peak)
Low Frequency	15.0" / 381 mm woofer
High Frequency	1.0" / 25.4 mm tweeter
Frequency Response	55 Hz – 20 kHz
Bluetooth	Profile: A2DP, AVCTP Module: Bluetooth 5.1 Range: Up to 100 feet / 30.5 meters Linked Range: Up to 100 feet / 30.5 meters
USB/SD Card	Audio: Music playback from USB drive or SD card Supported File System: FAT 32 Supported File Type: MP3 Maximum File Size: 16 GB Maximum USB Drive / SD Card Capacity: 16 GB
Remote Battery	CR2025
Power	IEC320 C13 power cable
Dimensions	17.5" x 14" x 27" / 445 x 356 x 686 mm
Weight	39.9 lbs. / 18.1 kg.

Specifications are subject to change without notice.

*Bluetooth and wireless reception and range are affected by walls, obstructions, and movement. For optimal performance, place the product in the center of the room so it is unobstructed by walls, furniture, etc.

Trademarks & Licenses

ION Audio is a trademark of inMusic Brands, Inc., registered in the U.S. and other countries. App Store is a trademark of Apple Inc., registered in the U.S. and other countries. Android and Google Play are registered trademarks of Google Inc. The Bluetooth word mark and logos are owned by the Bluetooth SIG, Inc. and any use of such marks by ION Audio is under license. All other product names, company names, trademarks, or trade names are those of their respective owners.



ionaudio.com

Manual Version 1.2

Documents / Resources

	ION PA Glow Max [pdf] User Guide PA Glow Max
---	---

References

-  [Sound Experiences | ION Audio](#)
-  [Support : ION Audio](#)