



**BR Series Liquid
CPU and UMA Cooler**



Inwin BR Series Liquid CPU and UMA Cooler User Manual

[Home](#) » [InWin](#) » Inwin BR Series Liquid CPU and UMA Cooler User Manual 

Contents

- [1 Inwin BR Series Liquid CPU and UMA Cooler](#)
- [2 Product Video Information](#)
- [3 Product Story](#)
- [4 Specifications](#)
- [5 Package Contents](#)
- [6 Installation Guide](#)
- [7 Troubleshooting](#)
- [8 Notices and Warranty](#)
- [9 Specifications](#)
- [10 FAQ](#)
- [11 Documents / Resources](#)
 - [11.1 References](#)



Inwin BR Series Liquid CPU and UMA Cooler



Product Video Information

- BR Series Product Video



- BR Series Installation Video



Product Story

Cool Like Never Before! At InWin, we dare to be bold. We challenge ourselves to think beyond the typical CPU liquid cooler. What additional features can we include to cool more efficiently? Introducing the new BR Series Liquid CPU & UMA (Upper Motherboard Area) Cooler for gamers, designers and users that desire optimal thermal performance. Cooling like never before experienced.

Specifications



Model		BR24	BR36
Model Number		IW-LC-BR24	IW-LC-BR36
CPU Socket Support		Intel® LGA 1851/ 1700/1200/ 2066/ 2011-V3/ 2011/ 1366/ 1156/ 1155/ 1151/ 1150 AMD® AM5/AM4/ AM3+/ AM3/ AM2+/ AM2/ FM2+/ FM2/ FM1/ TR4	
Radiator	Dimensions (L x W x H)	277 x 120 x 27 mm (10.9 x 4.7 x 1.1")	397 x 120 x 27 mm (15.6 x 4.7 x 1.1")
	Materials	Aluminium	
	Tube Length	400 mm	450 mm
	Tube Material	Rubber with Nylon Braided Sleeve	
Water Block	Dimensions (L x W x H)	100 x 75 x 100 mm (3.9 x 2.9 x 3.9")	
	Materials	Copper, Plastic	
	Fan Speed Mode	PWM 400 - 2500 +/- 10% RPM	
	Fan Airflow	26.93 CFM (Max.)	
	Fan Air Pressure	2.28 mm/ H2O	
	Fan Bearing Type	Long Lifespan Sleeve Bearing	
Pump	Dimensions (L x W x H)	65 x 50 x 31 mm (2.6 x 2.0 x 1.2")	
	Materials	PPS, GF	
	Pump Speed	5200 RPM +/- 10%	

Fan	Model	Luna Series AL120	
	Quantity Included	2 PCS	3 PCS
	Dimensions (L x W x H)	120 x 120 x 25 mm (4.7 x 4.7 x 1.0")	
	Speed Mode (PWM)	PWM 600 - 1800 +/- 10% RPM	
	Noise Level	35.5 dBA (Max.)	
	Airflow	82.96 CFM (Max.)	
	Air Pressure	2.31 mm / H2O	
	Connectors	4-Pin (12V, PWM), 3-Pin (5V, ARGB)	
	Rated Voltage	DC 12V	
	Bearing Type	Long Lifespan Sleeve Bearing	
Package Dimension (L x W x H)		331 x 265 x 136 mm (13 x 10.4 x 5.3")	459 x 244 x 136 mm (18.1 x 9.6 x 5.3")
Net Weight		0.9 kg / 2 lb	1.1 kg / 2.2 lb
Gross Weight		2.1 kg / 4.6 lb	2.5 kg / 5.5 lb
Warranty		3 Years	
* Specifications may vary based on different regions.			
* InWin's products comply with RoHS regulations.			

Package Contents

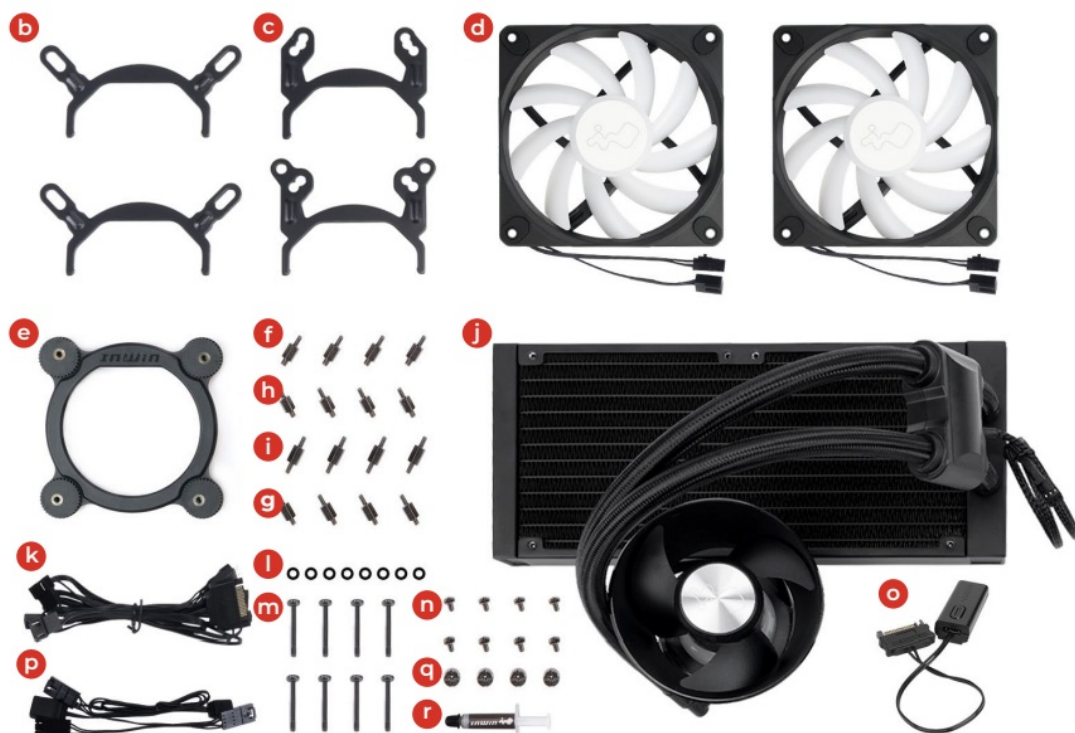

- a. QR Code Card x1
- b. Intel Mounting Bracket x2

- c. AMD Mounting Bracket x2
- d. Luna AL120 Fan x2
- e. Intel CPU Backplate x1
- f. Standoff Screws x4 (LGA 20XX)
- g. Standoff Screws x4 (AMD)
- h. Standoff Screws x4 (TR4)
- i. Standoff Screws x4 (LGA 115X/1366)
- j. 240 Radiator x1
- k. Main Cable (SATA + ARGB + PWM) x1
- l. Washer x8
- m. Fan Screws x8
- n. Radiator Screws x8
- o. ARGB One-Click Controller Ver. 1.1 x1
- p. ARGB Cable to M/B (5V, 3-pin) 1 to 3 x1
- q. Thumbscrew Cap x4
- r. Thermal Compound x1

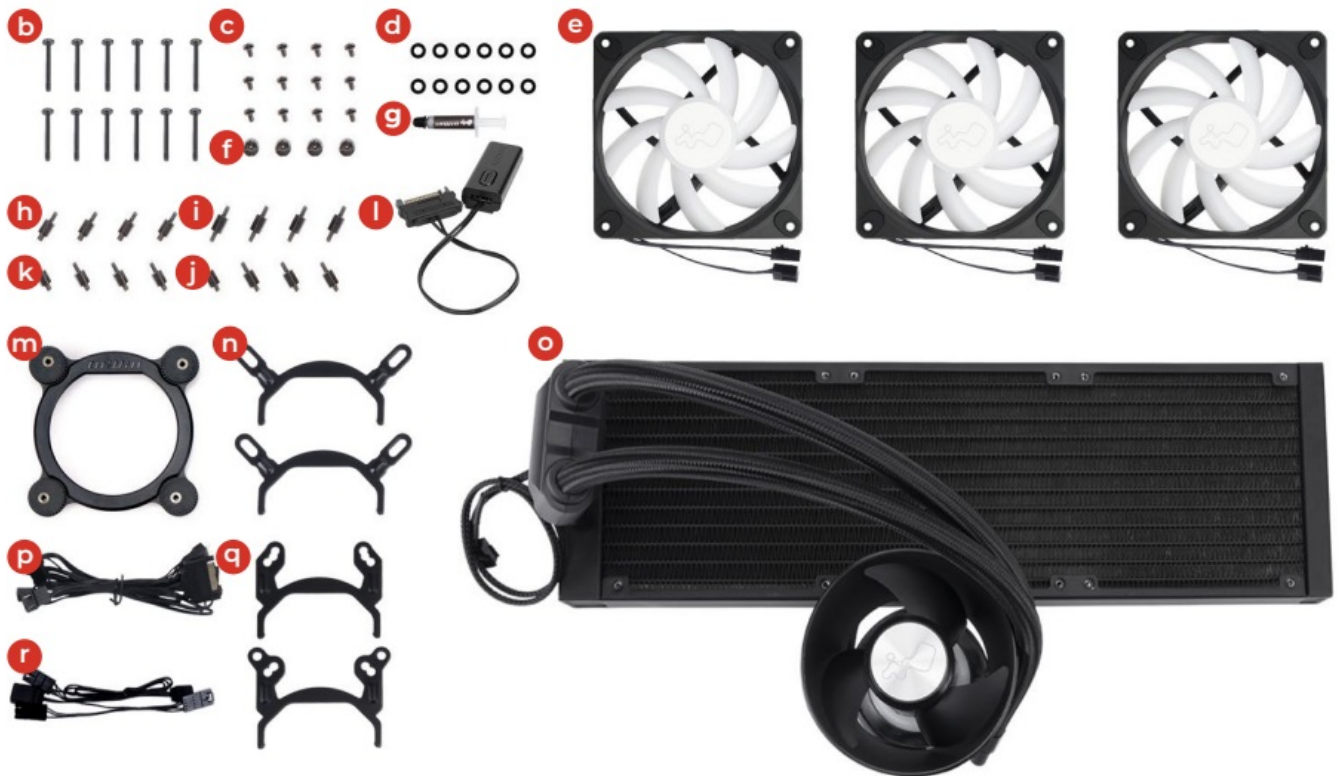

- a. QR Code Card x1
- b. Fan Screws x12
- c. Radiator Screws x12
- d. Washer x12
- e. Luna AL120 Fan x3
- f. Thumbscrew Cap x4
- g. Thermal Compound x1
- h. Standoff Screws x4 (LGA 20XX)
- i. Standoff Screws x4 (LGA 115X/1366)

- j. Standoff Screws x4 (AMD)
- k. Standoff Screws x4 (TR4)
- l. ARGB One-Click Controller Ver. 1.1 x1
- m. Intel CPU Backplate x1
- n. Intel Mounting Bracket x2
- o. 360 Radiator x1
- p. Main Cable (SATA + ARGB + PWM) x1
- q. AMD Mounting Bracket x2
- r. ARGB Cable to M/B (5V, 3-pin) 1 to 3 x1

Installation Guide

- Please follow the related chapters to assemble.
- Please use the original provided accessories to avoid damage to the product.

Install AL120 Fans to Radiator

Parts Required: 240mm/360mm radiator, Luna AL120 Fans, Washers, Fan Screws

- **Note:** Please be sure to use a washer on each screw before installation.

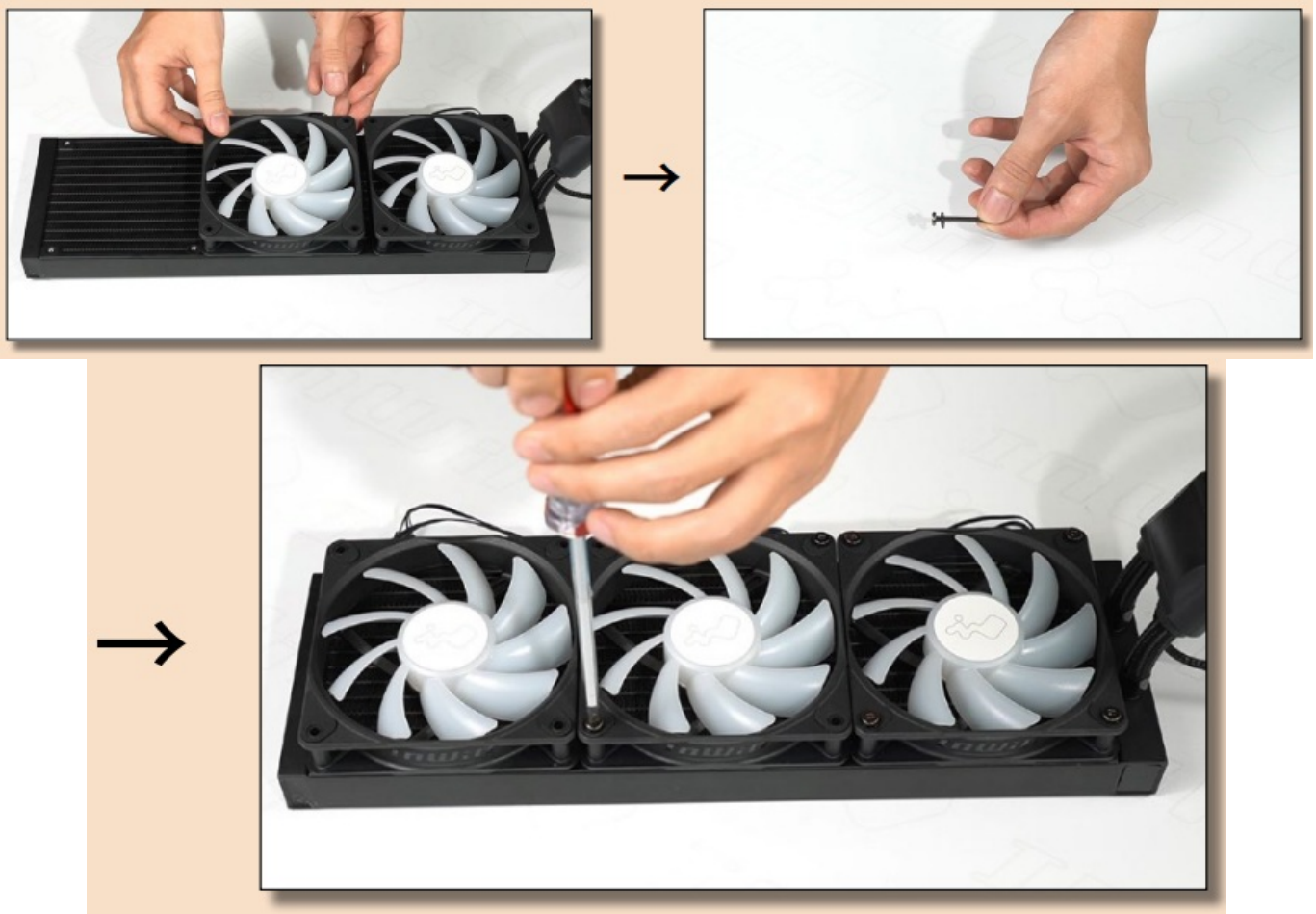

Install Fans and Radiator combo to your PC chassis.

Parts Required: Radiator Screws



Installation for motherboards

A. For Intel Motherboards (LGA 115X/1200/1366/20XX/1700/1851) :

1. Switch the Intel backplate pins according to the CPU socket of your motherboard.

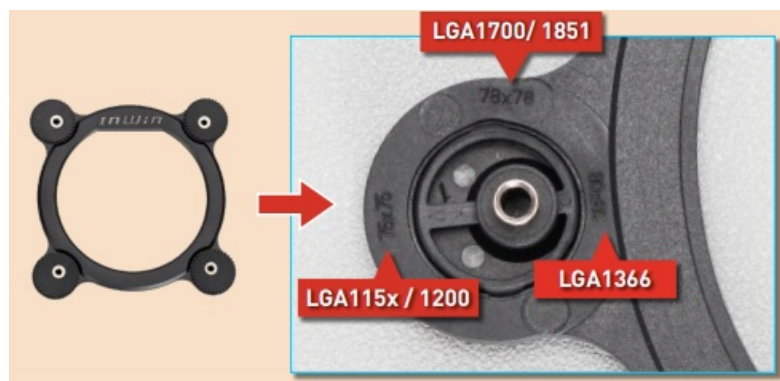

2. Attach the Intel backplate to the bottom of the motherboard.

- **Note:** Intel LGA 20XX does not require backplate installation.

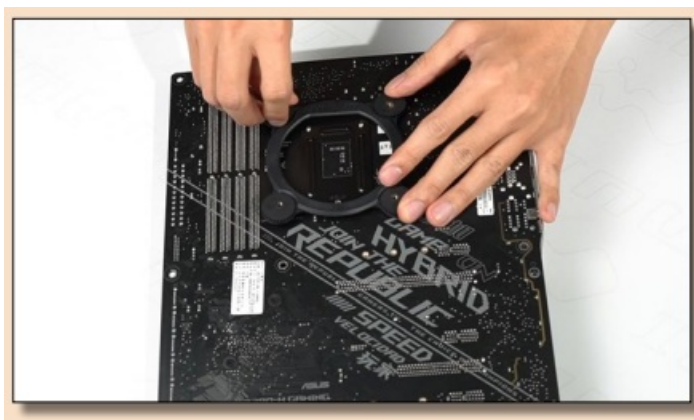

3. Install the standoff screws onto your motherboard. Ensure to use the correct standoff screws for your CPU socket.

Parts Required: Standoff Screws (LGA 115X/1200/1366/20XX/1700/1851)

- **Note:** Intel LGA 20XX does not require backplate installation.

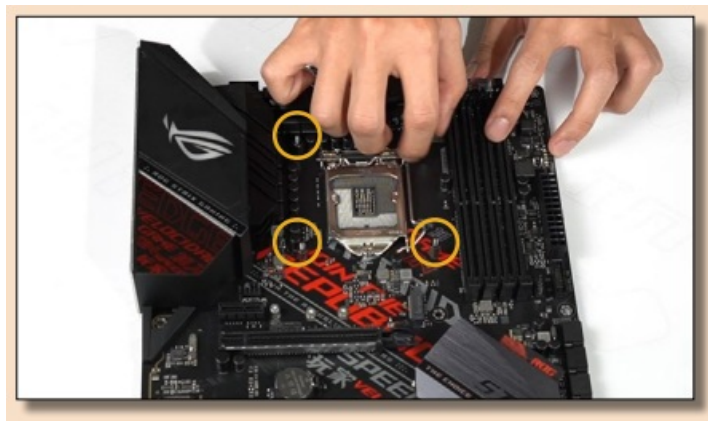

Installation for motherboards

For AMD Motherboards (AMD or TR4) :

1. Please remove the retention module. AMD's backplate comes with AMD's motherboard. Attach it to the bottom of the motherboard.

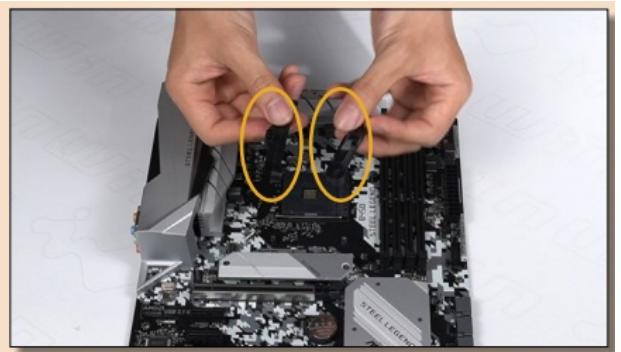

2. Install the standoff screws onto your motherboard. Ensure to use the correct standoff screws for your CPU socket. Parts Required: Standoff Screws (AMD or TR4)

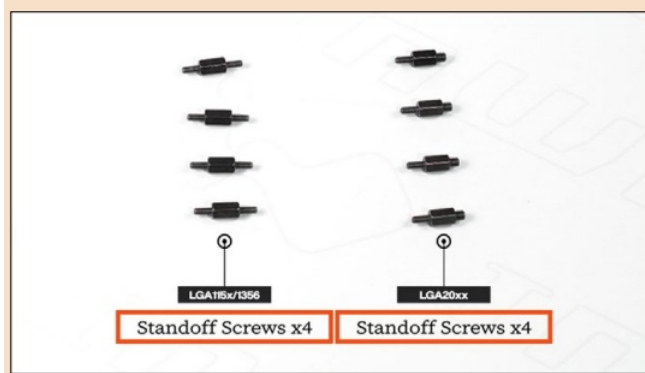
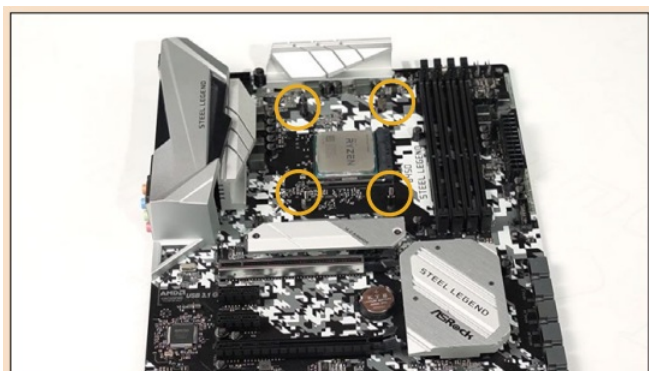

Install the Pump Unit

- A. Choose your Mounting Bracket according to your CPU.
- **Parts Required:** Mounting Bracket, Thumbscrew Cap, Thermal Compound

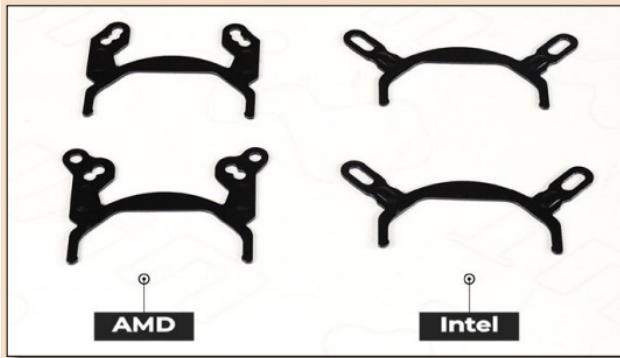

- B. Apply the Thermal Compound evenly on the CPU surface.

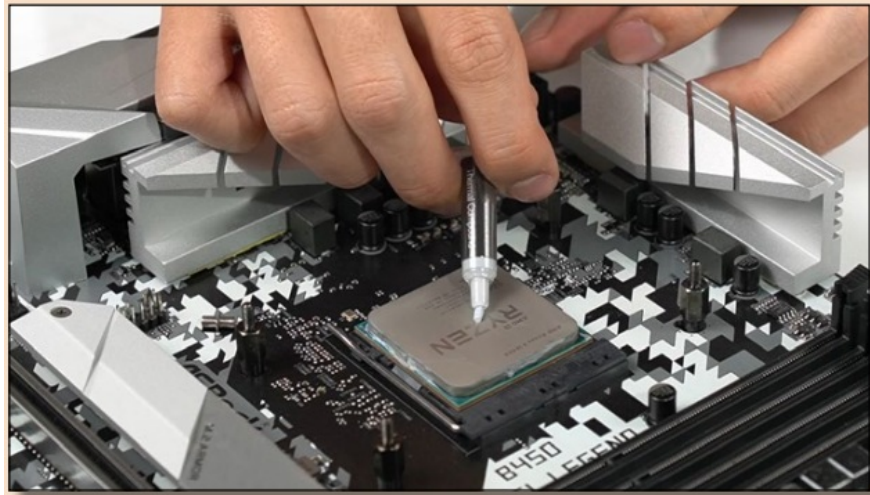

- C. Remove the protect film from the cold-plate.



- D. Install the water block and then tighten it with the Thumbscrews.

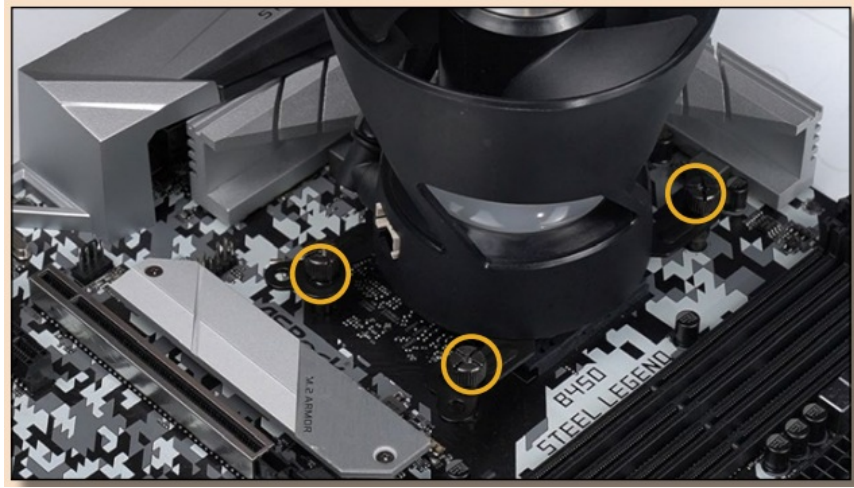

Connection Cables.

Parts Required: Main Cable (SATA + ARGB + PWM), ARGB Cable (5V, 3-pin), Pump Cable(AIO Pump)

Cable A: Main Cable (SATA + ARGB + PWM)

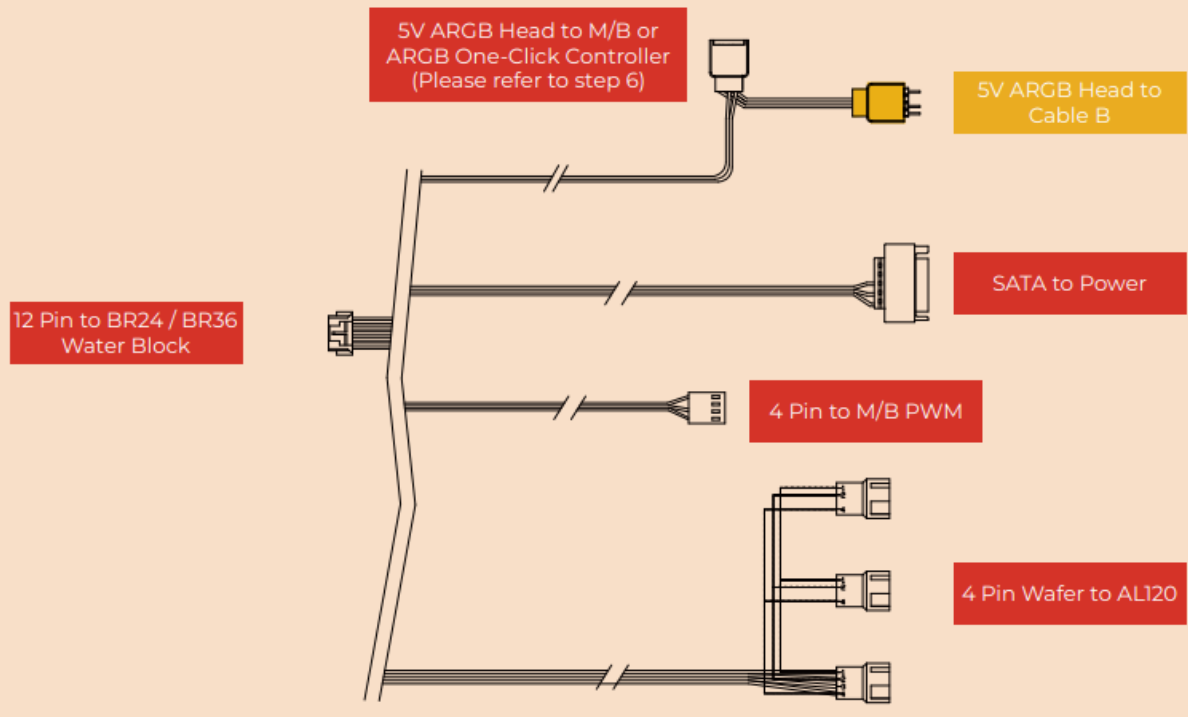

**Cable B: Addressable Cable
(5V, 3-pin)**

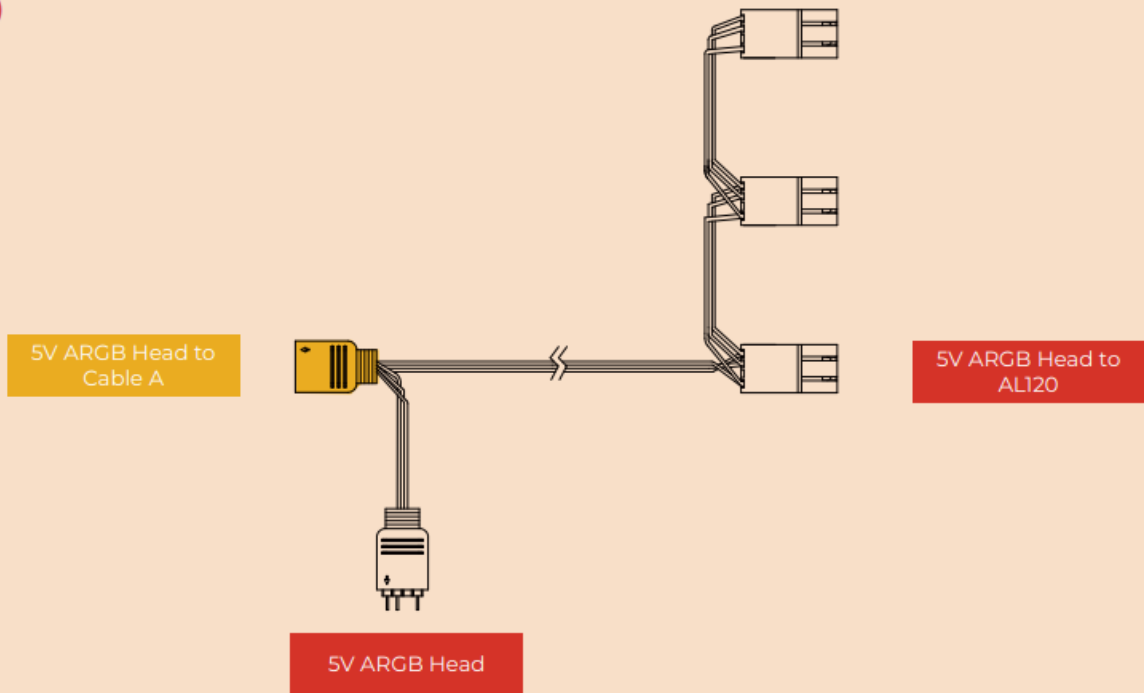

Cable C: Pump Cable (AIO Pump)

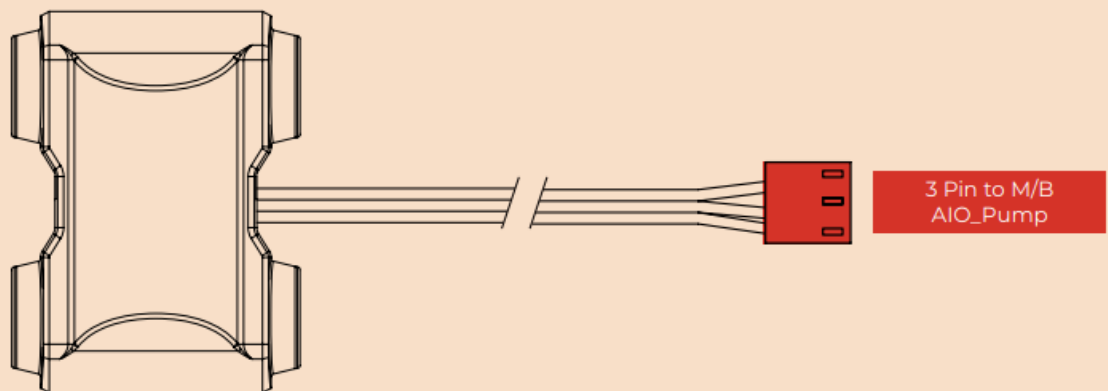

ARGB One-Click Controller Ver. 1.1 Installation

Please use the included ARGB One-Click Controller to connect to your PSU's SATA cable and the Addressable Cable in order to use the 14 different of lighting effects.

Note: Please follow this step if your motherboard does not support the ARGB effect.

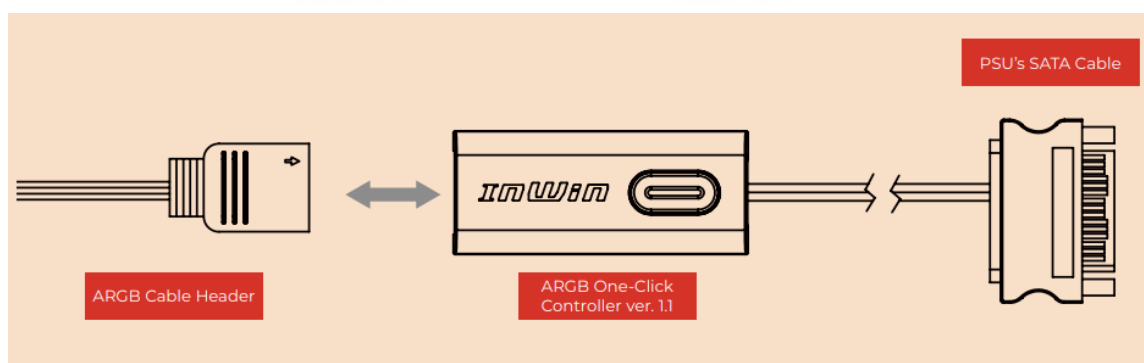
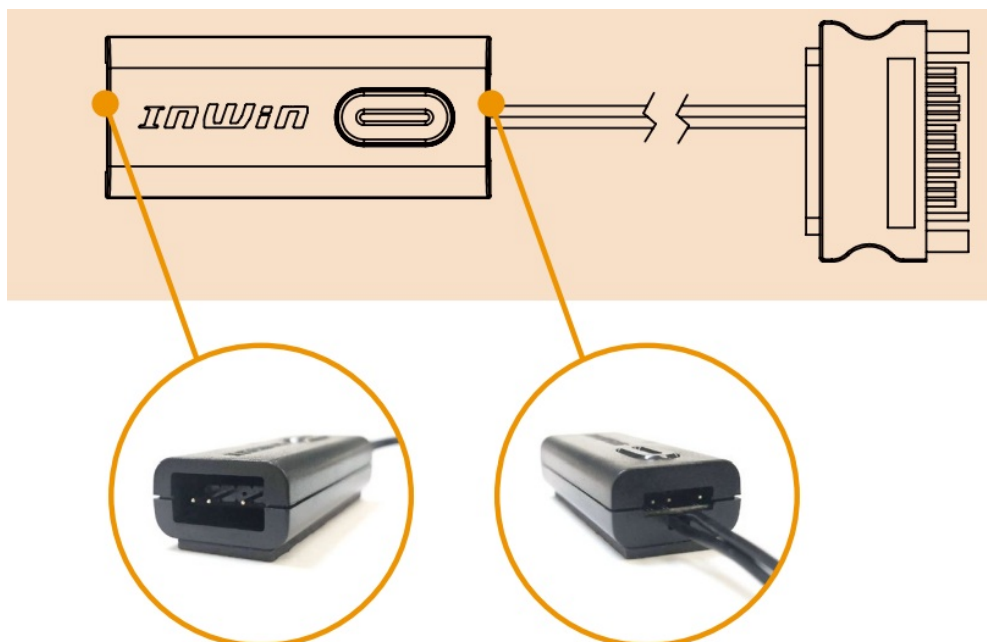

ARGB One-Click Controller Ver. 1.1 Installation

Hold the button to turn on or off the lights. Tap the button to change the lighting modes.

1. Rainbow
2. LED-Red Breathing
3. LED-Green
4. LED-Blue
5. LED-Purple
6. LED-White
7. Light at the end of the Tunnel
8. Two-Tone Ring
9. Diagonal Transition
10. Rotating LED Trio
11. Full Circle
12. Flow-Red
13. Flow-Green
14. Flow-Blue

InWin reserves the right to change the lighting modes.

- For more installation instructions, please scan the QR Code below or watch the video in the website



Troubleshooting

If your AIO pump or fan does not operate properly, please follow the instructions below:

1. Please check your system's power.
2. Please make sure all the connectors are connected properly.
3. For more technical support, please visit the InWin Forum website at <https://forum.in-win.com/>

Notices and Warranty

Notices

1. Install in accordance with the user manual's instructions and safety warnings. Incorrect installation may burn out the motherboard and other system components.
2. Keep this product away from areas with high temperatures such as heat dissipation machines, air conditioners, or other machines that may generate high temperatures.
3. Please do not put anything in the impeller.
4. Do not modify the cables and/or connectors included with this product.
5. Please do not put your hands or other objects into the fan blades when the fan is in operation. And please make sure to keep away from children and pets.
6. Please only use this product in a computer case.
7. Please keep this product away from any liquids.
8. Please use only this product's exclusively supplied cables. Other cables may not be compatible and could cause serious damage to your system and power supply.

Warranty

1. For more detailed warranty information, please visit the InWin retail website at www.in-win.com
2. The actual product is subject to change without prior notice. IN WIN DEVELOPMENT INC. reserves the right to make any final modifications.

- www.in-win.com
- Copyright © 2021 In Win Development Inc. All Rights Reserved.

Specifications

Model	BR24	BR36
CPU Socket Support	—	—

FAQ

Q: What is included in the BR24 package contents?

A: The BR24 package includes a QR Code Card, Intel and AMD Mounting Brackets, Luna AL120 Fan x2, Intel CPU Backplate, Standoff Screws for various sockets, 240 Radiator, Main Cable, Washers, Fan and Radiator Screws, ARGB One-Click Controller, ARGB Cable to M/B, Thumbscrew Cap, and Thermal Compound.

Q: What is the warranty for the BR Series Liquid CPU Cooler?

A: The warranty for the BR Series Liquid CPU Cooler is 3 years.

Documents / Resources



[Inwin BR Series Liquid CPU and UMA Cooler](#) [pdf] User Manual

IW-LC-BR24, IW-LC-BR36, BR Series Liquid CPU and UMA Cooler, BR Series, Liquid CPU and UMA Cooler, CPU and UMA Cooler, UMA Cooler, Cooler

References

- [InWin](#)
- [Forums - InWin Forums](#)
- [User Manual](#)

[Manuals+](#), [Privacy Policy](#)

This website is an independent publication and is neither affiliated with nor endorsed by any of the trademark owners. The "Bluetooth®" word mark and logos are registered trademarks owned by Bluetooth SIG, Inc. The "Wi-Fi®" word mark and logos are registered trademarks owned by the Wi-Fi Alliance. Any use of these marks on this website does not imply any affiliation with or endorsement.