



InVid Tech SN-M2207NT-B Face Recognition Terminal User Guide

[Home](#) » [InVid Tech](#) » InVid Tech SN-M2207NT-B Face Recognition Terminal User Guide 

Contents

- [1 InVid Tech SN-M2207NT-B Face Recognition Terminal](#)
- [2 Precautions](#)
- [3 Special Announcement](#)
- [4 Open Package Examination](#)
- [5 Device Installation](#)
- [6 Documents / Resources](#)
- [7 Related Posts](#)



InVid Tech SN-M2207NT-B Face Recognition Terminal



Precautions

Fully understand this document before using this device, and strictly observe rules in this document when using this device. If you install this device in public places, provide the tip "You have entered the area of electronic surveillance" in an eye-catching location. Failure to correctly use electrical products may cause fire and severe injuries.

WARNING

It alerts you to moderate dangers which, if not avoided, may cause minor or moderate injuries.

CAUTION

It alerts you to risks. Neglect of these risks may cause device damage, data loss, device performance deterioration, or unpredictable results.

NOTE

It provides additional information.

WARNING

- Strictly observe installation requirements when installing the device. The manufacturer shall not be held

responsible for device damage caused by users' non-compliance to these requirements.

- Strictly conform to local electrical safety standards and use power adapters that are marked with the LPS standard when installing and using this device. Otherwise, this device may be damaged.
- Use accessories delivered with this device. The voltage must meet input voltage requirements for this device.
- If this device is installed in places with unsteady voltage, ground this device to discharge high energy such as electrical surges in order to prevent the power supply from burning out.
- When this device is in use, ensure that no water or any liquid flows into the device. If water or liquid unexpectedly flows into the device, immediately power off the device and disconnect all cables (such as power cables and network cables) from this device.
- Do not focus strong light (such as lighted bulbs or sunlight) on this device. Otherwise, the service life of the image sensor may be shortened.
- If this device is installed in places where thunder and lightning frequently occur, ground the device nearby to discharge high energy such as thunder strikes in order to prevent device damage.

CAUTION

- The normal operating temperature of the device is 0°C~50°C(32°F~122°F). Please ensure that the device is used within this ambient temperature range. If you need to measure temperature, please install the device in 20°C~35°C(68°F~95°F) indoor environment without wind to keep accuracy. Use beyond the temperature range may cause abnormal display of the thermal image, and long-term work will damage the equipment.
- Avoid heavy loads, intensive shakes, and soaking to prevent damages during transportation and storage. The warranty does not cover any device damage that is caused during secondary packaging and transportation after the original packaging is taken apart.
- Protect this device from fall-down and intensive strikes, keep the device away from magnetic field interference, and do not install the device in places with shaking surfaces or under shocks.
- Clean the device with a soft dry cloth. For stubborn dirt, dip the cloth into slight neutral cleanser, gently wipe the dirt with the cloth, and then dry the device.
- Do not jam the ventilation opening. Follow the installation instructions provided in this document when installing the device.
- Keep the device away from heat sources such as radiators, electric heaters, or other heat equipment.
- Keep the device away from moist, dusty, extremely hot or cold places, or places with strong electric radiation.
- Remove the power plug if the device is idle for a long time.
- Before unpacking, check whether the fragile sticker is damaged. If the fragile sticker is damaged, contact customer services or sales personnel. The manufacturer shall not be held responsible for any artificial damage of the fragile sticker.

Special Announcement

- All complete products sold by the manufacturer are delivered along with nameplates, quick setup guide and accessories after strict inspection. The manufacturer shall not be held responsible for counterfeit products.
- This manual may contain misprints, technology information which isn't accurate enough, or product function and operation description that is slightly inconsistent with the actual product, the final interpretation of company is as a standard.
- This manual is only for reference and does not ensure that the information is totally consistent with the actual product. For consistency, see the actual product.

NOTE
For more information, please refer to website.

Open Package Examination

Open the package, check the appearance of the product for no obvious damage, and confirm the item list for Table is consistent.

Component	Quantity	Remark
Face recognition terminal	1	
Power supply DC 12 V 2A	1	
L hexagonal wrench	1	
Bracket	1	
Screw package	1	

Device Structure

Device Ports

NOTE
Different devices may have different ports and multi-head cables, please refer to the actual product.

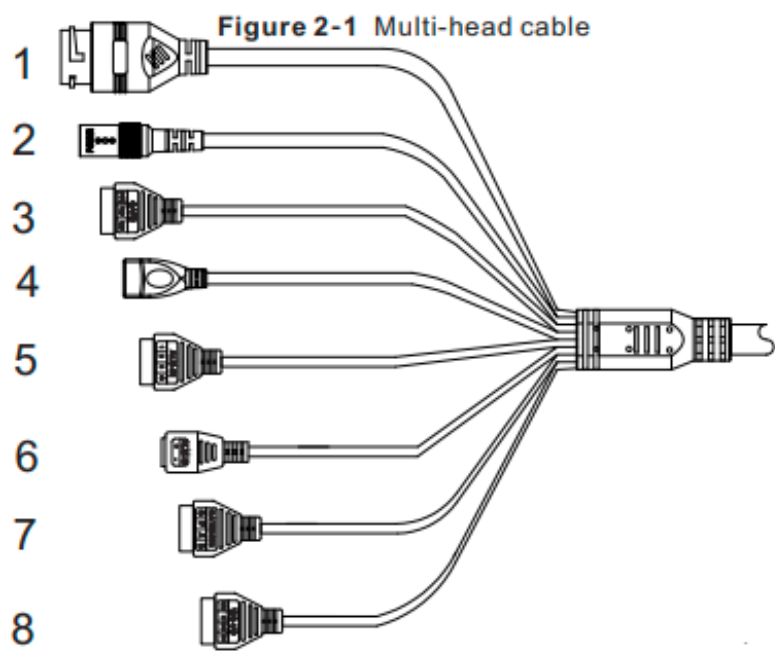

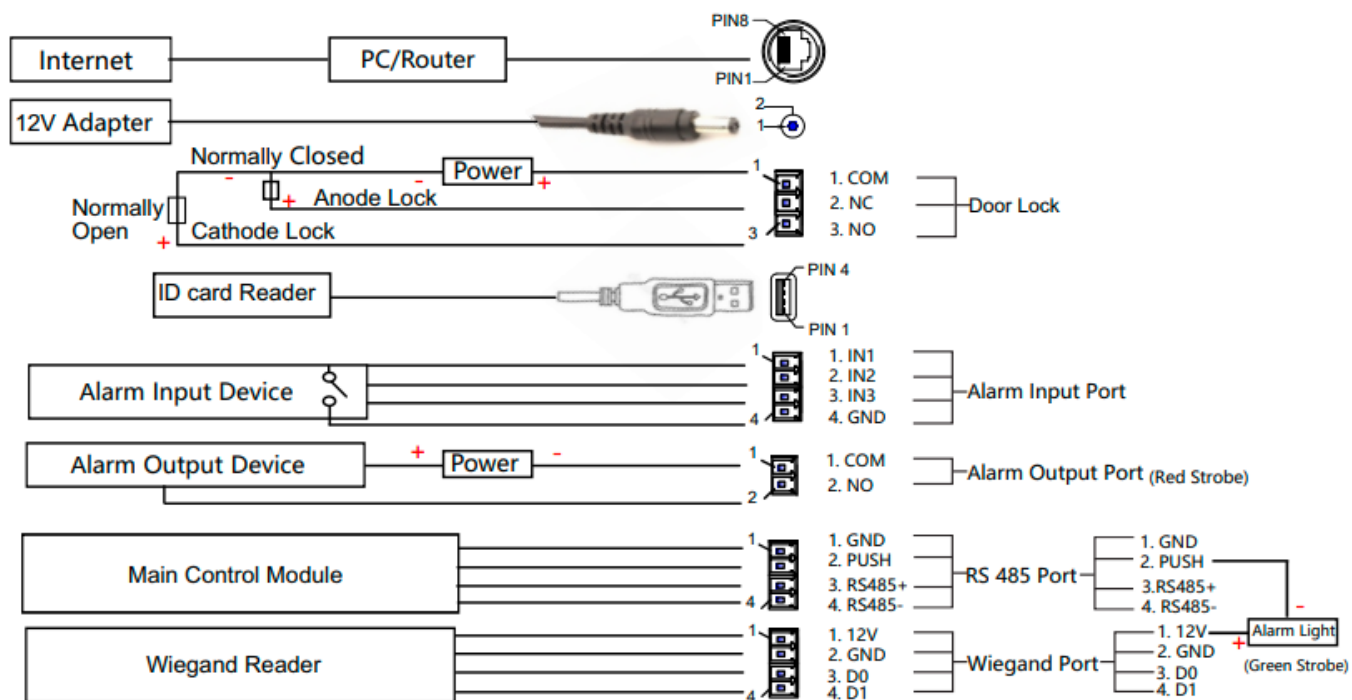

ID	Core	Description	Remark
1 RJ45	Network	Connect to Ethernet	Doesn't support POE
2 POWER	Power	Connect to DC 12 V	
3 GATE	COM	Connect to Access control's COM	Access control port When the door lock is not triggered, COM-NC is short-circuited and NO is suspended; COM-NO is short-circuited when the door lock is triggered; NC is suspended;
	NC	Connect to Access control's COM NC	
	NO	Connect to Access control's COM NO	
4 USB	USB port	Connect to USB ID reader	
5 ALARM IN	1	Connect to alarm device line 1	Alarm In
	2	Connect to alarm device line 2	
	3	Connect to alarm device line 2	
	G	GND	
6 ALARM OUT	—	Alarm out COM, negative	Alarm out
	+	Alarm out, positive	
7 GATE/485	G	GND	The positive of alarm light needs to be connected to DC 12V, or connect to 8 WG-I/O 12V port.
	P	Connect to alarm light negative	
	A	RS 485 port A (+)	
	B	RS 485 port B(-)	
8 WG-IO	12V	DC 12V	Wiegand IN/OUT port
	G	GND	
	D0	Wiegand data port 0	
	D1	Wiegand data port 1	

Camera Dimensions

NOTE

Different devices may have different dimensions, please refer to the actual product.
Figure Dimensions (Unit: inch)

Figure 2-3Dimensions (Unit: inch)

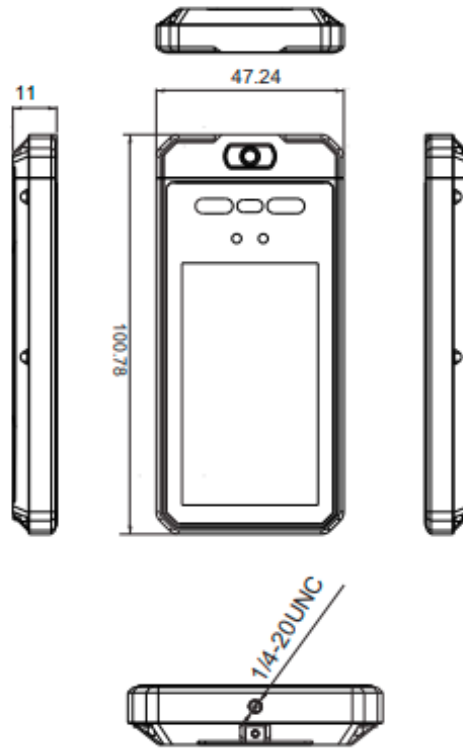

Device Appearance

2.3 Device Appearance

Figure 2-4Device Appearance

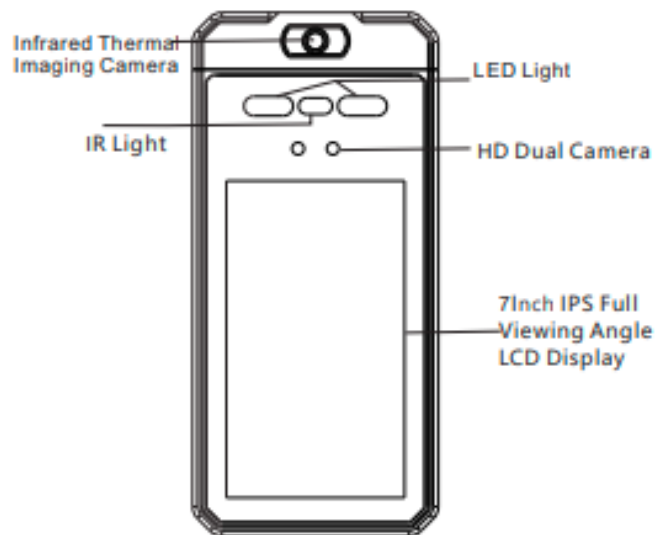

Device Installation

Installation Tips

1. To ensure the accuracy and ensure the measure result closer to the real temperature, please install the camera indoor in stable environment with 20~35°C(68-95°F) ambient temperature.
2. Please do not install opposite to a door, air conditioner, heat source, vent or any place in sunshine.
3. Please do not cover tablet forehead after installation.
4. The device should be powered on for half-hour, so that the measurement temperature is normal, powered on

for more than 1.5 hours is the best status.

5. The recommended installation environment is an airless aisle, please ensure the monitoring field is far away from any objects that could produce airflow, high temperature, reflection.

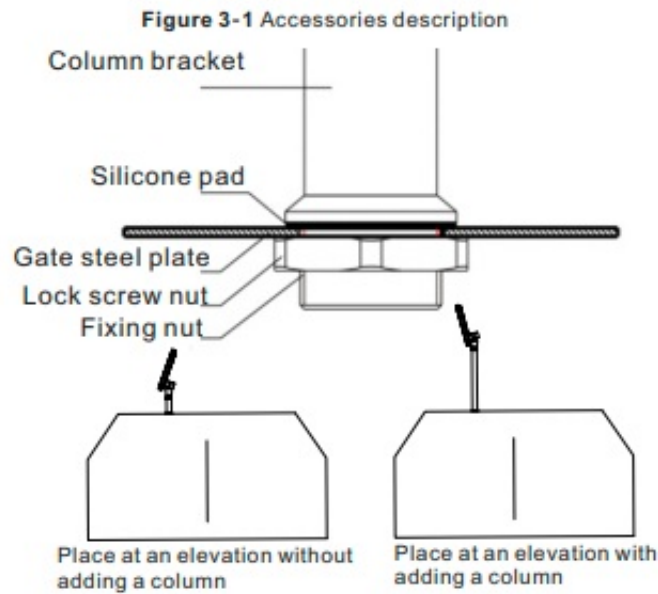

Table Installing distance

Distance between person and device(feet)	The recognizable height range without column (feet)	Distance between person and device(feet)	The recognizable height range with column (feet)
1.80	4.92~6.07	2.13	4.26~6.07
1.97	4.75~6.23	2.46	4.26~6.23
2.13	4.59~6.39	2.78	4.26~6.39

Procedure of installing at gate

1. Drill a hole with the diameter of 1.33inch on the gate machine according to (Figure 1);
2. Remove the nut on the column of the integrated machine, and pass the threaded section of the column through the hole (Figure 2);
3. Screw the column nut onto the threaded section of the column, and use a wrench or other tools to tighten the nut (Figure 3);
4. Connect the corresponding functions' cable to multi cable, and the installation is completed (Figure 4);

Figure Fixing steel plate

Figure3-2 Fixing steel plate

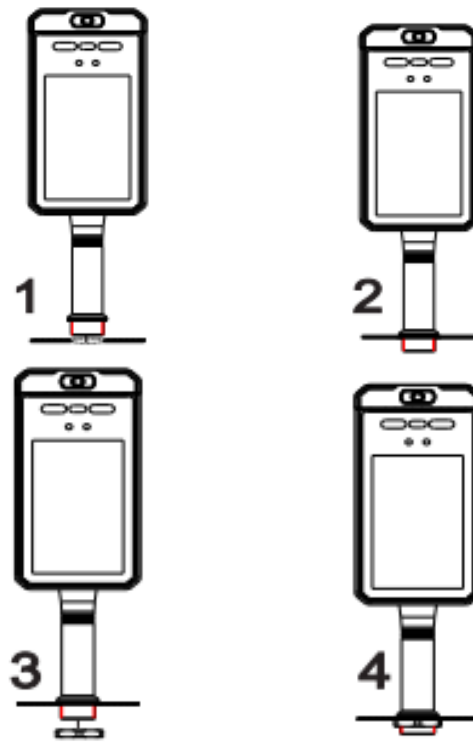

Instruction of wall mounting

CAUTION

When mounting on the wall, user can choose to drill hole on wall, or not drill hole, the accessory is optional following with the different installment. The installation height should choose the appropriate face height, when the angle of a human face is deviated too much from the device, the temperature that is detected will be less accurate, when the person passing through the device, he should adjust face parallel to device.

Figure Dimensions (Unit: inch)

Figure3-3 Dimensions (Unit: inch)

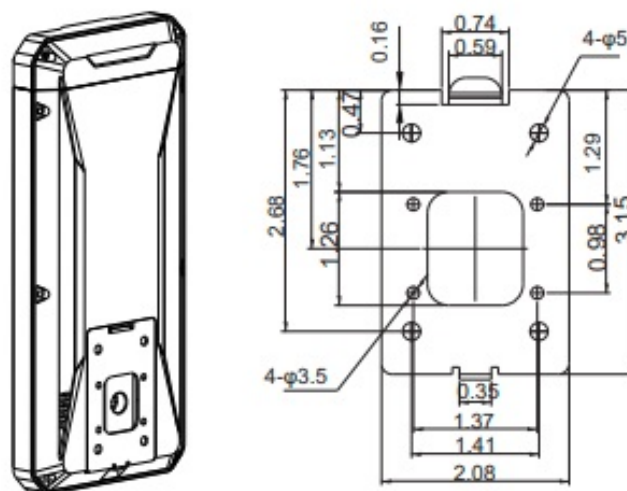

The installation method is to first install the wall hanging brackets on the wall and the device respectively, and then fit the bracket of the all-in-one machine and the wall hanging brackets, as shown in Figure 3-4.

Figure Wall mounting (drill the passing cables hole)

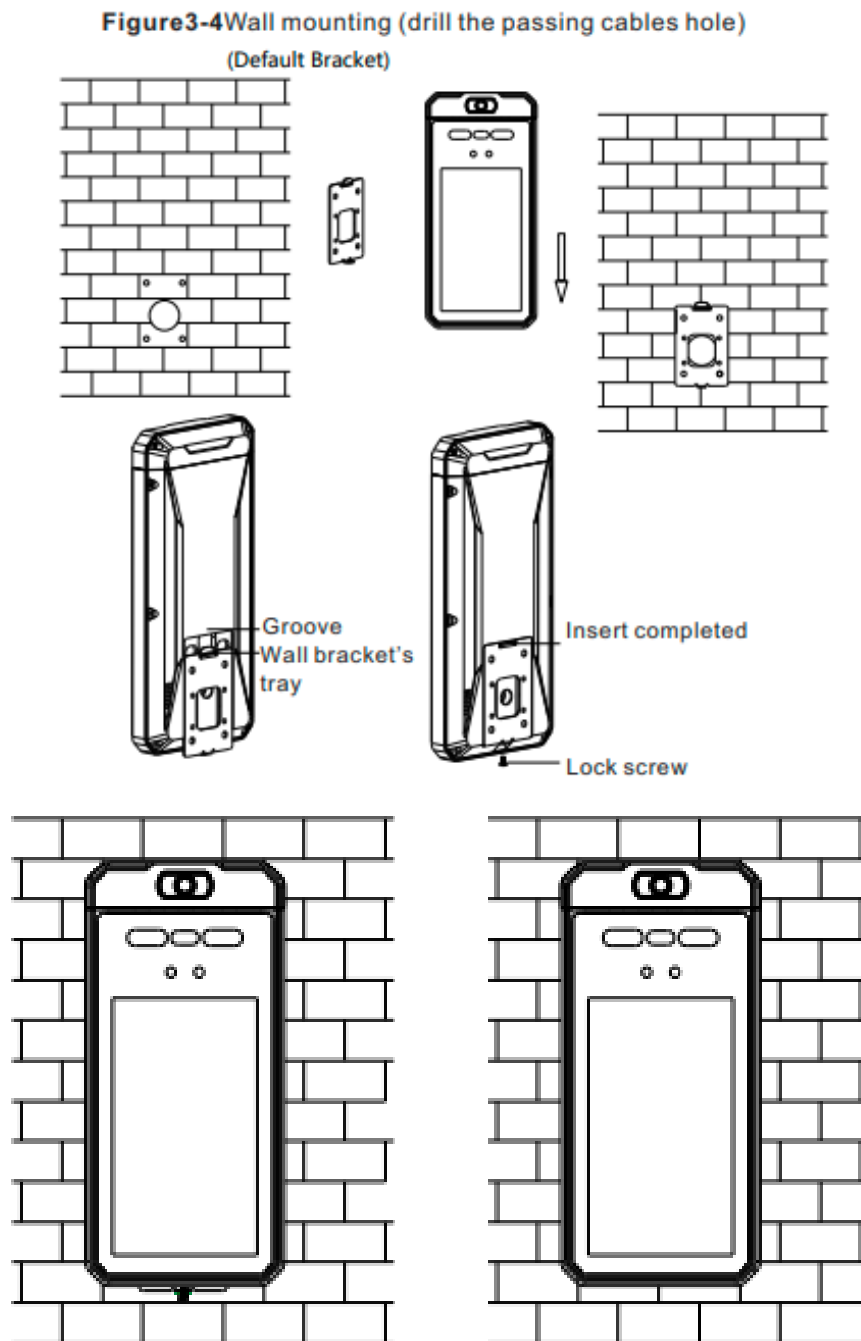

1. Drill holes (2.20 X 1.41 inch) on the wall as the dimensions of the wall bracket, insert the rubber plug into the hole, and reserve a cable hole on the wall;
2. Fix the wall mount bracket to the wall plug with 4 self-tapping screws, and first pass the equipment wire through the wall mount bracket into the reserved hole on the wall;
3. When the camera falls from the top, insert the tray of the bracket into the groove on the back of the camera;
4. After the device falls to the final position, tighten the middle screw at the bottom of the device.

Wall mounting (no passing cables hole)

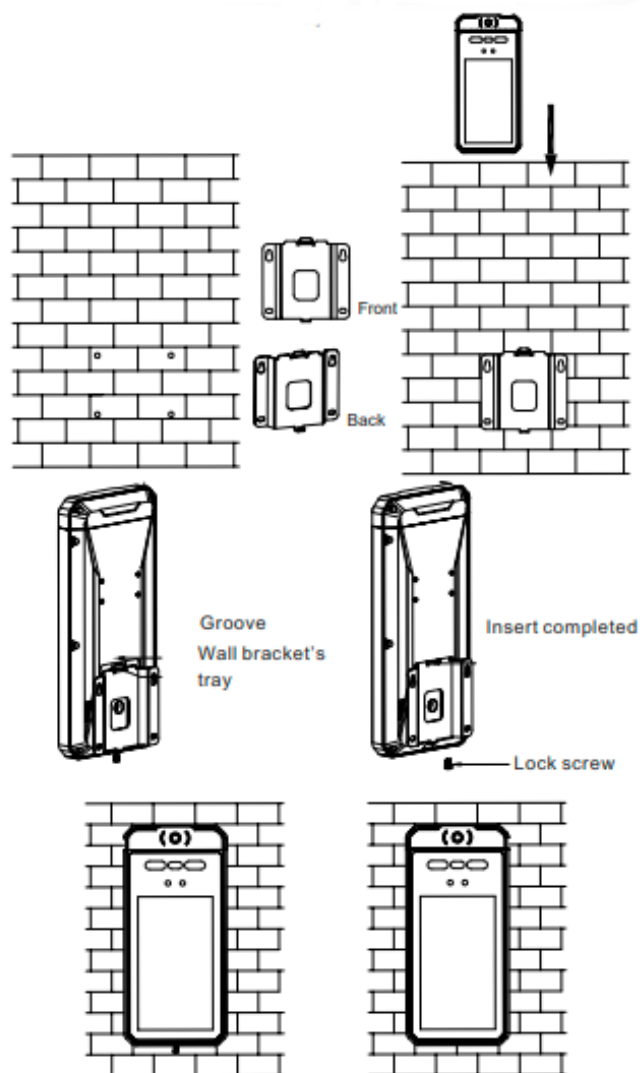

1. Drill holes (2.95 X 2.36 inch) on the wall as the dimensions of the wall bracket, insert the rubber plug into the hole;
2. Fix the wall mount bracket to the wall plug with 4 self-tapping screws, and pass the equipment wire through the wall mount bracket up or down depending on the need;
3. When the camera falls from the top, insert the tray of the bracket into the groove on the back of the camera;
4. After the device falls to the final position, tighten the middle screw at the bottom of the device.

Documents / Resources

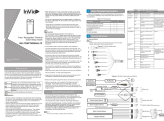
	<p>InVid Tech SN-M2207NT-B Face Recognition Terminal [pdf] User Guide SN-M2207NT-B Face Recognition Terminal, SN-M2207NT-B, Face Recognition Terminal</p>
---	--