



## **INVENTUM IKI9045FLOW Built-In Flow-In Induction Hob Instruction Manual**

[Home](#) » [INVENTUM](#) » **INVENTUM IKI9045FLOW Built-In Flow-In Induction Hob Instruction Manual** 

## Contents

- 1 INVENTUM IKI9045FLOW Built-In Flow-In Induction Hob
- 2 Introduction
  - 2.1 HOW TO USE THIS DOCUMENT
  - 2.2 SYMBOLS USED IN THIS DOCUMENT
- 3 Safety
  - 3.1 GENERAL SAFETY INSTRUCTIONS
  - 3.2 SAFETY INSTRUCTIONS FOR INSTALLATION
- 4 Description
  - 4.1 WORKING PRINCIPLE COOKER HOOD
  - 4.2 Extracting
  - 4.3 Filtering (Recycling)
  - 4.4 Using a Plasma Filter
- 5 Installation
  - 5.1 SAFETY INSTRUCTIONS FOR INSTALLATION
  - 5.2 INSTALLATION ITEMS
  - 5.3 ACCESSORIES
  - 5.4 TOOLS AND SUPPLIES
  - 5.5 PROTECTIVE EQUIPMENT
  - 5.6 REQUIREMENTS FOR INSTALLATION
  - 5.7 UNPACKING
  - 5.8 PREPARING FOR INSTALLATION
  - 5.9 INSTALLING THE SEAL
  - 5.10 INSTALLING THE INDUCTION HOB
  - 5.11 Non-Flush Installation
  - 5.12 Flush Installation
  - 5.13 CHANGING THE OUTPUT DIRECTION OF THE MOTOR
  - 5.14 REPLACING THE DUCT ADAPTER
  - 5.15 INSTALLING THE COOKER HOOD
  - 5.16 INSTALLING THE ELECTRICAL CONNECTIONS
  - 5.17 INSTALLING THE FILTERING KIT (OPTIONAL)
  - 5.18 CONNECTING THE APPLIANCE
  - 5.19 FINISHING THE INSTALLATION
- 6 Documents / Resources
  - 6.1 References
- 7 Related Posts

# INVENTUM

**INVENTUM IKI9045FLOW Built-In Flow-In Induction Hob**

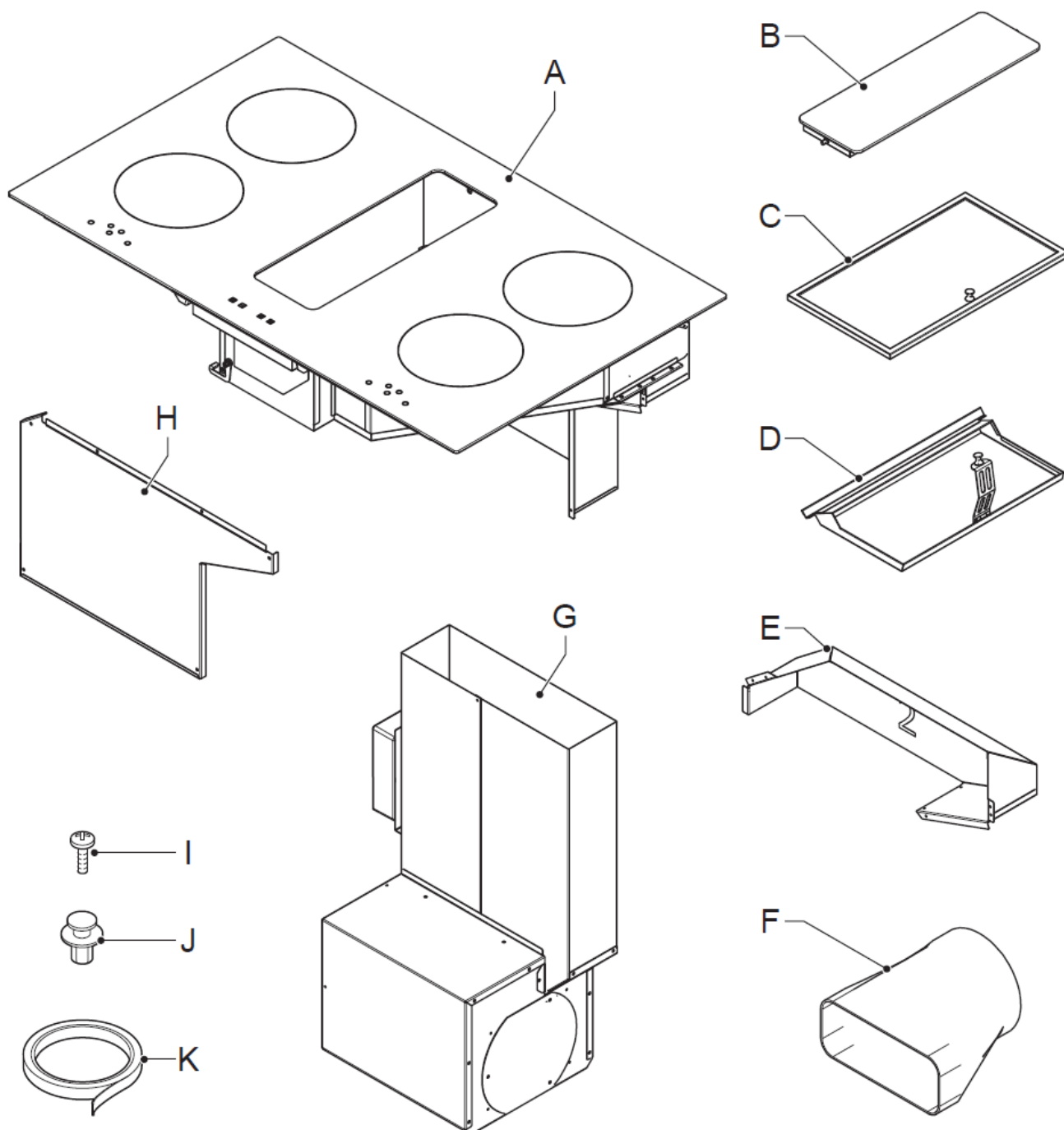
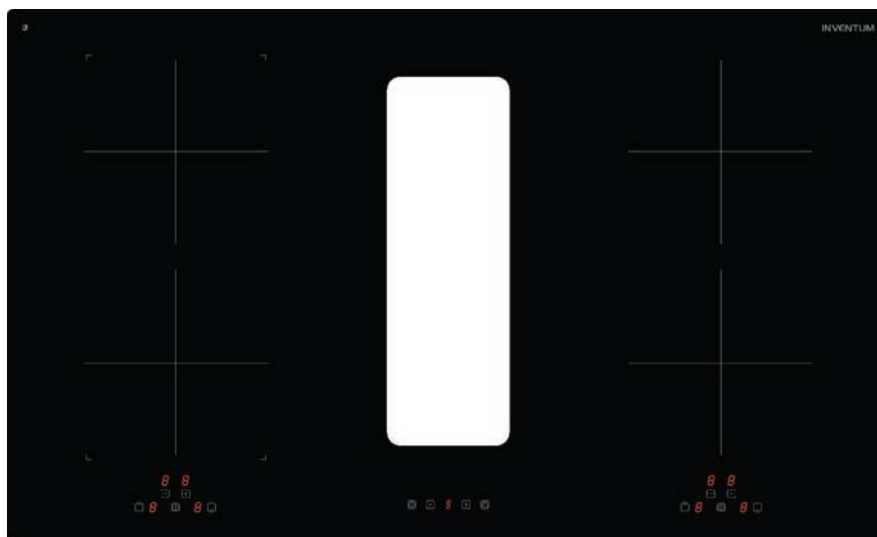

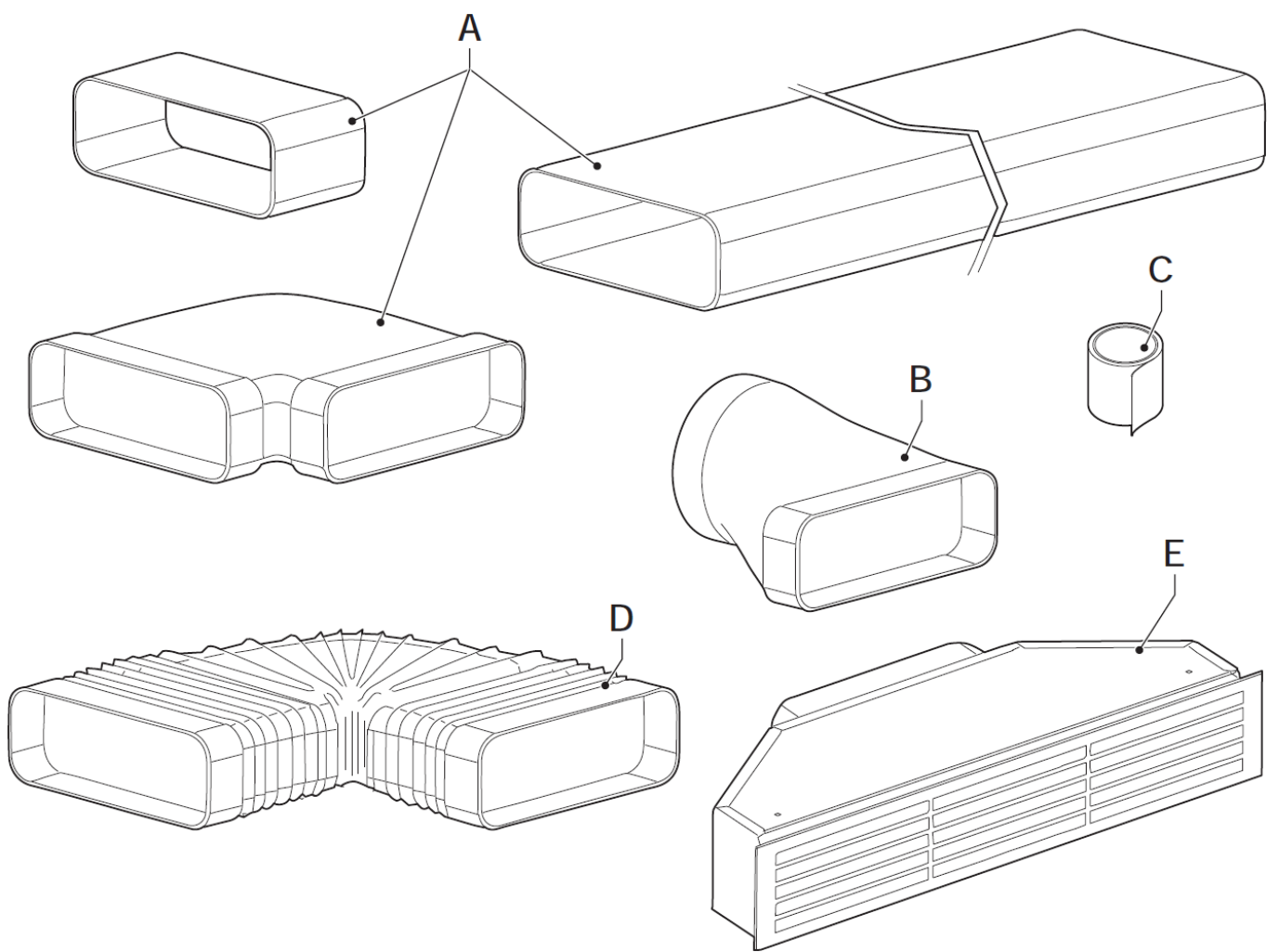

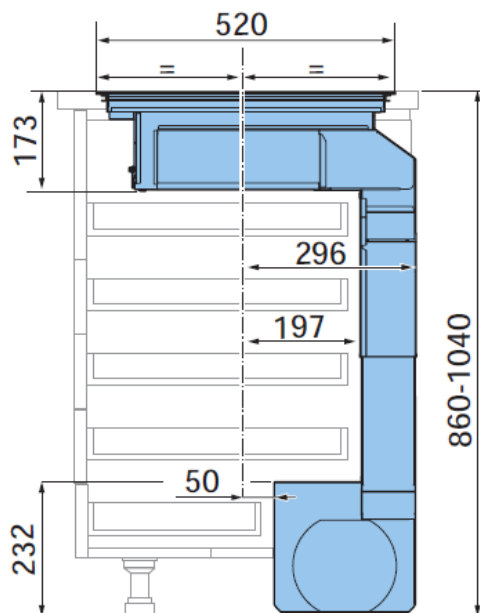

1

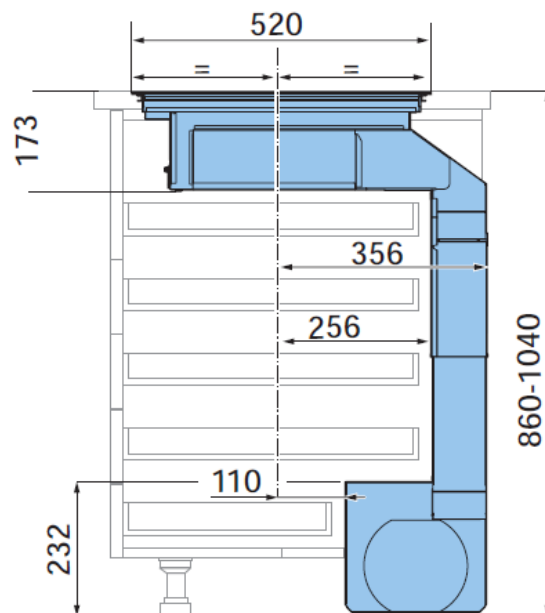

2

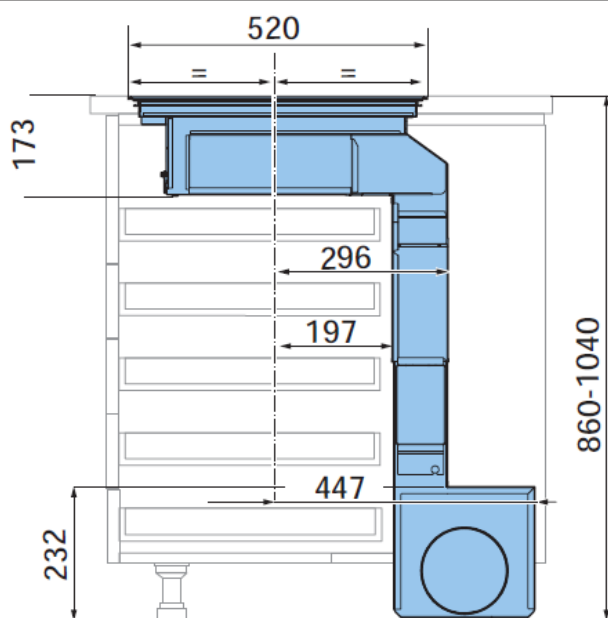

3

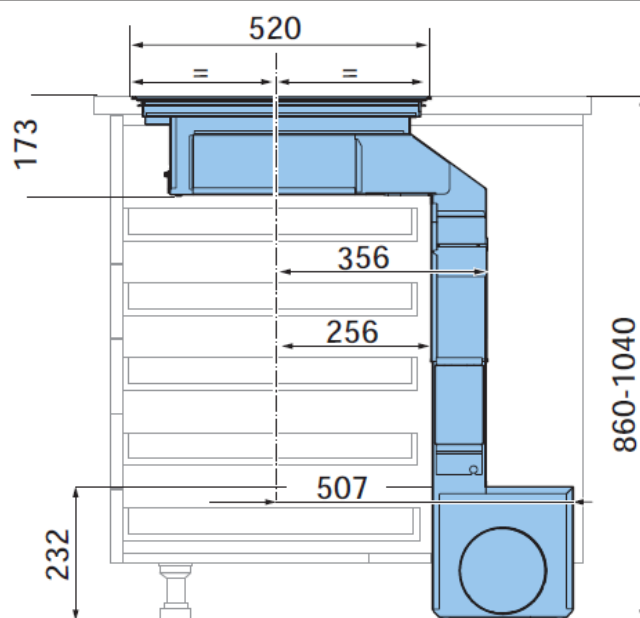

4

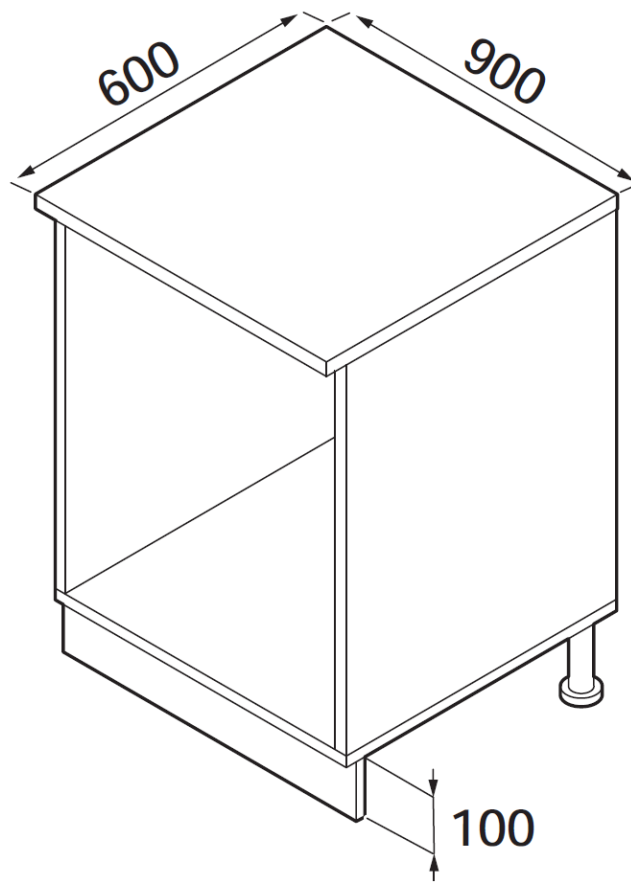

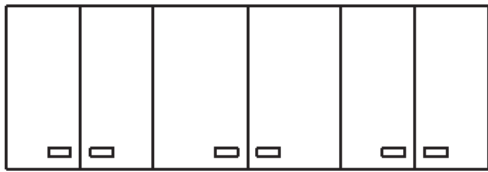

A



B

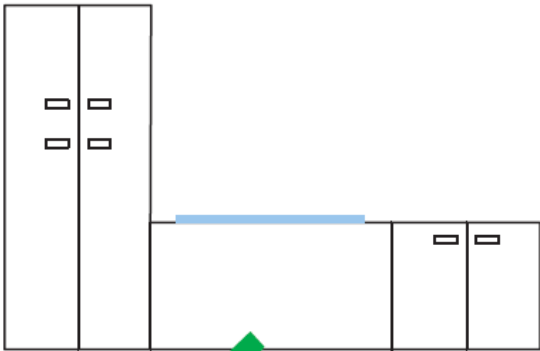

C

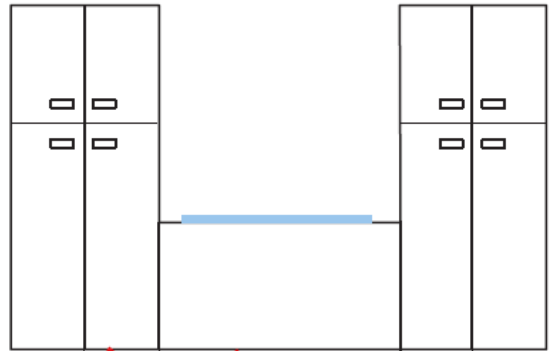

D



$\geq 30$   
mm

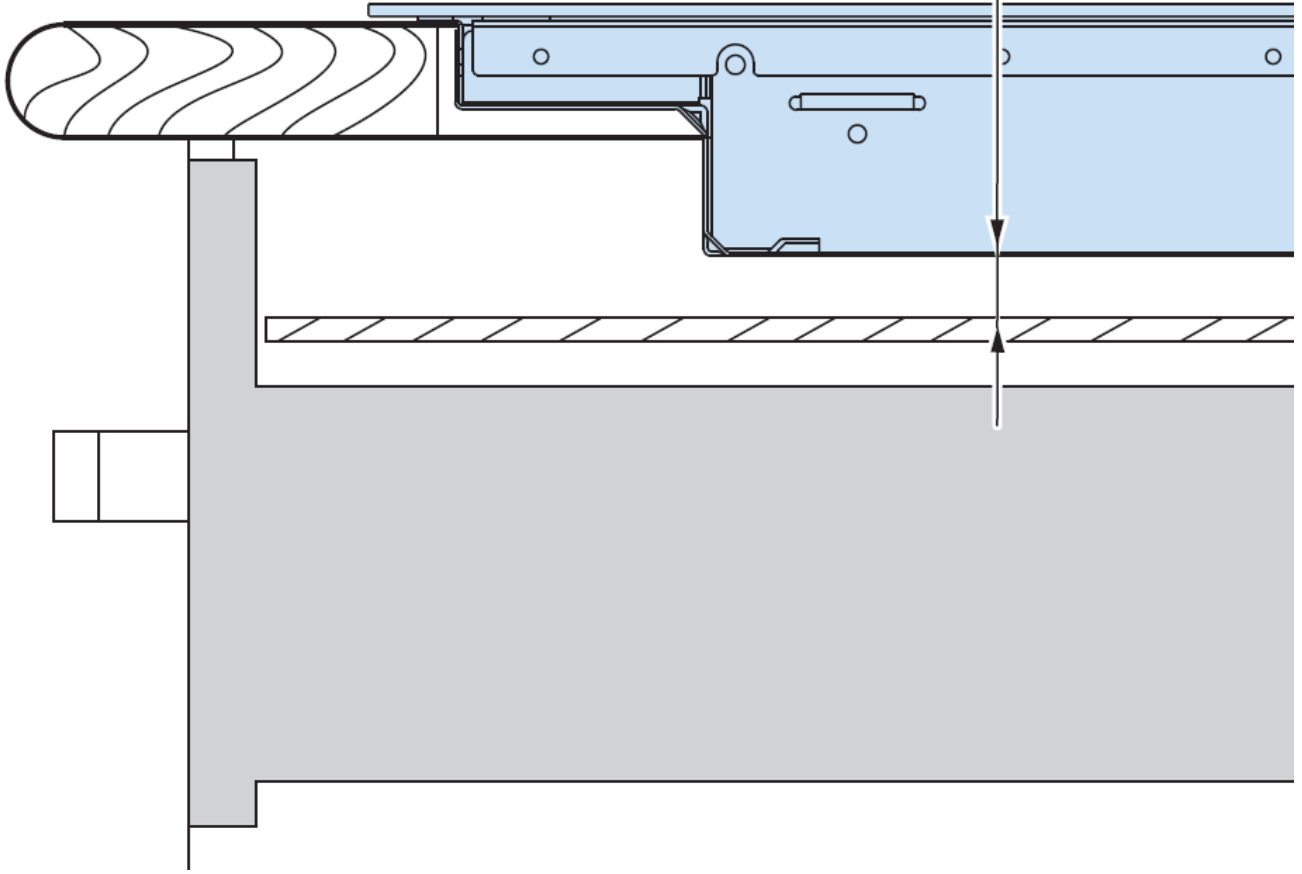



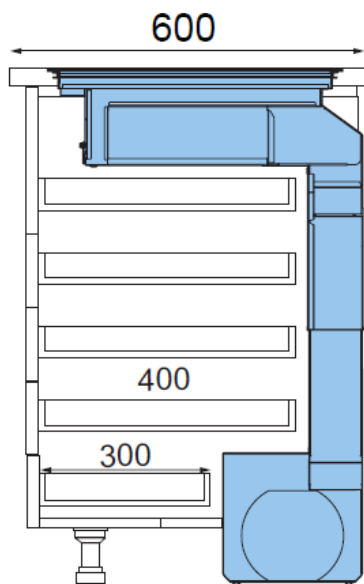

1

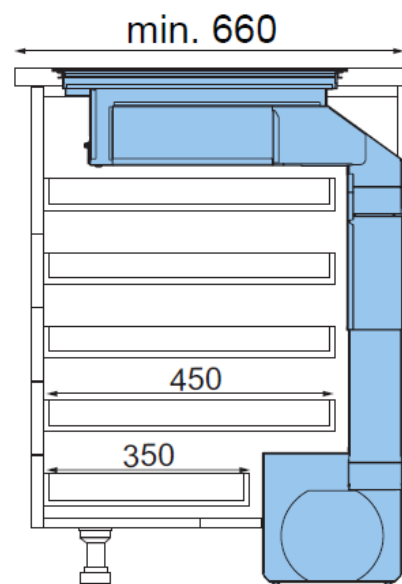

2

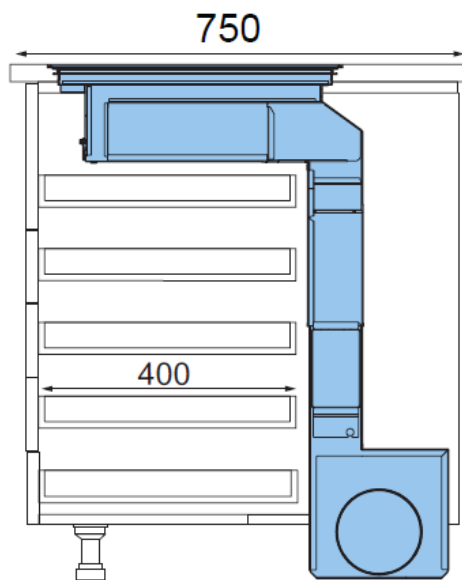

3

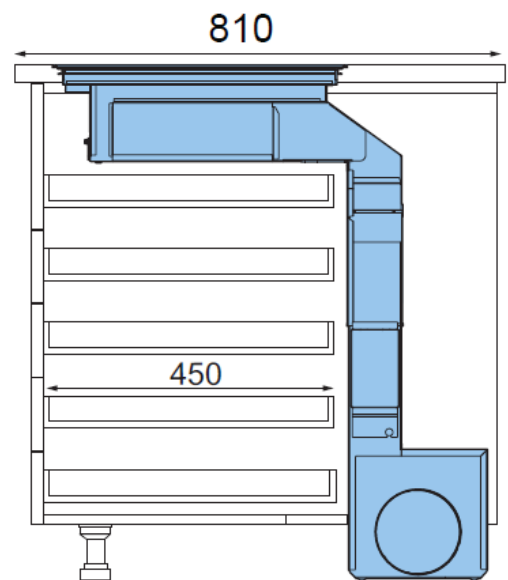

4

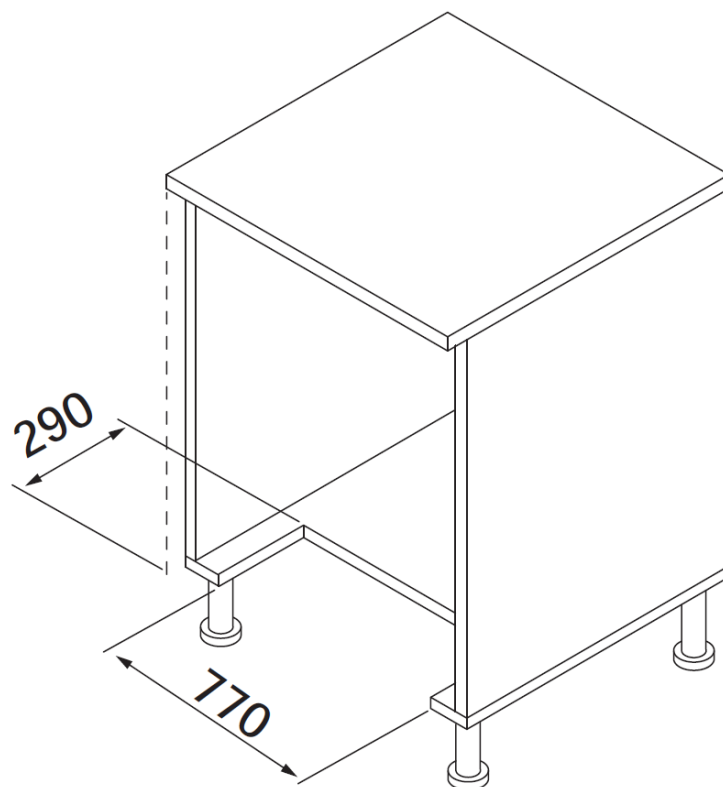
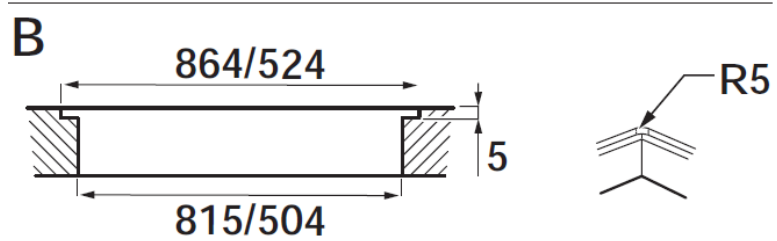
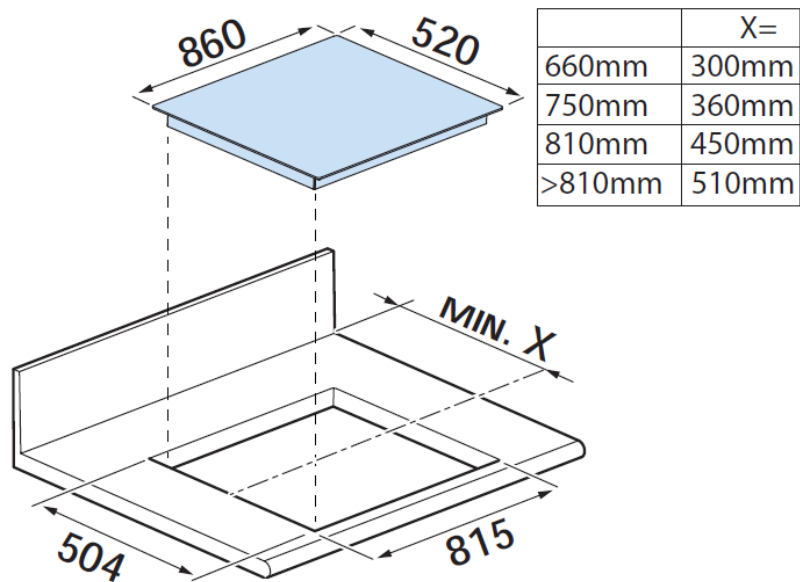

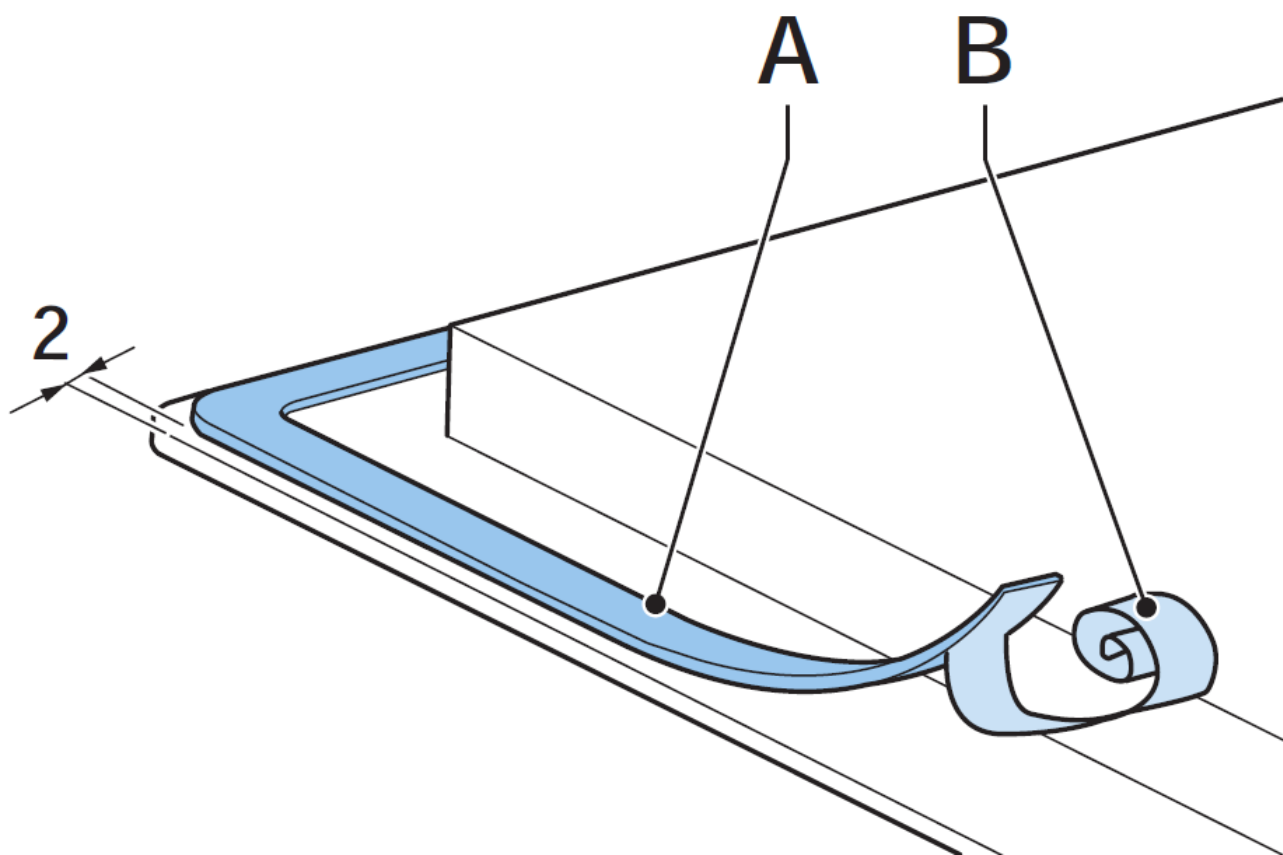

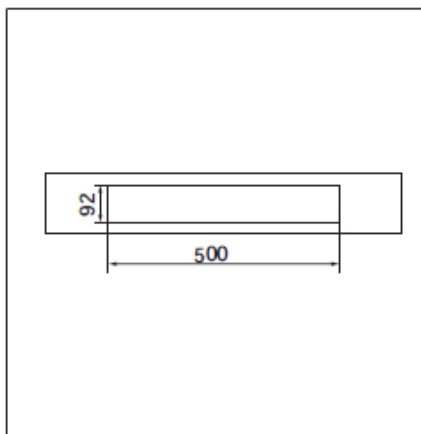
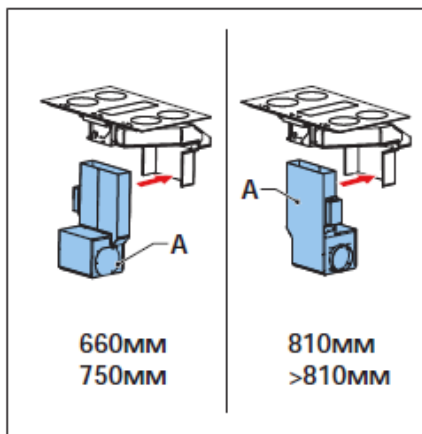
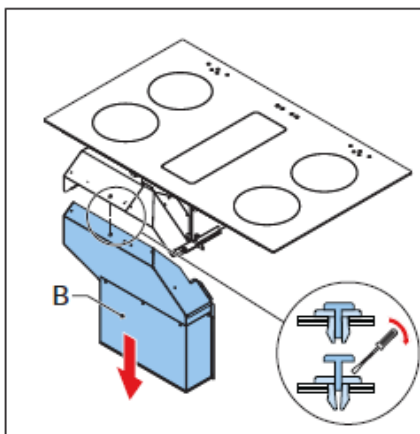
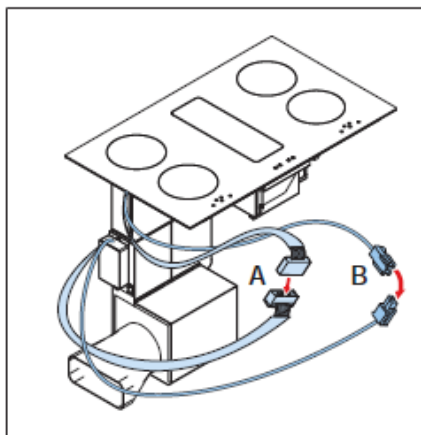
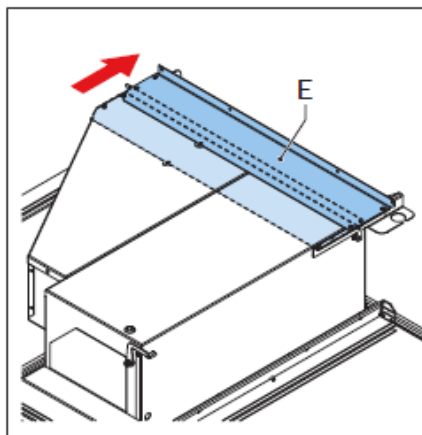
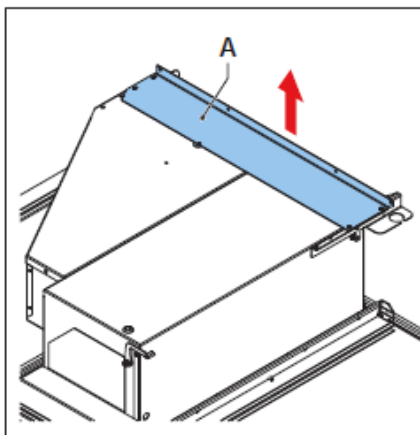
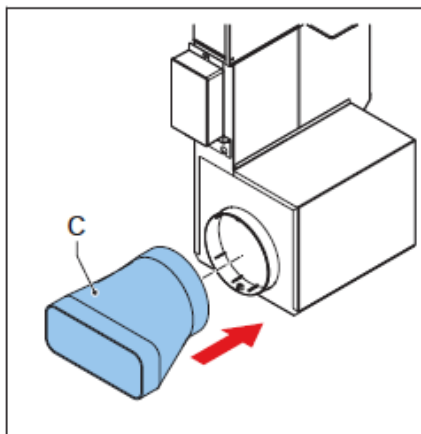
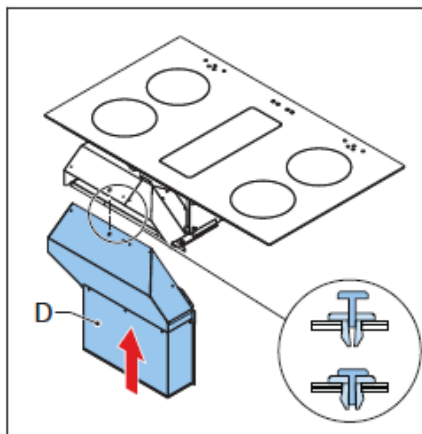
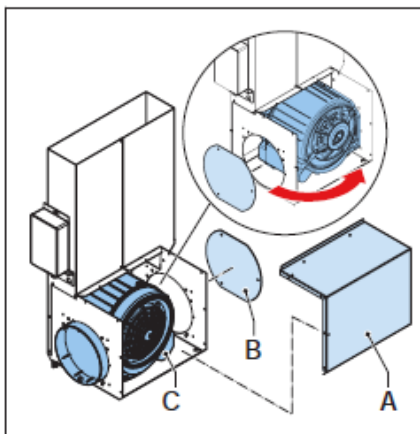
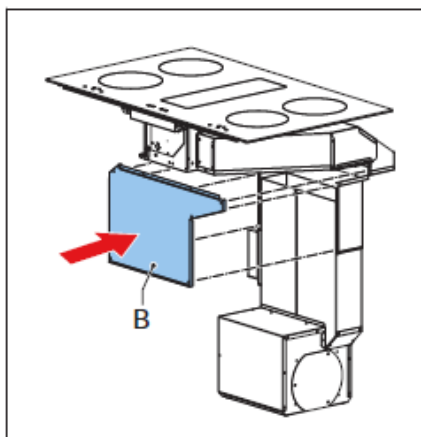
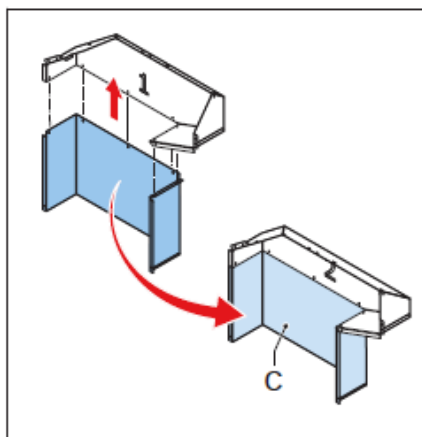
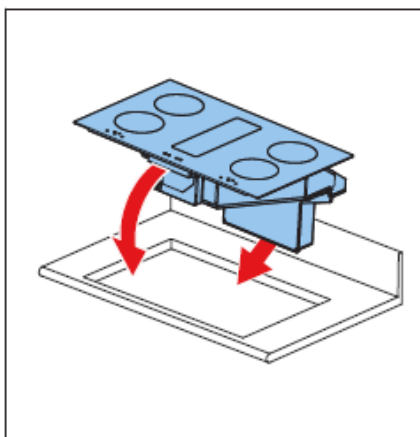

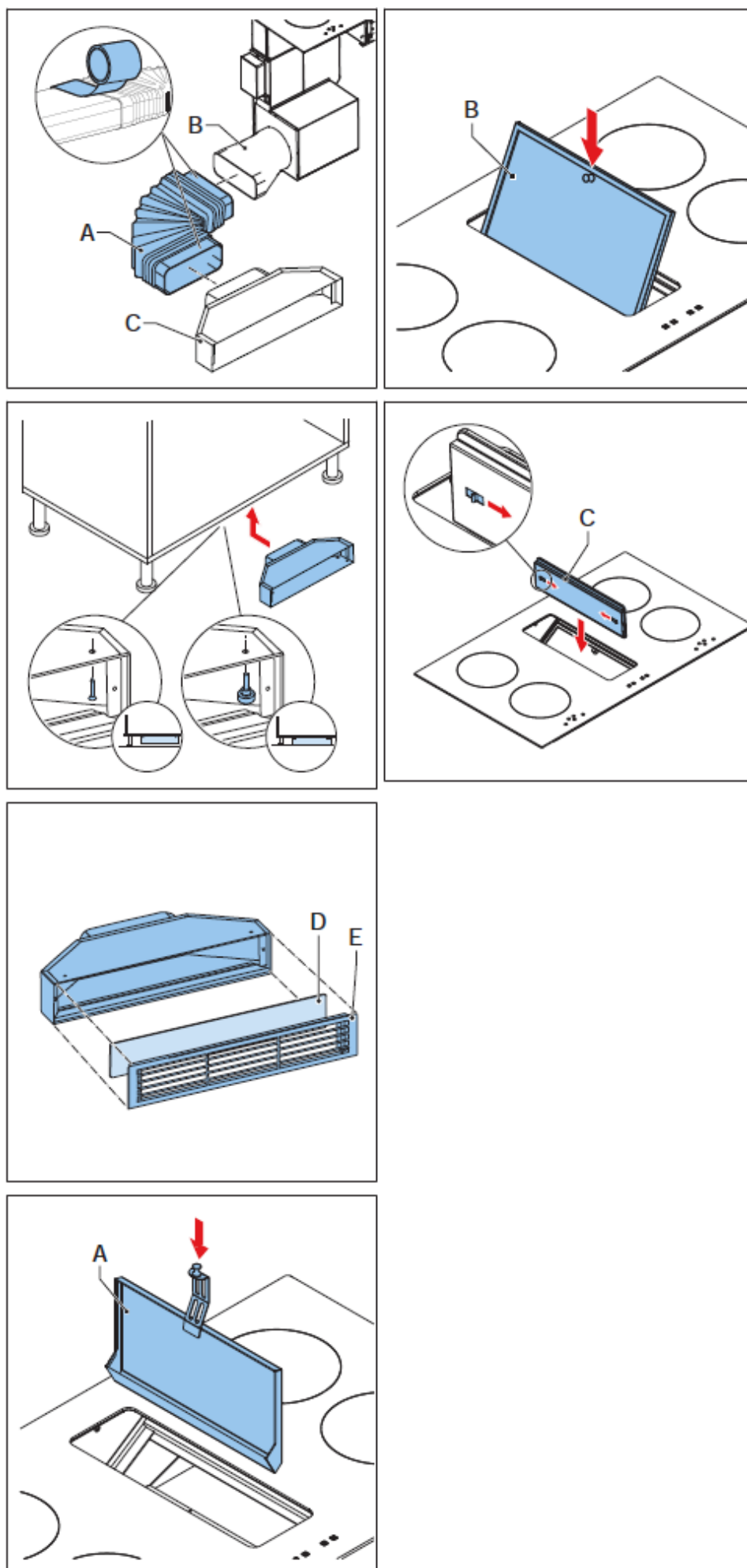



## HOW TO USE THIS DOCUMENT

1. Read this document completely. Make sure that you know and understand all the instructions.
2. Obey the safety instructions to prevent injury and/or damage to the appliance and its surroundings.
3. Do the procedures completely and in the given sequence.
4. Keep this document in a safe area for future use. This document is a part of the appliance.

## SYMBOLS USED IN THIS DOCUMENT

Safety Symbol	Function	Description
	Warning	“Warning” means that injury or death is possible if you do not obey the instructions.
	Caution	“Caution” means that damage to the appliance is possible if you do not obey the instructions.
	Note	“Note” is used to give additional information.

## Safety

### GENERAL SAFETY INSTRUCTIONS

- Fully read the manual prior to using the appliance.
- Carefully store the manual for future reference.
- Only use this appliance for the purposes described in the instruction manual.
- Children are not allowed to play with the appliance.
- Do not store objects that might be of interest to children in cabinets above or behind the appliance.
- If the safety instructions and warnings are not observed, the manufacturer cannot be held liable for any resulting damage.
- Damage as a result of incorrect connection, incorrect fitting or incorrect use does not fall under the warranty.
- The system consists of two appliances:
  - An induction hob;

- A cooker hood.

The appliances are electrically and functionally independent and have two separate serial numbers.

## **SAFETY INSTRUCTIONS FOR INSTALLATION**

- Do not store flammable objects or substances in a drawer below the appliance. Make sure that there is enough clearance between the underside of the appliance and the contents of any drawer.
- Do not install the appliance above a dish washer or washing machine. Steam may cause damage to the appliance.
- The appliance may only be fitted by a certified installer.
- The electrical connection must meet national and local regulations.
- The mains socket and mains plug must always be within reach.
- The appliance may not be connected to the mains supply via a power strip or extension cable. If this is not observed, the safety of the appliance cannot be guaranteed.
- The appliance must always be earthed.
- The mains cable should be freely suspended and may not come into contact with a drawer.
- The worktop in which the appliance is installed must be level.
- The walls and the worktop around the appliance must be heat resistant to at least 100°C. Even if the appliance itself does not get hot, the heat of a hot pan could discolor or deform the wall.

## **Description**

### **WORKING PRINCIPLE COOKER HOOD**

The appliance is used for handling the air of cooking fumes. The appliance can be installed in three different ways.

#### **Extracting**

The cooking fumes are released through a pipe that is connected to the outlet of a motor. Installing the appliance in this way gives the best results.

Using a long pipe with a lot of bends or a pipe with a diameter smaller than the outlet of the motor decreases the performance of the appliance and increases the noise that is produced.

#### **Warning:**

Never connect the pipe to a duct that contains gas or other fuels.

#### **Note:**

Pipes (Naber system) are not supplied.

#### **Filtering (Recycling)**

The cooking fumes go through a charcoal filter. The filter purifies the fumes and recycles these back to the kitchen. The charcoal filter can be placed in the base of the cabinet. Two possible grids are available for installation (10 cm and 6 cm), refer to section 'Accessories'.

Using a charcoal filter decreases the performance of the appliance. It is recommended to install the appliance in the extracting mode.

#### **Note:**

A charcoal filter is not supplied.

## Using a Plasma Filter

The cooking fumes go through a plasma filter. Refer to the user manual of the plasma filter for correct use.

### **Note:**

A plasma filter is not supplied.

## Installation

### **SAFETY INSTRUCTIONS FOR INSTALLATION**

- Follow the installation procedures completely.
- After installation, make sure that the appliance is assembled correctly. Incorrect assembly may lead to dangerous situations. The installer is liable for damage caused during incorrect installation.
- Only a qualified electrician is allowed to electrically connect the appliance.
- The appliance must be installed according to national and regional safety instructions.
- The appliance has protection class I and may only be used in combination with an earthed connection. The manufacturer is not liable for unsuitable operation and possible damage caused by unsuitable electric installations.
- The appliance must be connected to a permanent installation in which provisions for switching off are integrated, in accordance with the installation instructions.
- The appliance may only be installed above a drawer or an oven with forced ventilation. There must be a minimum distance for ventilation.
- Do not install the appliance above a refrigerator, oven without ventilation, washing machine or dishwasher.
- Make sure that the mains cable does not get jammed during installation or is running along sharp edges. If an oven is installed below it, make sure that the mains cable goes via the rear corners of the oven to the connection box. The mains cable must be placed in such a way that no contact is made with hot parts of the appliance or the oven.
- The connection point, mains socket and/or mains plug must always be accessible.
- The worktop on which the appliance is placed must be flat, horizontal and stable. Observe the instructions from the manufacturer of the worktop.
- In case of incorrect installation or connection, the warranty becomes invalid.
- Any change to the appliance, including replacement of the mains cable, must be performed by a certified installer.
- Do not change the appliance.
- Use the correct protective equipment. Refer to section 'Protective equipment'.
- Install the appliance after the kitchen cabinets are installed to prevent possible damage to the appliance.
- The appliance must be earthed and connected according to local standards.

### **INSTALLATION ITEMS**

- Induction hob
- Glass valve
- Grease filter
- Grease collector
- Duct adapter 2



- Joint
- Cooker hood
- Cover
- Screw
- Plastic locking pin
- Seal

**Note:**

There are more screws supplied than needed during the installation. There will be screws left after completing the installation.

**ACCESSORIES**

**Note:**

The accessories are not included with the appliance. They are available from the manufacturer.

- Pipes (Naber system)
- Joint
- Tape
- Flexible hose
- Filtering kit with charcoal filter

**TOOLS AND SUPPLIES**

You need these tools and supplies during installing:

- Tape measure
- Pencil
- Philips screwdriver
- Flat head screwdriver
- Sealant
- Sealant gun

**PROTECTIVE EQUIPMENT**

Always wear protective equipment during installing:

- Safety hat
- Safety shoes
- Safety gloves

**REQUIREMENTS FOR INSTALLATION**

The appliance is suitable for 4 different types of kitchen cabinets:

1. Kitchen cabinets with a depth up to 660 mm.

2. Kitchen cabinets with a depth up to 750 mm.
3. Kitchen cabinets with a depth up to 810 mm.
4. Kitchen cabinets with a depth of more than 810 mm.

The figure shows an overview of the dimensions of the appliance after installation.

**Warning:**

Obey the requirements for installation.

- Make sure that the dimensions of the cabinet are suitable for installing the appliance. Refer to the figure.
- Make sure that the minimum height of the plinth of the cabinet is 100 mm so that the air ducts can pass below the cabinet.

**Note:**

There are accessories available for plinths with a height up to 60 mm. Refer to the website of the manufacturer.

- Make sure that you use heat resistant glue (100°C) to prevent changes in shape and color.
- Install the appliance without adjacent kitchen furniture or a wall on both sides (A) or with kitchen furniture on only one side of the appliance (B and C).
- Do not install the appliance with kitchen furniture on both sides that is higher than the appliance (D). There is a risk of fire.
- Do not use wooden decoration plates or boards.
- There must be a minimum distance of 760 mm between the appliance and any kitchen furniture that is located above the appliance.
- There must be a distance of 50 mm between the appliance and the wall or the sides of the kitchen furniture.
- If the appliance is installed above a drawer, make sure that there is a minimum space of 30 mm for the ventilation openings at the bottom of the appliance.
- The upper drawer inside the kitchen cabinet can have a maximum depth of 450 mm or 400 mm and the lower drawer of 350 mm or 300 mm. This depends on the installation direction of the motor of the cooker hood.

## UNPACKING

1. Remove the packaging.

**Caution:**

Make sure that you remove all labels and stickers from the ceramic glass.

2. Examine the appliance for damage.
3. Make sure that the voltage is the same as on the type plate.

## PREPARING FOR INSTALLATION

1. Make sure that the worktop is prepared according to the dimensions of the induction hob (A).

**Note:**

Use dimensions B if the appliance must be flush with the worktop.

2. Make sure that the cabinet is prepared according to the dimensions of the cooker hood ©).

**Note:**

If necessary, you can remove the back of the cabinet.

**Note:**

If the installation includes a plasma filter, the opening in the cabinet has to be 660 mm.

3. Install the seal for non-flush installations of the induction hob. Refer to section 'Installing the seal'.

For an overview of the items for installing the appliance, refer to section 'Installation items'.

For an overview of the items for installing the accessories, refer to section 'Accessories'.

## **INSTALLING THE SEAL**

### **Caution:**

The seal must be installed before you install the induction hob. Do not install the appliance without the seal.

### **Note:**

This procedure is only valid for non-flush installations of the appliance.

1. Remove the protective film (B) from the seal (A).
2. Put the seal around the appliance. Make sure that there is a distance of 2 mm between the appliance and the seal.

## **INSTALLING THE INDUCTION HOB**

### **Caution:**

Do not block the ventilation openings of the appliance.

### **Non-Flush Installation**

1. Put the appliance in the opening of the worktop.

### **Flush Installation**

1. Apply sealant along the edges of the appliance.
2. Put the appliance in the opening of the worktop.
3. Remove too much sealant.

## **CHANGING THE OUTPUT DIRECTION OF THE MOTOR**

The output direction of the motor can be on the left or on the right side of the cooker hood.

1. Remove the screws.
2. Remove the two covers (A) and (B).
3. Turn the motor (C) to the opposite direction.
4. Install the two covers. Use the screws.

## **REPLACING THE DUCT ADAPTER**

For kitchen cabinets with a depth up to 750 mm or with a depth of more than 810 mm you can replace the duct adapter to increase the space for the drawers.

### **Removing Duct Adapter 1**

1. Remove the screws.

2. Remove the cover (A).
3. Remove the screws.
4. Loosen the plastic locking pin. Use a screwdriver.
5. Remove the extension together with the duct adapter marked 1 (B).

### **Replacing the Duct Adapter**

1. Remove the screws.
2. Remove the duct adapter marked 1 from the extension (C).
3. Attach the duct adapter marked 2 to the extension. Use the screws.

### **Installing Duct Adapter 2**

1. Put the plastic locking pin in the opening.
2. Attach the extension together with the duct adapter marked 2 (D).
3. Install the cover (E). Use the screws.

### **INSTALLING THE COOKER HOOD**

#### **Caution:**

For kitchen cabinets with a depth up to 750 mm or with a depth of more than 810 mm, it is necessary to replace the duct adapter before installing the cooker hood. Refer to section 'Replacing the duct adapter'.

1. Put the cooker hood (A) in the kitchen cabinet.
2. Attach the cooker hood to the duct. Use the screws.
3. Install the cover (B). Use the screws.
4. Install the joint for the pipes (C). Use the screws.

### **INSTALLING THE ELECTRICAL CONNECTIONS**

1. Connect the connectors for the controls (A).
2. Connect the connectors for the sensor (B).
3. Install the mains plug for the two mains cables of the induction hob.

#### **Note:**

The mains cable of the cooker hood is supplied with a mains plug.

### **INSTALLING THE FILTERING KIT (OPTIONAL)**

1. Prepare the plinth of the kitchen cabinet according to the dimensions of the box for the filter.

#### **Note:**

Make sure that the grid and the filter are removed.

2. Connect one side of the flexible pipe (A) to the joint (B) on the cooker hood. Use the tape.
3. Connect the other side of the flexible pipe to the box of the filter (C). Use the tape.
4. Install the box of the filter to the cabinet:
  - Use the knobs to fit the box between the cabinet and the floor.

- Use the screws to attach the box directly to the cabinet.
5. Put the carbon filter (D) in the box of the filter.
  6. Install the grid (E).

## CONNECTING THE APPLIANCE

### Note:

The appliance has three mains plugs: two for the induction hob and one for the cooker hood.

1. Make sure that the electrical system is suitable for the load of the appliance.
2. Make sure that the mains socket is grounded.
3. Connect the appliance to the mains supply.

After connecting the display of the appliance lights up for a short time. The appliance is ready for use.

## FINISHING THE INSTALLATION

1. Put the grease collector (A) in the opening.
2. Put the grease filter (B) in the grease collector.
3. Install the glass valve (C).
  - Put one side of the valve in the opening on the side.
  - Push the slider on the other side of the valve.
  - Put the other side of the valve in the opening and release the slider.

### Inventum huishoudelijke Apparaten B.V.

Meander 901

6825 MH Arnhem

Tel: 0800 -4583688

Email: [info@inventum.eu](mailto:info@inventum.eu)

Website: [www.inventum.eu](http://www.inventum.eu)

## Documents / Resources

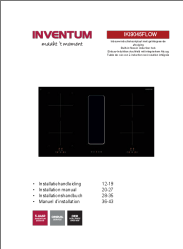
	<p><b><a href="#">INVENTUM IKI9045FLOW Built-In Flow-In Induction Hob</a></b> [pdf] Instruction Manual          IKI9045FLOW Built-In Flow-In Induction Hob, IKI9045FLOW, Built-In Flow-In Induction Hob</p>
-------------------------------------------------------------------------------------	-----------------------------------------------------------------------------------------------------------------------------------------------------------------------------------------------------------------

## References

-  [Inventum Huishoudelijke Apparaten - Altijd 5 jaar garantie!](#)