



inventor WiFi Function Dehumidifier User Manual

[Home](#) » [inventor](#) » inventor WiFi Function Dehumidifier User Manual 

inventor WiFi Function Dehumidifier



Contents

1 BEFORE YOU START

1.1 Before you start

2 Precautions

3 Download APP

4 Account registration

5 CONNECTING YOUR DEHUMIDIFIER WITH INVENTOR CONTROL

5.1 Add Manually with Easy Pairing

5.2 Add Manually with AP Mode

5.3 Add Automatically

6 Customer Support

7 Documents / Resources

7.1 References

8 Related Posts

BEFORE YOU START

Before you start

- Verify that your router broadcasts Wi-Fi at 2.4GHz.
- If you have a Dual Band router, make sure that the two Wi-Fi networks have different names (SSIDs).

- Place your Dehumidifier near your router to ensure proper connection.
- Verify that your mobile device's data are disabled.
- It is necessary to forget any other around network and make sure the Android or iOS device is connected to the same wireless network.
- Be certain that the Android or IOS platforms operate correct and connect to your selected Wireless network automatically.

Technical note:

Transmit frequency: 2412-2472MHz

Maximum transmit power: <20dBm

Precautions

Applicable systems:

- Requires Android 4.4 or later.
- Requires iOS 9.0 or later. Compatible with iPhone, iPad, and iPod touch

Notice:

- Keep your APP updated with the latest version.
- It is possible that some Android and IOS devices may not be compatible with this APP. Our company will not be held responsible for any issues resulted from the incompatibility.

Cautions:

- You might experience a short delay between the screen and the display, this is normal.
- To use the QR code option, the cam of your smartphone or tablet should be 5mp or above.
- Under certain network connections, it is possible the pairing could time out with no connection, if this occurs please perform network configuration once again.
- For improvement purposes, this APP may be updated without any prior notice. The actual configuration process may be slightly different from the one mentioned in this manual.
- Please check our website for more information: <https://www.inventorairconditioner.com/blog/faq/wi-fi-installation-guide>

Download APP

- **CAUTION:** The QR code below, is for downloading the APP only.



[App Store](#)



Play Store

- Android users: scan Android QR code or visit Play Store and search for “Inventor Control” app.
- IOS users: scan iOS QR code or visit App Store and search for “Inventor Control” app.

Account registration

Select “Register” to register a new account.



Log in with Existing Account

Register

Read the Privacy Policy and User Agreement and agree to continue.

Notice

We understand the importance of privacy. In order to more fully present our collection and use of your personal information, we have revised our privacy policy and user agreement in detail in accordance with the latest laws and regulations. When you click [Agree], you have fully read, understood and accepted all of the updated Privacy Policy and User Agreement. Please take some time to become familiar with our privacy policy, and if you have any questions, please feel free to contact us.

[Privacy Policy](#) and [User Agreement](#)

Disagree

Agree

Register

Select your Region and enter you email address or your mobile phone number to receive a verification code. Press "Get Verification Code".

12:31 PM

93%

Register

Greece

example@inventor.ac

Get Verification Code

☒

Agree and submit the Agreement [User Agreement](#) and [Privacy Policy](#)

Enter the verification code and proceed to set your password.

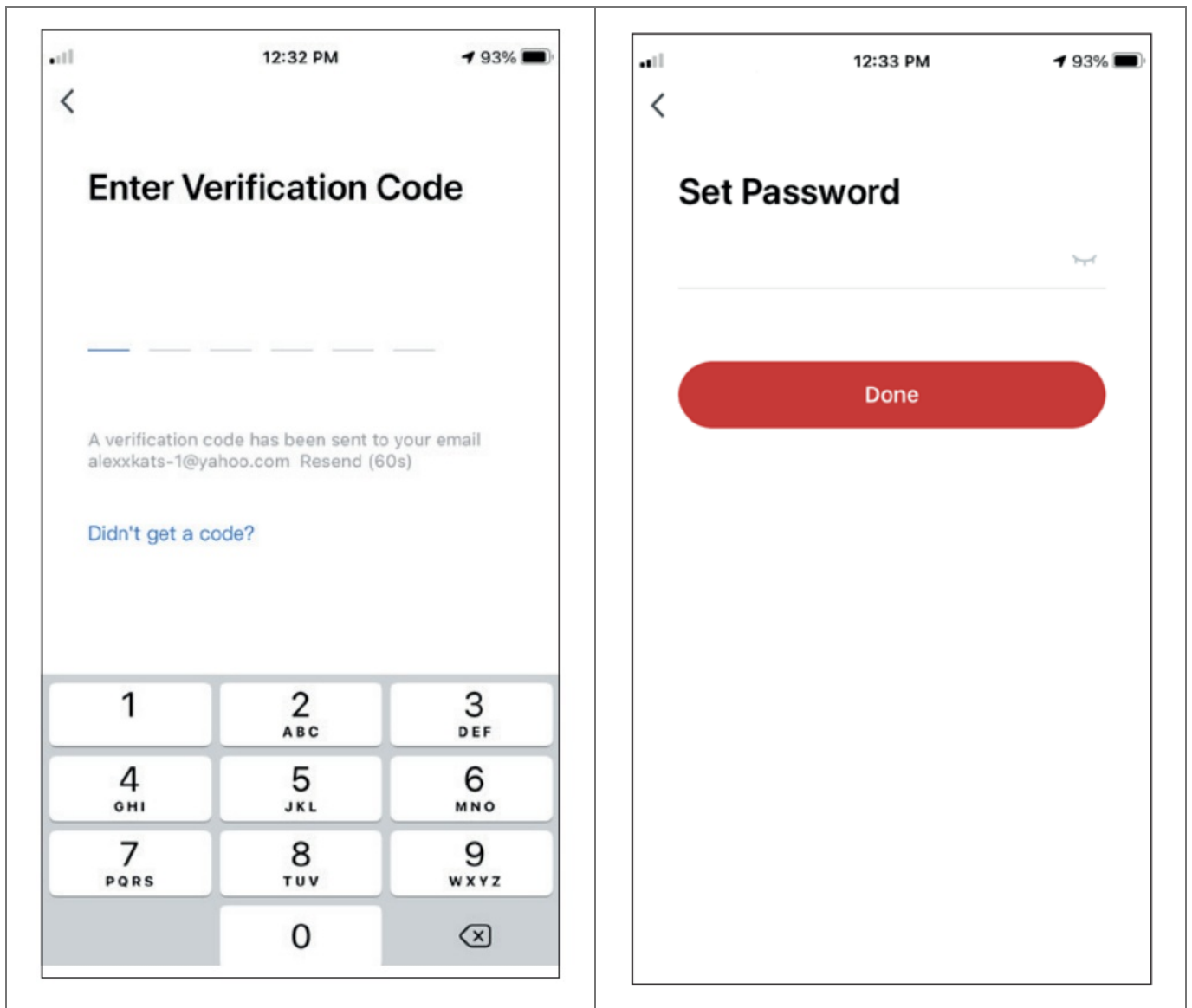

CONNECTING YOUR DEHUMIDIFIER WITH INVENTOR CONTROL

Add Manually with Easy Pairing

Step 1: Select "Add Device" or the "+" icon on the top right.

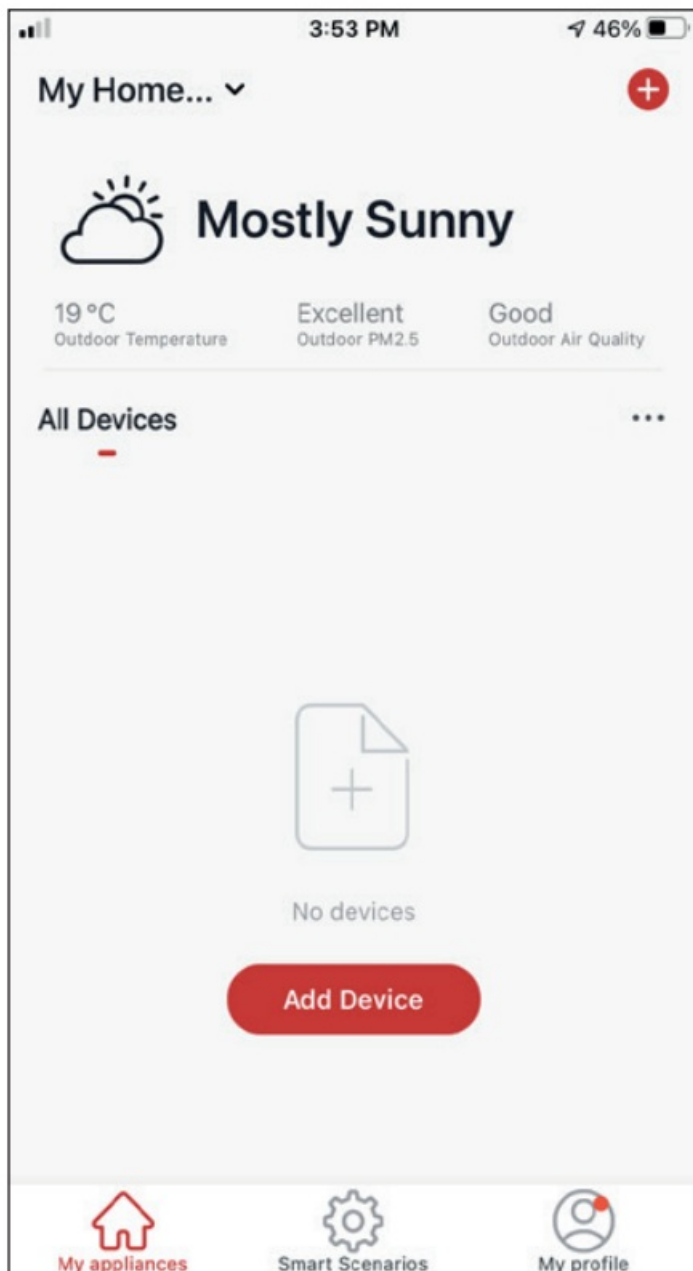

Step 2: Select “Add Manually” on the top bar, then in the left side menu, select Dehumidifier and the model name



Step 3: Select your WiFi and input your password.

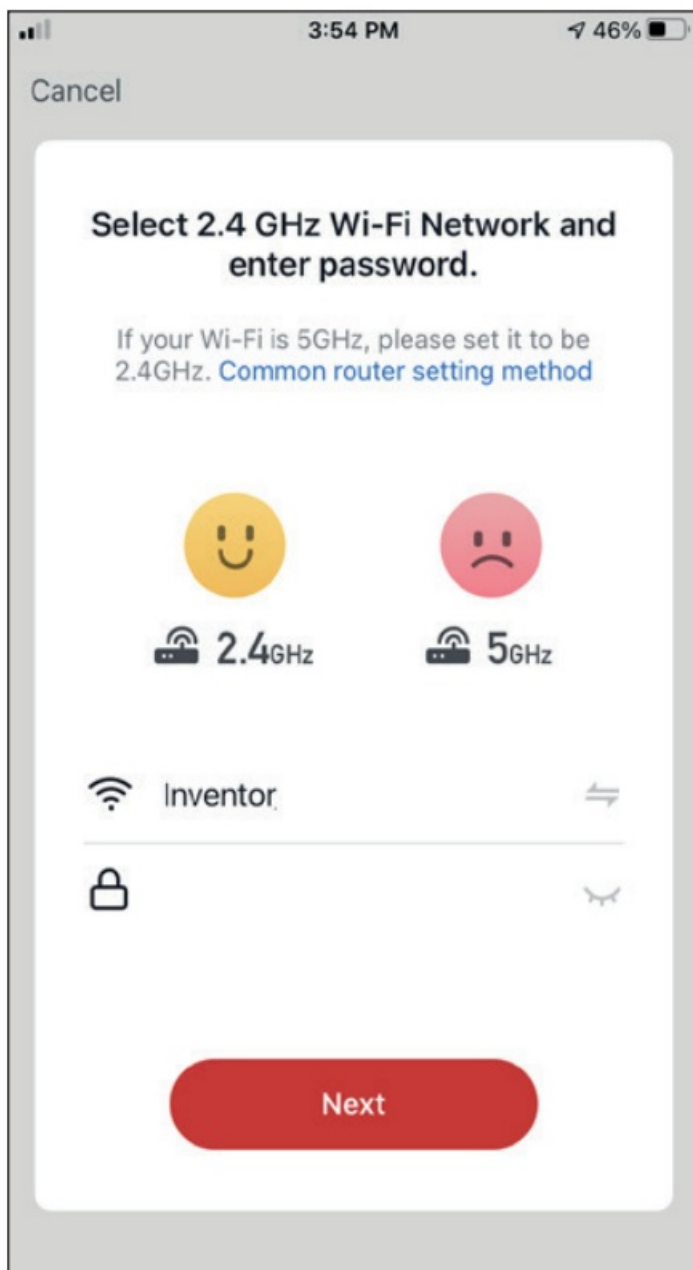

Step 4: Press for 3 seconds the connection button on the control panel, marked as (3" ) to enter the pairing mode. Verify that the pairing indication on the display of the device blinks fast and press "Next". Refer to the user's manual of your dehumidifier regarding the relevant connection button, as it may vary on your device.

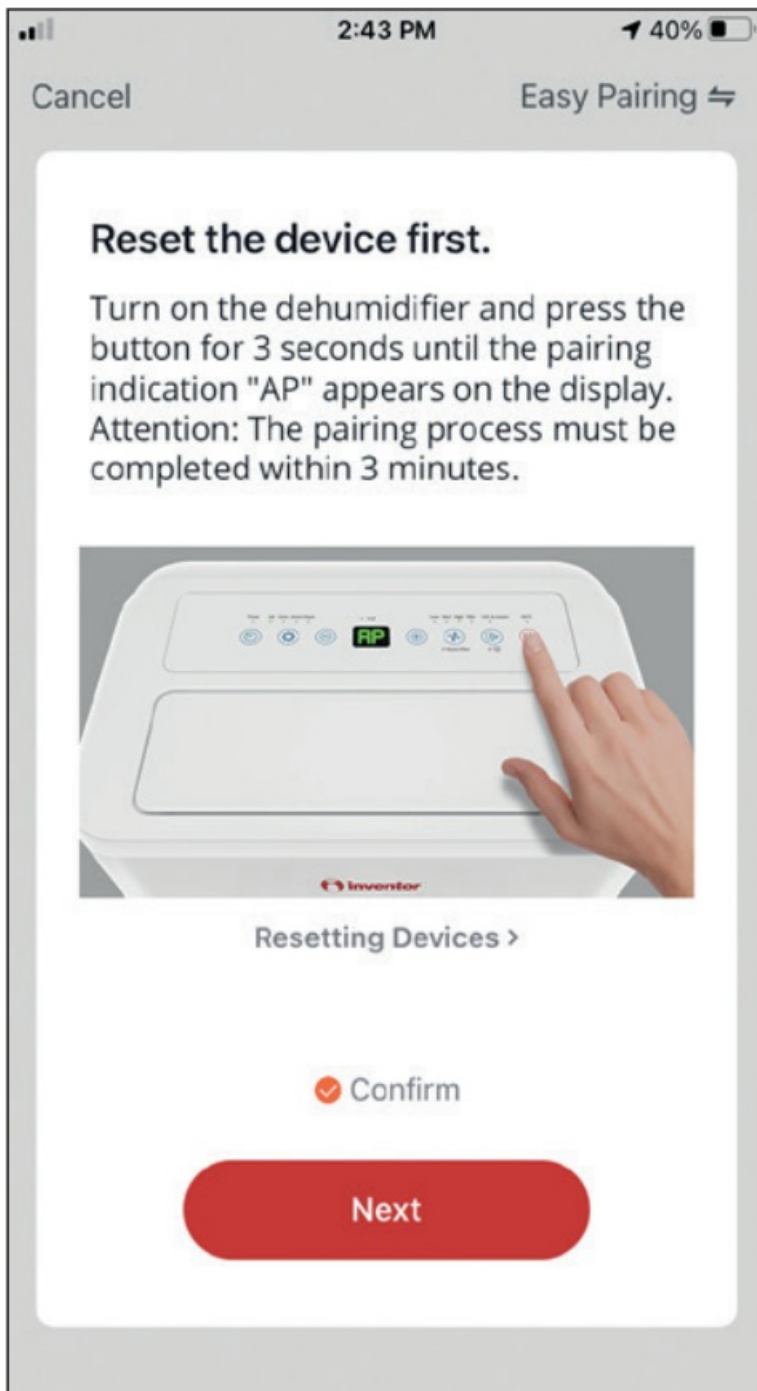

Step 5: Allow a few moments for the pairing process to complete.

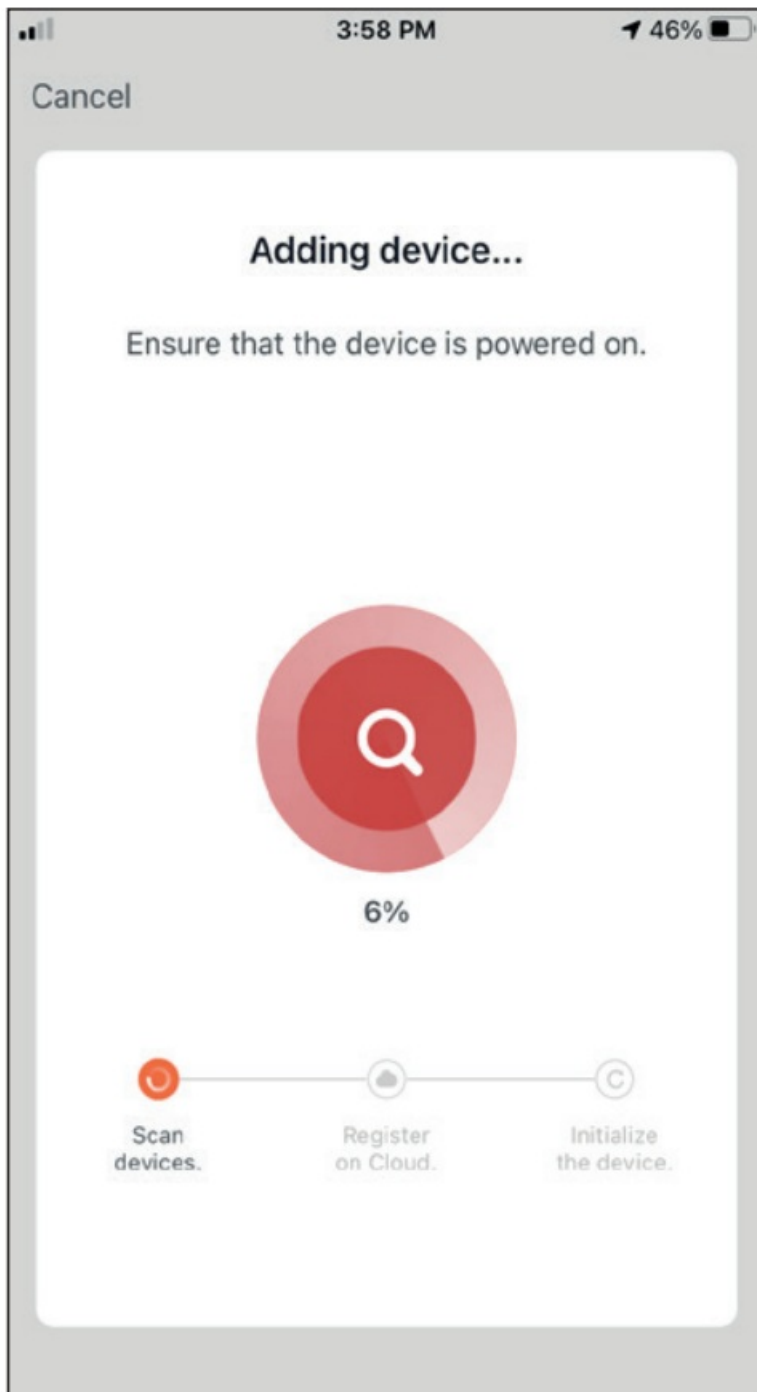

Step 6: When the pairing is completed if you wish, you may rename your device. Press “Done” when ready.

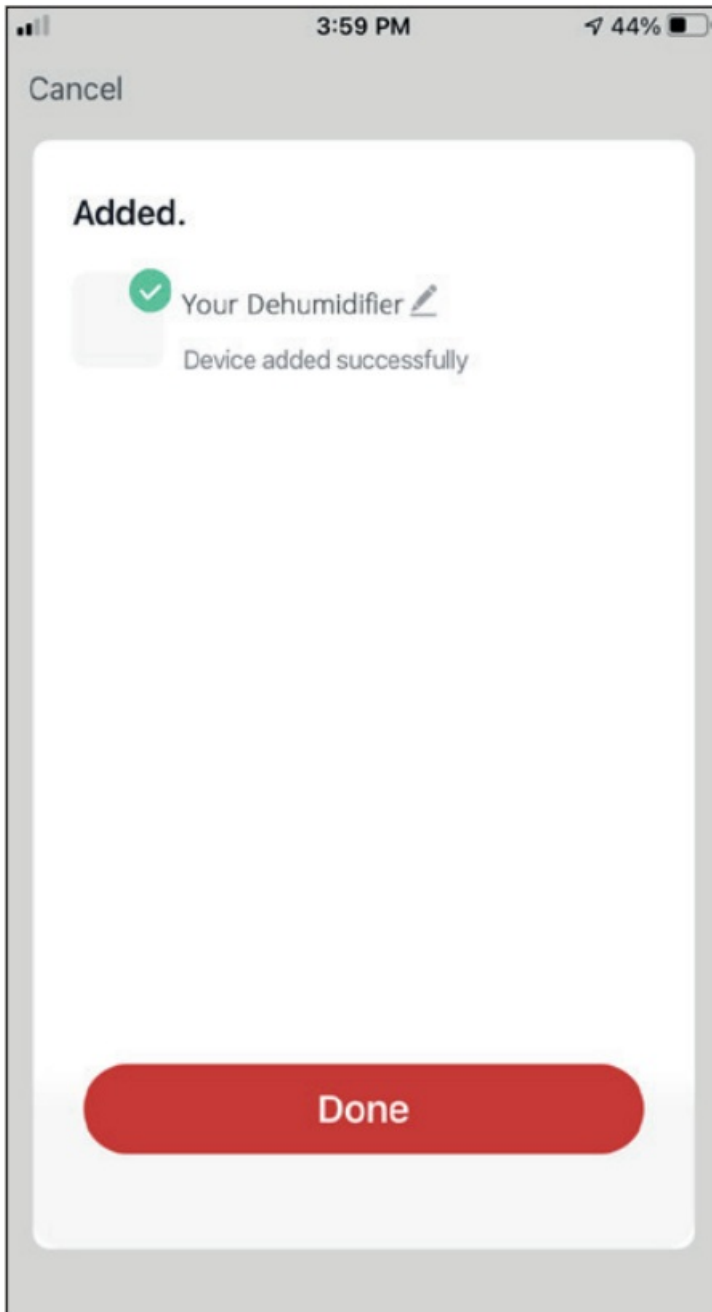

You are all set.

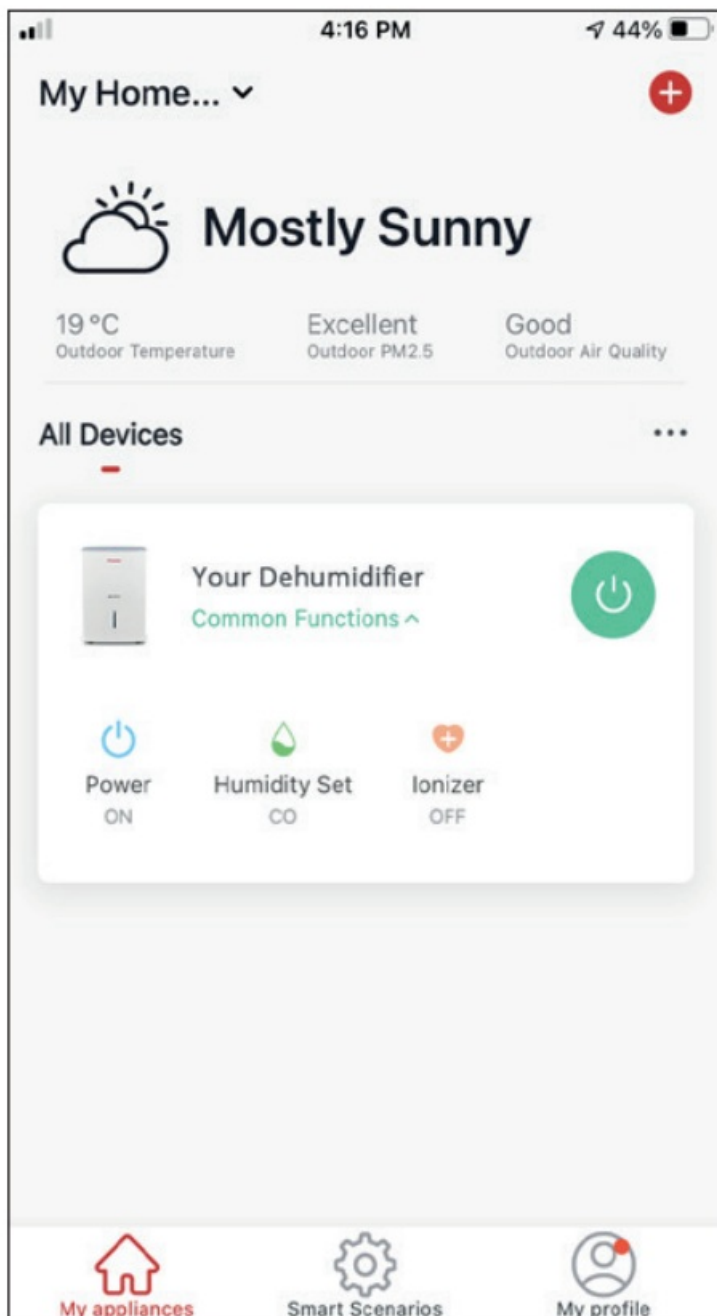

Add Manually with AP Mode

Step 1: Select “Add Device” or the “+” icon on the top right.

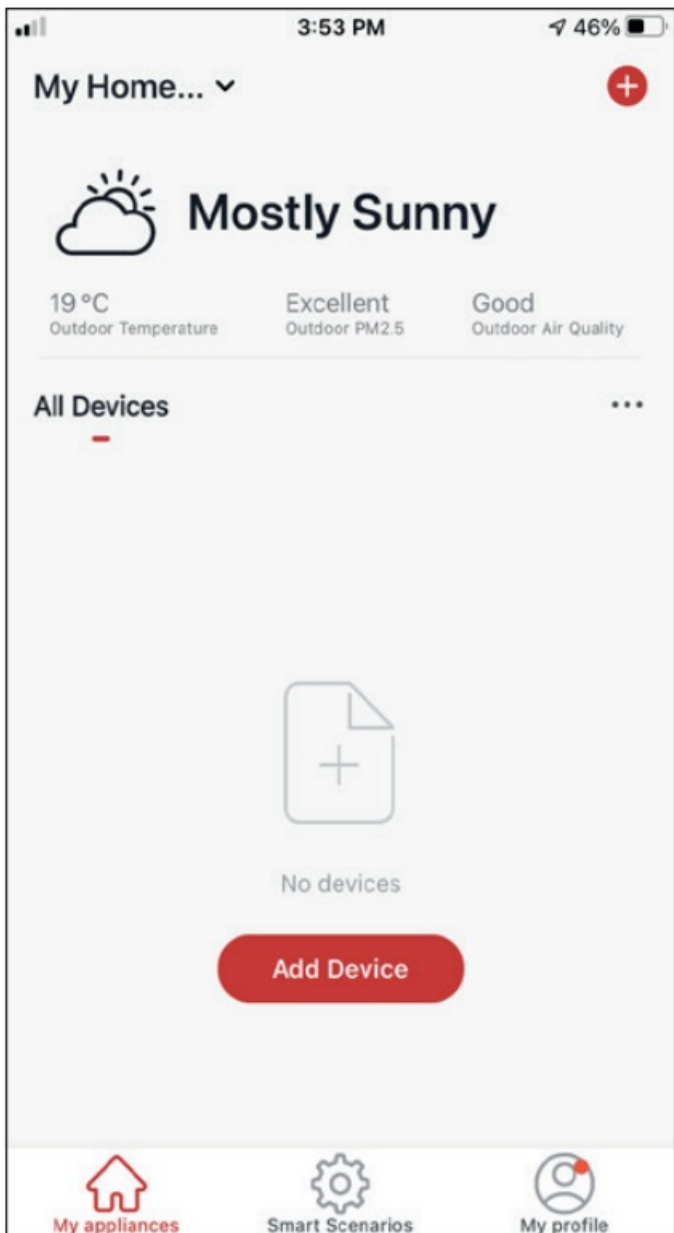

Step 2: Select “Add Manually” on the top bar, then in the left side menu, select Dehumidifier and the model name

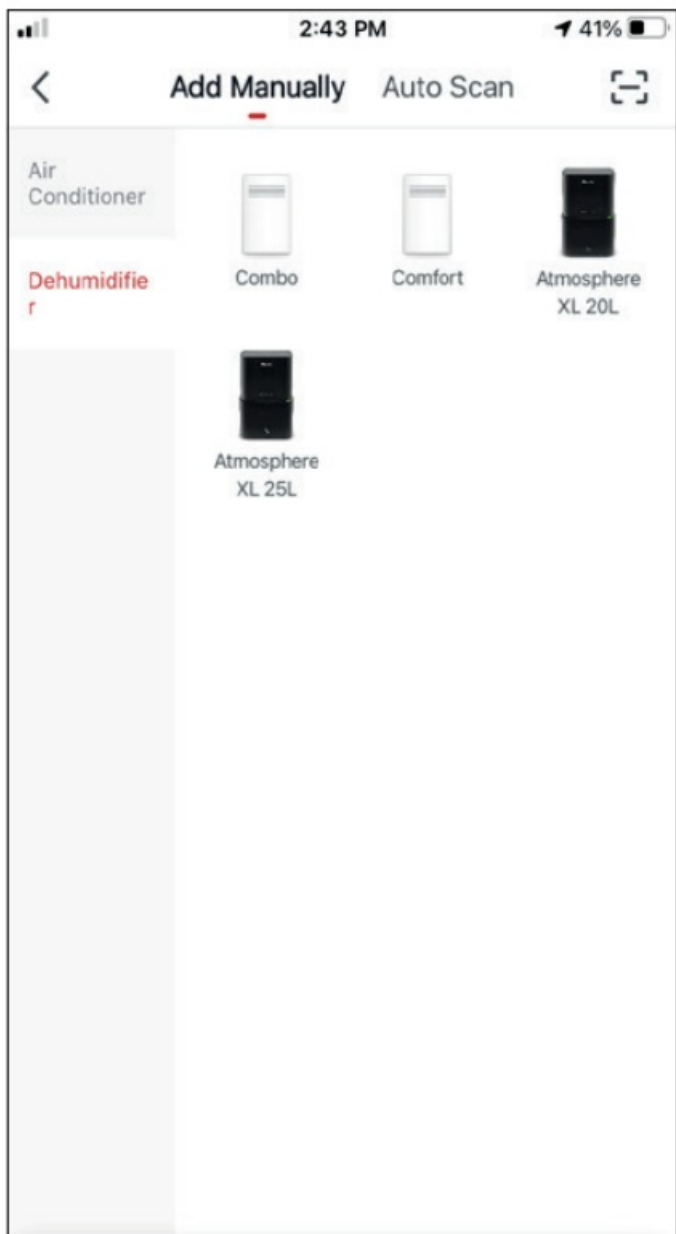

Step 3: Select your WiFi and input your password.

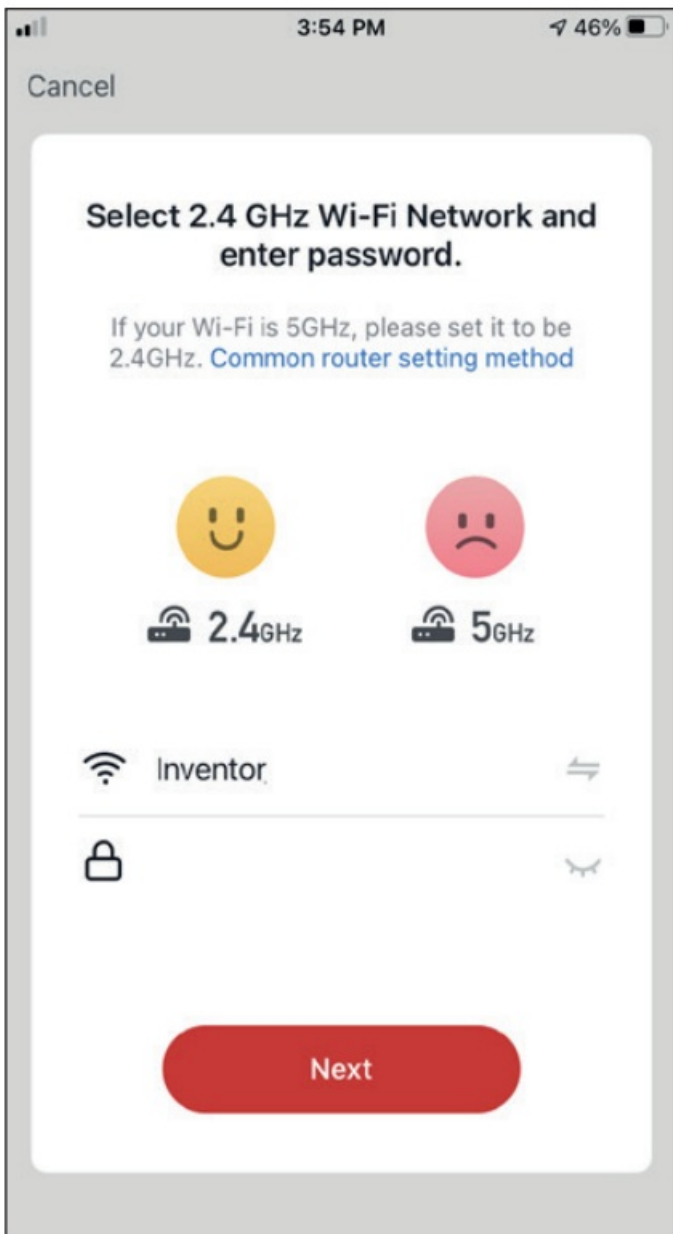

Step 4: Tap on “Easy Pairing” on the top right and select “AP Mode”.

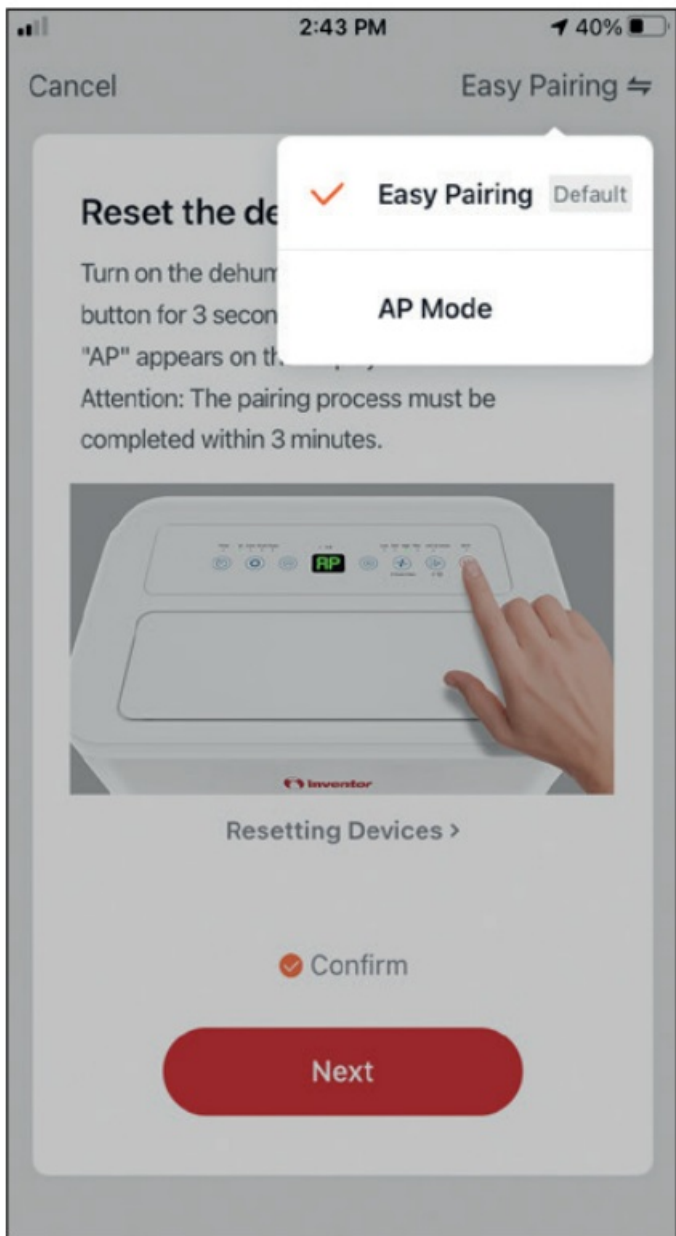

Step 5: Press for 3 seconds the connection button on the control panel, marked as (3" ) to enter the pairing mode. Verify that the pairing indication on the display of the device blinks fast and press "Next". Refer to the user's manual of your dehumidifier regarding the relevant connection button, as it may vary on your device.

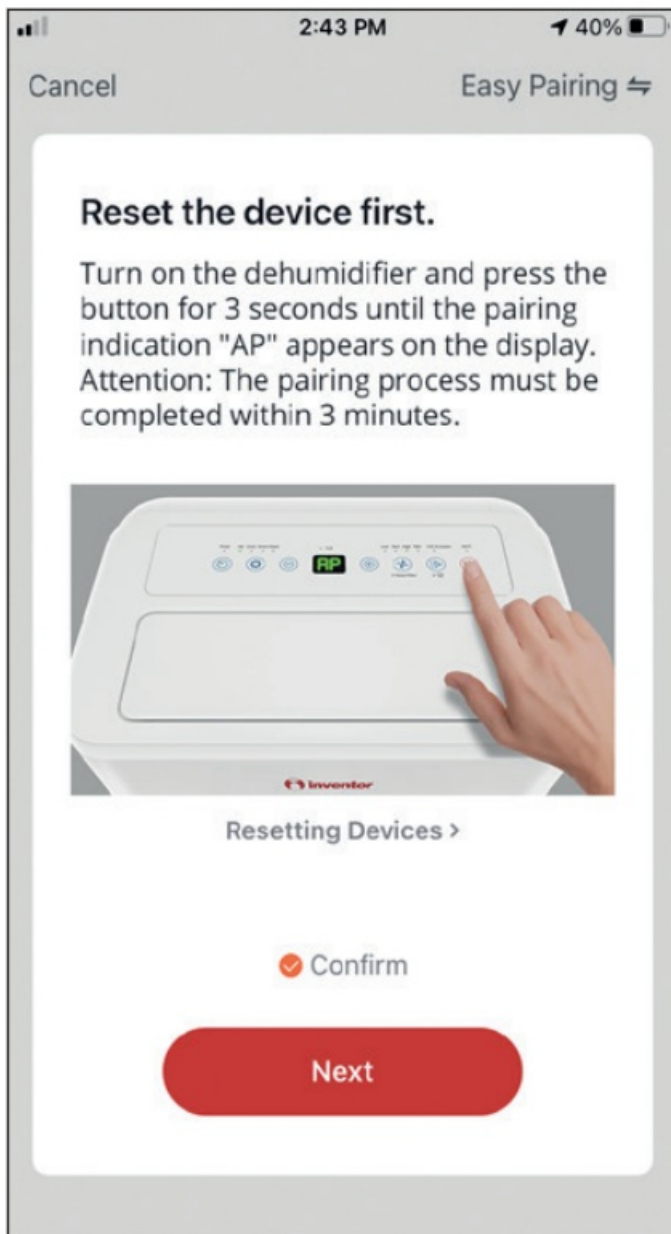

Step 6: Press “Go to Connect” to enter your device’s WiFi Networks.



Step 7: From your mobile device settings, connect to the dehumidifier's network "SmartLife XXXX". Return to the app and press "Next".

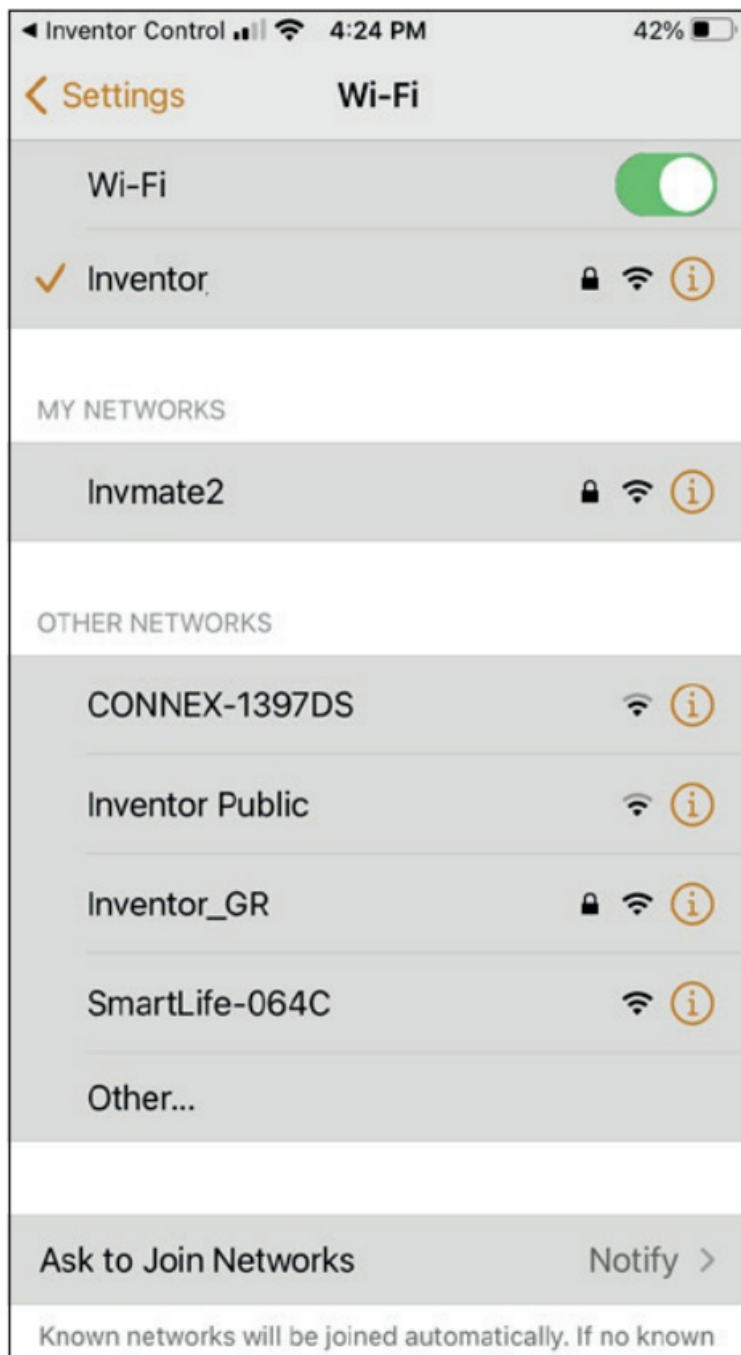

Step 8: Allow a few moments for the pairing process to complete.

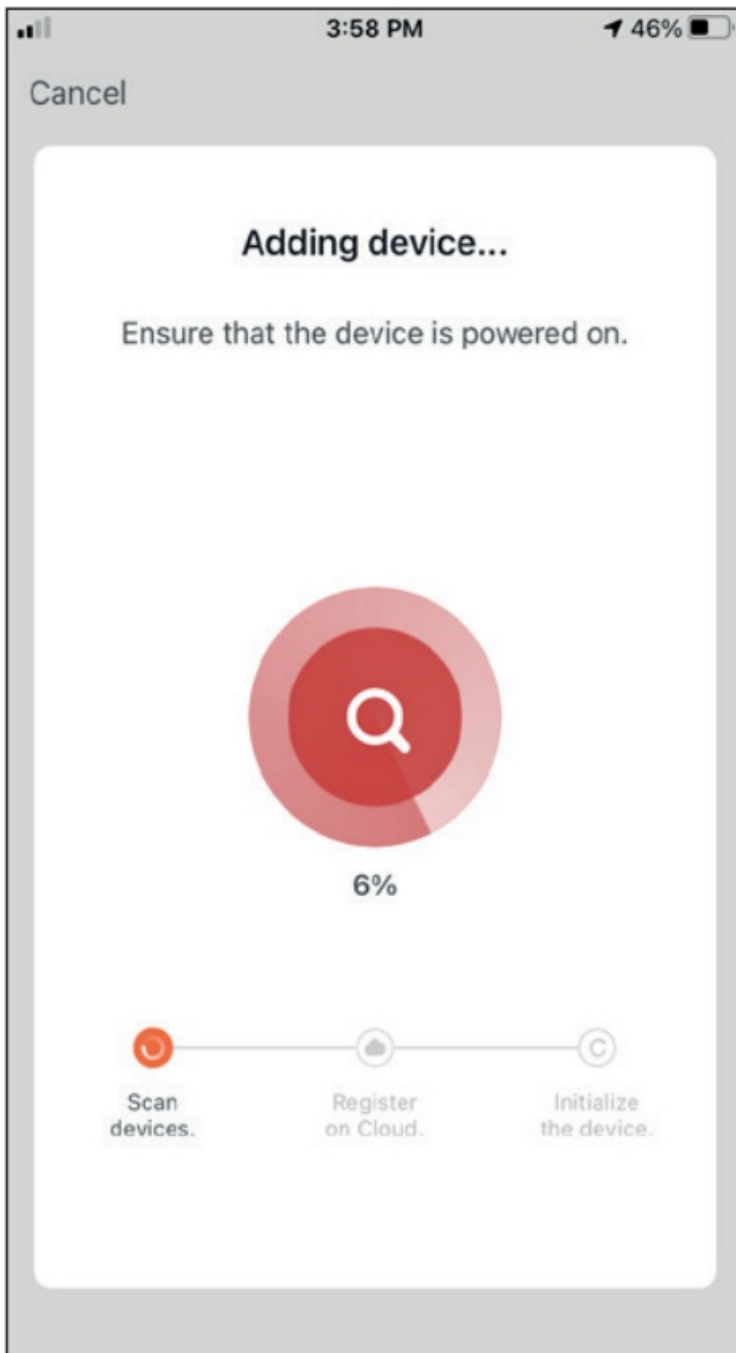

Step 9: When the pairing is completed if you wish, you may rename your device. Press “Done” when ready.

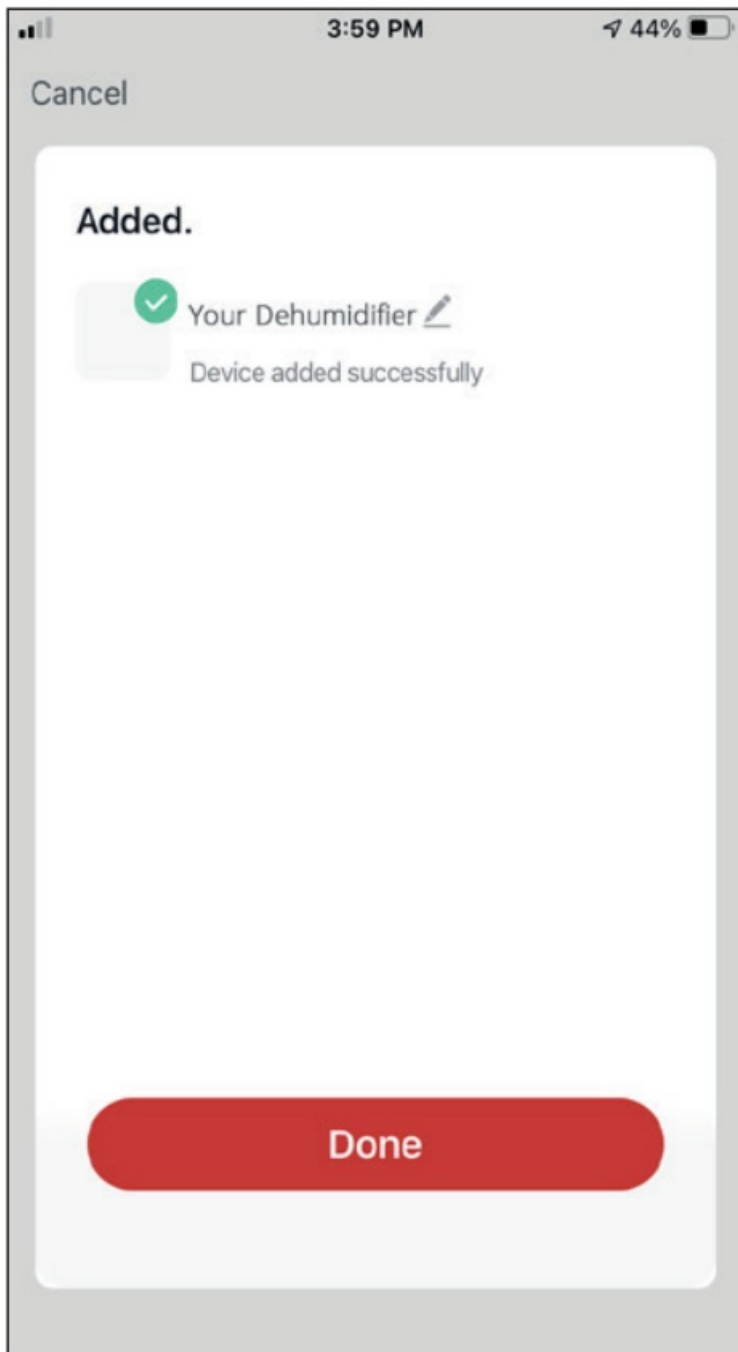

You are all set.

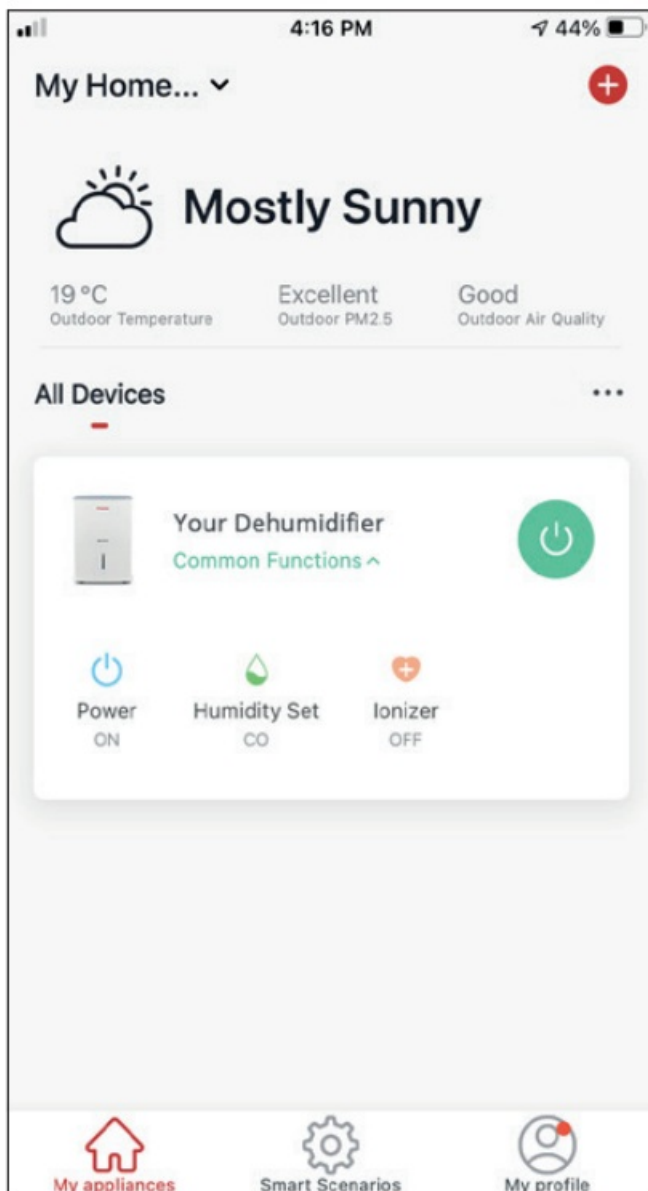

Add Automatically

Step 1: Select "Add Device" or the "+" icon on the top right.

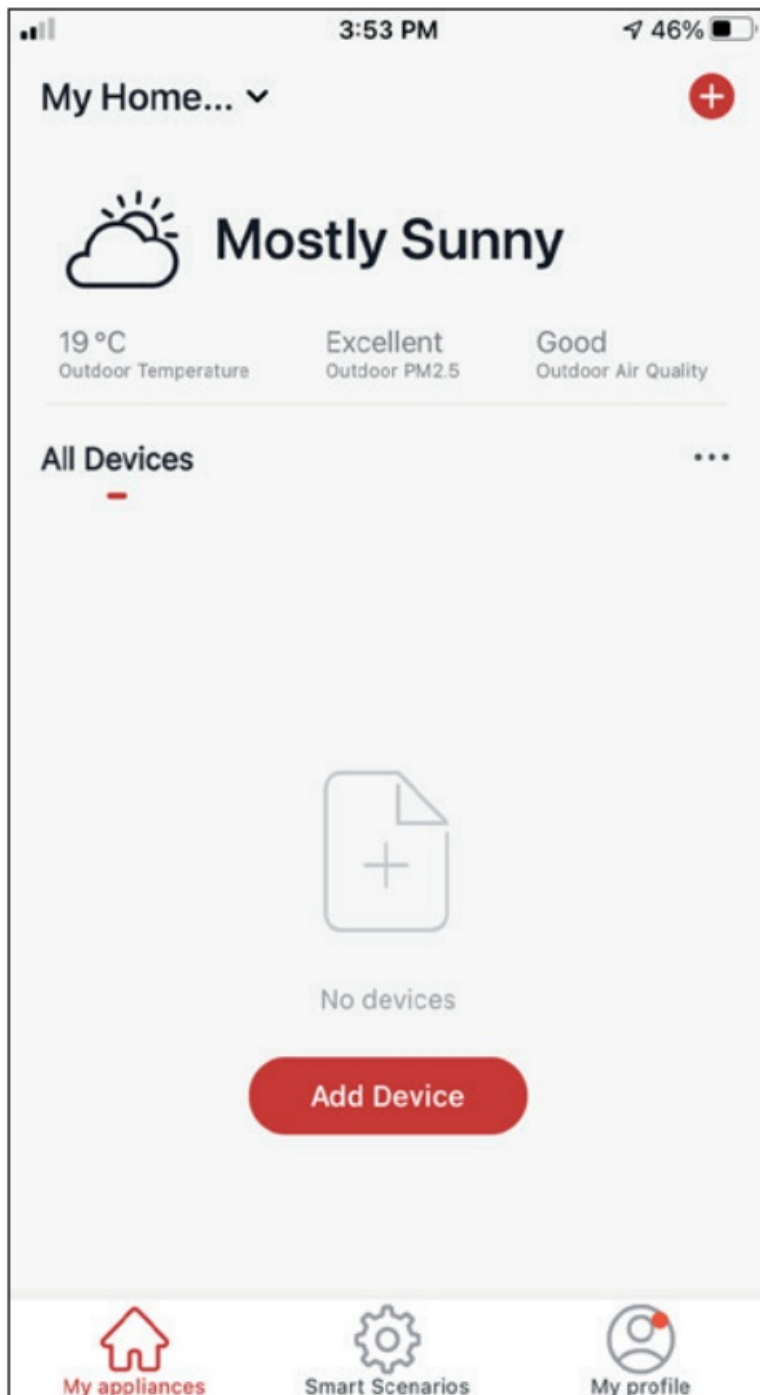

Step 2: Select "Auto Scan" on the top bar and press "Start scanning".

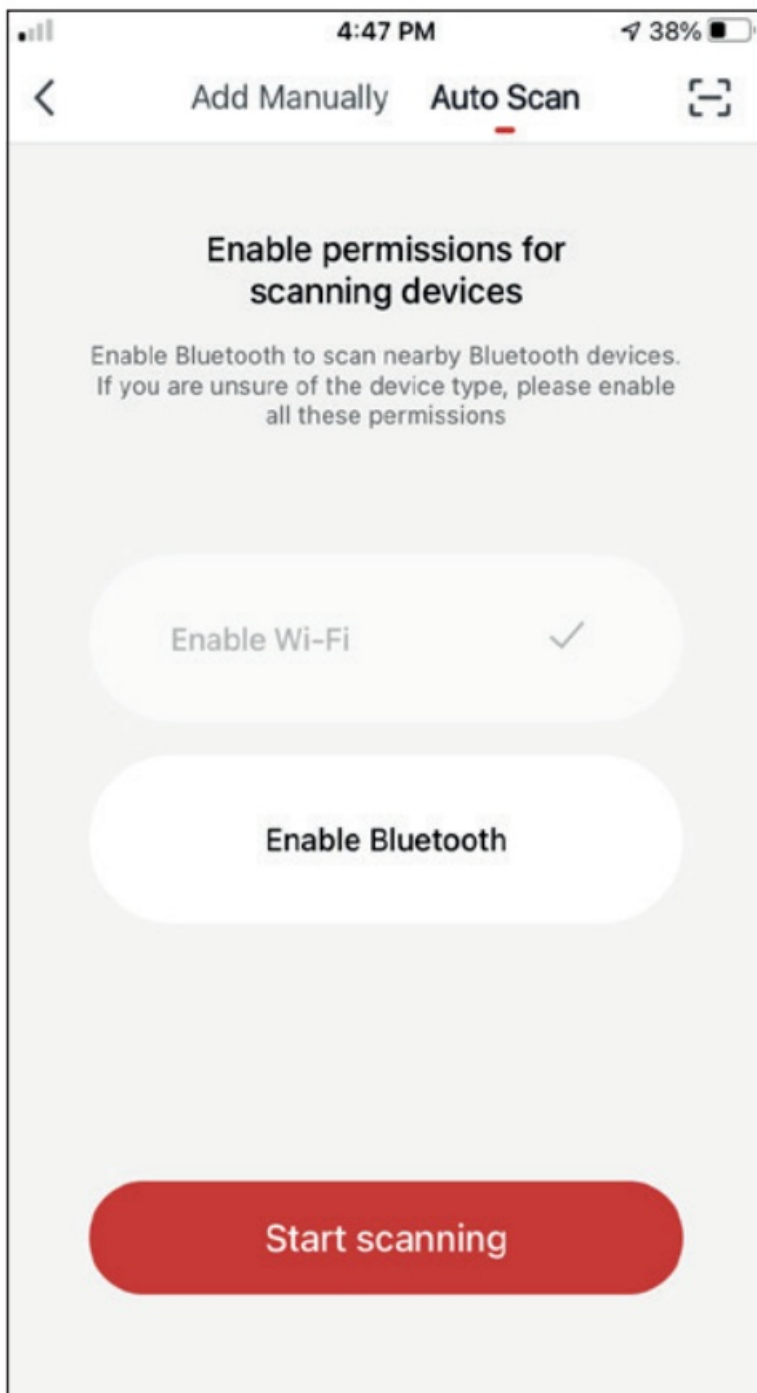

Step 3: Select “Configuring Wi-Fi” to input your Wi-Fi name and password. Select “Mode” on the dehumidifier for 3 seconds to enter the pairing mode and press “Next”.

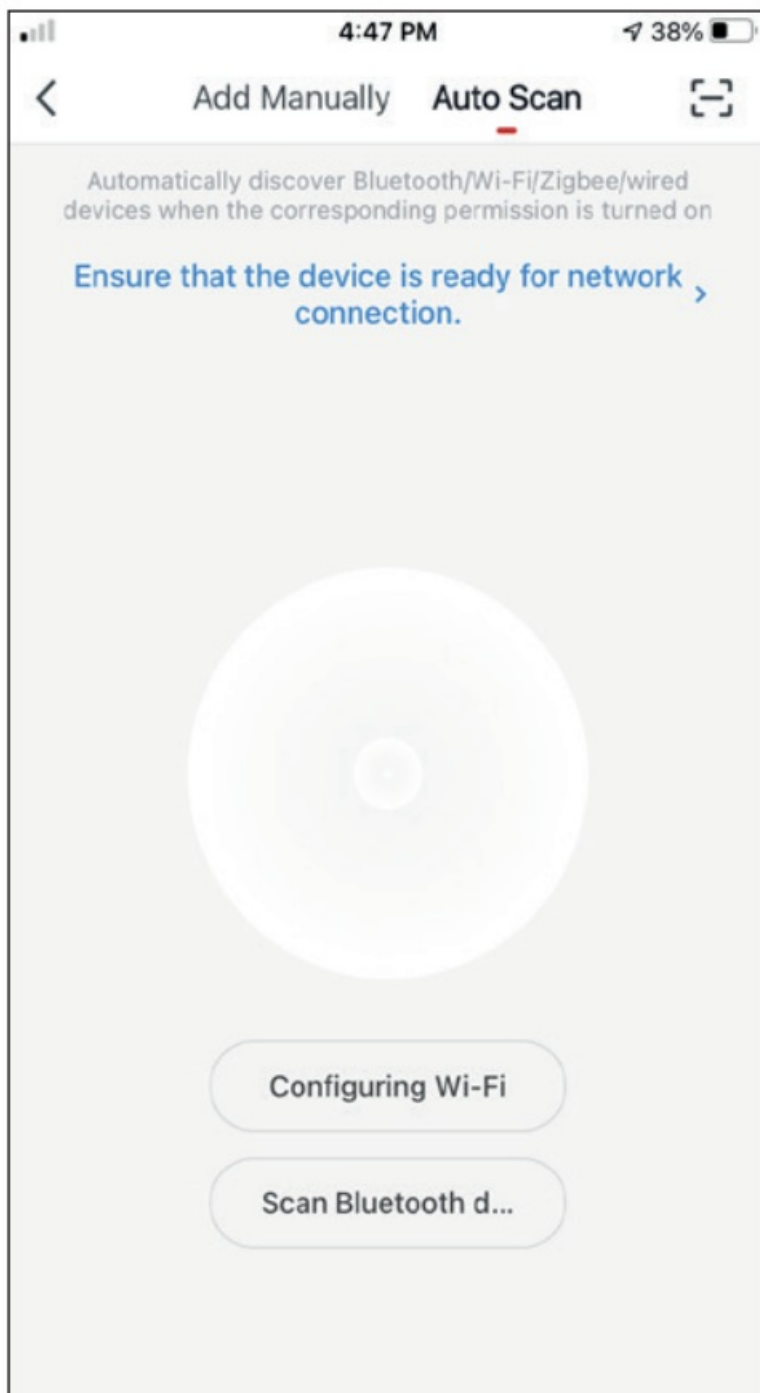

Step 4: When the search is complete, your device will appear on the screen. Press “Next”.

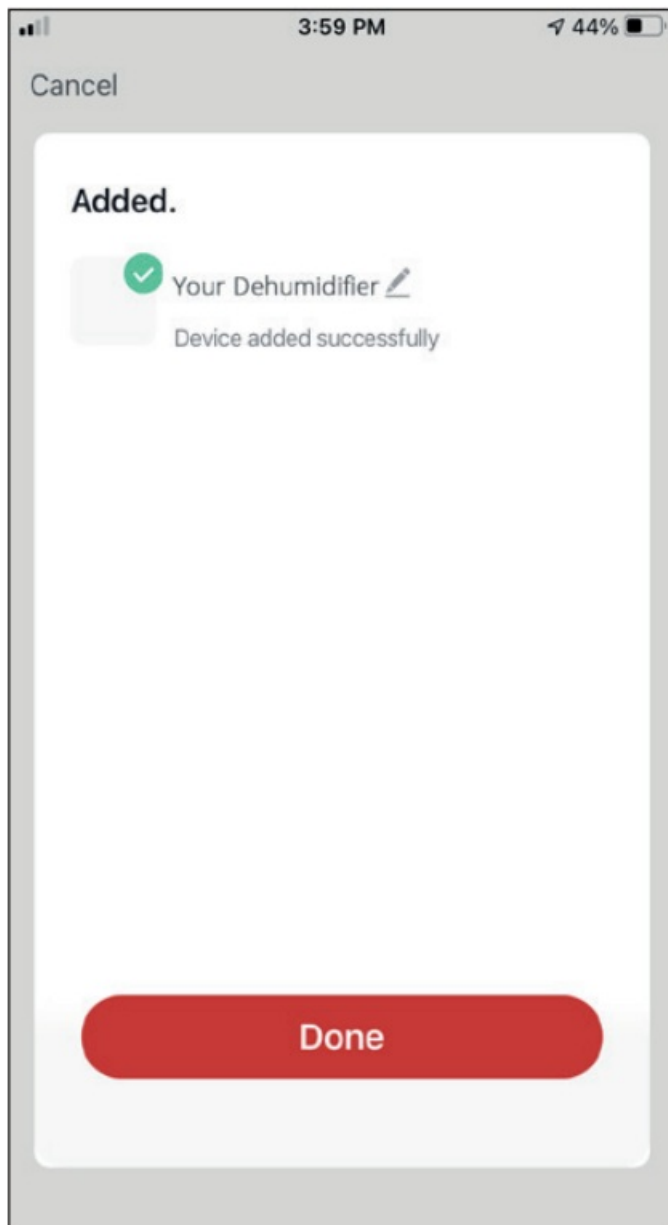

You are all set.

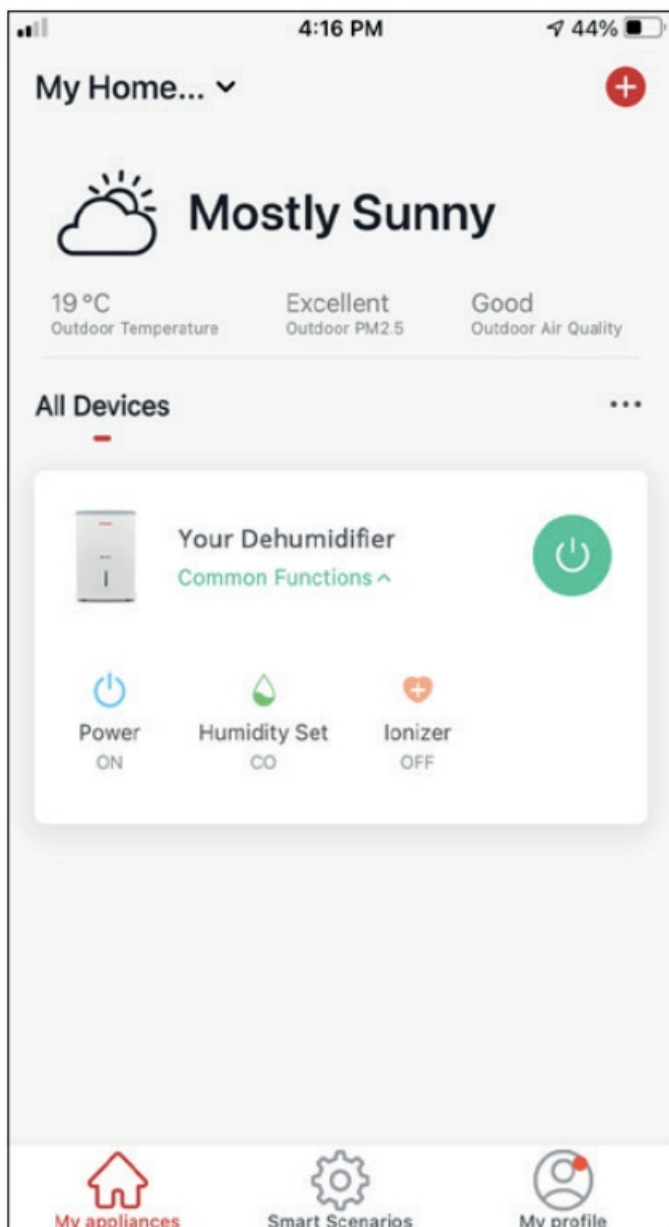

NOTE: Due to different Wi-Fi settings, the Add Automatically might not be able to find your dehumidifier. In this case you can connect using one of the two Manual methods.

Reminder: The process should be completed within 3 minutes. If it is not, please repeat the process.

Wait, there is more!

Explore new possibilities by downloading Inventor Control App and gain access to a wide range of exciting and unique features. Smart scenarios, weekly scheduling, central control of your devices and many more operations become part of your smart device. Learn more by downloading the Wi-Fi Manual for your model by following the link below or scanning the QR code on the side: <https://www.inventorappliances.com/manuals?item=dehumidifiers>



All the pictures in the manual are for explanatory purposes only. The actual shape of the unit you purchased may be slightly different, but the operations and functions are the same.

The company may not be held responsible for any misprinted information. The design and the specifications of the product for reasons, such as product improvement, are subject to change without any prior notice. Please consult with the manufacturer at +30 211 300 3300 or with the Sales agency for further details. Any future updates to the manual will be uploaded to the service website, and it is advised to always check for the latest version.

Scan here to download the latest version of this manual. www.inventorappliances.com/manuals



Customer Support

Manufacturer: INVENTOR A.G. S.A.
24th km National Road Athens – Lamia & 2 Thoukididou Str., Ag.Stefanos, 14565

The image shows the cover of a user manual for the Inventor WiFi Function Dehumidifier. The top section features the 'inventor' logo in a dark blue circle, followed by the text 'DEHUMIDIFIER' and 'WiFi FUNCTION - QUICK START GUIDE' in a dark blue box. Below this, a list of contents is provided: '• USER'S MANUAL', '• ΕΓΧΕΙΡΙΔΙΟ ΧΡΗΣΗΣ', '• MANUALE UTILITY CONTROLUI', '• BEDIENUNGSANLEITUNG', '• MANUEL D'UTILISATION', '• MANUALE DELL'UTENTE', and '• MANUAL DE USUARIO'. The central part of the cover has the title 'inventor WiFi Function Dehumidifier [pdf] User Manual' in a large, bold, blue font, with 'WiFi Function Dehumidifier, WiFi Function, Dehumidifier' in a smaller black font below it. The bottom left corner features a Wi-Fi symbol, the text 'Wi-Fi', and 'From Web Control - Via Gateway - Control - Via Cloud To Mobile Phone'. The bottom right corner contains a small information icon and the text 'ENGLISH | FRANÇAIS | ESPAÑOL | DEUTSCH | PORTUGAL | ITALIANO | JAPONAIS'.

- [!\[\]\(3ed193150ebea7ccd4ff6ad1634a6c3b_img.jpg\) Κλιματιστικά Inverter WiFi, Ψυγεία, Αφυγραντήρες, Air Conditioners - Inventor](#)
- [!\[\]\(cf3a44bc738ffddb92f98f791902787c_img.jpg\) Biblioteca media - Inventor](#)
- [!\[\]\(2ce7cc6ad6a3d77d190fa99405ce0b50_img.jpg\) Αρχεία και Υποστήριξη - Inventor](#)
- [!\[\]\(46545a24d73eb974fd796f84183285e7_img.jpg\) Wifi installation guide - Inventor](#)
- [!\[\]\(988c677bfb919f358f9ebb1968a19e67_img.jpg\) Bedienungsanleitungen - Inventor appliances](#)
- [!\[\]\(037280c63209da9d9cece9141c98b3b0_img.jpg\) Manuels de produits - Inventor appliances](#)
- [!\[\]\(5df37091a43934d850d37536f715fb47_img.jpg\) Inventor Appliances User Manuals - Inventor appliances](#)
- [!\[\]\(a0fbb89594a96584c66a9bda76625119_img.jpg\) Biblioteca media - Inventor](#)
- [!\[\]\(5df03de62810aac40adbc61463eb6761_img.jpg\) Αρχεία και Υποστήριξη - Inventor](#)
- [!\[\]\(aa4d96372c1b869fa3de5beb0cab6a36_img.jpg\) Wifi installation guide - Inventor](#)
- [!\[\]\(ef42600e804eac85201fe3ed074e927b_img.jpg\) Bedienungsanleitungen - Inventor appliances](#)
- [!\[\]\(c8848fa77cc46681029511f56dea3802_img.jpg\) Manuales de productos - Inventor appliances](#)
- [!\[\]\(43f2054b55d1bce732733ee05a4b4109_img.jpg\) Manuels de produits - Inventor appliances](#)
- [!\[\]\(fb3f13e3316b32c97d922f0d9a56ad90_img.jpg\) Manuali dei prodotti - Inventor appliances](#)
- [!\[\]\(850354467bc7625aae8b5eafc6cad5f1_img.jpg\) Inventor Appliances User Manuals - Inventor appliances](#)