



Contents [[hide](#)]

- [1 VERI-09WFI Air Conditioning System Remote Controller](#)
- [2 Specifications](#)
- [3 Quick Start Guide](#)
- [4 Handling the Remote Controller](#)
- [5 Buttons and Functions](#)
- [6 Remote Screen Indicators](#)
- [7 FAQs](#)
- [8 Documents / Resources](#)
 - [8.1 References](#)



VERI-09WFI Air Conditioning System Remote Controller



Specifications

- **Models:**

- VERI-09WFI / VERO-09
- VERI-12WFI / VERO-12
- VERI-18WFI / VERO-18
- VERI-24WFI / VERO-24

- **Remote Controller Specifications**

- **Model:** RG081A3(2S)/BGEF, RG081A3(2S)/BGEFL
- **Rated Voltage:** 1.5V
- **Signal Receiving Range:** 8m
- **Environment:** -5°C~60°C (23°F~140°F)

Quick Start Guide

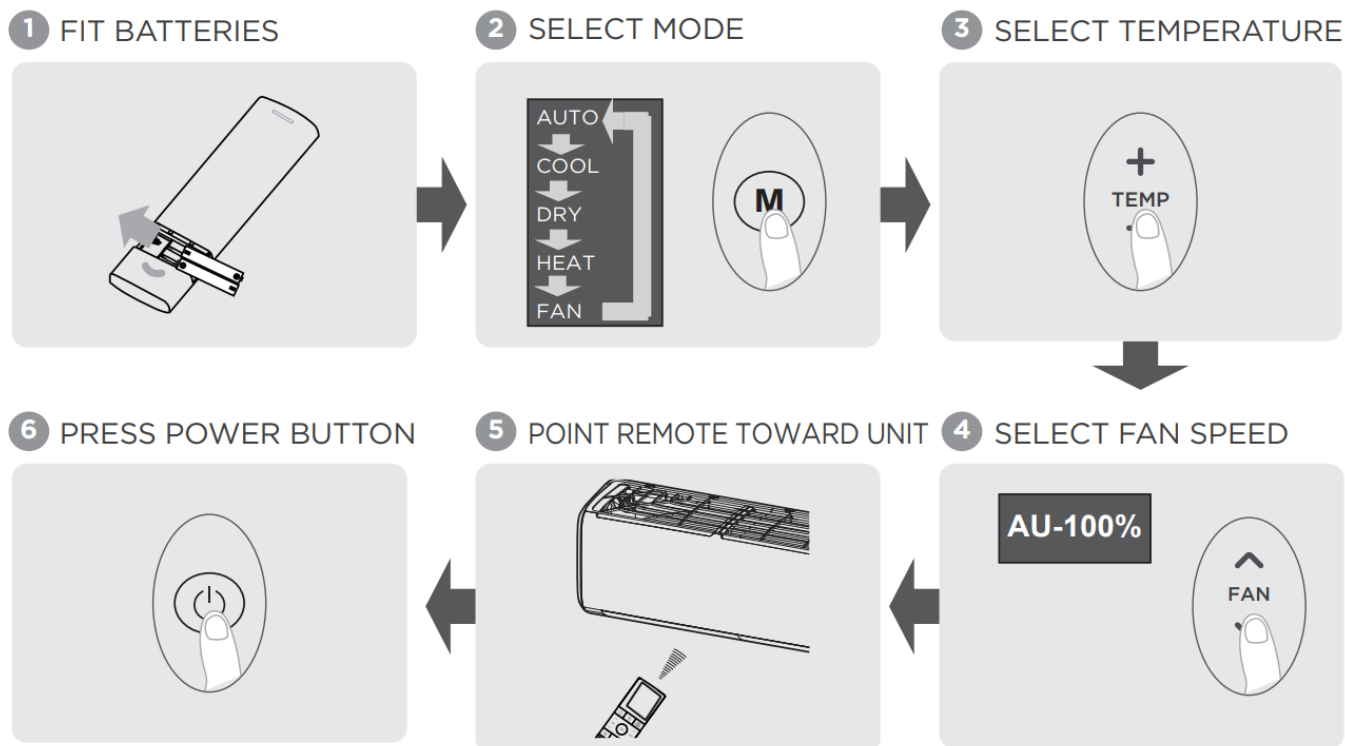

NOT SURE WHAT A FUNCTION DOES?

Refer to the How to Use Basic Functions and How to Use Advanced Functions sections of this manual for a detailed description of how to use your air conditioner.

SPECIAL NOTE

- Button designs on your unit may differ slightly from the example shown. If the indoor unit does not have a particular function, pressing the corresponding button on the remote control will have no effect. When there are wide differences between “Remote controller Manual” and “USER’S MANUAL” on function description, the description of “USER’S MANUAL” shall prevail.

Handling the Remote Controller

Inserting and Replacing Batteries

Your air conditioning unit may come with two batteries(some units). Put the batteries in the remote control before use.

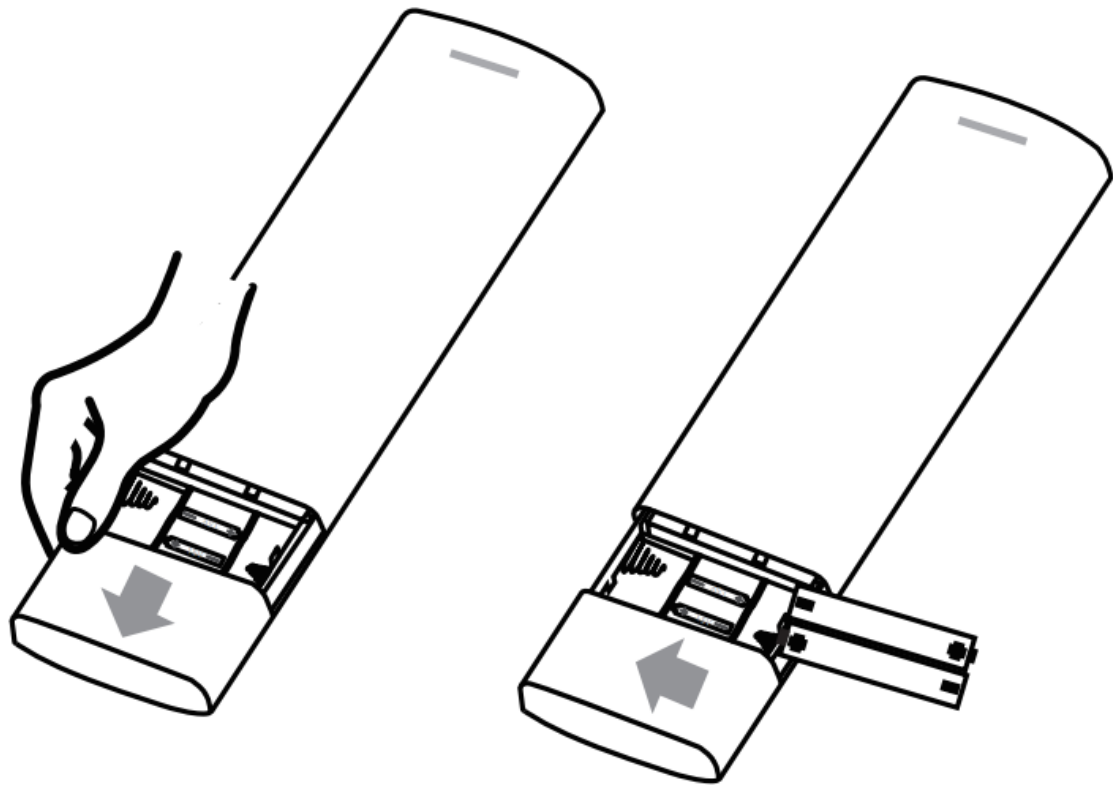

1. Slide the back cover of the remote control downward, exposing the battery compartment.
2. Insert the batteries, paying attention to matching up the (+) and (-) ends of the batteries with the symbols inside the battery compartment.
3. Slide the battery cover back into place.

Remote Control

- Direct sunlight can interfere with the infrared signal receiver.
- There must be a clear line of sight between the remote and the appliance.
- If the signals from the remote control happen to control another appliance, move the appliance to another location, or contact customer service.

Battery Disposal

- Do not dispose of batteries as unsorted municipal waste. Refer to local laws for proper disposal of batteries.
- Batteries may have a chemical symbol under the disposal icon. This chemical symbol means that the battery contains a heavy metal that exceeds a certain concentration. An example is Pb: Lead (>0.004%).

- Appliances and used batteries must be treated in a specialized facility for reuse, recycling, and recovery. By ensuring correct disposal, you will help avoid possible negative consequences for the environment and human health.

Battery Performance

For optimal product performance:

- Do not mix old and new batteries, or batteries from different brands.
- Do not leave batteries in the remote control if you don't plan on using the device for more than 2 months.

Notes for Using Remote Control

The device could comply with the local national regulations.

- In Canada, it should comply with CAN ICES-3(B)/NMB-3(B).
- In the USA, this device complies with part 15 of the FCC Rules. Operation is subject to the following two conditions:
 1. This device may not cause harmful interference, and
 2. This device must accept any interference received, including interference that may cause undesired operation.

This equipment has been tested and found to comply with the limits for a Class B digital device, pursuant to part 15 of the FCC Rules. These limits are designed to provide reasonable protection against harmful interference in a residential installation. This equipment generates, uses, and can radiate radio frequency energy and, if not installed and used according to the instructions, may cause harmful interference to radio communications. However, there is no guarantee that interference will not occur in a particular installation. If this equipment does cause harmful interference to radio or television reception, which can be determined by turning the equipment on and on, the user is encouraged to try to correct the interference by one or more of the following measures:

- Reorient or relocate the receiving antenna.

- Increase the separation between the equipment and receiver.
- Connect the equipment to an outlet on a circuit different from that to which the receiver is connected.
- Consult the dealer or an experienced radio/TV technician for help.
- Changes or modifications not approved by the party responsible for compliance could void the user’s authority to operate the equipment.

Buttons and Functions

Before you begin using your new air conditioner, make sure to familiarize yourself with the remote controller. The following content is a brief introduction to the remote controller. For instructions on how to operate your air conditioner, refer to this manual of How to Use Basic Functions section.

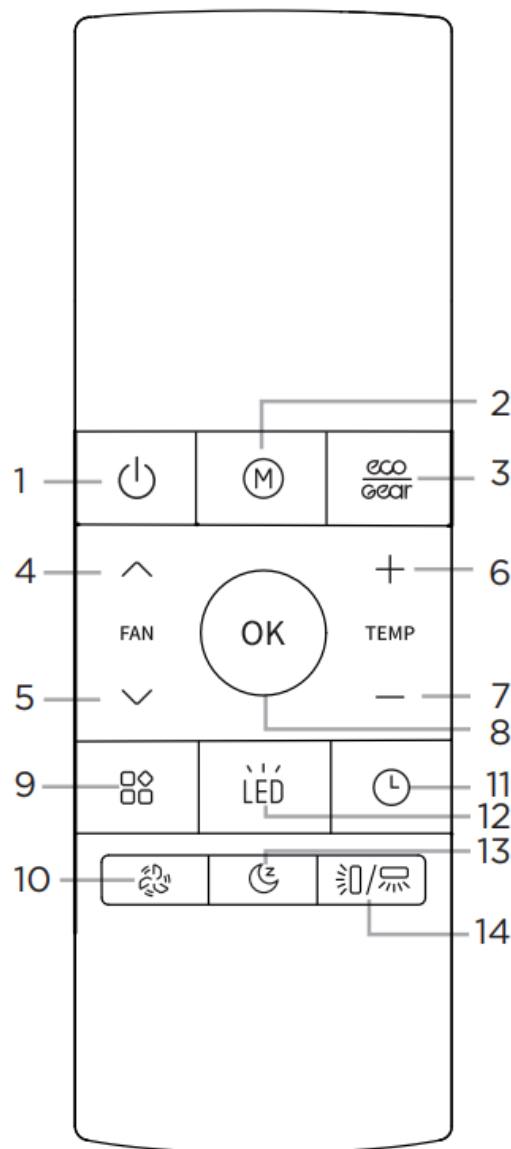

1	ON/OFF: Turn the unit on or off.
---	----------------------------------

2	Mode: Auto > Cool > Dry > Heat> Fan
3	eco/Gear: Starts and stops the energy-efficient mode.
4	FANSpeed :AU>20%>40%>60%>80%>100%. Press the TEMP or button to increase/ decrease the fanspeed in 1% increments.
5	FANSpeed :AU>100%>80%>60%>40%>20%. Press the TEMP or button to increase/ decrease the fanspeed in 1% increments.
6	TEMPUp: Increases temperature in 1°C (1°F) increments. Max. temperature is 30°C (86°F). NOTE: Press & buttons at the same time for 3 seconds will alternate the temperature display between the °C & °F
7	TEMPDown : Decreases temperature in 1°C (1°F) increments. Min. temperature is 16°C (60°F).
8	OK: Used to confirm the selected functions
9	SET: Fresh/UV lamp>Breeze Away>Follow Me>Active Clean>AP mode Note: Every time you press the button, the function will switch to the next one. When the desired function is displayed, you can press the OK button to confirm, or wait for 5 seconds for the function to start automatically.
10	Turbo: Reduce (cool mode) or raise (heat mode) temperature in a short time.

11	Timer: Settimertoturnunitonoroff.
12	LED: TurnsLEDdisplay&airconditionerbuzzer on and off.
13	Sleep: Used to create a more comfortable sleeping environment.
14	Swing: Starts and stops the vertical louver movement.

Remote Screen Indicators

Information is displayed when the remote controller is powered up.

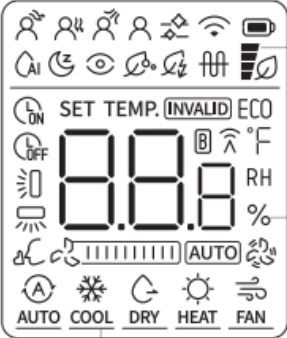

The remote controller screen features a digital display with three segments. Above the display are icons for 'ON', 'OFF', and 'SET TEMP.'. To the right of the display is an 'INVALID' indicator and an 'ECO' mode icon. Below the display are icons for 'RH' (Relative Humidity) and 'FAN' speed. At the bottom, there are five mode buttons: 'AUTO', 'COOL', 'DRY', 'HEAT', and 'FAN'.

Breeze away people
Not available for this unit.

Follow me
Active clean

Wireless control
Low battery (If flashes)

Not available for this unit
Sleep mode
Not available for this unit

Fresh
Gear mode
Not available for this unit

Temperature/Timer/Fan speed display
Displays the set temperature by default, fan speed, or Timer setting when using Timer on/off functions.

FAN SPEED
AUTO

1-10%	11-20%	21-30%	31-40%	41-50%
51-60%	61-70%	71-80%	81-90%	91-100%

Note: The fan speed can not be adjusted in AUTO or DRY mode.

Transmission Indicator
ECO feature
Silent feature
Turbo feature
Not available for this unit.
Displayed when the operation is invalid.

Timer ON
Timer OFF
Vertical louver swing
Not available for this unit.

MODE display : Displays the current mode

AUTO
COOL
DRY
HEAT
FAN

Note: While using the remote controller, only the relevant function indicator will be shown. The indicators above are for reference only.

How to Use Basic Functions

NOTE: Before operation, please ensure that the unit is plugged in and the power is available.

AUTO mode

Select AUTO mode

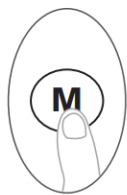

Set your desired temperature

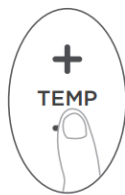

Turn on the air conditioner



Note:

1. In AUTO mode, the unit will automatically select the COOL, FAN, or HEAT function based on the selected temperature.
2. In AUTO mode, fan speed cannot be set.

COOL or HEAT mode

Select COOL/HEAT mode



Set the temperature

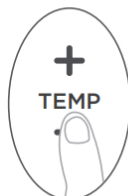

Set the FAN speed



Turn on the air conditioner



DRY mode

Select DRY mode



Set your desired temperature

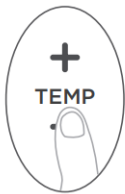

Turn on the air conditioner



Note: In DRY mode, fan speed cannot be set since it has already been automatically controlled.

FAN mode

Select FAN mode

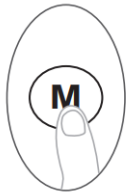

Set the FAN speed



Turn on the air conditioner



Note: In FAN mode, you can't set the temperature. As a result, no temperature is displayed on the remote's screen.

Setting the TIMER

TIMER ON/OFF – Set the amount of time after which the unit will automatically turn on/off.

TIMER ON setting

Press the TIMER button to initiate the time ON sequence.



Press the TEMP “+” or “–” or FAN “or” button multiple times to set the desired time to turn on the unit. Press the OK button to activate the time to turn on the unit.

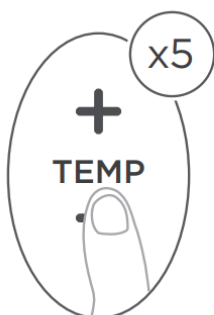

or

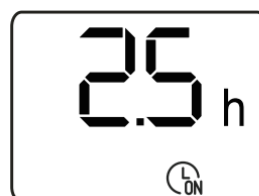

TIMER OFF setting

Press the TIMER button to initiate the time OFF sequence.

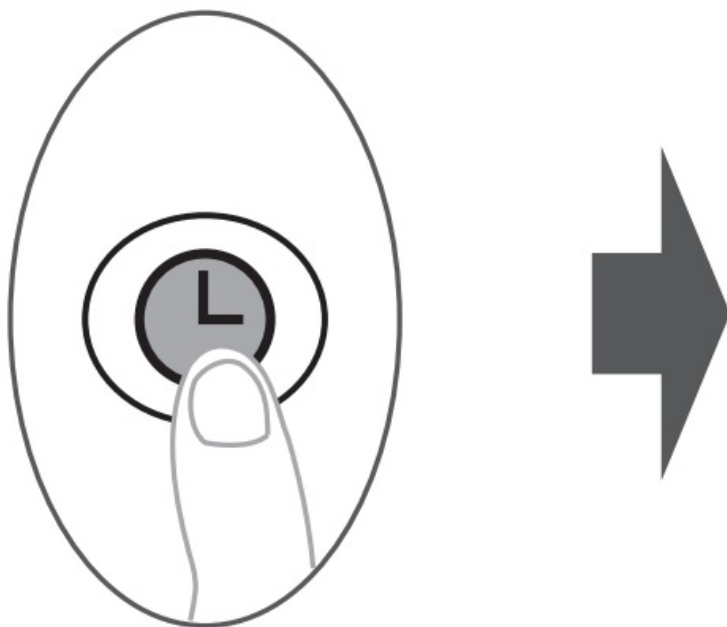

Press the TEMP “+” or “–” or FAN “or” button multiple times to set the desired time to turn off. The unit. Press the OK button to activate the time to turn off. The unit.

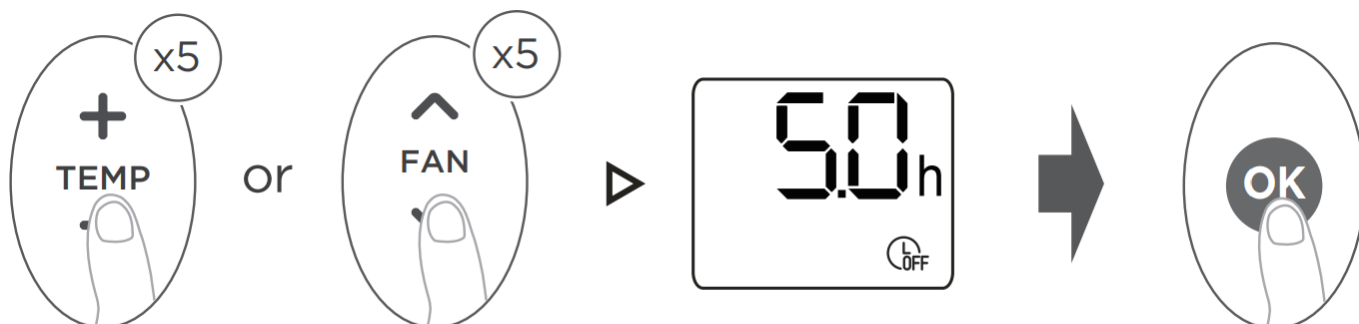

Note:

1. When setting the TIMER ON or TIMER OFF, the time will increase in 30-minute increments with each press, up to 10 hours. After 10 hours and up to 24:00, it will increase in 1-hour increments (For example, press 5 times to get 2.5h and press 10 times to get 5h). The timer will revert to 0:00 after 24:00.
2. Cancel either function by setting the timer to 0:00h.

TIMER ON & OFF setting (example)

Keep in mind that the periods you set for both functions refer to hours after the current

time.

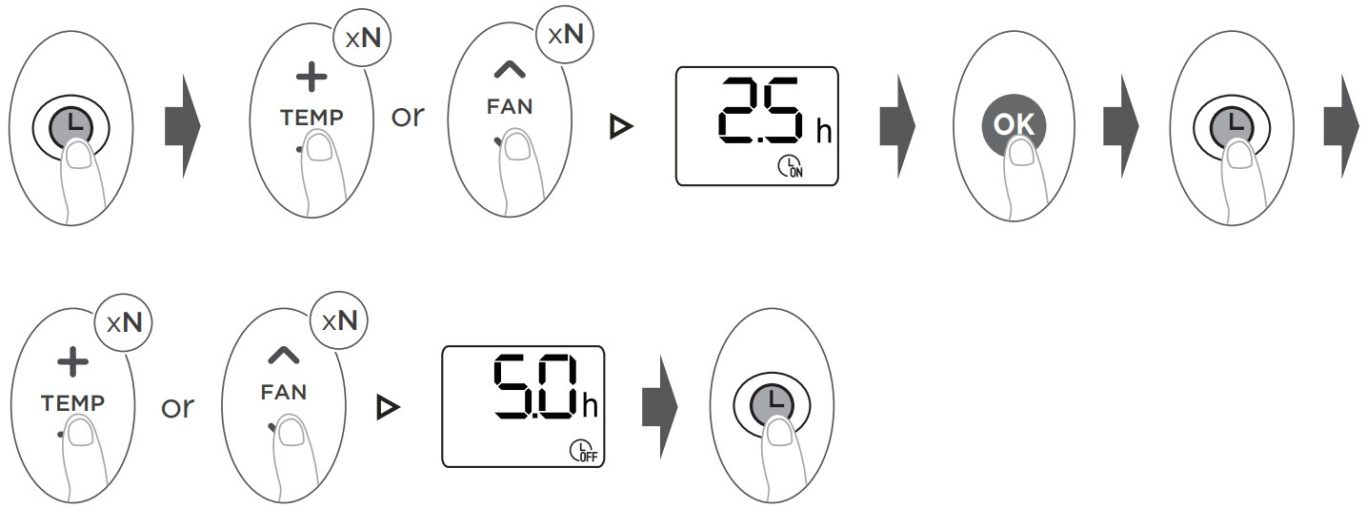

Note: “ x N ” means you can press multiple times until it is set to the time you need.

Example: If the current time is 1:00 PM, after setting the timer as above steps, the unit will turn on 2.5h later (3:30 PM) and turn off at 6:00 PM.

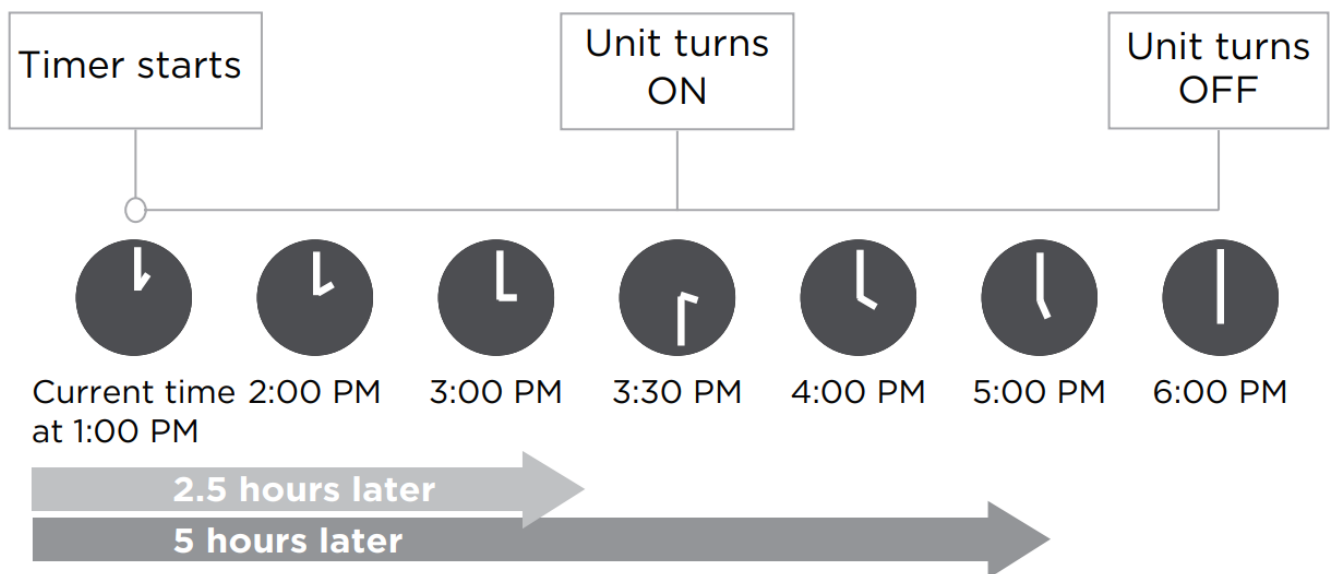

How to Use Advanced Functions

Swing function

Swing up and down

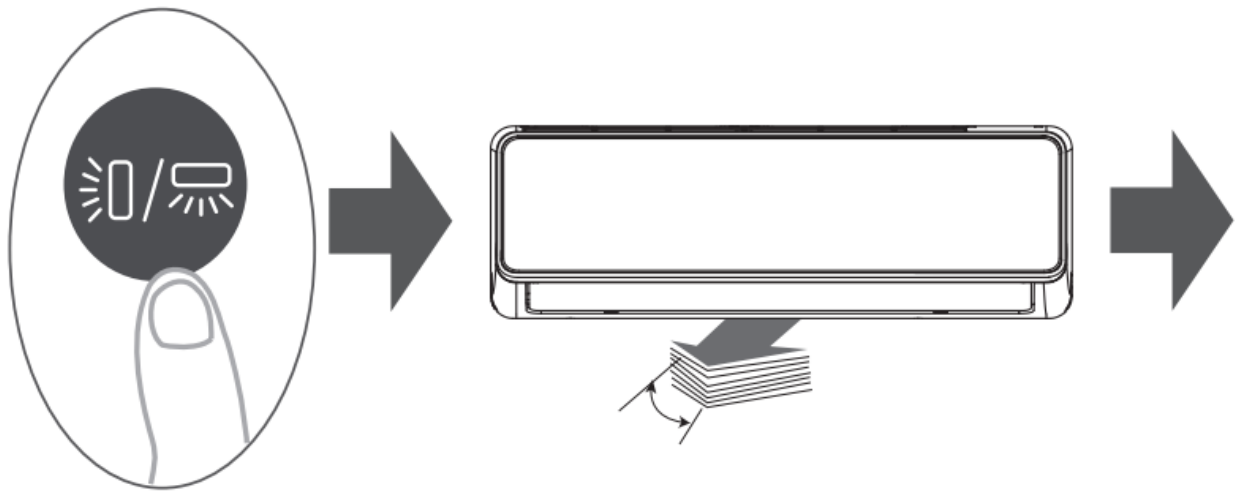

Press this button repeatedly, and if the interval between presses is within 3 seconds, the vertical louver will operate in the following order: Louver auto swing stop > Louver auto swing start > Louver angle 1 > Louver angle 2 > Louver angle 3 > Louver angle 4 > Louver angle 5. Press this button repeatedly, and if the interval between presses is more than 3 seconds, the vertical louver will operate in the following order: Louver at a certain angle > Louver auto swing start > Louver auto swing stop.

SLEEP function

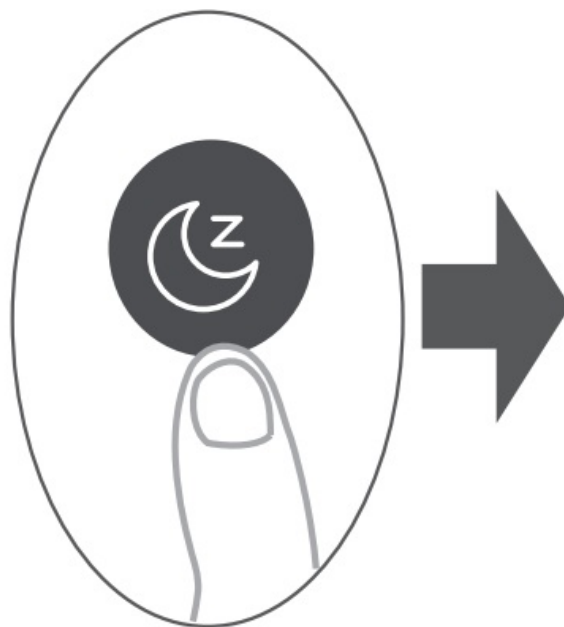

NOTE: The SLEEP function is not available in FAN and DRY mode

The SLEEP function is used to create a more comfortable sleeping environment. The fan speed can be adjusted in Cool/Heat mode. In Auto mode, the fan speed is fixed. Press the SLEEP button on the remote control when in COOL mode, the unit will increase the temperature by 1°C (2°F) after 1 hour, and will increase an additional 1°C (2°F) after

another hour. When in HEAT mode, the unit will decrease the temperature by 1°C (2°F) after 1 hour, and will decrease an additional 1°C (2°F) after another hour. Two hours later, the temperature will no longer change, and the sleep function will end automatically after eight hours.

Silent function

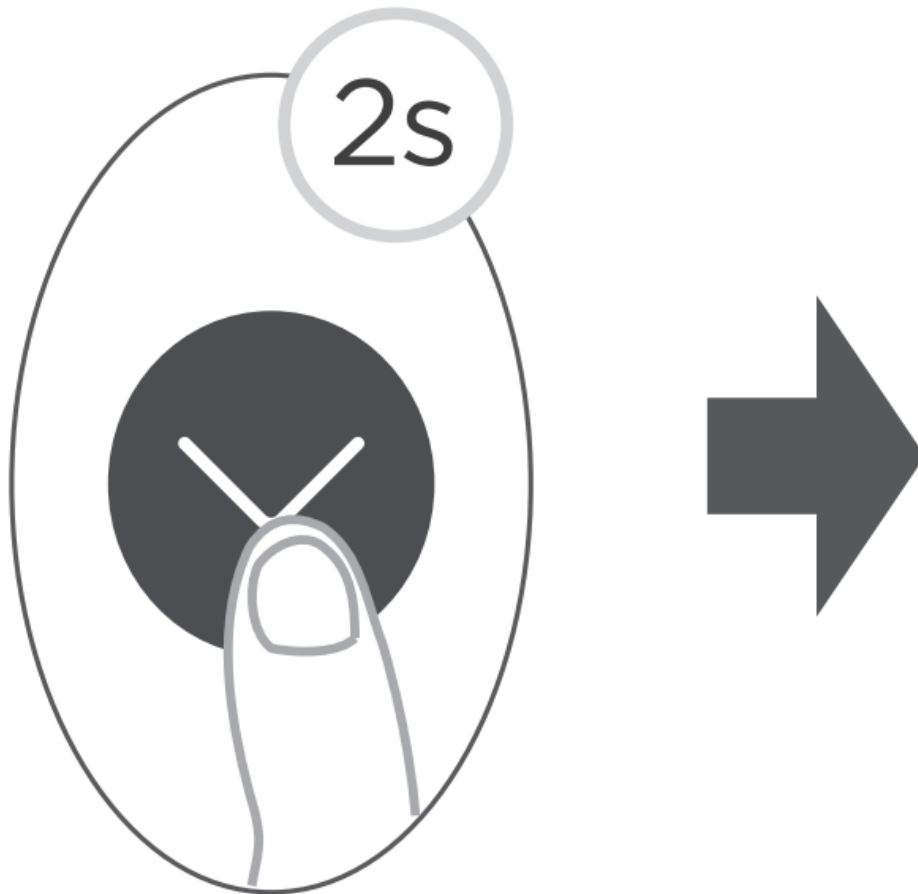

Keep pressing the Fan button for more than 2 seconds to activate/disable the Silent function. Due to the low frequency operation of the compressor, it may result in insufficient cooling and heating capacity.

FP function

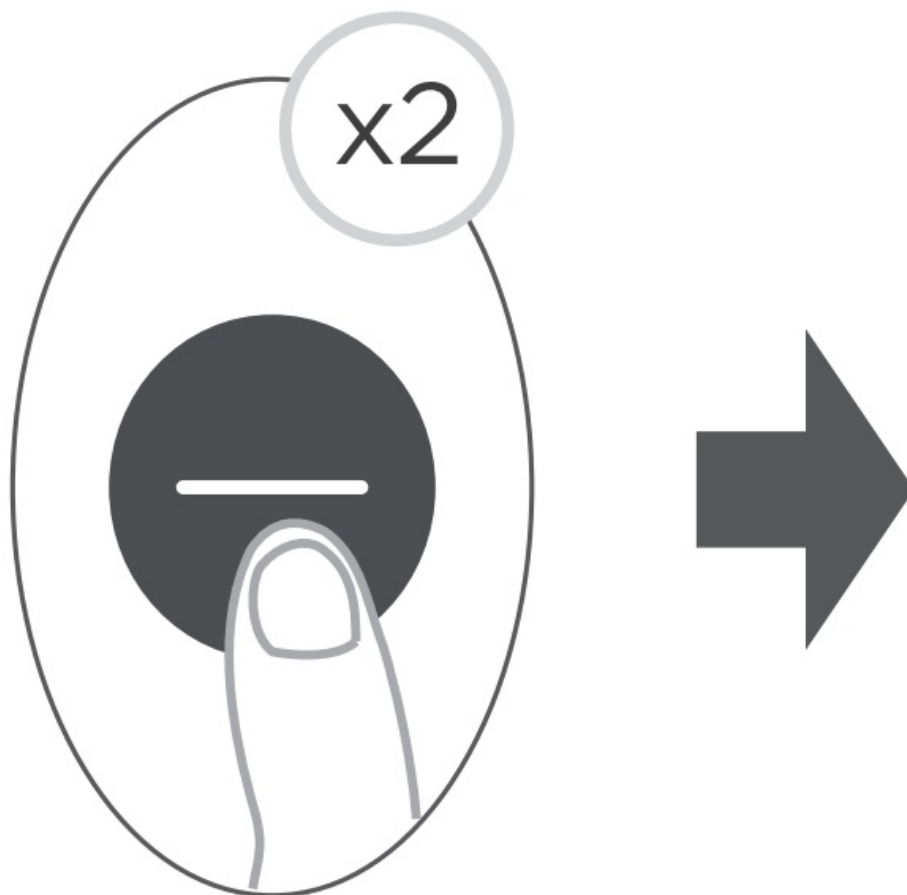

Press this button 2 times during one second under HEAT mode and set the temperature of 16°C/60°F to activate the FP function. The unit will operate at high fan speed (while the compressor is on) with the temperature automatically set to 8°C/46°F. Pressing On/O%, Mode, Fan, and Temp. The Button, while operating, will cancel this function.

LED display

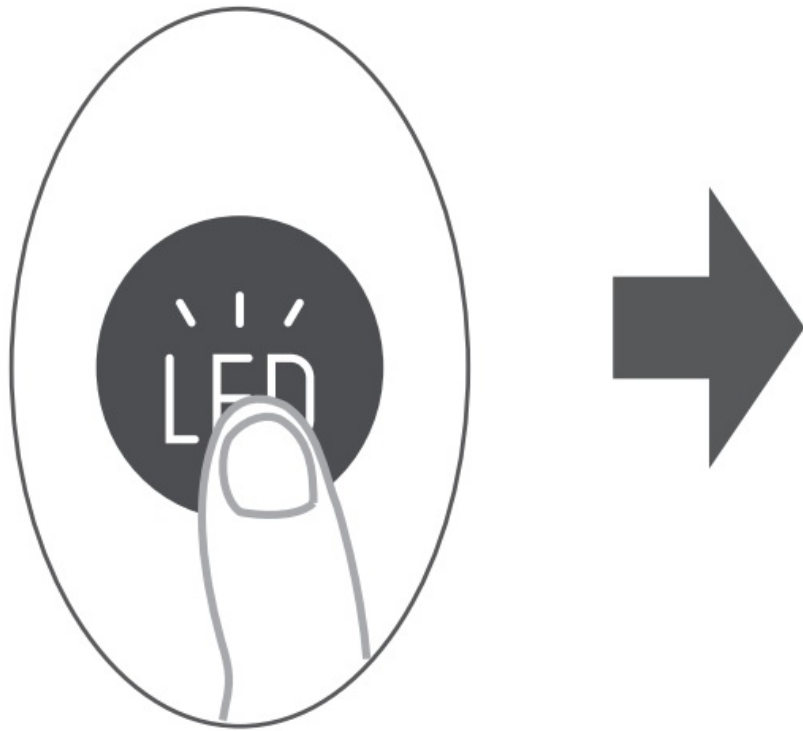

Press this button to turn on and turn off the display on the indoor unit.

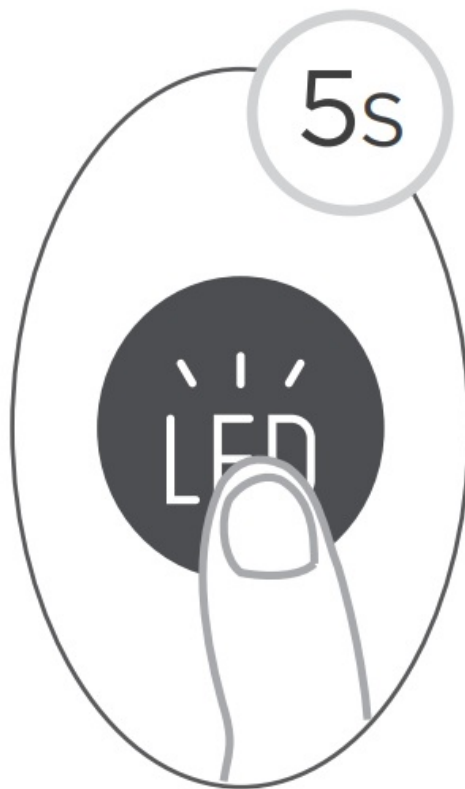

Press this button for more than 5 seconds (some units). After pressing this button for more than 5 seconds, the indoor unit will display the actual room temperature. Pressing more than 5 seconds again will revert to displaying the setting temperature.

Eco/Gear function

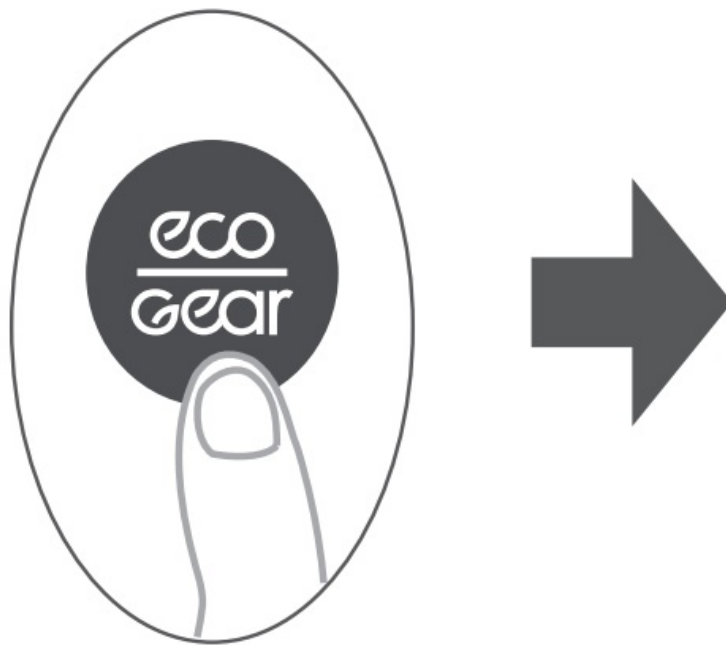

Press this button to enter the energy efficient mode in a sequence of the following: ECO GEAR (75%), GEAR (50%), ECO....

Note: This function is only available under COOL mode.

ECO operation

Under cooling mode, press this button, the remote controller will adjust the temperature automatically to 24°C/75°F, fan speed of Auto to save energy (only when the set temperature is less than 24°C/75°F). If the set temperature is above 24°C/75°F, press the ECO button; the fan speed will change to Auto, and the set temperature will remain unchanged.

NOTE: Pressing the ECO/GEAR button, or modifying the mode, or adjusting the set temperature to less than 24°C/75°F will stop ECO operation. Under ECO operation, the set temperature should be 24°C/75°F or above; it may result in insufficient cooling. If you feel uncomfortable, just press the ECO button again to stop it.

GEAR operation

Press the ECO/GEAR button to enter the GEAR operation as follows: 75% (up to 75% electrical energy consumption) 50% (up to 50% electrical energy consumption), Previous setting mode. Under GEAR operation, the setting temperature will revert to the display screen after 3 seconds if you select the desired electrical energy consumption operation.

Turbo function

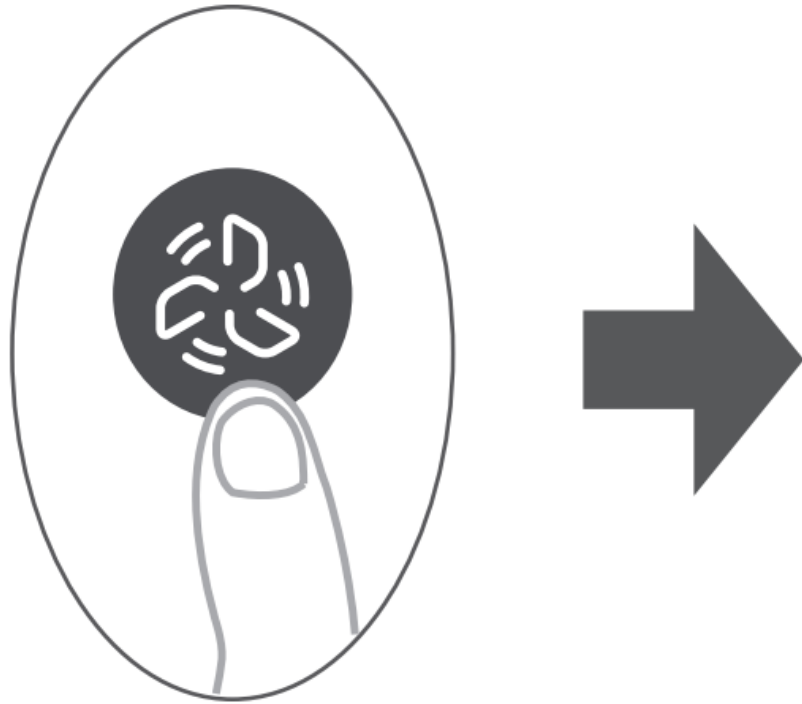





When you select the Turbo feature in COOL mode, the unit will blow cool air with the strongest wind setting to jump-start the cooling process. When you select the Turbo feature in HEAT mode, the unit will blow hot air with the strongest wind setting to jump-start the heating process.

SET function



- Press the SET button to enter the function setting, then press the SET button to select the desired function. The selected symbol will flash on the display area. Press the OK button to confirm.
- To cancel the selected function, just perform the same procedures as above.

- Press the SET button to scroll through operation functions as follows: Fresh/UV lamp () > Breeze away () > Follow Me () > Active clean () > AP mode ()

Fresh/UV lamp function

When this function is initiated, the Ionizer or UVC lamp (model dependent) feature will be activated. If it has both features, these two features will be activated at the same time and will help to purify the air in the room.

Breeze Away function

Use this feature to avoid direct air flow blowing on the body and make you feel indulged in silky coolness.

NOTE: This feature is available under Cool, Fan, and Dry mode only.

Follow Me function

The FOLLOW ME function enables the remote control to measure the temperature at its current location and send this signal to the air conditioner in 3-minute intervals. When using AUTO, COL, or HEAT modes, measuring ambient temperature from the remote control (instead of from the indoor unit itself) will enable the air conditioner to optimize the temperature around you and ensure maximum comfort.

NOTE: Press and hold the Turbo button for 7 seconds to start/stop the memory feature of the Follow Me function.

- If the memory feature is activated, “On” displays for 3 seconds on the screen.
- If the memory feature is stopped, “OF” displays for 3 seconds on the screen.
- While the memory feature is activated, pressing the ON/OFF button, shifting the mode, or a power failure will not cancel the Follow Me function.

Active Clean function

The Active Clean technology removes dust and mold that may cause odours. The Active Clean function rapidly freezes and thaws the heat exchanger to clean away material that has adhered to it.

When this function is turned on, the indoor unit displays “CL”. After 20 to 130 minutes (model dependent), the unit will turn off automatically and terminate the CLEAN function.

AP function

Name

Email

Website

☐ Save my name, email, and website in this browser for the next time I comment.

Post Comment

Search:

e.g. whirlpool wrf535swhz

Search

Manuals+ | Upload | Deep Search | Privacy Policy | @manuals.plus | YouTube

This website is an independent publication and is neither affiliated with nor endorsed by any of the trademark owners. The "Bluetooth®" word mark and logos are registered trademarks owned by Bluetooth SIG, Inc. The "Wi-Fi®" word mark and logos are registered trademarks owned by the Wi-Fi Alliance. Any use of these marks on this website does not imply any affiliation with or endorsement.