



**Contents** [ [hide](#) ]

[1 Inventor FN40-INV Floor Fan](#)

[2 Product Usage Instructions](#)

[3 RULES FOR SAFE OPERATION](#)

[4 INSTALLATION INSTRUCTIONS](#)

[5 INSTRUCTIONS FOR USE](#)

[6 MAINTENANCE INSTRUCTION](#)

[7 FAQ](#)

[8 Documents / Resources](#)

[8.1 References](#)



## **Inventor FN40-INV Floor Fan**



## **Product Usage Instructions**

- Follow the installation instructions provided in the user manual to set up the product correctly.
- Use the designated power button to turn the fan on or off as needed.
- Use the speed control settings to adjust the fan flow rate based on your preference.
- Regularly clean the fan blades and ensure proper ventilation to maintain optimal performance.

## **CAUTION**

For safe operation, please read and follow the instructions below carefully.

## **WARNING**

1. If the supply cord is damaged, it must be replaced by the manufacturer or its service agent, or a similarly qualified person in order to avoid a hazard.
2. Domestic use only.
3. To avoid the risk of electrical shock, do not immerse the unit, cord, or plug in water or any other liquids.

4. This appliance is not intended for use by persons (including children) with reduced physical, sensory, or mental capabilities, or lack of experience and knowledge, unless they have been given supervision or instruction concerning use of the appliance by a person responsible for their safety.

Minors should be supervised at all times to avoid the mistreatment of the unit and/or possible injury.

5. When the appliance is not operating, and, prior to cleaning, please unplug it from the power socket.
6. When assembling the fan, make sure that the protective fan grill covers are properly installed.



7. Do not dispose of this product as unsorted municipal waste. This appliance requires special treatment for disposal. It is prohibited to dispose of this appliance in domestic household waste. To prevent possible harm to the environment or human health from uncontrolled waste disposal, recycle it responsibly to promote the sustainable reuse of material resources.

To return your used device, contact the retailer; it is possible they may dispose of it at a recycling facility.

## **RULES FOR SAFE OPERATION**

1. While the fan is operating, no sharp objects, such as pencils, should be inserted through the protective grill. Be extra cautious when handling and be certain no fingers penetrate beyond the protective grill area; this should be strictly avoided at all times.
2. Be certain that the fan is disconnected when repositioning from one location to another.
3. Be certain that the fan is on sturdy grounds while operating, to avoid accidental tipping.
4. Be extra cautious when operating near a window, as rain may cause an electric shock.
5. This device is intended for domestic use only.

## **INSTALLATION INSTRUCTIONS**

### **Name of Components**

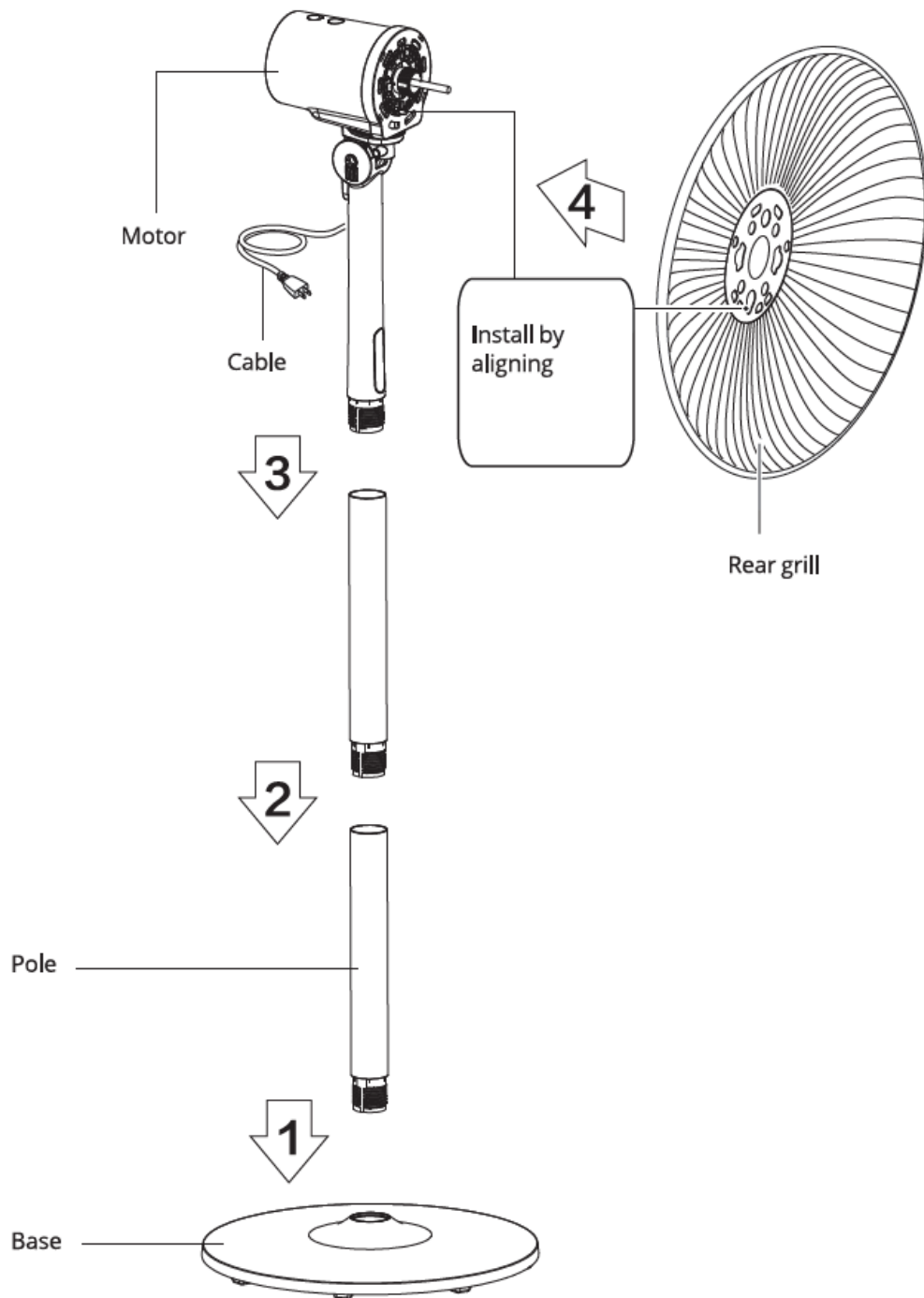

### Useful Tip

- Prior to installation, remove the fan leaf lock nut and the mesh hood lock nut from the fuselage.

### Installation

- Install by rotating (screwing) the pole to the base.

### Front and back protective Fan Grill Installation

Align the front with the back protective fan grill, then secure as shown in the figure.

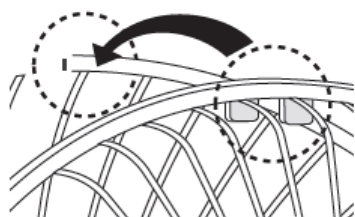

Firmly hold on both (front & back) Protective Fan Grills together

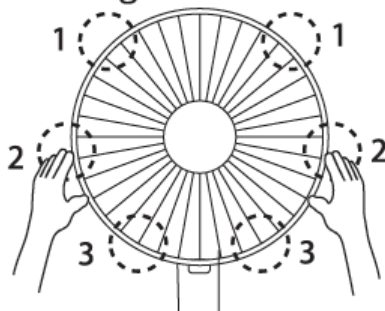

Screw

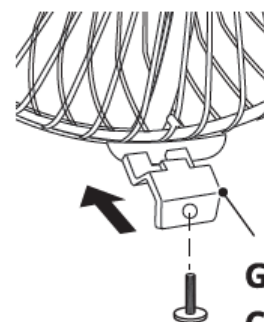

**Guard Catch**

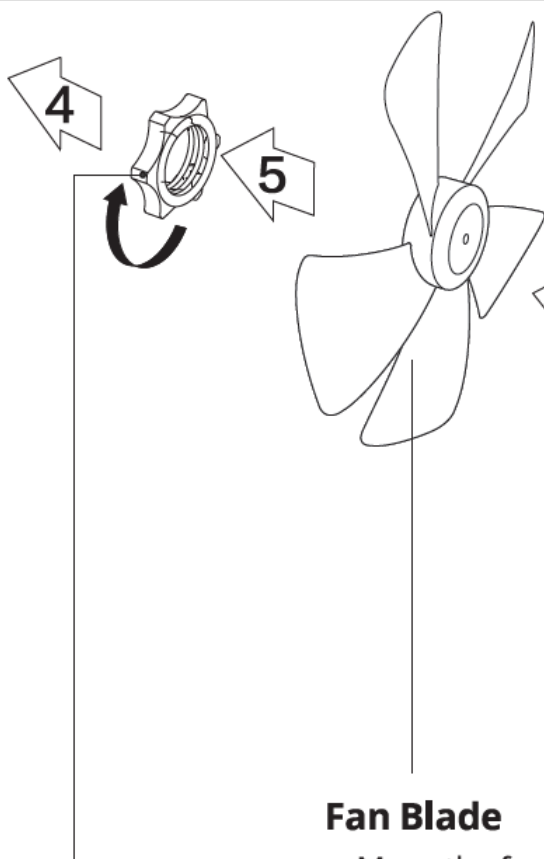

### Locknut of Protective Grill

- Screw the locknut clockwise, and then install the front cover of the fan.

### Fan Blade

- Move the fan blade and rotate after installation, to ensure that it rotates smoothly.

### Casing Screw Nut

- Screw the cover nut counterclockwise and then install the fan's front protective grill.



**Front grill**

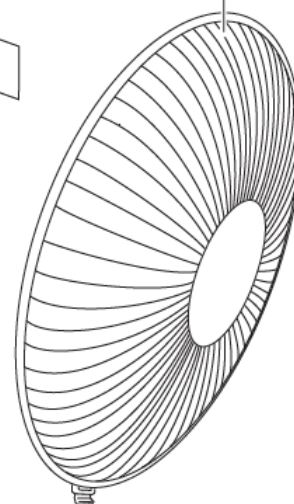

## INSTRUCTIONS FOR USE

### Remote control functions

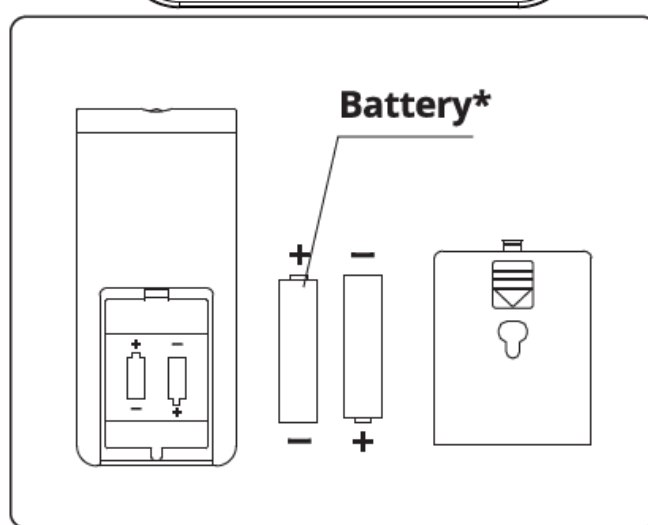
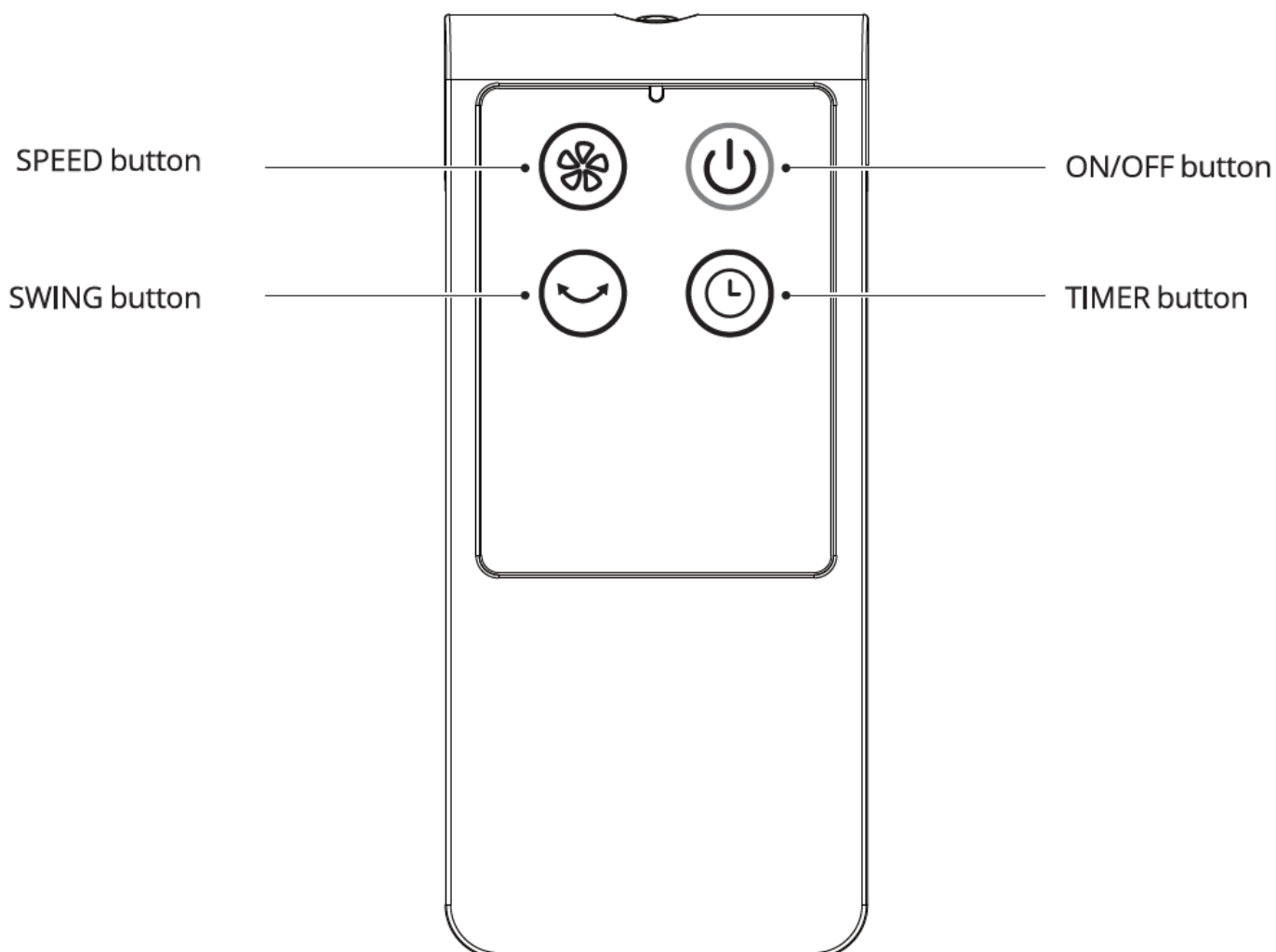

\*Batteries are not included

### Useful Tip

- The remote control operates best when it is within a range of 5 meters from the fan, and with an angle of no more than 30°.

### Instructions for main unit

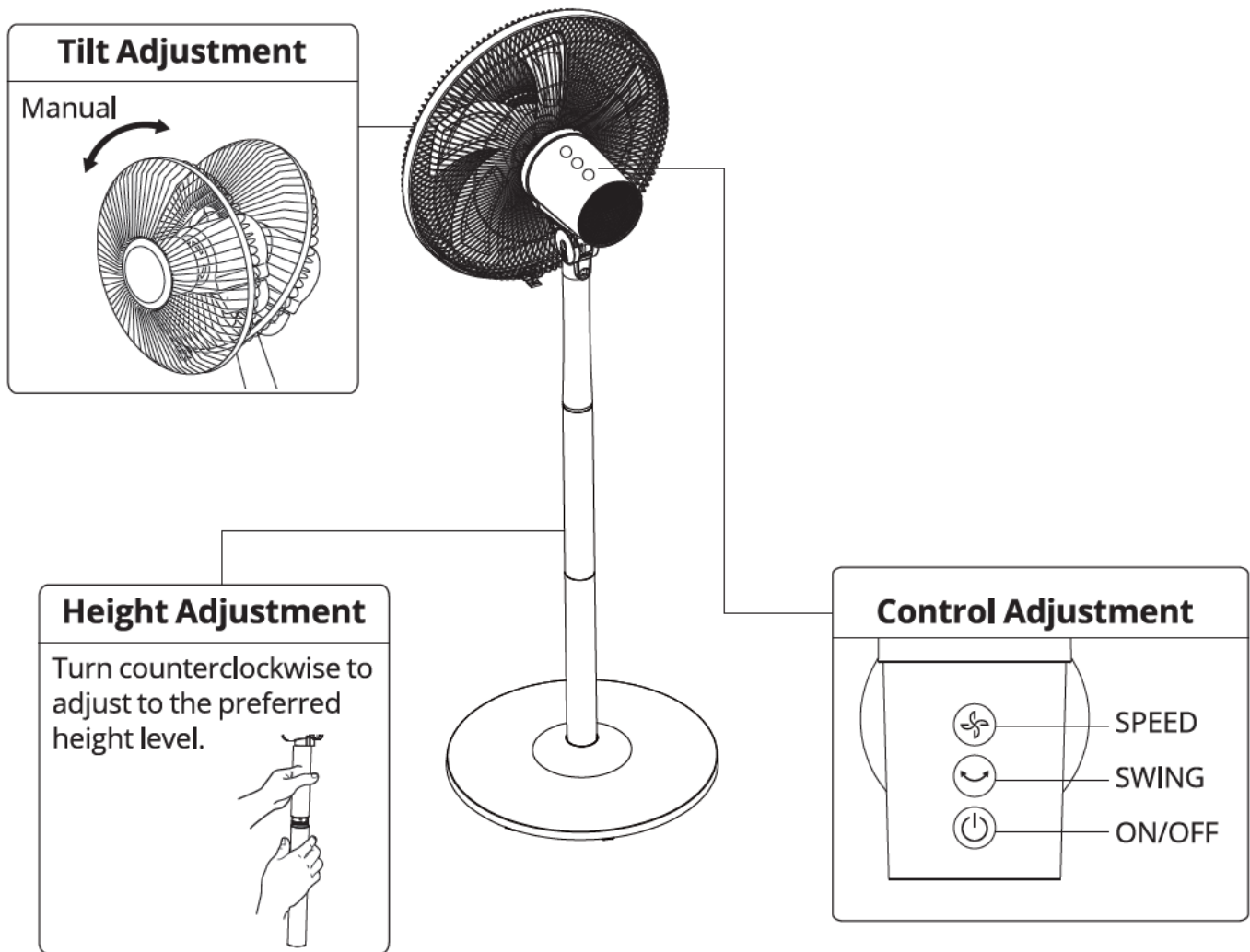

### Air Speed Button

- Press for a short period of time to adjust the air speed, prolonged period (two seconds) to set the timer.

## MAINTENANCE INSTRUCTION

This fan requires limited maintenance. Do not attempt to fix it on your own. Always refer to qualified personnel if any service is required.

1. Prior to cleaning and assembling, the fan must be unplugged.
2. To ensure adequate air circulation, vents should be free of dust at all times. Do not disassemble the fan in order to remove the dust.
3. The exterior parts of the device may be wiped with a soft and damp, with a mild detergent, cloth.
4. The use of any abrasive detergents or solvents should be avoided, as this may result in scratching the surface. The use of gasoline or paint thinner for cleaning purposes

should be avoided.

5. Water or any other liquids in the motor housing or interior parts of the device must be avoided at all times.

## CLEANING

1. Prior to performing any cleaning, the device must be unplugged.
2. All plastic parts of the device should be cleaned with a soft, moist cloth and with mild soap.

Thoroughly clean any soap excess with a dry cloth.

Description	Symbol	Value	Unit
Maximum fan flow rate	F	57.8	m <sup>3</sup> /min
Fan power input	P	41.6	W
Service value	SV	1.39	(m <sup>3</sup> /min)/ W
Standby/off power consumption	PSB	0.20	W
Seasonal electricity consumption	$Q \sim (P \cdot 320 + PSB \cdot 1120) / 1000$	15.6	kWh/a
Fan sound power level	LWA	59	dB(A)
Maximum air velocity	c	3.4	meters/s ec
Measurement standard for service value	EN 60879:2019		



Contact details for obtaining more information	<p>Inventor A.G. A.E. 24th National Road Athens – Lamia &amp; 1 Thoukididou Str., Ag.Stefanos, 14 565</p> <p>Tel.: +30 211 300 3300, Fax: +30 211 300 333 3 – 3333 MADE in P.R.C.</p>
--	---

- All the pictures in the manual are for explanatory purposes only. The actual shape of the unit you purchased may be slightly different, but the operations and functions are the same.
- The company may not be held responsible for any misprinted information. The design and the specifications of the product, for reasons such as product improvement, are subject to change without any prior notice.
- Please consult with the manufacturer at +30 211 300 3300 or with the Sales agency for further details. Any future updates to the manual will be uploaded to the service website, and it is advised to always check for the latest version.

Scan here to download the latest version of this manual.

[www.inventorappliances.com/manuals](http://www.inventorappliances.com/manuals)



## FAQ

- **Q: How do I clean the fan blades?**
  - **A:** To clean the fan blades, first, ensure the fan is unplugged.  
Use a soft, damp cloth to gently wipe down the blades, avoiding any harsh chemicals.
- **Q: Can I use this product in a humid environment?**
  - **A:** It is recommended to avoid using the product in high-humidity areas to prevent damage to the internal components.

# Documents / Resources

	<a href="#">Inventor FN40-INV Floor Fan [pdf]</a> User Manual FN40-INV, FN40-INV Floor Fan, FN40-INV, Floor Fan, Fan
---	---

## References

- [User Manual](#)

fan, Floor Fan, FN40-INV, FN40-INV Floor Fan,  
inventor inventor

## Leave a comment

Your email address will not be published. Required fields are marked \*

Comment \*

Name

Email

Website

☐ Save my name, email, and website in this browser for the next time I comment.

**Post Comment**

## Search:

e.g. whirlpool wrf535swhz

**Search**

[Manuals+](#) | [Upload](#) | [Deep Search](#) | [Privacy Policy](#) | [@manuals.plus](#) | [YouTube](#)

This website is an independent publication and is neither affiliated with nor endorsed by any of the trademark owners. The "Bluetooth®" word mark and logos are registered trademarks owned by Bluetooth SIG, Inc. The "Wi-Fi®" word mark and logos are registered trademarks owned by the Wi-Fi Alliance. Any use of these marks on this website does not imply any affiliation with or endorsement.