



## inventer RG66A/BGEF Remote Controller User Manual

[Home](#) » [inVENTer](#) » inventer RG66A/BGEF Remote Controller User Manual 



**AIR CONDITIONING SYSTEMS  
REMOTE CONTROLLER  
USER'S MANUAL**



**MODELS:  
AR5VI-09WFI/AR5VO-09**

## Contents

- 1 Remote Controller Specifications
- 2 Function Buttons
- 3 Handling The Remote Controller
- 4 Remote LCD Screen Indicators
- 5 How To Use The Basic Functions
  - 5.1 COOL operation
- 6 How To Use The Basic Functions
  - 6.1 FAN operation
- 7 How To Use The Basic Functions
- 8 Setting the TIMER function
  - 8.1 Setting both TIMER ON and TIMER OFF at the same time
- 9 How To Use The Advanced Functions
- 10 How To Use The Advanced Functions
- 11 Documents / Resources
  - 11.1 References
- 12 Related Posts

## Remote Controller Specifications

Model	RG66AIBGEF
Rated Voltage	3.0V(Dry batteries R03/LRO3 x2)
Signal Receiving Range	8m
Environment	-5°C-60°C

### NOTE:

- Buttons design is based on a typical model and might be slightly different from the actual one you purchased, the actual shape shall prevail.
- All the functions described are accomplished by the unit. If the unit has no this feature, there is no corresponding operation that happened when pressing the relative button on the remote controller.
- When there are wide differences between “Remote controller Illustration” and ” USER’S MANUAL” on function description, the description of “USER’S MANUAL” shall prevail.

The design and specifications are subject to change without prior notice for product improvement. Consult with the sales agency or manufacturer for details.

## Function Buttons

Before you begin using your new air conditioner, make sure to familiarize yourself with its remote control. The following is a brief introduction to the remote control itself. For instructions on how to operate your air conditioner, refer to the How to Use The Basic/Advance Functions section of this manual. NOTE: Please do not select HEAT mode if the machine you purchased is cooling only type. Heat mode is not supported by the cooling-only appliance.

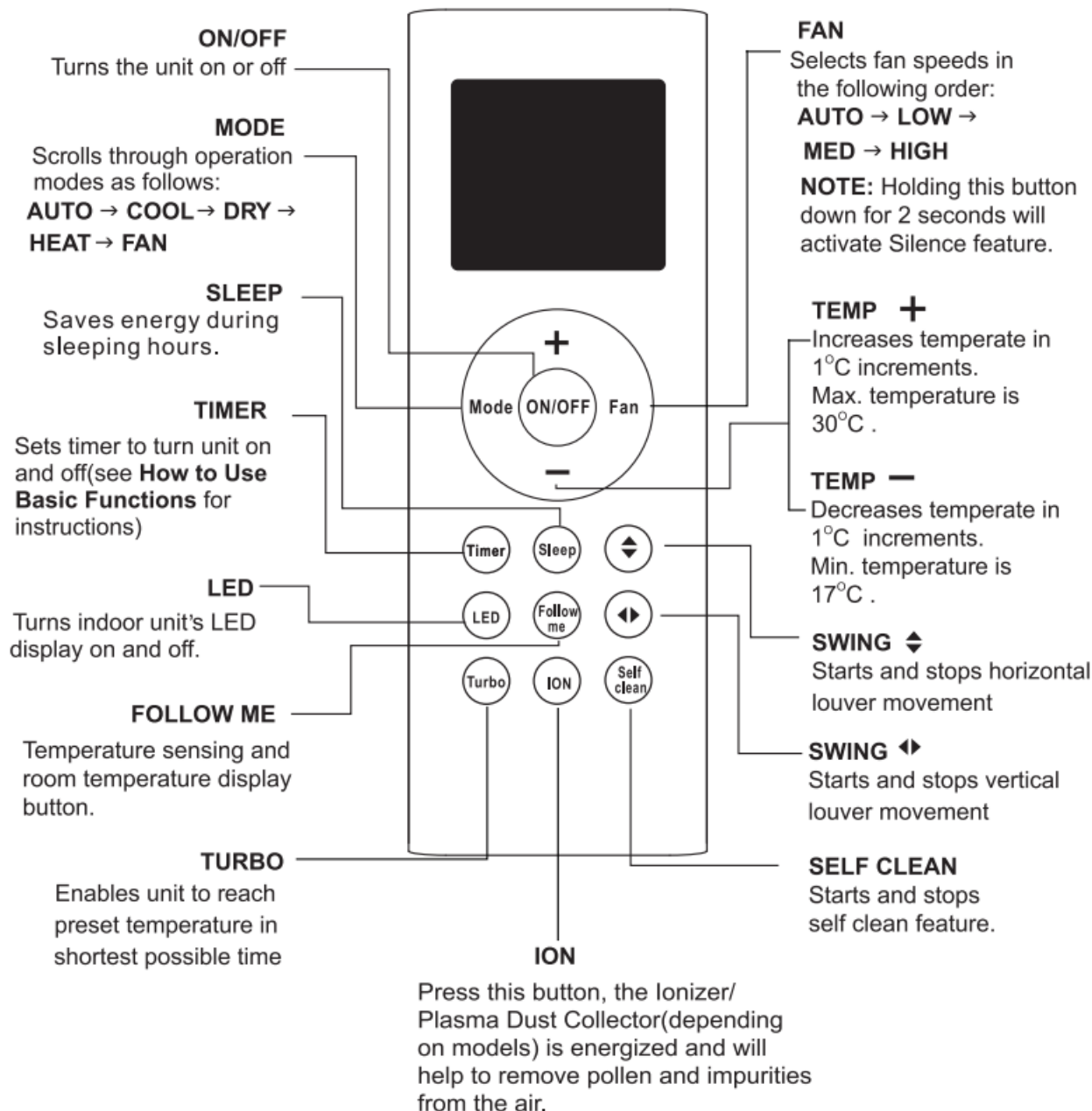

## Handling The Remote Controller

NOT SURE WHAT A FUNCTION DOES? Refer to the How to Use Basic Functions and How to Use Advanced Functions sections of this manual for a detailed description of how to use your air conditioner.

### SPECIAL NOTE

- Button designs on your unit may differ slightly from the example shown.
- If the indoor unit does not have a particular function, pressing that function's button on the remote control will have no effect.

## INSERTING AND REPLACING BATTERIES

Your air conditioning unit comes with two AAA batteries. Put the batteries in the remote control before use:

1. Remove the back cover from the remote control, exposing the battery compartment.
2. Insert the batteries, paying attention to match up the (+) and (-) ends of the batteries with the symbols inside

the battery compartment.

3. Install the back cover on.

### INSTALLING REMOTE CONTROL HOLDER

The remote controller can be attached to a wall or stand by using a remote controller holder (optional part, not supplied with the unit).

1. Before installing the remote controller, check that the air conditioner receives the signals properly.
2. Install the holder with two screws.
3. Put the remote controller in the holder.

### BATTERY NOTES

For optimum product performance:

- Do not mix old and new batteries or batteries of different types.
- Do not leave batteries in the remote control if you don't plan on using the device for more than 2 months.

### BATTERY DISPOSAL

Do not dispose of batteries as unsorted municipal waste. Refer to local laws for proper disposal of batteries.

### TIPS FOR USING REMOTE CONTROL

- The remote control must be used within 8 meters of the unit.
- The unit will beep when a remote signal is received.
- Curtains, other materials and direct sunlight can interfere with the infrared signal receiver.
- Remove batteries if the remote control will not be used for more than 2 months.

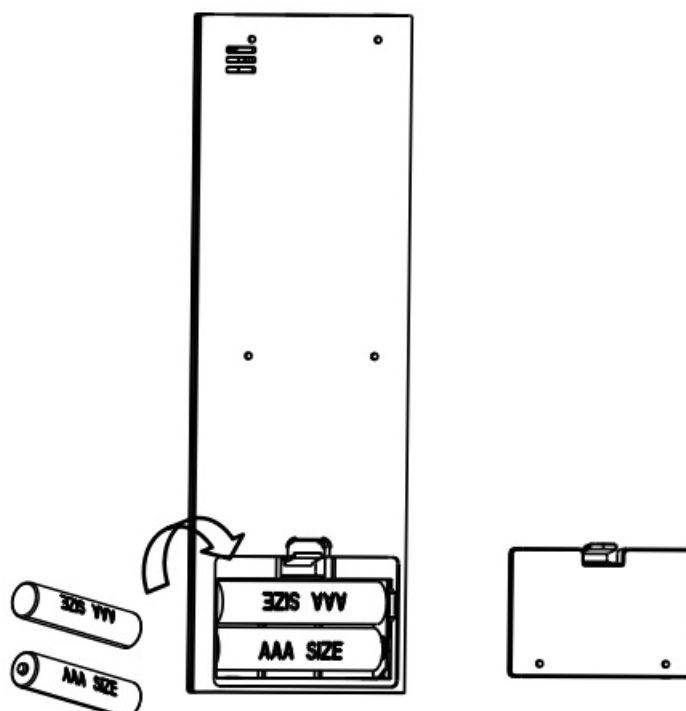

Remove the back cover to install batteries

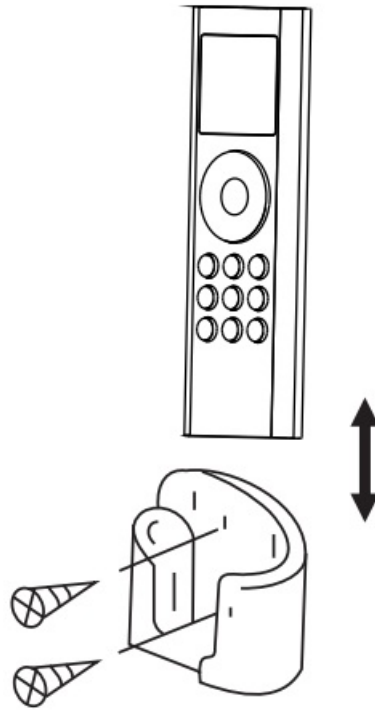

Put the remote controller in the holder.

### **Remote LCD Screen Indicators**

Information are displayed when the remote controller is powered up.

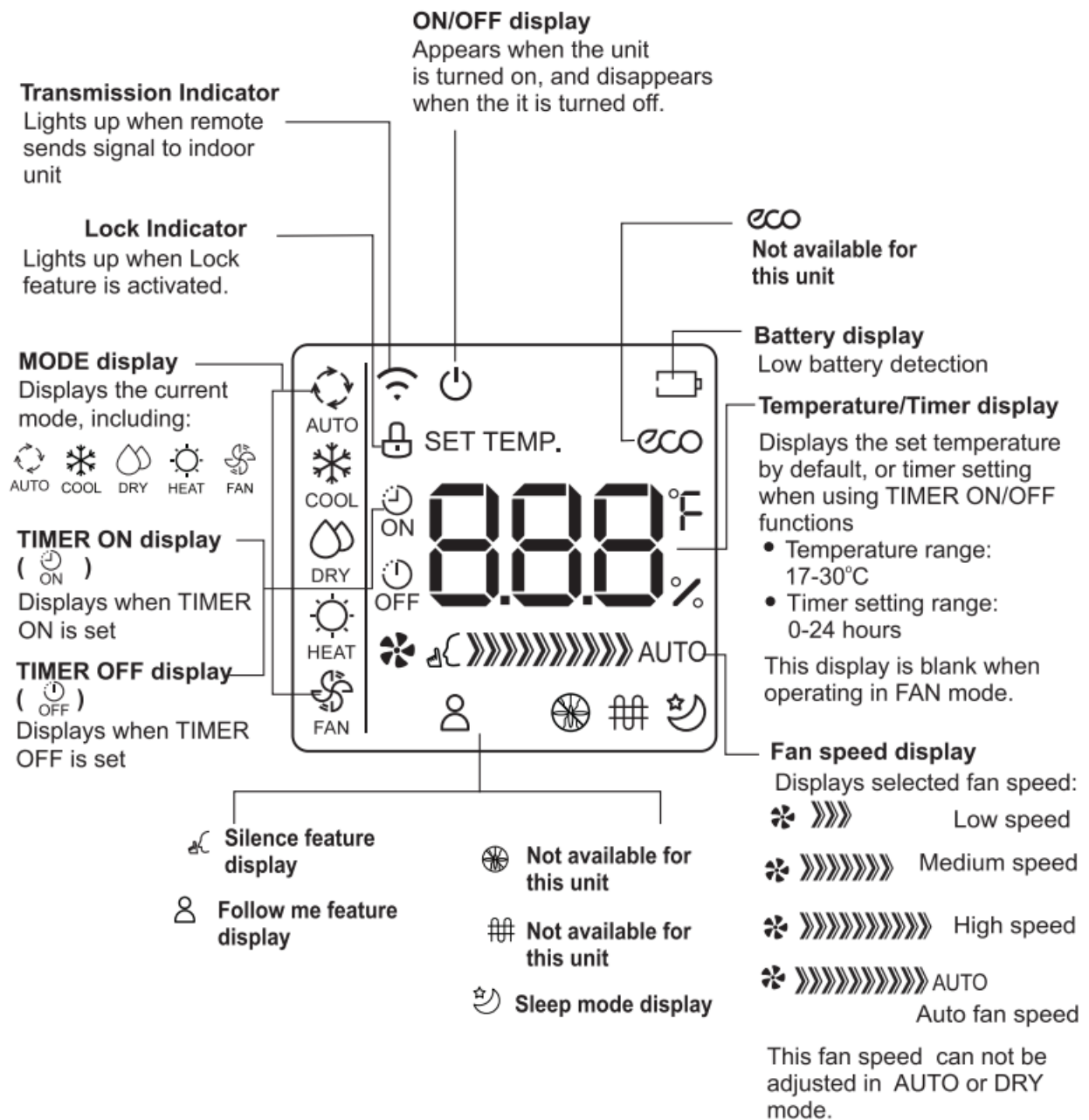

**Note:**

All indicators shown in the figure are for the purpose of clear presentation. But during the actual operation, only the relative functional signs are shown on the display window.

## How To Use The Basic Functions

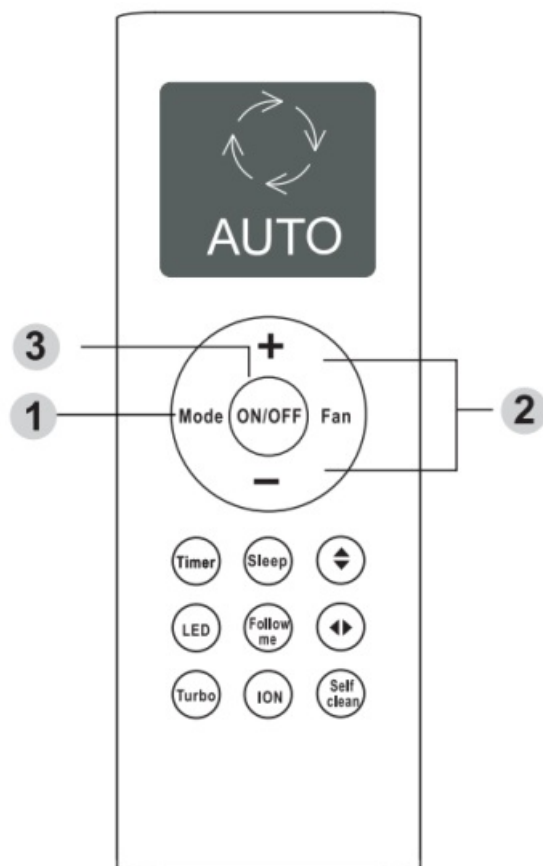

### COOL operation

1. Press the MODE button to select COOL mode.
2. Set your desired temperature using the Temp + or Temp — button
3. Press the FAN button to select the fan speed.
4. Press the ON/OFF button to start the unit.

### SETTING TEMPERATURE

The operating temperature range for units is 17-30°C. You can increase or decrease the set temperature in 1°C increment.

### AUTO operation

In AUTO mode, the unit will automatically select the COOL, FAN, HEAT or DRY mode based on the set temperature.

1. Press the MODE button to select Auto mode.
2. Set your desired temperature using the Temp + or Temp — button.
3. Press the ON/OFF button to start the unit.

**NOTE:** FAN SPEED can't be set in Auto mode.

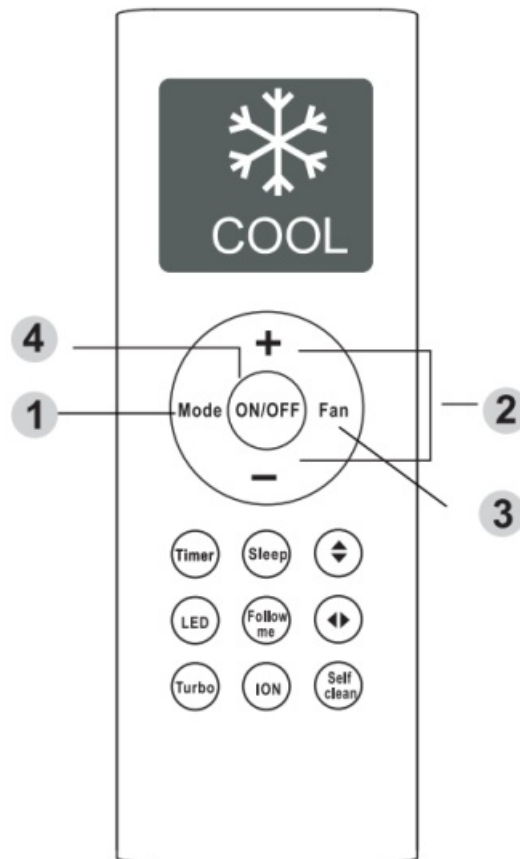

## How To Use The Basic Functions

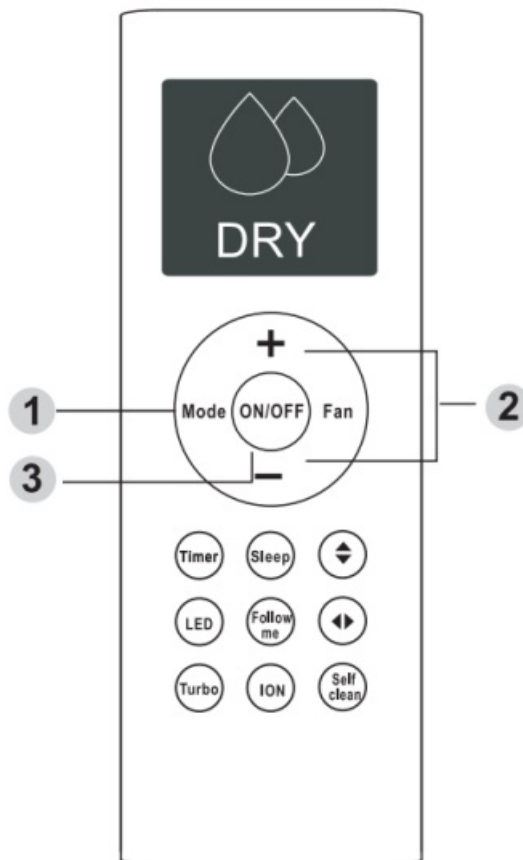

### FAN operation

1. Press the MODE button to select FAN mode.
2. Press the FAN button to select the fan speed.



3. Press the ON/off button to start the unit.

**NOTE:** You can't set the temperature in FAN mode. As a result, your remote control's LCD screen will not display the temperature.

**DRY operation(dehumidifying)**

1. Press the MODE button to select DRY mode.
2. Set your desired temperature using the Temp + or Temp — button.
3. Press the ON/off button to start the unit.

**NOTE:** FAN SPEED can't be changed in DRY mode.

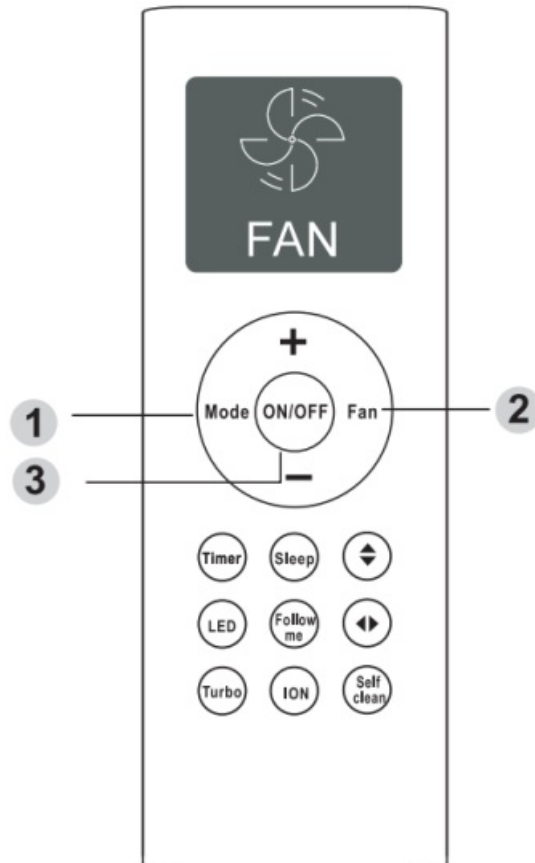

## How To Use The Basic Functions

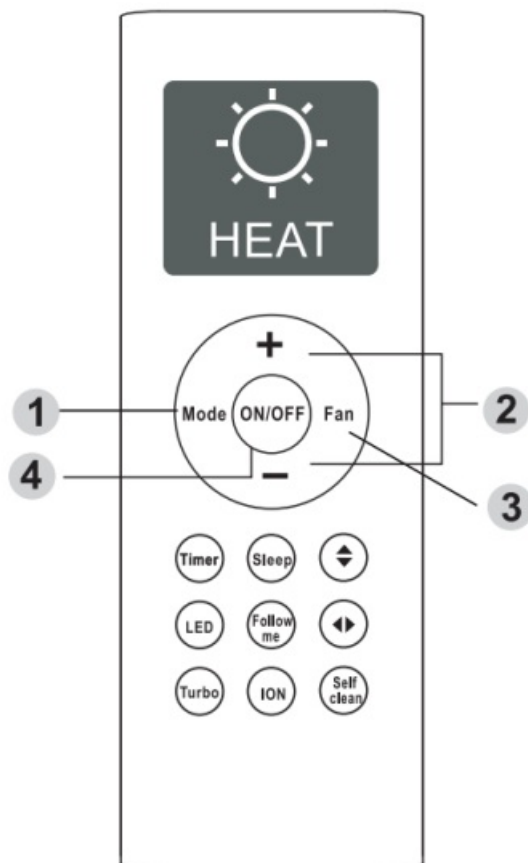

### HEAT operation

1. Press the MODE button to select HEAT mode.
2. Set your desired temperature using the Temp + or Temp – button.
3. Press the FAN button to select the fan speed.
4. Press the ON/OFF button to start the unit.

**NOTE:** As outdoor temperature drops, the performance of your unit's HEAT function may be affected. In such instances, we recommend using this air conditioner in conjunction with other heating appliances.

### Setting the TIMER function

Your air conditioning unit has two timer-related functions:

- **TIMER ON-** sets the amount of timer after which the unit will automatically turn on.
- **TIMER OFF-** sets the amount of time after which the unit will automatically turn off.

#### TIMER ON function

The **TIMER ON** function allows you to set a period of time after which the unit will automatically turn on, such as when you come home from work.

1. Press the Timer button, and the Timer on the indicator "g?" displays and flashes. By default, the last time period that you set and an "h" (indicating hours) will appear on the display. Note: This number indicates the amount of time after the current time that you want the unit to turn on. For example, if you set **TIMER ON** for 2.5 hours, "2.5h" will appear on the screen, and the unit will turn on after 2.5 hours.

2. Press the Temp or Temp button repeatedly to set the time when you want the unit to turn on.
3. Wait 3 seconds, then the TIMER ON function will be activated. The digital display on your remote control will then return to the temperature display. The " indicator remains on and this ON function is activated.

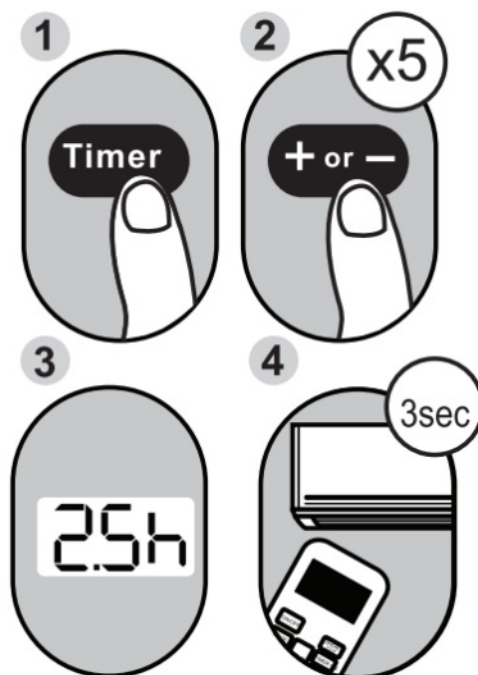

**Example:** Setting unit to turn on after 2.5 hours.

#### **TIMER OFF function**

The TIMER OFF function allows you to set a period of time after which the unit will automatically turn off, such as when you wake up.

1. Press the Timer button, the Timer off indicator "o" displays and flashes. By default, the last time period that you set and an "h" (indicating hours) will appear on the display. Note: This number indicates the amount of time after the current time that you want the unit to turn off. For example, if you set TIMER OFF for 5 hours, "5.0h" will appear on the screen, and the unit will turn on after 5 hours.
2. Press the Temp ± or Temp button repeatedly to set the time when you want the unit to turn on.
3. Wait 3 seconds, then the TIMER OFF function will be activated. The digital display on your remote control will then return to the temperature display. The '0' indicator remains on and this OFF function is activated.

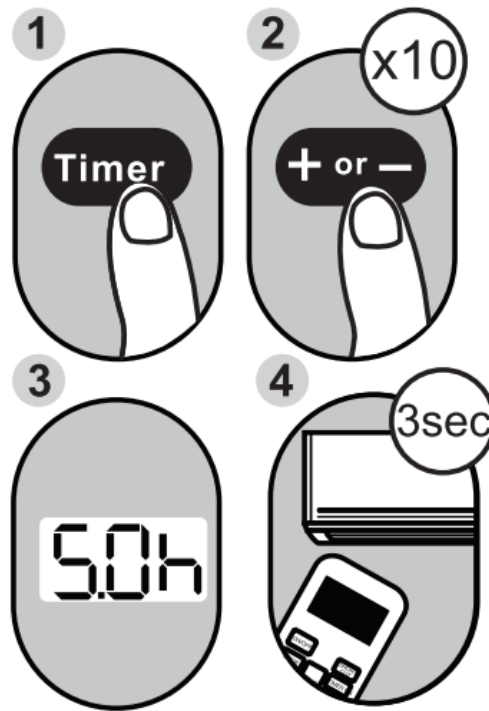

**Example:** Setting unit to turn off after 5 hours.

**NOTE:** When setting the TIMER ON or TIMER OFF functions, for up to 10 hours, the time will increase in 30-minute increments with each press. After 10 hours and up to 24, it will increase in 1-hour increments. The timer will revert to zero after 24 hours. You can turn off either function by setting its timer to "0.0h".

#### Setting both TIMER ON and TIMER OFF at the same time

Keep in mind that the time periods you set for both functions refer to hours after the current time. For example, say that the current time is 1:00 PM, and you want the unit to turn on automatically at 7:00 PM. You want it to operate for 2 hours, then automatically turn off at 9:00 PM.

Do the following:

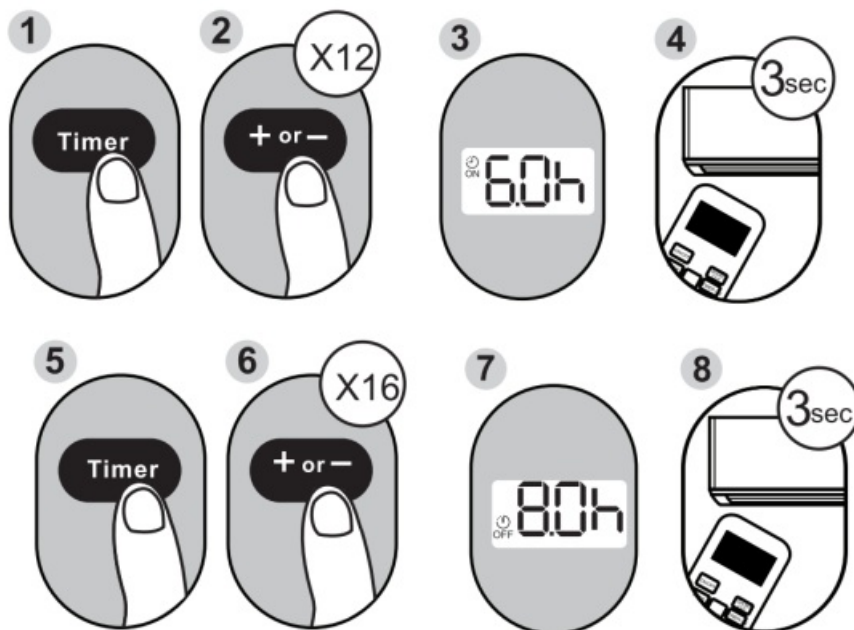

**Example:** Setting the unit to turn on after 6 hours, operate for 2 hours, then turn off (see the figure below)  
Your remote display

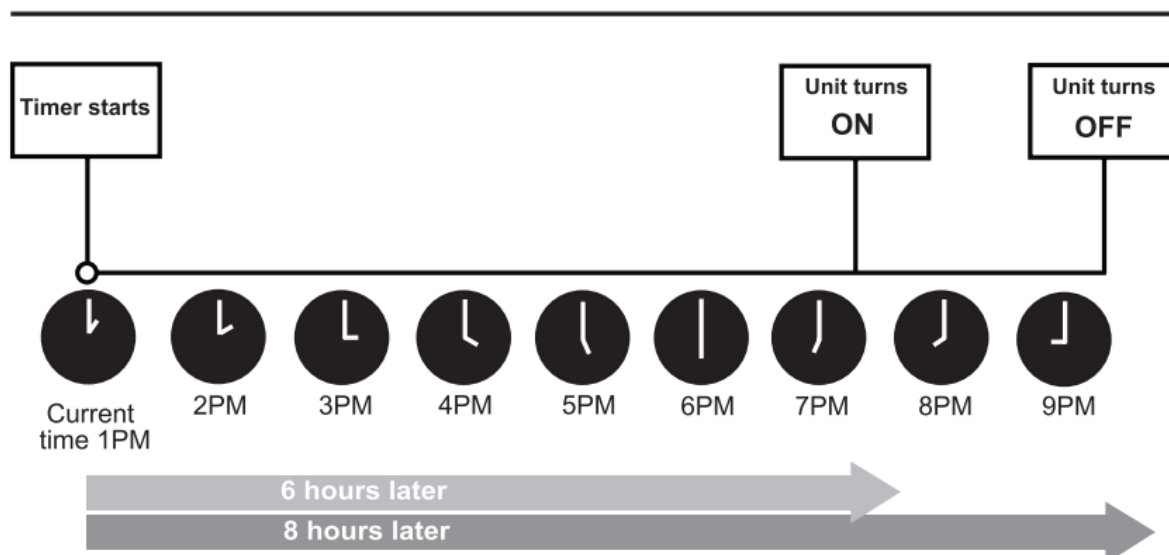
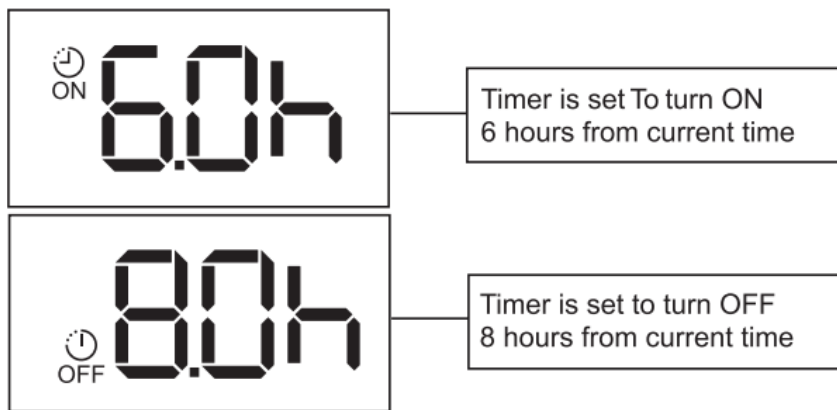

## How To Use The Advanced Functions

### SLEEP Function

The SLEEP function is used to decrease energy use while you sleep (and don't need the same temperature settings to stay comfortable). This function can only be activated via remote control. For the detail, see "sleep operation" in "USER'S MANUAL".

**Note:** The SLEEP function is not available in FAN or DRY mode.

### TURBO function

The TURBO function makes the unit work extra hard to reach your present temperature in the shortest amount of time possible.

- When you select the TURBO feature in COOL mode, the unit will blow cool air with the strongest wind setting to jump-start the cooling process.
- When you select the TURBO feature in HEAT mode, for units with Electric heat elements, the Electric Heater will activate and jump-start the heating process.

### FOLLOW ME function

The FOLLOW ME function enables the remote control to measure the temperature at its current location and send this signal to the air conditioner every 3 minutes interval. When using AUTO, COOL, or HEAT modes, measuring ambient temperature from the remote control (instead of from the indoor unit itself) will enable the air conditioner to optimize the temperature around you and ensure maximum comfort.

### SELF CLEAN function

Airborne bacteria can grow in the moisture that condenses around the heat exchanger in the unit. With regular use, most of this moisture is evaporated from the unit. When the SELF CLEAN feature is activated, your unit will clean itself automatically. The cleaning cycle takes 30 minutes, after which the unit will turn off automatically. You can use SELF CLEAN as often as you like. Note: You can only activate this function in COOL or DRY mode.

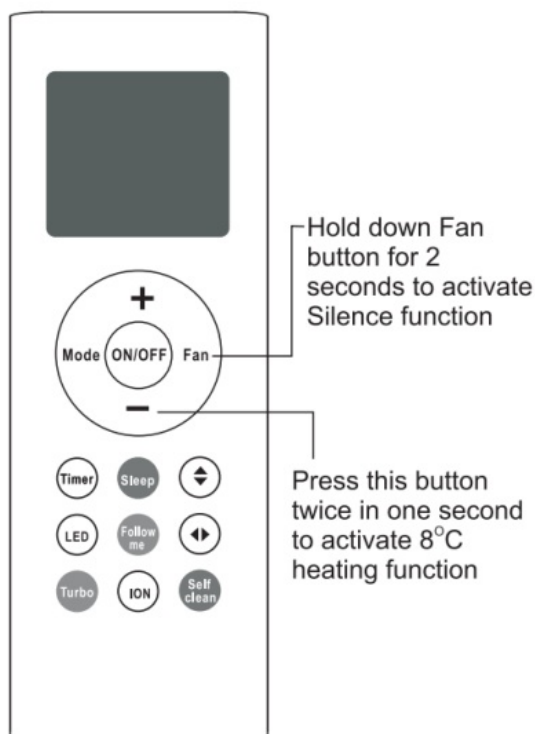

## How To Use The Advanced Functions

### Silence function

Hold down Fan speed button for 2 seconds to activate/cancel Silent mode. Due to the low-frequency operation of the compressor, it may result in insufficient cooling and heating capacity. (applicable to the air conditioner with Silent feature only)

### SWING function

Swing ◀ ▶ Button Used to stop or start vertical louver movement and set the desired left/right airflow direction. The vertical louver changes 6 degrees in angle for each press. If keep pushing for more than 2 seconds, the vertical louver auto swing feature is activated.

#### Swing • Button

Used to stop or start horizontal louver movement or set the desired up/down airflow direction. The louver changes 6 degrees in angle for each press. If keep pushing for more than 2 seconds, the louver will swing up and down automatically.

### 8°C Heating Function

When the air conditioner operates under heating mode with a set temperature of 17°C, pressing the Temp button twice in one second will activate 8 Degree heating function. The unit will operate at a set temperature of 8°C. The indoor unit display shows "FP".

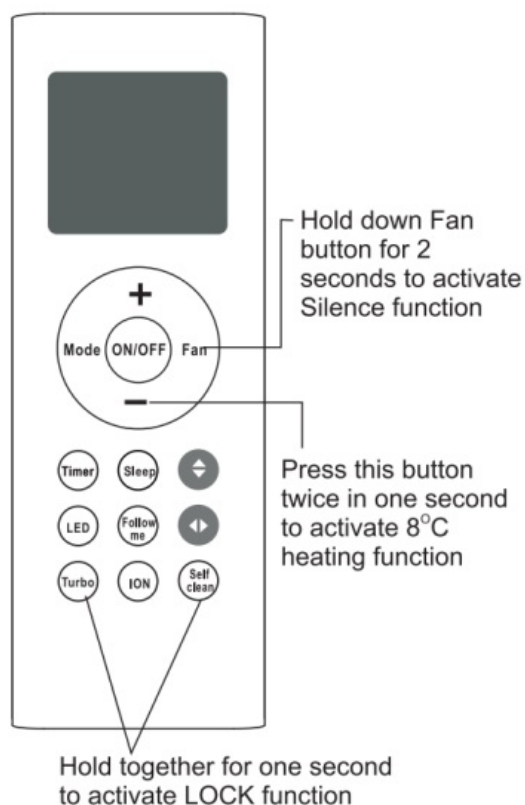

### LOCK function

Press Turbo button and Self clean button simultaneously for one second to lock or unlock the keyboard.

All the pictures in the manual are for explanatory purposes only. The actual shape of the unit you purchased may be slightly different, but the operations and functions are the same.

The company may not be held responsible for any misprinted information. The design and the specifications of the product for reasons, such as product improvement, are subject to change without any prior notice.

Please consult with the manufacturer at +30 211 300 3300 or with the Sales agency for further details. Any future updates to the manual will be uploaded to the service website, and it is advised to always check for the latest version.



Scan here to download the latest version of this manual. [www.inventorairconditioner.com/media-library](http://www.inventorairconditioner.com/media-library)



V: 1.1

Please check the applicable models, F-GAS, and manufacturer information.  
from the “Owner’s Manual – Product Fiche” in the packaging of the outdoor unit. (European Union products only).

Manufacturer: INVENTOR A.G. S.A.

24th km National Road Athens – Lamia & 2 Thoukididou Str., Ag.Stefanos, 14565

Tel.: +30 211 300 3300, Fax: +30 211 300 3333 – [www.inventor.ac](http://www.inventor.ac)



## Documents / Resources

	<p><a href="#">inventor RG66A/BGEF Remote Controller</a> [pdf] User Manual</p> <p>AR5VI-09WFI, AR5VO-09, AR4VI32-12WFI, AR4VO32-12, AR5VI-18WFI, AR5VO-18, AR5VI-24WFI, AR5VO-24, AR5VO-09 Air Conditioning Systems, Air Conditioning Systems, RG66A BGEF Remote Controller, RG66A BGEF, Remote Controller</p>
---	--

## References

- [Κλιματιστικά Inverter WiFi, Ψυγεία, Αφυγραντήρες, Air Conditioners - Inventor](#)
- [Biblioteca media - Inventor](#)
- [Αρχεία και Υποστήριξη - Inventor](#)
- [Media Library & Support - Inventor](#)