



INTEX Ladder with Removable Steps Owner's Manual

[Home](#) » [INTEX](#) » INTEX Ladder with Removable Steps Owner's Manual 

INTEX[®]
OWNER'S MANUAL



**Ladder with
Removable Steps
48" (122cm) & 52" (132cm) models
For illustrative purposes only.
52" (132cm) Shown**

Contents

- 1 IMPORTANT SAFETY RULES**
- 2 IMPORTANT SAFETY RULES**
- 3 PARTS REFERENCE**
- 4 WINTERIZING / LONG TERM STORAGE**
- 5 GENERAL AQUATIC SAFETY**
- 6 LIMITED WARRANTY**
- 7 Documents / Resources**
 - 7.1 References**

IMPORTANT SAFETY RULES

Read, understand, and follow all instructions carefully before installing and using this product.
SAVE THESE INSTRUCTIONS

IMPORTANT SAFETY RULES

Read, Understand and Follow All Instructions Carefully Before Installing and Using this Product.



WARNING

- Supervise children and those with disabilities at all times.
- Always assist children when they use the ladder to avoid falls and/or serious injury.
- Never dive or jump from this ladder.
- Locate the ladder on a level, solid base.
- One person on this ladder at a time.
- Maximum load: 300 lbs (136 kg). Complies with EN16582 strength requirements.
- Face the ladder at all times for entry/exit of pool.
- Remove and secure ladder when pool is not occupied.
- Do not swim under, through or behind ladder.
- Check all nuts and bolts regularly to ensure ladder stays sturdy.
- If swimming at night use artificial lighting to illuminate all safety signs, ladders, pool floor and walk ways.
- Assembly and disassembly by adults only.
- This ladder is designed and manufactured for a specific pool wall height and/or deck of the pool. Do not use with other pools.
- Failure to follow the main tenance instructions and warnings may result in adverse health effects or injury, particularly to children.
- Only use this ladder for the purposes described in this manual.

FAILURE TO FOLLOW THESE WARNINGS MAY RESULT IN BROKEN BONES, ENTRAPMENT, PARALYSIS, DROWNING OR OTHER SERIOUS INJURY.

These product warnings, instructions and safety rules provided with the product represent some common risks of water recreation devices and do not cover all instances of risk and danger. Please use common sense and good judgment when enjoying any water activity.

PARTS REFERENCE

Before assembling your product, please take a few minutes to check the contents and become familiar with all the parts.

48" (122cm) model

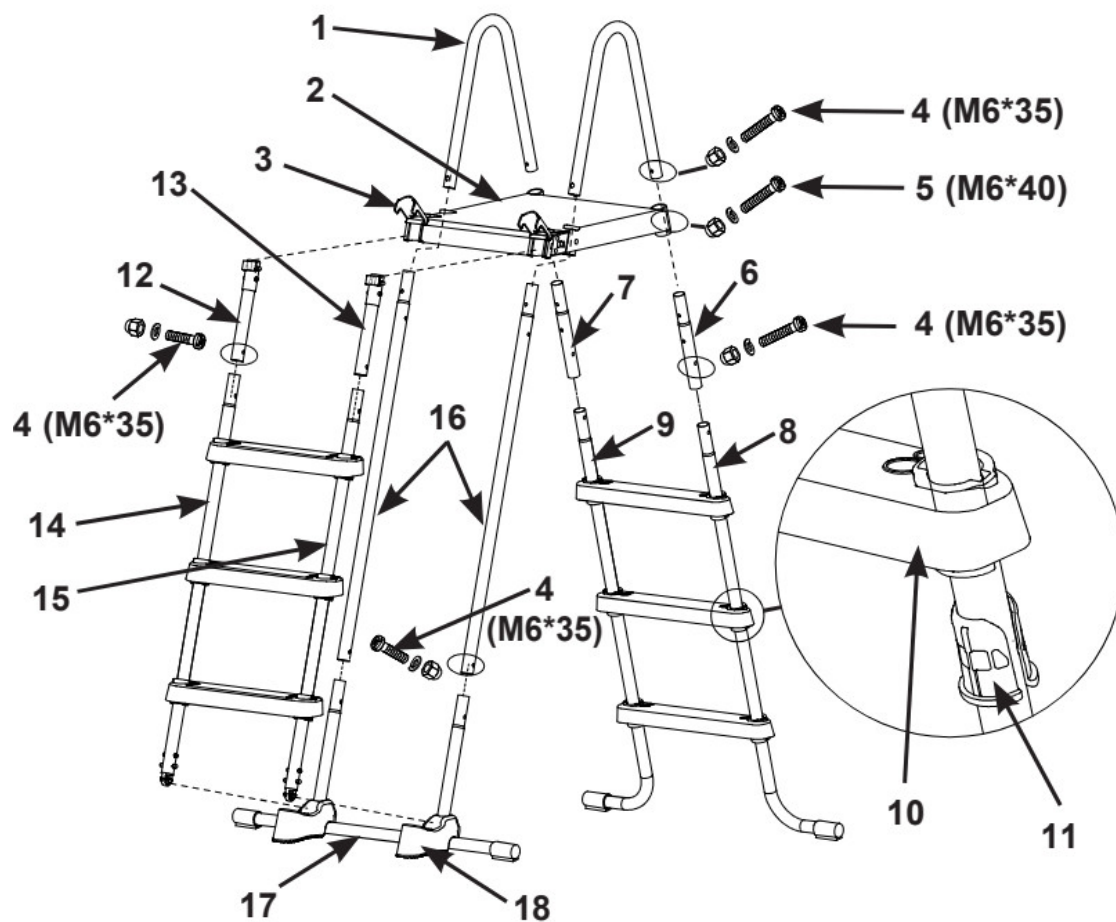

52" (132cm) model

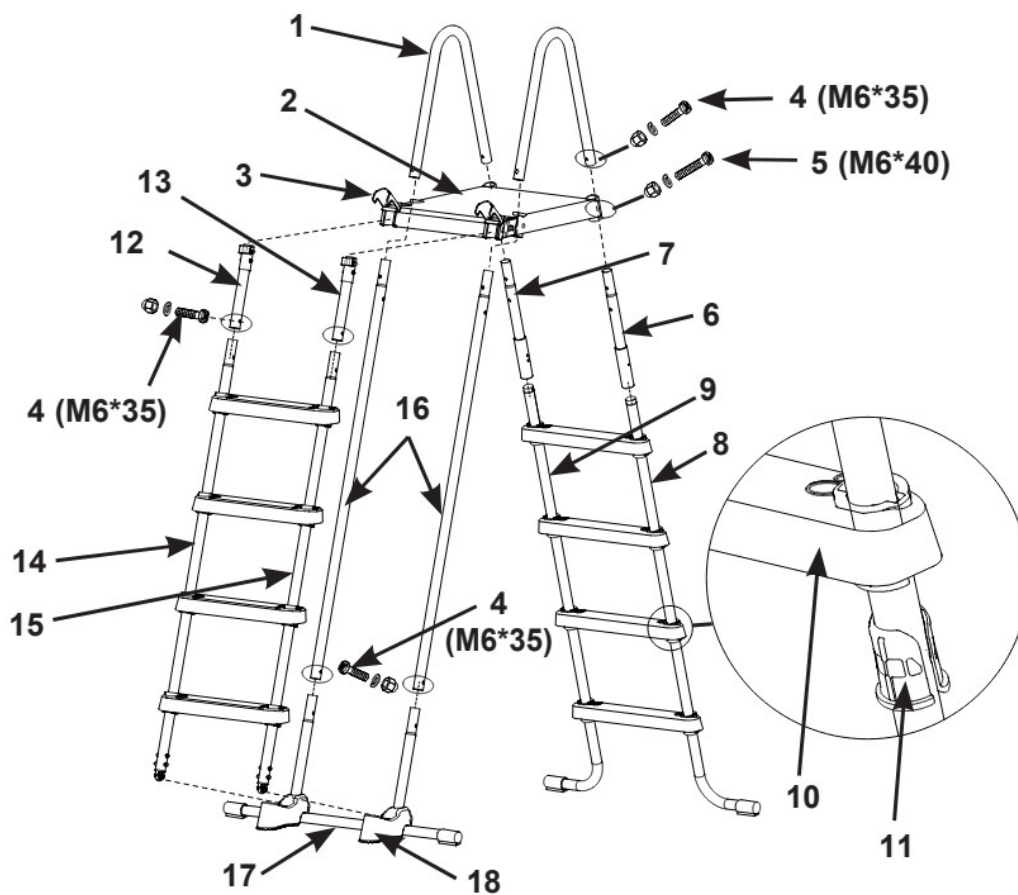

NOTE: Drawings for illustration purpose only. Actual product may vary. Not to scale.

Before assembling your product, please take a few minutes to check the contents and become familiar with all the parts.

REF. NO.	DESCRIPTION	QUANTITY		SPARE PART NO.	
				48"	52"
		48"	52"	#28076	#28077
1	U-SHAPED TOP RAIL	2	2	12512A	12512A
2	TOP PLATFORM	1	1	12182	12182
3	CLASP	2	2	12190	12190
4	SHORT FASTENER FOR U-SHAPED TOP RAIL (WITH 1 EXTRA)	11	9	10810	10810
5	LONG FASTENER FOR TOP PLATFORM (WITH 1 EXTRA)	5	5	10227	10227
6	A SIDE – UPPER SIDE LEG (MARKED “A”)	1	1	12669AA	12643AA
7	A SIDE – UPPER SIDE LEG (MARKED “B”)	1	1	12669AB	12643AB
8	A SIDE – LOWER J- LEG (MARKED “A”)	1	1	12670AA	12644AA
9	A SIDE – LOWER J- LEG (MARKED “B”)	1	1	12670AB	12644AB
10	STEP	6	8	12629	12629
11	STEP ANCHOR SLEEVE	12	16	12630	12630
12	B SIDE – UPPER SIDE LEG (MARKED “A1”)	1	1	12653AA	12653AA
13	B SIDE – UPPER SIDE LEG (MARKED “B1”)	1	1	12653AB	12653AB
14	B SIDE – LOWER SIDE LEG (MARKED “A1”)	1	1	12651AA	12654AA
15	B SIDE – LOWER SIDE LEG (MARKED “B1”)	1	1	12651AB	12654AB
16	C SIDE – UPPER SIDE LEG (MARKED “C”)	2	2	12652A	12655A
17	C SIDE – LOWER U-SHAPED SIDE LEG (MARKED “C”)	1	1	12650A	12650A
18	SUPPORT BASE	2	2	11356	11356

This ladder is designed and manufactured for Intex pool wall height:

Item #	Pool Wall Height
28076	48" (122cm)
28077	52" (132cm)

IMPORTANT

It is very important to lay out the parts correctly and identify which parts connect together before starting the assembly. Although some parts look alike, they are not always interchangeable. Refer to the parts list.

LADDER SETUP

TOOLS REQUIRED: One (1) Phillips screwdriver, one (1) small flat screwdriver One (1) pair of pliers or a small adjustable wrench Estimated assembly time 30-60 minutes. (Note the assembly time is only approximate and individual assembly experience may vary.)



WARNING

INCORRECTLY CONNECTED PARTS MAY RESULT IN AN UNSTABLE LADDER OR LADDER FAILURE WHICH CAN CAUSE

1. SIDE A LEGS ASSEMBLY (refer to figures 1.1 through 1.4):

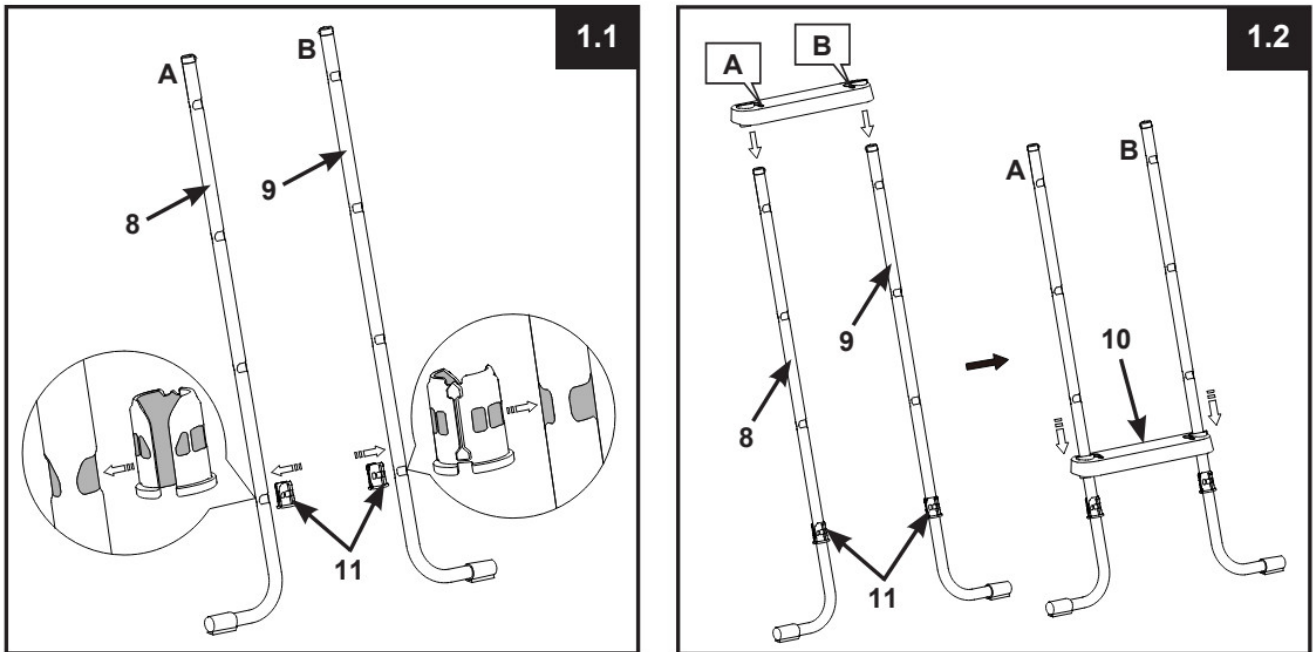

IMPORTANT: Ensure the J-shaped legs are pointing outwards before installing the steps

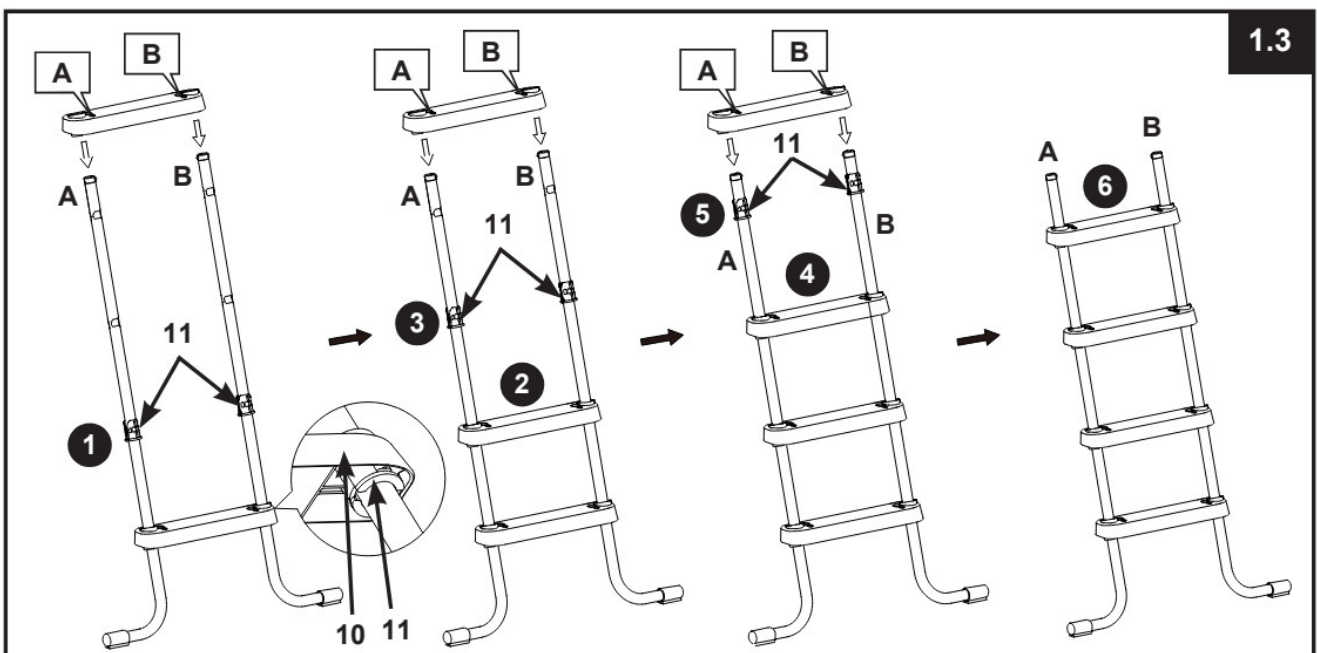

UPPER SIDE A LEGS ASSEMBLY (refer to figure 1.4):

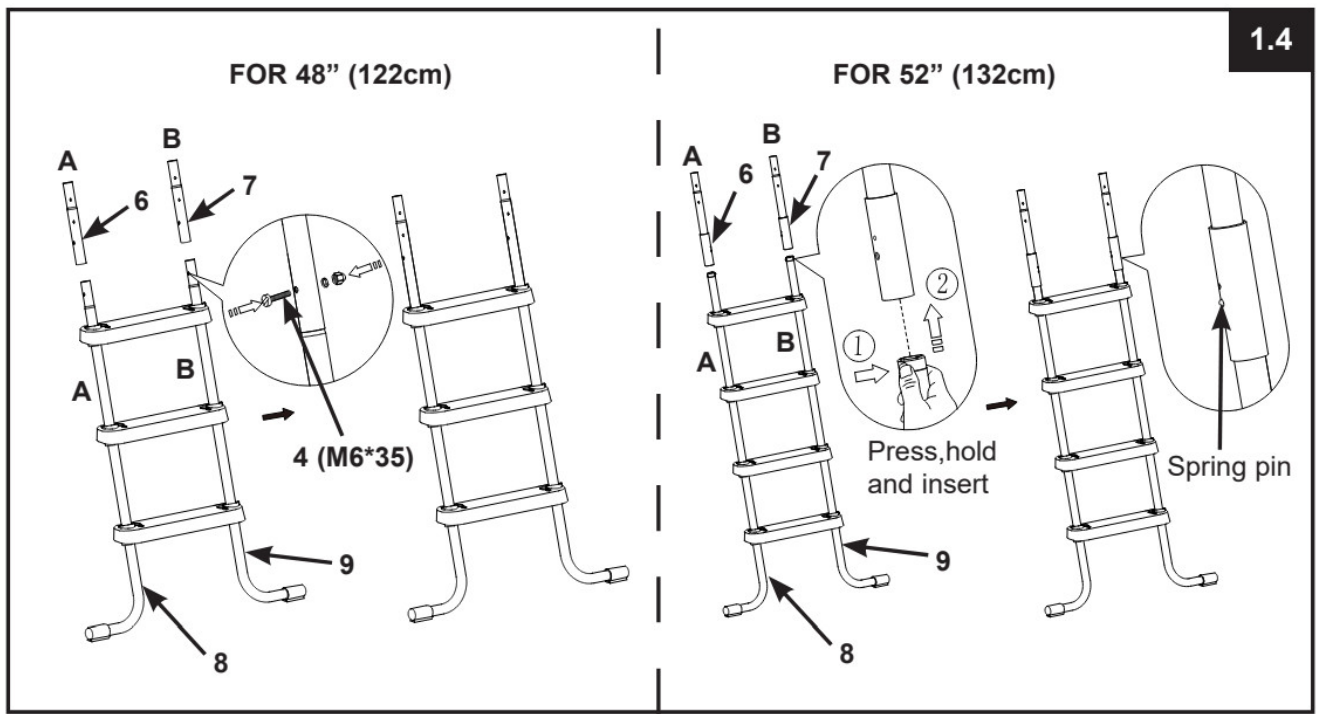

2. SIDE B LEGS ASSEMBLY (refer to figures 2.1 through 2.4):

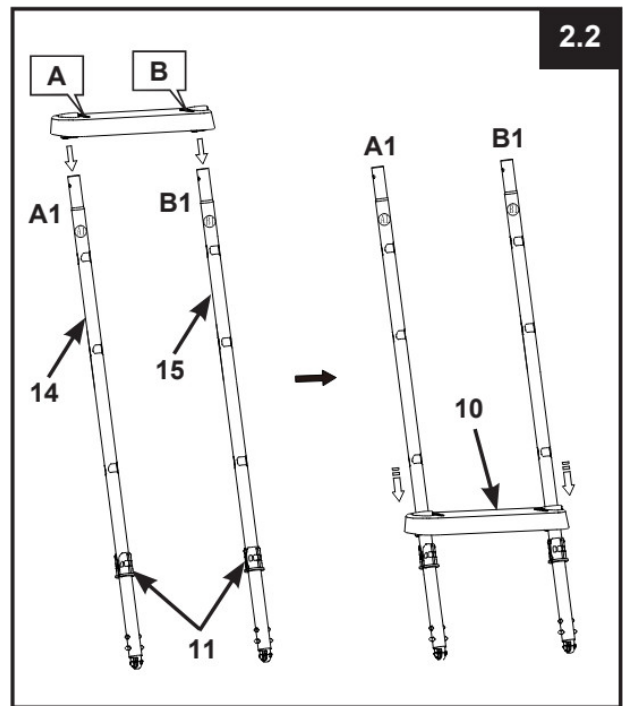
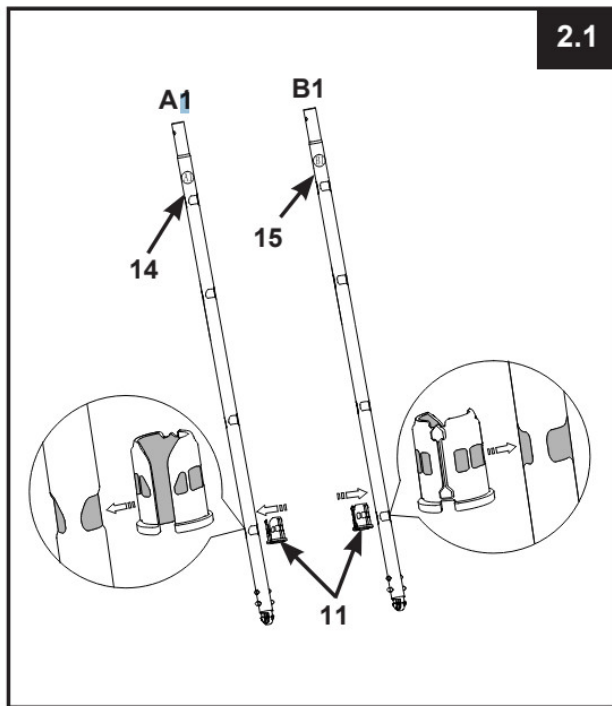

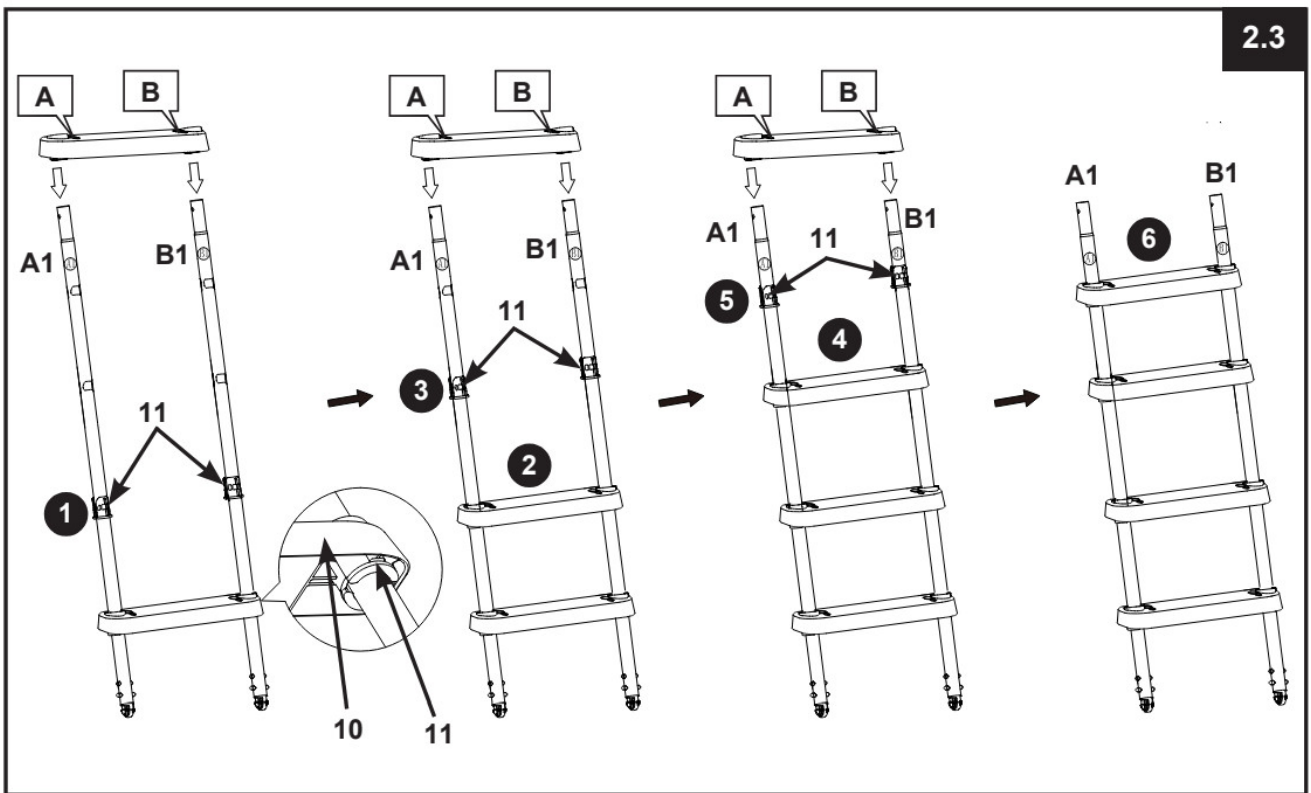

• UPPER SIDE B LEGS ASSEMBLY (refer to figure 2.4):

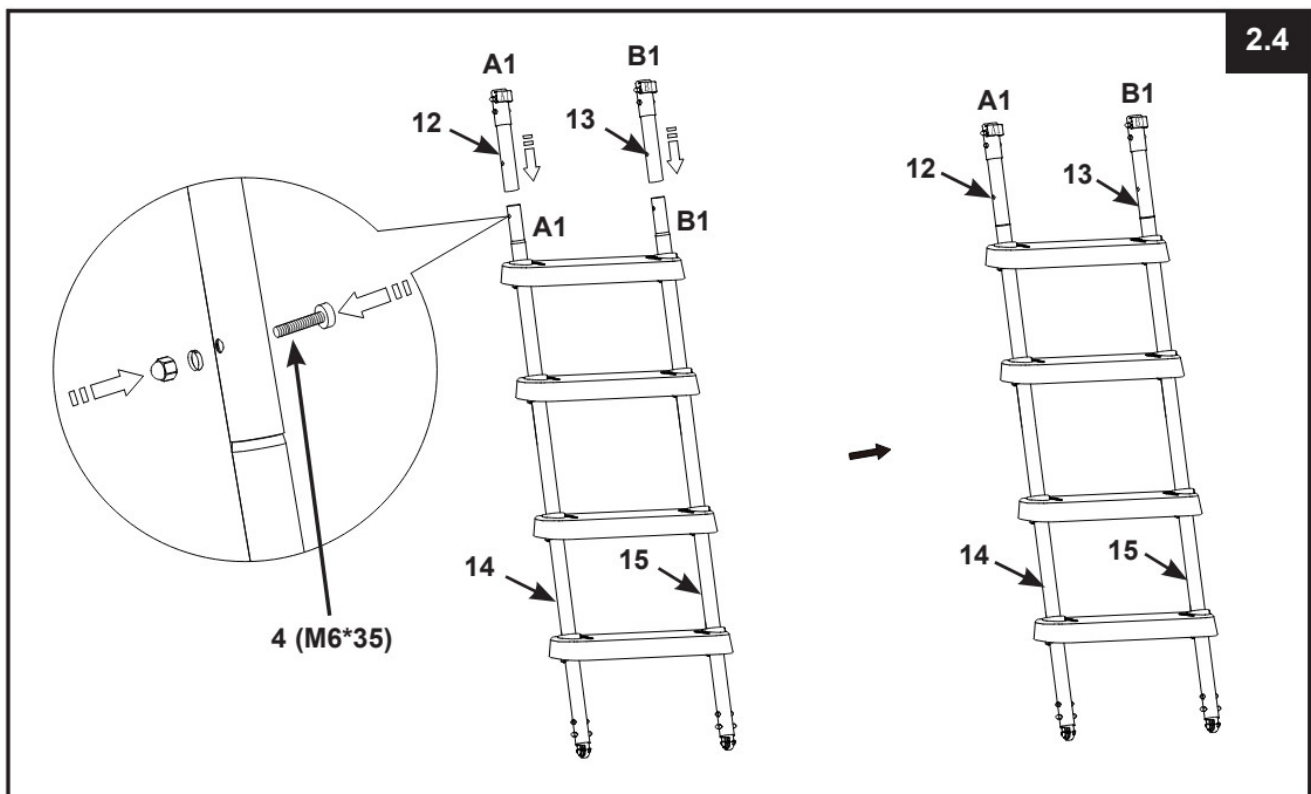

3. SIDE C LEGS ASSEMBLY (refer to figures 3.1 through 3.4):

IMPORTANT: Make sure the legs are securely connected and locked.

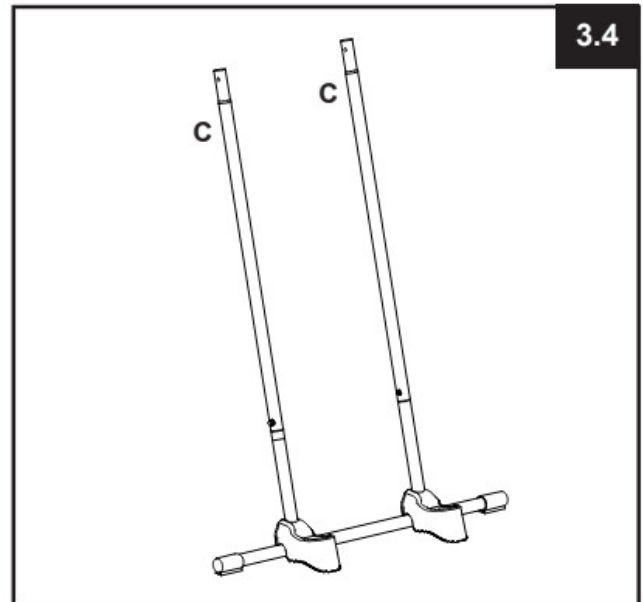
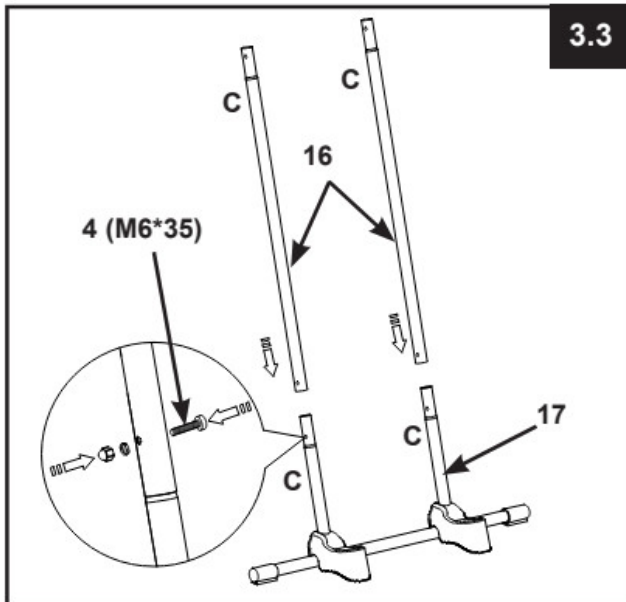
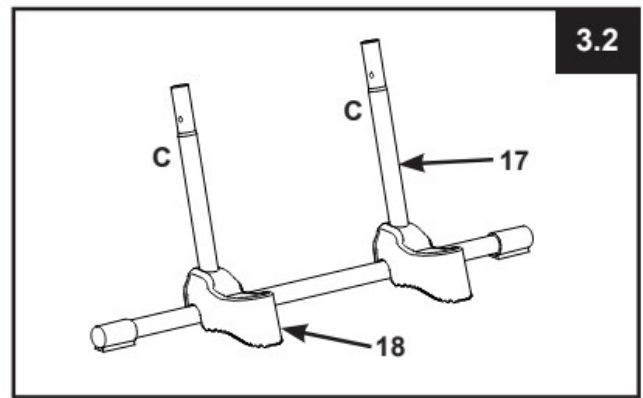
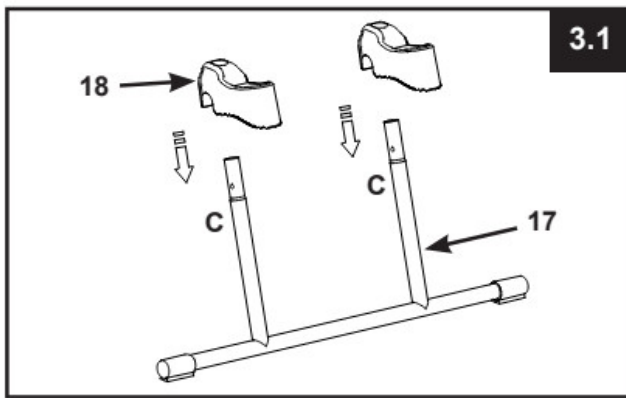

4. TOP PLATFORM INSTALLATION (refer to figure 4):

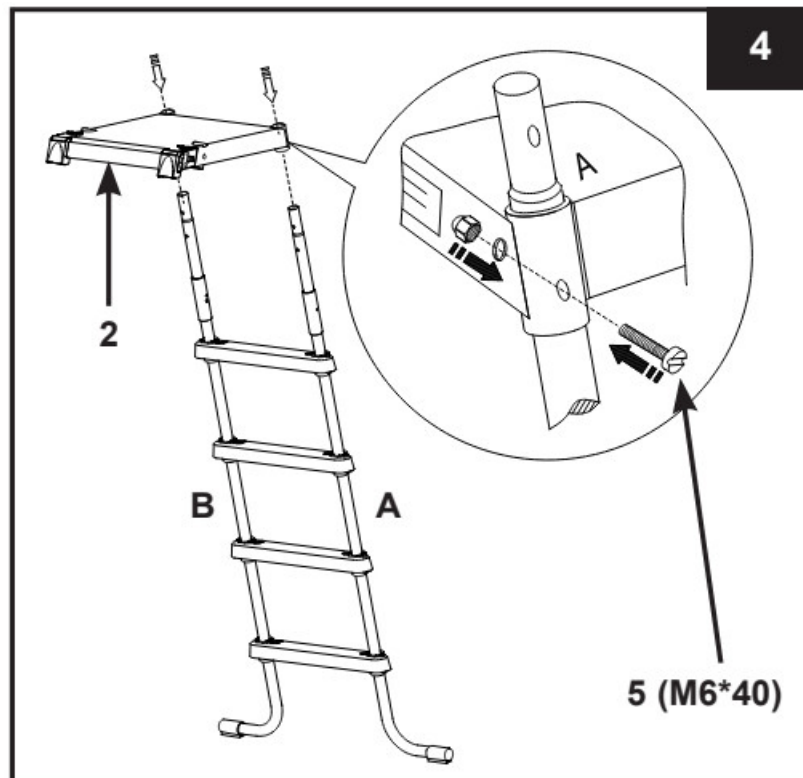

5. U-SHAPED TOP RAIL INSTALLATION (refer to figures 5.1 through 5.2):

IMPORTANT: One side at a time. Do not attach the other side of the U-shaped top rail until the U-shaped top rail is installed. Make sure all nuts and bolts are securely tightened. Do not fully tighten fasteners until after assembly operation.

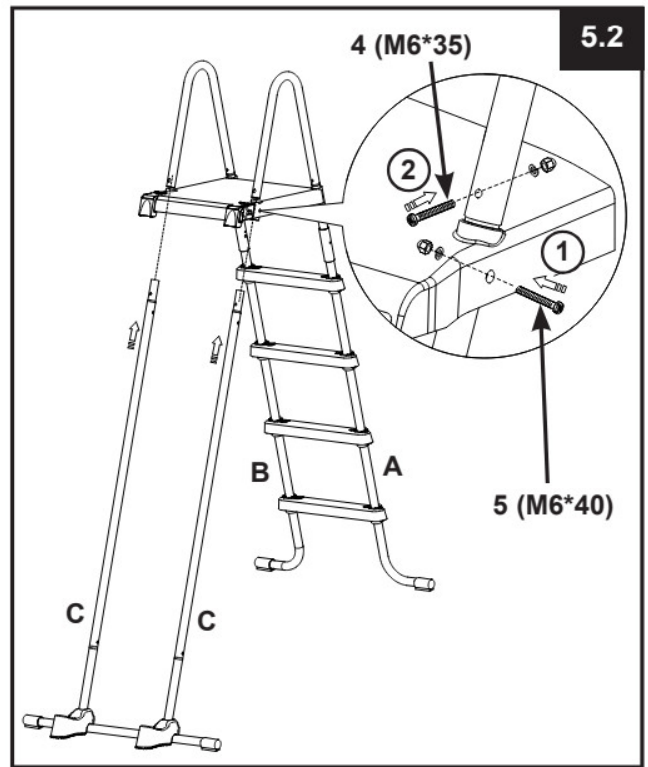
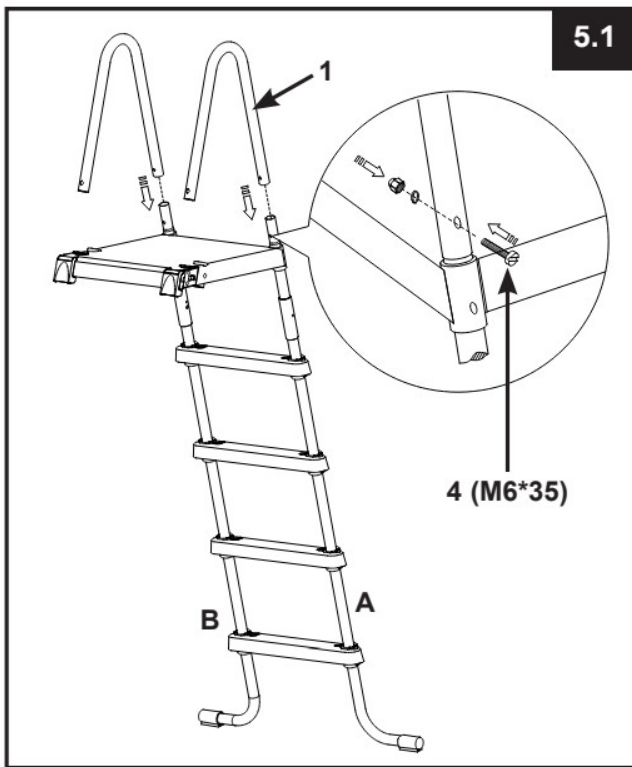

6. SIDE B LEGS INSTALLATION (refer to figure 6):

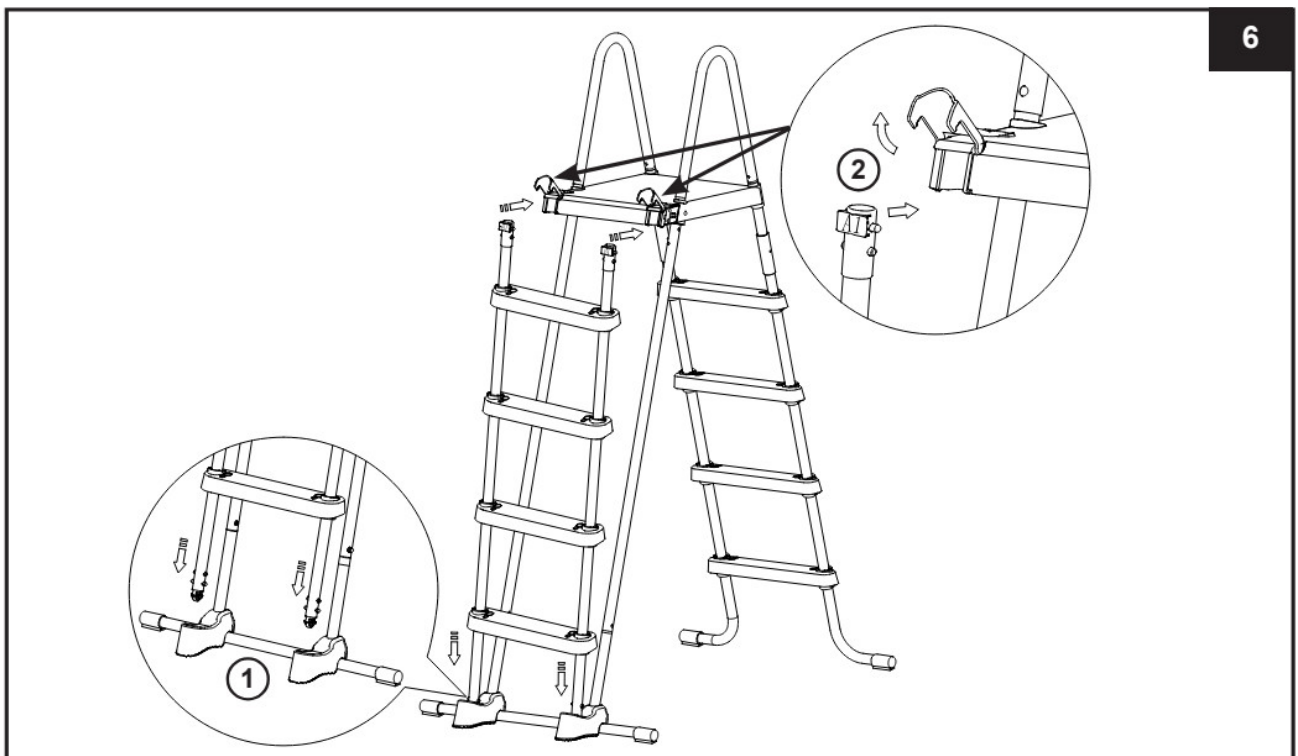

7. MAINTENANCE: Regularly check all nuts, bolts, steps and stepan chors leevesto ensure all parts are secure dproperly and the ladder is sturdy.

8. BEFORE USE OF LADDER (refer to figure 7):

With all parts no winplace, verify that all fasteners/screws are fully tight tened and apply down ward pressure to each step to be sure the yarefully anchored in place.

IMPORTANT: The removable steps side must be located outside of the pool.

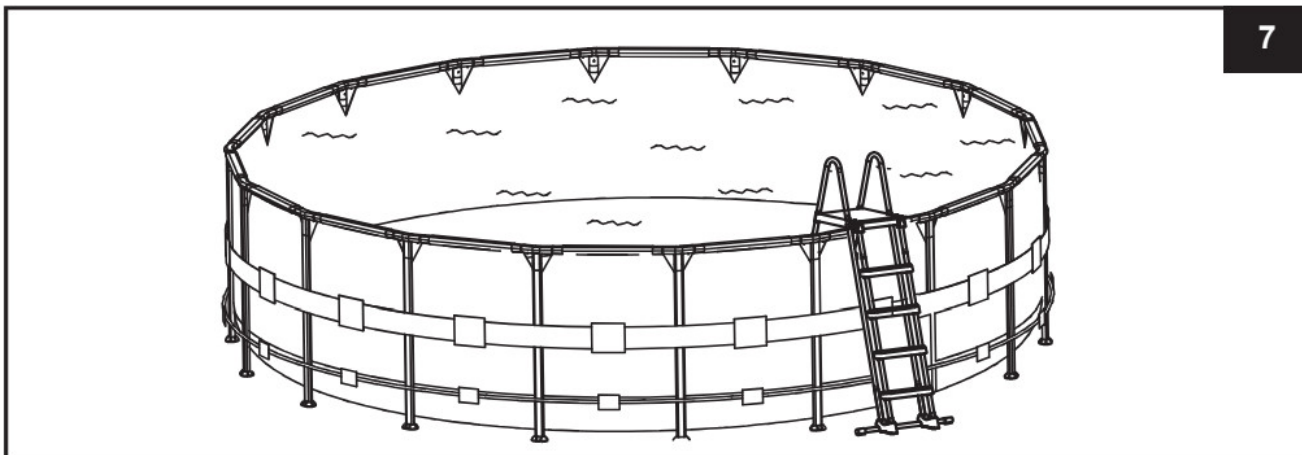

WARNING

BEFORE EACH USE, ENSURE THE REMOVABLE STEPS SIDE IS ANCHORED INTO THE SUPPORT BASE AND SECURELY LOCKED IN THE CLASPS LOCATED AT THE FRONT EDGE OF THE TOP PLATFORM.

8

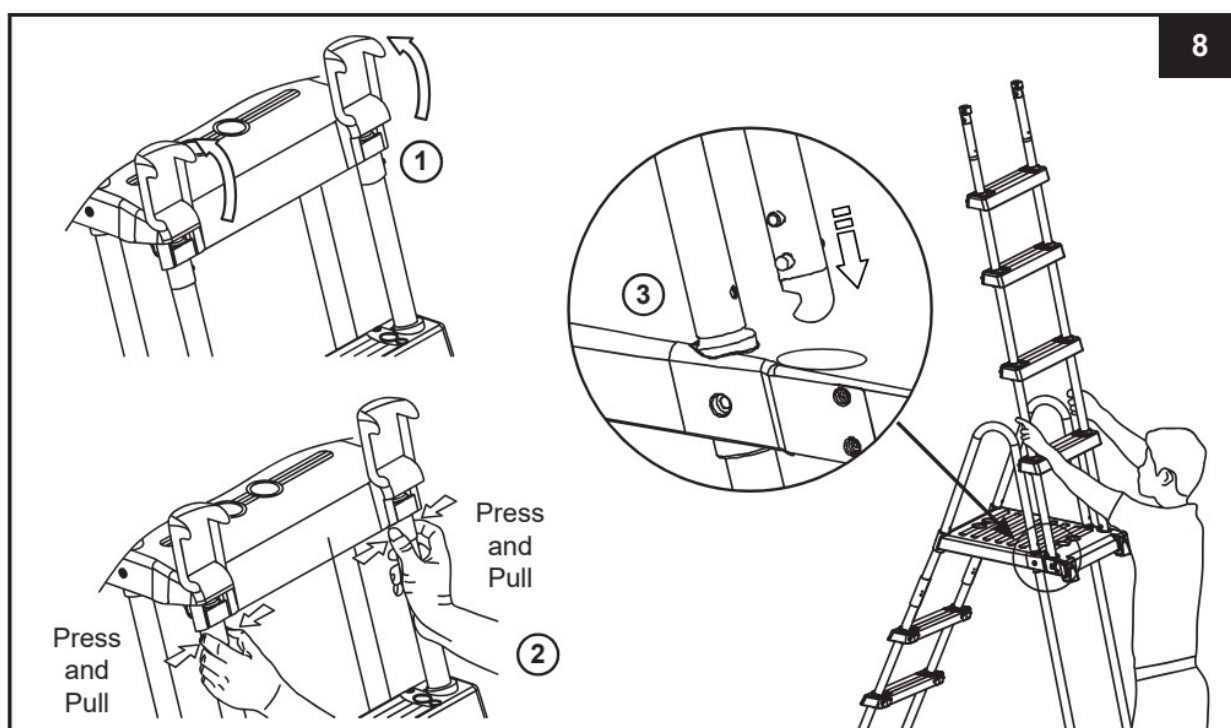

9

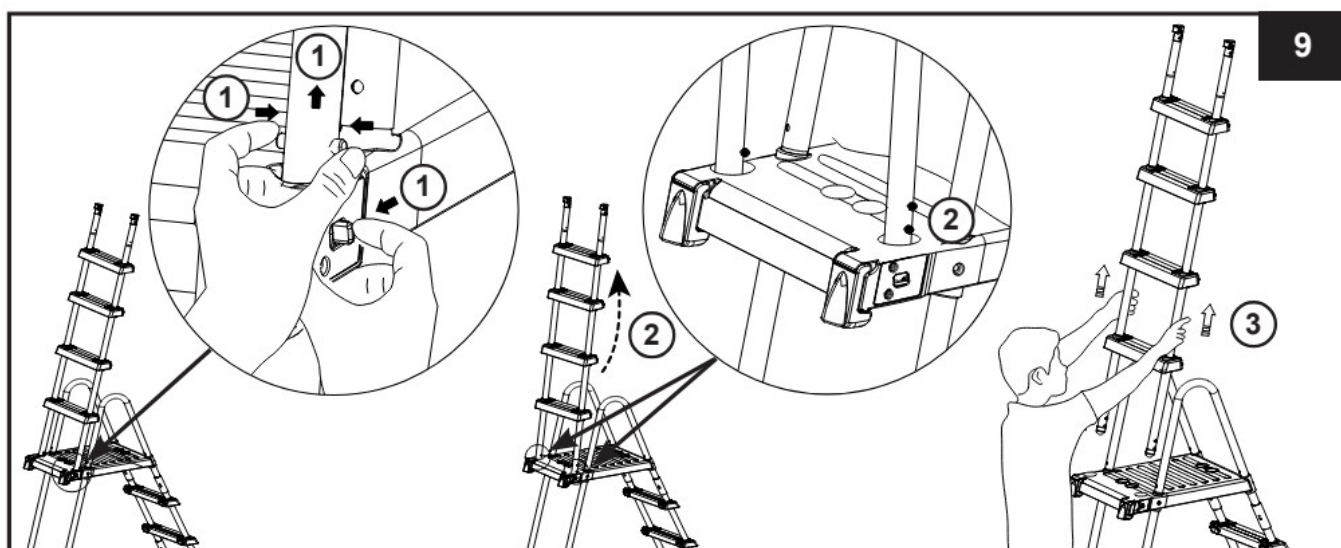

WINTERIZING / LONG TERM STORAGE

1. Remove the “removable steps” as shown in the After Use of Ladder section, see figure 8.
2. Remove the ladder from the pool, and make sure the ladder and the removable steps are thoroughly dry before long term storage.
3. Bring the ladder and all its components indoors and store in a safe and dry area, preferably between 32°F (0°C) and 104°F (40°C).
4. Be sure the ladder and all components are stored in a safe place away from children's reach.
5. Step disassembly:

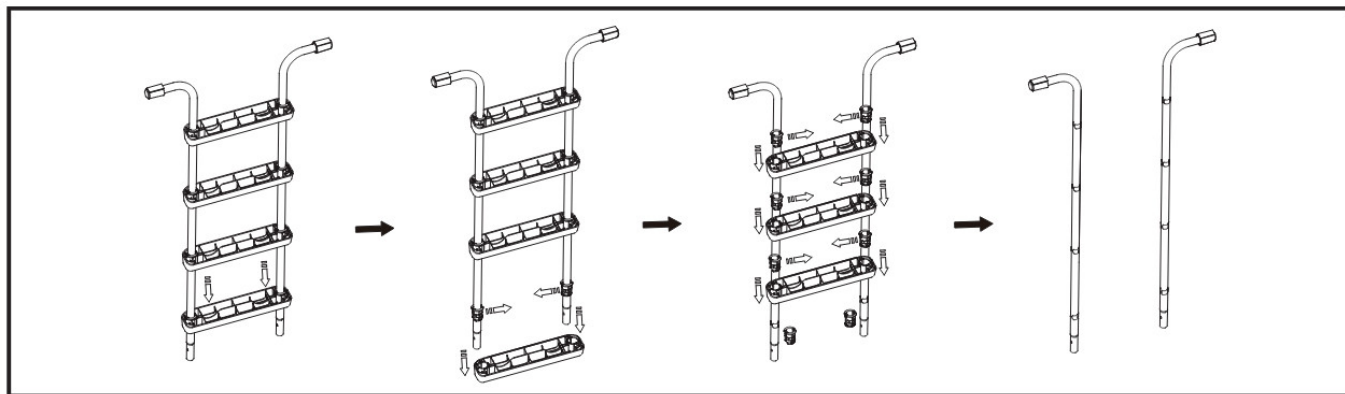

WARNING

WHEN NOT IN USE, LADDERS SHOULD BE KEPT IN SAFETY POSITION.

REMOVE THE FRONT STEP SIDE WHEN THE POOL IS NOT IN USE OR OCCUPIED. STORE THE REMOVABLE STEPS

GENERAL AQUATIC SAFETY

Water recreation is both fun and therapeutic. However, it involves inherent risks of injury and death. To reduce your risk of injury, read and follow all product, package and package insert warnings and instructions. Remember, however, that product warnings, instructions and safety guidelines cover some common risks of water recreation, but do not cover all risks and dangers. For additional safeguards, also familiarize yourself with the following general guidelines as well as guidelines provided by nationally recognized Safety Organizations:

- Demand constant supervision. A competent adult should be appointed as a “lifeguard” or water watcher, especially when children are in and around the pool.
- Learn to swim.
- Take the time to learn CPR and first aid.
- Instruct anyone who is supervising pool users about potential pool hazards and about the use of protective device such as locked doors, barriers, etc.
- Instruct all pool users, including children what to do in case of an emergency.
- Always use common sense and good judgement when enjoying any water activity.
- Supervise, supervise, supervise. For additional information on safety, please visit:
 - The Association of Pool and Spa Professionals: The Sensible Way to Enjoy Your
 - Aboveground/Onground Swimming Pool www.nspi.org
 - American Academy of Pediatrics: Pool Safety for Children www.aap.org
 - Red Cross www.redcross.org

- Safe Kids www.safekids.org
- Home Safety Council: Safety Guide www.homesafetycouncil.org
- Toy Industry Association: Toy Safety www.toy-tia.org

LIMITED WARRANTY

Your Intex Pool Ladder has been manufactured using the highest quality materials and workmanship. All Intex products have been inspected and found free of defects prior to leaving the factory. This Limited Warranty applies to the Intex Pool Ladder only.

The provisions of this Limited Warranty apply only to the original purchaser and is not transferable. This Limited Warranty is valid for a period of 1 year from the date of the initial retail purchase. Keep your original sales receipt with this manual, as proof of purchase will be required and must accompany warranty claims or the Limited Warranty is invalid.

If a manufacturing defect is found within this 1 year period, please contact the appropriate Intex Service Center listed in the separate "Authorized Service Centers" sheet. The Service Center will determine the validity of the claim. If the Service Center directs you to return the product, please carefully package the product and send with shipping and insurance prepaid to the Service Center. Upon receipt of the returned product, the Intex Service Center will inspect the item and determine the validity of the claim. If the provisions of this warranty cover the item, the item will be repaired or replaced at no charge.

Any and all disputes regarding the provisions of this Limited Warranty shall be brought before an informal dispute settlement board and unless and until the provisions of these paragraphs are carried forth, no civil action may be instituted. The methods and procedures of this settlement board shall be subject to the rules and regulations set forth by the Federal Trade Commission (F.T.C.). IMPLIED WARRANTIES ARE LIMITED TO THE TERMS OF THIS WARRANTY AND IN NO EVENT SHALL INTEX, THEIR AUTHORIZED AGENTS OR EMPLOYEES BE LIABLE TO THE BUYER OR ANY OTHER PARTY FOR DIRECT OR CONSEQUENTIAL DAMAGES OR LIABILITIES. Some states, or jurisdictions do not allow the exclusion or limitation of incidental or consequential damages, so the above limitation or exclusion may not apply to you.

This Limited Warranty does not apply if the Intex product is subject to negligence, abnormal use or operation, accident, improper operation, improper maintenance or storage, or to damage by circumstances beyond Intex's control, including but not limited to, ordinary wear and tear and damage caused by exposure to fire, flood, freezing, rain, or other external environmental forces. This Limited Warranty applies only to those parts and components sold by Intex. The Limited Warranty does not cover unauthorized alterations, repairs or disassembly by anyone other than Intex Service Center personnel.

DO NOT GO BACK TO THE PLACE OF PURCHASE FOR RETURN OR REPLACEMENT.

IF YOU ARE MISSING PARTS OR NEED ASSISTANCE, PLEASE CALL US (FOR U.S.

AND CANADIAN RESIDENTS): 1-310-549-8235 OR VISIT OUR WEBSITE: WWW.INTEXCORP.COM.





Proof of Purchase must accompany all returns or the warranty claim will be invalid.

INTEX®

Documents / Resources

	<p>INTEX Ladder with Removable Steps [pdf] Owner's Manual 48 122cm, 52 132cm, Ladder with Removable Steps, Removable Steps, Steps</p>
---	---

References

-  [Home | AAP](#)
-  [INTEX: The leader in Above Ground Swimming Pools, Air Mattresses and Inflatable Spas](#)
-  [Home - Pool & Hot Tub Alliance](#)
-  [American Red Cross | Help Those Affected by Disasters](#)
-  [Safe Kids Worldwide](#)

Manuals+.