



INTERPHONE SYNC70 Essential Smart Display User Manual

[Home](#) » [Interphone](#) » INTERPHONE SYNC70 Essential Smart Display User Manual 

Contents

- [1 INTERPHONE SYNC70 Essential Smart Display](#)
- [2 Product Usage Instructions](#)
- [3 Introduction](#)
- [4 Safety and Warnings](#)
- [5 Technical Specifications](#)
- [6 Installation](#)
- [7 Usage](#)
- [8 Settings](#)
- [9 FAQ](#)
- [10 Documents / Resources](#)
 - [10.1 References](#)

INTERPHONE

INTERPHONE SYNC70 Essential Smart Display



Product Usage Instructions

- Read the safety instructions carefully before using the product to prevent any accidents or damage.
- Always focus on driving and avoid distractions while using the device.
- Choose the suitable spacer and apply it on the handlebar/bar.
- Screw and tighten the mount on the rubber spacer.
- Adjust the mount as needed by unscrewing, rotating, and screwing it back.
- Yellow Wire (BATT): Connect to a permanent +12V power source like the positive terminal of the motorcycle battery (+).
- Black Wire (GND): Connect to a ground point on the motorcycle.

Introduction

- SYNC70 is a 7-inch Smart Display designed for riders, featuring a high-visibility IPS touch screen with anti-rain drop activation.
- It seamlessly connects via Apple CarPlay and Android Auto for navigation, calls, and media control.
- Enhanced safety includes Blind Spot Detection (BSD) with rear camera alerts and Dual Camera Recording (DCR) for continuous front and rear video capture.
- TPMS (Tire Pressure Monitoring System) ensures real-time tire pressure monitoring.
- With split-screen mode, riders can view navigation, rear camera feed, and dashboard data simultaneously.
- IP66 waterproof and Quiklox mount provide durability and easy installation.

Safety and Warnings

Important! Read before use!

- Failure to follow instructions may result in death, serious injury, or device damage.
- Incorrect setup or use increases these risks. Use with caution and stay focused while driving.
- Minimize screen interaction and comply with the laws of your region.
- Cellularline S.p.A. is not liable for fines due to noncompliance.

Correct mounting

- Ensure the device does not obstruct your view, vehicle control, or any safety function or dashboard instruments.

Use of audio systems (Bluetooth Intercoms)

- This device does not support Bluetooth headsets or intercoms.
- Connect your mobile phone directly to a Bluetooth headset for concurrent use.

Water resistance

- IP67 waterproof when correctly installed and used. Do not immerse in water.

TPMS: TPMS are not suitable for 90° tire valves.

General guidelines

- Sync70 mirrors apps via CarPlay & Android Auto. It has GPS for the odometer but isn't a navigator. It's not a music player.
- The touchscreen may not work with gloves or rain. Do not open it; it's dangerous and voids the warranty. Clean with a soft cloth only.

Memory Card (Video Recording)

- Use a U3-class mini type SD memory card (32GB–256GB) from reputable brands for optimal performance. Other cards may cause malfunctions.



Technical Specifications

- CE Declaration of Conformity: Cellularline S.p.A. declares that this device complies with Directive 2014/53/EU. The full text of the EU declaration of conformity is available at the following address:
- www.cellularline.com/_/declaration-of-conformity . Cellularline S.p.A. also declares that this device complies with the 2011/65/EU updated from 2015/863/EU.

Product: INTERPHOSYNC70	Model: SYNC70	Operating temperature: -20~70°C
Dimensions mm: 184.2 x 117 x 31.2	Power supply: 5V DC - 2,5A	Weight: 419,5 g
Bluetooth® v. 4.2 - Class 2	Frequency Bluetooth: 2.402 – 2.480GHz	Power Bluetooth: 20dBm
Frequency WIFI : 2.4G (2400MHz ~ 2500MHz) / 5G (5150Mhz~5250Mhz)	Power: Wi-Fi 20 dBm	

WEEE: The crossed-out wheel bin symbol on the product, literature, or packaging reminds you that all electrical and electronic products, batteries, and accumulators must be taken to separate collection at the end of their working life. This requirement applies to the European Union and other locations where separate collection systems are available. To prevent possible harm to the environment or human health from uncontrolled waste disposal, please do not dispose of these products as unsorted municipal waste but hand them in at an official collection point for recycling.



Installation

Overview

1. Sync70 main unit
2. Front&Rear cameras + mounting adhesives/screws
3. Main cable
4. 12V Power supply cable
5. USB-A Power supply cable
6. USB-C Power supply cable
7. Handlebar adapter spacers 12-22-24.5-28mm
8. Handlebar Quiklox mount
9. TPMS sensors set
10. Tools

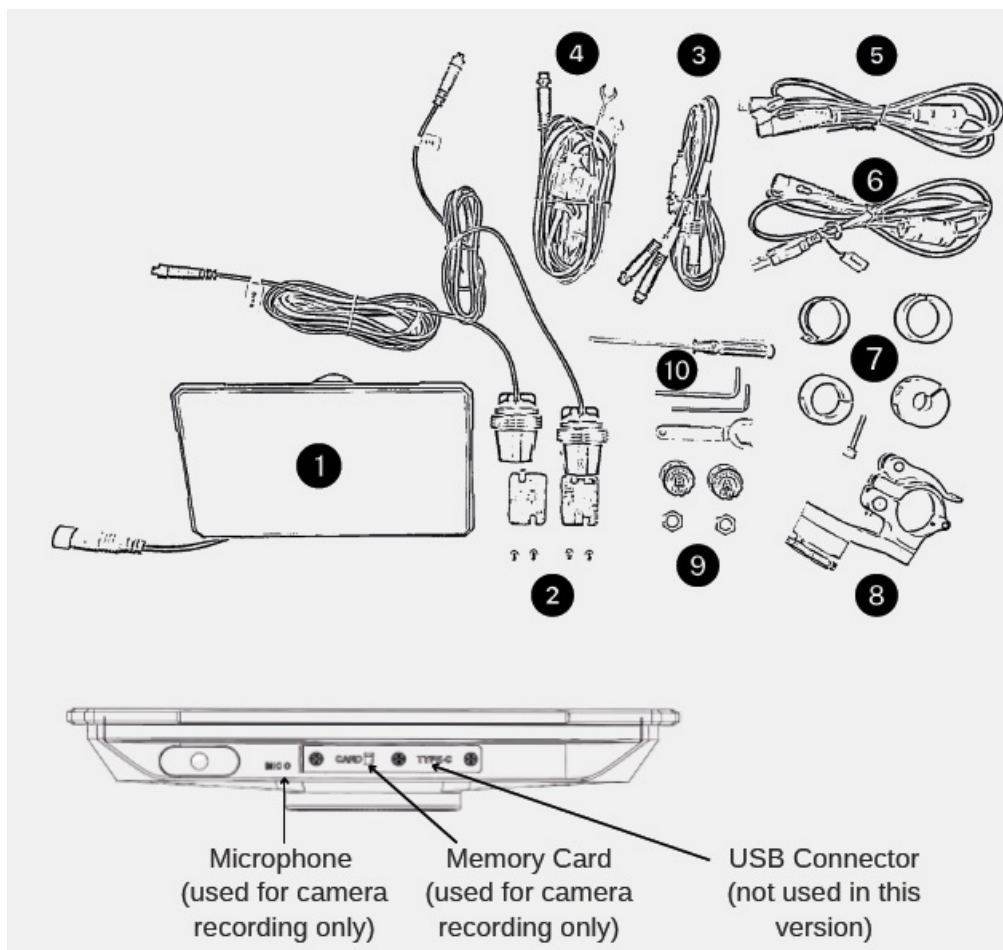

Installation

- Sync70 is compatible with all Interphone Quiklox mounts, allowing multiple installation options, including handlebar clamp, sportbike steering stem, mirror, crossbar, brake reservoir, and car mount.
- Visit www.interphone.com for more details.

Chose the suitable spacer and apply it on the handlebar/bar

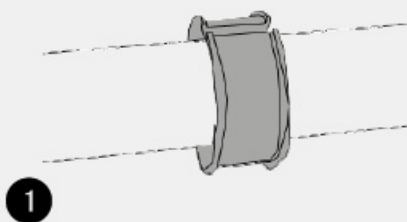

Install the mount on rubber spacer

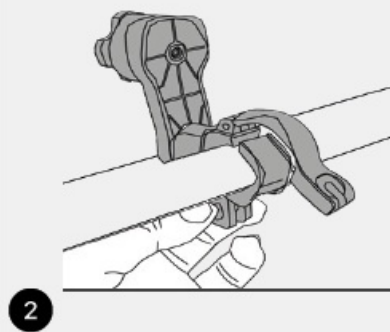

Screw and tighten

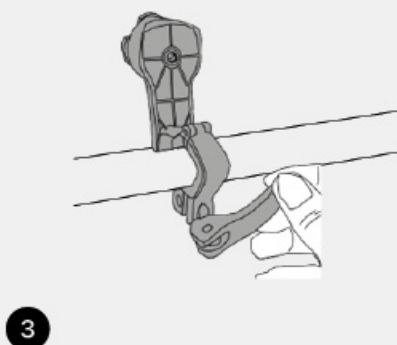

Lock

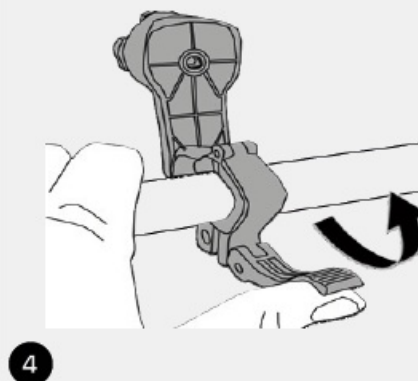

*Mount adjustment: Unscrew
Rotate and screw*

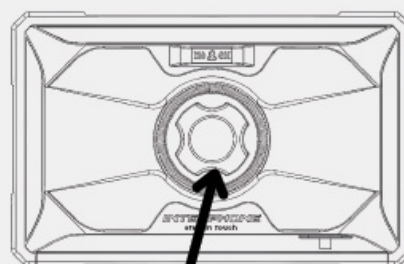
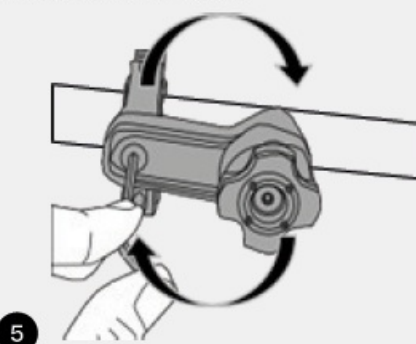

Quiklox mount-system

To lock: insert, push and rotate 45 degrees CW or CCW to lock

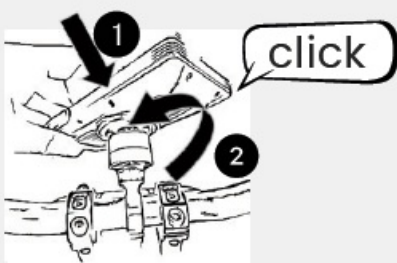

To release: push and rotate 45 degrees CW or CCW to remove device from mount

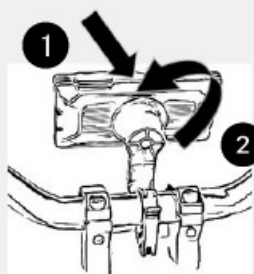

Wiring to motorcycle 12V power supply

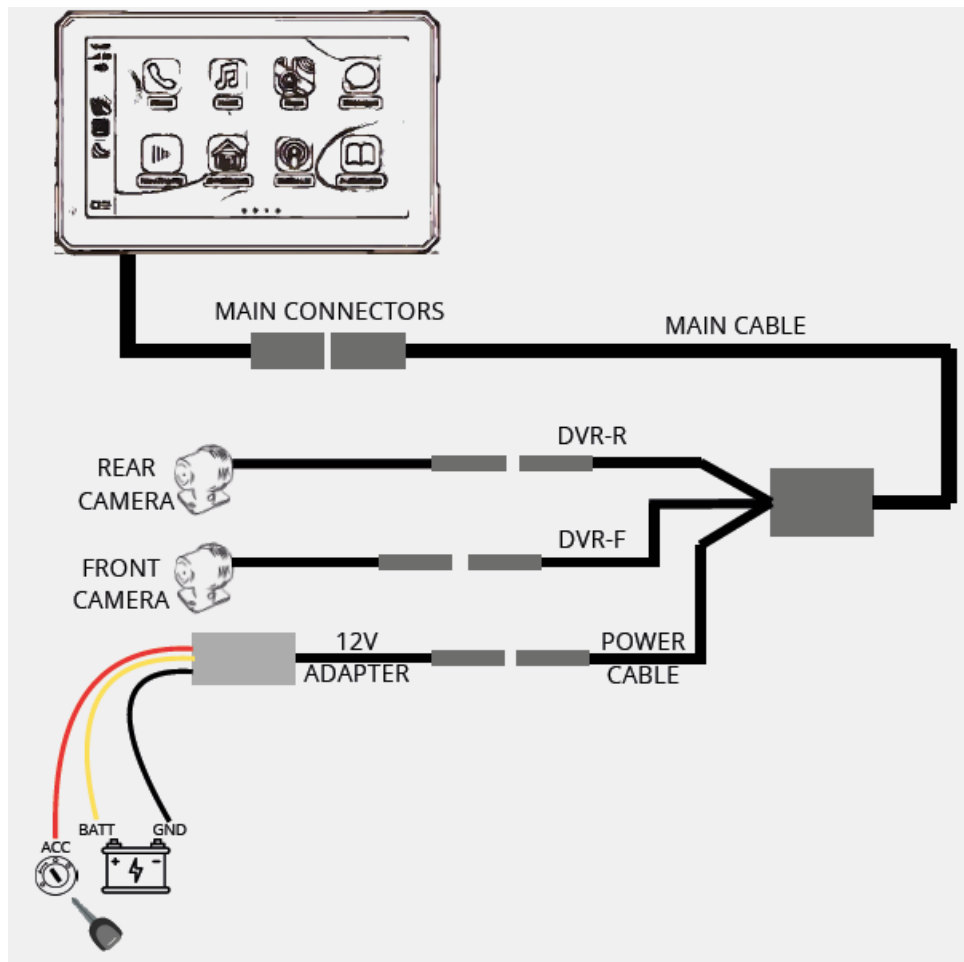

- Yellow Wire (BATT): Connect to a permanent +12V power source, such as the positive terminal of the motorcycle battery (+).
- Black Wire (GND): Connect to a ground point on the motorcycle frame or directly to the negative terminal of the battery (-).
- Red Wire (ACC): Connect to a switched +12V source, which is active only when the motorcycle key is in the ACC position or when the dashboard is on.

Wiring to USB power supply

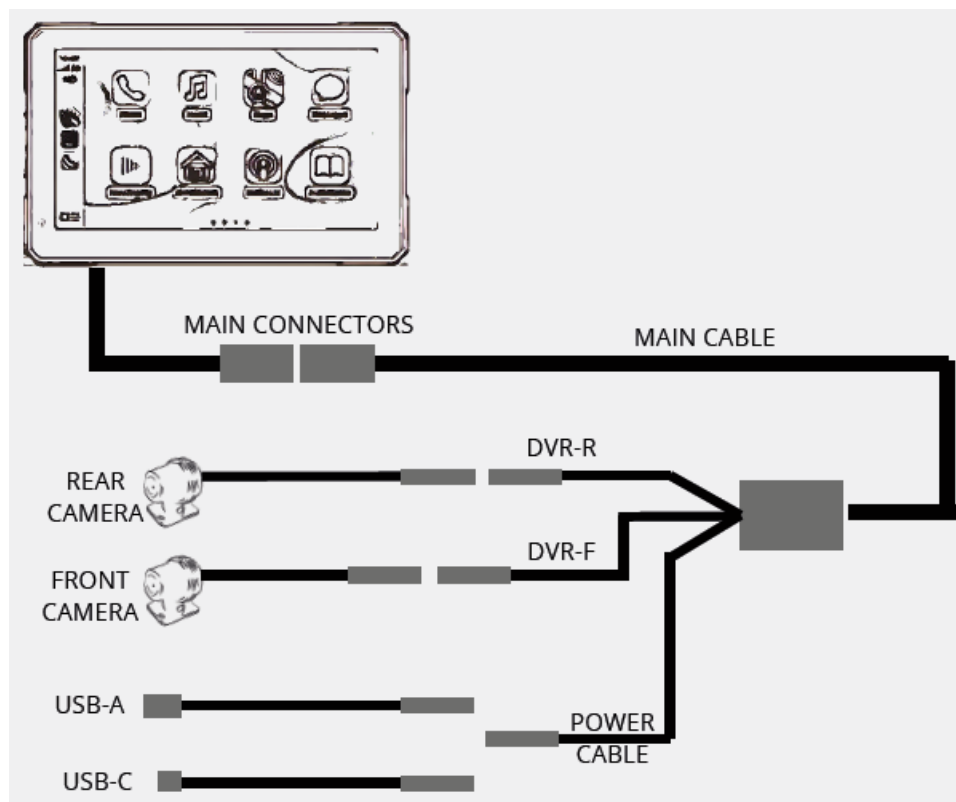

- Use the provided USB cable to power the device from the USB-A or USB-C power socket. (!) Use only a 2,5A / 12,5W power source for optimal performance. Lower power source may cause malfunctions.

Cameras installation

- Install the front and rear cameras on the motorcycle's head and tail using the provided pre-cut adhesive or screws.
- Choose a position free from obstacles that could block the view and ensure the lenses are well protected.

Camera adjustment

1. Loosen the screw&nut at the base of the camera
2. Rotate CW/CCW and UP/DOWN to get the correct view angle
3. Tighten the screw&nut at the base of the camera



SD Card Installation

- Remove the TF card cover, insert the card, place back the cover, and secure it with three screws.
- Ensure the snap-on cover is oriented correctly. Use a U3-class memory card (32GB–256GB) from reputable

brands for optimal performance. Other cards may cause malfunctions.

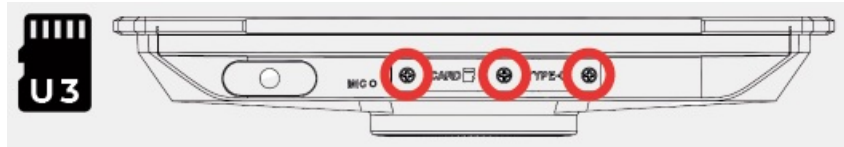

TPMS sensors installation

1. Remove the valve cap.
2. Clean the valve stem.
3. Insert the TPMS bolt.
4. Screw the sensor on valve. Tighten it gently and ensure no air is leaking.
5. Lock the sensor with the locking nut.
6. Test for leaks with soapy water—no bubbles should appear.

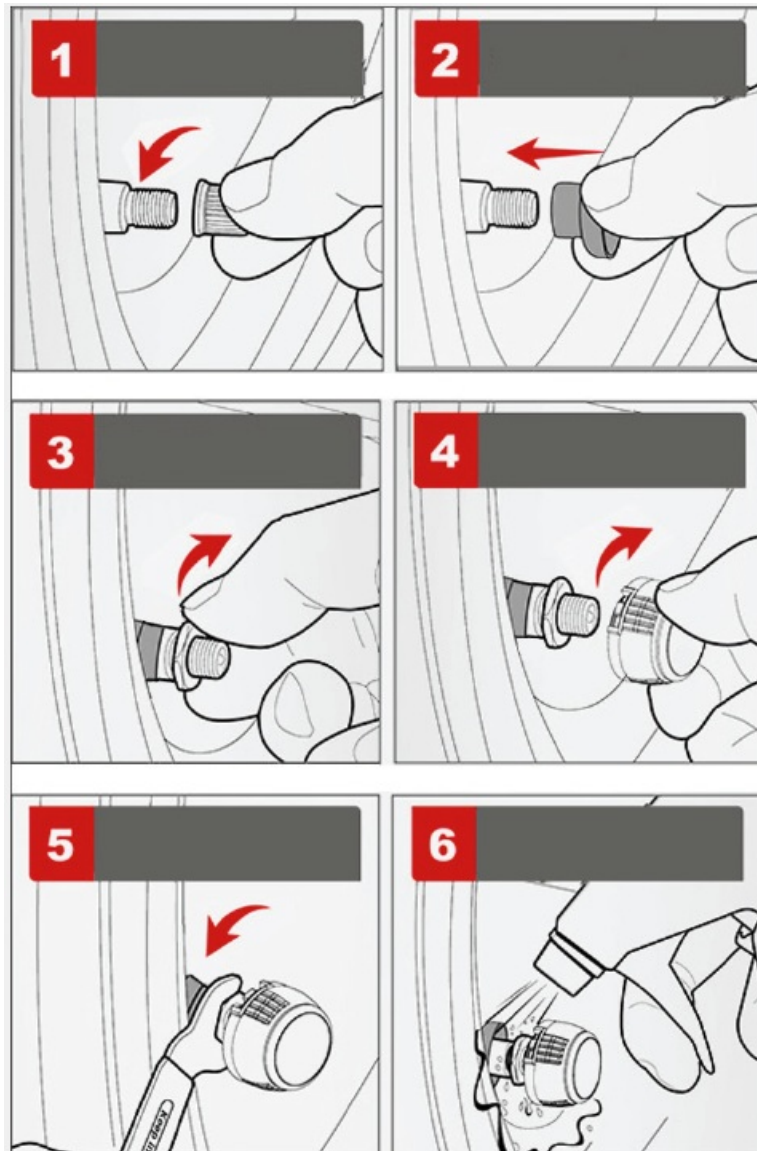

- The sensor uses CR1632 batteries. The cover is screwed on, and to replace the batteries, simply unscrew the cover.

Usage

Home screen



1. Carplay/Android auto: tap on first time for phone pairing, then tap to access to carplay/andorid auto screen
2. Dash camera: tap to access DVR recording screen and settings
3. Setting screen menu: tap to access device's settings
4. Odometer: tap to access the odometer screen, long tap to reset the odometer
5. Tire pressure: tap to access TPMS screen & settings
6. Compass
7. GPS signal status
8. Dashcam microphone status
9. Clock

Odometer screen

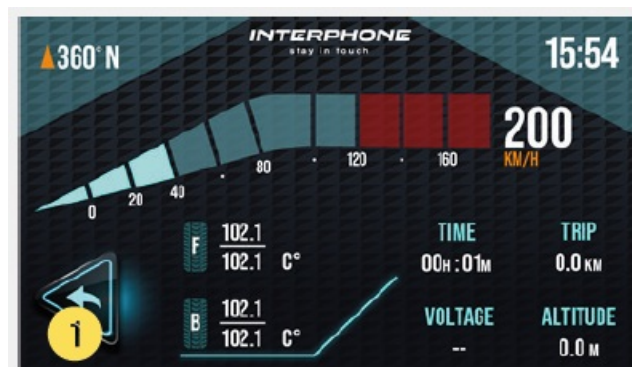

1. **Back:** tap to go back to the Home screen

Note: the odometer on SYNC70 is a total (not partial) odometer.
To reset it, it's necessary to do a long tap on the odometer on the main screen.

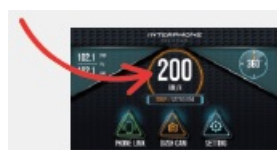

Carplay & Android Auto

First Use

Sync70 needs to be paired with your smartphone only during the initial setup.

To proceed with pairing, after connecting Sync70 to power and enabling Bluetooth and Wi-Fi functions on your smartphone, press the “Carplay” icon for Apple smartphones or “Android Auto” for Android smartphones as illustrated on the screen. On the next screen, follow the prescribed instructions.



- Tap on the circle spot to activate the Shortcut Menu

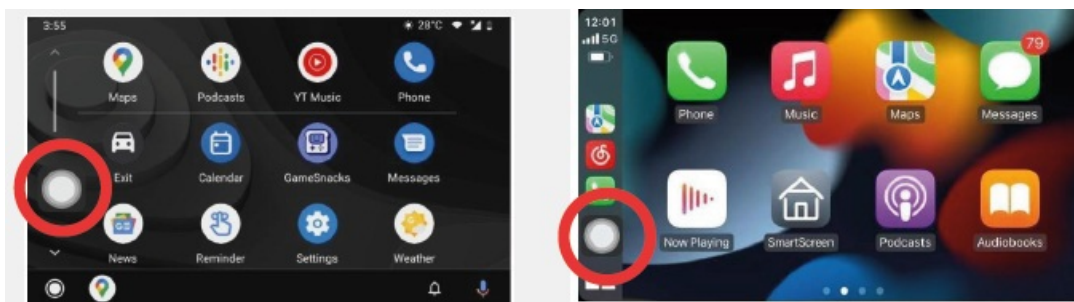

Dash cam

- When there is a card inserted, the system automatically enters the recording mode, and when recording, the red circle in the [Dashcam] button will be displayed

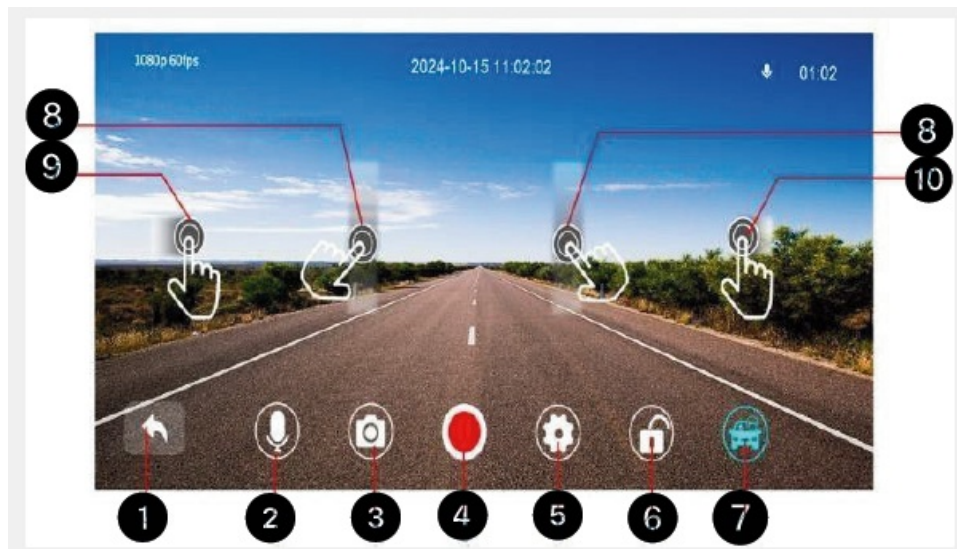

1. Tap to return to the main screen.
2. Tap to turn on or off the recording of environmental sound.
3. Tap to take a picture with one click.
4. Tap to start recording. Tap again to close the recording.
5. Tap to enter the settings menu.
6. Tap to lock the video with one click, footage will be saved to the “emergency” folder.
7. Tap for the rear camera BSD function (only supports 2K). Long press to activate the BSD detection area setting.
8. Swipe up and down to adjust the brightness.
9. Swipe left to switch between front and back recording.
10. Swipe right to enter the playback interface.

Video playback

- Tap on “ordinary video” folders to review standard footage.
- Tap on “emergency video” folders to review footage recorded when the video lock feature was active.

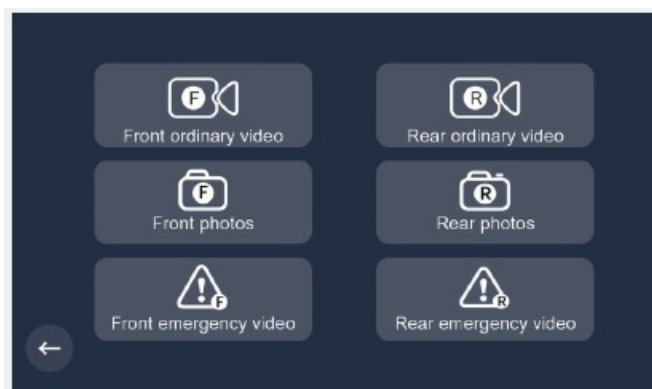

Video download

You can replay your dash cam footage directly on your smartphone by installing the “Viidure” app and pairing it with the SYNC70 device. Scan the QR code or search for it in your smartphone app store to download it. To perform the pairing, search for the Wifi name SYNC70XXXX (XXXX is a progressive serial number) use WiFi password: 88888888. Tip: Turn off VPN in case of connection issues.





- As an alternative solution, remove the SD card from the SYNC70 and download the video files to a computer using an SD card reader.

BSD detection and warning function

- BSD (Blind Spot Detection) is a safety system that alerts the rider to vehicles in blind spots, using visual indicators on the SYNC70 display. When BSD is on, visual indicators will appear in every screen.
- **Warning:**** Our technology uses the rear camera to perform this feature, which may generate unwanted warnings in environments with parked cars or pedestrians walking along the road.
- Tap the icon  to open the BSD detection and warning function.
- Long tap on it to open the detection area range wireframe, as shown in picture below. Slide the arrows to adjust the detection range.
- The “red box area” is to detect rear vehicles, and the two sides of the “yellow box area” is to detect the left and right rear vehicles.



TPMS

- Tap  and wait for the front (F) tire pressure icon to flash. Insert the tire pressure sensor into the front wheel. Once paired, the F icon will display the pressure value.
- Repeat same procedure for rear wheel; tap  and wait for the rear (R) tire pressure icon to flash. Insert the sensor into the rear wheel. Once both values are displayed, the pairing is complete.
- To remove the tire pressure data, tap on  it again after successful pairing.

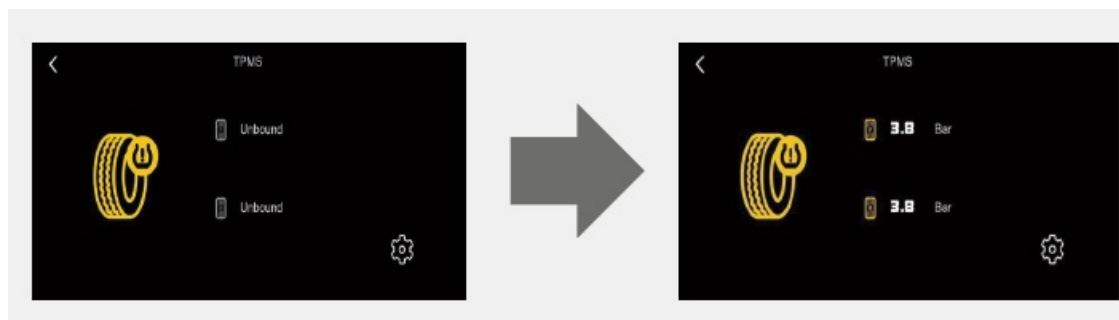

Abnormal pressure warning

- A warning pop-up will appear if the tire pressure is abnormal.

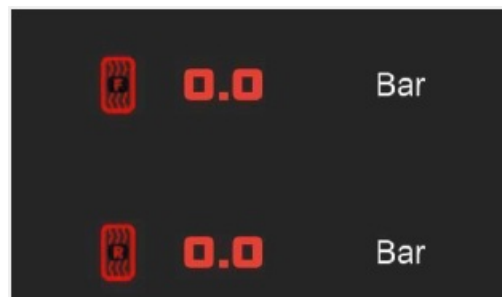

Pressure warning setup

Tap on settings icon at bottom right of TPMS screen. In the settings menu, tap the front and rear tire icons to set your desired warning pressure, and unit to select between PSI/BAR.

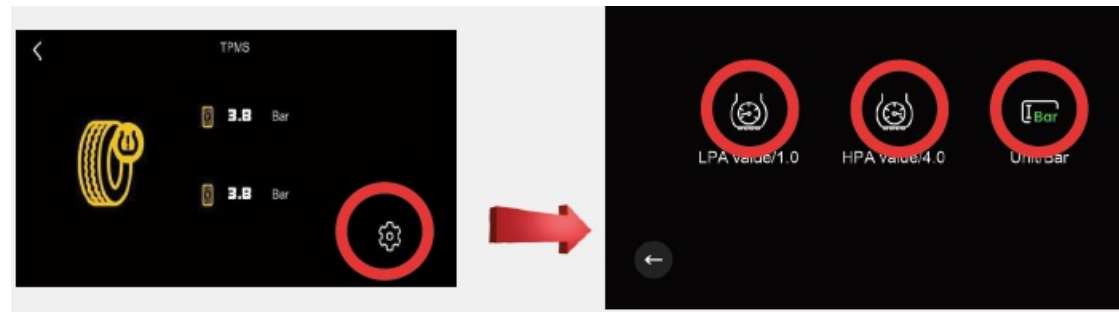

Settings

1. General system setting
2. Video settings
3. Brightness settings
4. Sound settings (not used in this version)
5. Video download app instructions
6. Format SD card
7. Restore factory settings
8. Check installed firmware version

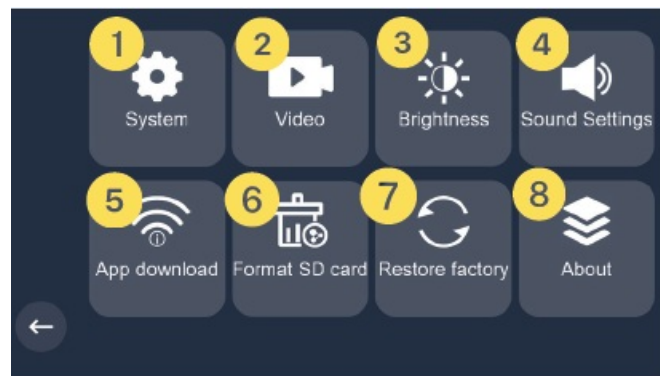

System settings



1. Switch on/off blind spot detection warning
2. Switch on/off the Floating button to quick access shortcut menu
3. Toggling between full screen/split screen visualization mode
4. Set time zone
5. Set speed unit
6. Set screen sleep time (10"/30"/60"/OFF)
7. Check available space on SD Card
8. Set language
9. Set date & time
10. Check the GPS status

FAQ

- **Q: Does the device support Bluetooth headsets or intercoms?**
 - **A:** No, this device does not support Bluetooth headsets or intercoms. Connect your mobile phone directly to a Bluetooth headset for concurrent use.
- **Q: Can the touchscreen work with gloves or in rainy conditions?**
 - **A:** The touchscreen may not work with gloves or rain. It is recommended to operate the device with caution in such conditions.

Documents / Resources

	<p>INTERPHONE SYNC70 Essential Smart Display [pdf] User Manual SYNC70 Essential Smart Display, SYNC70, Essential Smart Display, Smart Display</p>
--	---

References

-  [Declaration of conformity | Cellularline Site WW](#)
-  [INTERPHONE](#)
- [User Manual](#)

Manuals+. [Privacy Policy](#)

This website is an independent publication and is neither affiliated with nor endorsed by any of the trademark owners. The "Bluetooth®" word mark and logos are registered trademarks owned by Bluetooth SIG, Inc. The "Wi-Fi®" word mark and logos are registered trademarks owned by the Wi-Fi Alliance. Any use of these marks on this website does not imply any affiliation with or endorsement.