



INTERPHONE RIDESYNC Car Play and Android Auto User Manual

[Home](#) » [Interphone](#) » INTERPHONE RIDESYNC Car Play and Android Auto User Manual 

INTERPHONE RIDESYNC Car Play and Android Auto User Manual

INTERPHONE

stay in touch



| USER MANUAL |

Important Safety Notices and Warnings

Important! Read before use!

Failure to observe or partially observe the instructions and warnings may result in death or serious injury. Improper configuration or use of the device may increase the risk of death, serious injury, or damage to the device. Use with caution. As a user, it is your responsibility to exercise judgment and pay attention when using this device. Do not distract yourself by interacting with this device while driving. Minimize the time spent looking at the device while driving. As a user, you are responsible for complying with regulations that limit or prohibit the use of cell phones or other electronic devices (e.g., the requirement to use hands-free options for making calls while driving). Always obey applicable laws and traffic signs. Cellularline is not responsible for any fines resulting from non-compliance with applicable regulations and provisions.

Correct mounting

Do not mount the device in a way that obstructs the view of the road or the vehicle's control capabilities. Do not place the device in an area that may obstruct any vehicle safety function.

Use of audio systems (Intercoms)

Ridesync does not provide connection to a Bluetooth headset or intercom. It is recommended to use your mobile phone's connection directly to the Bluetooth headset, concurrently with the use of Ridesync.

Water resistance

IPX6 level waterproofing if stored, used, and mounted correctly. Do not immerse in water.

User instructions:

Interphone Ridesync is a smartphone display mirroring device, meaning it replicates the display and use of apps compatible with Apple CarPlay and Android Auto technology. Interphone Ridesync is not a satellite navigator, standalone music player, or instrumentation (speedometer or tachometer). The Ridesync screen is capacitive touchscreen: it may not work with motorcycle gloves, and raindrops may trigger commands. Do not open the device under any circumstances. Such an operation can be dangerous and voids the warranty. Only dry or clean the device screen with a soft cloth. Do not use liquid detergents.

Technical Specifications:

CE Declaration of Conformity: Cellularline S.p.A., declares that this device complies with Directive 2014/53/EU.

The full text of the EU declaration of conformity is available at the following address:

www.cellularline.com/_/declaration-of-conformity . Cellularline S.p.A., also declares that this device complies with the 2011/65/EU updated from 2015/863/EU.

Product: INTERPHORIDESYNC	Model: RIDESYNC	Operating temperature: - 20~70°C	Dimensions mm: 85mm X 49mm X 25mm	Power supply: 5V DC - 2,5A	Weight: 182g
Bluetooth® v. 4.0 - Class 2	Frequency Bluetooth: 2.402 – 2.480GHz	Power Bluetooth: 20dBm	Frequency WIFI : 4G (2400MHz ~ 2500MHz) / 5G (5150mhz~5250mhz)	Power: Wi-Fi 15 dBm	



WEEE: The crossed-out wheel bin symbol on the product, literature, or packaging reminds you that all electrical and electronic products, batteries, and accumulators must be taken to separate collection at the end of their working life. This requirement applies to the European Union and other locations where separate collection systems are available. To prevent possible harm to the environment or human health from uncontrolled waste disposal, please do not dispose of these products as unsorted municipal waste, but hand it in at an official collection point for recycling.

Triman Logo

Handlebar Mount Installation

1. Apply the chosen spacer on the handlebar

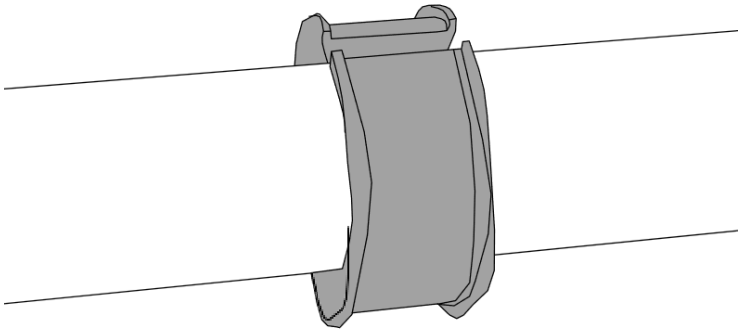

2. Install the mount

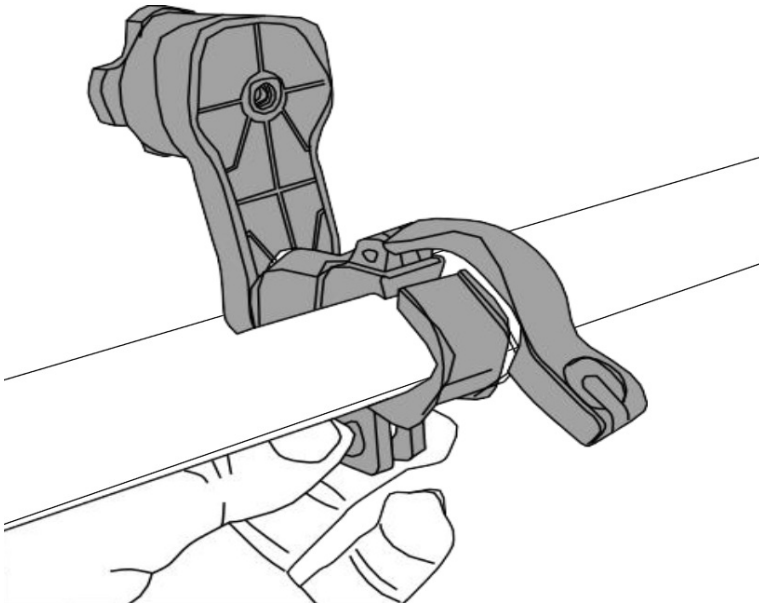

3. Screw and tighten

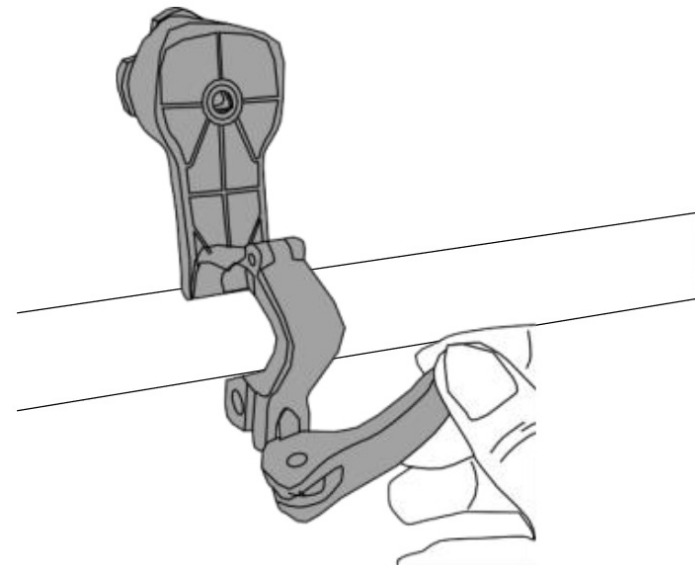

4. Lock

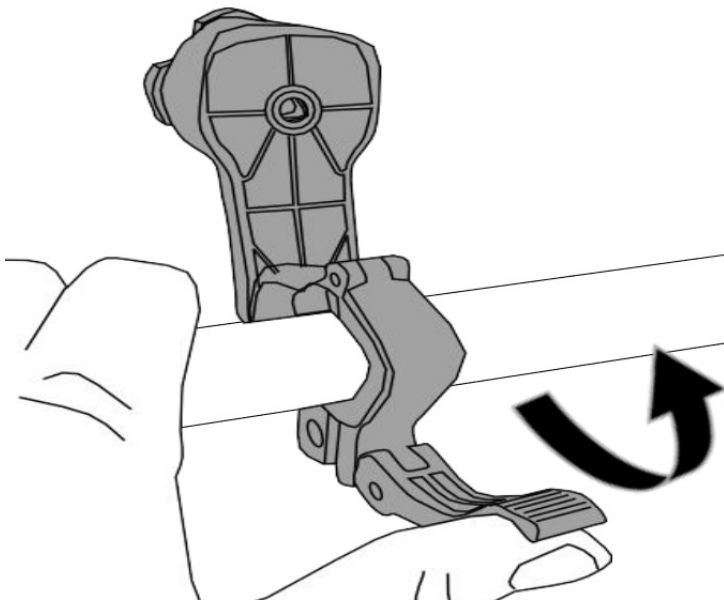

Mount adjustment

Unscrew Rotate and screw

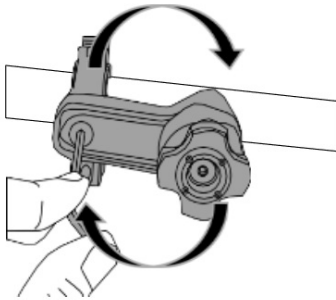

Insert, push and rotate 45 degrees to lock

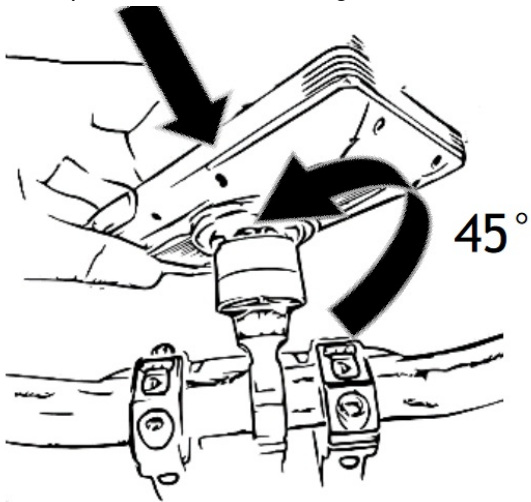

Push and rotate 45 degrees to unlock

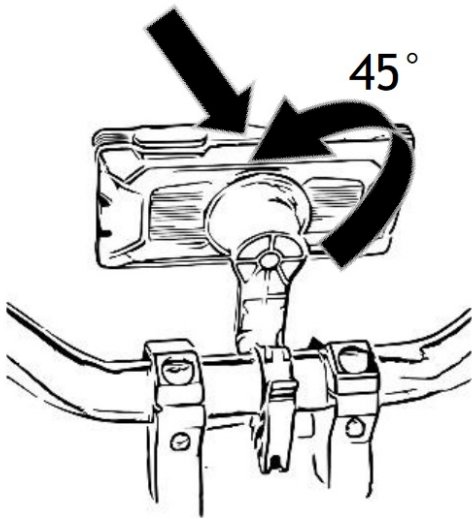

Note:

Ridesync can be used with all mounts in the Interphone Quiklox range, providing various additional mounting opportunities, including handlebar clamp, super sport motorcycle handlebar stem, rearview mirror or handlebar crossbar, brake fluid reservoir, car vent or windshield mount, etc. Visit the website www.interphone.com for more information.

Power

Ridesync can be powered in two ways:

1. By connecting the power cable with a 12V adapter directly to the motorcycle. Connect the Yellow “B+” cable to the positive battery terminal, the Red “ACC” cable to the key switched power, and the Black “GND” cable to the negative battery terminal. It is recommended to perform the wiring installation only by experienced personnel for safety reasons.
2. By connecting the provided USB cable to a USB-A port (in a motorcycle or a car). The provided cable maintains waterproof characteristics. **Note:** the device cannot be powered using a USB-C/USB-C cable but only with a USB- C/USB-A type cable.



First Use

Ridesync needs to be paired with your smartphone only during the initial setup. To proceed with pairing, after connecting Ridesync to power and enabling Bluetooth and Wi-Fi functions on your smartphone, press the “Carplay” icon for Apple smartphones or “Android Auto” for Android smartphones as illustrated on the screen.

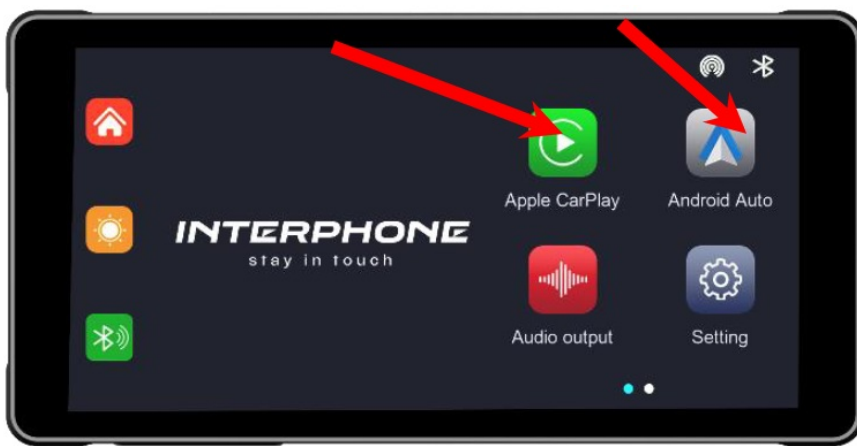

On the next screen, follow the prescribed instructions.

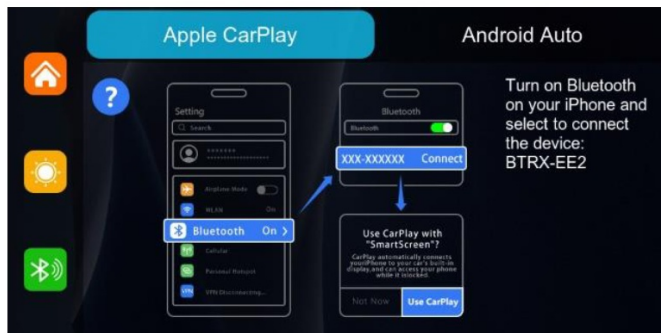

Usage

Once paired, upon each power-up, after a short moment, Ridesync will display the HOME screen of your smartphone. Refer to your phone's manual for detailed instructions on how to operate the Carplay / Android Auto system.

When the phone is not connected and therefore the HOME screen of the phone itself is not visible, the Ridesync startup screen will be displayed, from which you can:

- **initiate** the Carplay/Android Auto connection.
- **adjust** the brightness (which can be automatic or manually set).
- **view** the recommended audio device connection diagram.
- **modify** settings (change language, reset pairings, etc.).



This menu can be disabled from the settings by selecting the appropriate function..

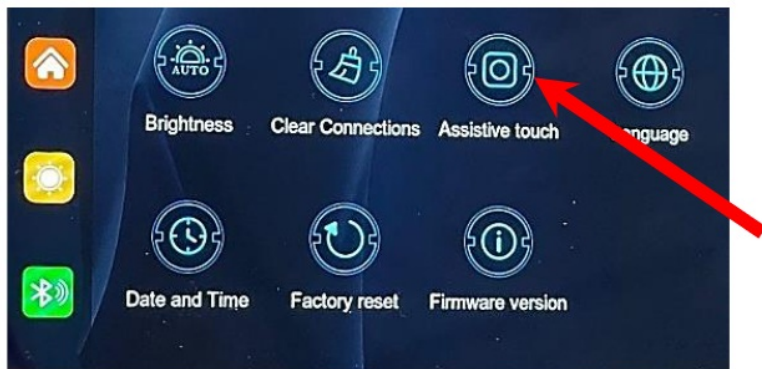

Contents

- 1 Documents / Resources
- 1.1 References

Documents / Resources

 <p>INTERPHONE stay in touch</p> <p>MANUALE UTENTE USER MANUAL GUIDE DE L'UTILISATEUR GUÍA DE USUARIO BEDIENUNGSANLEITUNG</p>	<p>INTERPHONE RIDESYNC Car Play and Android Auto [pdf] User Manual RIDESYNC Car Play and Android Auto, RIDESYNC, Car Play and Android Auto, Android Auto</p>
---	--

References

- [Cellularline IT | Homepage](#)
- [Declaration of conformity | Cellularline Site WW](#)
- [INTERPHONE](#)
- [INTERPHONE](#)
- [User Manual](#)

[Manuals+.](#) [Privacy Policy](#)

This website is an independent publication and is neither affiliated with nor endorsed by any of the trademark owners. The "Bluetooth®" word mark and logos are registered trademarks owned by Bluetooth SIG, Inc. The "Wi-Fi®" word mark and logos are registered trademarks owned by the Wi-Fi Alliance. Any use of these marks on this website does not imply any affiliation with or endorsement.