



INTERMATIC STW700W Standard Smart Programmable Timer User Guide

[Home](#) » [Intermatic](#) » INTERMATIC STW700W Standard Smart Programmable Timer User Guide 



STW700W Standard Smart Programmable Timer User Guide



Libertyville, Illinois 60048

www.intermatic.com

Ascend™

Quick Installation and Setup Guide

See the back page for details on accessing the comprehensive Timer manual.

Contents

1 COMPLIANCE

2 WARNINGS/SAFETY

3 SINGLE-POLE WIRING

4 TYPICAL THREE-WAY WIRING

5 WARRANTY

6 PRODUCT OVERVIEW

7 INITIAL SETUP OF A TIMER

8 Documents / Resources

8.1 References

9 Related Posts

COMPLIANCE

Operation is subject to the following two conditions: (1) this device may not cause harmful interference, and (2) this device must accept any interference received, including interference that may cause undesired operation.

FCC NOTE: The manufacturer is not responsible for any radio or TV interference caused by unauthorized modifications to this equipment. Such modifications could void the user's authority to operate the equipment.

NOTE: This equipment has been tested and found to comply with the limits for a Class B digital device, pursuant to Part 15 of the FCC Rules. These limits are designed to provide reasonable protection against harmful interference in a residential installation. This equipment generates, uses, and can radiate radio frequency energy and, if not installed and used in accordance with the instructions may cause harmful interference to radio communications. However, there is no guarantee that interference will not occur in a particular installation. If this equipment does cause harmful interference to radio or television reception, which can be determined by turning the equipment off and on, the user is encouraged to try to correct the interference by one or more of the following measures:

- Reorient or relocate the receiving antenna.
- Increase the separation between the equipment and receiver.
- Connect the equipment into an outlet on a circuit different from that to which the receiver is connected.
- Consult the dealer or an experienced radio/TV technician for help.

Important note: To comply with the FCC RF exposure compliance requirements, no change to the antenna or the device is permitted. Any change to the antenna or the device could result in the device exceeding the RF exposure requirements and void user's authority to operate the device.

This Class B digital apparatus complies with ICES-005 of Canada.

WARNINGS/SAFETY



WARNING

Risk of Fire or Electric Shock

- Disconnect power at the circuit breaker(s) or disconnect switch(es) before installing or servicing.

- Installation and/or wiring must be in accordance with national and local electrical code requirements.
- Only use copper conductors rated 105°C minimum.
- The battery is not user replaceable.
- Do NOT use timers to control devices that could have dangerous consequences due to inaccurate timing, such as sun lamps, saunas, heaters, and slow cookers.

NOTICE

Dispose of product per local regulations on the disposal of lithium batteries.

Ratings¹

Operating Voltage	120 VAC, 50/60 Hz
General Purpose	15 A
Inductive Ballast	15 A
Tungsten/Incandescent	8:00 AM
Electronic Ballast/LED Driver	5:00 AM
LED Load	600 W
Motor Load	1 HP
Dimensions	2 3/4" H x 1 3/4" W x 1 1/3" D

¹Type 1. C Action Operating Control, Pollution Degree 2, Impulse Voltage 2500 V

SINGLE-POLE WIRING

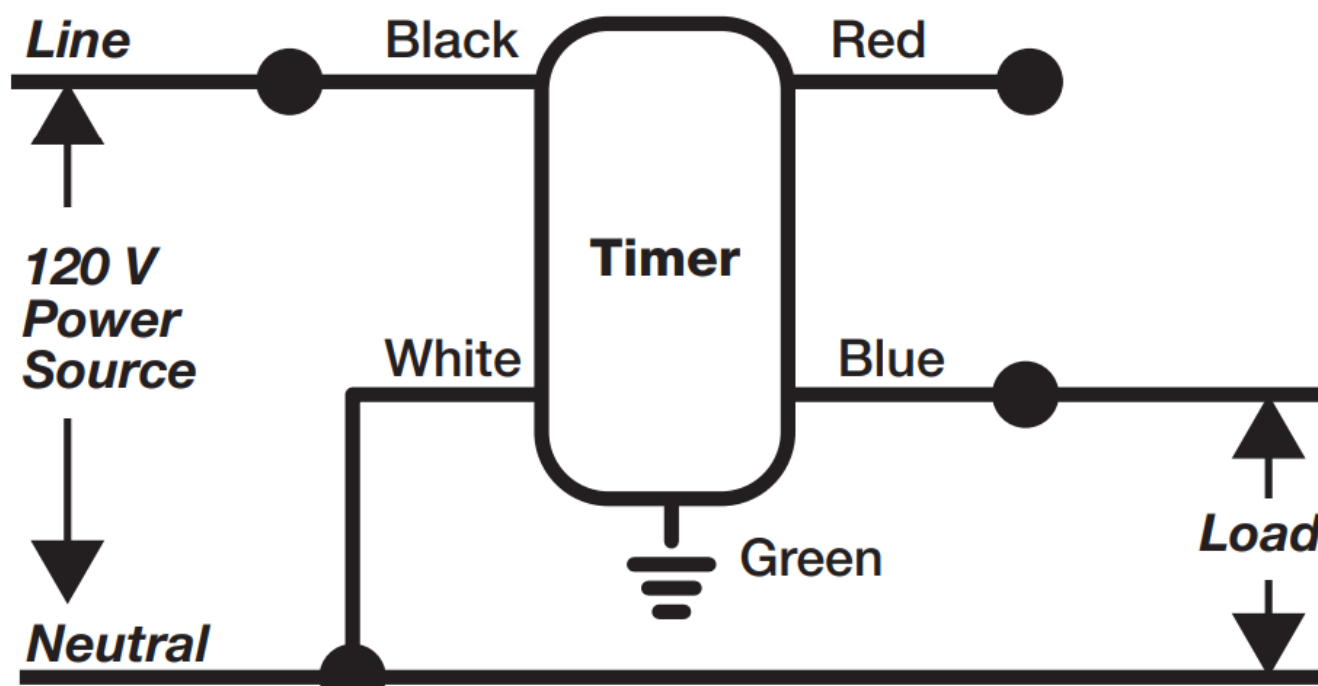

Wire	Description
Blue	Connects to black wire from Load
White	Connects to white (neutral) wire from Load and Power Source
Black	Connects to black (hot) wire from Power Source
Green	Connects to ground
Red	Not used in single-pole installations

Note: To be installed in single- and double-gang with 2-1/2" minimum depth. Please consult a qualified electrician for specific wiring details.

TYPICAL THREE-WAY WIRING

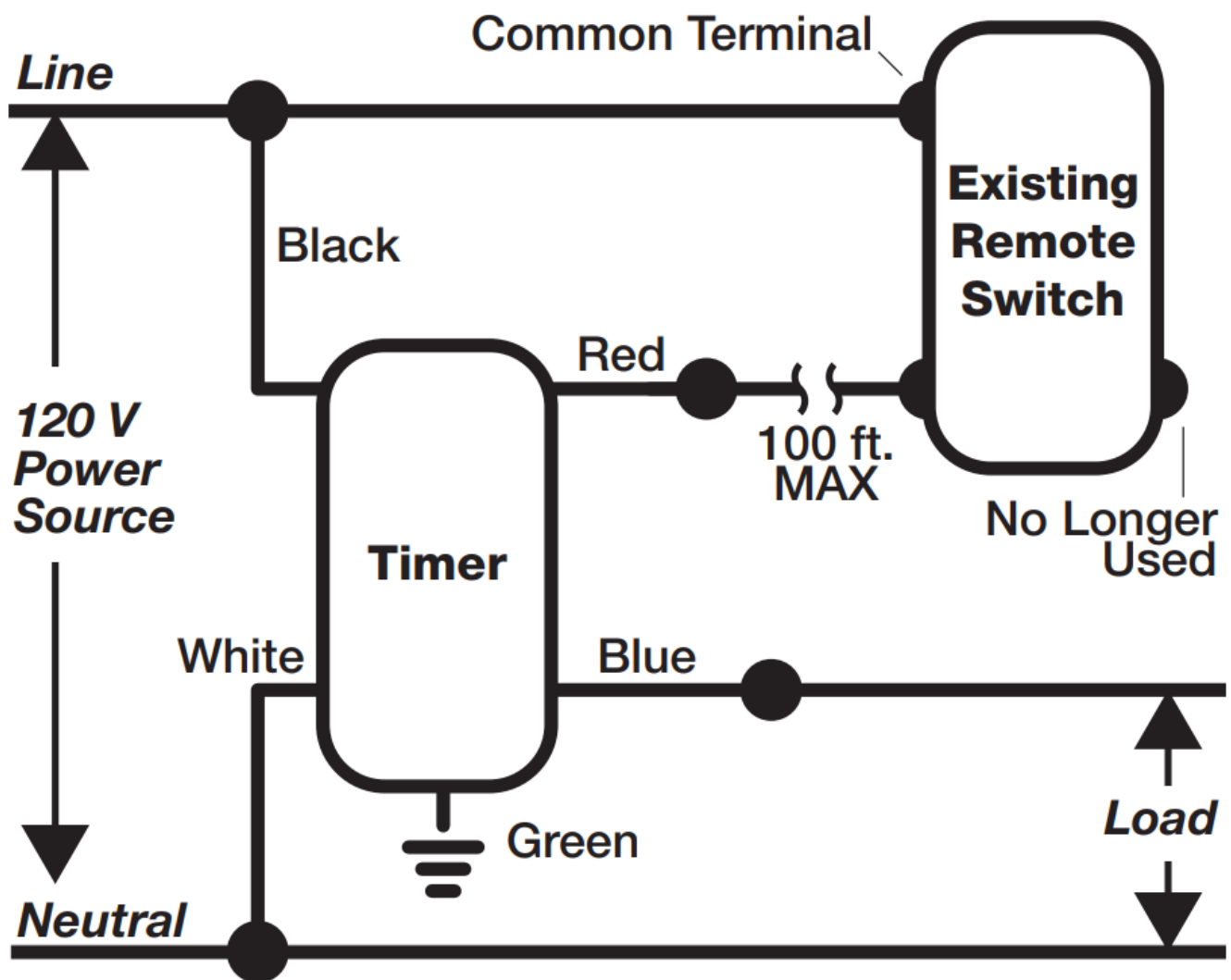

Wire	Description
Blue	Connects to black wire from Load
White	Connects to white (neutral) wire from Load and Power Source
Black	Connects to black (hot) wire from Power Source
Green	Connects to ground
Red	Not used in single-pole installations

Note: For other three-way wiring scenarios, go to [www.Intermatic.com/Ascend](http://www.intermatic.com/Ascend).

WARRANTY

LIMITED WARRANTY

Warranty service is available by either (a) returning the product to the dealer from whom the unit was purchased or (b) completing a warranty claim online at www.intermatic.com. This warranty is made by: Intermatic Incorporated, Customer Service 1950 Innovation Way, Suite 300, Libertyville, IL 60048. For warranty service go to: [http://www.Intermatic.com](http://www.intermatic.com) or call 815-675-7000. For complete information on Intermatic products, literature, and Contractors Guides visit www.intermatic.com.

PRODUCT OVERVIEW

The Ascend 7-Day Timer portfolio consists of two timer models: ST700W Standard and STW700W Wi-Fi enabled. In addition to the intuitive control interface common to both models, the Wi-Fi-enabled Timer offers a mobile app for access to a quick setup feature, and the ability to save schedules for easy transfer to other Ascend Wi-Fi-enabled timers, and convenient monitoring from compatible Apple or Android mobile devices.

Access Point Mode

- Creates a peer-to-peer communication network between the Timer and your mobile device to offer a direct connection for initial setup and scheduling.
- Access Point range is approximately 100'.

Wi-Fi Mode (Local)

- Connects the Timer to your local wireless network.
- Provides the benefit of constant connection with every Timer on your network, when using the App.

Remote Access (Cloud)

- Establishing an Intermatic Connect Account and registering a Timer(s) with your account, enables access from anywhere you have an active Wi-Fi or cellular connection.

Voice Integration

- Works with Alexa compatibility. Through the Alexa app, enable Intermatic – Home Skills and Intermatic – Custom Skills.

- Works with Alexa, for ON/OFF, mode changes, and status updates.
- Works with Google Assistant. Through the Google Home app, turn your Ascend device ON/OFF or change modes: Random (Swing), Auto and Manual.

Setup Instructions

ST700W:

- Go to the Initial Setup at Timer section for instructions.

STW700W:

- Go to the Initial Setup at Timer section for instructions.
- Go to the Apple Store or Google Play Store and download the ASCEND 7-Day Timer App for initial setup.

INITIAL SETUP OF A TIMER

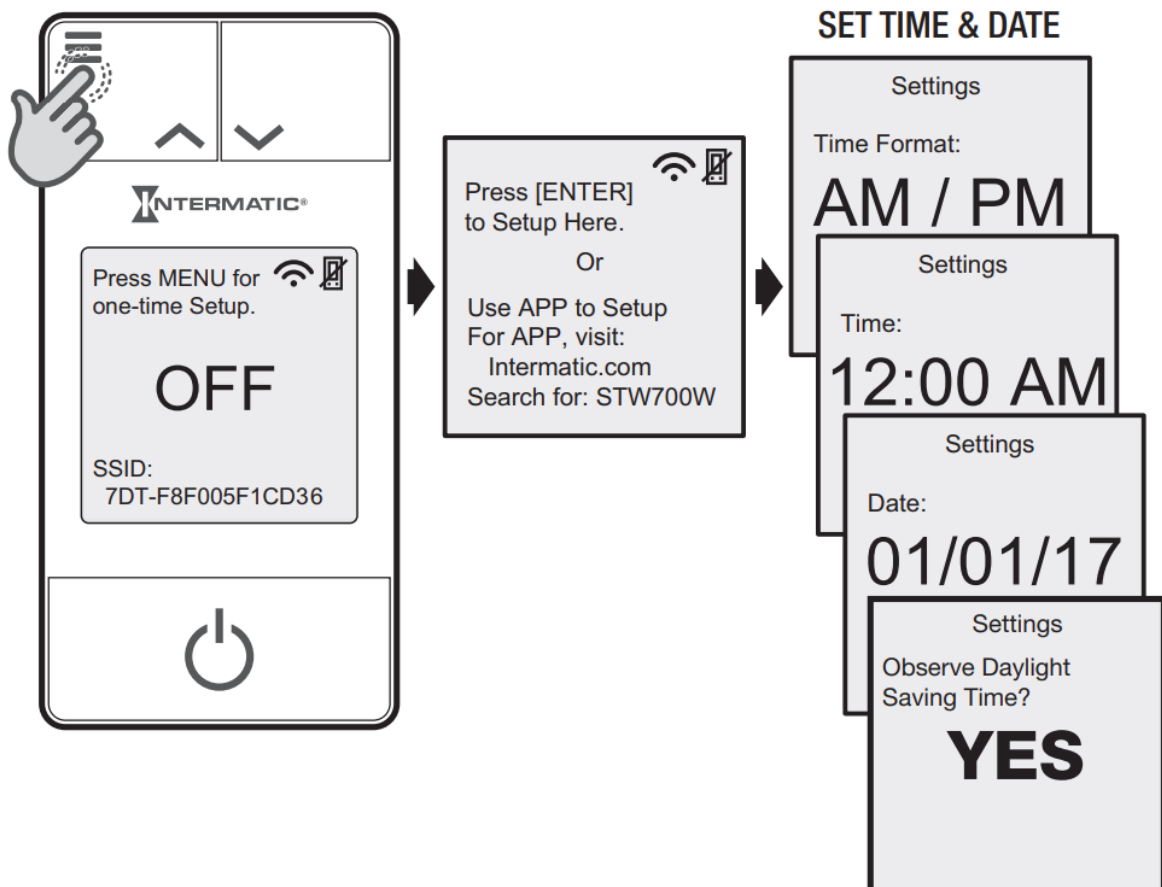

1. Scroll UP/DOWN to desired option on the menu screen
2. Option blinks when selected
3. Press ENTER to confirm and move to the next menu

Note:

- The App setup option is only applicable to the STW700W Wi-Fi-enabled model. Press ENTER to begin setup for the ST700W standard model.
- You must complete all screens before returning to the Timer interface screen.

- Refer to the comprehensive user guide on Intermatic.com for descriptions of Schedule Templates.
- Refer to the Latitude/Longitude estimation chart on pages 26 and 27.

- The SSID  *and*  icons are not available for the ST700W.

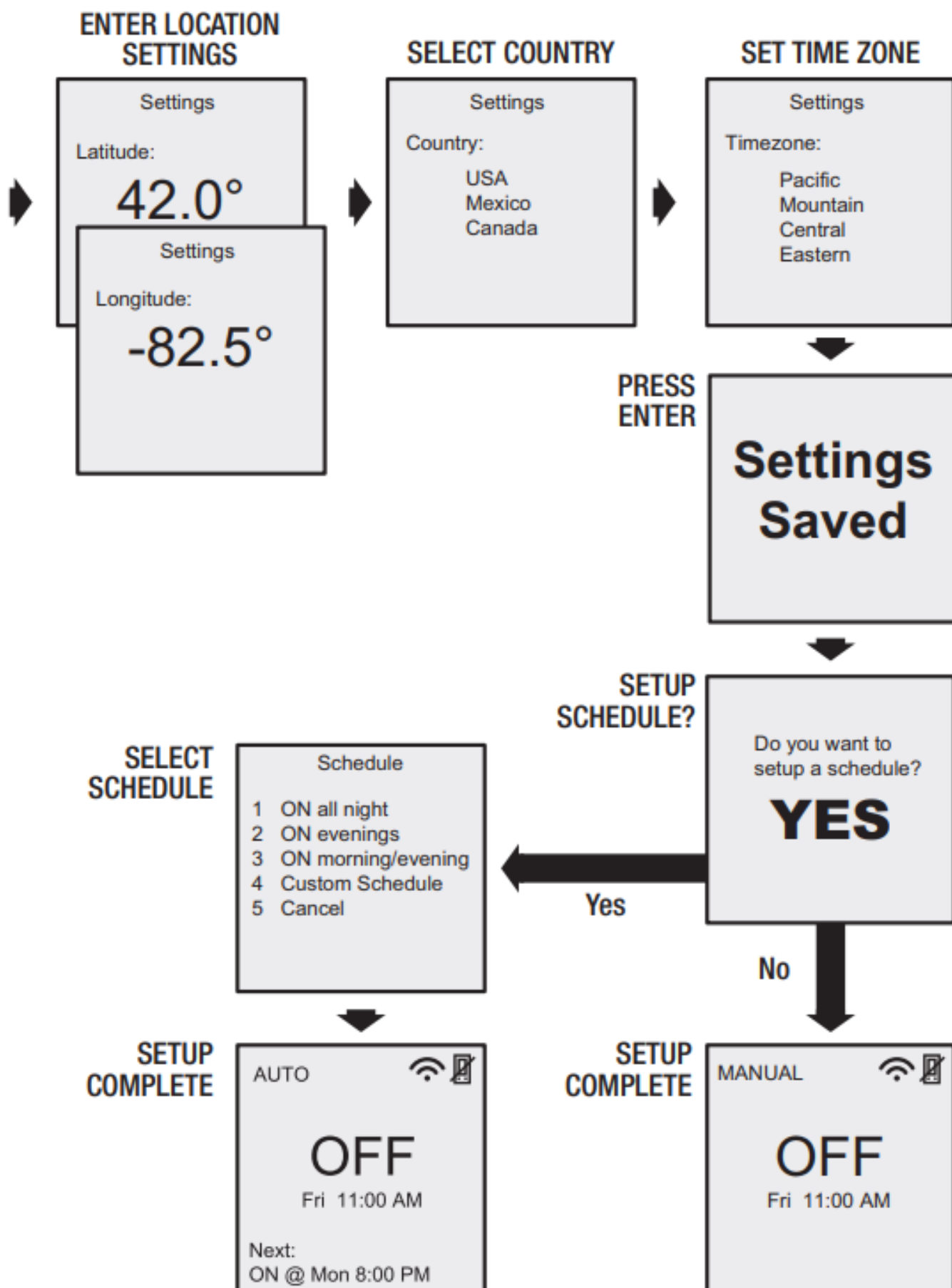

LONGITUDE

Major United States Cities

City	Lat. n°	Long. w°	City	Lat. n°	Long. w°
Albany, NY	43	-74	Fresno, CA	37	-120
Albuquerque, NM	35	-107	Grand Rapids, MI	43	-86
Amarillo, TX	35	-102	Helena, MT	47	-112
Anchorage, AK	61	-150	Honolulu, HI	21	-158
Atlanta, GA	34	-84	Hot Springs, AR	35	-93
Austin, TX	30	-98	Houston, TX	30	-95
Baker, OR	45	-118	ID Falls, ID	44	-112
Baltimore, MD	39	-77	Indianapolis, IN	40	-86
Bangor, ME	45	-69	Jackson, MS	32	-90
Birmingham, AL	34	-87	Jacksonville, FL	30	-82
Bismarck, ND	47	-101	Juneau, AK	58	-134
Boise, ID	44	-116	Kansas City, MO	39	-95
Boston, MA	42	-71	Key West, FL	25	-82
Buffalo, NY	43	-79	Klamath Falls, OR	42	-122
Carlsbad, NM	32	-104	Knoxville, TN	36	-84
Charleston, WV	38	-82	Las Vegas, NV	36	-115
Charlotte, NC	35	-81	Los Angeles, CA	34	-118
Cheyenne, WY	41	-105	Louisville, KY	38	-86
Chicago, IL	42	-88	Manchester, NH	43	-72
Cincinnati, OH	39	-85	Memphis, TN	35	-90
Cleveland, OH	41	-82	Miami, FL	26	-80
Columbia, SC	34	-81	Milwaukee, WI	43	-88
Columbus, OH	40	-83	Minneapolis, MN	45	-93
Dallas, TX	33	-97	Mobile, AL	31	-88
Denver, CO	40	-105	Montgomery, AL	32	-86
Des Moines, IA	42	-94	Montpelier, VT	44	-73
Detroit, MI	42	-83	Nashville, TN	36	-87
Dubuque, IA	43	-91	New Haven, CT	41	-73
Duluth, MN	47	-92	New Orleans, LA	30	-90

El Paso, TX	32	-106	New York, NY	41	-74
Eugene, OR	44	-123	Nome, AK	64	-166
Fargo, ND	47	-97	Oklahoma City, OK	35	-97
Flagstaff, AZ	35	-112	Philadelphia, PA	40	-75

City	Lat. n°	Long. w°
Phoenix, AZ	33	-112
Pierre, SD	44	-100
Pittsburgh, PA	40	-80
Portland, ME	44	-70
Portland, OR	46	-123
Providence, RI	42	-71
Raleigh, NC	36	-79
Reno, NV	40	-120
Richfield, UT	39	-112
Richmond, VA	38	-77
Roanoke, VA	37	-80
Sacramento, CA	39	-122
Salt Lake City, UT	41	-112
San Antonio, TX	29	-99
San Diego, CA	33	-117
San Francisco, CA	38	-122
San Juan, PR	19	-66
Savannah, GA	32	-81
Seattle, WA	48	-122
Shreveport, LA	32	-94
Sioux Falls, SD	44	-97
Spokane, WA	48	-117
Springfield, IL	40	-90

Springfield, MO	37	-93
St. Louis, MO	39	-90
Syracuse, NY	43	-76
Tampa, FL	28	-82
Virginia Beach, VA	37	-76
Washington, D.C.	39	-77
Wichita, KS	38	-97
Wilmington, NC	34	-78

Major Canadian Cities

City	Lat. n°	Long. w°
Calgary, AL	51	-114
Edmonton, AL	54	-113
Fredericton, NB	46	-67
Halifax, NS	45	-64
London, ON	43	-82
Montreal, QC	46	-74
Nelson, BC	50	-117
Ottawa, ON	45	-76
Quebec, QC	53	-74
Regina, SK	50	-105
Toronto, ON	44	-79
Vancouver, BC	49	-123
Whitehorse, YT	61	-135
Winnipeg, MB	50	-97

Major Mexican Cities

City	Lat. n°	Long. w°
Acapulco	17	-100
Cancún	21	-87
Colima	19	-104
Culiacán	25	-107
Durango	24	-105
Guadalajara	21	-103
La Paz	24	-110
León	21	-102
Mérida	21	-90
Mexico City	19	-99
Monterrey	26	-100
Morelia	20	-101
Oaxaca	17	-97
Querétaro	21	-100
Tepic	22	-105
Tuxtla Gutiérrez	17	-93
Veracruz	19	-96
Villahermosa	18	-93
Zacatecas	23	-103

Note: These charts provide approximate information on your Latitude and Longitude. Perform an app or Internet search for location-specific values.



Scan this QR code, using your mobile device and any QR code reader app, to get quick access to the

comprehensive installation and operation manual for the STW700W and ST700W In-Wall Timers on Intermatic.com.

Documents / Resources

<p>INTERMATIC™ LibertyLine, Inc. (Model 620-48) www.intermatic.com</p> <p>Ascend™ Quick Installation and Setup Guide <small>Page 1</small> Guide d'installation et de configuration rapide <small>Page 2</small> Guía rápida de instalación y configuración <small>Page 3</small></p> <p>See back page for details on an energy saving feature. Energy Star.</p> <p>Check the back of the device for details on energy saving features.</p> <p>Consider components and wiring when installing and use the correct wiring diagram.</p> <p>STW700W Smart Standard Smart STW700W Standard Smart Timer</p> 	<p>INTERMATIC STW700W Standard Smart Programmable Timer [pdf] User Guide STW700W, ST700W, Standard Smart Programmable Timer, Smart Programmable Timer, Prog rammable Timer, STW700W, Timer</p>
---	---

References

- [Intermatic.com](https://intermatic.com)
- intermatic.com