



INTERMATIC PX Series Transformers Installation Guide

[Home](#) » [Intermatic](#) » INTERMATIC PX Series Transformers Installation Guide 

Contents

- [1 INTERMATIC PX Series Transformers](#)
- [2 INSTALLATION](#)
- [3 OPERATION](#)
- [4 CHARGING INSTRUCTIONS](#)
- [5 GENERAL INFORMATION](#)
- [6 SPECIFICATIONS](#)
- [7 Pool/Spa Underwater Lighting Application](#)
- [8 LANDSCAPE LIGHTING APPLICATIONS](#)
- [9 LIMITED ONE YEAR WARRANTY](#)
- [10 Documents / Resources](#)
 - [10.1 References](#)
- [11 Related Posts](#)



INTERMATIC PX Series Transformers



SLOW-DISSOLVE CAL-HYPO FEEDER INSTALLATION AND OPERATION MANUAL

INSTALLATION

This slow-dissolve cal-hypo feeder is designed to be hard plumbed with 1" PVC pipe with standard threaded inlet and outlet fittings. It operates via pressure differential to circulate water in the feeder. The inlet side connects to the plumbing near the pump outlet. The outlet line connects near the filter inlet. A diverter valve (not included) must be installed between these two lines (see diagram). Slightly closing this valve will allow for higher flow into the feeder. The feeder should be installed bolted down.

OPERATION

- Always use extreme caution when operating or servicing the feeder. NEVER OPEN WHEN THE PUMP IS RUNNING, NEVER INHALE CHEMICAL FUMES. Use caution in hotter weather, as this can create a higher level of gasses. Wear protective glasses and gloves when operating the feeder. Always follow product label directions for handling chemicals.
- Before starting the feeder adjust chlorine level to 1-4 ppm. Check with your chemical dealer for more information on proper water care. Sanitizer demand can depend on many environmental factors. Valve settings may need adjustment at times to accommodate changing conditions. Attempt to increase the feeder rate a day or two in advance of anticipated increases in demand. Test water to determine proper Chlorine residual levels; it is recommended that the levels are checked daily for the first week after start-up to adjust to the ideal rate. Higher numbers dispense more sanitizer.
- Small, incremental changes are recommended to best control sanitizer levels.

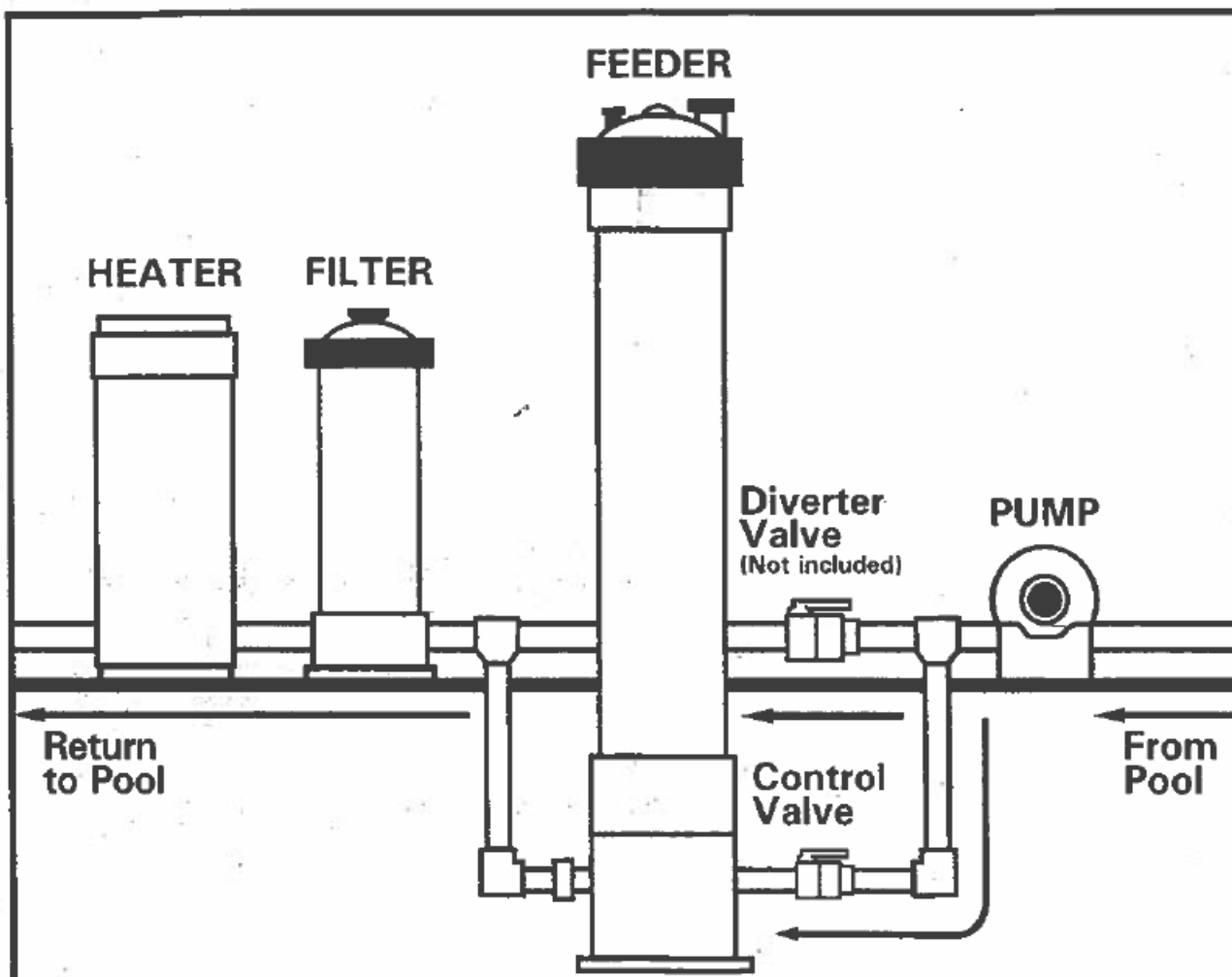

WARNING

This feeder is designed to use only slow-dissolve cal-hypo tablets. NEVER MIX slow-dissolve cal-hypo tablets with other forms of chlorine or with other chemicals. FIRE AND/OR EXPLOSION MAY RESULT. Lubricate o-ring with silicone o-ring lubricant. If you are not the original owner of this feeder, or not sure which chemical was used, be SAFE and flush thoroughly with fresh water. CAUTION SHOULD BE USED WHEN REMOVING CAP. DO NOT INHALE FUMES.

CHARGING INSTRUCTIONS

Use caution when operating or servicing the feeder. NEVER INHALE CHEMICAL FUMES. Wear safety glasses and gloves when using the feeder. Always follow product label directions for chemical use.

1. Shut off pump and close the control valve. Wait one minute. If installed below water level, close any in-line valves to prevent back flow before the vent valve. Next, open the air relief valve, then open the feeder bottom drain valve. Drain water into a plastic container and pour into the pool.
2. Close the drain valve. Lift the lock spring and unscrew the lid lock ring. Remove feeder lid and fill with slow-dissolve cal-hypo tablets. For best results, stack tablets vertically (see diagram).
3. Clean and lubricate the O-ring, then replace the lid. Only use silicone lubricant. Press the lid into position, then close the vent valve.

Tighten the lock ring until the O-ring contacts the body, then turn until the lock spring snaps into the next notch in the body. There are four notches located on the upper flange of the body. Never force the lock ring past the lock spring.

4. Open any in-line valves, and turn on pump/timer. Adjust the control valve to the proper setting.

IF ISOLATION VALVES ARE USED, you must open them before start-up. Always keep the return line valves open to prevent gas or pressure build-up, except when opening or servicing the feeder_ Close the control valve if adding chemicals to the pool, vacuuming, backwashing or maintainin your filter.

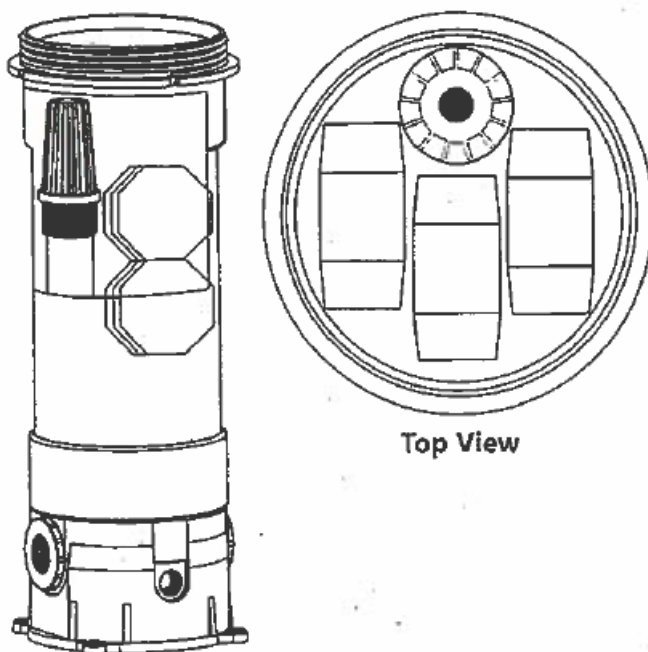

WINTERIZING

1. During freezing temperature seasons, drain all water from the feeder body. Carefully remove undissolved tablets using safety gloves. Clean the feeder body with water, replacing the lid when complete.
2. Leave the vent valve open slightly, and keep the feeder covered all winter season.

1) 25280-615-500	Lid Assy w/ o-ring & air relief
2) 25280-615-106	Screen
3) N/A	O-ring
4) N/A	Body w/ Stand
5) 25280-615-104	Plug
6) 25280-615-200	Union
7) 27313-010-100	Threaded Coupling
8) 25203-453-925	Gasket
9) 25280-615-300	Flow Control Valve
10) 25280-615-400	Drain Valve

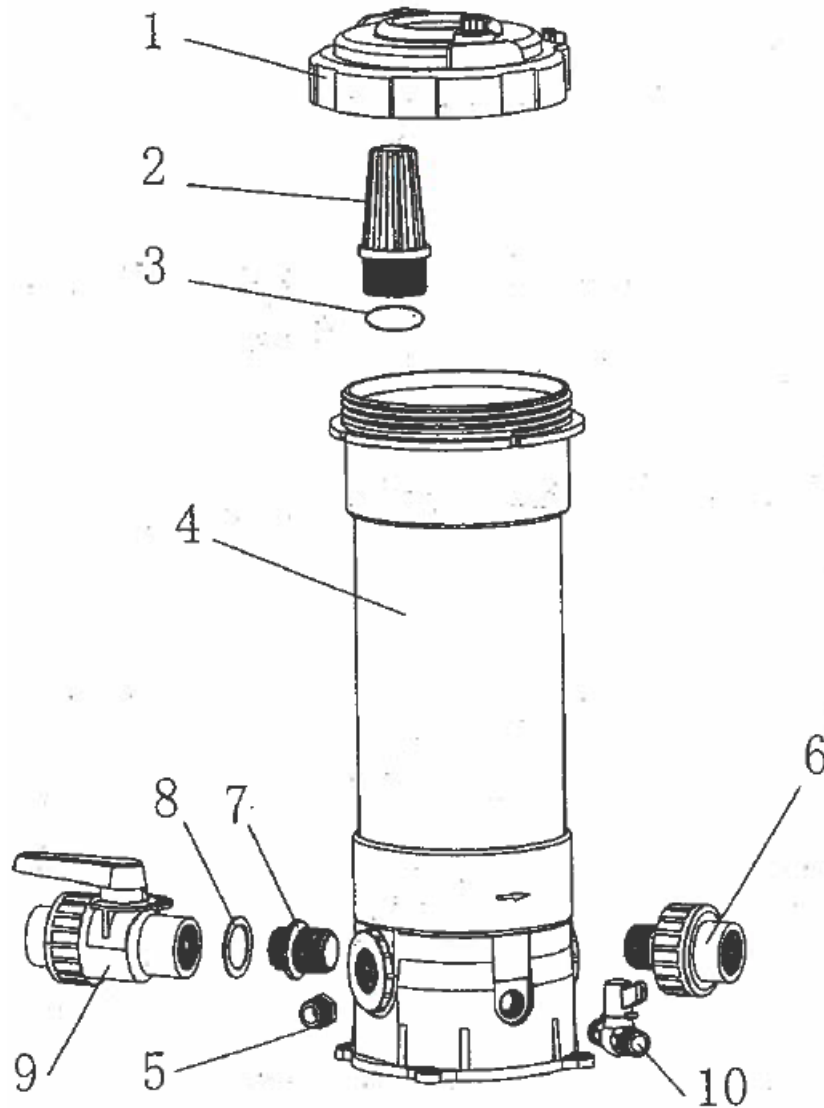

Questions?

- For Pool Breeze®, call 1-888-433-3029



- For poolife®, call 866-476-6538



Model: PX100 and PX100S 100 Watt Transformers

INPUT: 120 V.AC, **OUTPUT:** 12 V.AC or 13 V.AC

Model: PX300 and PX300S -300 Watt Transformers

INPUT: 120 V.AC, **OUTPUT:** 12 V.AC, 13 V.AC or 14 V.AC

Suitable for direct connection to underwater lights and for Indoor/Outdoor installations except in CANADA Low Voltage Landscape Lighting installation Outdoor only.

Read and follow the safety instructions listed below and other basic safety precautions before installation or operation of this transformer and other associated equipment

WARNING Risk of Fire or Electrical Shock

- If installation involves running wire through a building structure, special wiring methods are needed.
- Do not submerge transformer.
- Do not connect two or more transformers in parallel or use with dimmers

CAUTION Risk of Injury or Property Damage!

- This transformer must be installed by a qualified electrician, according to the National Electrical Codes (including article 680) or Canadian Electrical Code (including section 68) and, local requirements.
- **USE COPPER CONDUCTORS ONLY.**
- Do not exceed the maximum ratings of individual components, wiring devices, and current carrying capacity of conductors.
- Do not install this equipment within 5 feet (3 meters for Canadian installations) of any body of water.
- If transformer is used for direct connection of underwater lights, refer to NEC 680-24(b) or CEC 68-060, 062 and 066 for further details.
- For Canadian installations, supply circuit must be protected by a ground fault circuit interrupter.
- Installation is subject to approval by the local inspection authority.

GENERAL INFORMATION



- These Safety Transformers are specifically designed to supply 12 volts to pool/spa lights, submersible fixtures and outdoor garden lights. A grounded shield between the primary and secondary windings assures safe operation and the built-in circuit protection will disconnect power to the transformer in case of defect or

overload.

- These transformers are suitable for direct connection to underwater Pool and Spa lights.

SPECIFICATIONS

- **Enclosure Size:** 7 1/4" (19.4 cm) high x 5 1/4" (13.3 cm) wide x 4 1/2" (11.4 cm) deep. Mounting brackets top and bottom.
- **Enclosure Type:** (A) 0.048" corrosion resistant steel with electrostatically applied beige coating. (B) 0.036" stainless steel.
- **Knockouts:** Total of ten 1/2"-3/4" combination. (4) bottom, (2) right side, (2) left side, (2) back

Model	Input 60 Hz.	Secondary Output		Enclosure Type
		Lamp Watts*	Volts	
PX100 PX100 S PX300 PX300 S	120V. 1 Amp Max. 120V. 1 Amp Max. 120V. 3 Amp Max. 120V. 3 Amp Max.	100 Max. 100 Max. 300 Max. 300 Max.	12 or 13 12 or 13 12, 13 or 14 12, 13 or 14	A B A B

Any combination of bulbs, any tap

Pool/Spa Underwater Lighting Application

INSTALLATION

For field wiring information, please refer to the instructions attached to inside of front cover.

- The enclosure of the transformer must be provided with a fail-proof ground as required by NEC, Article 680 and any applicable local codes For Canadian installations, the supply circuit must be protected by a ground fault circuit interrupter.
- For direct wiring of underwater lights, the installation must comply with article 680-24(b) of the National Electrical Code, or articles 68-060, 062 and 066 of the Canadian Electric Code.
- The transformer should be mounted at least 1 foot above the deck level with the field wiring compartment down.
- Make sure that all unused taps (leads) are separately insulated.
- Use the following tables as a guide to determine the correct wire size.
- Check voltage at lamp terminals after installation. It should be 12 ± 0.3 volts

120 Volt Primary Input – 100 Watt Output

Distance* Feet	2#6AWG	2#8AWG	2#10AWG	2#12AWG	2#14AWG
5 Ft.	12V	12V	12V	12V	12V
30 Ft.	12V	12V	12V	13V	13V
60 Ft.	12V	12V	13V	13V	
90 Ft.	12V	13V	13V		
120 Ft.	13V	13V			
150 Ft.	13V	13V			
180 Ft.	13V				
210 Ft.	13V				
240 Ft.	13V				

120 Volt Primary Input – 300 Watt Output

Distance* Feet	2#6AWG	2#8AWG	2#10AWG	2#12AWG
5 Ft.	12V	12V	12V	12V
10 Ft.	12V	12V	12V	13V
20 Ft.	12V	12V	13V	13V
30 Ft.	12V	13V	13V	14V
40 Ft.	13V	13V	14V	
50 Ft.	13V	13V	14V	
60 Ft.	13V	14V		
70 Ft.	13V	14V		
80 Ft.	13V	14V		
90 Ft.	14V			
100 Ft.	14V			
110 Ft.	14V			

LANDSCAPE LIGHTING APPLICATIONS

WARNING Risk of Fire or Electrical Shock

SELECT CABLE. See Chart.

Transformer Wattage	Minimum Gauge Cable
300	12
100	16-14-12

- Failure to use appropriate gauge cable or install it as directed in these instructions and chart may result in Risk of Fire or Electric Shock.
- Use only CSA or UL approved low-voltage cable.
- Low voltage cable shall be buried a maximum 6 inches (15.2 cm) in order to connect to the main low voltage cable

LIMITED ONE YEAR WARRANTY

If within the warranty period specified, this product fails due to a defect in material or workmanship, Intermatic Incorporated will repair or replace it, at its sole option, free of charge. This warranty is extended to the original household purchaser only and is not transferable. This warranty does not apply to: (a) damage to units caused by accident, dropping or abuse in handling, acts of God or any negligent use; (b) units which have been subject to unauthorized repair, opened, taken apart or otherwise modified; (c) units not used in accordance with instructions; (d) damages exceeding the cost of the product; (e) sealed lamps and/or lamp bulbs, LED's and batteries; (f) the finish on any portion of the product, such as surface and/or weathering, as this is considered normal wear and tear; (g) transit damage, initial installation costs, removal costs, or reinstallation costs. INTERMATIC INCORPORATED WILL NOT BE LIABLE FOR INCIDENTAL OR CONSEQUENTIAL DAMAGES. SOME STATES DO NOT ALLOW THE EXCLUSION OR LIMITATION OF INCIDENTAL OR CONSEQUENTIAL DAMAGES, SO THE ABOVE LIMITATION OR EXCLUSION MAY NOT APPLY TO YOU. THIS WARRANTY IS IN LIEU OF ALL OTHER EXPRESS OR IMPLIED WARRANTIES. ALL IMPLIED WARRANTIES, INCLUDING THE WARRANTY OF MERCHANTABILITY AND THE WARRANTY OF FITNESS FOR A PARTICULAR PURPOSE, ARE HEREBY MODIFIED TO EXIST ONLY AS CONTAINED IN THIS LIMITED WARRANTY, AND SHALL BE OF THE SAME DURATION AS THE WARRANTY PERIOD STATED ABOVE. SOME STATES DO NOT ALLOW LIMITATIONS ON THE DURATION OF AN IMPLIED WARRANTY, SO THE ABOVE LIMITATION MAY NOT APPLY TO YOU. This warranty service is available by either (a) returning the product to the dealer from whom the unit was purchased, or (b) completing a warranty claim on line at www.intermatic.com. This warranty is made by: Intermatic Incorporated Customer Service/7777 Winn Rd., Spring Grove, Illinois 60081-9698 815-675-7000 <http://www.intermatic.com>

Because of our commitment to continuing research and improvements, Intermatic Incorporated reserves the right to make changes, without notice, in the specifications and material contained herein and shall not be responsible for any damages, direct or consequential, caused by reliance on the material presented
INTERMATIC INCORPORATED, SPRING GROVE, IL 60081-9698
<http://www.intermatic.com>

Documents / Resources

	<p>INTERMATIC PX Series Transformers [pdf] Installation Guide</p> <p>PX100 and PX100S - 100 Watt Transformers, 100 Watt Transformers, PX100S, PX100, PX300, PX300S, PX300 and PX300S - 300 Watt Transformers, 300 Watt Transformers, Transformers, P X Series Transformers</p>
--	---

References

- [X intermatic.com](http://www.intermatic.com)