



[Home](#) » [Intermatic](#) » **Intermatic KPT0170 Power Tap User Manual** 

Contents [[hide](#)]

- [1 Intermatic KPT0170 Power Tap User Manual](#)
- [2 SAFETY SECTION](#)
- [3 PRODUCT DESCRIPTION](#)
- [4 POWER TAP INSTALLATION](#)
- [5 Install the Power Tap](#)
- [6 LIMITED WARRANTY](#)
- [7 References](#)



Intermatic KPT0170 Power Tap User Manual



SAFETY SECTION

Warning

Risk of Fire or Electric Shock

- Disconnect power at the circuit breaker(s) or disconnect switch before installing or servicing.
- Thoroughly read the instructions before installing the unit.
- The line voltage to the receptacle must be 120 VAC as indicated on the label of the Power Tap.
- Installation and/or wiring must be by national and local electrical code requirements.
- Unused wire leads must be capped before installation.
- A photocontrol or shorting cap must be installed to ensure water does not enter Power Tap.
- Power Tap does not provide a ground connection. If the device requires grounding, other provisions must be made to ensure proper grounding.
- Power Tap contains no serviceable parts.

PRODUCT DESCRIPTION

KPT0170 Power Tap

The Intermatic Model KPT0170 Power Tap is a receptacle that is used to tap into the electric power feed of a lighting fixture through its ANSI C136.10 (3-pin) or C136.41 (7-pin) style receptacle. The Power Tap meets all applicable requirements of ANSI C136.10 and C136.41. It taps into the electrical power feed without disturbing the function of the light fixture's control device. The Power Tap comes with a 16 AWG flush-cut cable end. The Power Tap contains no serviceable parts and is intended for outdoor use.

Ratings

- 120 VAC
- 15 A max total, 5 A max on the line out
- 5 A from -40 °C to 50 °C, derate at 0.1 A/°C above 50 °C up to 70 °C max
- 50/60 Hz

POWER TAP INSTALLATION

Connect and Install an External Device

1. Connect the power feed cable from the Power Tap to the device per the manufacturer's instructions for the device.
Note: The Power Tap does not provide a ground connection. If the device requires grounding, other provisions must be made to ensure proper grounding.
2. Install the external device on the light pole or light pole arm as directed by the manufacturer of the device or by using the device installation guidelines.

Install the Power Tap

1. Disconnect power at the circuit breaker(s) or disconnect the switch(es) before installing.
2. If present, remove the photocontrol or control node from the existing receptacle.
3. Insert the Power Tap into the receptacle by aligning the prongs on the Power Tap with the openings in the receptacle.
4. Push down on the Power Tap and twist clockwise to lock. The Power Tap must be locked in place.

5. Reinstall the photocontrol, shorting cap, or control node device onto the Power Tap top receptacle.
6. Fasten the Power Tap cable to the light pole or light pole arm (per the regulations appropriate for your application) to ensure the cable is secure and that no undue stress is placed on the receptacle and light fixture.
7. Reconnect power at the circuit breaker(s) or reconnect the switch(es).

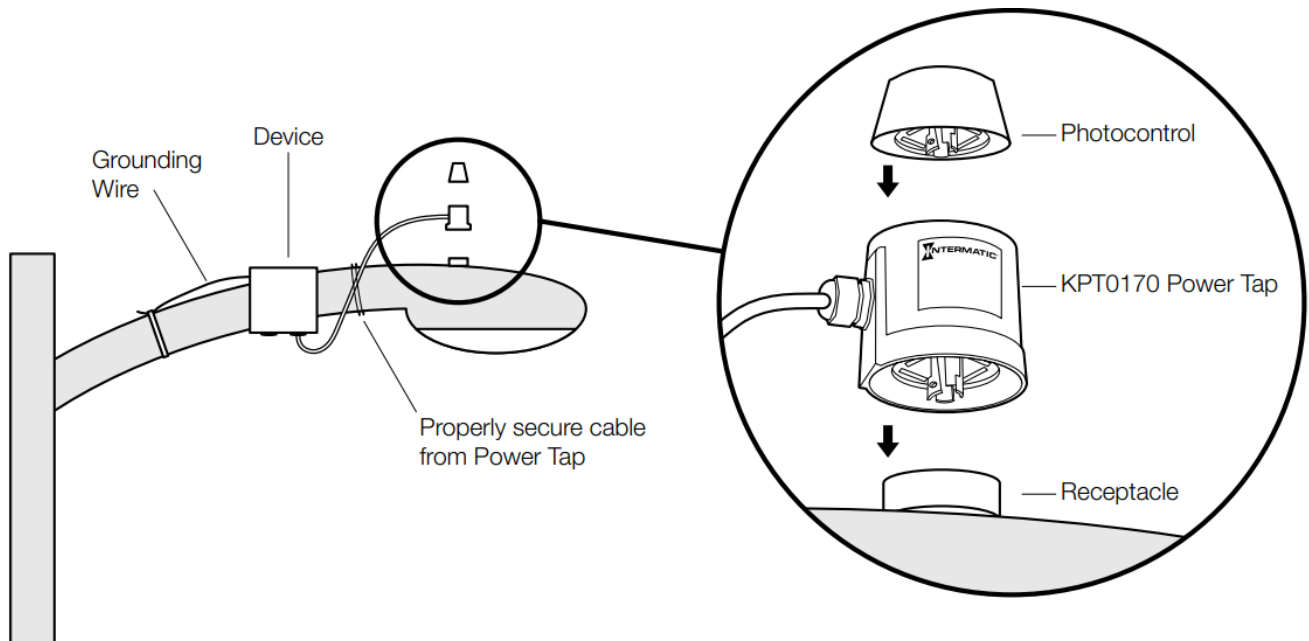

FIG. 1. Install Power Tap

LIMITED WARRANTY

Warranty service is available by either (a) returning the product to the dealer from whom the unit was purchased or (b) completing a warranty claim online at www.intermatic.com.

This warranty is made by: Intermatic Incorporated, Customer Service, 1950 Innovation Way, Suite 300, Libertyville, IL 60048. For warranty service, go to:

<http://www.intermatic.com> or call [815-675-7000](tel:815-675-7000).

Libertyville, Illinois 60048

www.intermatic.com

Download PDF: [Intermatic KPT0170 Power Tap User Manual](#)

References

- [User Manual](#)

Leave a comment

Your email address will not be published. Required fields are marked *

Comment *

Name

Email

Website

☐ Save my name, email, and website in this browser for the next time I comment.

Post Comment

Search:

Search

[Manuals+](#) | [Upload](#) | [Deep Search](#) | [Privacy Policy](#) | [@manuals.plus](#) | [YouTube](#)

This website is an independent publication and is neither affiliated with nor endorsed by any of the trademark owners. The "Bluetooth®" word mark and logos are registered trademarks owned by Bluetooth SIG, Inc. The "Wi-Fi®" word mark and logos are registered trademarks owned by the Wi-Fi Alliance. Any use of these marks on this website does not imply any affiliation with or endorsement.