

INTERMATIC A3400 ABRA In Wall Smart Switch User Guide

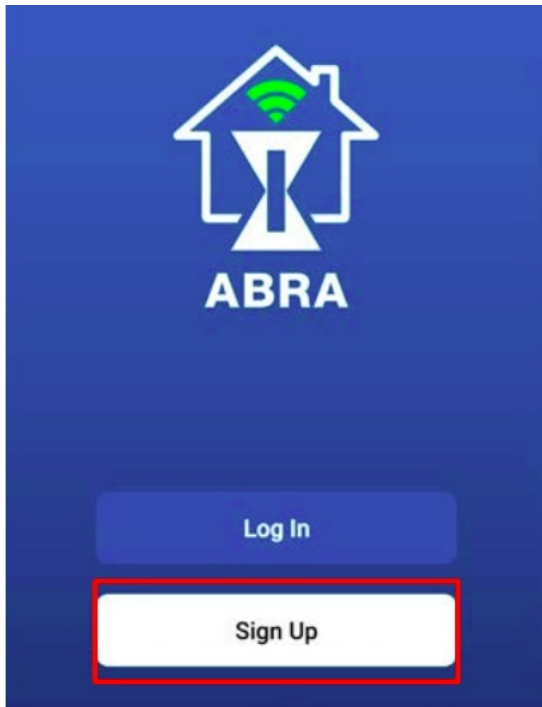

Table of Contents

- ABRA App: Getting Started
- ABRA App Home Screen
- Adding the In-Wall Smart Switch
- Managing and Controlling the In-Wall Smart Switch
- Creating Schedules for the In-Wall Switch
- Other ABRA In-Wall Smart Switch Features
- Using Google Home and Amazon Alexa
- ABRA and Siri
- In-Wall Smart Switch and Matter

ABRA App: Getting Started

- Download the Intermatic ABRA app from the App Store or Google Play, and sign-up for an account.

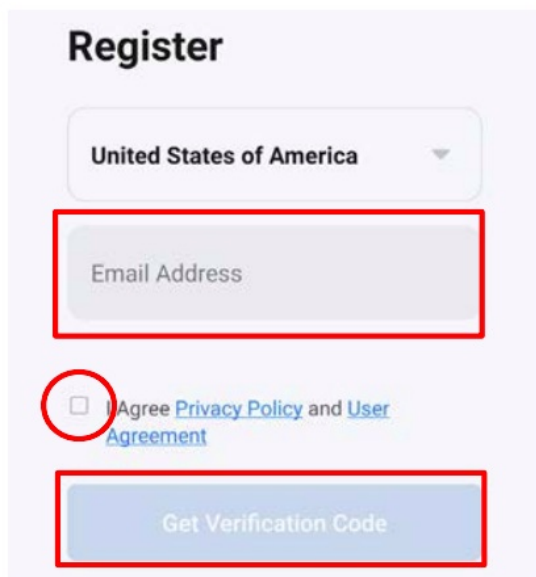

- Register your email address and tap "Get Verification Code."

The image shows the ABRA app's registration screen. At the top, the word "Register" is in bold black text. Below it, there is a dropdown menu showing "United States of America". Below the dropdown, there is a text input field for "Email Address" with a red border. Below the email field, there is a checkbox with a red circle around it, followed by the text "I Agree [Privacy Policy](#) and [User Agreement](#)". Below the checkbox, there is a blue button with the text "Get Verification Code" and a red border.

- Check your inbox for the verification email with code and enter it here.

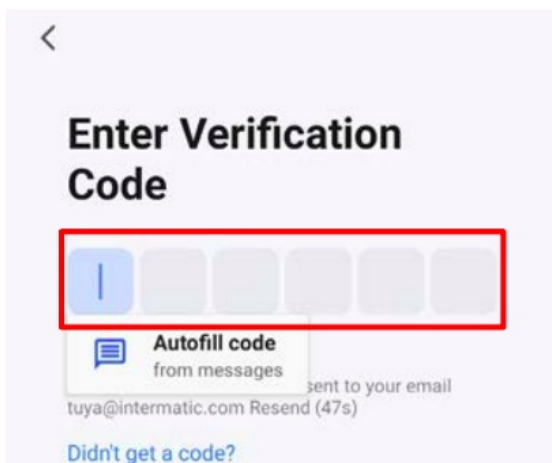
The image shows the ABRA app's verification code screen. At the top, there is a back arrow icon. Below it, the text "Enter Verification Code" is in bold black text. Below the text, there is a row of six input fields for the verification code, with the first field containing a blue vertical bar and a red border around the entire row. Below the input fields, there is a blue button with a speech bubble icon and the text "Autofill code from messages". Below the button, there is a small text "sent to your email" and "tuya@intermatic.com Resend (47s)". At the bottom, there is a blue link that says "Didn't get a code?".

- Set your Password, then tap “Done.”
- Set the “Permissions” on the next page, then you’ll be taken to the ABRA Home Screen.

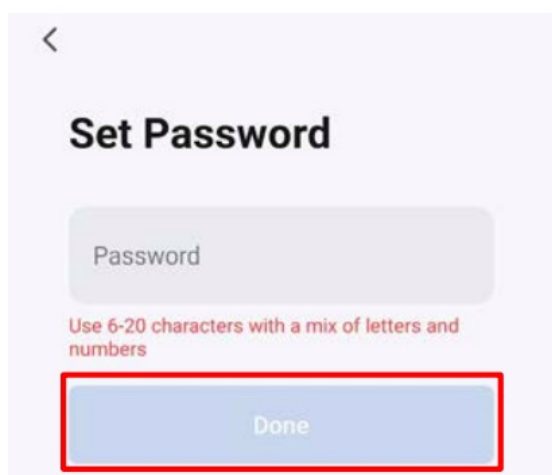

- Tap the “Welcome Home” area to set your home’s location using your phone’s GPS. This enables the ABRA system to create schedules with accurate sunrise/sunset times.

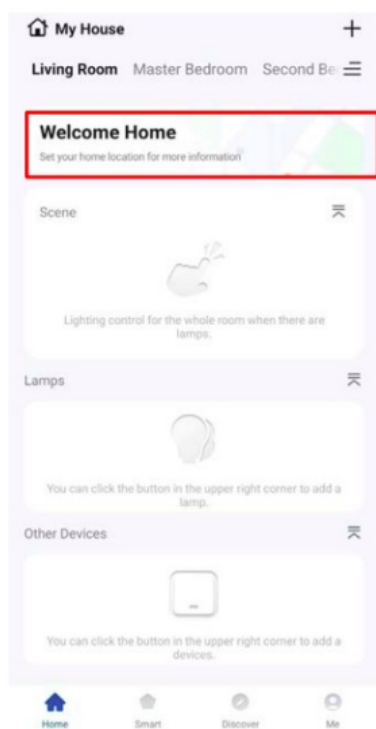

- The next screen shows a Google map highlighting your address. Tap “Confirm” or correct as needed.

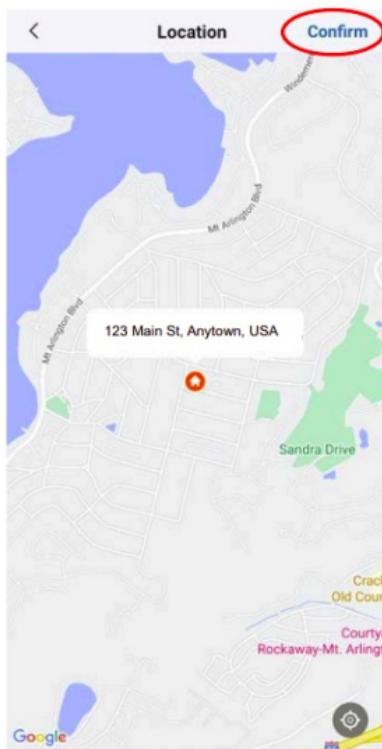

ABRA App Home Screen

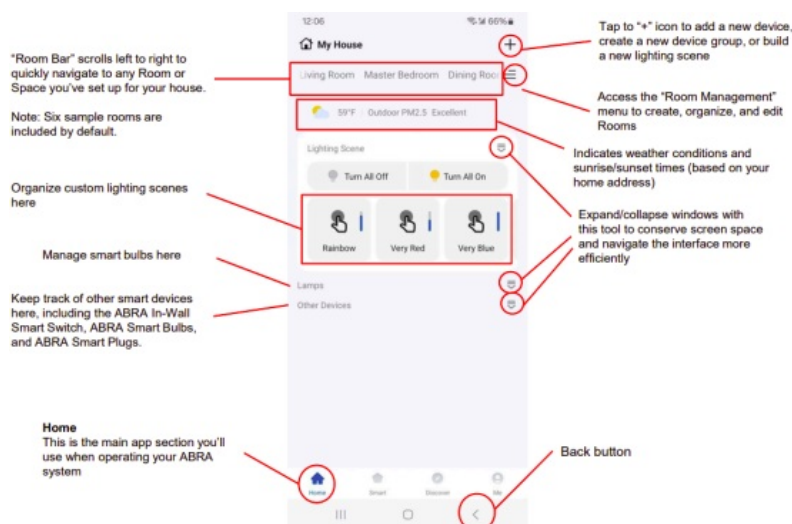

Adding the In-Wall Smart Switch

- The ABRA In-Wall Smart Switch (SH-ABIWS-WH) must be properly installed in a wall box .
- See the “ABRA In-Wall Smart Switch Quick Installation Guide” for specific wiring information and additional guidance.



- After installation, when power is restored to the switch, the blue LED indicator should begin to flash, indicating that the switch is in the “pairing mode.”
- If the LED is not flashing, press and hold the “OFF” button on the switch (the lower part of the paddle) until the LED begins to flash.



- On your mobile device, confirm that Wi-Fi and Bluetooth are both ON, and that you’re connected to your home’s W-Fi network.



- With the switch in pairing mode, tap the “+” icon at the top right of the ABRA app Home Screen

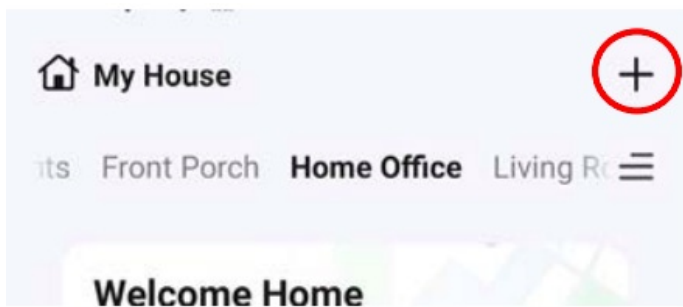

- Select “Add Device” from the menu

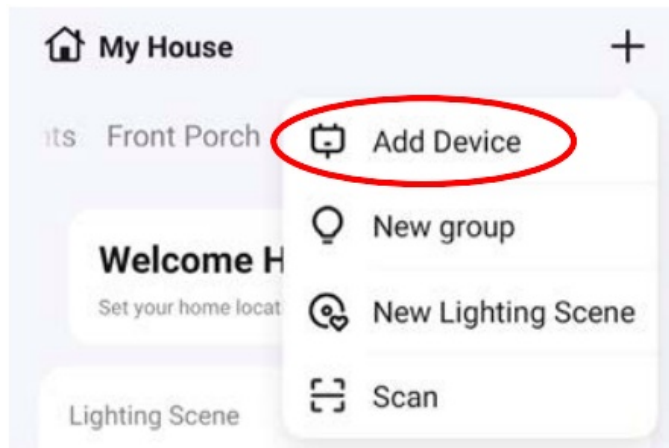

- Once the app auto-discovers the switch, tap “Add” to add the switch to your ABRA system.



- Confirm that your network name and password are correct, then tap “Next”

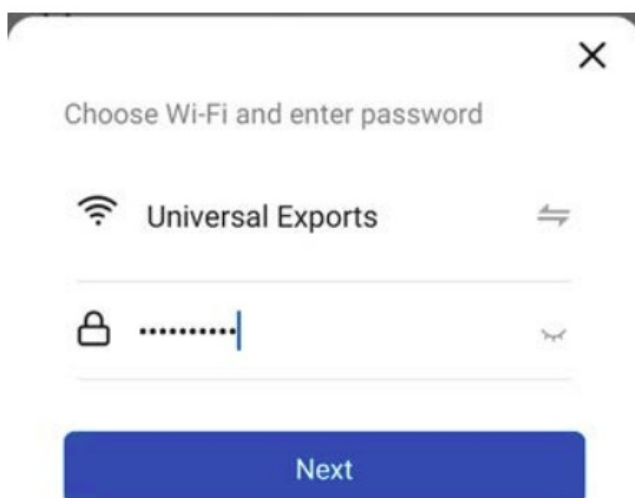

- You'll see the switch status as it's being added, followed by a confirmation that the device was added successfully.

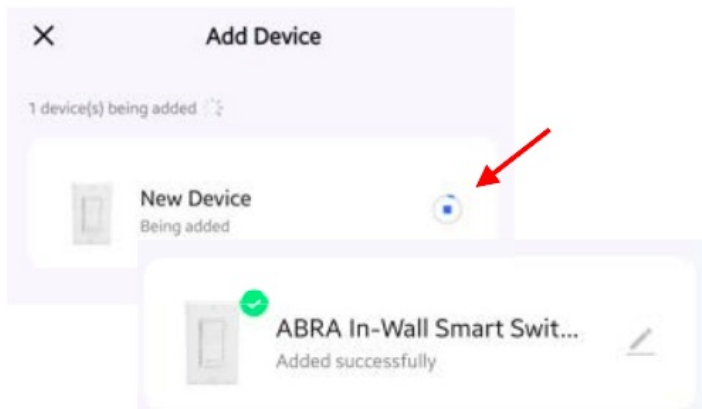

Managing and Controlling the In-Wall Smart Switch

- By default, the switch is named “ABRA In-Wall Smart Switch” and assigned to the first room in the Room List, which is “Living Room.”
- Tap on the “ABRA In-Wall Switch” area on the home screen to open the switch Control Panel. Here you can change the switch’s name and room location. You’ll want to change the name to differentiate it from other switches you may add in the future.



- Tap the “Edit” tool.

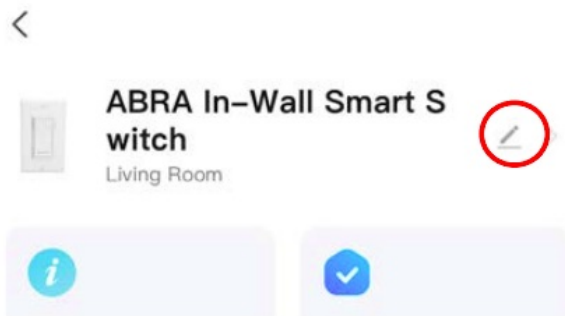

- Tap the “Edit” tool again on the next page.



- Tap the “>” tool to change the device name.

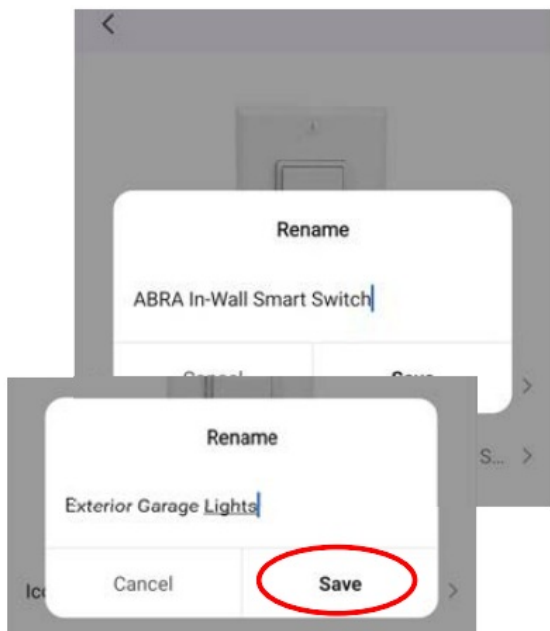

- Next we'll create a new Room called “Garage.”



Icon >

Name Exterior Garage Lights >

Location Living Room >

- The ABRA app includes 6 sample rooms, but you can easily add more rooms or re-name rooms as needed. Refer to the “Room Management” section of this documents or the ABRA User Guide for more details.

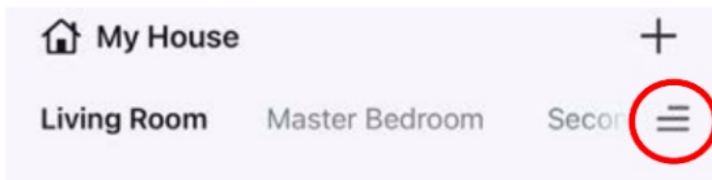

- On the Home page, tap the Room Management tool next to the scrolling “Room Bar.”

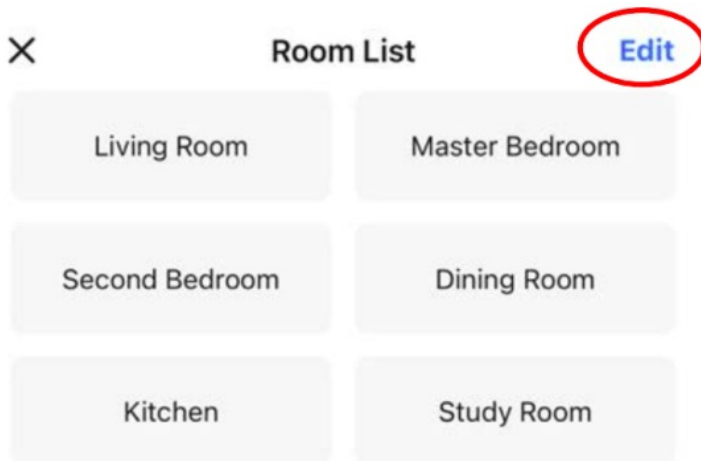

- Tap “Add Room.”

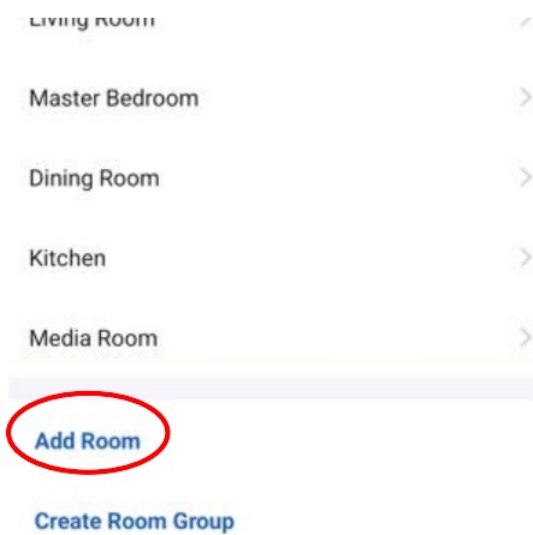

- Add a room called “Garage” to the Room List and select “Finish

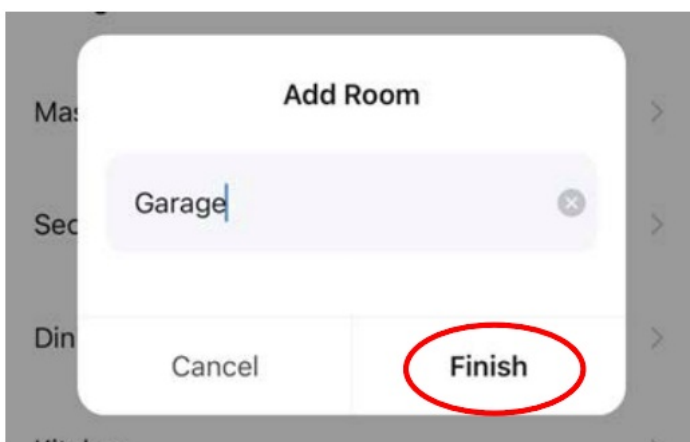

- Return to the Smart Switch Control Panel and change the device location from “Living Room” to “Garage.”

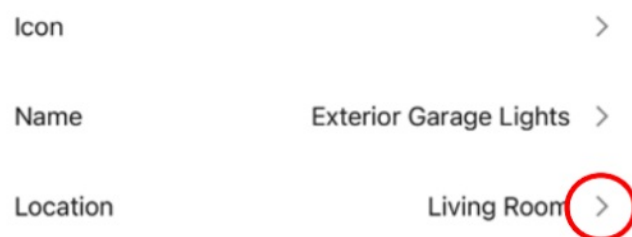

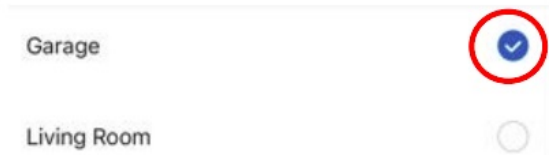
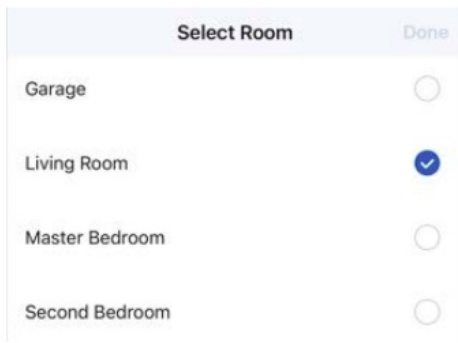

- The “Exterior Garage Lights” switch is now associated with the “Garage” room...



Icon >

Name Exterior Garage Lights >

Location Garage >

- and can be found on the Home page on the “Garage” tab.

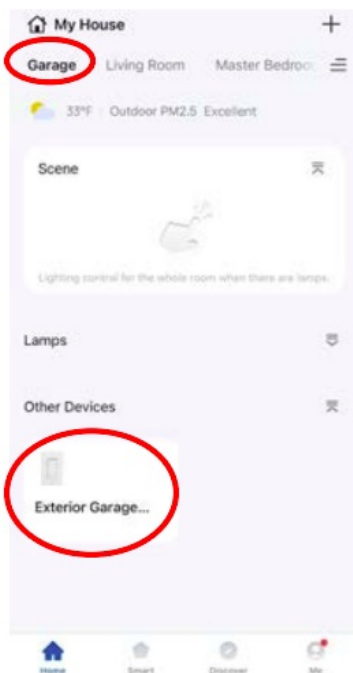

Creating Schedules for the In-Wall Smart Switch

- The ABRA app provides several ways to create schedules for your In Wall Smart Switch.



- Add a schedule by tapping the “+” tool at the lower right, then tap “Schedule.”

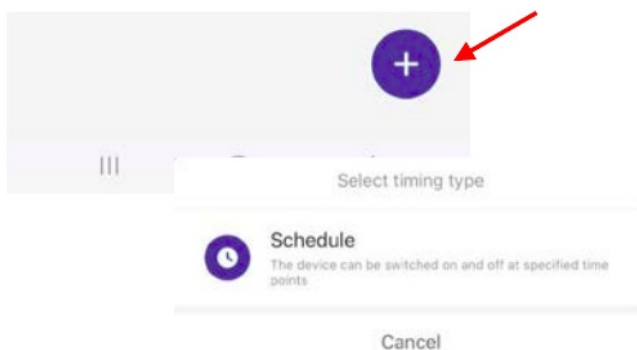

- Set the Start Time for the schedule with the numerical dial, along with the days of the week.
- “Perform Switch; Please Choose” sets the Smart Switch to either turn ON or OFF based on the schedule.

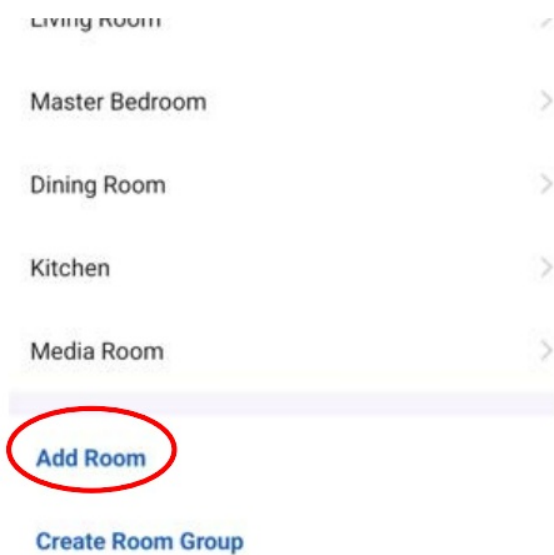

- If you have multiple smart switches, you can assign the schedule to all of them, or you can set each one to a different schedule.
- Tap “>” to select ON or OFF



- Repeat the process to create an ON schedule and an OFF schedule. The schedules will now appear on the Schedule screen in the Control Panel

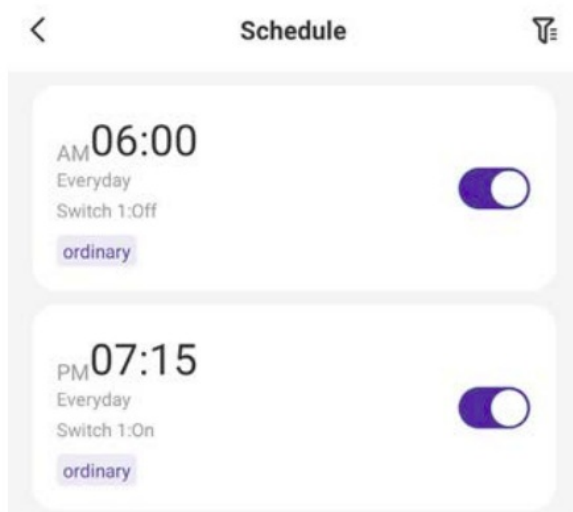

- For more sophisticated schedules with Sunrise/Sunset capabilities, use the ABRA app advanced Scheduling Tool found on the “Smart” page.

- Select “Automation” at the top of the page, then tap “Create Smart Task.”

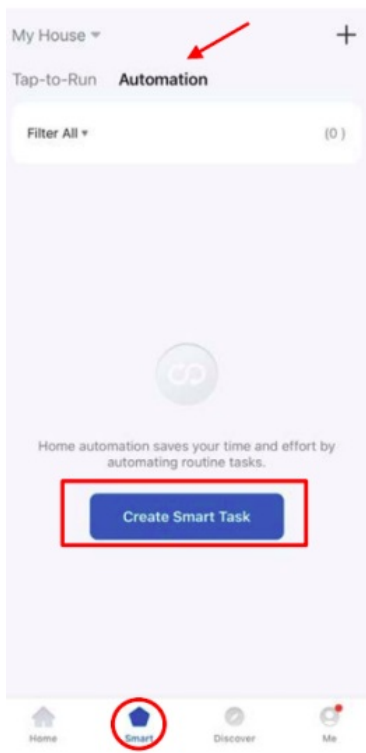

- Select “When Weather Changes” from the Smart Task menu. This is where the Sunset/Sunrise astronomic settings can be found.

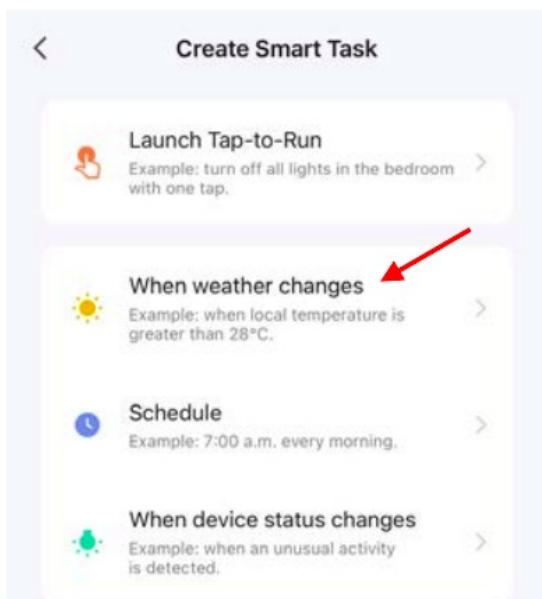

- The astronomic is based on the gps location in your mobile device when you set up your app.



- Tap “Sunrise” and note that you can offset the time by 5 minutes to 5 ours. For example, you can createa schedule that begins 20 minutes before sunrise every day.

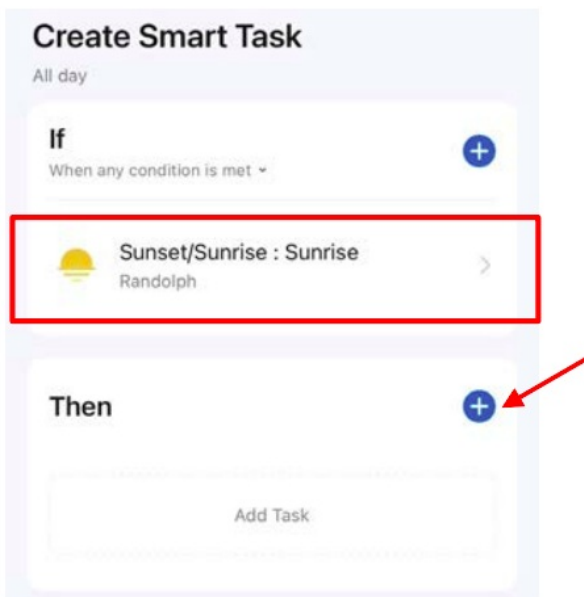

- Select “Control Single Device

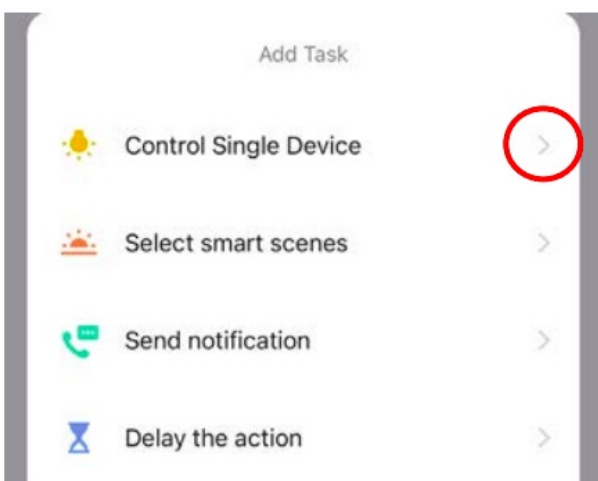

- Next, select your In-Wall Smart Switch by tapping the “>”

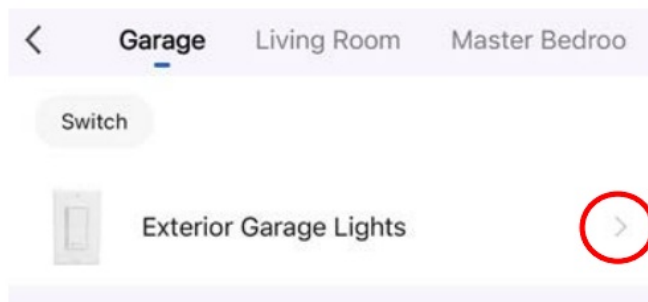

- Select “OFF” and “Save.”

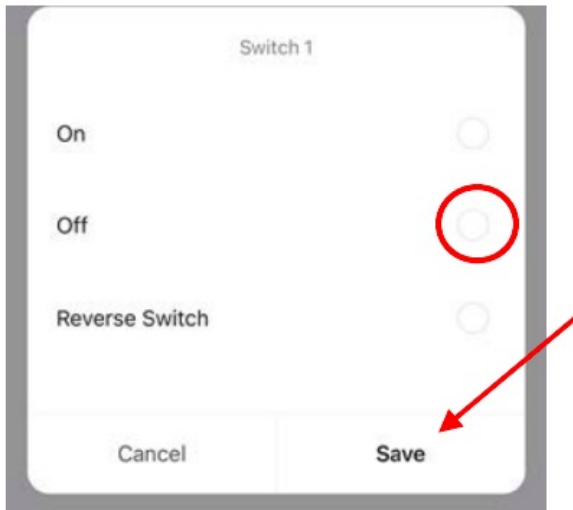

- Now, every day at sunrise the Smart Switch will turn OFF.

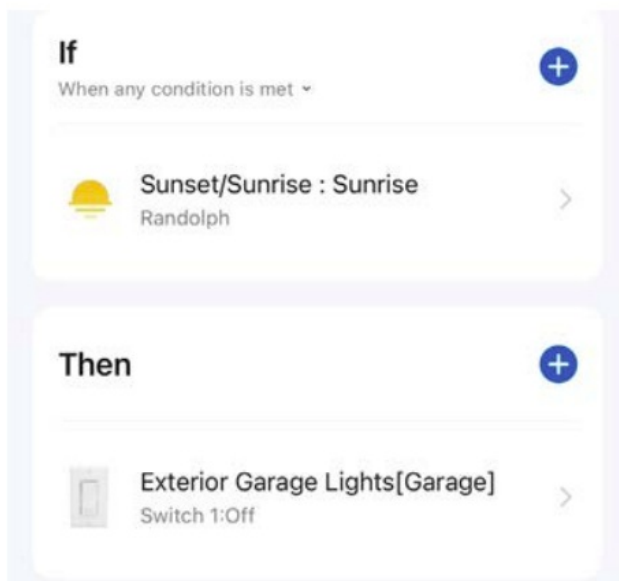

- Name the schedule “Sunrise,” tap “Confirm,” then “Save.”
- **TIP:** If you plan to add more smart switches or other ABRA devices, it’s a good idea to name the schedules according to their timing vs. “Garage Lights” or something like that. It will provide more flexibility when you want to sync multiple devices to the same schedule.

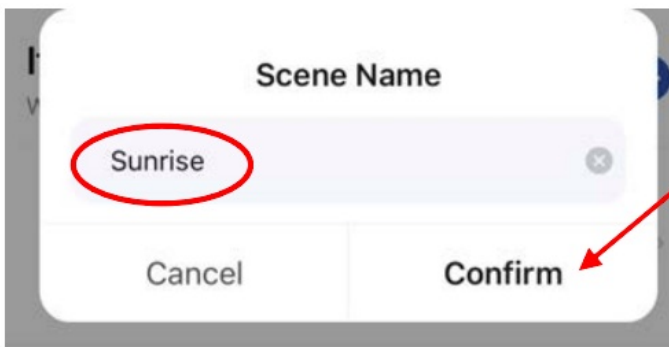

- To create an “ON” schedule, you simply repeat the process. In this example, we’ll use time-of-day to turn the switch ON.
- Go back to the “Smart” page “Automations” tab and select “Schedule

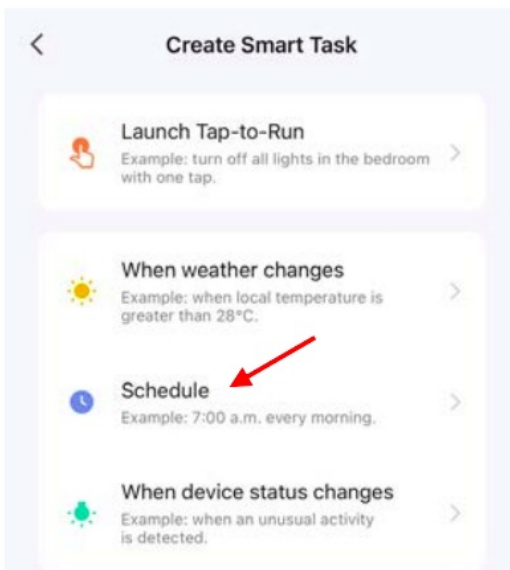

- Dial in the desired time and change the “Repeat>Once” selection to open the 7-day calendar.

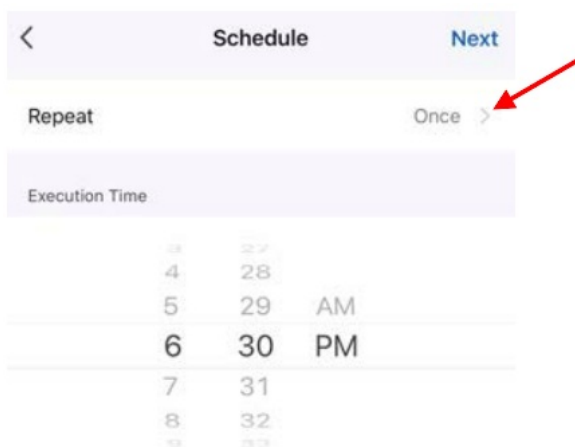

- Select the desired days for the schedule.

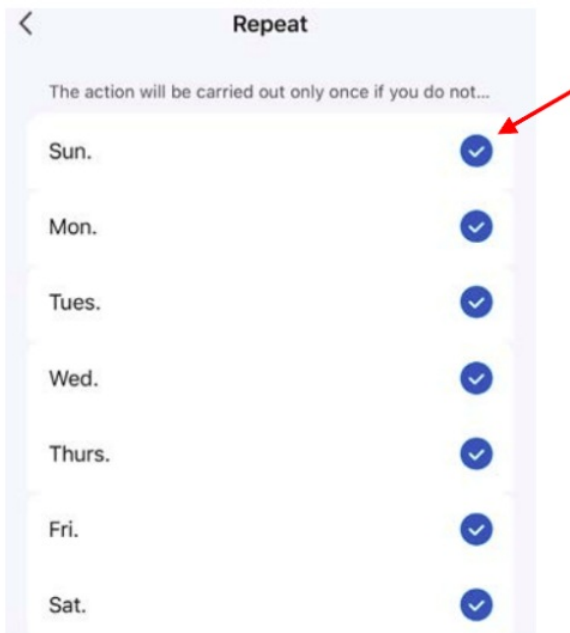

- With the Time and Days in place, the “action” must now be defined. Tap “+” in the “Then” area.

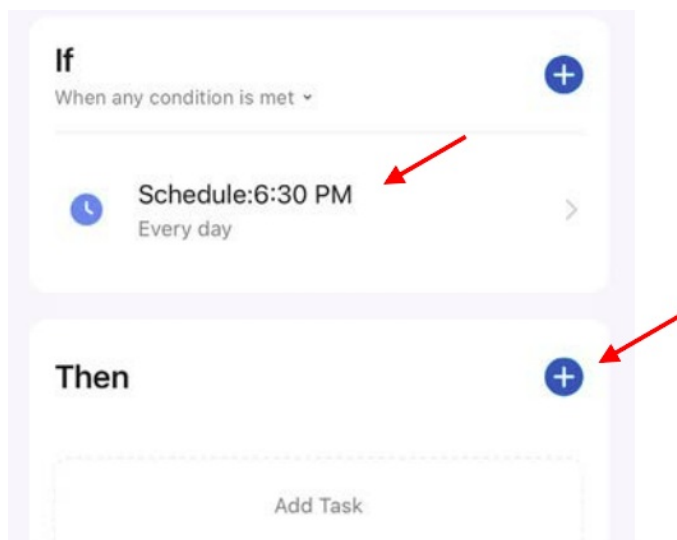

- Again, select “Control Single Device” and choose the smart switch.

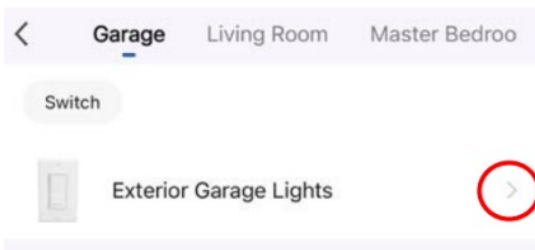
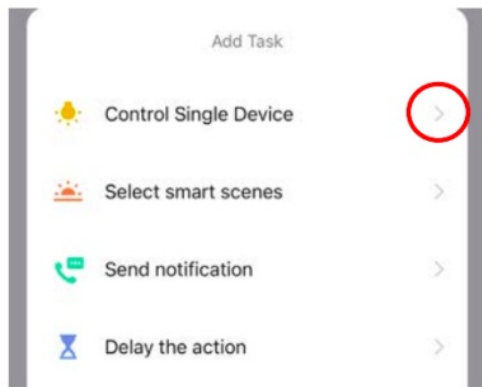

- This time, select “On” to turn the Smart Switch ON, then “Save.”

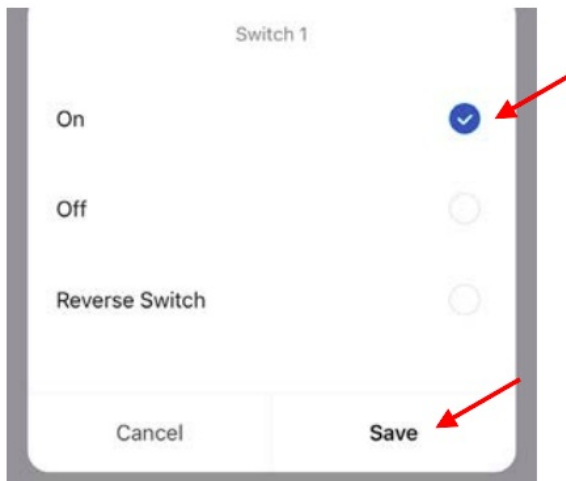

- Now, every day at 6:30PM the Smart Switch will turn ON

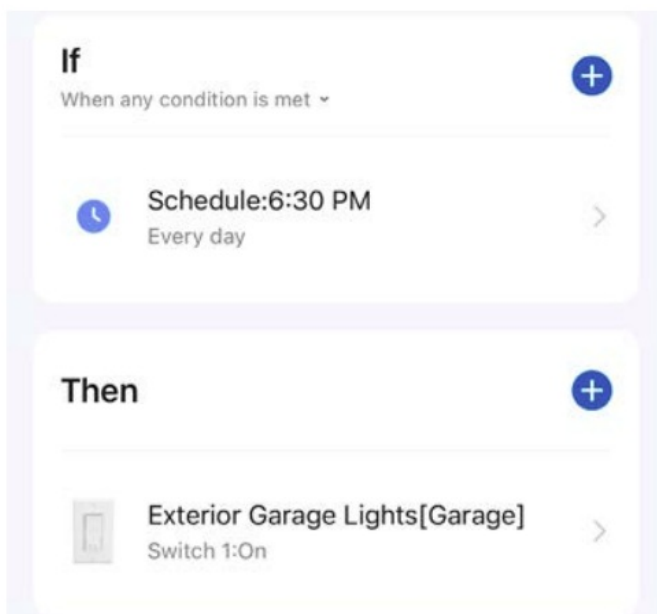

- Name the schedule, tap “Confirm,” then “Save.”

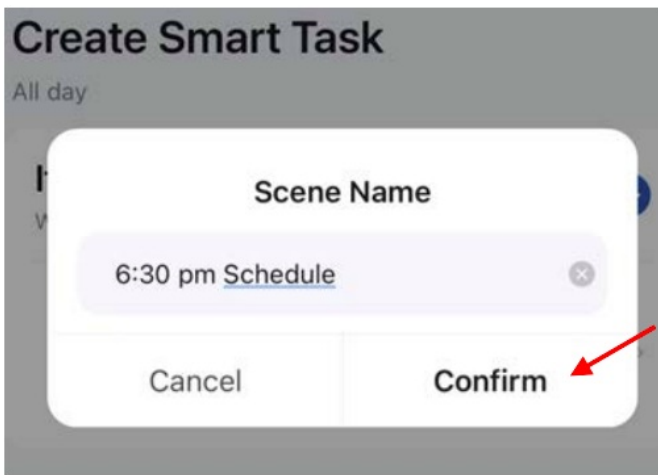

- The “Smart>Automation” page now contains the two automated schedules you just created.
- The “6:30 pm Schedule” turns the BRA In-wall Smart Switch ON every day. The “Sunrise” schedule turns the Smart Switch OFF every day at sunrise

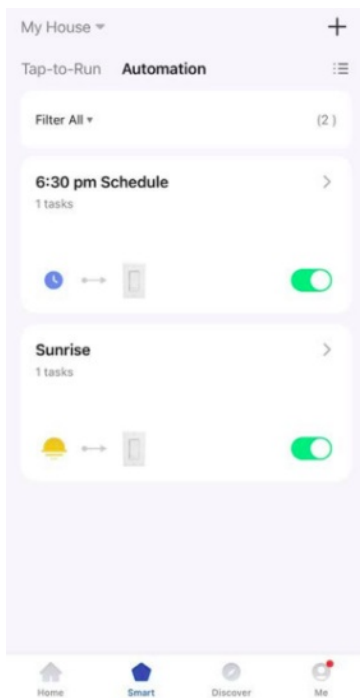

- Note that Automated Schedules can easily be modified, re-named, deleted, and turned On/Off using various tools in the ABRA app.

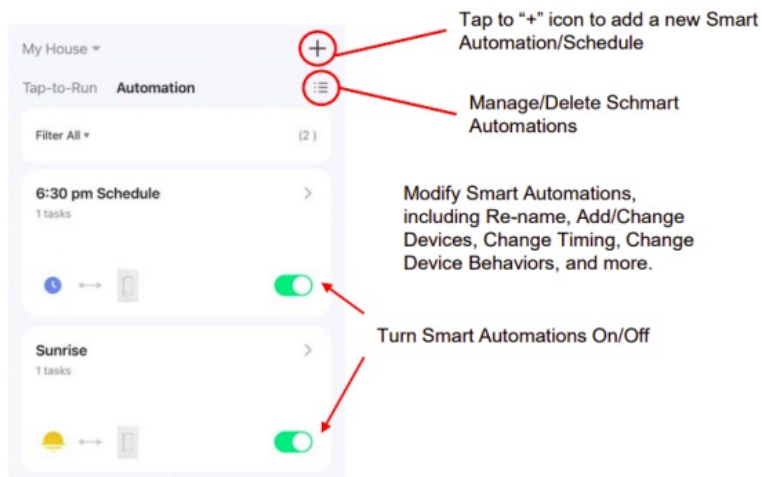

Other ABRA In-Wall Smart Switch Features



- Use the Countdown Timer to turn the switch ON or OFF after a specified period of time, up to 24 hours.

A time selection interface with two columns of digits. The top row shows '00' for hours and '01' for minutes, with 'hour' and 'minute' labels. Below are rows for '01', '02', '02', '03', '03', and '04'. The digits are arranged in a grid-like fashion, with some digits appearing to be part of a larger set of options.

Done

- The Settings tab contains 3 items.

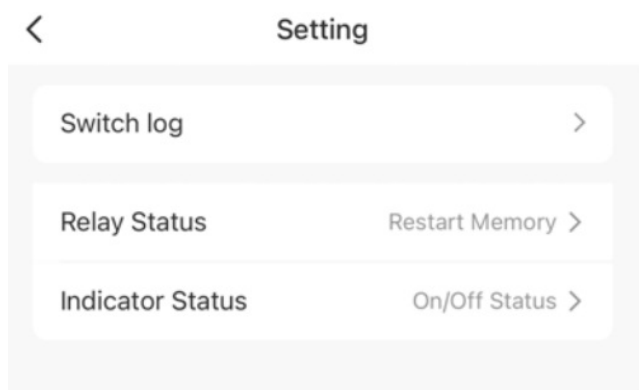

- The Switch log keeps track of your Smart Switch ON/OFF status over the course of time.

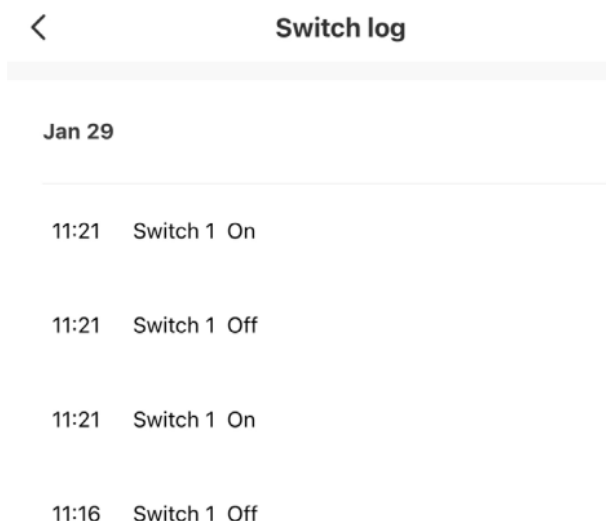

- Relay Status refers to your preferred switch status after a power failure. When power returns, the switch can be set to ON, OFF or to the state it was in at the time of the power loss.



- Indicator Status refers to the LED indicator. It can be turned OFF completely, or it can be set to indicate the status of the load.
- In Switch Position mode, the LED will be ON when the load is OFF, to act as a nightlight to help locate the switch in a darkened room.

Off



Using Google Home and Amazon Alexa

- The ABRA In-Wall Smart Switch can be used with Google Home and Amazon Alexa, for voice and app control.

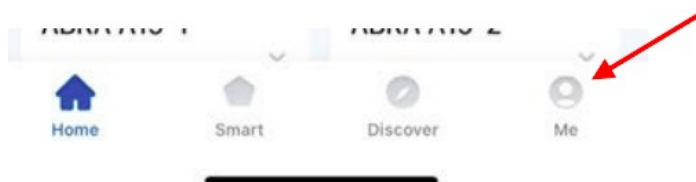

- For both Alexa and Google, tap the “Me” icon at the bottom of the screen.

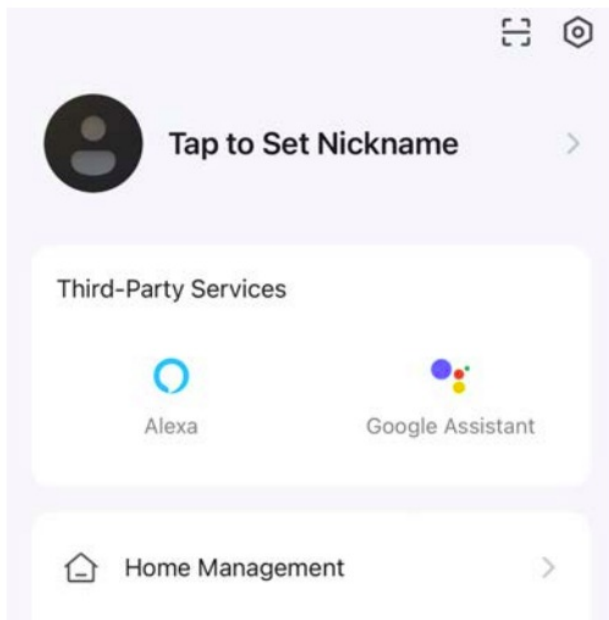

- Select either Alexa or Google.



“ABRA” on “Google”

Not yet linked to this App account, “Google” cannot obtain device status and control permissions.



Link to Google

[More ways to link](#)

- Tap “Link to Google” and follow the instructions.



Link an account to control ABRA on any device



This link will be available on devices or services where you're signed in to your Google Account.

[Cancel](#)

[Continue](#)



Intermatic ABRA

Link your Intermatic ABRA account with Google

The App will have the following permissions after authorization.

· Devices control permission

Agree and link

Cancel

- Tap “Agree and link” to proceed with the account linking.



Google



“ABRA” skill has been linked

“ABRA” on platform “Google” has obtained the device status and control permissions.

- Successful account linking will be confirmed. You can now use Google voice commands to control your ABRA switch.

Account Linking



Link ABRA with Alexa

Enable the ABRA skill and link your account with Alexa.

To unlink your account at any time, disable the skill in the Alexa app.

New look, same features.
Tap to talk to Alexa and more.

CANCEL

LINK

- The process is similar when linking ABRA to your Alexa account.

ABRA and Siri

- ABRA supports Siri voice commands on Apple devices.
- Unlike Google Home and Amazon Alexa, each Siri voice command for ABRA must be created from scratch.
- However, the process of creating Siri voice commands for ABRA (e.g., "Hey Siri, turn lights ON") is not difficult.

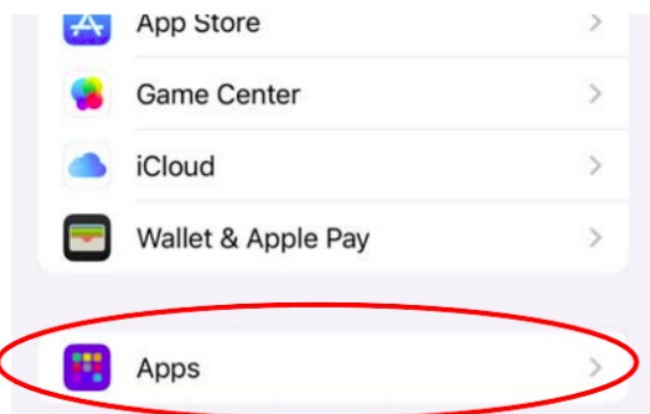

- Start by going to Settings on your iOS device, then scroll down to "Apps."

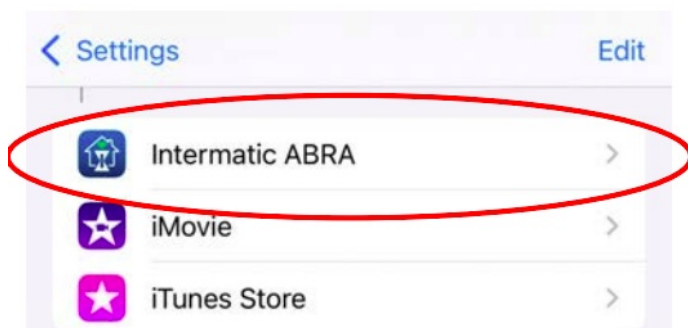

- Select the Intermatic ABRA app.



- Select “Siri.”

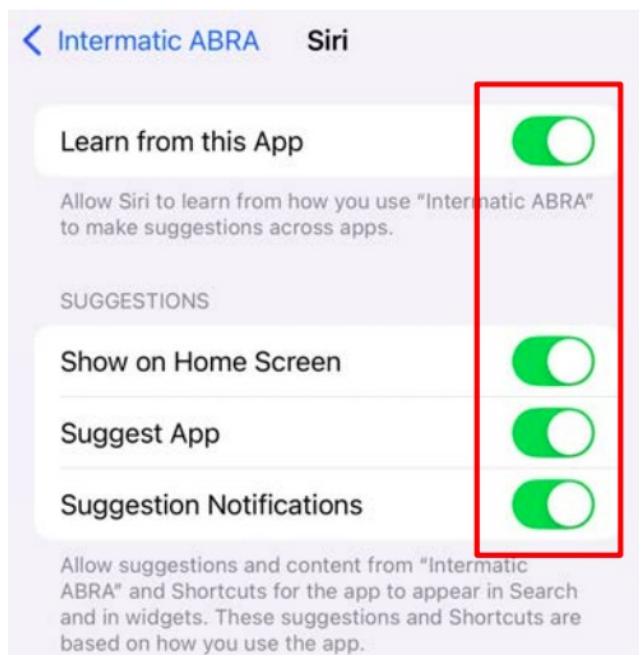

- Allow all permissions for Siri within the ABRA app.
- Exit “Settings.”

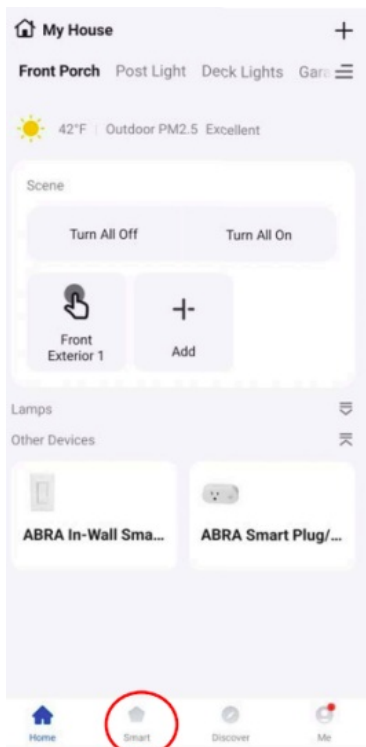

- In the ABRA app, select “Smart.”
- Select “Tap-to-Run, then tap “Create Smart Task.”

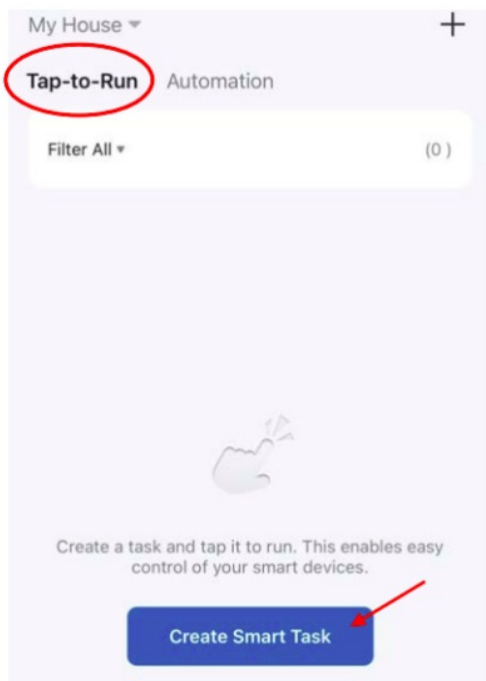

- Select “Launch Tap-to-Run.”

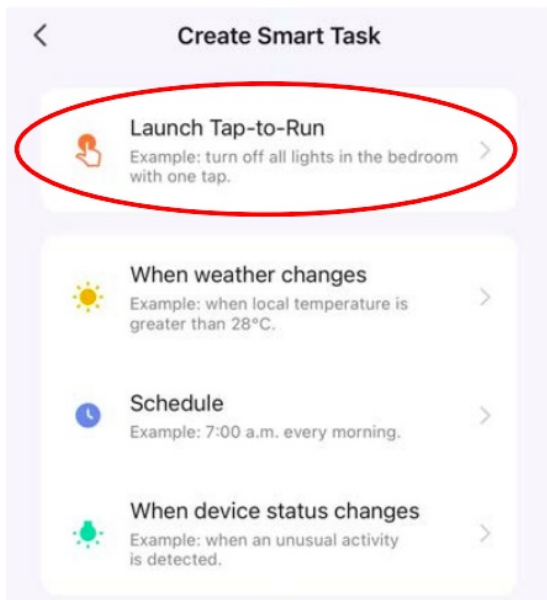

- Select the “+” symbol next to “Then” to define the task.

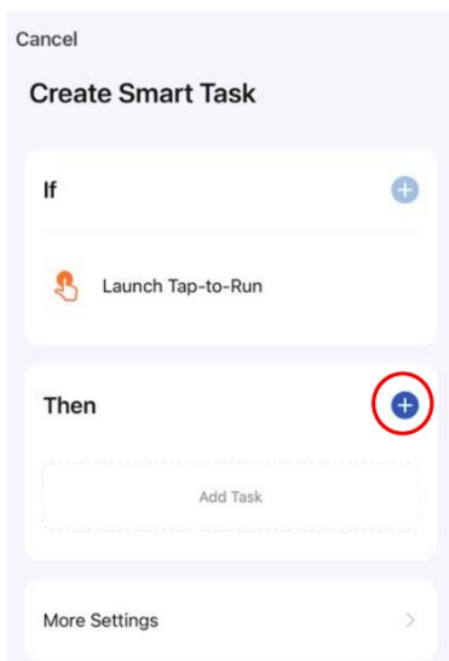

- A sub-menu appears with several options.
- Here you can define a task that controls a single device or a task that triggers a smart scene.
- In this example we'll select “Control Single Device.”

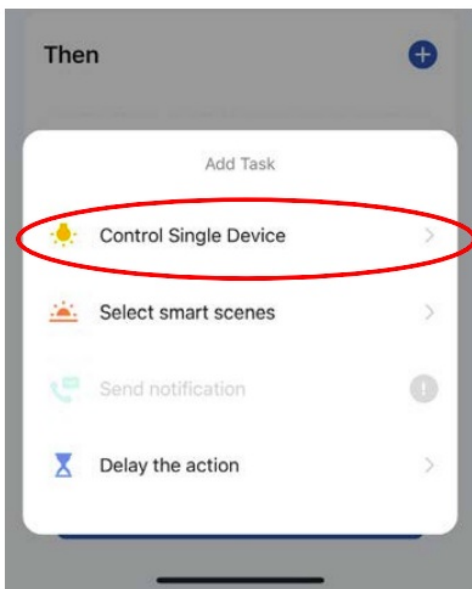

- Scroll horizontally to find the desired Room.
- The devices in each Room appear in the list.
- In this example, we'll select the "ABRA In-Wall Smart Switch" located in the space called "Front Porch."

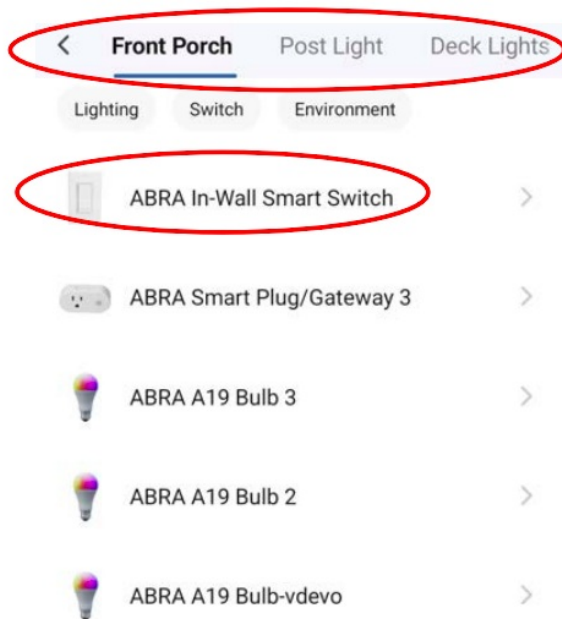

- There are 3 functions for this device: ON, OFF, and Reverse Switch. For this example we'll select "ON."
- Tap "Save," then "Next" at the top of the screen.

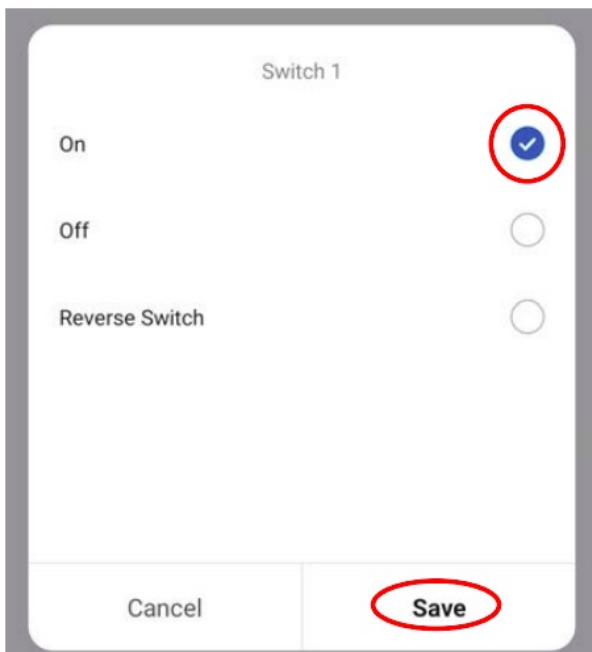

- The Smart Task itself is saved, but you will still need to give it a name.
- This is a critical step because Siri will use that name as the voice command.
- Tap “Save” to name the Smart Task and define the Siri voice command.

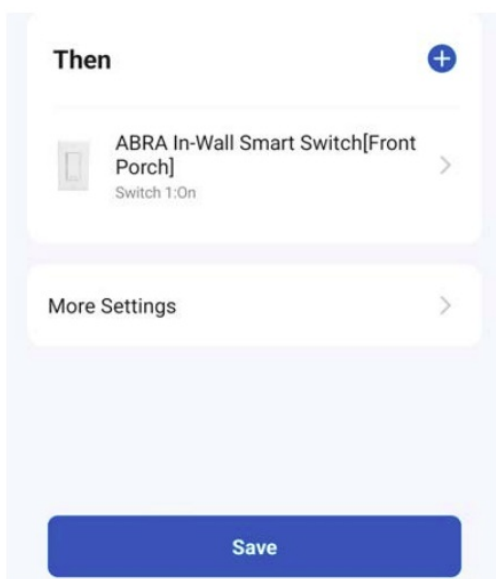

- For this example, let’s call the Scene “Porch Light On” and tap “Confirm.”

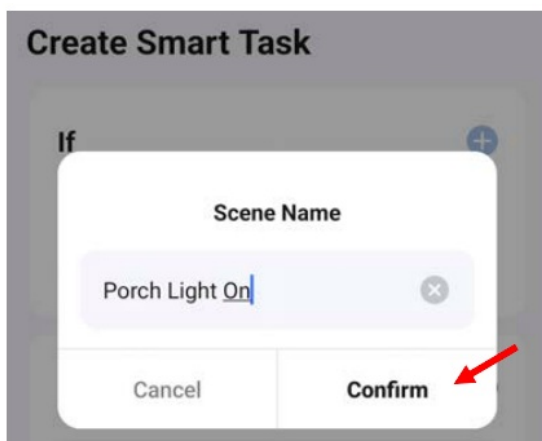

- The “Porch Light On” scene is now saved on the Smart> Tap-to-Run page.

- Tap the “Add to Siri” button to save the new Siri voice command.

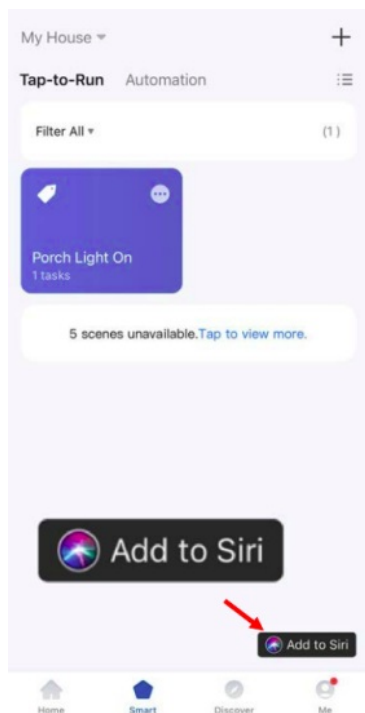

- “Porch Light On” is added to the Siri Shortcut List.
- Tap on the shortcut to edit the Siri command if needed.

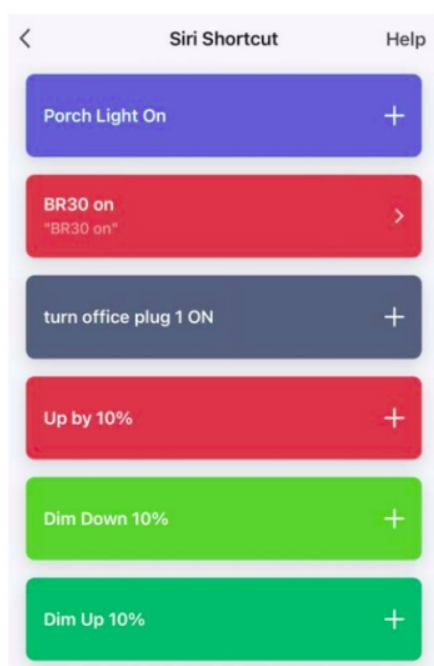

- To adjust the shortcut phrase, simply tap “Change Voice Phrase.”



**"Hey Siri,
Porch Light On"**

Shortcut added. To use it, say this phrase
to Siri

[Change Voice Phrase](#)

- You can simply say the new phrase into your device and Siri will automatically turn the phrase into the new Siri voice command.
- For example, you can change the phrase to "Hey Siri, turn porch light on."



**"Hey Siri,
Hey Siri turn porch
light on"**

Shortcut added. To use it, say this phrase
to Siri.

[Change Voice Phrase](#)

- Tap "Done" to save the new phrase.
- Once you've saved your Siri voice commands to the Siri Shortcut List, you can use Siri at any time to activate a lighting scene or a particular function for any of your ABRA devices.

[Edit in Shortcuts](#)



"Hey Siri,
Hey Siri **turn porch**
light on"

Shortcut added. To use it, say this phrase
to Siri.

[Change Voice Phrase](#)



Done

[Remove Shortcut](#)

In-Wall Smart Switch and Matter

- The Intermatic In-Wall Smart Switch is Matter-certified, allowing it to work with any Matter-compatible Smart Home platform.
- Matter is a new industry standard for smart devices, enabling simple pairing and consistent performance across all Matter-compatible platforms and brands.



Apple Home



Google Home



SmartThings

- Popular Matter-compliant platforms include Amazon Alexa, Apple Home, Google Home, and Samsung SmartThings.
- This is different than linking your ABRA account with your Google Home or Amazon Alex account for voice control.



- The Matter QR Code can be found on the front of the In-Wall Switch.
- Follow the Matter-specific instructions from your smart home platform provider to add the Intermatic switch.

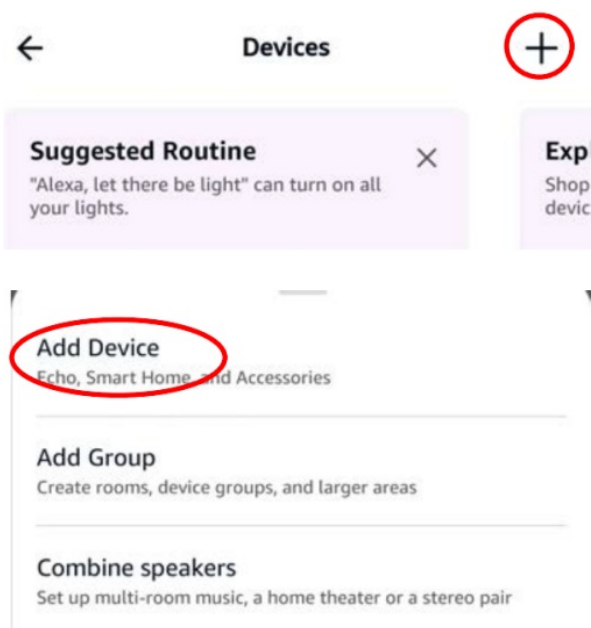

- For example, in the Alexa app you'll begin by tapping the "+" icon to "Add Device."

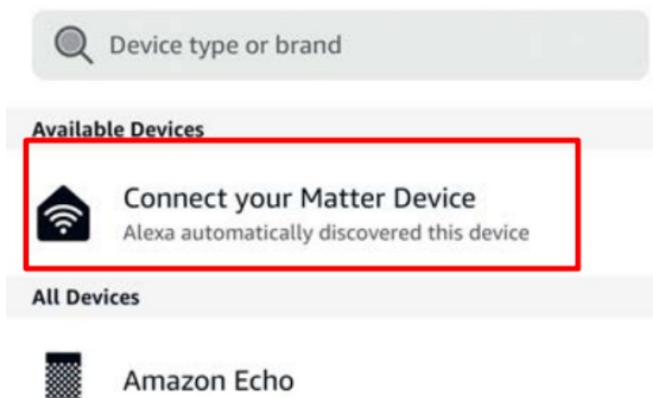

- Choose "Select your Matter Device" at the top of the menu.



Control your Matter device with Alexa

Once you connect your Matter device to Alexa, you can say things like,

- "Alexa, turn on device"
 - "Alexa, turn off device"
- From there, the Alexa app will walk you through the discovery and pairing process.



Does your device have a Matter logo?

You can find it inside the device box, Quick Start Guide or on the device.



Locate a QR code shown for your device

- Regardless of the app, you'll have the opportunity to scan the code with your phone's camera or enter it numerically.
- Once added, you can use the functions in your platform's app to control, manage, and schedule your Intermatic In-Wall Smart Switch.



Contents [[hide](#)]

1 Documents / Resources

1.1 References

Documents / Resources

	INTERMATIC A3400 ABRA In Wall Smart Switch [pdf] User Guide A3400 ABRA In Wall Smart Switch, A3400, ABRA In Wall Smart Switch, I n Wall Smart Switch, Smart Switch, Switch
---	--

References

- [User Manual](#)

📁 Intermatic

🔍 A3400, A3400 ABRA In Wall Smart Switch, ABRA In Wall Smart Switch, In-Wall Smart Switch, INTERMATIC, Smart Switch, switch

Leave a comment

Your email address will not be published. Required fields are marked *

Comment *

Name

Email

Website

☐ Save my name, email, and website in this browser for the next time I comment.

Post Comment

Search:

e.g. whirlpool wrf535swhz

Search

[Manuals+](#) | [Upload](#) | [Deep Search](#) | [Privacy Policy](#) | [@manuals.plus](#) | [YouTube](#)

This website is an independent publication and is neither affiliated with nor endorsed by any of the trademark owners. The "Bluetooth®" word mark and logos are registered trademarks owned by Bluetooth SIG, Inc. The "Wi-Fi®" word mark and logos are registered trademarks owned by the Wi-Fi Alliance. Any use of these marks on this website does not imply any affiliation with or endorsement.