



INTELVOICE T10 AI Language Translator Device User Manual

[Home](#) » [INTELVOICE](#) » INTELVOICE T10 AI Language Translator Device User Manual 

*INTELVOICE T10 AI Language Translator Device
User Manual*



Contents

- [1 FCC Statement](#)
- [2 Product Package Content](#)
- [3 Buttons Introduction](#)
- [4 Operation Guide](#)
- [5 Q&A Section](#)
- [6 Documents / Resources](#)
- [7 Related Posts](#)

FCC Statement

This device complies with part 15 of the FCC Rules. Operation is subject to the following two conditions: (1) This device may not cause harmful interference, and (2) this device must accept any interference received, including interference that may cause undesired operation.

This equipment has been tested and found to comply with the limits for a Class B digital device, pursuant to part 15 of the FCC Rules. These limits are designed to provide reasonable protection against harmful interference in a residential installation. This equipment generates, uses and can radiate radio frequency energy and, if not installed and used in accordance with the instructions, may cause harmful interference to radio communications. However, there is no guarantee that interference will not occur in a particular installation. If this equipment does cause harmful interference to radio or television reception, which can be determined by turning the equipment off and on, the user is encouraged to try to correct the interference by one or more of the following measures:

- Reorient or relocate the receiving antenna.
- Increase the separation between the equipment and receiver.
- Connect the equipment into an outlet on a circuit different from that to which the receiver is connected.
- Consult the dealer or an experienced radio/TV technician for help.

Caution: Any changes or modifications to this device not explicitly approved by manufacturer could void your authority to operate this equipment.

RF Exposure Information

The device has been evaluated to meet general RF exposure requirement. The device can be used in portable exposure condition without restriction.

Tips :

1. Before using the smart translator for the first time, please fully charge it.
2. We can connect to the Internet via WiFi/mobile hotspot.
Tip: The translator does not support secondary authentication WiFi, such as airport WiFi and public WiFi.
3. When the translator is in low battery mode or in weak WiFi signal, the translation timeout may be displayed. It is recommended to change the WiFi of the mobile hotspot.
4. Please read the operation manual carefully, which will show us the details of the operation of the product. We wish you will have a pleasant translation journey.

Product Package Content



This product includes the following:

- | | |
|----------------|---------------------|
| 1.translator*1 | 2.Type-CData line*1 |
| 3.manual*1 | 4.Packing box*1 |

Buttons Introduction

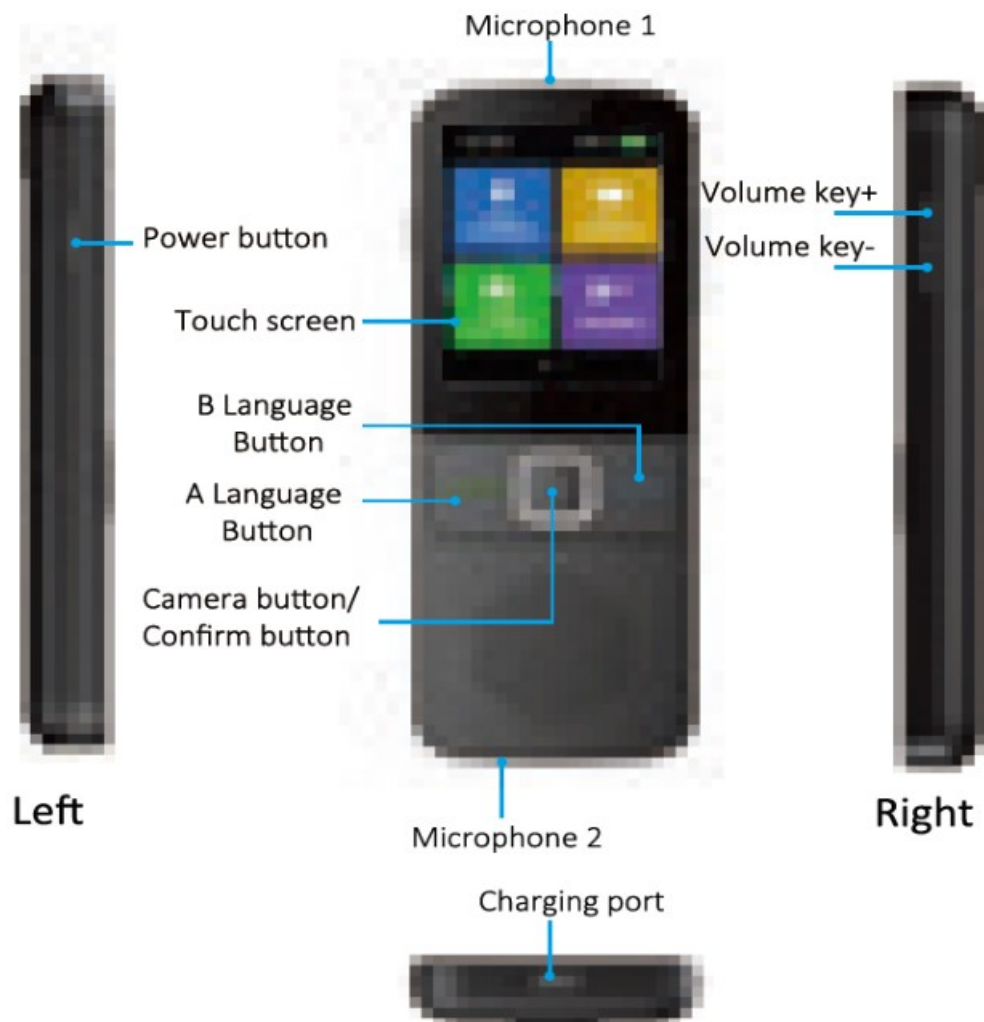

Operation Guide

1. Power On/ Power Off/ Reboot

- **Power On:** Long press the power button for 3 seconds to power on the device,
- **Power Off/ Reboot:** Long press and hold the power button for 3 seconds, it will pop up the "Power Off/Reboot" icon , click the corresponding icons to power off/restart device.
- **Unlock/Lock Screen:** Short Press the power button to unlock/lock screen.



2.Connect Network (WiFi/Hot-spot)

- Click the settings button, select WIFI, and turn on the switch button in the upper right corner.
- Select the WiFi and enter the password.
- When “Connected” is displayed under WiFi, it means that the network is connected successfully.

Note: The translator is not suitable for networks that require secondary authentication, such as airport WiFi and public WiFi.



3.Operation Guide

- The translator supports Voice Translation/ Photo Translation/ Offline Translation/ Recording Translation.
- Click the corresponding icon, we need to select A and B languages first. After clicking the language menu, select from the list of Commonlanguages, switch more other languages ,click "All" icon on the upper right conner.The operation details are shown in the figure below.



- Press and hold the A language button (Green Button) to speak A language, and the translator will automatically translate into B languages instantly.
- In the same way, press and hold the B language button (Blue Button) to speak B language, the translator will translate into A language instantly.

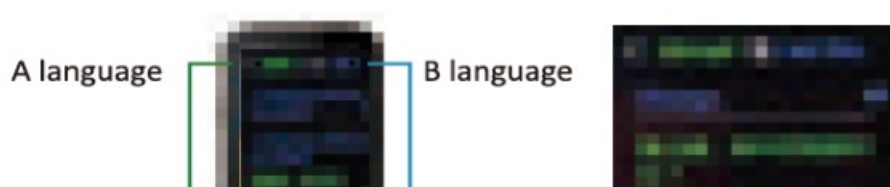



4. Voice Translation

- Support 137 languages translation (121 languages support voice broadcast).
- Click "Voice Translation" icon and select A and B language at the top of the screen.
- For detailed translation operations, please refer to the Operation Guide.
- Long press the translation results to "Favorite/Delete/Clear" the translation history.

Note: Please make sure that connected WiFi signal is good. Otherwise, a "Translation Timeout" prompt will appear on screen, when the WiFi signal is too weak. We can connect the hotspot and try again.

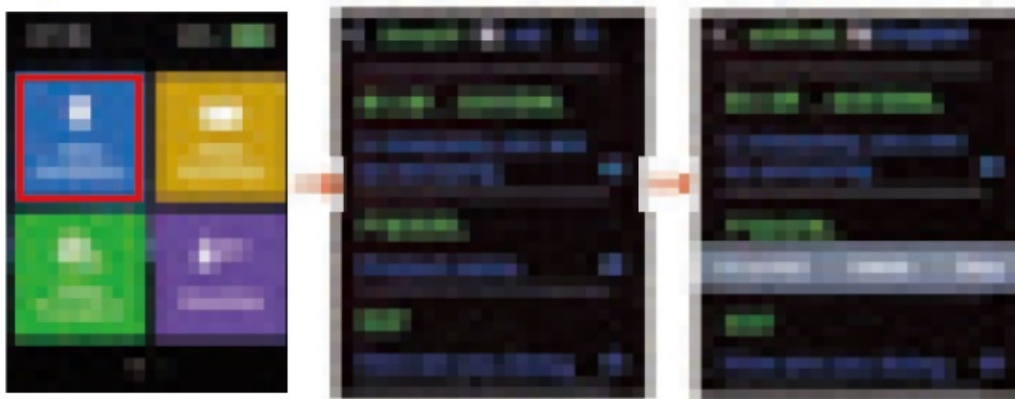

5. Photo Translation

- Photo translation supports 45 language recognition and can be translated into 137 languages.
- Click "Photo Translation" icon, please select A and B languages at the top of the screen.



- Click the camera button, the device will translate A language into B language, and support "Picture" and "Text" translation results for viewing.

- Click "Album" at the bottom left to view the history records. Long press the album icon to "Delete/Clear Translation".



6.Offline Translation

- Support 16 offline translation languages, We need to download the offline package before using offline translation.
- Steps to download offline package: Click "Settings" → "Offline Package Management" → select language and click "Download ↓" → restart the application.



- Click "Offline Translation" icon at the top of the screen. If the offline package has not been downloaded, please download it according to the above steps.
- For detailed translation operation, please refer to the Operation Guide. Long press the translation results to "Favorite/Delete/Clear" the translation history.

Note: It is recommended to connect the network and used online translation first. The offline translation is only for simple words.



7. Recording Translation

- Recording translation supports 4 languages: Chinese (Simplified) / Chinese (Traditional) / Cantonese / English
- Click "Recording Translation" icon, select A and B languages at the top of the screen.

•Click the "Start Recording" icon to start recording, the left button can switch display languages, and start the recording.

•Click the "History" icon to view recording history, long press the history to delete the history.

•The recording time is 1 hour.

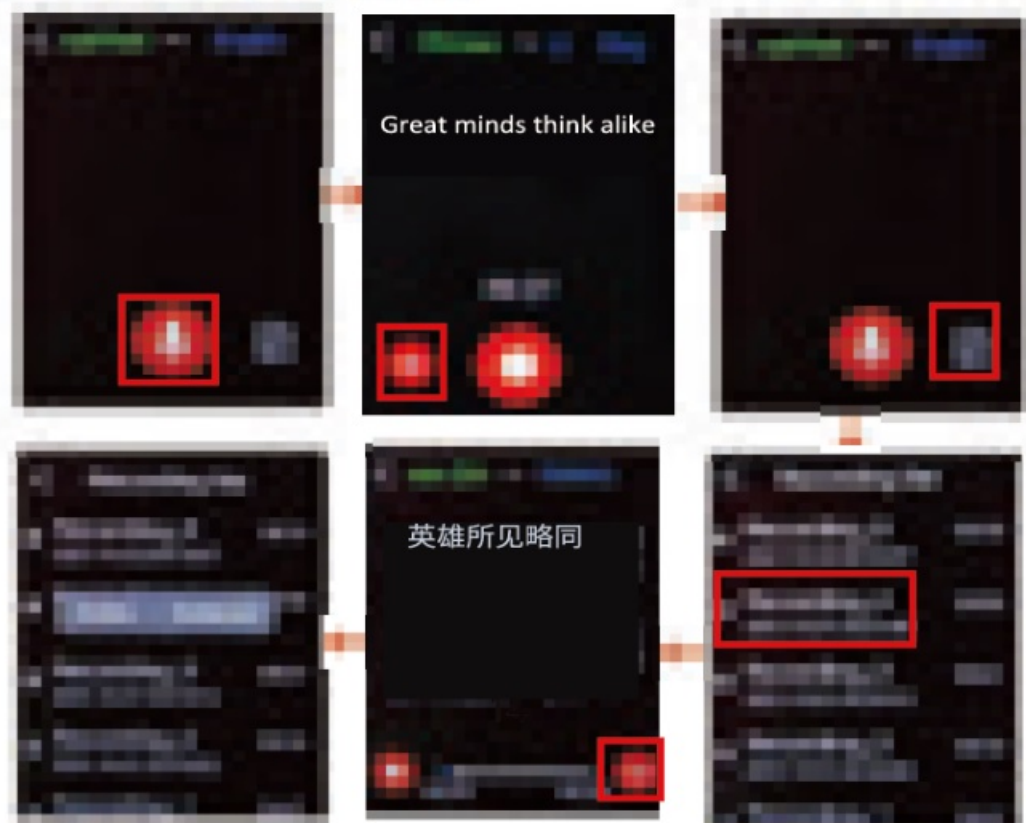

8. Conference

- Conference requires 2 or more devices, click the "Conference" icon, click create, and enter the ID of the other device.
- After the devices are connected, devices can realize simultaneous translation.

9. Exchange rate conversion

Click on the exchange rate tool to perform exchange rate conversion. This product supports 24 currency conversions: RMB/USD/GBP/HKD/MOP/JPY/Korean Won/Swiss Franc/Canadian Dollar/SGD/Swedish Krona/Denmark/Norwegian Krone/ Australian dollar / New Zealand dollar / Malaysian ringgit / South African rand / Philippine peso / Thai baht / Russian ruble / Saudi riyal / New Taiwan dollar / UAE dirham / Vietnamese dong.

10. Language Learning

- Click on the "Follow Up" icon, and select A and B languages at the top of the screen.
- Long press and hold the A language Button to speak language A, the device will automatically translate into language B.
- At the upper right of the sentence, click "Follow Up" icon to follow up the words, the device will score your pronunciation according to the standard level.

Q&A Section

1. What is the translation effect of the translator?

- In daily communication, the accuracy rate of online translation is as high as 98%.
- The voice speaker is up to level of a general announcer.

2. How do we connect to the Internet?

It supports to connect the WiFi or hotspot .

Note: The translator is not suitable for secondary authentication Internet, such as WiFi at the airport.

3. If we don't have a network, how to use the translator?

- The translator currently supports offline translation in 16 languages: Chinese/Simplified Chinese/Traditional Chinese/English(US)/English (English)/English(Canada)/English(Australia)/English(India)/Spanish/ Portuguese/Russian/German/ Japanese/ Korean/ French/ Italian/ Dutch.
- We recommend to used online translation, offline translation is only suitable for simple conversations.

4. Compared with the translation App, what's the advantages of the translator?

- The accuracy rate is higher than the translation app.
- It's not only supports online translation, but also supports photo translation, recording translation and offline translation (the App not support these function).
- Supports long-distance language recognition, dual-mic noise reduction, loud and clear speaker.
- Support two-way translation, 137 languages online translation, operation is much more convenient than App.

5. How long for the standby time/ working time?

The translator uses a 1500 mAh polymer battery, which can be used for about 3~4 hours in normal operation and about 48~72 hours in standby time. It only takes about 2~3 hours to charge, and it can be used repeatedly.

6. Why can't I enter the homepage of the translator? Why can't I power off the device?

Press and hold the power button for 15 seconds to force restart the device, and it can be used normally after restarting.

7. Why does the translator display the prompts "Translation Timeout/Unrecognized"?

Translation timeout: When WiFi network is too weak or release the button too quick. Please connect hotspot WiFi and try again.

Unrecognizable: The translator didn't recognize the voice. Please speak loudly with standard pronunciation.

Documents / Resources

	<p>INTELVOICE T10 AI Language Translator Device [pdf] User Manual T10, 2A7HI-T10, 2A7HIT10, AI Language Translator Device, T10 AI Language Translator Device</p>
---	--