



IntelLink INT1KPWF WiFi Access Control User Guide

[Home](#) » [IntelLink](#) » IntelLink INT1KPWF WiFi Access Control User Guide 



Contents

- 1 INT1KPWF WiFi Access Control
- 2 APP OPERATION
- 3 REGISTER & LOGIN
- 4 ADD DEVICE
- 5 MEMBER MANAGEMENT
- 6 USER MANAGEMENT
- 7 TEMPORARY CODE
- 8 SETTINGS
- 9 LOG (INCLUDING OPEN HISTORY AND ALARMS)
- 10 REMOVE DEVICE
- 11 Documents / Resources
 - 11.1 References
- 12 Related Posts

INT1KPWF WiFi Access Control

Introduction

This device is a Wi-Fi based Touch Key Access Keypad & RFID Reader. You can install the free IntelLink mobile App to easily control access to the door using your smartphone. The App supports and manages up to 1000 users (100 Fingerprint & 888 Card/PIN Users); and supports 500 mobile app users.

APP OPERATION

Here are just a few steps to get started:

1. Download the free IntelLink App.

Tip: Search for “IntelLink” on Google Play or Apple App Store.

2. Ensure your smart phone is connected to your Wi-Fi network.



REGISTER & LOGIN

Tap ‘Sign Up’. Enter your email address to register a free account.

Tap “Get Verification Code” (You will receive a security code via your email).

After registration, log into your new App account.

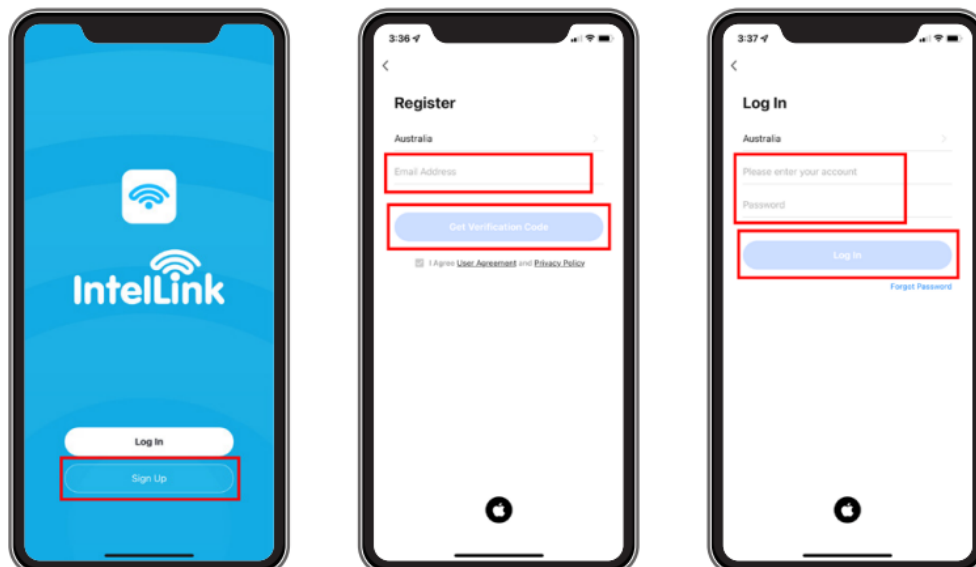

ADD DEVICE

You can add device by clicking ‘Add Device’ or clicking ‘+’ on the top.

Tip: Turning on Bluetooth may make it easier to find and add the **device**.

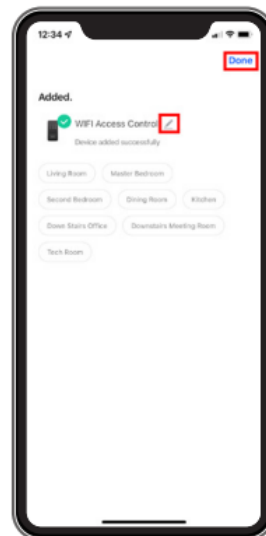
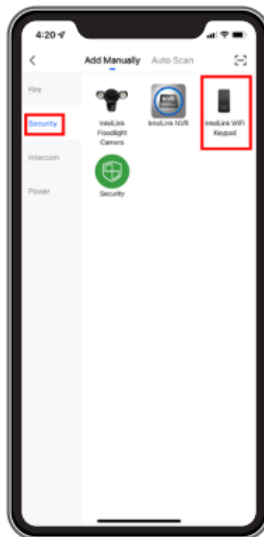
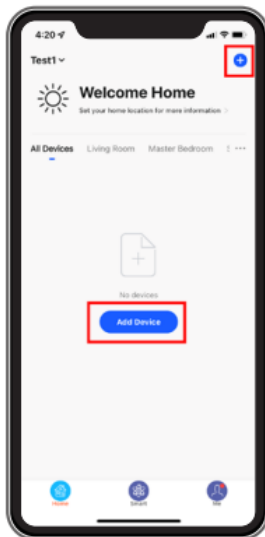

Note: To better manage the device and family members, you will need to create a HOME before you begin to manage this device.

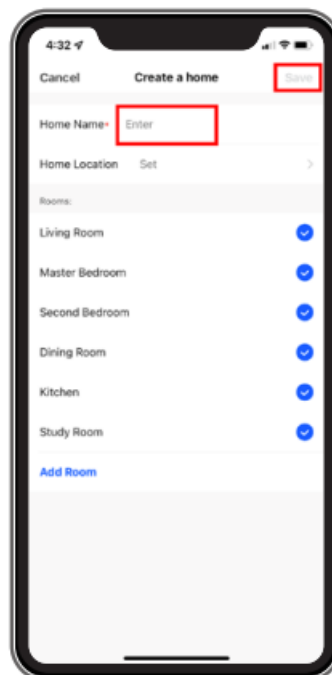
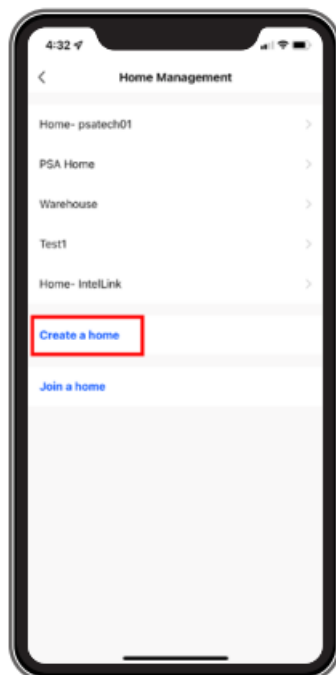

Attention: When the user first Open the lock through APP, APP will ask you to Switch on 'remote unlock' first.

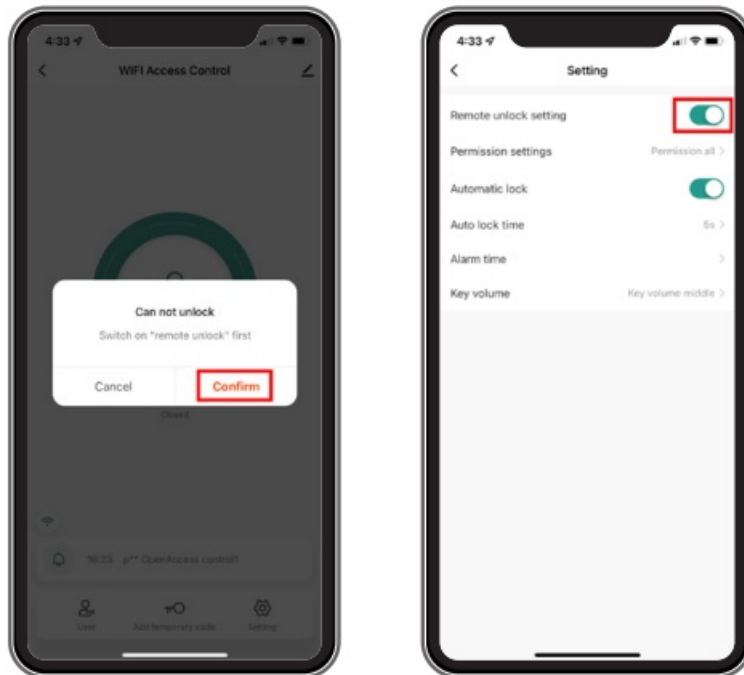

MEMBER MANAGEMENT

Note: The first to add the device is the Owner.

Authority	Owner	Admin	Ordinary Member
Open the door	✓	✓	✓
Member Management	✓	✓	X
User Management	✓	✓	X
Set Users as Admin	✓	X	X
View All Records	✓	✓	X
Set Relay Time	✓	✓	X

USER MANAGEMENT

4.1 Add Members

New members must first register an App account for sharing.

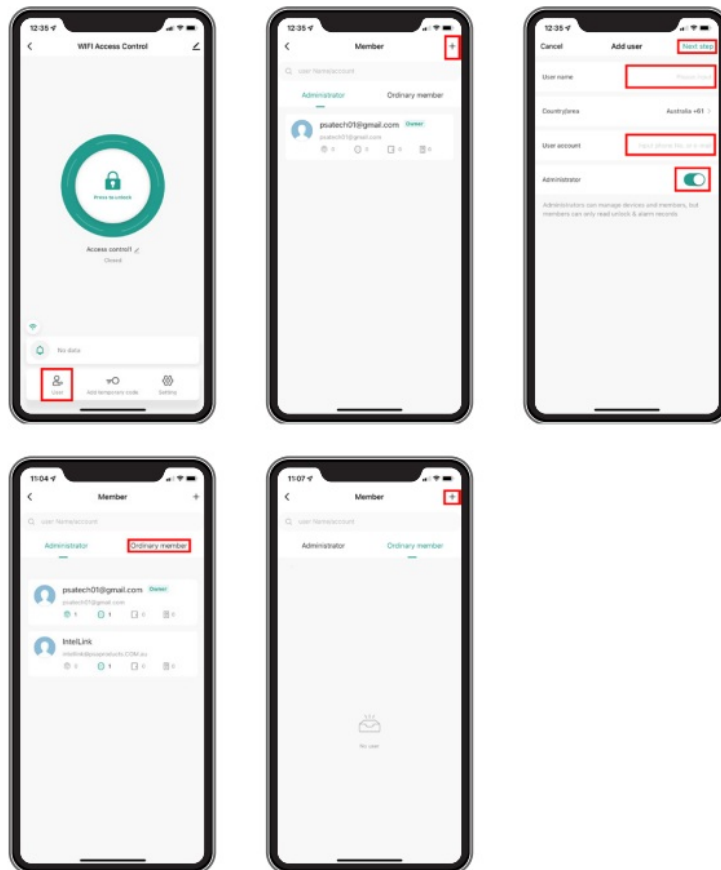

Remark: When adding members, the Owner can decide to add the user as Admin or Ordinary member

4.2 Manage Members

Owner can decide effective time (Permanent or Limited) of the members

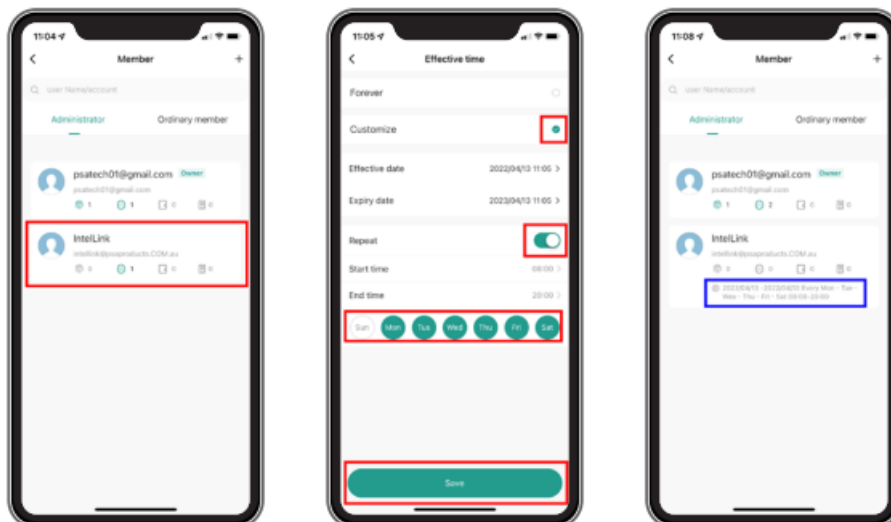

(Same operation for Ordinary member)

4.3 Delete Members

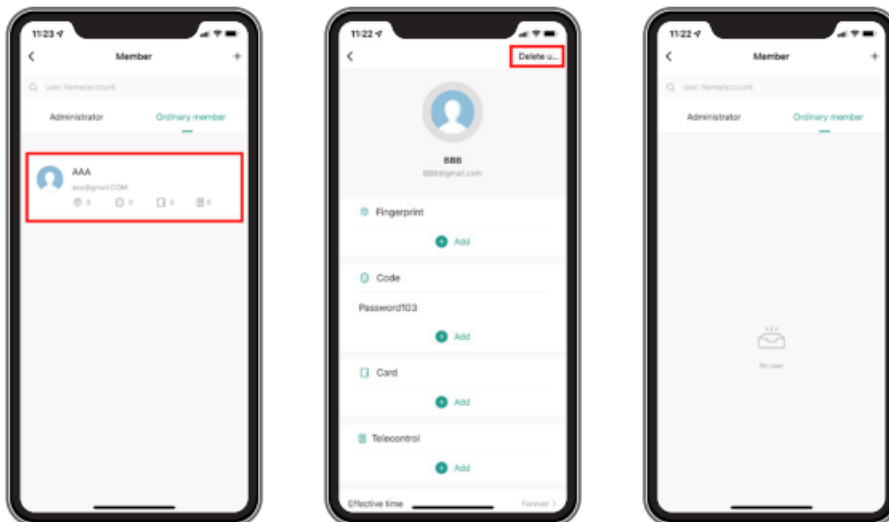

4.4 Add Users (Fingerprint/ PIN/ Card Users)

The APP supports Add/Delete Fingerprint / PIN / Card users.

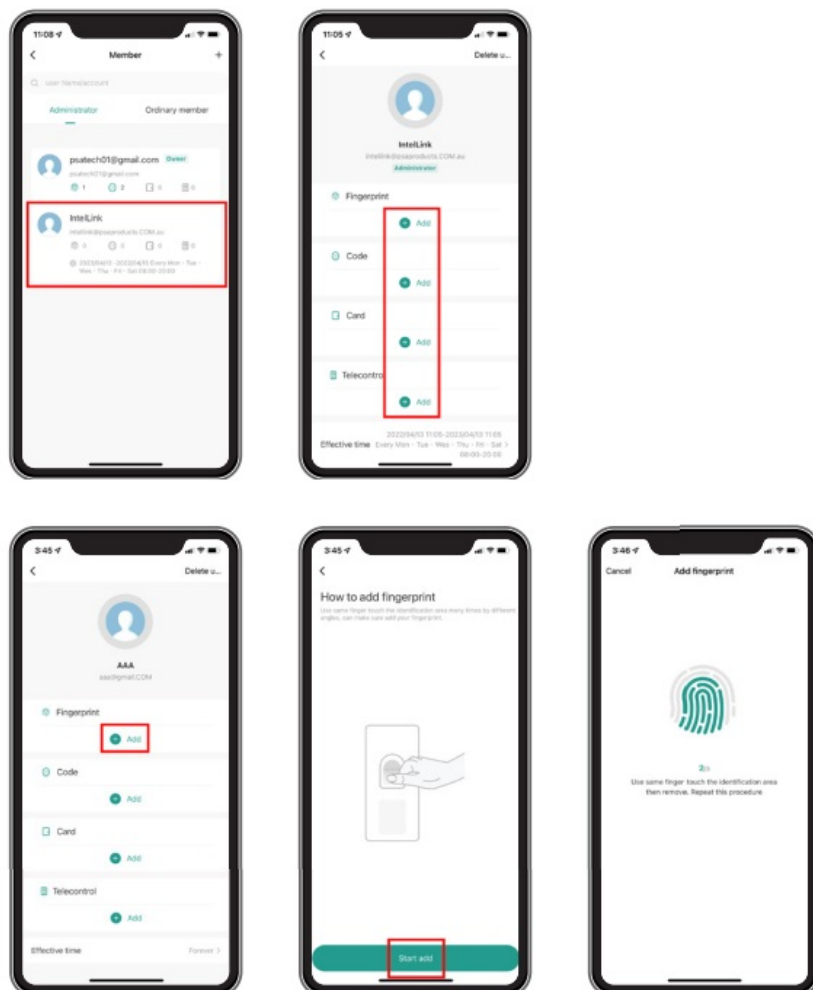

For adding PIN & Card users. same operation as adding Fingerprint user.

TIP: Enter a new PIN Code that had not been previously assigned.

Duplicated PIN Codes will be rejected by the App, and will not be displayed against the User.

4.5 Delete Users (Fingerprint/ PIN / Card Users)

For deleting PIN & Card users, same operation as deleting Fingerprint user.

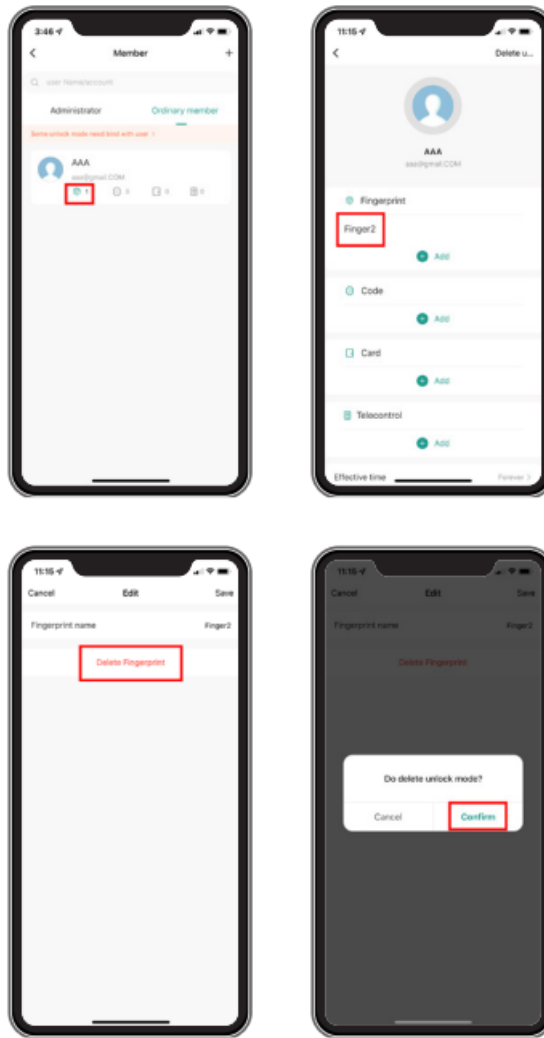

TEMPORARY CODE

The Temporary Code can be shared via messaging tools (eg. WhatsApp, Skype, WeChat), or via email to the guest/users. There are two types of Temporary Code. **Cyclicality:** For example, valid at 9:00am – 6:00pm every Monday – Friday during August – **October**.

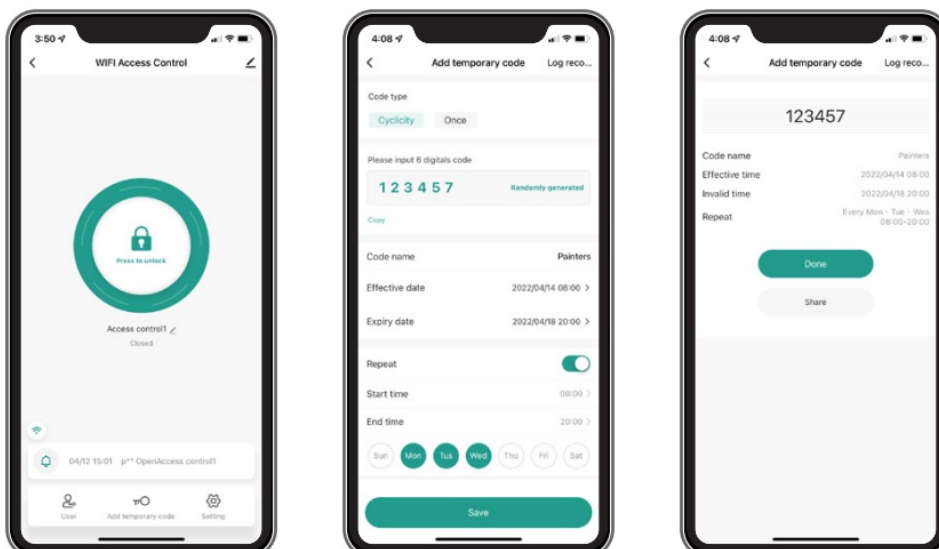

Once: One-time code is valid for 6-hours, and can only be used once.

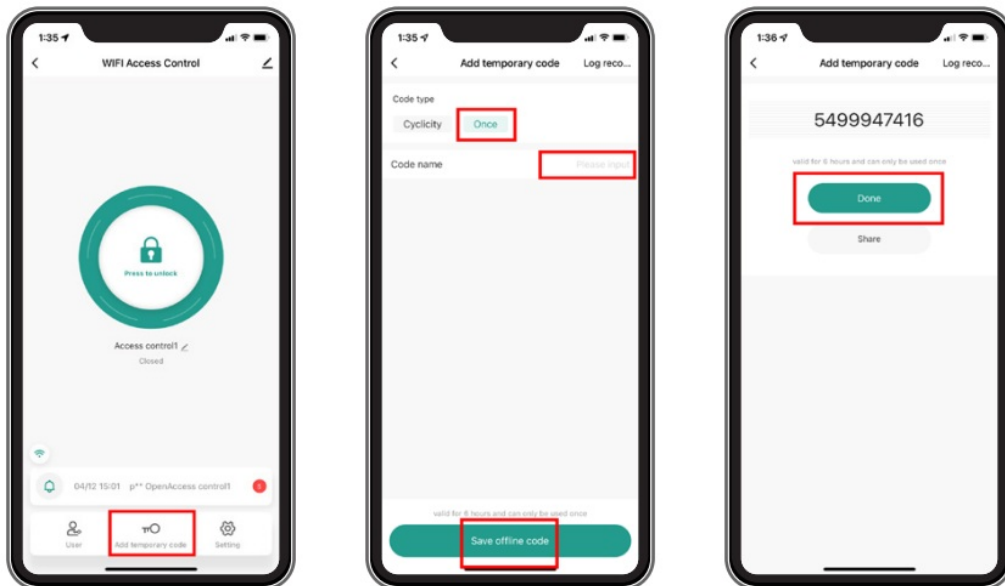

5.1 Edit Temporary Code

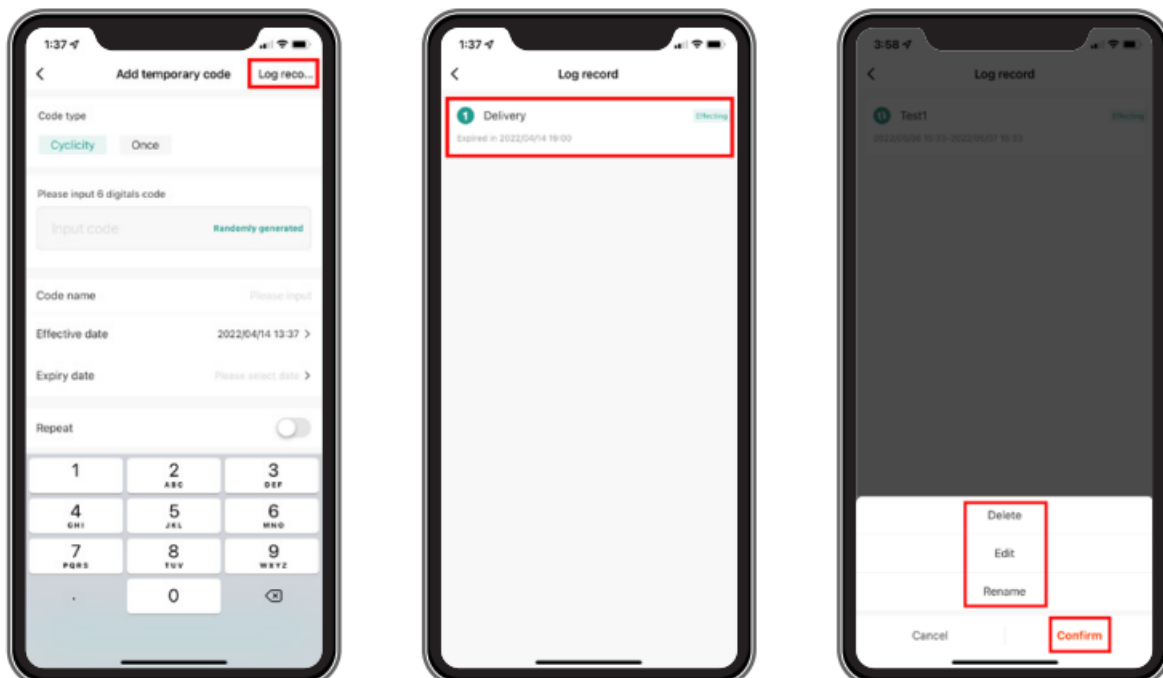

The Temporary Code can be deleted, edited or renamed during the valid period.

SETTINGS

6.1 Remote unlock setting

Default is OFF. When the device is first added, you will be prompted to turn ON this setting. If turned OFF, all mobile users cannot remotely operate the lock via their App.

6.2 Automatic Lock

Default Is on.

Automatic Lock on: Pulse Mode

Automatic Lock off: Latch Mode

6.3 Auto lock time

Default is 5 seconds. It can be set from 0 – 100 seconds.

6.4 Alarm time

Default is 1 minute. Can be set from 1 to 3 minutes.

6.5 Key Volume

Can be set to: Mute, Low, Middle and High.

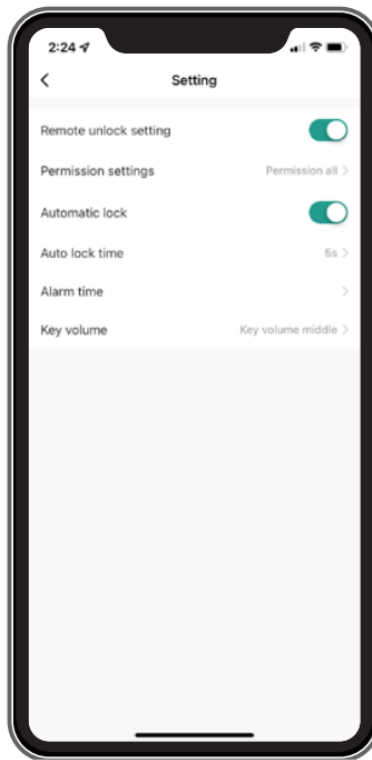

LOG (INCLUDING OPEN HISTORY AND ALARMS)

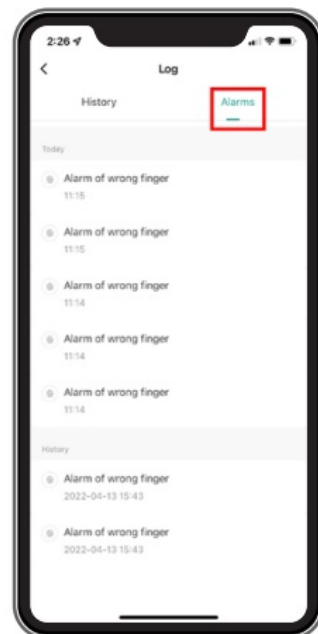
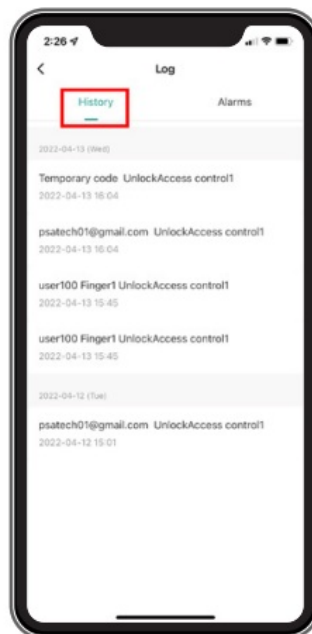
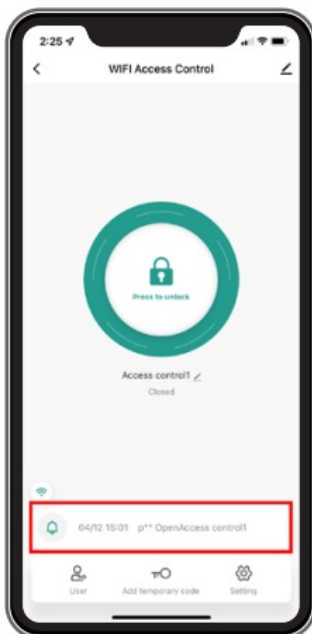

REMOVE DEVICE

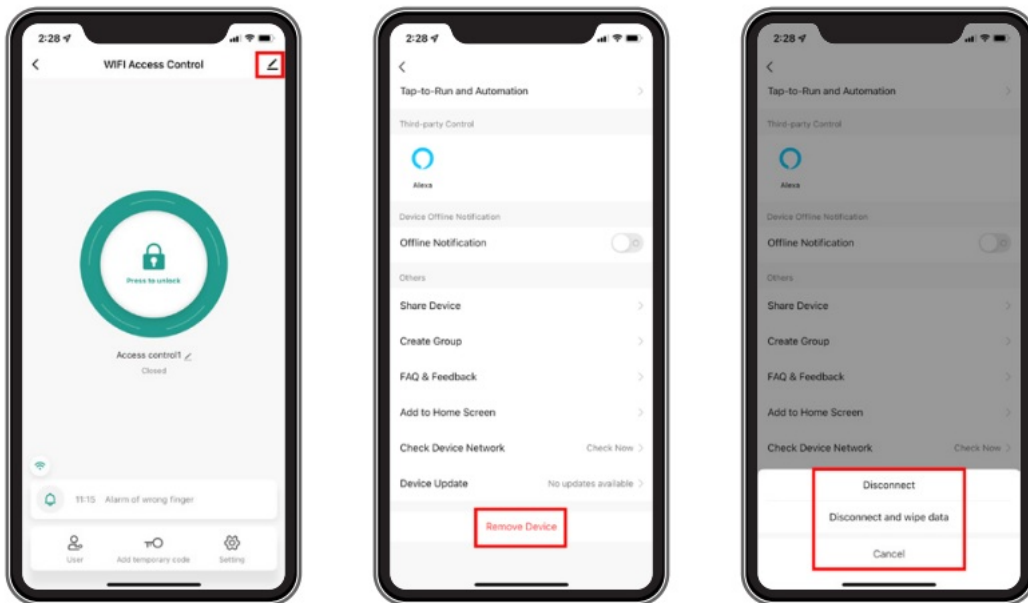

NOTE

Disconnect Removes the device from this App user account. If the Owner account disconnects, then the device is unbound; and all members will also lose access to the device. However, all user information (eg. cards / fingerprints / codes) is retained within the device.

Disconnect and wipe data Unbinds the device and deletes all stored user settings (The device can then be bound to a new Owner account)

Code Sequence to Unbind Device Using Keypad (Default Master Code is 123456)

* (Master Code)

9 (Master Code)# *

Power reset the device before pairing with a new Owner App account.

TIP: To change the Master Code, please refer to User Manual.

ATTENTION

The following functions are not accessible via the App:

1. 'Change PIN'
2. 'Card+ PIN' Access Mode
3. "Tips for PIN Security"— Hides your correct PIN with other numbers up to a max of 9 digits only.



17 Millicent Street, Burwood, VIC 3125 Australia

Tel: 1300 772 776 Fax: (03) 9888 9993

enquiry@psaproducts.com.au

psaproducts.com.au



Produced by PSA Products (www.psaproducts.com.au).

Version 1.0 May 2022



[IntelLink INT1KPWF WiFi Access Control](#) [pdf] User Guide
INT1KPWF, INT1KPWF WiFi Access Control, WiFi Access Control, Access Control, Control

References

- [PSA Home - PSA Products](#)
- [PSA Home - PSA Products](#)