

Intelligent MQ01 Smart Lock

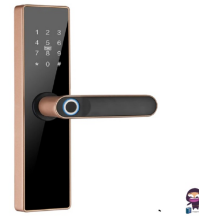

Intelligent MQ01 Smart Lock User Manual

[Home](#) » [Intelligent](#) » Intelligent MQ01 Smart Lock User Manual 

Contents

- [1 Intelligent MQ01 Smart Lock](#)
- [2 Part1. Appearance Display](#)
- [3 Part2. Packing List](#)
- [4 Part3.Feature List](#)
- [5 Part4.How to programm through the APP](#)
- [6 Parts.How to perform local programming](#)
- [7 Part6.How to unlock outdoor](#)
- [8 Part10.Troubleshooting](#)
- [9 FCC Warning](#)
- [10 Documents / Resources](#)
 - [10.1 References](#)
- [11 Related Posts](#)

Intelligent

Intelligent MQ01 Smart Lock



Smart Lock Product Manual
(MQ 01)

Part1. Appearance Display

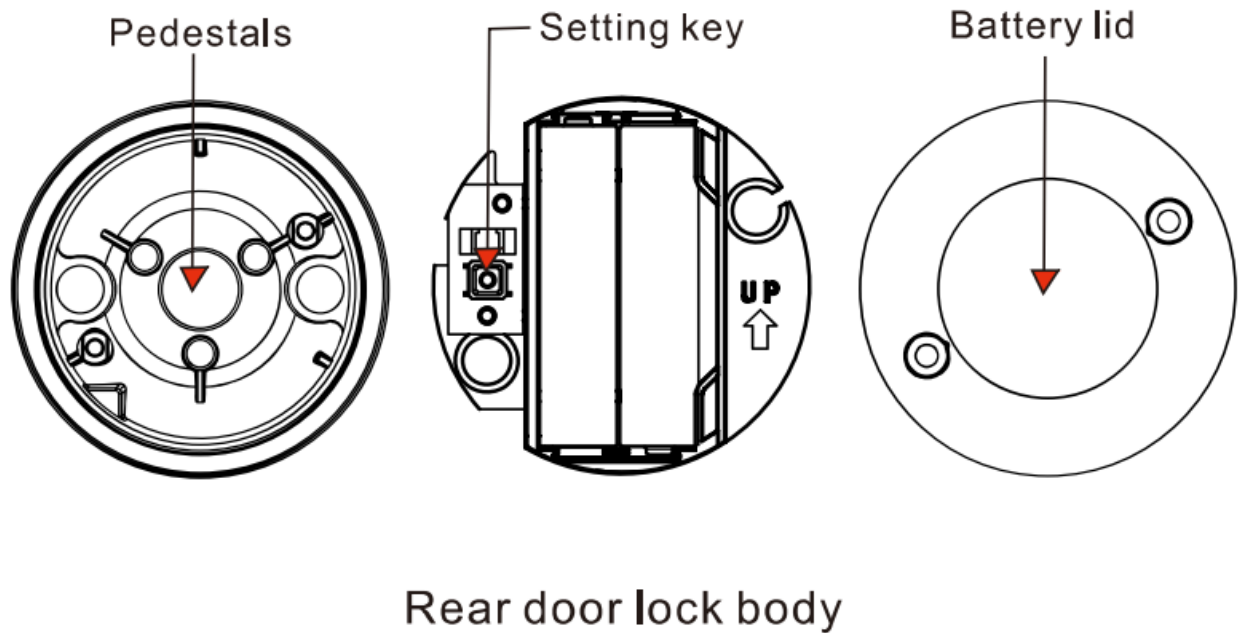
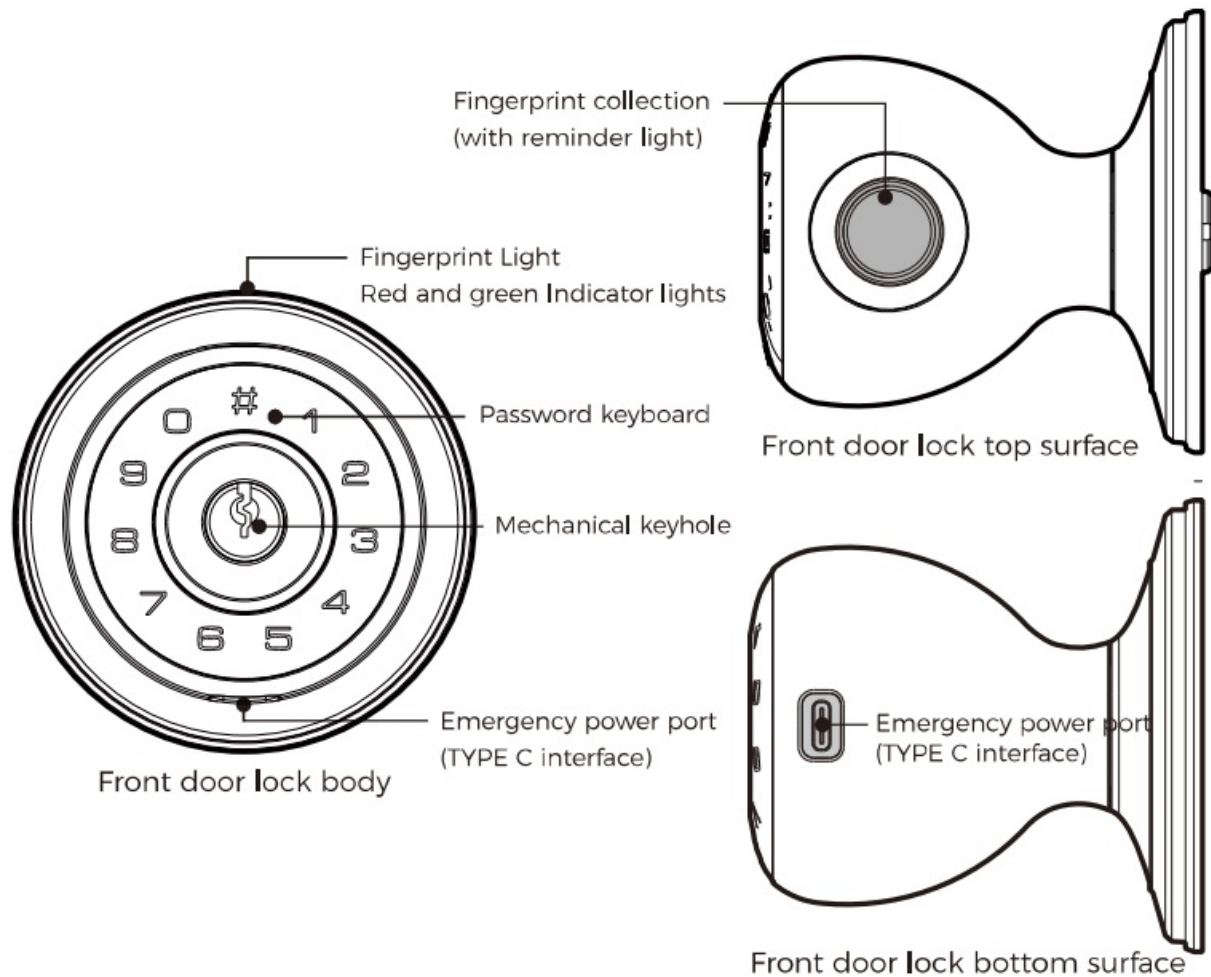

Part2. Packing List

No.	Item	Number
1	Exterior Part	1
2	Interior Part	1
3	Latch	1
4	Mechanical Key	2
5	Product & Installation Manual	2
6	Installation of auxiliary material package	1
7	Drilling Diagram	1

Part3.Feature List



Code
Unlock



Fingerprint
Unlock



Mechanical
Unlock



Mobile APP
Full Control



Voice
Prompt



Alarm
Reminder



Emergency
Power Supply



Auto-lock

Part4.How to programm through the APP

- Step 1.** Scan the QR-Code or download the smart life APP from APP store.
- Step 2.** Install the smart life APP and open the APP.
- Step 3.** Add device, please ensure that the door lock is in initialization mode. Notes: Need to turn on the Bluetooth switch on the phone and close to the door lock

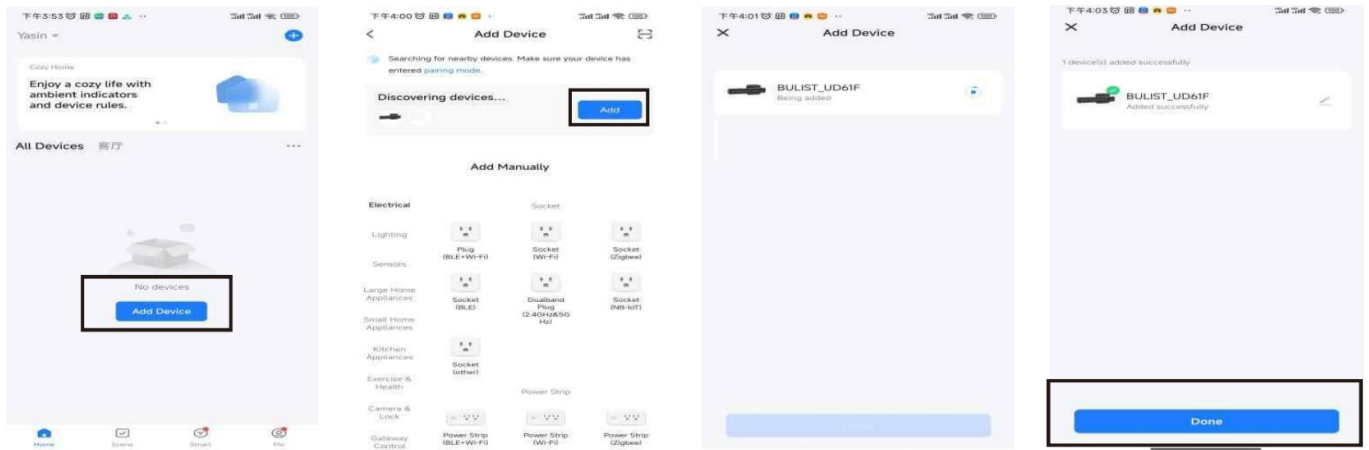

You can add the Tuya BLE/Wi-Fi gateway to enable remote management.

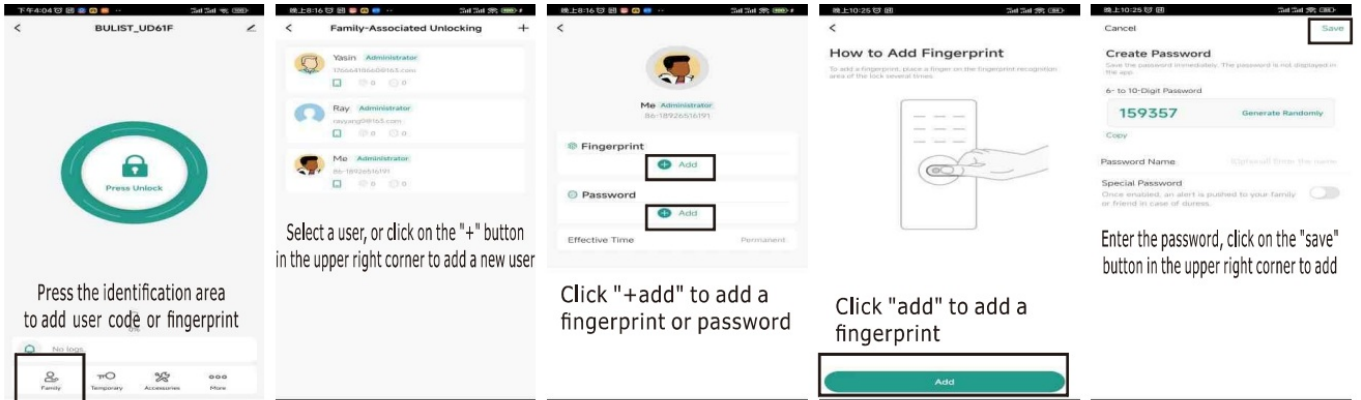

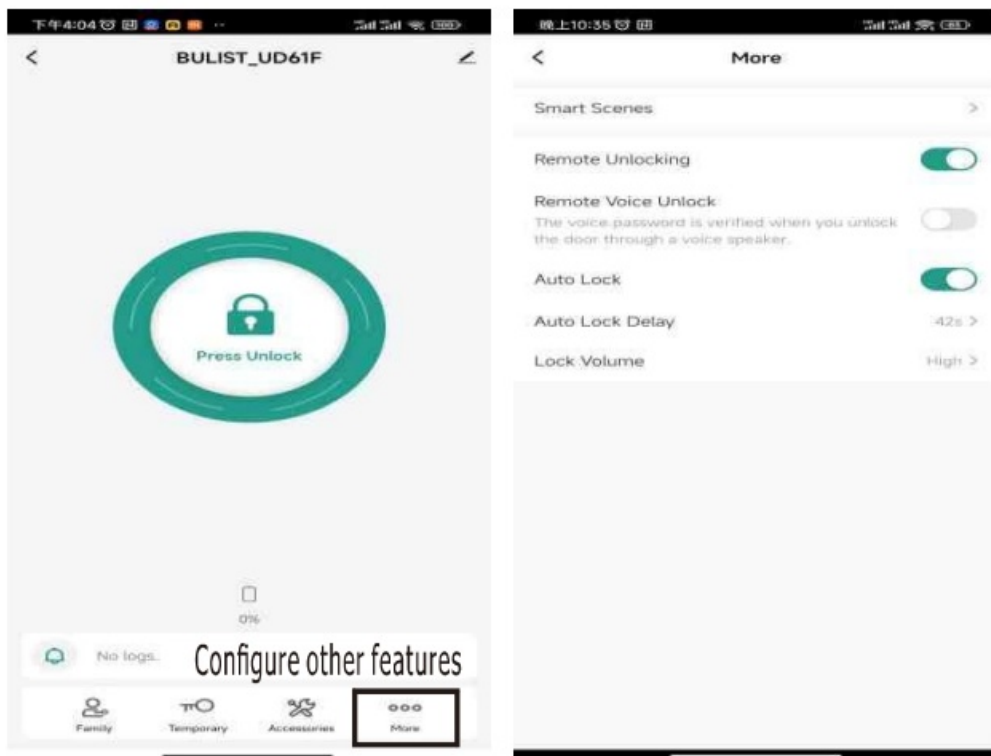
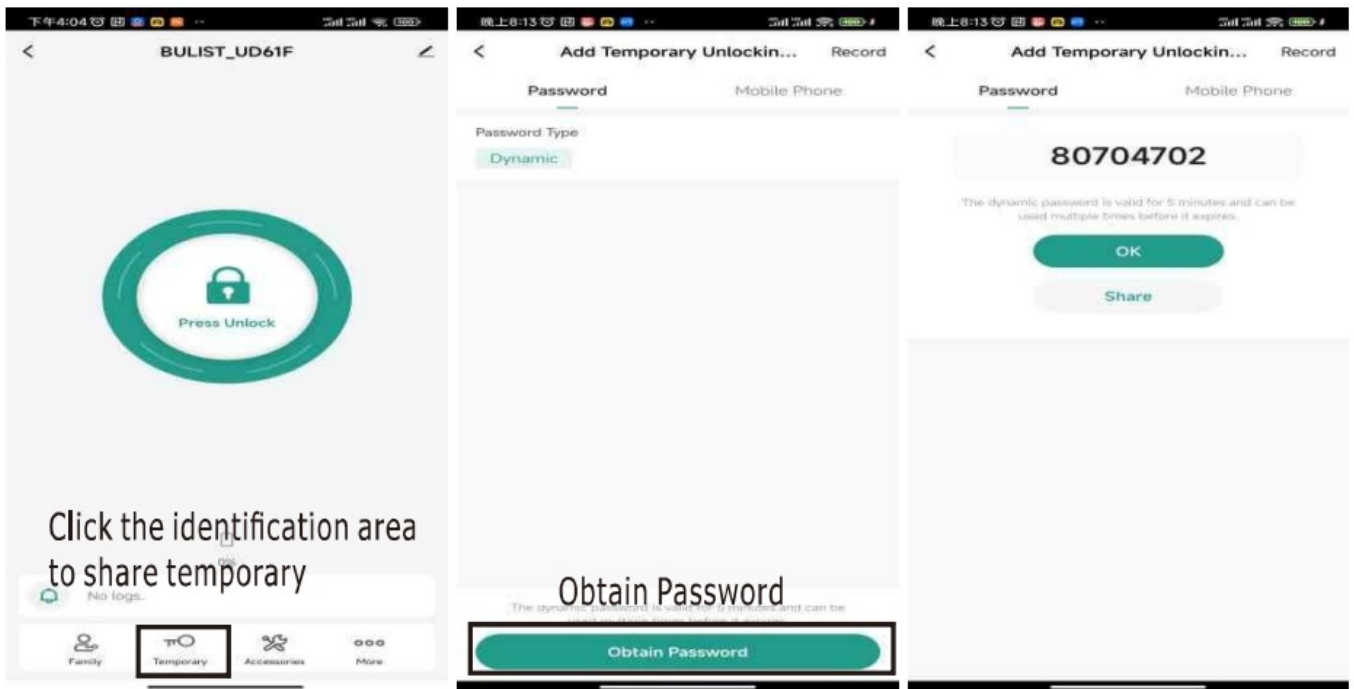

Parts.How to perform local programming

Note

If door lock management cannot be through the APP, local configuration can be used for basic function settings

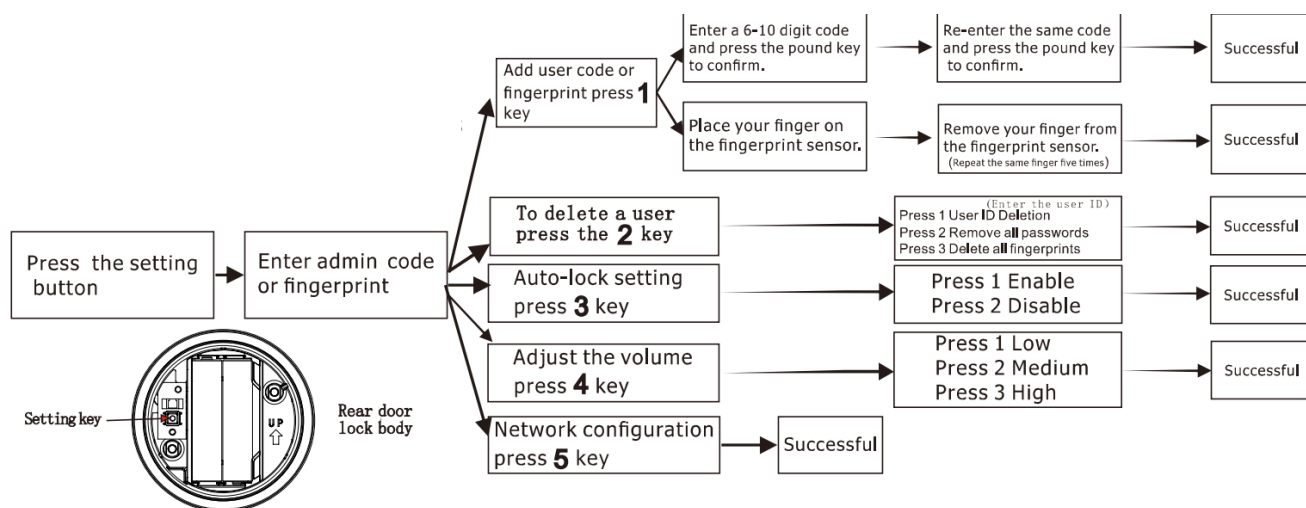

If you have already connected to the network, you need to restore the factory: settings before configuring again

Part6.How to unlock outdoor

Unlock by mechanical key

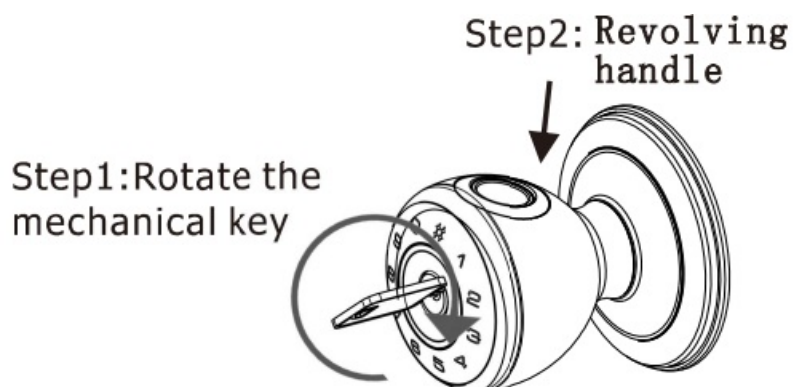

Unlock by user code fingerprint

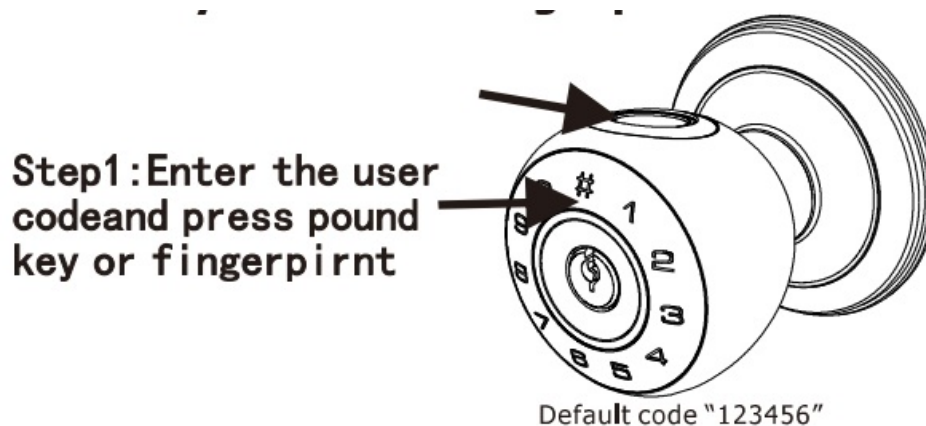

Part 7. How to restore factory setting

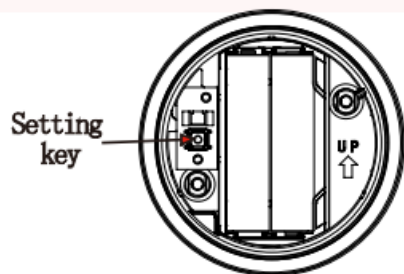

Rear door lock body

The restore factory setting will clear all configuration data. This operation is not reversible, so please proceed with caution.

Press and hold the setting button for 10 seconds.

press the pound key to confirm the operation.

Successful

Part8.How to supply power

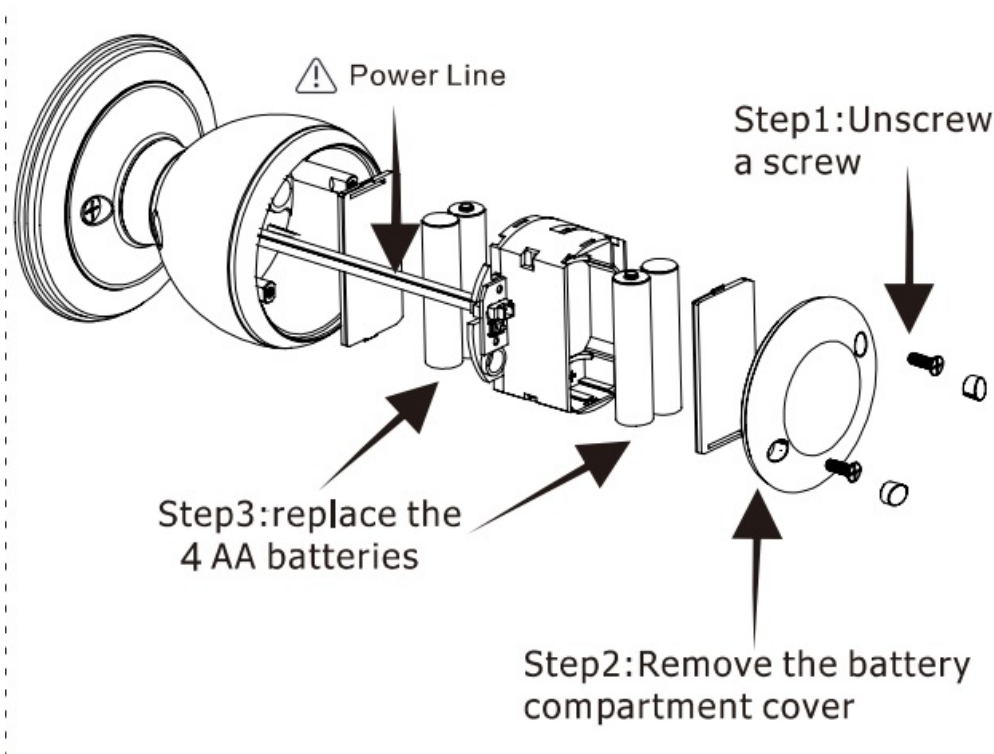

Reminders

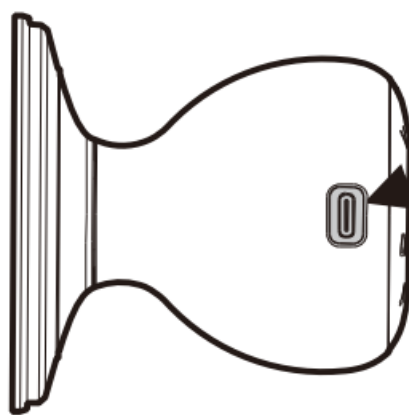

Front door lock bottom surface

Emergency power supply

You can use a power bank to temporarily power up and unlock when the battery is dead.

Part10.Troubleshooting

Question	Answer
Can not add new user code	<ul style="list-style-type: none"> • If 50 groups of normal user code have been added, you can delete the unused user code and add new user code again • The new user code is duplicate
Forget password	Restore the factory setting, and then add the user code or fingerprint
Can't hear the voice guidance	Increase volume through function setting
The APP can not add device	<ul style="list-style-type: none"> • Restore the factory setting, and try again • Check the mobile Bluetooth setting is turn on
The keypad or fingerprint locked	<ul style="list-style-type: none"> • Input error reached 5 times, keypad locked, enter user code in 90 seconds • Input error reached 10 times, fingerprint module locked, enter fingerprint in 90 seconds
The added finger-print verification	The same fingerprint can be added 2~3 times to improve the verification success rate

If you have any question during product using, please contact our after-sale service team, thanks.

E-mail: zhangzehongdidi@outlook.com

<p style="text-align: center;">QUALIFIED CERTIFICATE</p> <p>MODEL: _____</p> <p>CHECKER: _____</p> <p>DATE: _____</p>

FCC Warning

This device complies with part 15 of the FCC Rules. Operation is subject to the following two conditions:

1. This device may not cause harmful interference, and
2. This device must accept any interference received, including interference that may cause undesired operation.

Any Changes or modifications not expressly approved by the party responsible for compliance could void the user's authority to operate the equipment.

Note: This equipment has been tested and found to comply with the limits for a Class B digital device, pursuant to part 15 of the FCC Rules. These limits are designed to provide reasonable protection against harmful interference in a residential installation. This equipment generates uses and can radiate radio frequency energy and, if not installed and used in accordance with the instructions, may cause harmful interference to radio communications. However, there is no guarantee that interference will not occur in a particular installation. If this equipment does cause harmful interference to radio or television reception, which can be determined by turning the equipment off and on, the user is encouraged to try to correct the interference by one or more of the following measures:

- Reorient or relocate the receiving antenna.

- Increase the separation between the equipment and receiver.
- Connect the equipment into an outlet on a circuit different from that to which the receiver is connected.
- Consult the dealer or an experienced radio/TV technician for help.

This equipment complies with FCC radiation exposure limits set forth for an uncontrolled environment. This equipment should be installed and operated with minimum distance 20cm between the radiator & your body.

Documents / Resources

	Intelligent MQ01 Smart Lock [pdf] User Manual MQ01 Smart Lock, MQ01, Smart Lock, Lock
---	--

References

- [User Manual](#)

[Manuals+.](#) [Privacy Policy](#)

This website is an independent publication and is neither affiliated with nor endorsed by any of the trademark owners. The "Bluetooth®" word mark and logos are registered trademarks owned by Bluetooth SIG, Inc. The "Wi-Fi®" word mark and logos are registered trademarks owned by the Wi-Fi Alliance. Any use of these marks on this website does not imply any affiliation with or endorsement.