



# IntelliARK V6 Multi-Function Mobile Phone Holder User Manual

[Home](#) » [IntelliARK](#) » IntelliARK V6 Multi-Function Mobile Phone Holder User Manual

**IntelliARK V6 Multi-Function Mobile Phone Holder**



## Contents [ [hide](#)

### 1 Appearance Description

#### 1.1 How To Use

#### 1.2 Product Parameter

#### 1.3 Remote Control

#### Instruction

#### 1.4 Fill Light

#### 1.5 Warranty

### 2 Documents / Resources

### 3 Related Posts

## Appearance Description

Model: V6

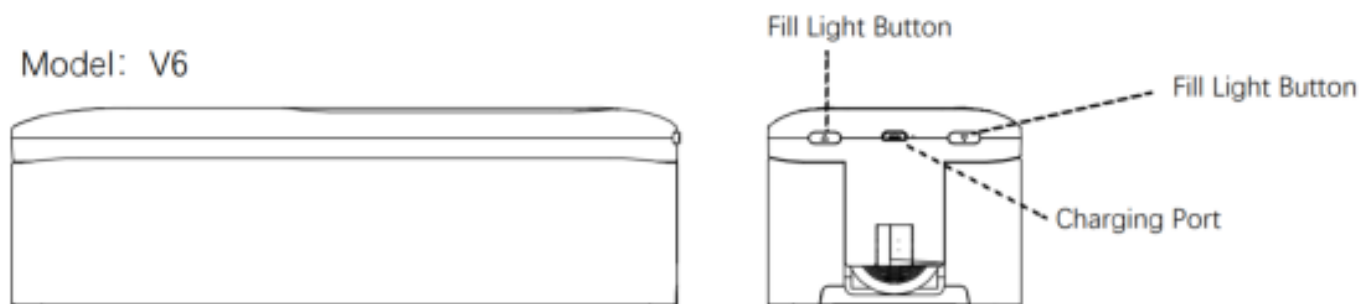

## Remote Control:

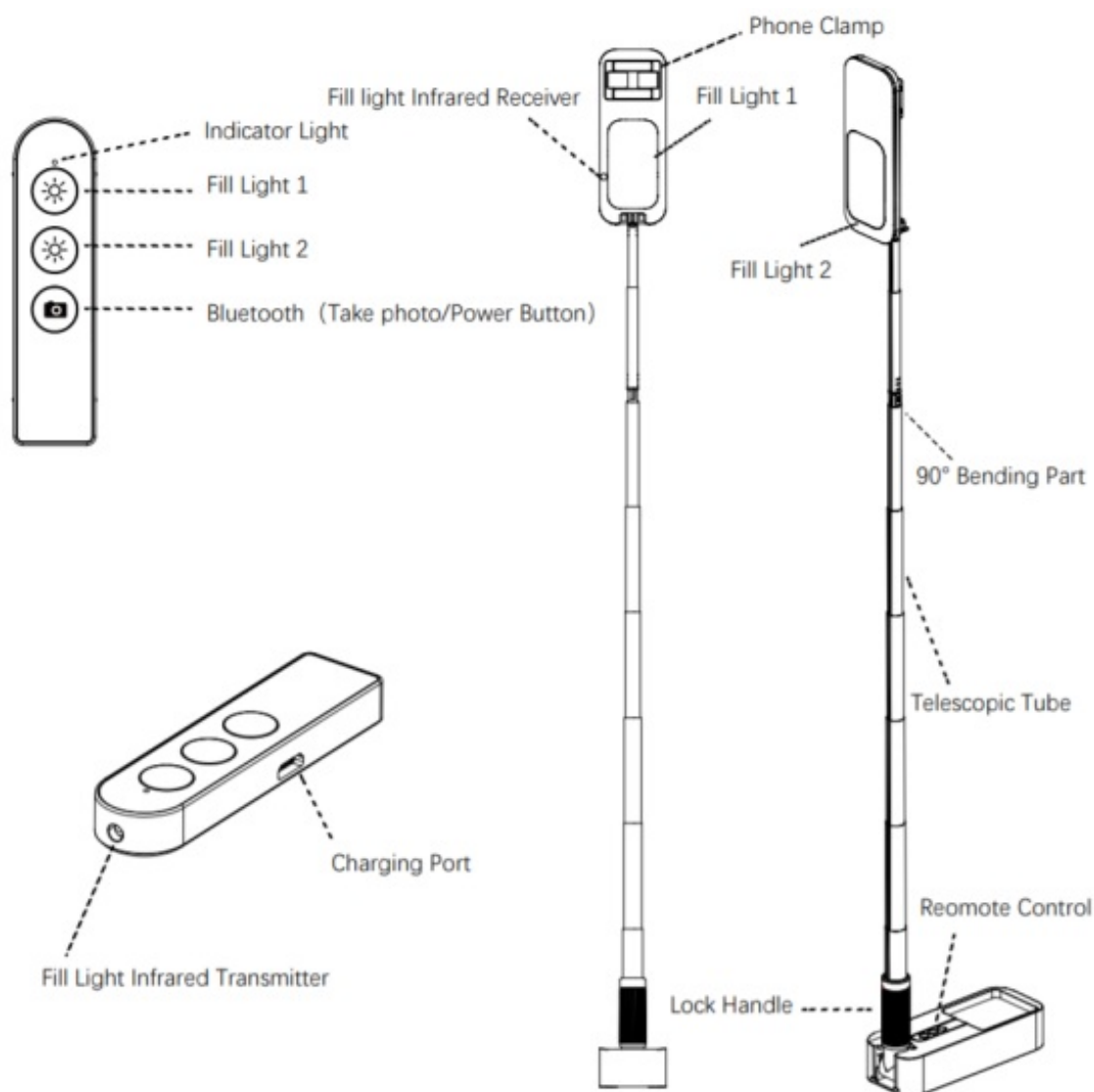

## How To Use

1 Please push as the arrow direction to open in case of force damag

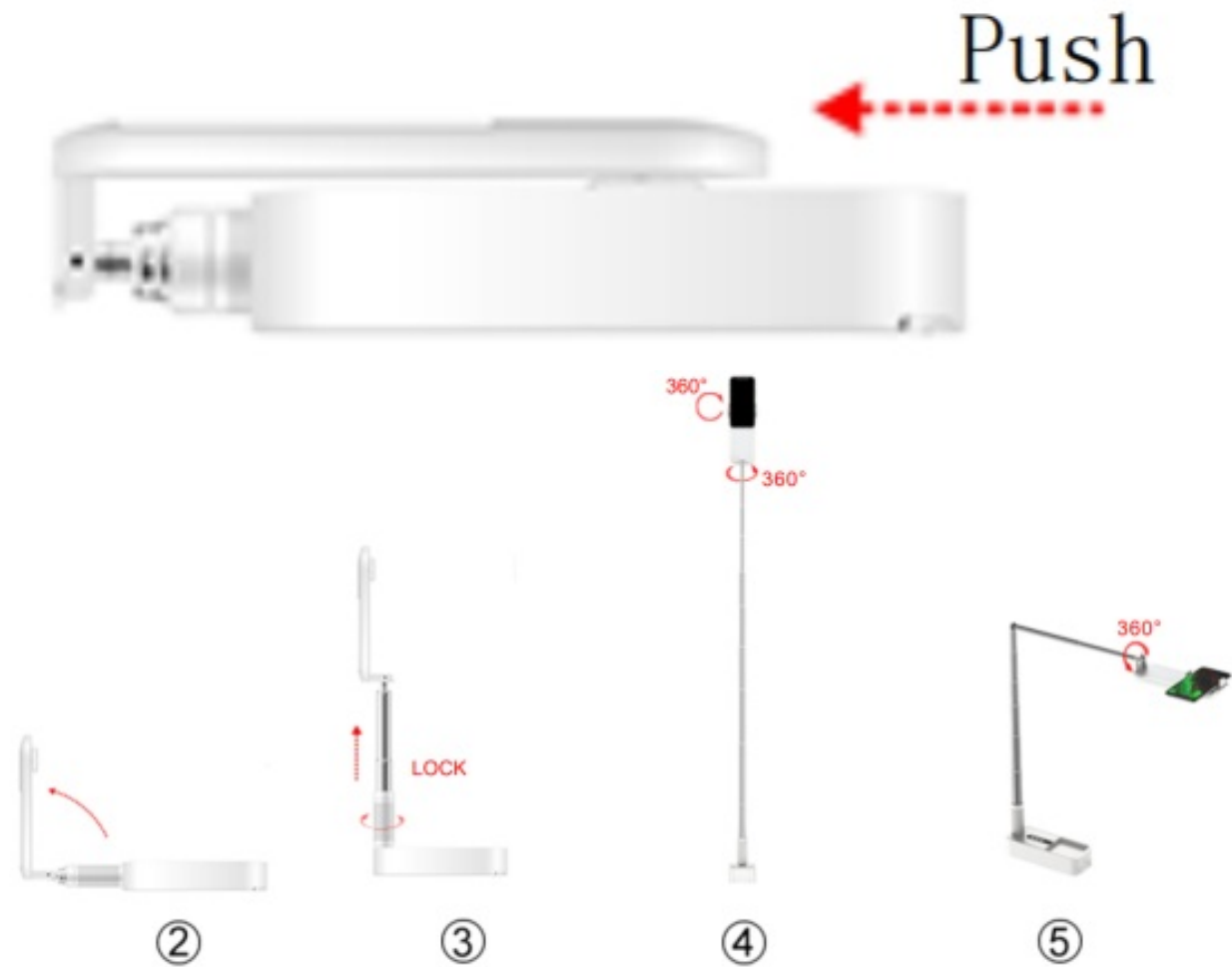

#### Product Parameter

**Product Name:** Multi-Function Phone Holder

**Product Model:** V6

**Remote-control distance:**  $\leq 10M$

**Rated Input:** DC5V/200mA

**Fill Light Battery Capacity:** 1000mAh

**Remote Controller Battery Capacity:** 50mAh

**Main Material:** Aluminum Alloy, ABS+PC

**Stretching Friction Strength:** 1KG-2.5KG

**Enterprise Standards:** Q/ZHZZ 001-2020

**Working Temperature:**  $-10^{\circ}C \sim +40^{\circ}C$

**Supported System:** Android/ IOS

**Size:** 210X80X63mm

**Maximum Extended Length:** 1300MM

**Net Weight about** 1126g

**Gross Weight:** about 1226g

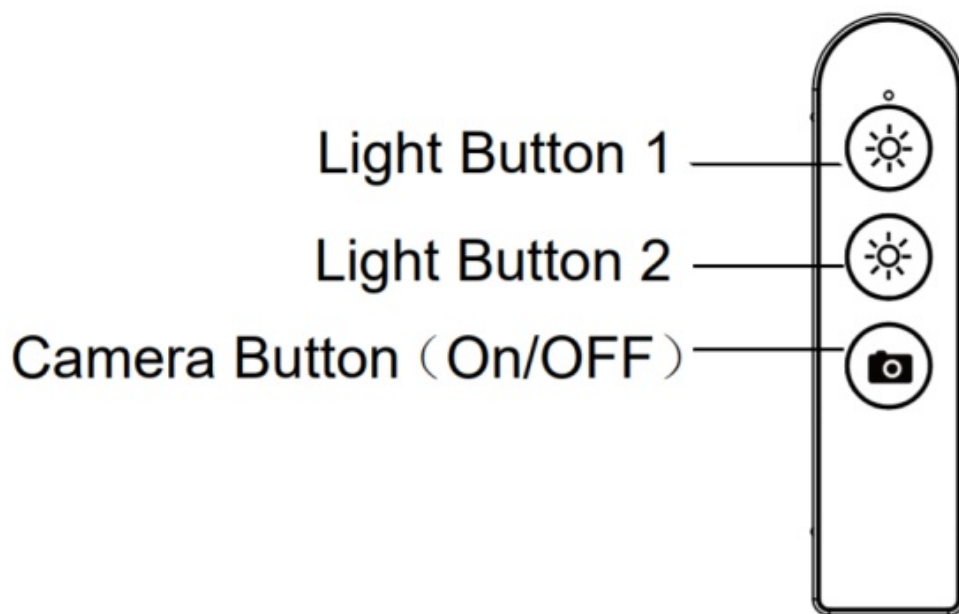

**!** The product is in energy-saving mode when come out from the factory. For the first time use, please long press the product one side two fill light button at the same time for 2 seconds to activation then use the product.  
Fill Light Button (ON/OFF Button)

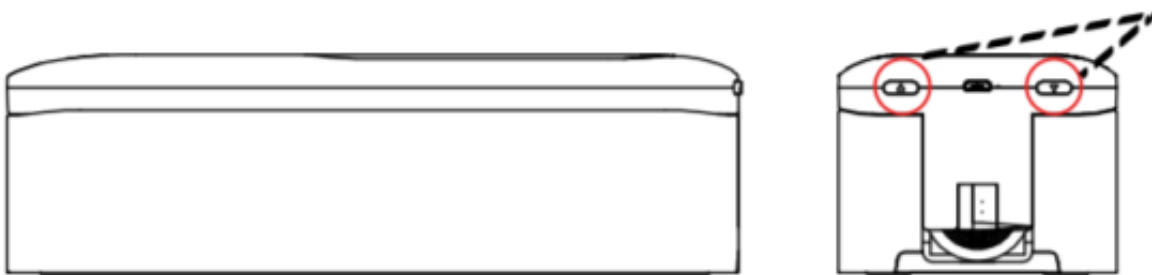

#### Remote Control Instruction

##### 1. Power On

Long press the camera button for 2 seconds, the blue flash light flash and product goes in to the pairing status.

##### 2. Bluetooth Pairing

Turns on your phone Bluetooth function in setting, search the product to recognize "DOXG-V6" and click to pair. The blue light off after the device paired successfully. (If your phone's volume button has been set for shutter, and you can't use it properly, please download 360Camera or MeiTu Camera App etc., and set the volume button for camera shutter in APP Settings to take photo.) The products without being paired with your phone within 300s will get in to sleeping mode, press the camera button once to activate it.

##### 3. Recording Video/ Take Photo

After finish the Bluetooth pair, open the phone camera, press the product camera button to take photos or record video and the blue light will blink once.

##### 4. Power Off

Long press the camera button for 2 seconds, the blue light flash and product being turns off

##### 5. Sleeping Mode

If the device unused in 300s after being paired successfully, it turns into sleeping mode, press the camera button once to activate it.

##### 6. Take Photos

Press the selfie stick shutter button to take photo. Activate it first if the device in sleeping mode.

## **Fill Light**

### **1. Turn on**

Long press the light button 2s to turn on the light device, the light in white light level-1.7 light effects

**White light:** level-1, level-2

**Yellow light:** level-1, level-2

**Mixed-color light:** level-1, level-2, Level-3

Then short press the button to switch to others light effects by turns in circulation.

### **2. Turn off:**

Long press 2s, the light device turns off.

\* Aim your remote at fill light infrared receiver when you use remote controller to adjust the light.

**Fill Light Working Time:** 3-12h

### **3. Accessories:**

V6 \*1

User Manual\*1

Charge Cable \*1

The picture is only for reference, please make the object as the standard. We reserve the right for final explanation.

## **Warranty**

1. Please keep your service card or receipt safe for maintenance certificate.
2. Warranty period is 6 month since the acquisition date.
3. During warranty period, if there are any problems or malfunction about this product in the case of normal use and maintenance, after verification, we will provide free repair and component replacement. The following situations are not included in warranty

We provide free repair and component replacement during warranty period. Damage or malfunction caused by the following situations are not included in warranty (even though during warranty period) , we assume no obligation to provide free warranty.

1. Devices, components is beyond the warranty period.
2. Damage caused by abnormal use such as any use, maintenance or wrong installation not according to the requirements of the product manual.
3. Damage caused by non-production manufacturer authorization server disassembly.
4. Damage caused by accidents or man-made reasons (Error in operation, scratch, transfer, bump, inappropriate voltage and current input, etc).
5. Damage caused by force major such as fires, floods and lightning.

Declaration of Conformity (FCC) Warning: Changes or modifications to this unit not expressly approved by the party responsible for compliance could void the user' s authority to operate the equipment.

This device complies with Part 15 of the FCC Rules.

Operation is subject to the following two conditions:

- (1) this device may not cause harmful interference
- (2) this device must accept any interference received, including interference that may cause undesired operation.

NOTE: This equipment has been tested and found to comply with the limits for a Class B digital device, pursuant to Part 15 of the FCC Rules. These limits are designed to provide reasonable protection against harmful interference in a residential installation. This equipment generates, uses and can radiate radio frequency energy and, if not installed and used in accordance with the instructions, may cause harmful interference to radio communications. However, there is no guarantee that interference will not occur in a particular installation. If this equipment does cause harmful interference to radio or television reception, which can be determined by turning the equipment off and on, the user is encouraged to try to correct the interference by one or more of the following measures:

- Reorient or relocate the receiving antenna.
- Increase the separation between the equipment and receiver.
- Connect the equipment into an outlet on a circuit different from that to which the receiver is connected.
- Consult the dealer or an experienced radio/TV technician for help.

## Documents / Resources

	<a href="#">IntelliARK V6 Multi-Function Mobile Phone Holder</a> [pdf] User Manual 20V6, 2AYSS-20V6, 2AYSS20V6, V6, Multi-Function Mobile Phone Holder
---	---