



integrattech RF RGBW Wall Mounted Controller Instruction Manual

[Home](#) » [integrattech](#) » integrattech RF RGBW Wall Mounted Controller Instruction Manual 

integrattech RF RGBW Wall Mounted Controller Instruction Manual



Important: Read All Instructions Prior to Installation

Contents

1 Function introduction

2 Product Data

3 Safety & Warnings

4 Pair with RF receiver

5 Installation

5.1 Built-in 10 color changing modes are as follows:

6 Documents / Resources

7 Related Posts

Function introduction

Front Side

Press and hold down the 2 buttons together at the same time for 2 seconds to save the color you like, Click the 2 buttons together at the same time to get that saved color. Can save only 1 color.

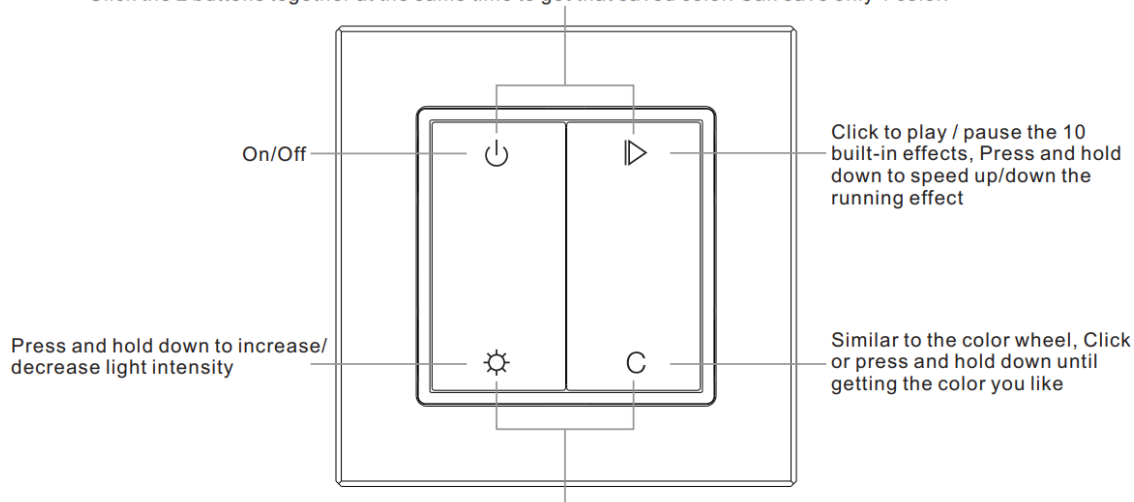

Click the 2 buttons together at the same time to turn on the 4th individual channel W, click again to turn it off, press and hold down the 2 buttons together to increase/decrease light intensity of 4th channel

Back side

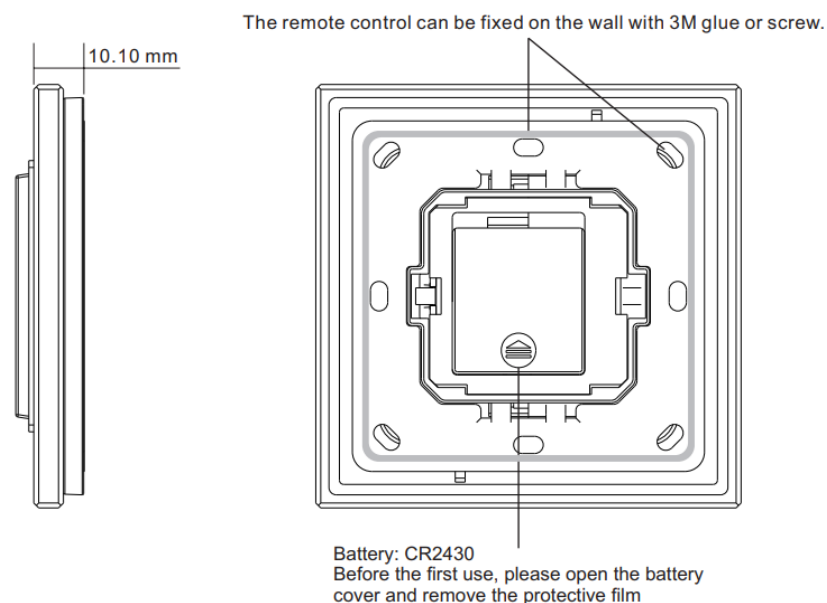

Product Data

Output	RF signal
Operation Frequency	869.5/434MHz
Power Supply	3V(1xCR2430 battery)
Operating temperature	0-40°C
Relative humidity	8% to 80%
Dimensions	86x86x14mm

- Control 1 zone of receiver
- **RGBW** color controller
- Compatible with all universal series **RF** receivers
- 1 receiver can be paired by max 8 different remote controls.
- Waterproof grade: IP20

Safety & Warnings

- This device contains a button lithium battery that shall be stored and disposed properly.
- DO NOT expose the device to moisture

Pair with RF receiver

- **Step 1:**Do wiring the **RF** receiver according to wiring diagram(please refer to the instruction of RF receiver that you would like to pair with.
- **Step 2:**Click the “**Learning Key**” button on RF receiver or re-power on the receiver three times continuously to set it into pairing status.
- **Step 3:**Click any button on the remote(e.g. button **),LED** lights connected with the **RF** receiver flicker once means the receiver is paired with the remote successfully.

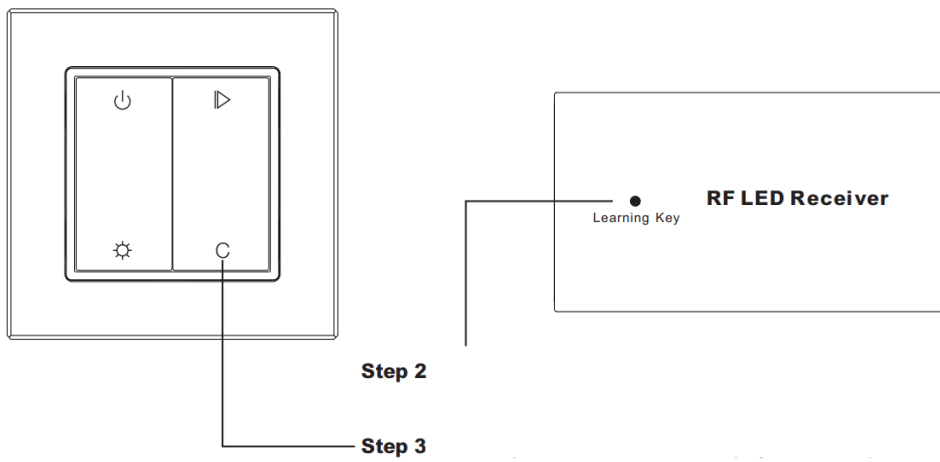

Note: one receiver can be paired with max 8 remote controls.

Installation

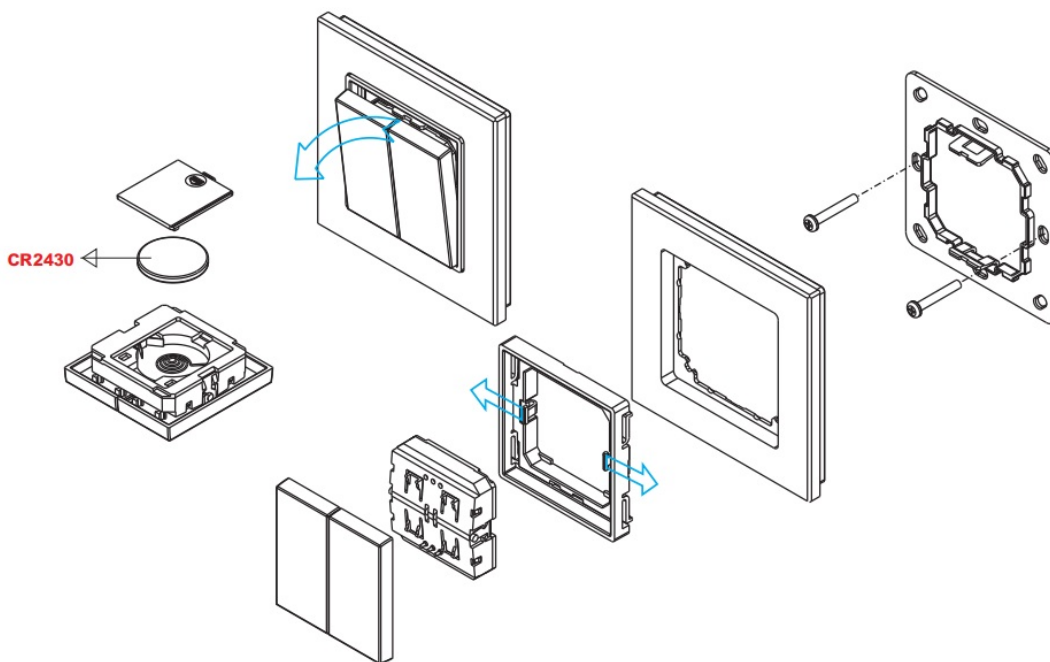

The key part of this controller is a universal, extremely rotary standard switch element that can be integrated in numerous frames by different manufactures as below list.

BEKER	S1, B1, B3, B7 glass
GIRA	Standard55, E2, Event, Esprit
JUNG	A500, Aplus
MERTEN	M-smart, M-Arc, M-Plan

Built-in 10 color changing modes are as follows:

- **Mode 1:** Any two colors of RGB mix fade-in & fade-out
- **Mode 2:** RGB three colors mix fade-in & fade-out
- **Mode 3:** RGB three colors mix fade-out & fade-in
- **Mode 4:** RGB flash

- **Mode 5:** RGB three colors fade-in & fade-out successively
- **Mode 6:** RGB three colors fade-in successively
- **Mode 7:** RGB three colors fade-out successivel
- **Mode 8:** RGB three colors jump changing successively
- **Mode 9:** R&B two colors mix fade (R in B out), then G fade-in, then R&B mix fade (R out B in), then G fade-out
- **Mode 10:** B fade-out, then G&B mix fade (G out B in), then R&G mix fade (R out G in), then R fade-in.

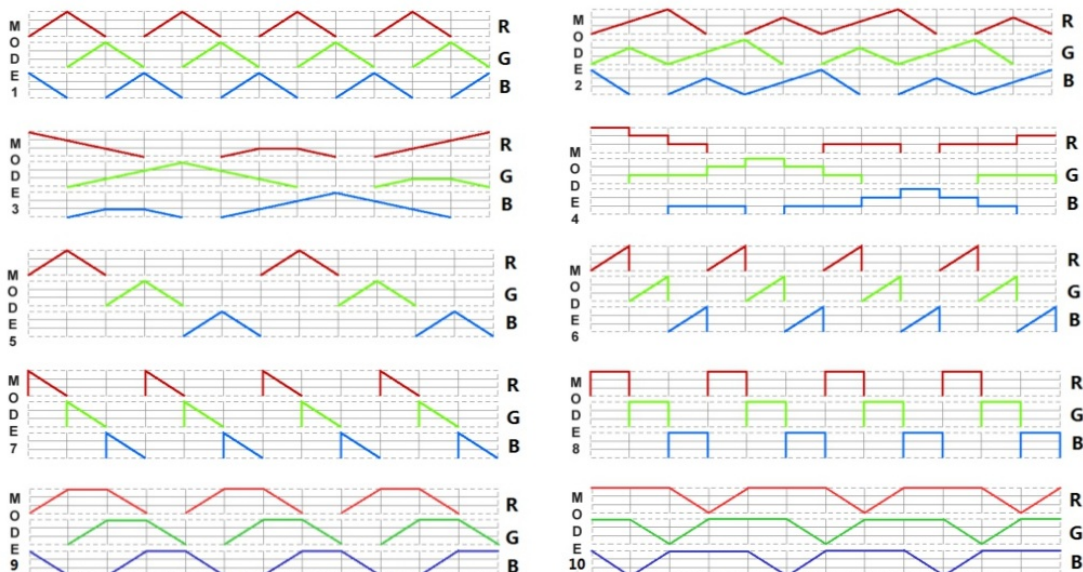

Documents / Resources

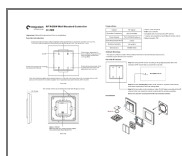

[integratech RF RGBW Wall Mounted Controller](#) [pdf] Instruction Manual
 RF RGBW Wall Mounted Controller, RF Wall Mounted Controller, RGBW Wall Mounted Controller, Wall Mounted Controller, RGBW Controller