

**integral™
LED**

**ILNEV046 3FT
Single Circuit
Track Starter Kit**



integral LED ILNEV046 3FT Single Circuit Track Starter Kit Installation Guide

[Home](#) » [integral LED](#) » integral LED ILNEV046 3FT Single Circuit Track Starter Kit Installation Guide 

Contents

- [1 integral LED ILNEV046 3FT Single Circuit Track Starter Kit](#)
- [2 features](#)
- [3 INSTALLATION INSTRUCTION](#)
- [4 Documents / Resources](#)
 - [4.1 References](#)

**integral™
LED**

integral LED ILNEV046 3FT Single Circuit Track Starter Kit



features



IS 1001



INSTALLATION INSTRUCTION

1

Installation

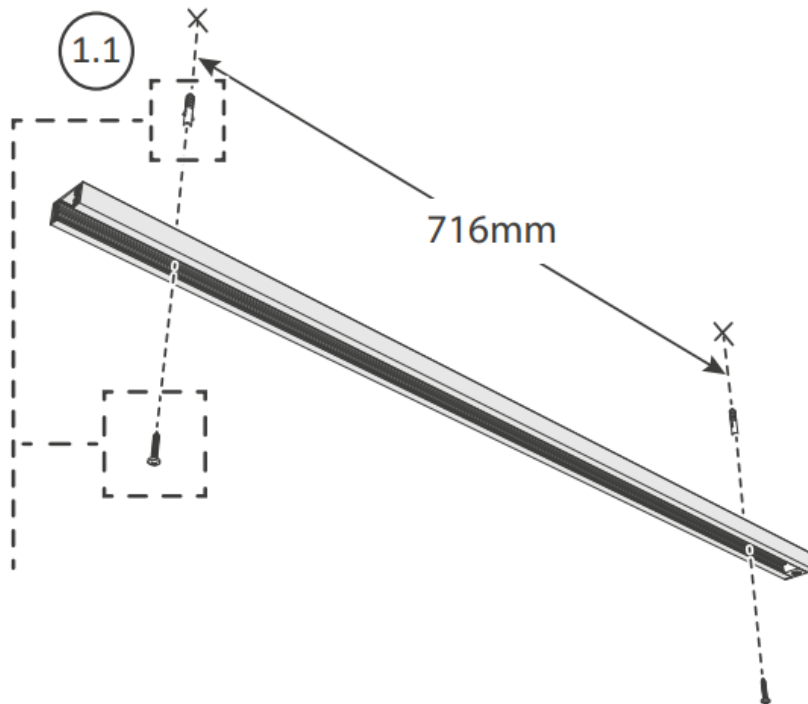

2

Connection

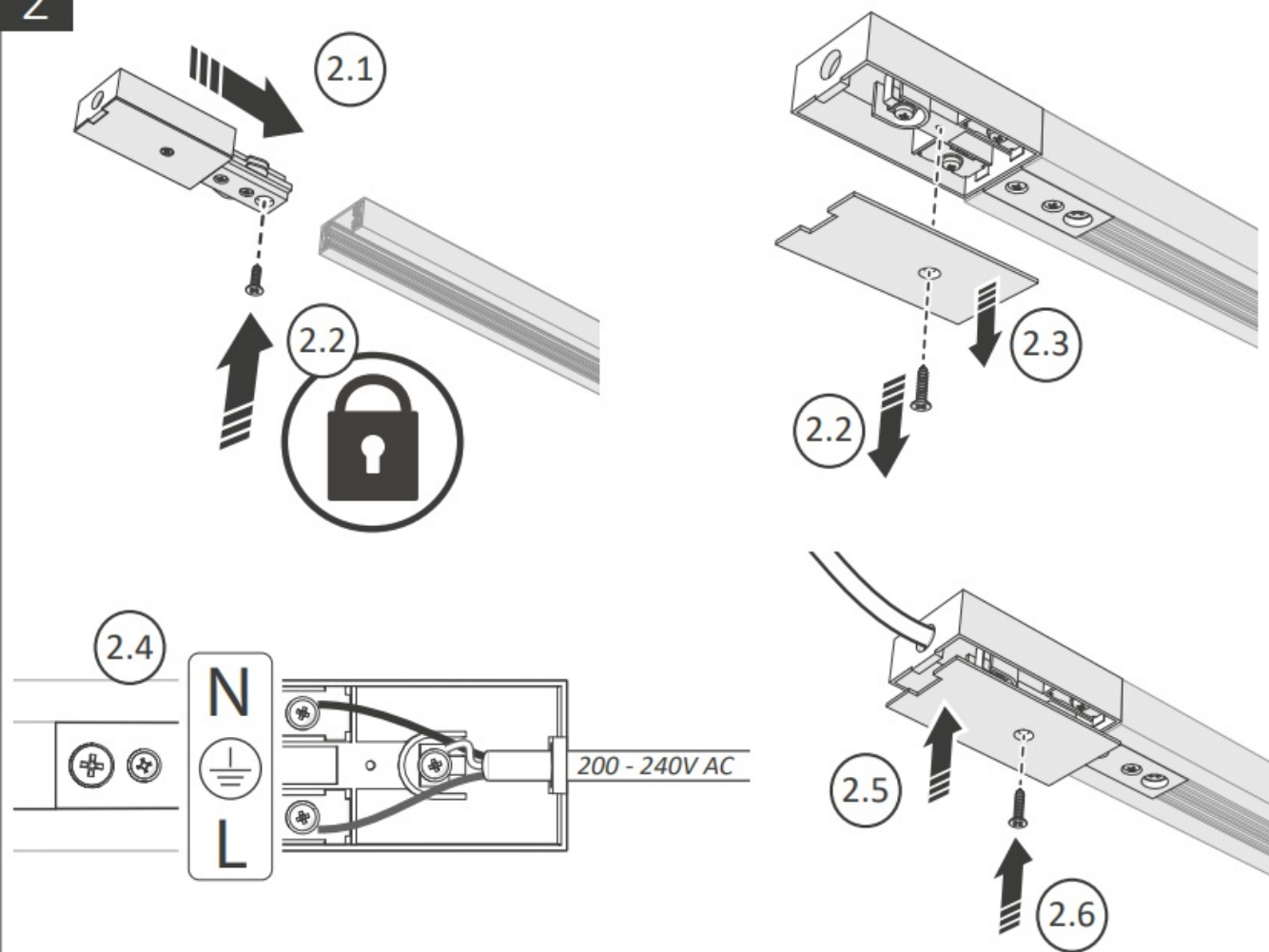

3

Continuous Installation

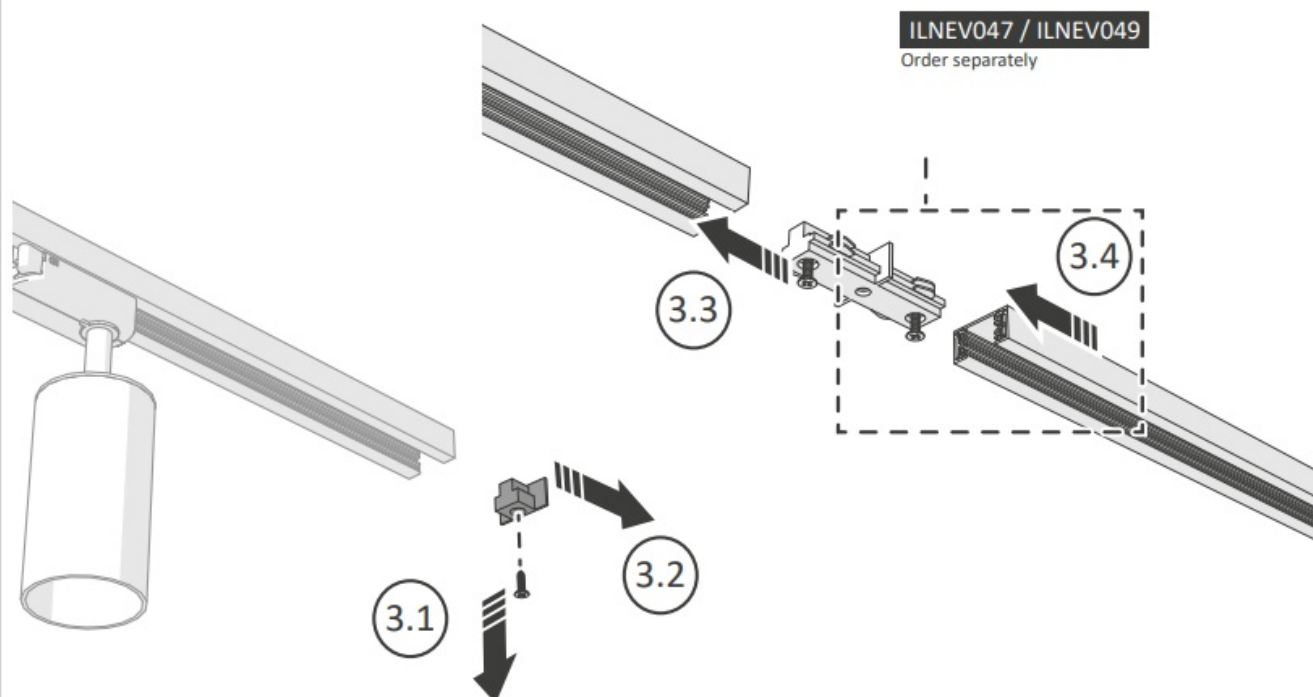

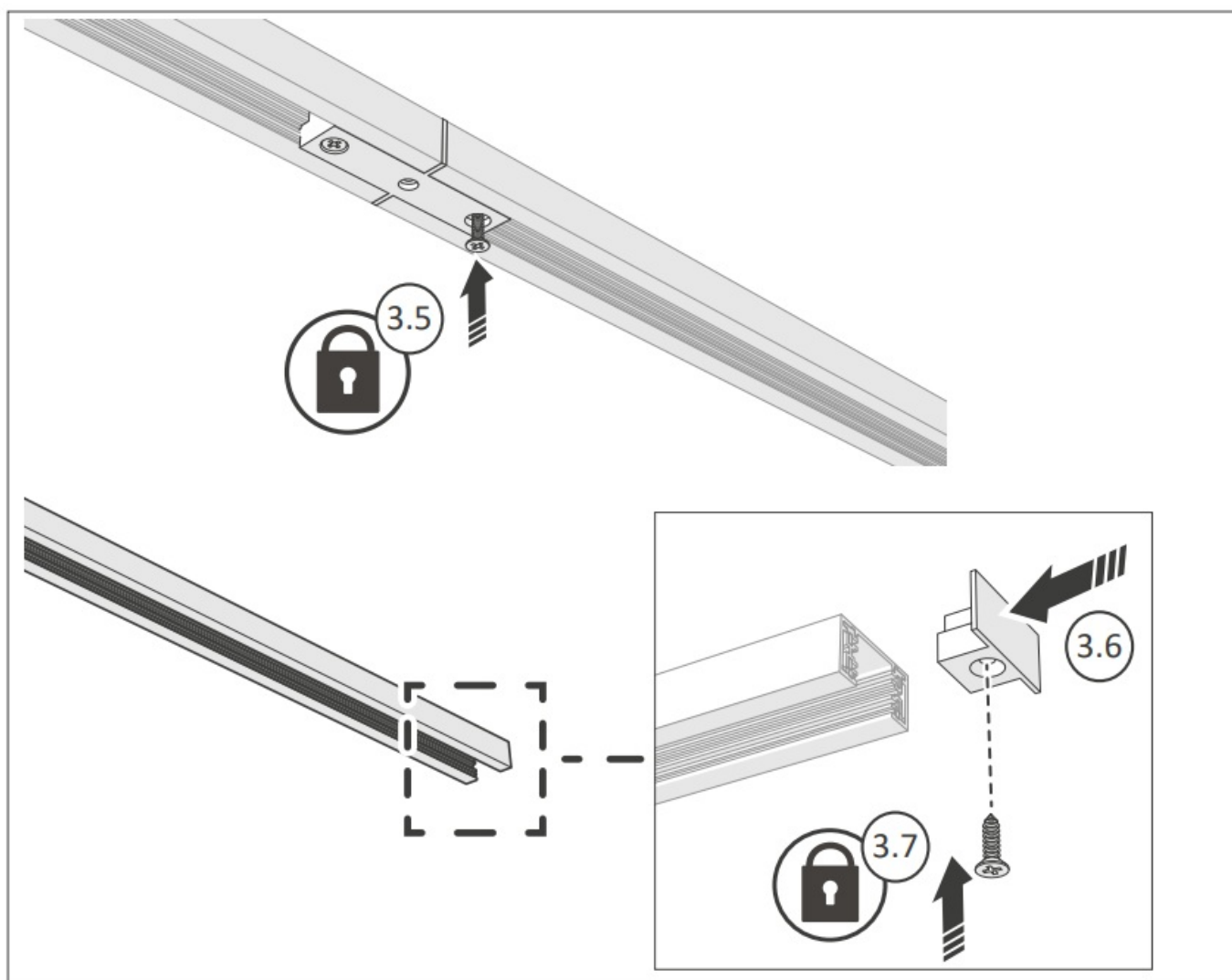

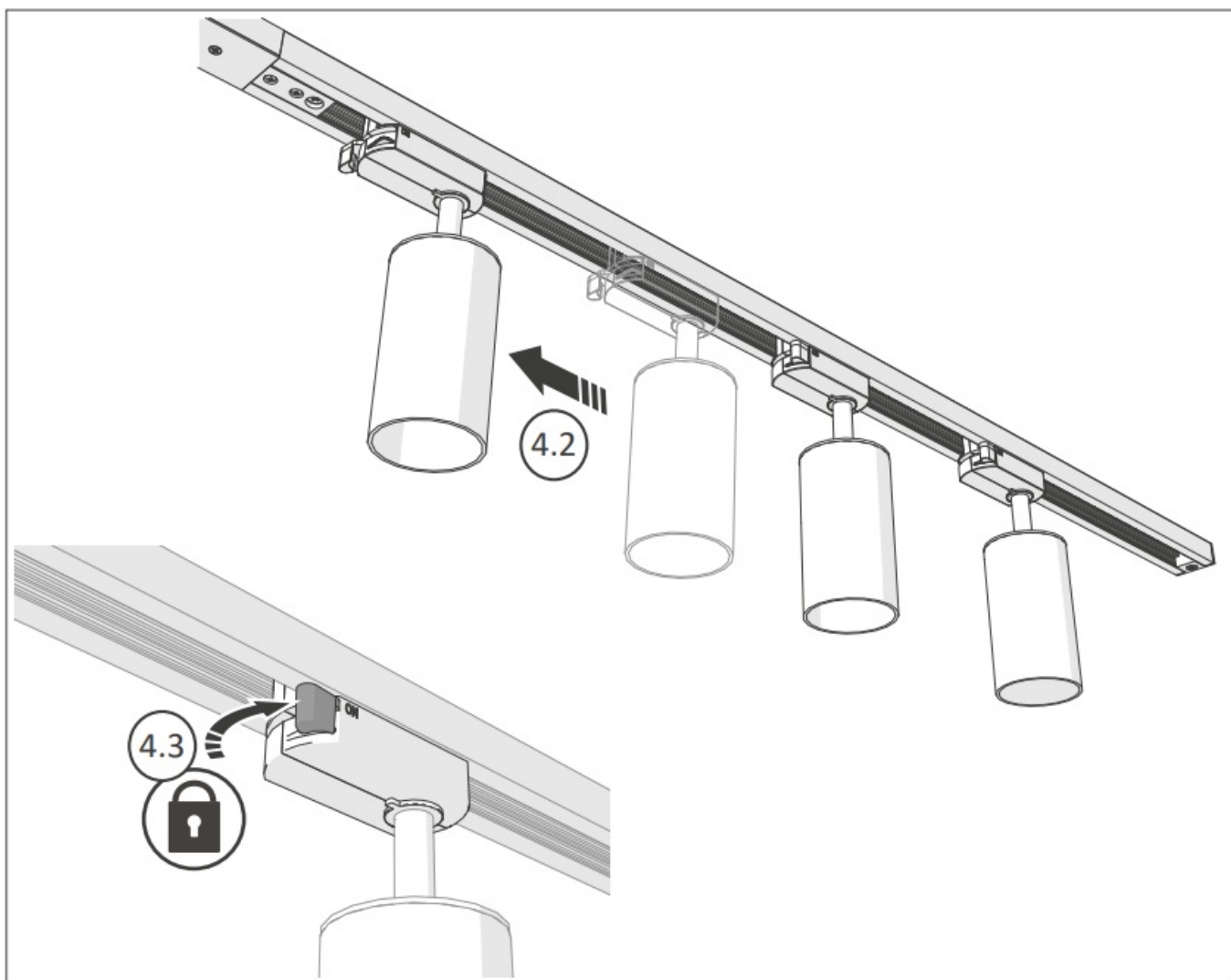

4

Adjustment

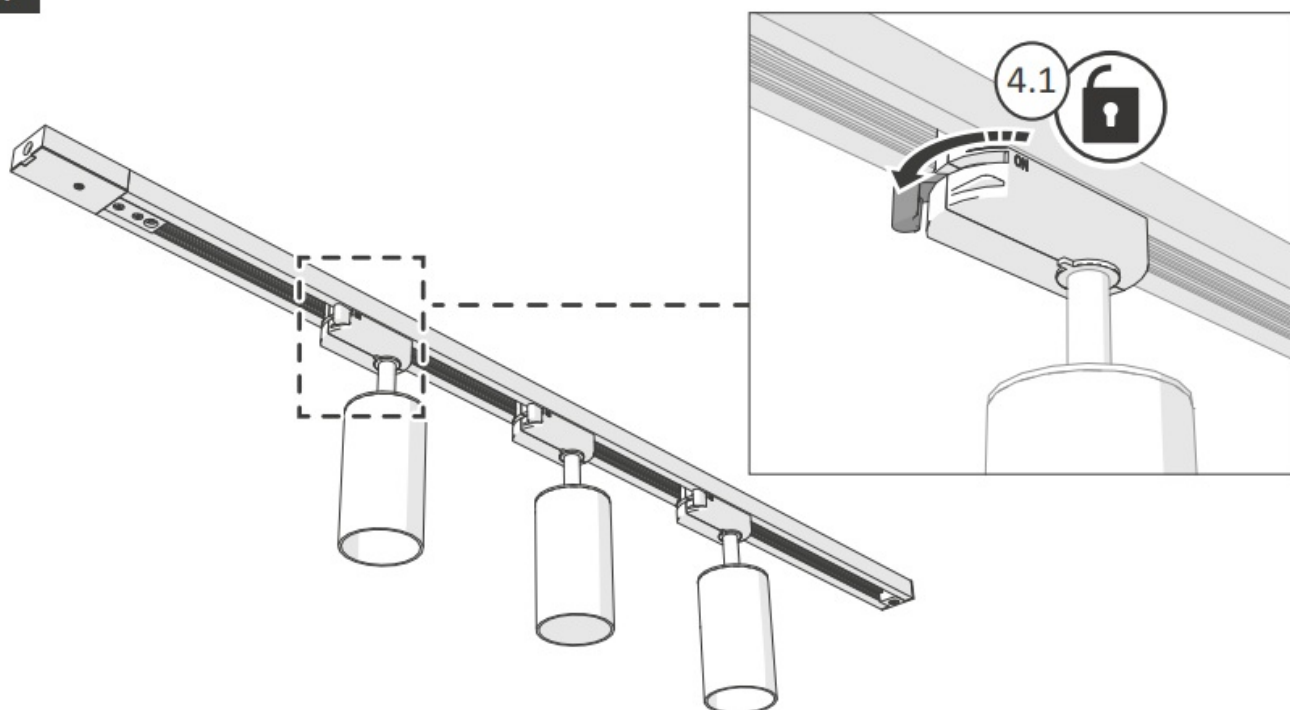

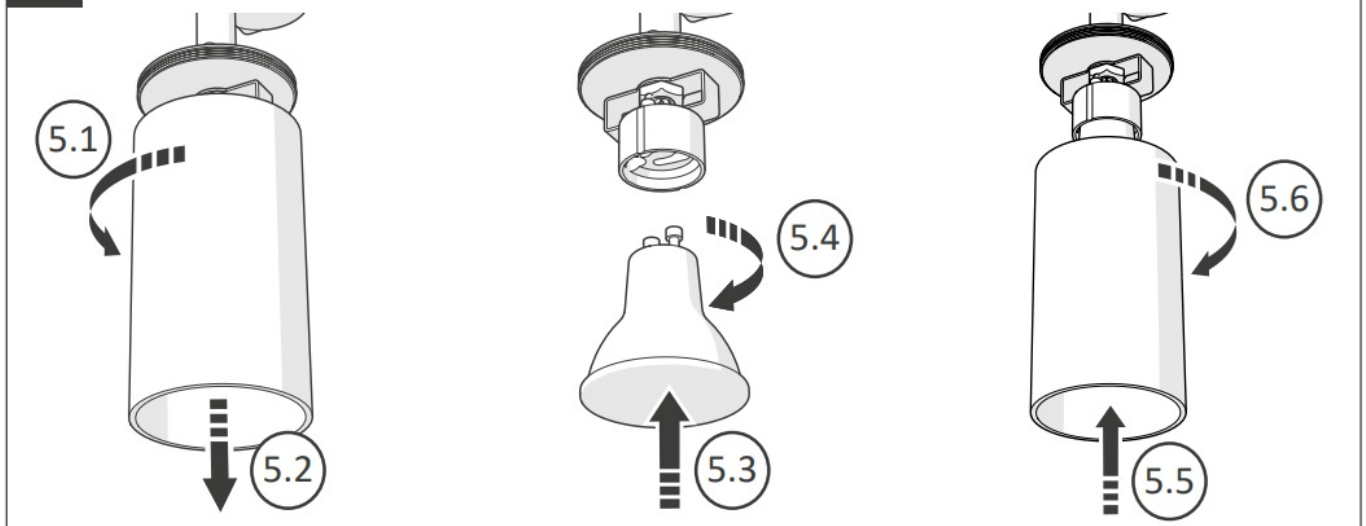

- Warranty/ Technical& contact information are all available at
- www.integral-led.com
- Integral LED is a division of Integral Memory plc: Unit 6, Iron Bridge Close, Iron Bridge Business Park, London, NW10 0UF, UK Integral Europe BV, 2801 DG, NL

Documents / Resources

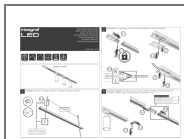

[integral LED ILNEV046 3FT Single Circuit Track Starter Kit](#) [pdf] Installation Guide
 ILNEV046, ILNEV048, ILNEV047, ILNEV049, ILNEV046 3FT Single Circuit Track Starter Kit, ILNEV046, 3FT Single Circuit Track Starter Kit, Single Circuit Track Starter Kit, Circuit Track Starter Kit, Track Starter Kit, Starter Kit, Kit

References

- [Trusted Lighting Solutions | Integral LED](#)
- [User Manual](#)

[Manuals+](#). [Privacy Policy](#)

This website is an independent publication and is neither affiliated with nor endorsed by any of the trademark owners. The "Bluetooth®" word mark and logos are registered trademarks owned by Bluetooth SIG, Inc. The "Wi-Fi®" word mark and logos are registered trademarks owned by the Wi-Fi Alliance. Any use of these marks on this website does not imply any affiliation with or endorsement.