



inswan INS-2 USB Document Camera User Manual

[Home](#) » [inswan](#) » inswan INS-2 USB Document Camera User Manual 

Contents

- 1 inswan INS-2 USB Document Camera
- 2 PRODUCT INFORMATION
- 3 Package Content
- 4 Preparing the Document Camera
- 5 Basic Operation
- 6 Troubleshooting
- 7 Documents / Resources
 - 7.1 References
- 8 Related Posts

inSwan

inswan INS-2 USB Document Camera



PRODUCT INFORMATION

Package Content

- INS-2 USB Document Camera
- Anti-Glare Sheet
- Quick Guide
- Microscope Adapters

Warning

1. Do not look directly at the LED light source, which may cause retinal damage.

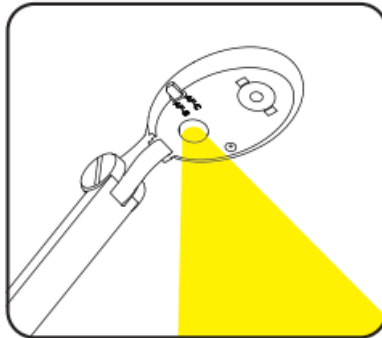

2. Carry the product by holding the base of the main unit in both hands. Never hold the product by the arm or the camera head only.

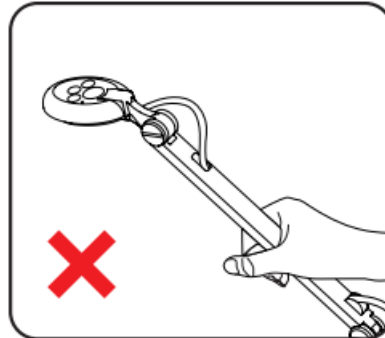
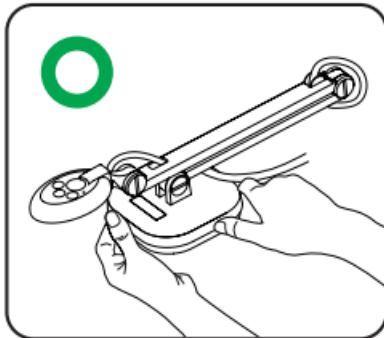

3. The camera can be damaged if it hits a desk surface or any hard object.
4. Never turn the arm in the opposite direction.
5. Be sure to keep one hand on the device base when adjusting the arm and camera head.

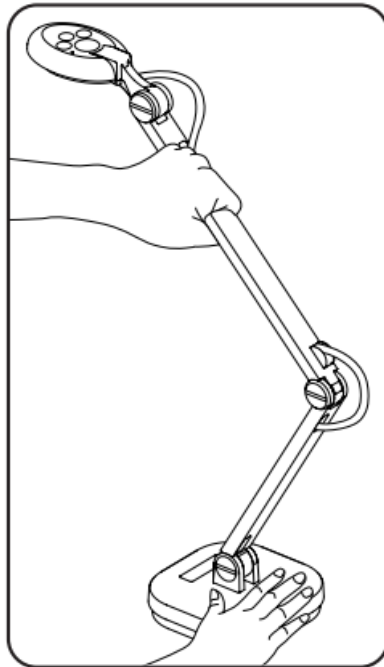

Preparing the Document Camera

Knowing the Document Camera Parts

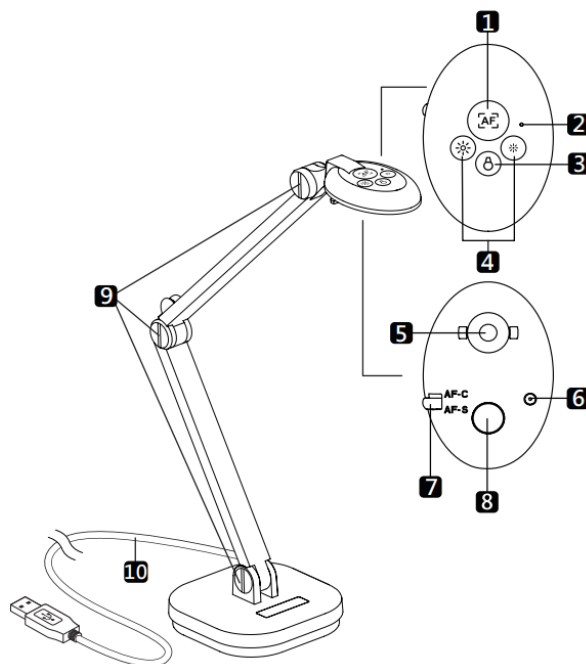

1. Auto Focus Button
2. Led Indicator
3. Lamp Button
4. Brightness Adjusting Button
5. Camera
6. Microphone
7. AF Switch
8. LED Lamp
9. Arm Screw
10. USB Cable

Setting Up

This section provides useful tips on how to adjust the document camera smoothly for your needs.

Working Area

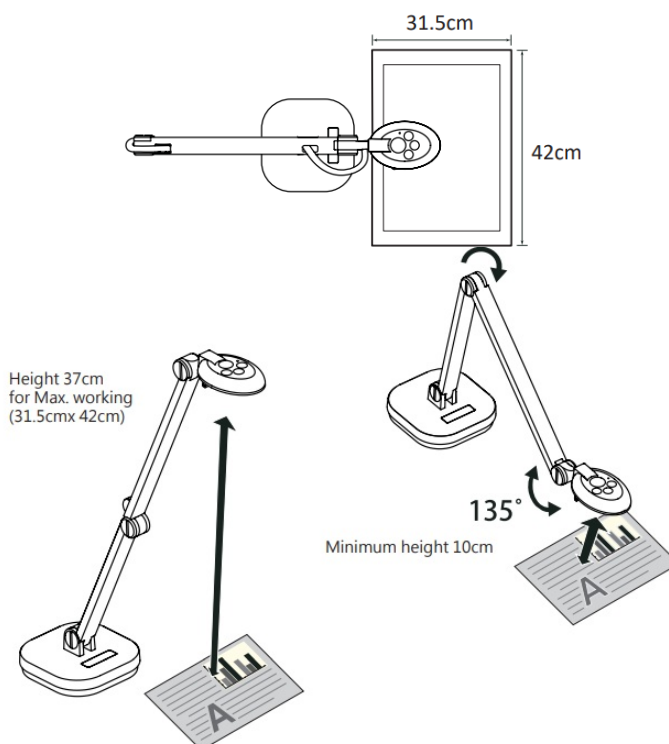

Note: Use two coins to tighten the screws if the arm is loose.

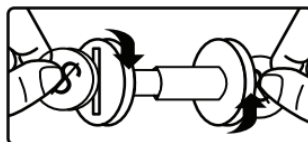

• Illumination Lamp

If you are in a dark environment, please turn the LED lamp on to make better exposure.

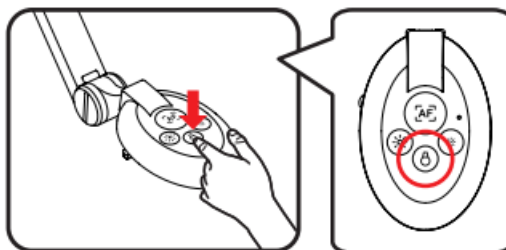

• Adjusting the Focus

Press the Focus button to do a one-time autofocus.

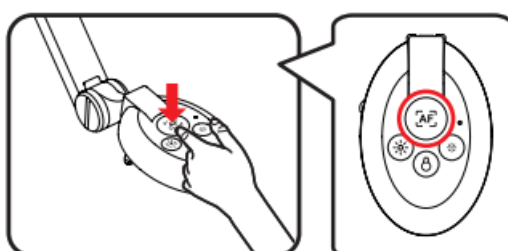

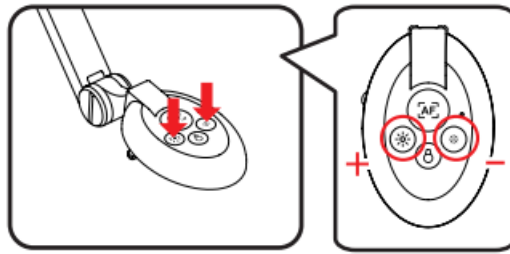

• Adjusting the Brightness

Press the Brightness button to increase or decrease the brightness level.



- **Change the image orientation**

If your image is upside down, change the image orientation by simultaneously pressing the ( brightness+) and ( brightness-) buttons.

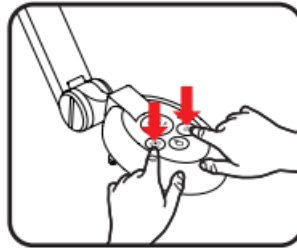

- **Anti-glare**

Anti-glare sheet is a transparent plastic that is overlaid on top of a shiny object or glossy surface to reduce the glare. To use, simply place the anti-glare sheet on top of the shiny object on a glossy surface such as a magazine to reduce light reflection

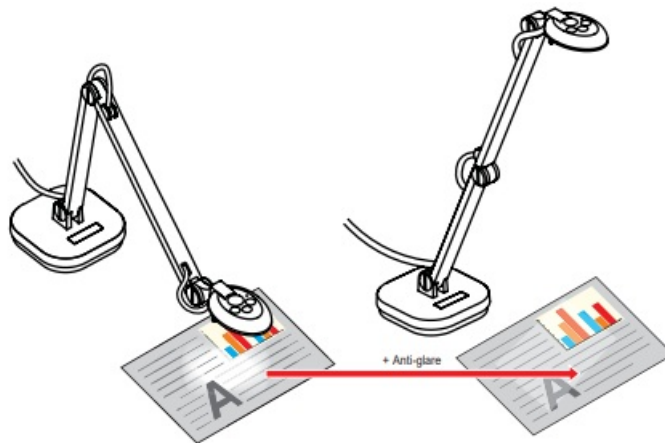

Basic Operation

Using Document Camera as a PC cam

Starting the application

1. Connect the document camera to your computer

Turn on your computer then connect the accessory USB cable to the USB port of your computer.
Make sure the connector and the port are aligned correctly.

2. Launch PC Camera

After the document camera is correctly connected to and detected by your PC, you are ready to use the PC Camera function

Working with Documate

1. Install Documate software.
2. Connect the device and PC with an accessory USB cable.
3. Start Documate on your PC.

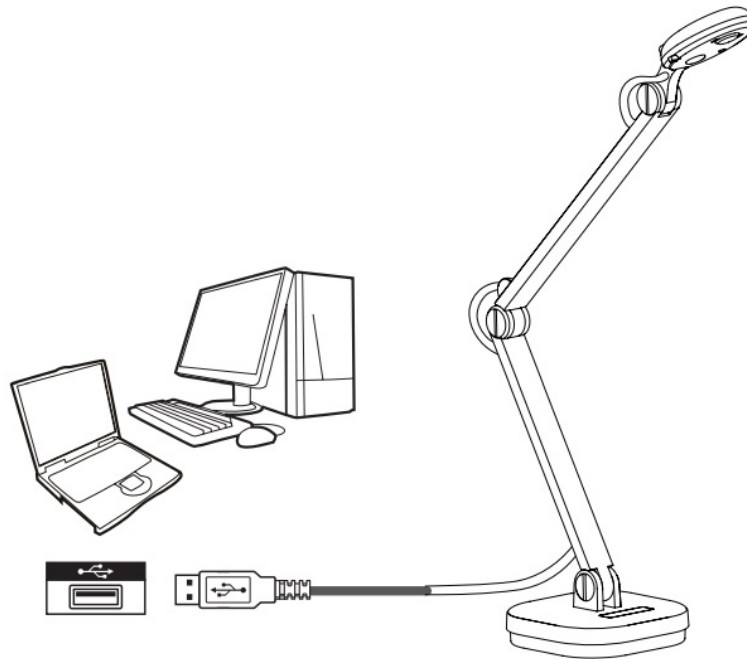

Advance Operation

Connect to a microscope

Connect to a microscope enables you to examine microscopic objects on a big screen.

1. Adjust the microscope and focus objects.
2. Choose an appropriate microscope adapter.
3. Microscope adapter accessories apply 28 mm Ø31mm, Ø33mm, and Ø34mm eyepieces.
 - For eyepieces of about Ø33mm and Ø34mm, only a microscope adaptor should be installed.
 - For a Ø28mm eyepiece, insert the Ø28mm adapter into the microscope adapter.
 - For a Ø31mm eyepiece, insert the Ø31mm adapter into the microscope adapter.

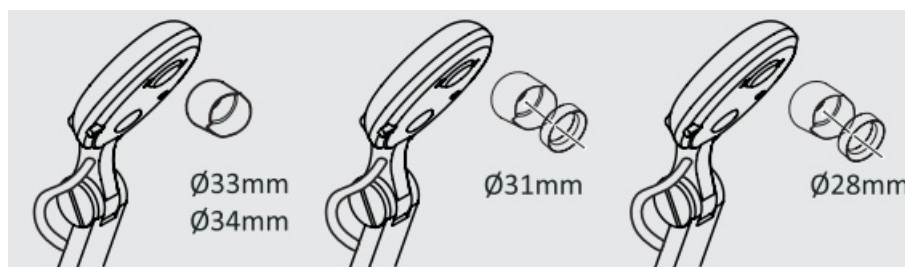

4. Mount / take off the microscope adapter onto/off the lens by doing the action shown in the picture.

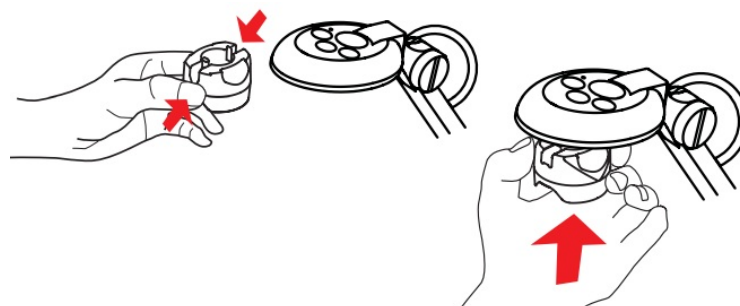

5. Connect the lens with the microscope adapter to the microscope.

- If the image is not clear. Please adjust the focus of the microscope.
- Press the Focus button to fine-tune the focus.

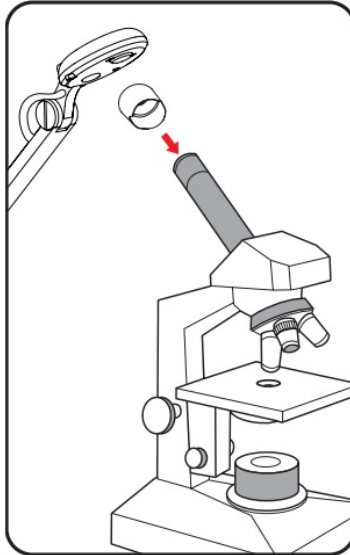

Troubleshooting

When using the document camera :		
Problem	Cause	Solution
Cannot be powered on normally.	The USB cable is not correctly connected to the computer or the computer may have crashed.	Re-connect the USB cable with the document camera.
		Restart the computer.
No image output after connecting.	The document camera is not correctly connected to the computer.	Re-connect the USB cable with the document camera.
	Software is not installed on the computer.	Install the bundled software on the computer.
	Application software is incompatible with the document camera.	Use the bundled software to operate the document camera.
The image is fuzzy.	Probably the distance of the object is too close to the lens.	Press the AF button to autofocus.
The image does not move.	The computer or application software may have crashed.	Restart the computer or application software.
Noise occurs when viewing images on the computer	The flicker setting does not match the standard of the country you are staying in.	Adjust the flicker setting in the software.
Freeze image or no image showing in Windows 7	The built-in decoder of Windows 7 operating system does not support the image streaming higher than 2592×1944 resolutions.	Download a free Codec Pack from the internet. Such as K-lite Codec Pack. This Codec Pack will install the necessary decoder for Windows 7 to work on high-resolution image streaming. http://www.codecguide.com/download_kl.htm

If you have any questions, please feel free to contact us at service@inswan.com.

Customer Service

Email : service@inswan.com Website : <http://www.inswan.com>

Welcome:

Thanks for purchasing this product. Please read the instructions carefully before using this product.

FCC Compliance Statement (Class A):

This device complies with Part 15 of the FCC Rules. Operation is subject to the following two conditions: (1) this device may not cause harmful interference, and (2) this device must accept any interference received; including interference that may cause undesired operation.

Federal Communications Commission (FCC) Statement :

This Equipment has been tested and found to comply with the limits for a Class A digital device, under Part 15 of the FCC rules. These limits are designed to provide reasonable protection against harmful interference when the equipment is operated in a commercial environment. This equipment generates, uses, and can radiate radio frequency energy and, if not installed and used in accordance with the instructions, may cause harmful interference to radio communications. Operation of this equipment in a residential area is likely to cause harmful interference in which case the user will be required to correct the interference at his own expense.

European Community Compliance Statement (Class A):

This is a class-A product. In a domestic environment, this product may cause radio interference in which case the user may be required to take adequate measures.

The symbol of the crossed-out wheeled bin indicates this product should not be placed in municipal waste. Instead, you need to dispose of the waste equipment by handing it over to a designated collection point for the recycling of waste electrical and electronic equipment.

Documents / Resources

	<p>inswan INS-2 USB Document Camera [pdf] User Manual</p> <p>INS-2 USB Document Camera, INS-2, USB Document Camera, Document Camera, Camera</p>
--	---

References

- [User Manual](#)