

 **Insta360**
W3 Bike
Computer Mount



Insta360 W3 Bike Computer Mount User Manual

[Home](#) » [Insta360](#) » Insta360 W3 Bike Computer Mount User Manual 

Contents

- [1 Insta360 W3 Bike Computer Mount](#)
- [2 What's Included](#)
- [3 Installation Instructions](#)
- [4 Instructions for Use](#)
- [5 Warranty Conditions](#)
- [6 Specifications](#)
- [7 FAQ](#)
- [8 Documents / Resources](#)
 - [8.1 References](#)
- [9 Related Posts](#)



Insta360 W3 Bike Computer Mount



Dear customer,

Thank you for purchasing our product. Please read the following instructions carefully before first use and keep this user manual for future reference. Pay particular attention to the safety instructions. If you have any questions or comments about the device, please contact the customer line.

- www.alza.co.uk/kontakt
- ☎ +44 (0)203 514 4411
- Importer Alza.cz a.s., Jankovcova 1522/53, Holešovice, 170 00 Praha 7, www.alza.cz

Video Tutorial

For a more detailed video tutorial, you can scan the QR code or visit the following link:

<https://www.insta360.com/guide/accessory/bikecomputermount-b>.

**What's Included**

- 1× Bike Computer Mount Main Frame
- 1× Thumb Screw
- 2× 40mm M5 Bolts
- 2× 30mm M5 Bolts
- 4× Anti-Slip Rings
- 1× 4mm Hex Wrench
- 1× 2mm Hex Wrench
- 1× Garmin Computer Mount
- 1× Wahoo Computer Mount
- 1× Bryton Computer Mount
- 1× Giant Computer Mount
- 2× Computer Mount Screws
- 2× Short Screw Posts
- 2× Long Screw Posts

Installation Instructions**Selecting and Installing the Computer Mount:**

- Choose the appropriate Computer Mount based on your bike computer model. Each Computer Mount can be installed in two different orientations, either facing up or down.
- The kit includes four types of Computer Mounts to support various brands. Make sure to select the one that fits your computer.

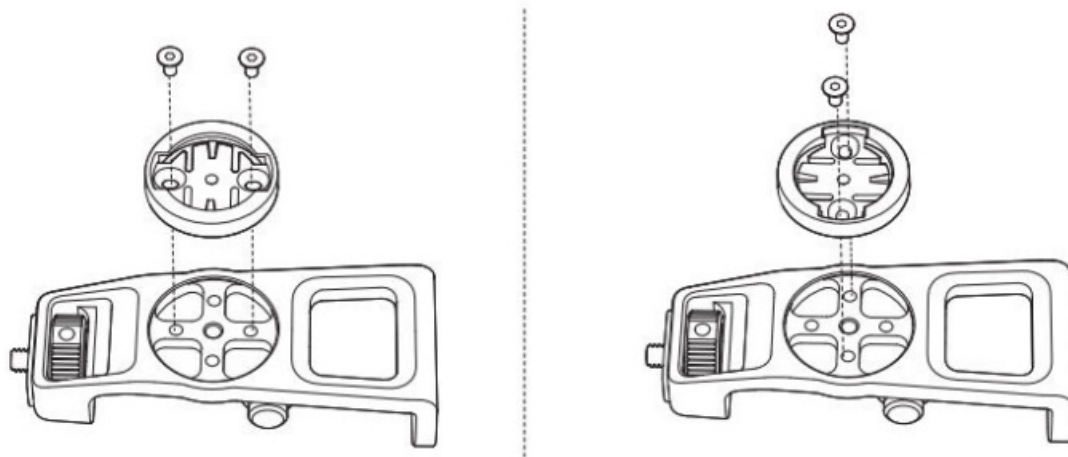

Tip:

- There are two directions to install the Computer Mount, depending on your preference.
- Always make sure to choose the mount that fits your bike computer.

Attaching the Bike Computer Mount to the Bike: Attach the Bike Computer Mount to the front of the bike, either on the upper or lower side of the handlebars, and secure it with the 40mm M5 Bolts using the provided 4mm Hex Wrench.

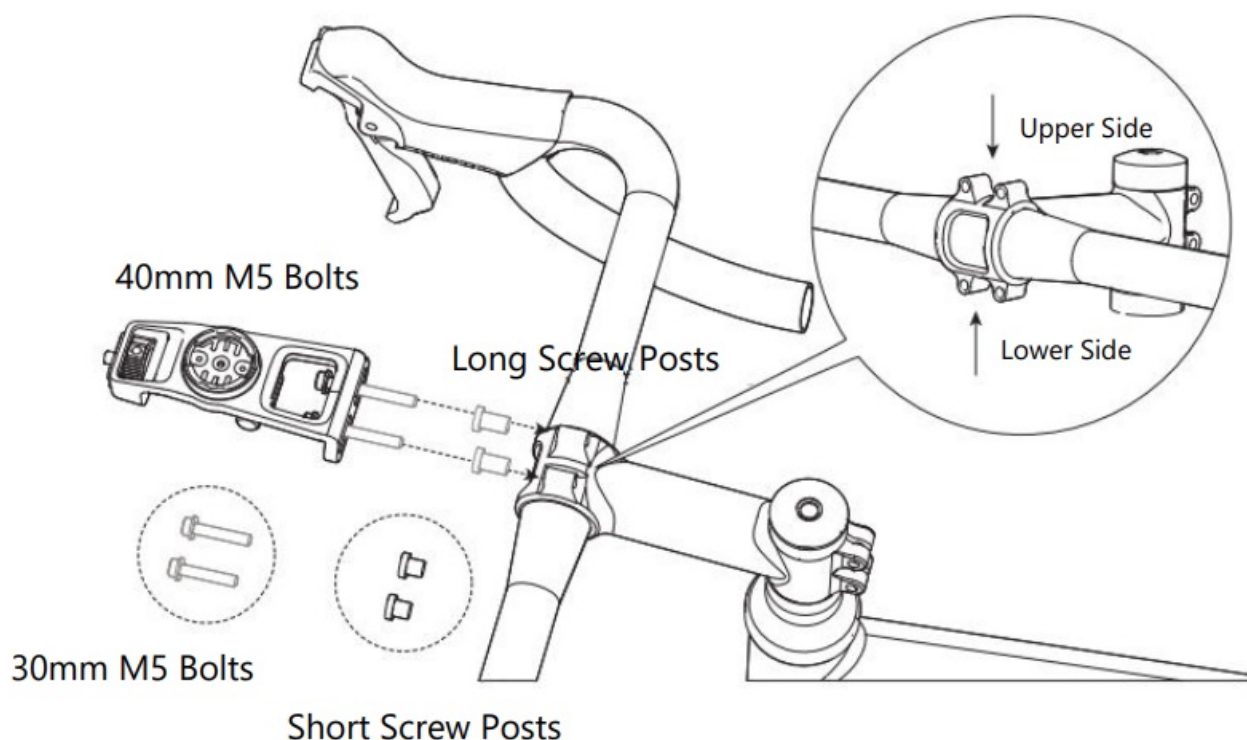

Note:

- The Bike Computer Mount can be installed on either the upper or lower side of the front of the bike, depending on your preference. To do this, remove a pair of bolts from either the upper or lower side of the bike. Select the appropriate bolts (either 30mm or 40mm M5 bolts) based on the length of the mounting holes, and use either the long or short screws with their corresponding posts. This will allow the mount to be positioned over the center of the bike, ensuring that the bolts are fastened securely and sit flush with the mounting posts. If you are unsure which bolts to use, try the longer bolt first. If the longer bolt does not fit properly, replace it with a shorter

one.

- When installing, make sure to pay attention to the alignment of the bolts so they are inserted directly into the screw posts. This ensures a secure fit.
- When tightening the bolts, it is recommended to use a torque wrench set to 5Nm. This ensures the mount is firmly secured to the handlebars. If you don't have a torque wrench, tighten the bolts until the mount is securely attached.
- The spacing between the holes of the Bike Computer Mount ranges from 11mm to 39mm, allowing compatibility with a variety of setups.

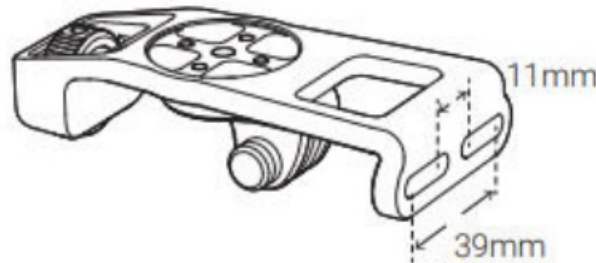

- Ensure that both bolts are securely fastened to the Bike Computer Mount. If your handlebar has only one bolt hole, or if the spacing is insufficient for proper installation, do not attempt to use the mount. Improper installation could result in mount failure and may cause damage to your camera.

Installing the Camera or Accessories

- Mount the camera (or accessories like a flashlight) using the 1/4" screw or the three-prong connector on the Bike Computer Mount.

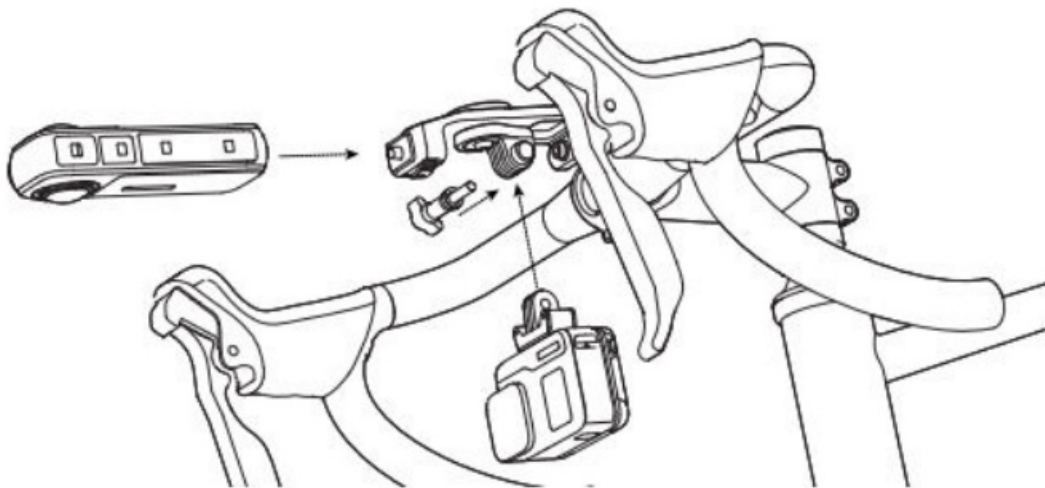

Note:

- Use the 1/4" screw or three-prong connector on the Bike Computer Mount to attach your camera or other accessories (like a flashlight).
- If installing via the 1/4" screw, make sure to tighten the mount securely during installation.
- If the three-prong connector becomes loose after installation, use one of the Anti-Slip Rings for extra reinforcement.

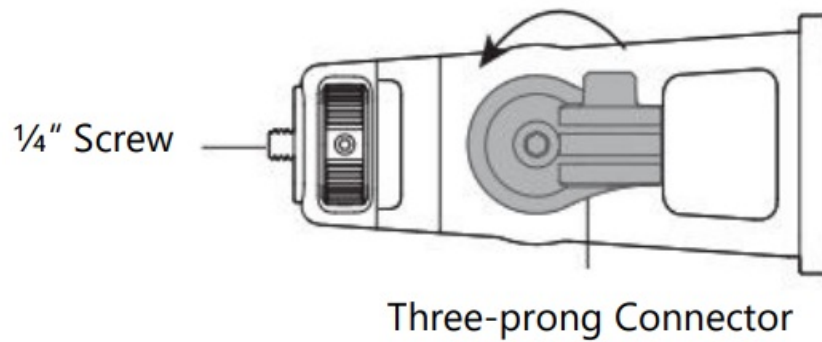

Tip: You can adjust the angle of the three-prong connector on the base by loosening or tightening the screws to get the desired camera angle.

Installing the Bike Computer

- After all other accessories are mounted, install the bike computer on the selected mount.
- Before riding, check that all screws and bolts are tight, and make sure the computer and accessories are properly mounted and secured.

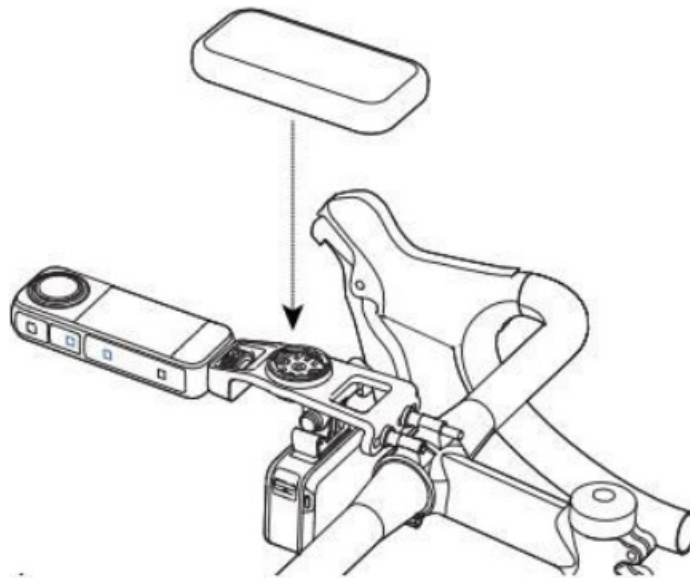

Instructions for Use

- Do not attach a selfie stick or similar accessory to the Bike Computer Mount. Only attach your bike computer directly.
- When installing any accessories, ensure the total weight does not exceed 500 grams (17.6 oz).
- Always check all screws, bolts, and mounts before riding to ensure everything is securely fastened and flush with the bike.
- For safety, it is recommended to keep your speed below 60km/h (37mph) on flat roads. This accessory is not suitable for rough or uneven terrains.

Disclaimer

Please read this disclaimer carefully before using the product. By using this accessory, you acknowledge and

agree to the terms outlined here. You are solely responsible for ensuring the safe use of this product and for any consequences that arise from improper use. Insta360, referred to as Arashi Vision Inc., accepts no liability for damages, injuries, or penalties that may occur from using this product and its associated accessories. Ensure that all components are functioning properly before use. If you notice any damage or irregularities, stop using the product immediately.

Insta360 reserves the right to revise this disclaimer at any time. Use of the product must comply with local safety regulations, including but not limited to road safety and traffic regulations. Insta360 will not be held liable for any legal issues resulting from improper use.

After-Sales Service

The product comes with a 3-month warranty starting from the original date of purchase. The availability of warranty services may vary depending on your location and the laws in your area. For further information on warranty policies, visit Insta360 Support.

Warranty Conditions

A new product purchased in the Alza.cz sales network is guaranteed for 2 years. If you need repair or other services during the warranty period, contact the product seller directly, you must provide the original proof of purchase with the date of purchase. The following are considered to be a conflict with the warranty conditions, for which the claimed claim may not be recognized:

- Using the product for any purpose other than that for which the product is intended or failing to follow the instructions for maintenance, operation, and service of the product.
- Damage to the product by a natural disaster, the intervention of an unauthorized person or mechanically through the fault of the buyer (e.g., during transport, cleaning by inappropriate means, etc.).
- Natural wear and aging of consumables or components during use (such as batteries, etc.).
- Exposure to adverse external influences, such as sunlight and other radiation or electromagnetic fields, fluid intrusion, object intrusion, mains overvoltage, electrostatic discharge voltage (including lightning), faulty supply or input voltage and inappropriate polarity of this voltage, chemical processes such as used power supplies, etc.
- If anyone has made modifications, modifications, alterations to the design, or adaptations to change or extend the functions of the product compared to the purchased design or use of non-original components.

Specifications

- **Product Name:** Bike Computer Mount (Independent Handlebars)
- **Manufacturer:** Alza.cz a.s.
- **Warranty:** 3 months
- **Weight Limit:** Not to exceed 500 grams (17.6 oz)

FAQ

Q: How do I adjust the camera angle?

A: You can adjust the camera angle by loosening or tightening the screws on the base of the mount.





Q: What is the weight limit for this mount?

A: The weight limit for this mount is 500 grams (17.6 oz).

Documents / Resources

 Bike Computer Mount (Independent Handlebars) <small>Insta360® - Bluetooth® - Handlebars® - Independent Handlebars®</small>	Insta360 W3 Bike Computer Mount [pdf] User Manual W3 Bike Computer Mount, W3, Bike Computer Mount, Computer Mount, Mount
---	--

References

-  [Alza | Alza.co.uk](#)
-  [Alza.cz – rychlý a pohodlný nákup odkudkoliv | Alza.cz](#)
-  [Alza.cz](#)
-  [alza.hu](#)
-  [alza.sk](#)
-  [Insta360 Bike Computer Mount - Independent Handlebars](#)
- [User Manual](#)

Manuals+. [Privacy Policy](#)

This website is an independent publication and is neither affiliated with nor endorsed by any of the trademark owners. The "Bluetooth®" word mark and logos are registered trademarks owned by Bluetooth SIG, Inc. The "Wi-Fi®" word mark and logos are registered trademarks owned by the Wi-Fi Alliance. Any use of these marks on this website does not imply any affiliation with or endorsement.