



Insta360 Pro 2 Panoramic Camera User Guide

[Home](#) » [Insta360](#) » Insta360 Pro 2 Panoramic Camera User Guide 

Insta360 Pro 2 Panoramic Camera User Guide



Contents

1 Insta360 Pro 2 Panoramic Camera

1.1 Insta360 Pro 2 Overview

1.2 Specification

2 Before You Start

3 Official App

4 Remote Connection

4.1 Wired Connection

4.2 Wireless Connection

5 Documents / Resources

6 Related Posts

Insta360 Pro 2 Panoramic Camera

Insta360 Pro 2 Overview

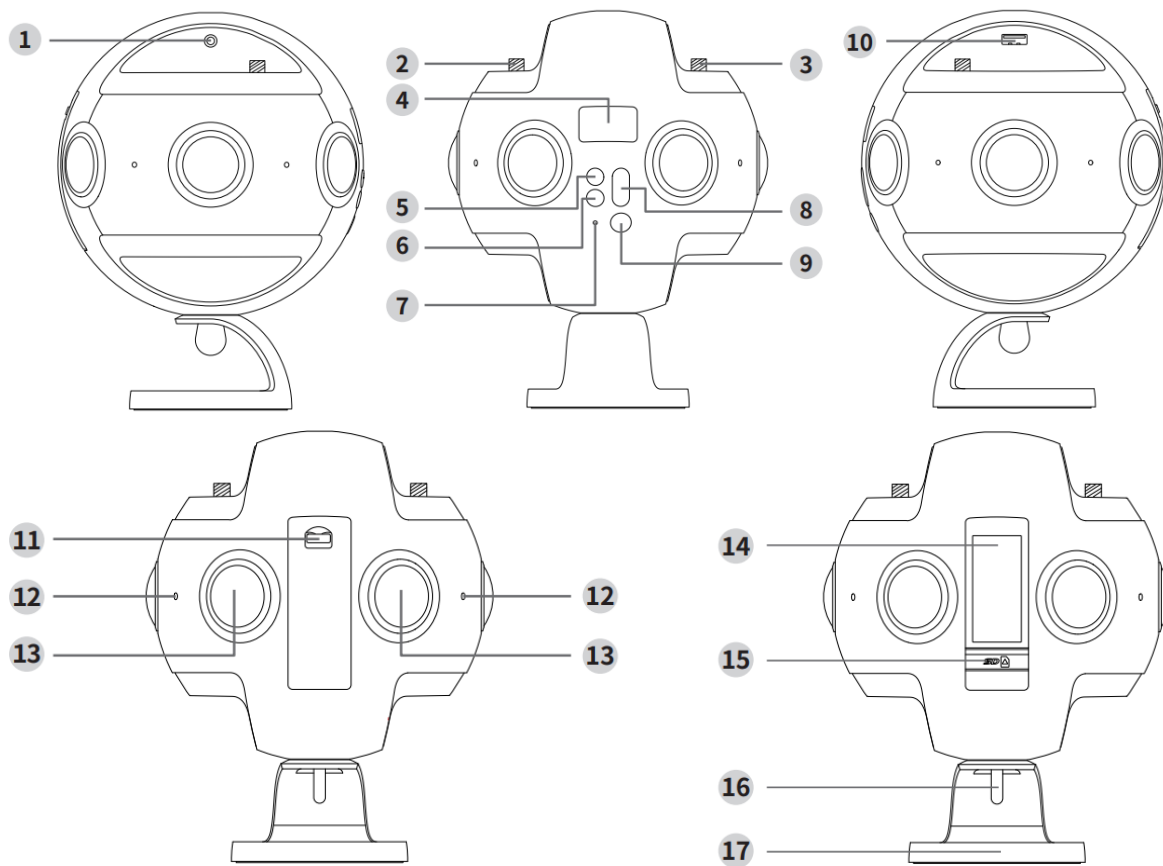

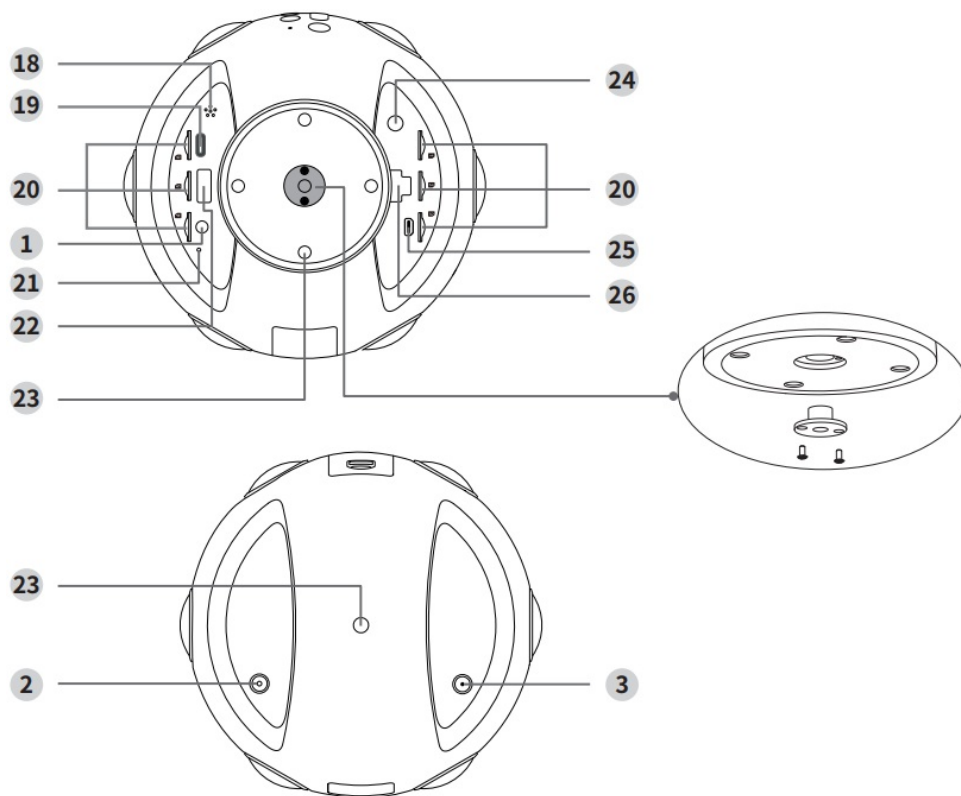

* As shown above, by detaching or attaching the 3/8" to 1/4" adapter on the fixed base, you can easily accomplish the conversion between a 1/4" and 3/8" mounting point

1. 3.5mm Audio input port x 2
2. GPS antenna
3. WIFI (AP) antenna
4. OLED display
5. Return button
6. Setting button
7. Power indicator
8. Switch button
9. Power/Enter button
10. USB 2.0 port
11. Battery hatch release
12. Microphone/Operation status indicator x 4
13. Lens x 6
14. Battery slot
15. SD card slot
16. Bolt
17. Fixed base
18. Speaker
19. USB Type-C port
20. MicroSD card slot x 6
21. Reset pinhole
22. USB 3.0 port
23. Standard 1/4" mounting pair
24. DC power Input port

25. HDMI 2.0 Type D port

26. LAN port

Specification

Items	Parameters
Lens	200° F2.4 fish-eye lens
Max. resolution of still image from single lens	4000 x 3000 (In-camera stitched panorama at maximum of 8K, 3D or mono)
Max. resolution of video from single lens in 360° panoramic mode	3840 x 2160 (Stitched panorama at maximum 8K mono)
Max. resolution of video from single lens in 360° 3D mode	3840 x 2880 (Stitched panorama at maximum 8K 3D)
Compatible storage media	SD card of standard V30 speed with UHS-I, exFat format. Sandisk Extreme Pro is recommended
Battery capacity	5100 mAh detachable lithium battery
Use time on full charge	50 min
Input	12 V / 5 A
Weight (with battery)	About 1.55 kg
Dimensions	φ143 mm

Before You Start

1. Before using the camera, please insert the rechargeable lithium polymer battery. Please connect the the power adapter in case of low or depleted battery.

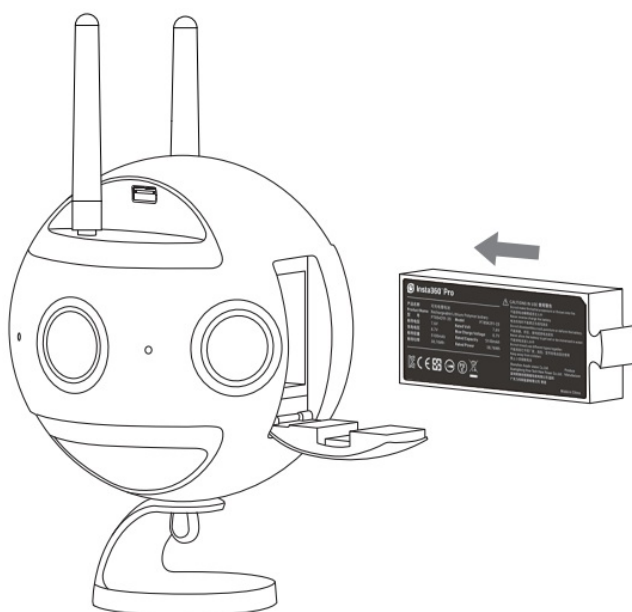

Rechargeable lithium polymer battery

2. Before using the camera, please insert 6 MicroSD cards, and insert an SD card.

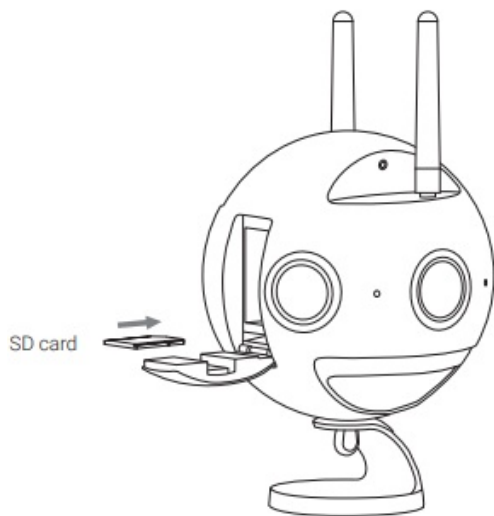
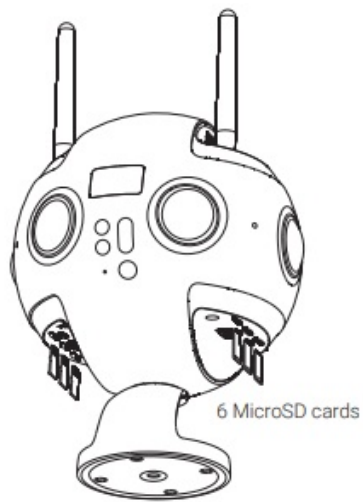

Official App

Scan the QR code below or visit https://www.insta360.com/r/download_insta360pro2 to download Insta360 Pro 2's official control app.



Remote Connection

After the camera connects to a wired/wireless network, it can be controlled remotely by the accompanying control software.

Wired Connection

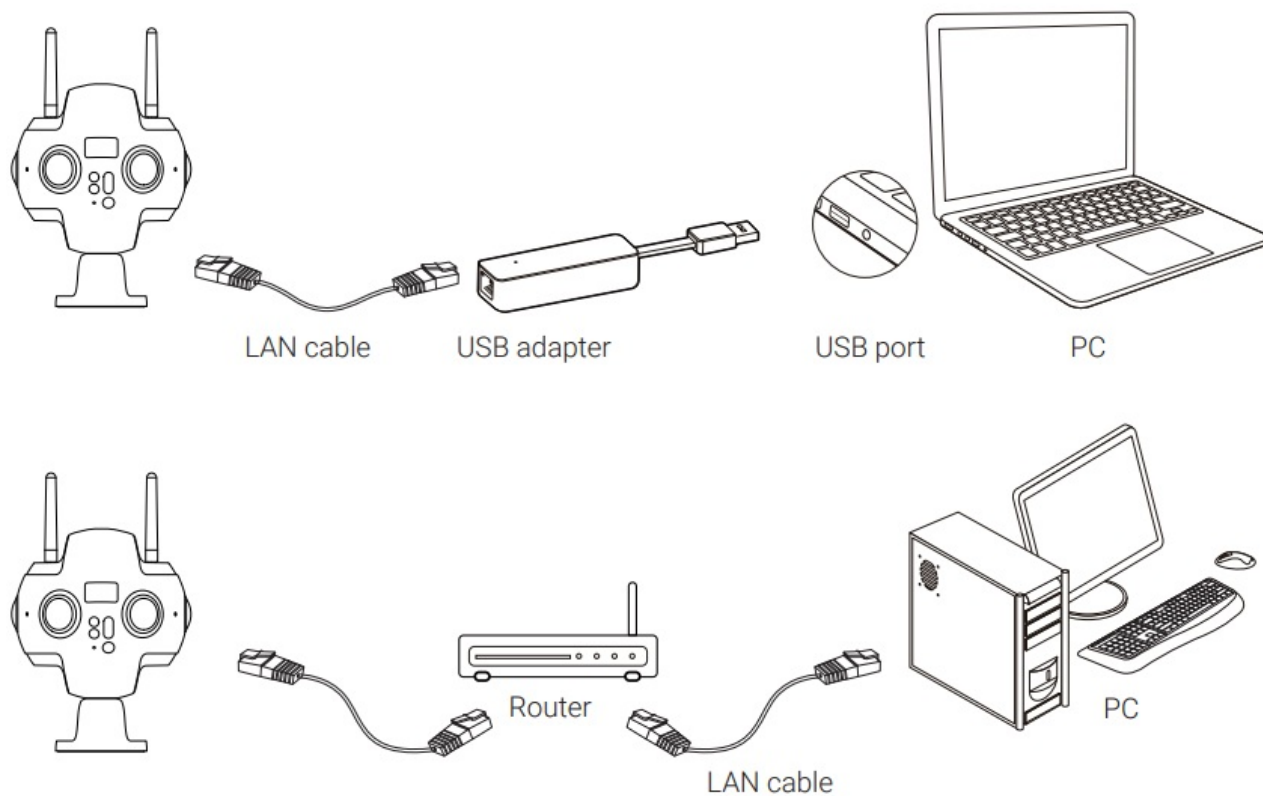

Wireless Connection

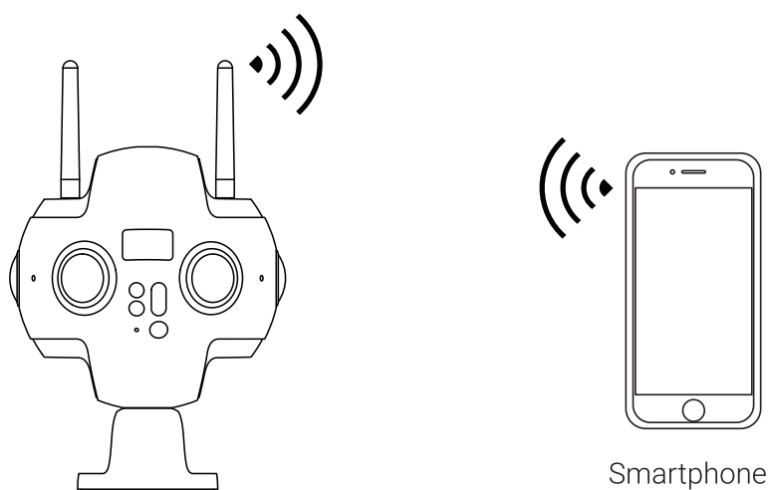

*Notice of further updates of this manual will not be issued.

Scan to learn more about the product



<https://www.insta360.com/r/pro2detail>

Scan by QR Code



Shenzhen Arashi Vision Company Limited

TEL (+86) 400-833-4360

EMAIL service@insta360.com

WEB www.insta360.com

ADD 6/F. Building A, Logan Century Center, 23 Haixiu Road, Bao'an District, Shenzhen, China



Documents / Resources

	<p>Insta360 Pro 2 Panoramic Camera [pdf] User Guide Pro 2 Panoramic Camera, Panoramic Camera, Camera</p>
---	--