

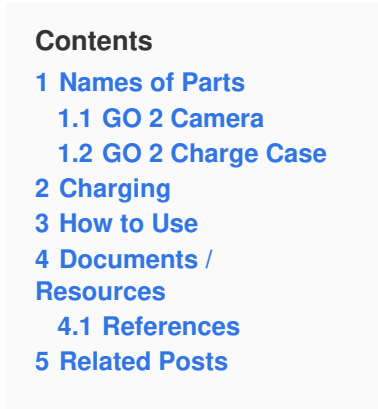

# Insta360 G0 2 Action Camera with Starter Accessory Bundle User Manual

[Home](#) » [Insta360](#) » **Insta360 G0 2 Action Camera with Starter Accessory Bundle User Manual** 

## Insta360 G0 2 Action Camera with Starter Accessory Bundle



## GO 2 Camera

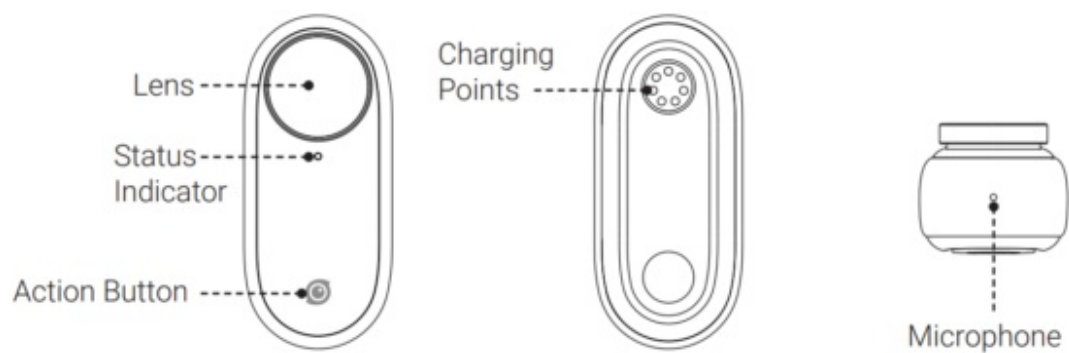

## GO 2 Charge Case

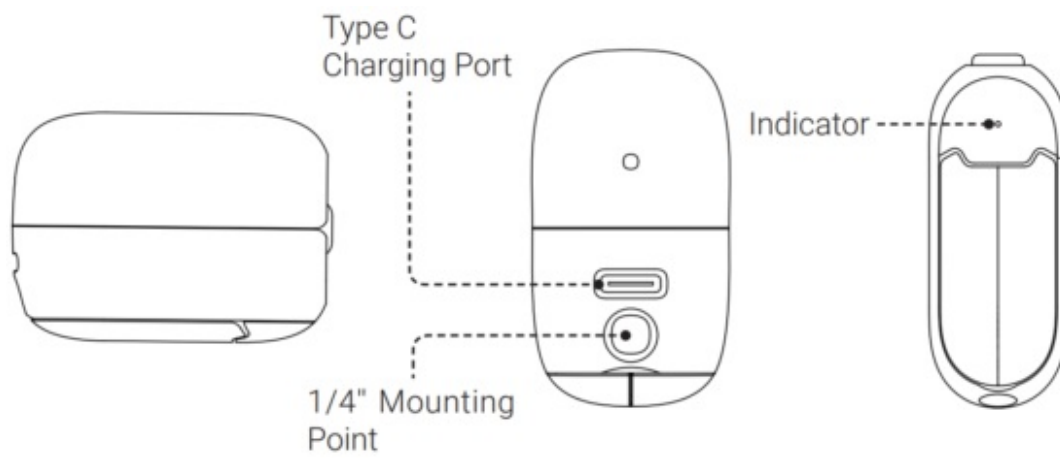

### Open the Charge Case:

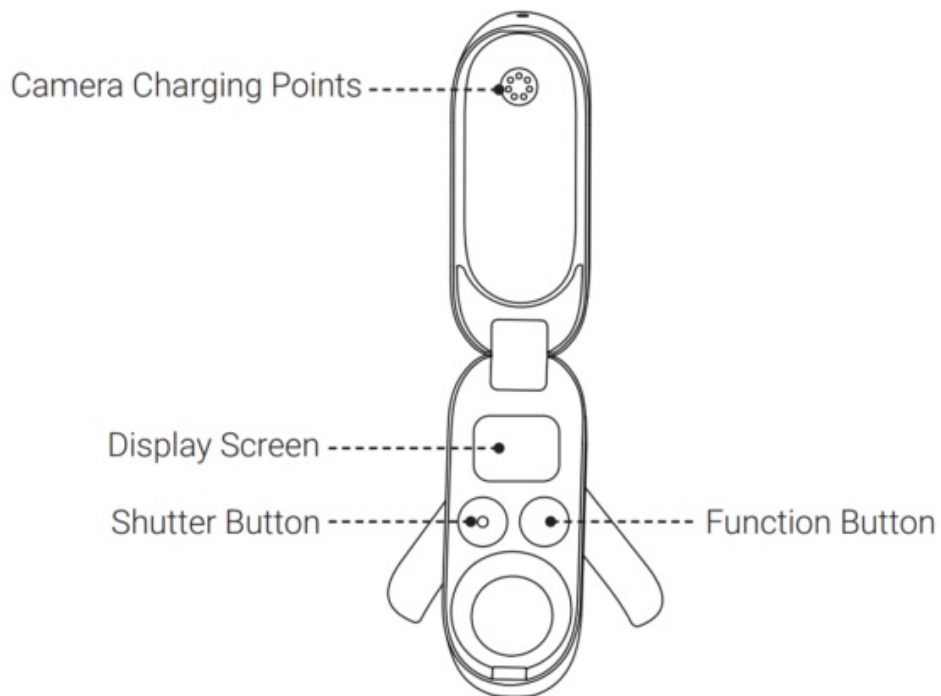

## Charging

Place GO 2 into its Charge Case for charging

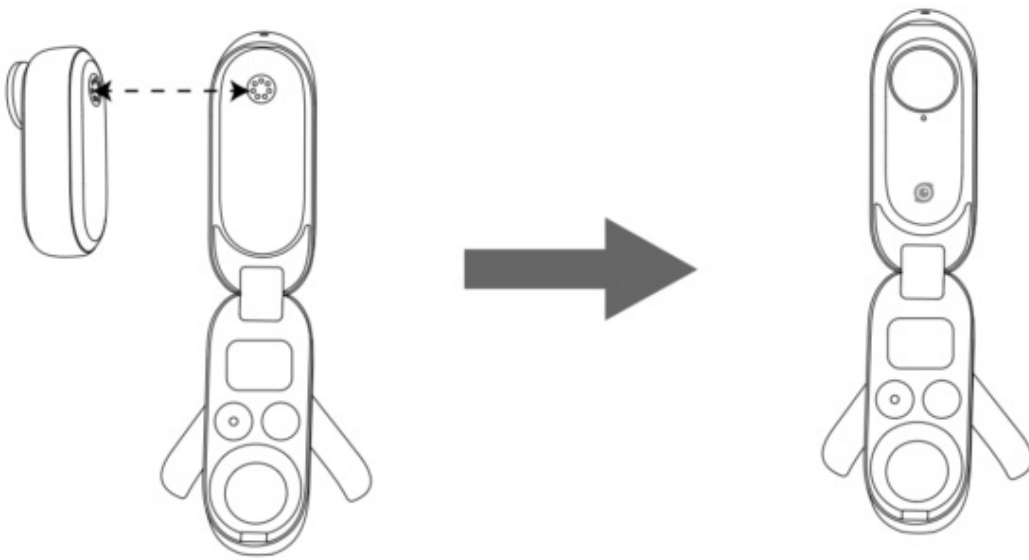

**Connect the included charge cable to GO 2 for charging**

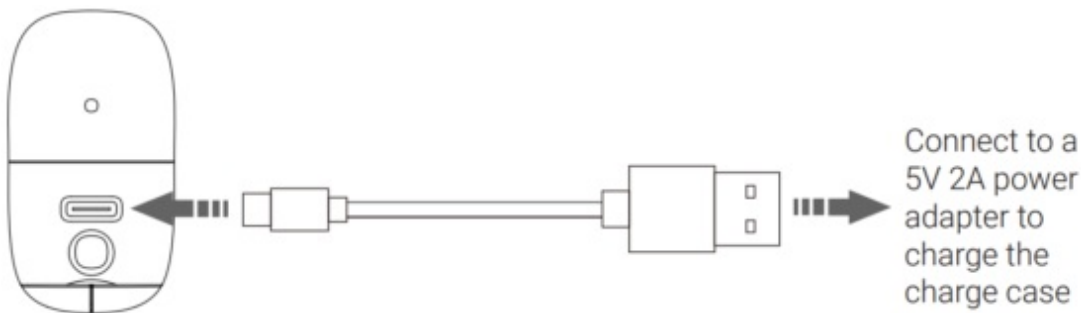

## How to Use

Press and hold the Action Button to power on GO 2, indicated with two short vibrations

Press and hold the Action Button for 2 seconds to power off.

Press and hold the Action Button for 6 seconds to force shutdown.

When the camera is powered on, press the Action Button to start recording (by default).

When the camera is powered on, press the Action Button to start recording (by default).

When the camera is powered on, press the Action Button twice in quick succession to take a photo.

\* This document is subject to change without notice. For more information, visit

<https://www.insta360.com/support/product-support>

## FCC Statement

This equipment has been tested and found to comply with the limits for a Class B digital device, pursuant to Part 15 of the FCC Rules. These limits are designed to provide reasonable protection against harmful interference in a residential installation. This equipment generates uses and can radiate radio frequency energy and, if not installed and used in accordance with the instructions, may cause harmful interference to radio communications. However, there is no guarantee that interference will not occur in a particular installation. If this equipment does cause harmful interference to radio or television reception, which can be determined by turning the equipment off and on, the user is encouraged to try to correct the interference by one or more of the following measures:

- Reorient or relocate the receiving antenna.
- Increase the separation between the equipment and receiver.
- Connect the equipment into an outlet on a circuit different from that to which the receiver is connected.
- Consult the dealer or an experienced radio/TV technician for help.

This device complies with part 15 of the FCC Rules. Operation is subject to the following two conditions:

(1) This device may not cause harmful interference, and (2) this device must accept any interference received, including interference that may cause undesired operation.

Changes or modifications not expressly approved by the party responsible for compliance could void the user's authority to operate the equipment

**IC STATEMENT**

This device complies with Industry Canada's licence-exempt RSSs. Operation is subject to the following two conditions:



- (1) This device may not cause interference; and
- (2) This device must accept any interference, including interference that may cause undesired operation of the device.

The device has been evaluated to meet general RF exposure requirement. The device can be used in portable exposure condition without restriction.

**Documents / Resources**

Insta360 GO 2	<a href="#">Insta360 GO 2 Action Camera with Starter Accessory Bundle</a> [pdf] User Manual IG2C, 2AWWH-IG2C, 2AWWHIG2C, GO 2 Action Camera with Starter Accessory Bundle
---------------	--

**References**

-  [Insta360 | Action Cameras | 360 Cameras | VR Cameras](#)
-  [Insta360 | Action Cameras | 360 Cameras | VR Cameras](#)