



# INSIGNIA NS-ATC18DSS1 Automatic Trash Can User Guide

[Home](#) » [Insignia](#) » INSIGNIA NS-ATC18DSS1 Automatic Trash Can User Guide 

# DENON<sup>®</sup>

## QUICK SETUP GUIDE Automatic Trash Can NS-ATC18DSS1

### Contents

- [1 PACKAGE CONTENTS](#)
- [2 FEATURES](#)
- [3 INSERTING THE BATTERIES](#)
- [4 SETTING UP YOUR TRASH CAN](#)
- [5 TURNING YOUR TRASH CAN ON AND OFF](#)
- [6 USING YOUR TRASH CAN](#)
- [7 USING MANUAL MODE](#)
- [8 LED INDICATORS](#)
- [9 TROUBLESHOOTING](#)
- [10 SPECIFICATIONS](#)
- [11 IMPORTANT SAFETY INFORMATION](#)
- [12 LEGAL NOTICES](#)
- [13 ONE-YEAR LIMITED WARRANTY](#)
- [14 Documents / Resources](#)
- [15 Related Posts](#)

## PACKAGE CONTENTS

- Lid
- Liner rings (2)
- Base
- Magnetic labels (2)

- Quick Setup Guide

## FEATURES

- Two compartments (9.3 gal/35 l each) with magnetic labels let you sort trash and recycling
- IR sensor detects your hand (or another object) to automatically open and close the lid
- Battery operated (3 D batteries, not included) for cordless operation
- Liner rings hold standard trash bags in place
- Fingerprint-free stainless steel fits seamlessly into any living space

Before using your new product, please read these instructions to prevent any damage.

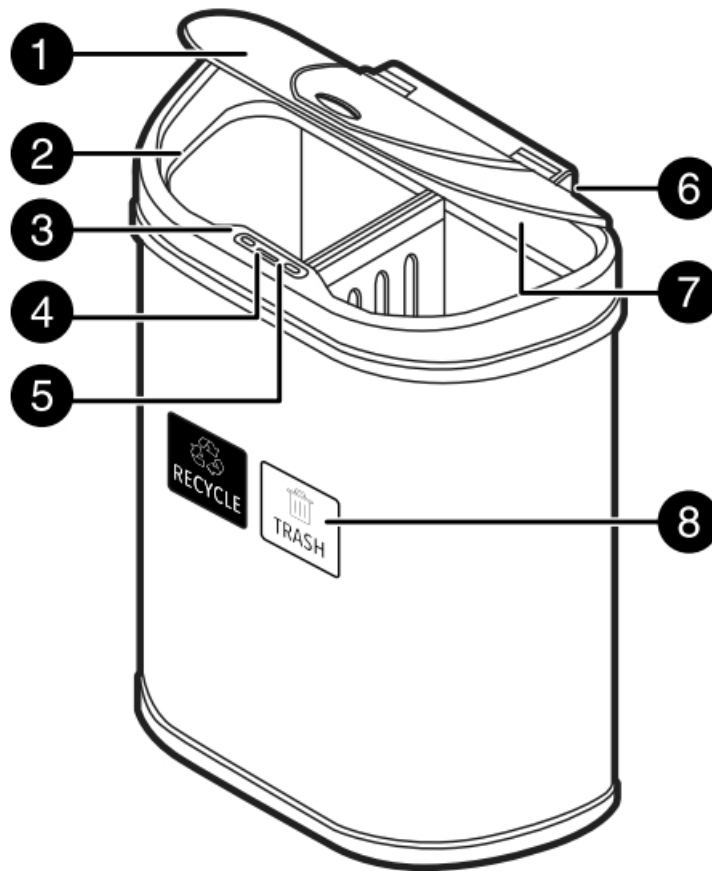

#	ITEM	DESCRIPTION
1	Hands-free automatic lid	Move an object or hand above the strategically placed infrared motion sensor. The lid opens automatically. After the object or the hand is out of sensor range, the lid closes automatically within seconds.
2	Liner ring (inside)	Secures the trash bag.
3	Manual close button	Closes the lid and reactivates the sensor.
4	LED indicator and infrared motion detecting sensor	<ul style="list-style-type: none"> <li>• Flashing green: The trash can is in sensor mode</li> <li>• Solid green: Lid opens</li> <li>• Flash 3 times: Lid closes</li> <li>• Red: Low battery power</li> </ul>
5	Manual open button	Keeps lid open and sensor off.
6	Power saving on/off switch	Located on the backside of the lid.
7	Battery compartment	Located underneath the lid (holds three “D” batteries not included)
8	Magnet labels	Trash and recycling magnet labels

## INSERTING THE BATTERIES

1. Locate the battery compartment underneath the lid.

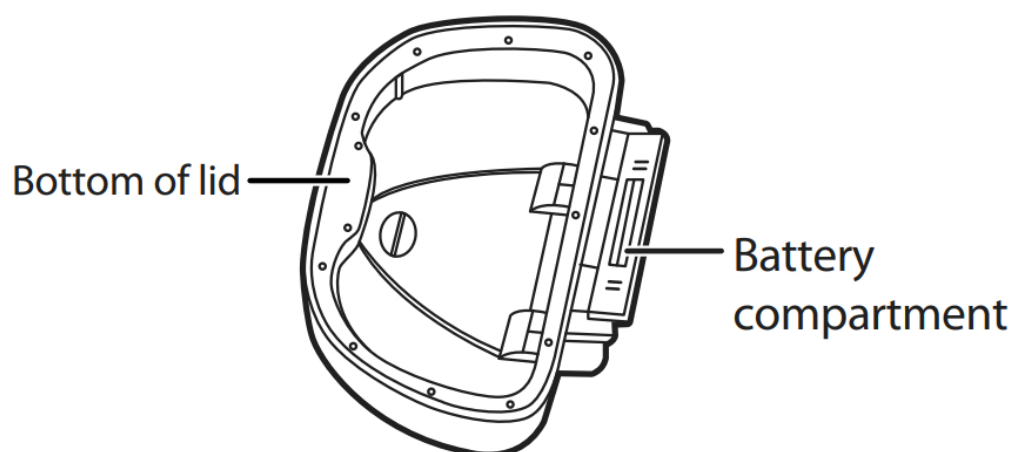

2. Push the tab on the battery cap in and carefully lift up to open.

3. Insert three heavy-duty D-size batteries (not included) in accordance with the positive (+) and negative (-) poles shown in the battery compartment.
4. To close, insert the side without the clip first, then push the battery cap down. Make sure that it's securely fastened (it should click into place).

## SETTING UP YOUR TRASH CAN

1. Remove your lid and liner ring.

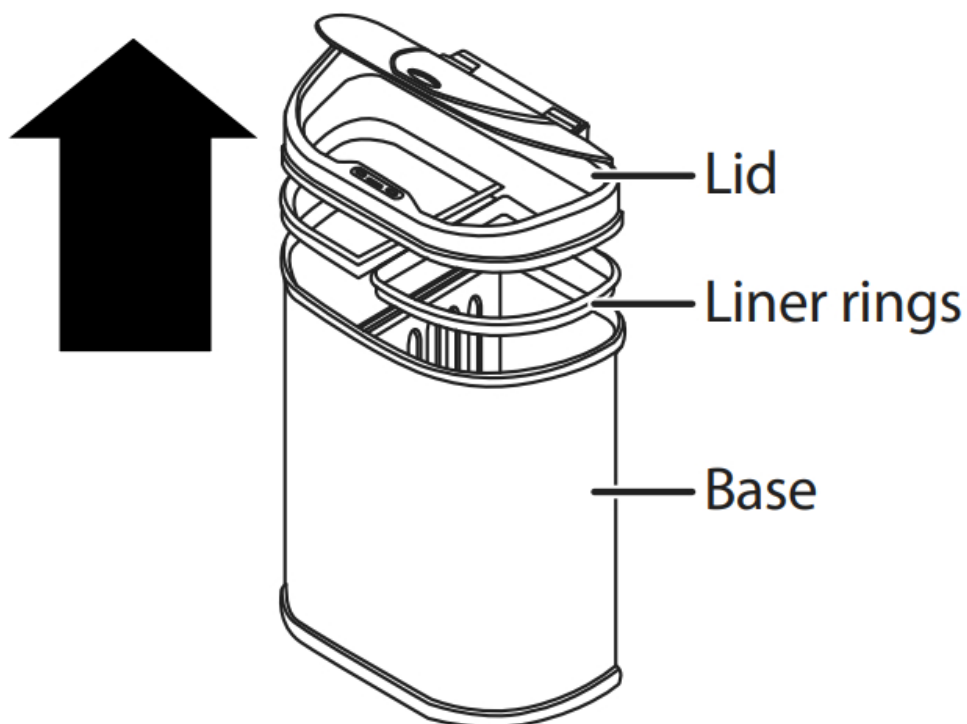

2. Insert the trash bag through the liner ring.

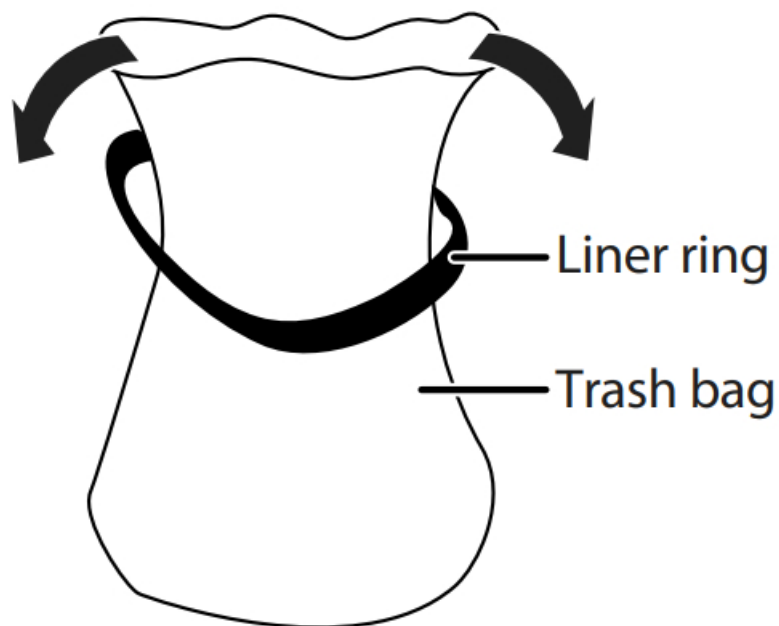

3. Fold the upper rim of the bag around the liner ring.
4. Place the trash bag and the liner ring in the trash container.
5. Tuck the bag completely into the bottom of the container so that the edges of the bag are concealed after the lid is closed.

Note: Do not put the liner ring inside the bag.

6. Repeat steps 2-5 on the other side.
7. Align the lid with the base and gently place the lid on top.

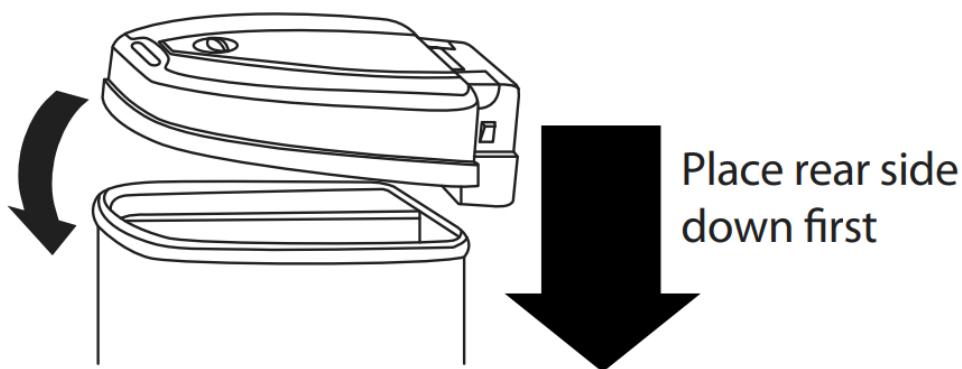

## TURNING YOUR TRASH CAN ON AND OFF

1. Locate the power switch on the back of the automatic lid.
2. Press the switch to the "I" position to turn the power/sensor on.
3. Press the switch to the "O" position to turn the power/sensor off.

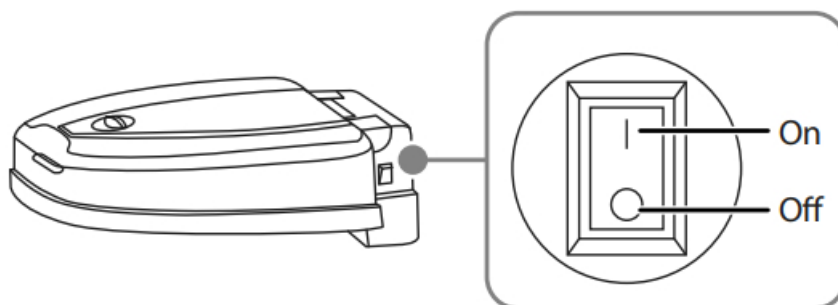

## USING YOUR TRASH CAN

1. Place your hand or an object within inches of the motion sensor (located on the lid). The lid opens automatically.

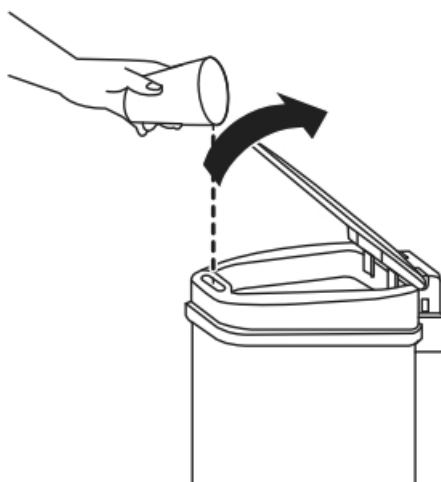

2. After your hand or object is out of the sensor range, the lid closes automatically within seconds. The lid remains open if the object stays within the sensor range.

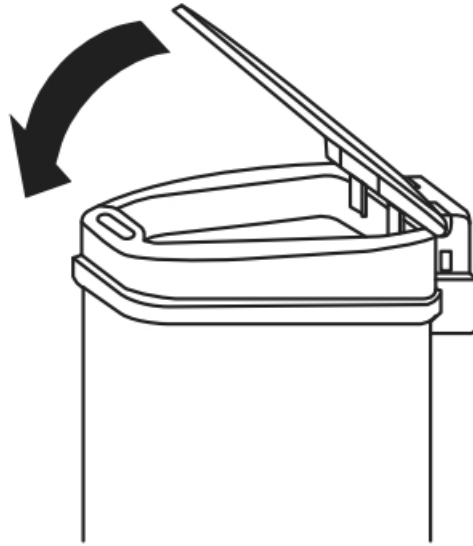

## USING MANUAL MODE

1. To keep the lid in the open position for a longer period, press the OPEN button.
2. Press the CLOSE button to close the lid and reactivate the sensor.

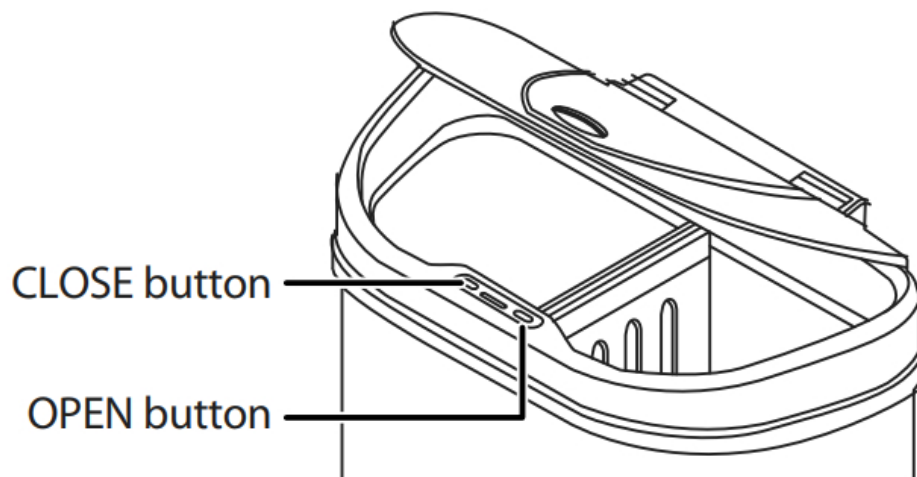

**Note:** The lid has a soft close feature that allows the lid to close at a slow and quiet pace.

## LED INDICATORS

- **Turning on the trash can:** Turn the power switch into the “I” position and a green light will flash once, indicating that the trash can is in sensor mode.
- **Opening the lid:** Wave above the sensor, a solid green light appears when the lid opens.
- **Lid closing:** A green light will flash 3 times, then the lid closes. A solid green light appears when the lid is in motion.
- **Low battery:** A red light appears when battery power is low. Replace the batteries.

## TROUBLESHOOTING

Lid does not open

- Make sure that the power is on by pressing the power switch.
- Make sure that the batteries are installed correctly.
- Wipe the sensor with a dry cloth. The lid does not close, the indicator light is a constant green
- Press the power switch to close the trash can.
- Check to see if there are any objects within the sensor area. If there are, remove them.
- Wipe the sensor with a dry cloth to make sure that the sensor is clean and that there is no excess moisture on it. The lid opens slowly and the indicator light flashes yellow
- Battery power is low. Replace the batteries.

**Note:** If the above solutions do not correct the problem, contact customer service.

## SPECIFICATIONS

- Dimensions: 13 × 21.3 × 26.4 in.  
(33 × 54.2 × 67.1 cm)
- Dimensions with lid open: 13 × 21.3 × 36.5 in.  
(33 × 54.2 × 92.7 cm)
- Sensor distance: 7.8 in. (20 cm)
- Batteries: Three D (not included)
- Input: DC 4.5 V, .15 mA
- Net weight: 12.6 lbs. (5.7 kg)
- Basket capacity: 9.3 gal (35 l)(each side)
- Material: Stainless steel

## IMPORTANT SAFETY INFORMATION

1. Align batteries according to the positive and negative poles.
2. Do not submerge the trash can into the water because it is equipped with many electrical components. The trash can may be wiped with a damp cloth.
3. Do not manually force the lid to close. This can cause damage to the internal gears. If the gears are damaged, the automatic lid will not function properly.
4. Replace used batteries in a timely manner to prevent battery acid leakage. Battery acid may cause damage to the electrical components of the trash can.
5. Do not mix new and used batteries.
6. Do not place the trash can in direct sunlight or a heavily moisturized environment.
7. Do not mix alkaline, standard (zinc-carbon), or rechargeable (NiCad, NiMH, etc) batteries.
8. Batteries are harmful if swallowed, so keep away from young children.

## LEGAL NOTICES

This device complies with part 15 of the FCC Rules. Operation is subject to the following two conditions:

1. This device may not cause harmful interference, and (2) this device must accept any interference received, including interference that may cause undesired operation. Changes or modifications not expressly approved

by the party responsible for compliance could void the user's authority to operate the equipment.

**Note:** This equipment has been tested and found to comply with the limits for a Class B digital device, pursuant to part 15 of the FCC Rules. These limits are designed to provide reasonable protection against harmful interference in a residential installation. This equipment generates, uses, and can radiate radio frequency energy and, if not installed and used in accordance with the instructions, may cause harmful interference to radio communications. However, there is no guarantee that interference will not occur in a particular installation. If this equipment does cause harmful interference to radio or television reception, which can be determined by turning the equipment off and on, the user is encouraged to try to correct the interference by one or more of the following measures:

- Reorient or relocate the receiving antenna.
- Increase the separation between the equipment and receiver.
- Connect the equipment into an outlet on a circuit different from that to which the receiver is connected.
- Consult the dealer or an experienced radio/TV technician for help.

**CAN ICES-3(B)/NMB-3(B)**

## ONE-YEAR LIMITED WARRANTY

Visit [www.insigniaproducts.com](http://www.insigniaproducts.com) for details.

### CONTACT INSIGNIA:

For customer service, call 1-877-467-4289 (U.S. and Canada) or

01-800-926-3000 (Mexico)

[www.insigniaproducts.com](http://www.insigniaproducts.com)

INSIGNIA is a trademark of Best Buy and its affiliated companies.

Distributed by Best Buy Purchasing, LLC

7601 Penn Ave South, Richfield, MN 55423 U.S.A.

©2020 Best Buy. All rights reserved.

## Documents / Resources

	<p><a href="#">INSIGNIA NS-ATC18DSS1 Automatic Trash Can</a> [pdf] User Guide NS-ATC18DSS1, Automatic Trash Can</p>
-------------------------------------------------------------------------------------	-------------------------------------------------------------------------------------------------------------------------