

Inner range IR Fisheye Camera User Guide

[Home](#) » [inner range](#) » Inner range IR Fisheye Camera User Guide 

Contents

- 1 Inner range IR Fisheye Camera
- 2 1. Packing List
- 3 2. Device Port
- 4 3. Device Dimension
- 5 4. Reset and Install SD Card
- 6 5. Device Installation
- 7 6. Network Setup / Device Activation
- 8 7. Network Setup / Device Activation
- 9 8. Important Information
- 10 9. Installation and Usage Precautions
- 11 Specifications
- 12 FAQ
 - 12.1 Q: Can the camera be activated with an Inner Range Gateway?
 - 12.2 Q: Is there power voltage from the camera?
- 13 Documents / Resources
 - 13.1 References
- 14 Related Posts

Inner range IR Fisheye Camera

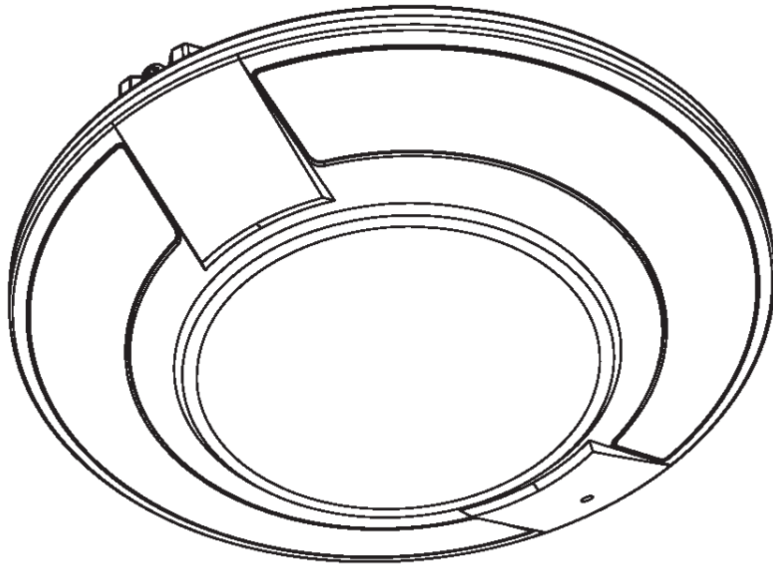

USER GUIDE

1. Packing List

Accessories can vary from region to region. Please refer to the actual product.

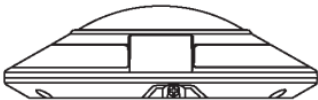

1 x Flat head
screwdriver



1 x Waterproof
grommet for network
access port



3 x Stainless steel
self-tapping screws



3 x Plastic wall
anchors



1 x Mounting
template

2. Device Port

NOTE: Different devices may have different multi-core cables; The figure is only for your reference, please refer to the actual application scene.

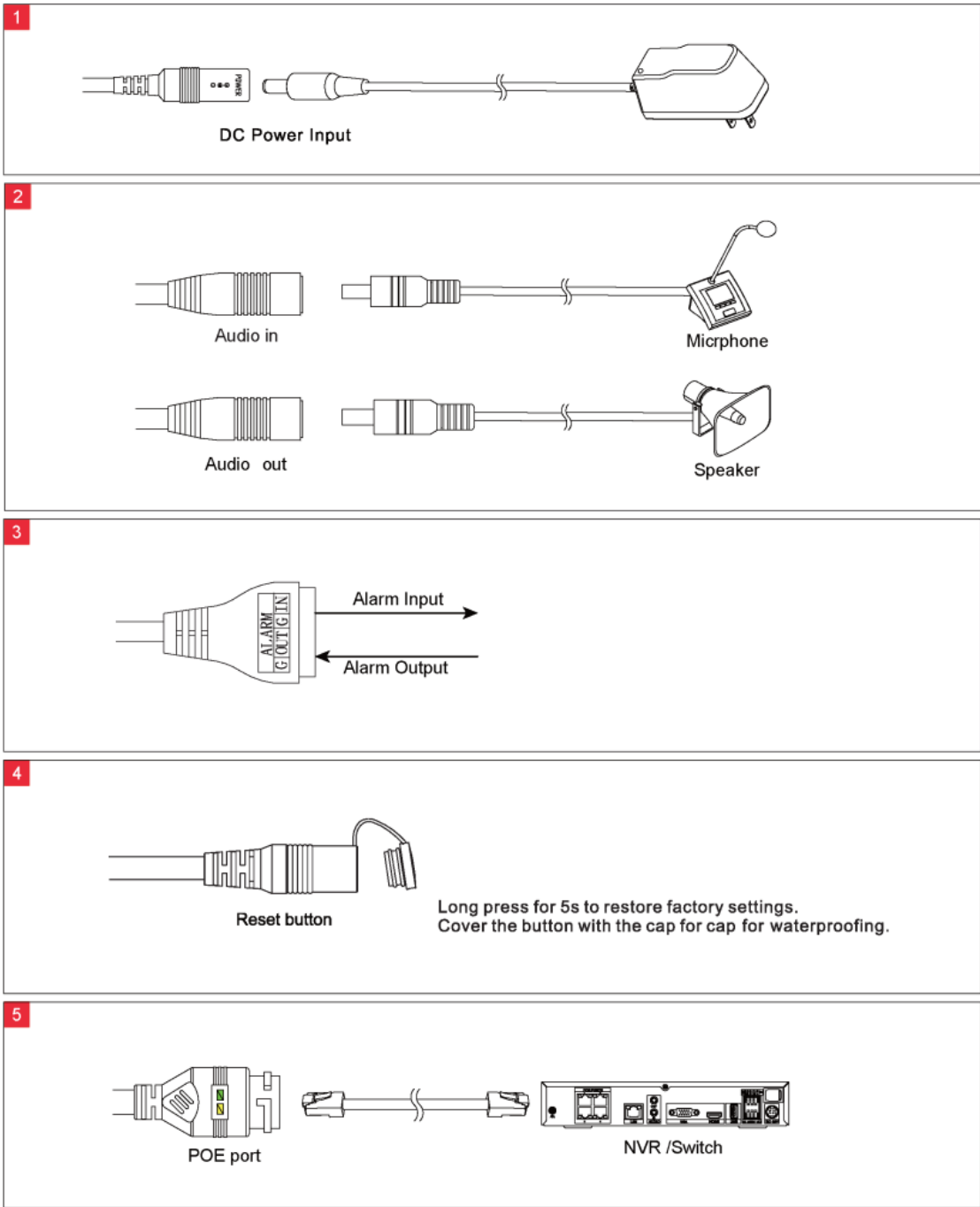

NOTE: All external devices should be powered separately.

There is no power voltage from the camera.

3. Device Dimension

NOTE: Fisheye cameras have varying overall dimensions, please check the product data sheet for accuracy.

Unit: mm

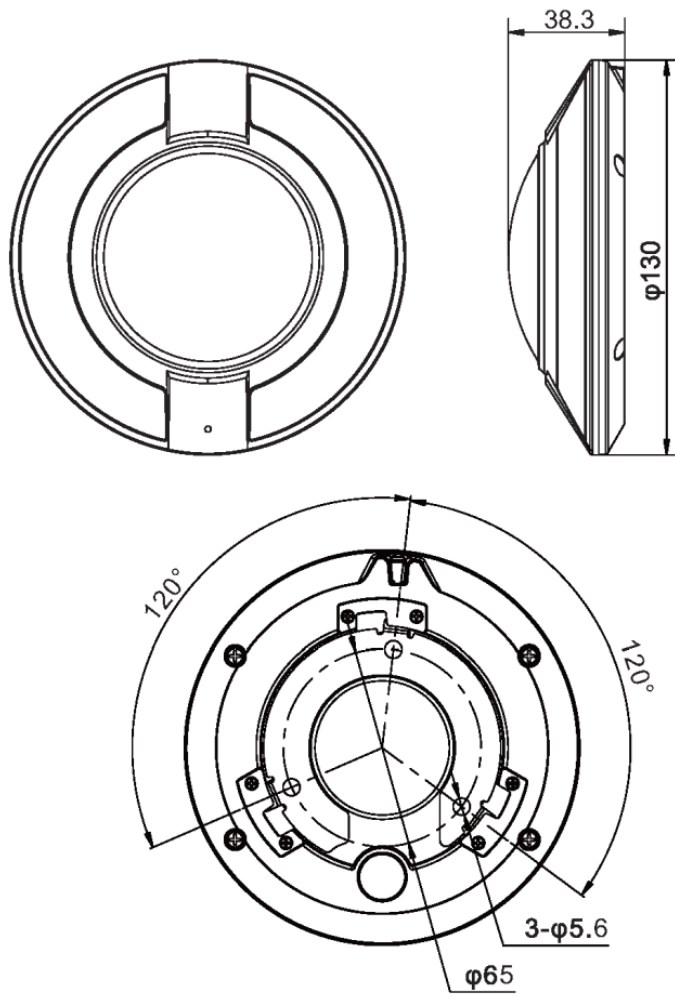

4. Reset and Install SD Card

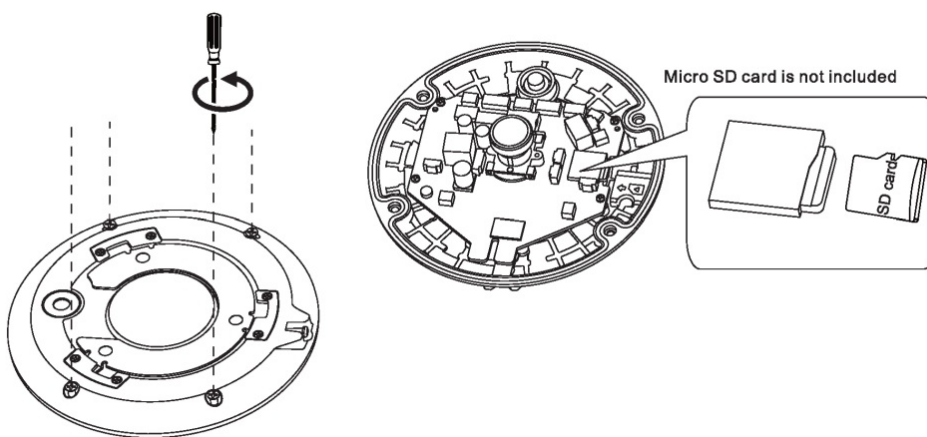

5. Device Installation

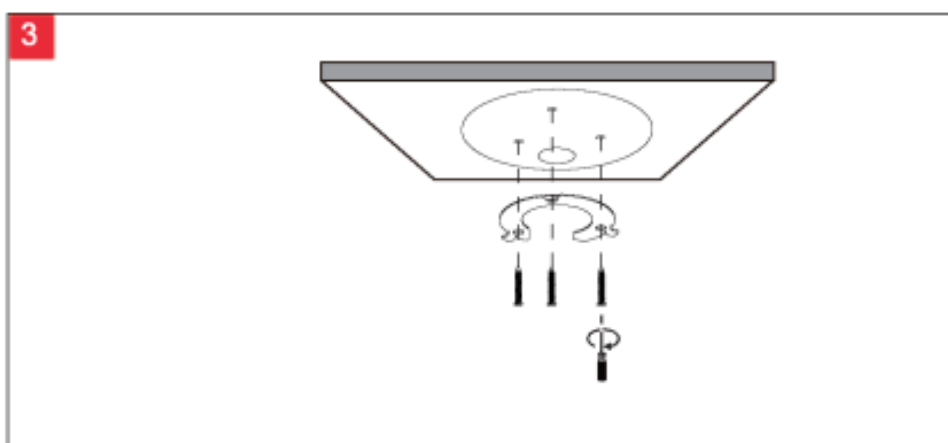
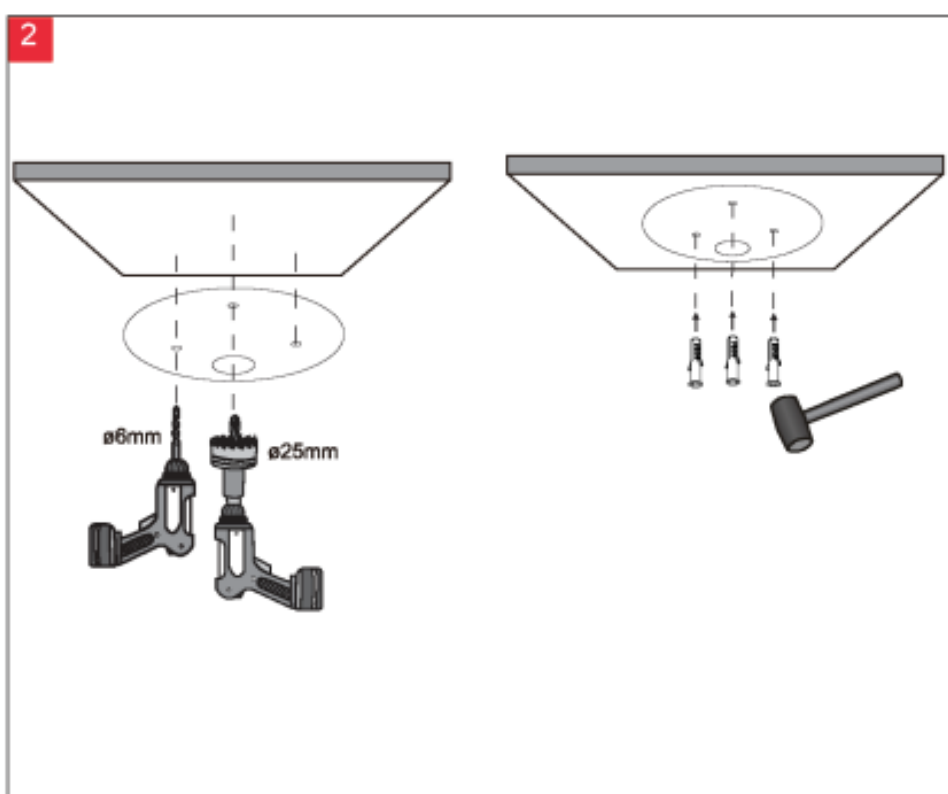
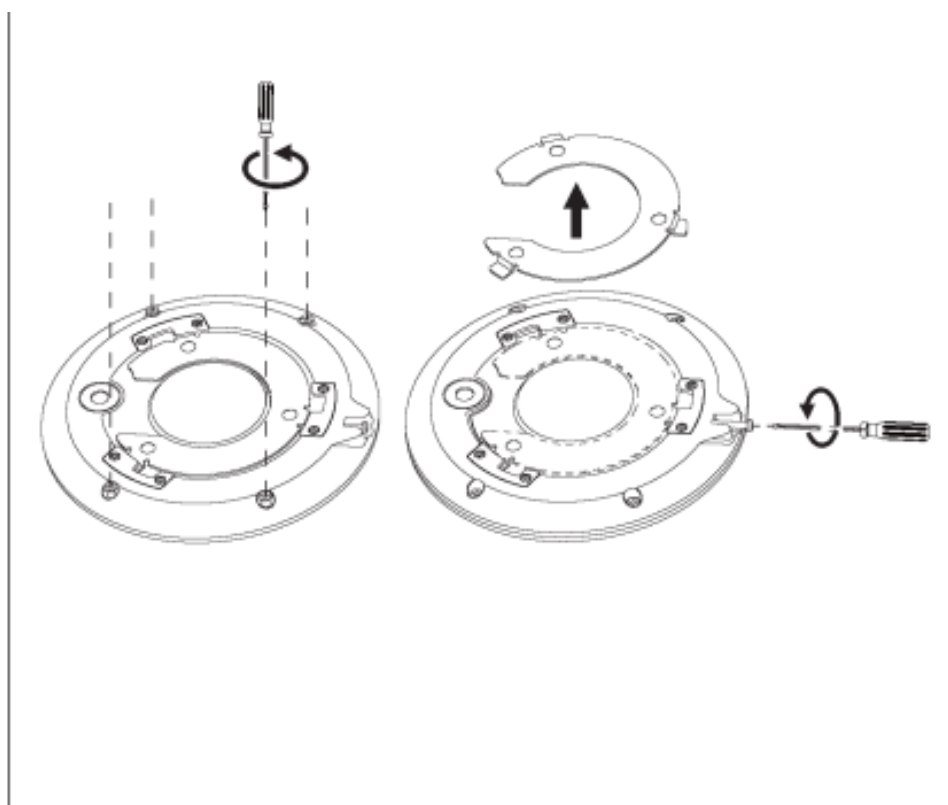

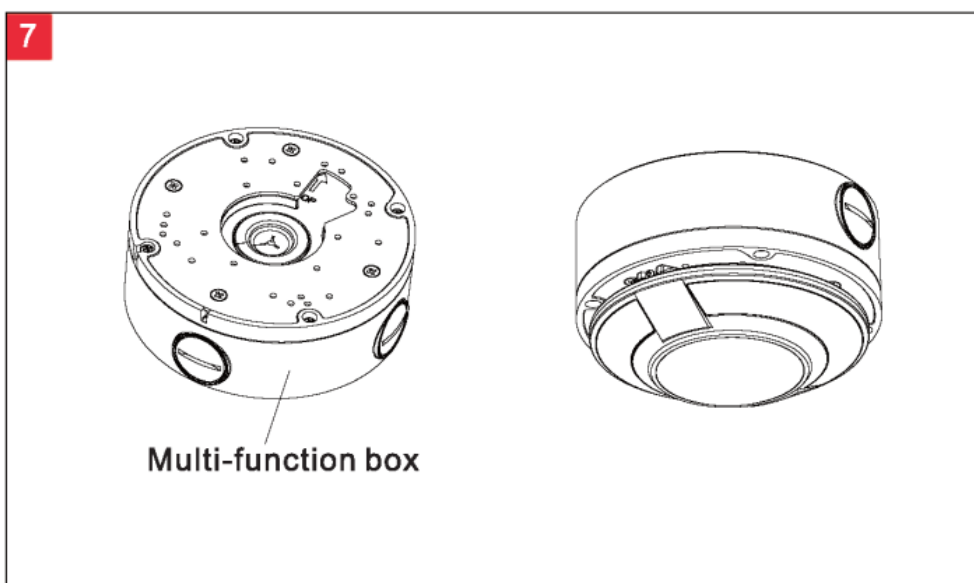
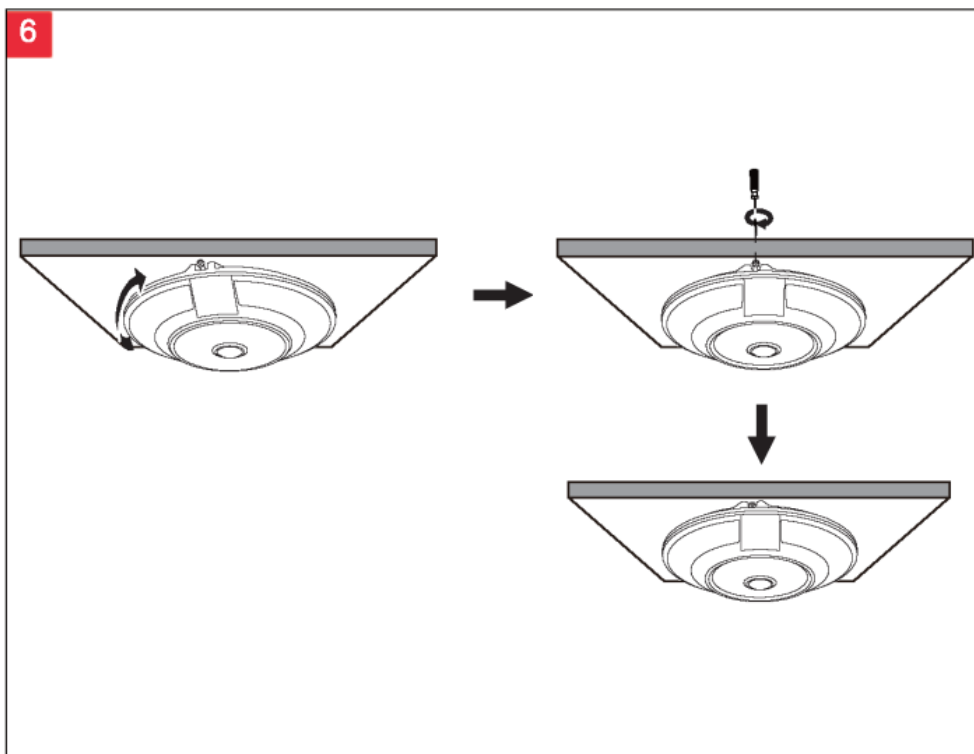

6. Network Setup / Device Activation

1. Connect to the IP address from your web browser.
2. For security, HTTPS is turned on by default, you may see a warning telling you the site is insecure ... this is because the self-signed certificate built into the camera is not “trusted” by your computer.

This is not an issue in this case, all data sent between your computer and the camera is safely encrypted and it is safe to proceed.



Your connection isn't private

Attackers might be trying to steal your information from **192.168.160.249** (for example, passwords, messages, or credit cards). [Learn more about this warning](#)

NET:ERR_CERT_AUTHORITY_INVALID

Hide advanced

Go back

This server couldn't prove that it's **192.168.160.249**; its security certificate is not trusted by your computer's operating system. This may be caused by a misconfiguration or an attacker intercepting your connection.

[Continue to 192.168.160.249 \(unsafe\)](#)

3. You will then be prompted to create a new admin password and can then use that password to log-in and configure your camera.



Please Create Password

English ▾

User Name

admin

New Password

Please Input New Password

Confirm

Create



English ▾

Please Input Username

Please Input Password

Login

7. Network Setup / Device Activation

The camera can be either activated with your Inner Range Gateway (NVR) or directly from the built in web interface.

Activation with a Gateway

- Connect the Camera to one of the POE ports on the Gateway with a network cable.
- The Gateway will automatically discover and adopt the camera.
- Alternatively, you can connect the camera to the same network the Gateway is on and allow the Gateways built in search functionality to discover and adopt it. Please consult the Gateway documentation for further details.

Stand Alone Activation

- Connect the camera to your network, and power it (either by PoE or by the DC jack)
- Your camera is set to obtain an IP address automatically via DHCP.
- Discover the IP address that was assigned to your camera from either your network administration portal, or the “IR Video Search Tool” available in the downloads section of the Inner Range website (see QR Code on this guide).

8. Important Information

- Please read this guide thoroughly before using the device.
- Failure to use the product correctly may result in fire or injury.
- Improper use can lead to equipment damage, data loss, or poor performance. Always follow the recommended guidelines for installation and usage.
- Always use accessories provided with the camera. Ensure the voltage aligns with the device’s input requirements.

9. Installation and Usage Precautions

- Install according to the given guidelines to prevent damage.
- Use only power adapters compliant with local safety.
- If powered by PoE (power over ethernet) ensure the powering device has sufficient PoE budget to allow all devices to operate at their maximum rated power (see datasheet).

Specifications

- Device Type: Panoramic Fisheye Camera
- Power Source: POE port
- Dimensions: Varying, refer to product data sheet

Quick Setup Guide – Copyright © Inner Range Pty Ltd October 2024

The specifications and descriptions of products and services contained in this document were correct at the time

of release of this document. Inner Range Pty Ltd reserves the right to change specifications or withdraw products without notice.

This document cannot be re-published or re-hosted without the prior written consent of Inner Range. For the latest version of this document, please visit the Inner Range website.

FAQ

Q: Can the camera be activated with an Inner Range Gateway?

A: Yes, the camera can be activated either with an Inner Range Gateway (NVR) or directly through the built-in web interface.

Q: Is there power voltage from the camera?

A: No, all external devices should be powered separately as the camera does not provide power voltage.

Documents / Resources

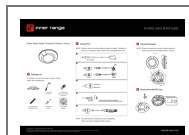

[Inner range IR Fisheye Camera](#) [pdf] User Guide
IR Fisheye Camera, IR Fisheye, Camera

References

- [User Manual](#)

[Manuals+](#), [Privacy Policy](#)

This website is an independent publication and is neither affiliated with nor endorsed by any of the trademark owners. The "Bluetooth®" word mark and logos are registered trademarks owned by Bluetooth SIG, Inc. The "Wi-Fi®" word mark and logos are registered trademarks owned by the Wi-Fi Alliance. Any use of these marks on this website does not imply any affiliation with or endorsement.