



# INKBIRDPLUS PTH-9A Multi Functional Air Quality Detector User Manual

[Home](#) » [INKBIRDPLUS](#) » INKBIRDPLUS PTH-9A Multi Functional Air Quality Detector User Manual 

## Contents

- [1 INKBIRDPLUS PTH-9A Multi Functional Air Quality Detector](#)
- [2 Product Introduction](#)
- [3 Specification](#)
- [4 Operation](#)
- [5 How to set time, date and year](#)
- [6 Limited Warranty](#)
- [7 Documents / Resources](#)
  - [7.1 References](#)
- [8 Related Posts](#)

INKBIRD**PLUS**

**INKBIRDPLUS PTH-9A Multi Functional Air Quality Detector**



## Product Introduction

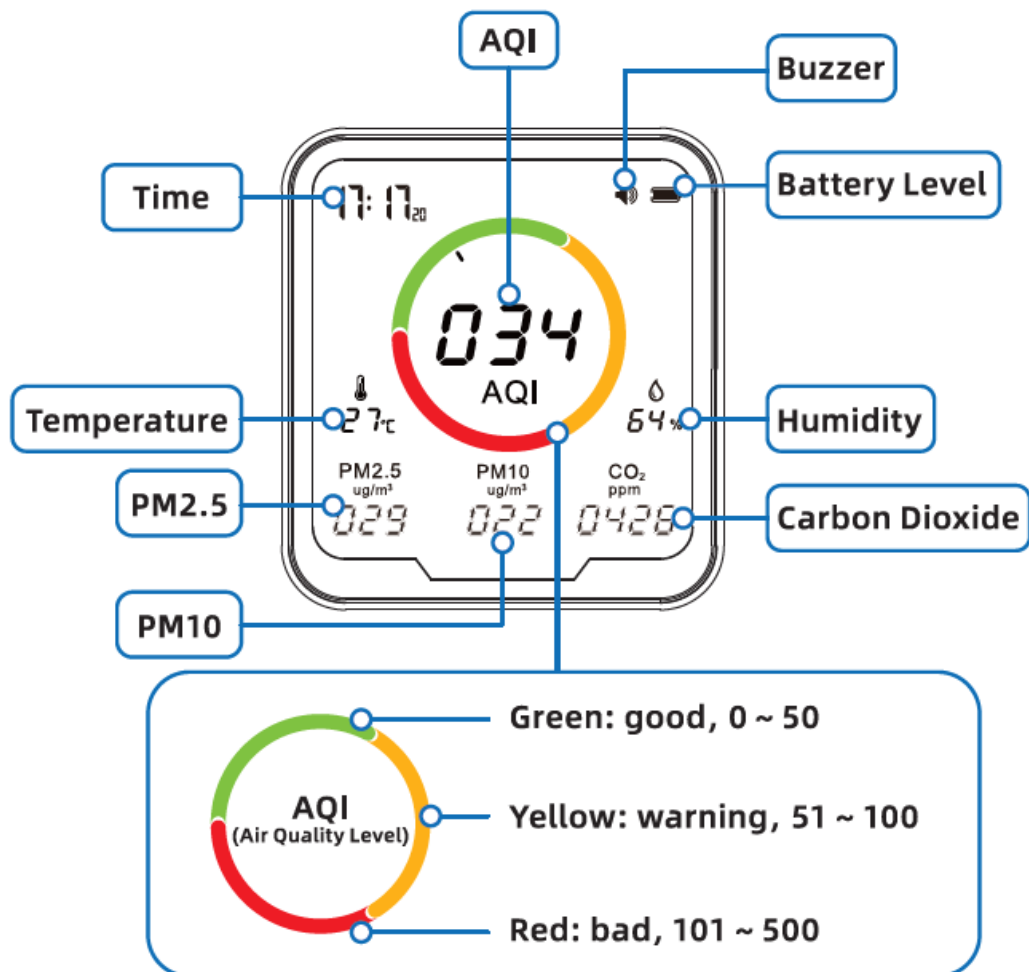

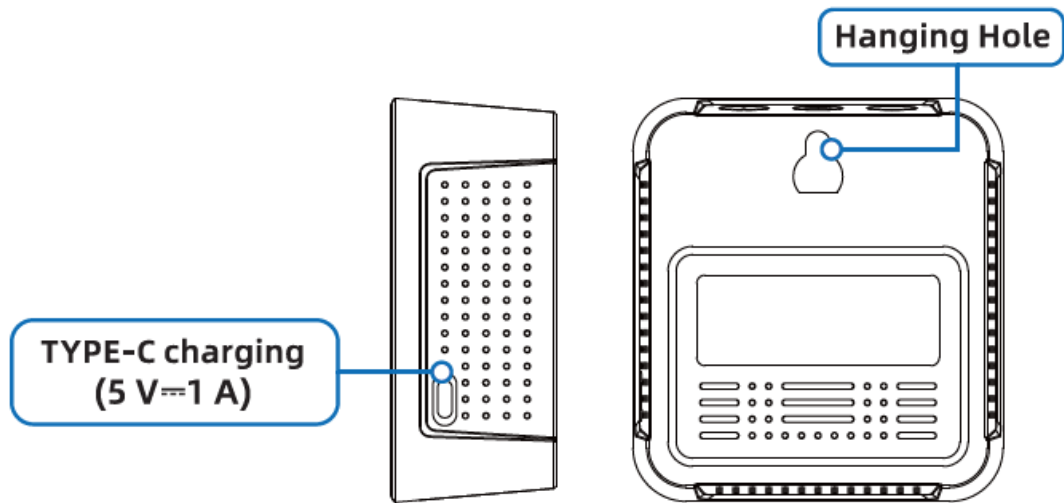

## Specification





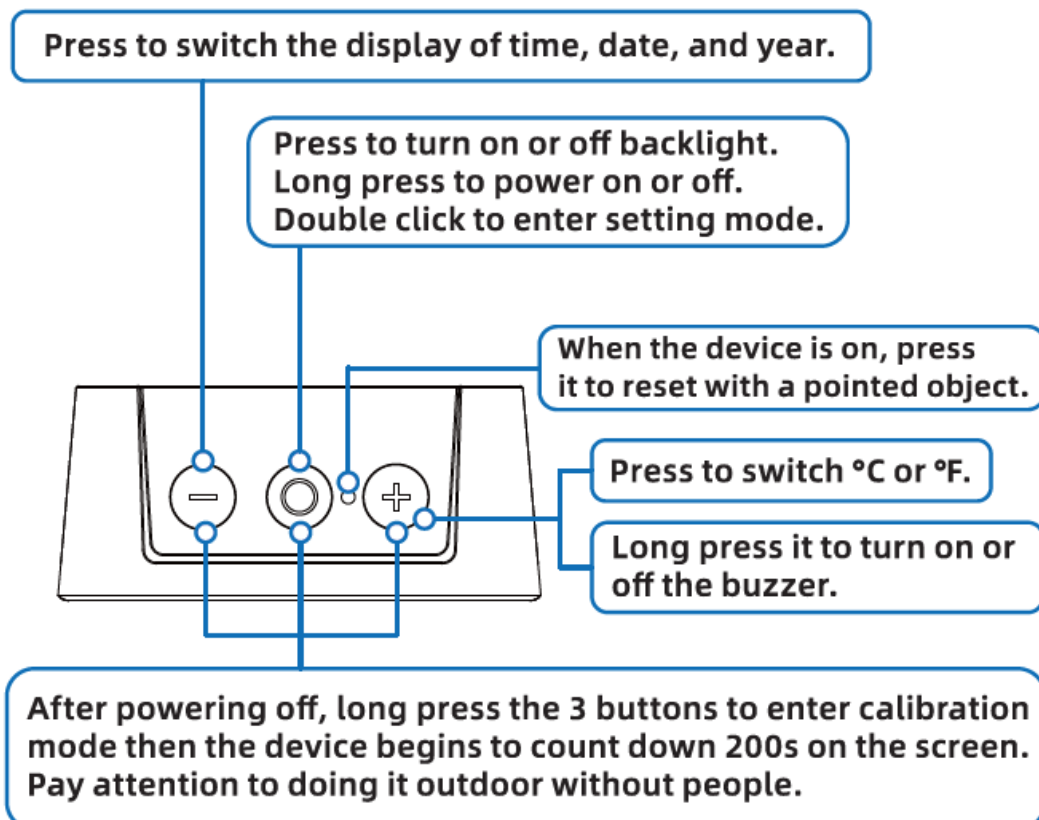

- **Air Quality Level (AQI):** 0 -500
- **Carbon Dioxide:** 400 ~ 5000 ppm[ $\pm$  (S0ppm + 5%)] Temperature: -10°C-40°C ( $\pm$ 2°C) / 14°F-104°F ( $\pm$ 3.6°F)  
Humidity: 20 -80 % RH ( $\pm$ 5 % RH)
- **PM10:** 0 ~ 1000  $\mu$ g/m<sup>3</sup> ( $\pm$ 10%)
- **PM2.5:** 0 -1000  $\mu$ g/m<sup>3</sup> ( $\pm$ 10%)
- **Product Size:** 98 x 90 x 40 mm
- **Battery:** Li-ion Cylindrical Battery/IIi-ion 186S0C (2400mAh) Input: 5 V=1 A
- **Packing List:** PTH-9A x 1; User Manual x 1; TYPE-C Cable x 1

## Operation



- **Note:** When AQI exceeds 100, and the buzzer is on, the buzzer will sound an alarm. Long press “+” button to stop it.

## How to set time, date and year

1. Double click “” button to enter setting mode, the “year” display starts to flash, and then press “+” button or “-” button to set it.
2. Press “” to confirm the setting, the “month” display starts to flash, and then press “+” button or “-” button to set it.
3. Press “” to confirm the setting, the “date” display starts to flash, and then press “+” button or “-” button to set it.
4. Press “” to confirm the setting, the “hour” display starts to flash, and then press “+” button or “-” button to set it.
5. Press “” to confirm the setting, the “minute” display starts to flash, and then press “+” button or “-” button to set it.
6. After finishing the above steps, press “” to save the settings.

## Limited Warranty

### Note:

1. Do not expose this product to water, nor place it in a high-temperature environment exceeding 60°C, and keep it away from fire;
2. This product is a precision measuring instrument, and it is not allowed to disassemble the machine without authorization;
3. Can not be placed in an environment full of dust or corrosive gas for measurement;
4. When measuring the environment in the car, please do not expose this product directly to the sun for a long time.

1-year warranty against any manufacturing defects or faulty workmanship. This warranty does not cover disposable batteries or damage from accident, neglect, misuse, alteration, contamination or abnormal conditions of operation or handling. WEEE Directive 2012/19/EU At the end of the product life, dispose of the device & batteries in a corresponding recycling center. Do not dispose of the product.

## Documents / Resources

<div></div>	<a href="#">INKBIRDPLUS PTH-9A Multi Functional Air Quality Detector</a> [pdf] User Manual PTH-9A Multi Functional Air Quality Detector, PTH-9A, PTH-9A Air Quality Detector, Multi Functional Air Quality Detector, Air Quality Detector, Multi Functional Quality Detector, Quality Detector
-------------	---

References

- [User Manual](#)

[Manuals+](#), [Privacy Policy](#)

This website is an independent publication and is neither affiliated with nor endorsed by any of the trademark owners. The "Bluetooth®" word mark and logos are registered trademarks owned by Bluetooth SIG, Inc. The "Wi-Fi®" word mark and logos are registered trademarks owned by the Wi-Fi Alliance. Any use of these marks on this website does not imply any affiliation with or endorsement.